

City of Detroit  
**City Engineering Division, Department of Public Works**  
**Survey Bureau**

**NOTICE OF PROPOSED CHANGE IN PROPERTY**

**Date:** 9-23-13

**Petition:** X 2656

- |   |  |
|---|--|
| <input type="checkbox"/> AT&T Telecommunication                         |  |
| <input type="checkbox"/> Cable Television (CATV)                        | <input checked="" type="checkbox"/> Vacation               |
| <input checked="" type="checkbox"/> Detroit Edison (DTE)                |  |
| <input type="checkbox"/> Michigan Consolidated Gas (DTE)                | <input checked="" type="checkbox"/> Conversion to Easement |
| <input type="checkbox"/> Fire Department                                | <input type="checkbox"/> Dedication                        |
| <input type="checkbox"/> Planning & Development Department              |  |
| <input type="checkbox"/> Public Lighting Dept. - Communication Division | <input type="checkbox"/> Encroachment                      |
| <input type="checkbox"/> Public Lighting Dept. - Overhead Line Division |  |
| <input type="checkbox"/> Public Lighting Dept. - Underground Division   | <input type="checkbox"/> Temporary Closing                 |
| <input type="checkbox"/> Police Department                              |  |
| <input type="checkbox"/> Recreation Department                          | <input type="checkbox"/> Berm Use                          |
| <input type="checkbox"/> Sanitation Division, DPW                       |  |
| <input type="checkbox"/> Street Design Bureau, DPW                      |  |
| <input type="checkbox"/> Street Maintenance Division, DPW               |  |
| <input type="checkbox"/> Street and Traffic Division, DPW               |  |
| <input type="checkbox"/> Water and Sewerage Dept. - Sewer Design        |  |
| <input type="checkbox"/> Water and Sewerage Dept. - Water Design        |  |

A petition drawing is attached. Property shown on the attached print is proposed to be changed as indicated.

Kindly report (using the back of this sheet) the nature of your services (if any) affected by the proposed change and the estimated costs of removing and rerouting such services (if necessary).

Please return one copy to City Engineering Division, DPW. Retain one copy and print for you file.

Alfred Jordan, Director, Department of Public Works

By: Richard Doherty, CED DPW  
Head Engineer

TO: City Engineering Division, DPW  
65 Cadillac Square, Suite 900  
Detroit, Michigan 48226-2873  
Survey Bureau: 313-224-3970  
Fax: 313-224-3471

The proposed change in property (referred to on the other side of this sheet) would affect our services as follows:

- ☐ Not Involved
- ☐ Involved; but asking you to hold action on this petition until further notice.
- ☐ Involved; but no objections to the property change .
- ☒ Involved; but no objections to the property change...provided as easement of the full width of the public right-of-way (street, alley or other public place) is reserved.
- ☐ Involved; the nature of our services, and the estimated costs of removing and/or rerouting such services are:

DTE Energy Planning + Design  
(Utility or City Department)

Irene Lynn  
By

Senior Engineer  
Title

10/2/13  
Date

313-235-4415  
Area code – Telephone number

CITY OF DETROIT CITY ENGINEERING DEPARTMENT SURVEY BUREAU	
JOB NO.	01-01
DRWG. NO.	X2656

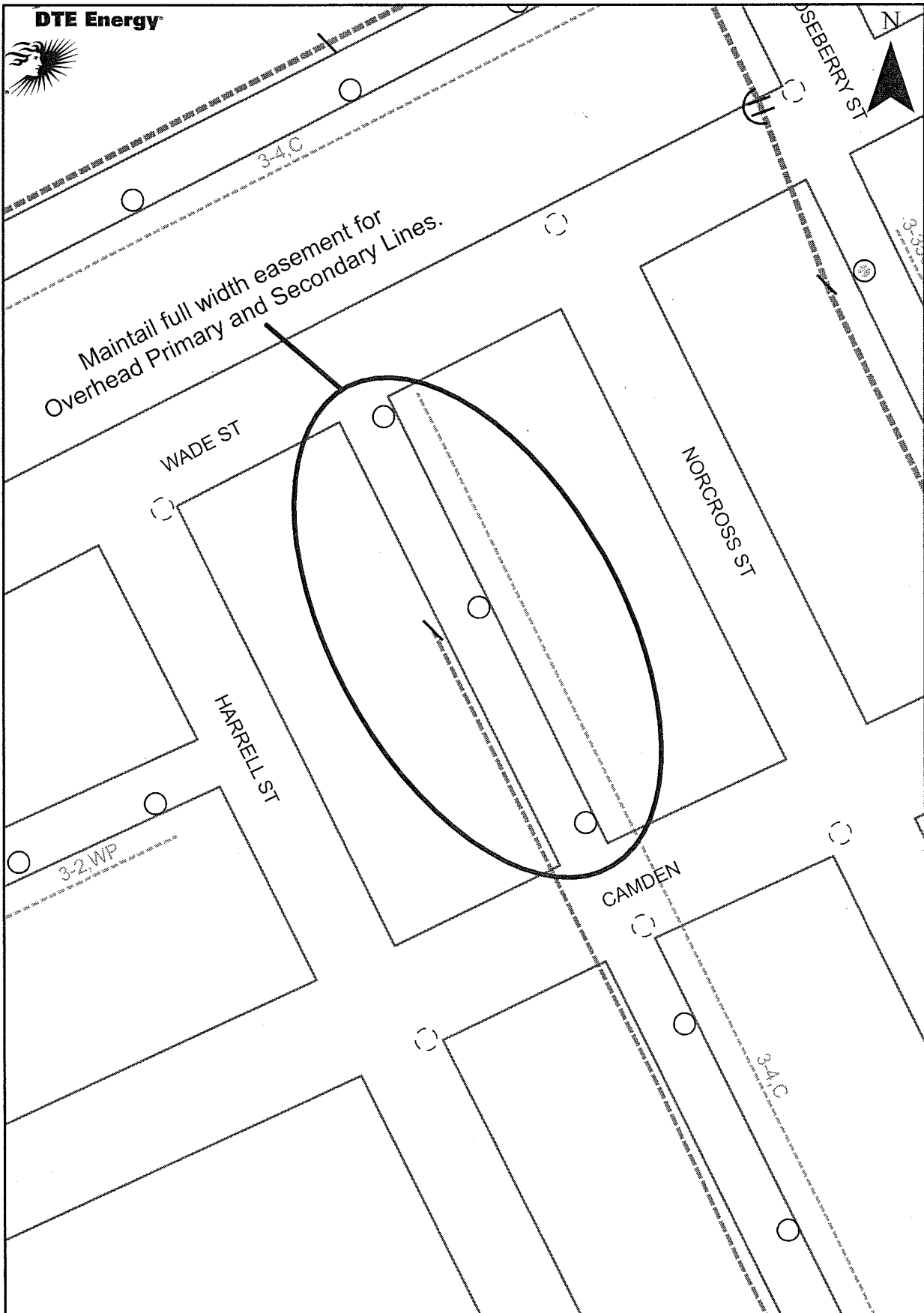

City of Detroit City Engineering Division Department of Public Works Survey Bureau Petition: X 2656	APPROVED	DTE ELECTRIC COMPANY	
		REGIONAL PLANNING	
		LAYOUT BY IRL	DRAWN BY IRL
		DATE 10/2/13	DRAWING NUMBER
	SCALE		