



**DTE Energy**

**DTE Energy - Michigan Consolidated Gas Company  
Data Integrity and Technology, Drafting Department  
One Energy Plaza, WCB-1836, 18<sup>TH</sup> Floor  
City of Detroit, MI 48226**

**April 2, 2013**

**Richard Doherty, CED DPW, City Engineer**  
City of Detroit Engineering Division, DPW  
65 Cadillac Square, Suite 900  
City of Detroit, MI 48226-2873

**RE: Petition #2628                      Dated: 03/26/2013**

The proposed change in property referred to would affect our services as follows:

- Not involved, no gas involved, and no objections. **See Remarks!**
- Involved but withholding action on petition until further notice.
- Involved but have no objection to the property change, provided that an easement of the full width of of the street/alley is reserved as shown.
- Involved – nature of services and estimated cost of removing or rerouting such services are:

**REMARKS:**

**Not involved, no gas involved, and no objections to the request for Conversion to Easement the 20' Wd. E/W Alley in the abb: Alpine, Garden, Central, and Tireman. Please see enclosed strip print for your use and information.**

**Please abide by Public Act 53, three (3) working days before you dig, dial toll free MISS DIG at: 1 – 800 – 482 – 7171.**

**Michcon Gas Leak Emergency Phone Number: 1- 800 – 947 – 5000.**

Sincerely,

*/s/ Eddie A. Reyes*  
Senior Drafter  
Data Integrity and Technology

EAR/  
Enclosure

**RECEIVED APR 04 2013**

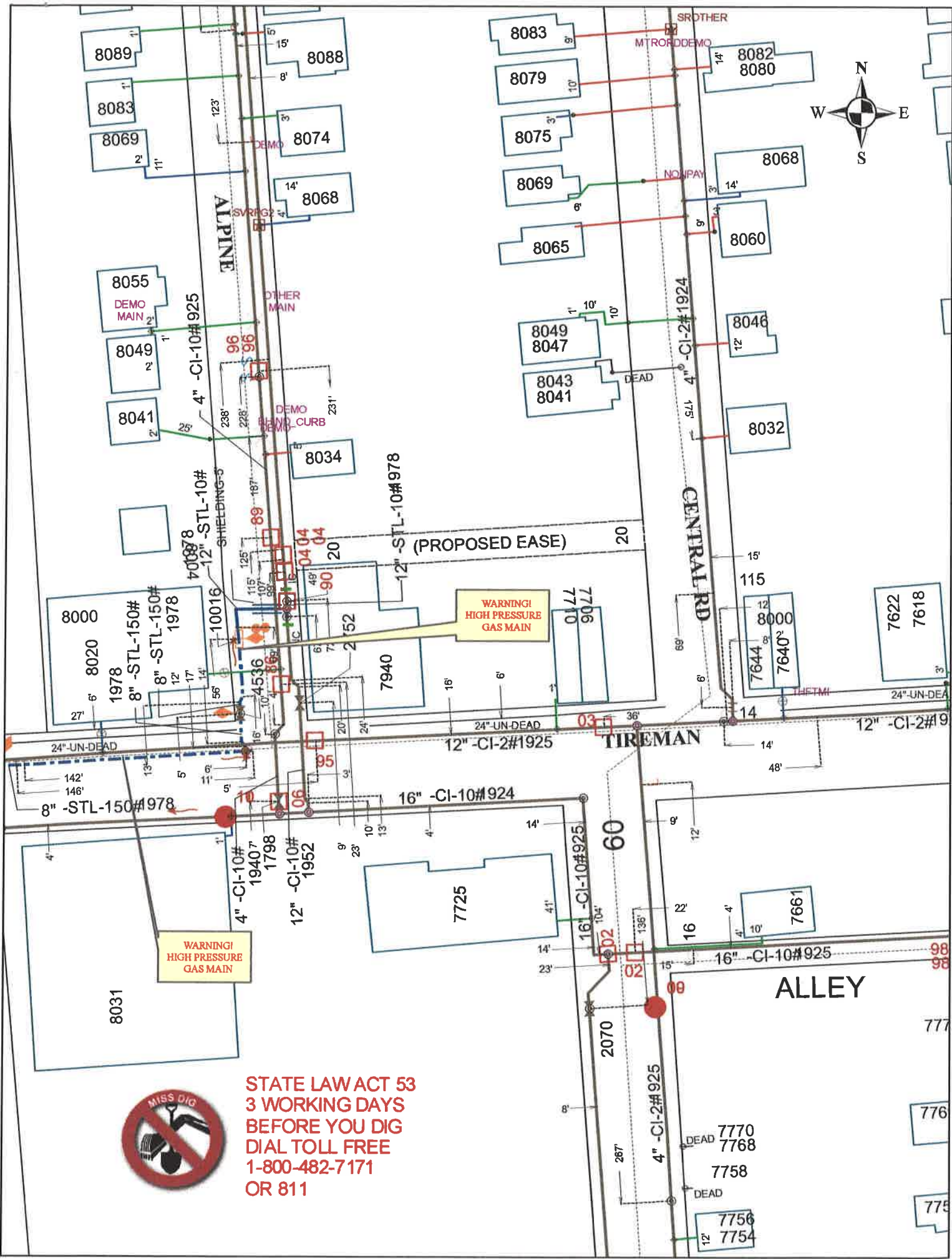

**WARNING!**  
HIGH PRESSURE  
GAS MAIN

**WARNING!**  
HIGH PRESSURE  
GAS MAIN



**STATE LAW ACT 53**  
**3 WORKING DAYS**  
**BEFORE YOU DIG**  
**DIAL TOLL FREE**  
**1-800-482-7171**  
**OR 811**

City of Detroit  
**City Engineering Division, Department of Public Works  
Survey Bureau**

**NOTICE OF PROPOSED CHANGE IN PROPERTY**

**Date:** 3-26-2013

**Petition:** x 2628

- |   |  |
|---|--|
| <input type="checkbox"/> AT&T Telecommunication                         |  |
| <input type="checkbox"/> Cable Television (CATV)                        | <input type="checkbox"/> Vacation                          |
| <input type="checkbox"/> Detroit Edison (DTE)                           |  |
| <input type="checkbox"/> Michigan Consolidated Gas (DTE)                | <input checked="" type="checkbox"/> Conversion to Easement |
| <input type="checkbox"/> Fire Department                                | <input type="checkbox"/> Dedication                        |
| <input type="checkbox"/> Planning & Development Department              |  |
| <input type="checkbox"/> Public Lighting Dept. - Communication Division | <input type="checkbox"/> Encroachment                      |
| <input type="checkbox"/> Public Lighting Dept. - Overhead Line Division |  |
| <input type="checkbox"/> Public Lighting Dept. - Underground Division   | <input type="checkbox"/> Temporary Closing                 |
| <input type="checkbox"/> Police Department                              |  |
| <input type="checkbox"/> Recreation Department                          | <input type="checkbox"/> Berm Use                          |
| <input type="checkbox"/> Sanitation Division, DPW                       |  |
| <input type="checkbox"/> Street Design Bureau, DPW                      |  |
| <input type="checkbox"/> Street Maintenance Division, DPW               |  |
| <input type="checkbox"/> Street and Traffic Division, DPW               |  |
| <input type="checkbox"/> Water and Sewerage Dept. - Sewer Design        |  |
| <input type="checkbox"/> Water and Sewerage Dept. - Water Design        |  |

A petition drawing is attached. Property shown on the attached print is proposed to be changed as indicated.

Kindly report (using the back of this sheet) the nature of your services if any) affected by the proposed change and the estimated costs of removing and rerouting such services (if necessary).

Please return one copy to City Engineering Division, DPW. Retain one copy and print for you file.

Alfred Jordan, Director, Department of Public Works

By: Richard Doherty, CED DPW  
Head Engineer

PETITION NO. 2628  
 AYED AL MODHGI  
 7706 TIREMAN  
 DETROIT, MICHIGAN 48204  
 PHONE NO. 734 686 9696



**GARDEN AVE. 50 FT. WD.**

**ALPINE AVE. 50 FT. WD.**

**CENTRAL AVE. 60 FT. WD.**

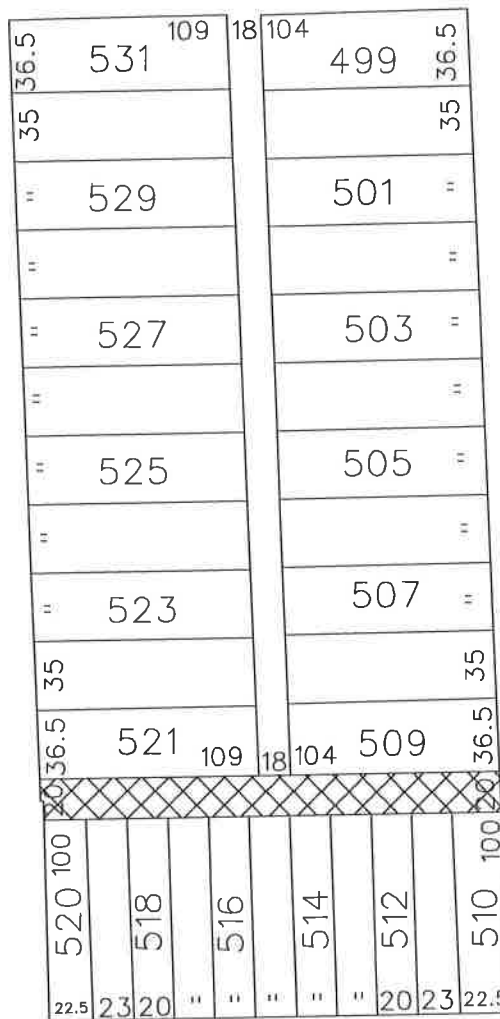

**TIREMAN AVE. 66 FT. WD.**



- AREA OF EASEMENT

(FOR OFFICE USE ONLY)

CARTO 6 A

B					
A					
DESCRIPTION	DRWN	CHKD	APPD	DATE	
REVISIONS					
DRAWN BY	KSM		CHECKED		
DATE	3-21-13		APPROVED		

**REQUEST CONVERSION TO EASEMENT  
 THE 20 FOOT WIDE E/W ALLEY  
 IN THE AREA BOUND BY  
 ALPINE, GARDEN, CENTRAL  
 AND TIREMAN**

<b>CITY OF DETROIT</b>	
CITY ENGINEERING DEPARTMENT	
SURVEY BUREAU	
JOB NO.	01-01
DRWG. NO.	X2628.dgn