

City of Detroit
**City Engineering Division, Department of Public Works
Survey Bureau**

NOTICE OF PROPOSED CHANGE IN PROPERTY

Date: 3-26-2013

Petition: x 2628

- | | |
|---|--|
| <input type="checkbox"/> AT&T Telecommunication | |
| <input type="checkbox"/> Cable Television (CATV) | <input type="checkbox"/> Vacation |
| <input type="checkbox"/> Detroit Edison (DTE) | |
| <input type="checkbox"/> Michigan Consolidated Gas (DTE) | <input checked="" type="checkbox"/> Conversion to Easement |
| <input type="checkbox"/> Fire Department | <input type="checkbox"/> Dedication |
| <input type="checkbox"/> Planning & Development Department | |
| <input type="checkbox"/> Public Lighting Dept. - Communication Division | <input type="checkbox"/> Encroachment |
| <input type="checkbox"/> Public Lighting Dept. - Overhead Line Division | |
| <input type="checkbox"/> Public Lighting Dept. - Underground Division | <input type="checkbox"/> Temporary Closing |
| <input checked="" type="checkbox"/> Police Department | |
| <input type="checkbox"/> Recreation Department | <input type="checkbox"/> Berm Use |
| <input type="checkbox"/> Sanitation Division, DPW | |
| <input type="checkbox"/> Street Design Bureau, DPW | |
| <input type="checkbox"/> Street Maintenance Division, DPW | |
| <input type="checkbox"/> Street and Traffic Division, DPW | |
| <input type="checkbox"/> Water and Sewerage Dept. - Sewer Design | |
| <input type="checkbox"/> Water and Sewerage Dept. - Water Design | |

A petition drawing is attached. Property shown on the attached print is proposed to be changed as indicated.

Kindly report (using the back of this sheet) the nature of your services if any) affected by the proposed change and the estimated costs of removing and rerouting such services (if necessary).

Please return one copy to City Engineering Division, DPW. Retain one copy and print for you file.

Alfred Jordan, Director, Department of Public Works

By: Richard Doherty, CED DPW
Head Engineer

1/29/2013 clr

CITY ENGINEERING DIVISION - DPW
900 CADILLAC TOWER
DETROIT, MICHIGAN 48226-2873

RECEIVED
SEP 24 2013
PATROL OPERATIONS BUREAU

RECEIVED OCT 21 2013

**TO: City Engineering Division, DPW
65 Cadillac Square, Suite 900
Detroit, Michigan 48226-2873
Survey Bureau: 313-224-3970
Fax: 313-224-3471**

The proposed change in property (referred to on the other side of this sheet) would affect our services as follows:

- Not Involved
- Involved; but asking you to hold action on this petition until further notice.
- Involved; but no objections to the property change .
- Involved; but no objections to the property change...provided as easement of the full width of the public right-of-way (street, alley or other public place) is reserved.
- Involved; the nature of our services, and the estimated costs of removing and/or rerouting such services are:

DPD- SECOND PRECINCT
(Utility or City Department)

UNESSA WYATT
By

SERGEANT
Title

10/7/13
Date

(313) 596-5210
Area code - Telephone number



PETITION NO. 2628
 AYED AL MODHGI
 7706 TIREMAN
 DETROIT, MICHIGAN 48204
 PHONE NO. 734 686 9696



GARDEN AVE. 50 FT. WD.

ALPINE AVE. 50 FT. WD.

CENTRAL AVE. 60 FT. WD.

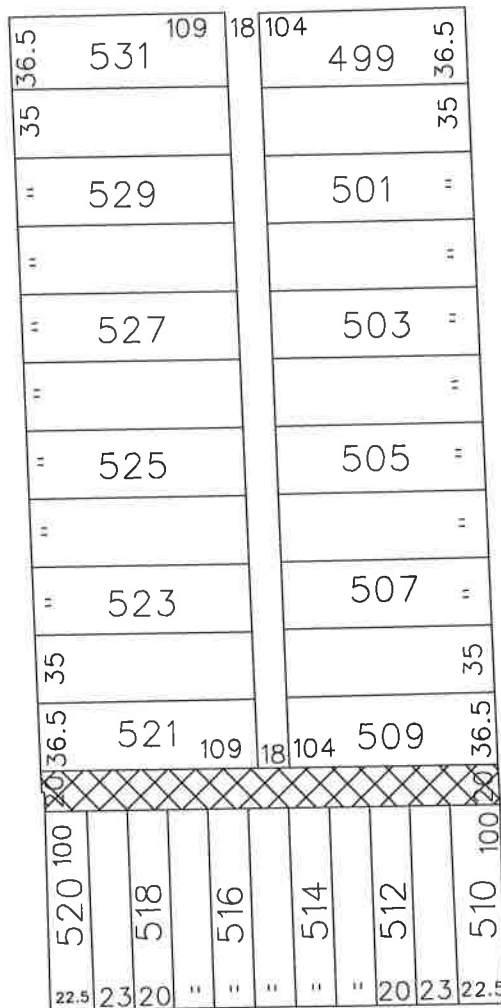

TIREMAN AVE. 66 FT. WD.



- AREA OF EASEMENT

(FOR OFFICE USE ONLY)

CARTO 6 A

B					
A					
DESCRIPTION	DRWN	CHKD	APPD	DATE	
REVISIONS					
DRAWN BY	KSM				
DATE	3-21-13				
	CHECKED				
	APPROVED				

**REQUEST CONVERSION TO EASEMENT
 THE 20 FOOT WIDE E/W ALLEY
 IN THE AREA BOUND BY
 ALPINE, GARDEN, CENTRAL
 AND TIREMAN**

CITY OF DETROIT	
CITY ENGINEERING DEPARTMENT	
SURVEY BUREAU	
JOB NO.	01-01
DRWG. NO.	X2628.dgn