

City of Detroit  
OFFICE OF THE CITY CLERK

Janice M. Winfrey  
City Clerk

Vivian A. Hudson  
Deputy City Clerk

**DEPARTMENTAL REFERENCE COMMUNICATION**

*Wednesday, June 27, 2012*

*To: The Department or Commission Listed Below*

*From: Janice M. Winfrey, Detroit City Clerk*

---

The following petition is herewith referred to you for report and recommendation to the City Council.

In accordance with that body's directive, kindly return the same with your report in duplicate within four (4) weeks.

---

PLANNING AND DEVELOPMENT DEPARTMENT    DPW - CITY ENGINEERING DIVISION

**2434**    *Quatro Construction LLC, requesting permanent alley closure behind abutting property located at 2479 W. Davison or Lots 175 thru 182 and 2513 thru 2477 Waverly or Lots 170 thru 163.*

City of Detroit Engineering Department

Quatro Construction LLC  
201 N. Park Street  
Ypsilanti, MI 48198

MAY 21 9 09

-CITY CLERK-

To Whom it may concern:

We are requesting to permanent closure of the allyway behind the property commonly known as 2479 W. Davison or Lots 175 thru 182 and Property commonly known as 2513 thru 2477 Waverly or lots 170 thru 163. There is a temporary closure in place at the present and we are requesting it become permanent.



Deponent: Salwan Yono

WARNING TO DEPONENT: A PERSON, WITH INTENT TO DEFRAUD, GIVES FALSE SWORN STATEMENT IS SUBJECT TO CRIMINAL PENALTIES AS PROVIDED IN SECTION 110 OF THE MICHIGAN CONSTRUCTION LIEN ACT, ACT NO. 497 OF THE PUBLIC ACTS OF 1980, AS AMENDED, SECTION 570.1110 OF THE MICHIGAN COMPLIED LAWS.

Subscribed and sworn to before me this

County of

day of 2012

Notary Public

My Commission Expires

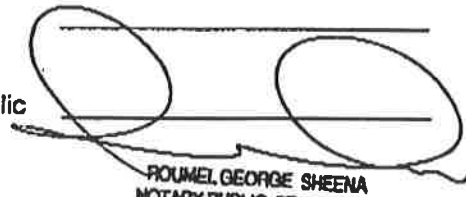
  
ROUMEL GEORGE SHEENA  
NOTARY PUBLIC, STATE OF MI  
COUNTY OF OAKLAND  
MY COMMISSION EXPIRES JUN 14, 2012  
ACTING IN COUNTY OF Oakland

PETITION NO. 2434  
 QUATRO CONSTRUCTION LLC  
 201 N. PARK STREET  
 YPSILANTI, MICHIGAN 48198  
 C/O SALWAN YONO  
 PHONE NO. 734 485 7737



LINWOOD AVE. 86 FT. WD.

DAVISON AVENUE 120 FT. WD.

LASALLE AVE. 80 FT. WD.

WAVERLY AVE. 50 FT. WD.

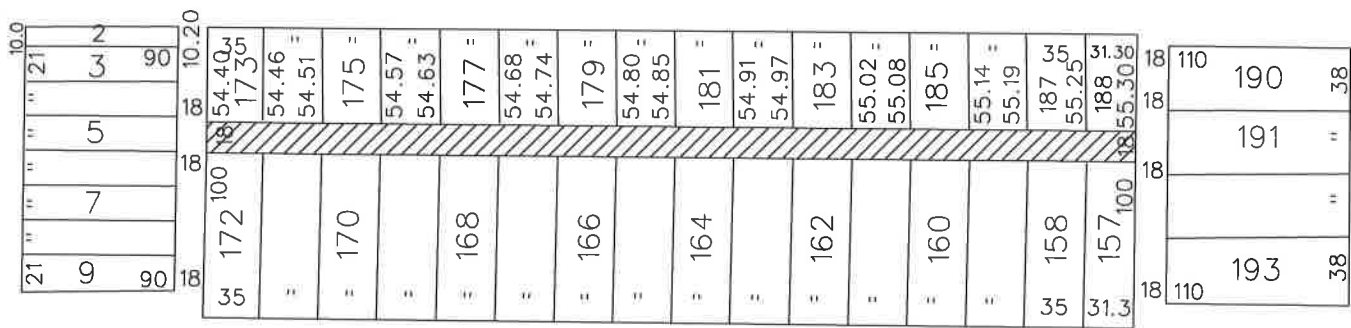

 - AREA OF EASEMENT

(FOR OFFICE USE ONLY)

CARTO 23 A

B					
A					
DESCRIPTION		DRWN	CHKD	APPD	DATE
REVISIONS					
DRAWN BY		CHECKED			
KSM					
DATE		APPROVED			
9-17-12					

REQUEST CONVERSION TO EASEMENT  
 THE 18 FT. WD. E/W ALLEY  
 IN THE AREA BOUND BY  
 DAVISON, LASALLE, WAVERLY  
 AND LINWOOD

CITY OF DETROIT	
CITY ENGINEERING DEPARTMENT	
SURVEY BUREAU	
JOB NO.	01-01
DRWG. NO.	X2434.dgn