

City of Detroit
OFFICE OF THE CITY CLERK

Janice M. Winfrey
City Clerk

Vivian A. Hudson
Deputy City Clerk

DEPARTMENTAL REFERENCE COMMUNICATION

Thursday, August 26, 2010

To: The Department or Commission Listed Below

From: Janice M. Winfrey, Detroit City Clerk

The following petition is herewith referred to you for report and recommendation to the City Council.

In accordance with that body's directive, kindly return the same with your report in duplicate within four (4) weeks.

PLANNING AND DEVELOPMENT DEPARTMENT DPW - CITY ENGINEERING DIVISION

666 *La Terraza, requesting outdoor café permit in front of 1633 Lawndale St.*

6666

August 11th 2010

City Clerk's Office
Coleman A Young, Municipal Center
Detroit, MI 48226

Dear Sir

I, YSRAEL ROCHA-VILLASENOR, owner of the Restaurant "LA TERRAZA", located at 1633 Lawndale St., Detroit, MI 48209, kindly request your authorization to install, outside of the business, some tables to give service to our customers, see floor site drawing attached.

Our intention is give a different image to our neighborhood, we are trying to recover the pleasant places that were neighboring our City of Detroit; Southwest Business Association is supporting this initiative.

We estimate, after to get the sidewalk permit, start to build that comfortable and nice space on September 2010, we won't give service during winter time.

This project, also, will provide employment that people need at this moment, we need arise again and we want to help to do that.

We will comply with the ordinances required to obtain the permit above mentioned.

If you need additional information, please feel free to contact me at the address or phone below indicated.

Thank you so much

Sincerely



Ysrael Rocha-Villasenor
1633 Lawndale St.
Detroit, MI 48209
(313)843-1433

18 AUG 10 3:45

--CITY CLERK--

RESTAURANT LA TERRAZA
1633 LAWMDALE, DET. MI 48209
SITE PLAN

A L L E Y

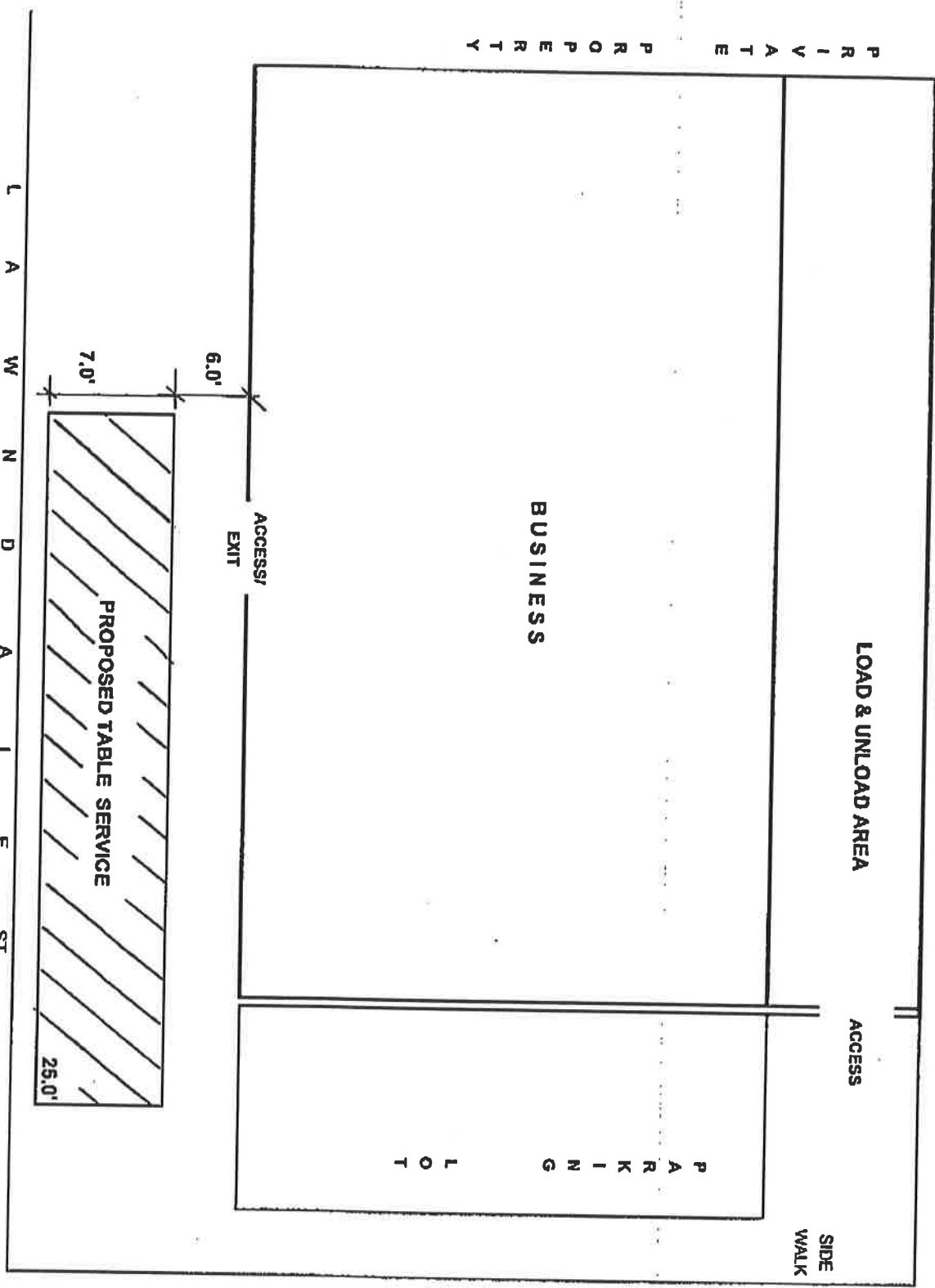

P R I V A T E
P R O P E R T Y

B U S I N E S S

L O A D & U N L O A D A R E A

A C C E S S

S I D E
W A L K

P A R K I N G
L O T

P R O P O S E D T A B L E S E R V I C E

25.0'

L A W M D A L E S T.

C A B O T
S T.

PETITION NO. 666
 LA TERRAZA
 1633 LAWNDALE STREET
 DETROIT, MICHIGAN 48209
 C/O YSRAEL ROCHA-VILLASENOR
 PHONE NO. 313 843 1433



AVIS AVE. 50 FT.WD.

LAWNDALE AVE. 66 FT. WD.

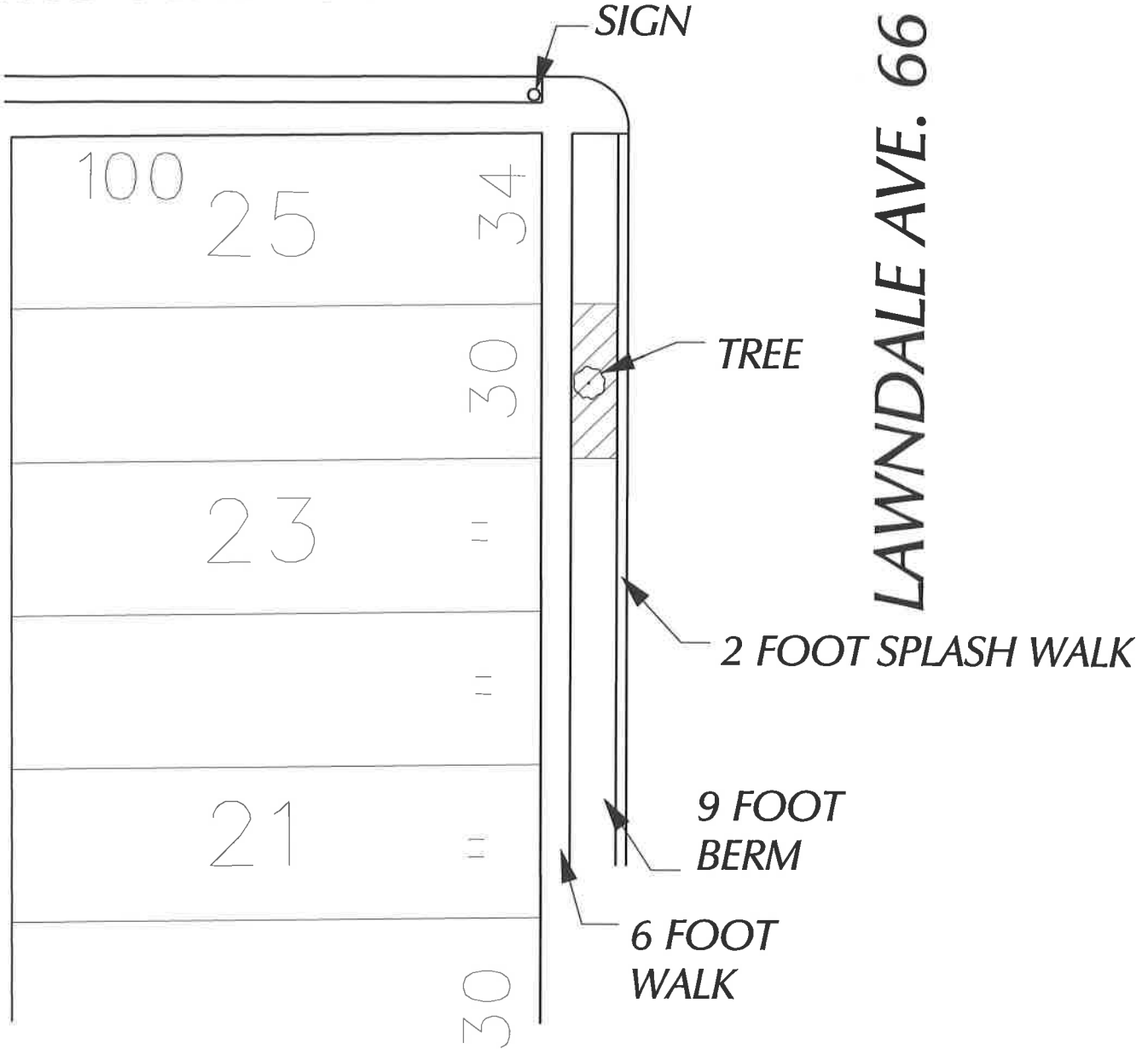

- AREA OF ENCROACHMENT
(with sidewalk cafe)

(FOR OFFICE USE ONLY)

CARTO 2 B

B					
A					
DESCRIPTION	DRWN	CHKD	APPD	DATE	
REVISIONS					
DRAWN BY	KSM		CHECKED		
DATE	4-26-11		APPROVED	<i>[Signature]</i>	

**REQUEST ENCROACHMENT
 INTO LAWNDALE BERM
 (With Sidewalk Cafe)**

CITY OF DETROIT
 CITY ENGINEERING DEPARTMENT
 SURVEY BUREAU

JOB NO. 01-01

DRWG. NO. X666.dgn