

City of Detroit
OFFICE OF THE CITY CLERK

ONE
Janice M. Winfrey
City Clerk

Vivian A. Hudson
Deputy City Clerk

DEPARTMENTAL REFERENCE COMMUNICATION

Friday, August 08, 2008

To: The Department or Commission Listed Below

From: Janice M. Winfrey, Detroit City Clerk

The following petition is herewith referred to you for report and recommendation to the City Council.

In accordance with that body's directive, kindly return the same with your report in duplicate within four (4) weeks.

DPW - CITY ENGINEERING DIVISION

2860 *Giffels-Webster Engineers, Inc., request to vacate the existing 18' wide public ally lying approximately north south between Trumbull St. (west) and Lincoln Ave. (east), and Canfield Ave. (north) and Calumet Ave. (south).*

RECEIVED
AUG 11 2008

30 D

30

LED
TBD

2860

July 15, 2008

City Clerk's Office
200 Coleman A. Young Municipal Center
Two Woodward Avenue
Detroit, MI 48226

RE: Woodbridge Farms
Alley Vacation
GWE No. 15615.14D

Honorable City Council Members:

Giffels-Webster Engineers, Inc. is requesting a petition to vacate the existing 18' wide public alley lying approximately north south between Trumbull Street (west) and Lincoln Avenue (east), and Canfield Avenue (north) and Calumet Avenue (south). This request is to vacate the alley from Canfield Avenue to Calumet Avenue with easements to remain for existing utilities in said alley. This request has been indicated on the attached Exhibit A.

Please review this matter and notify us once the City Council has made a decision. If you have any questions, or require additional information, feel free to contact me at (586) 781.8950. Thank you in advance for your assistance in this matter.

Respectfully,

Giffels-Webster Engineers, Inc.

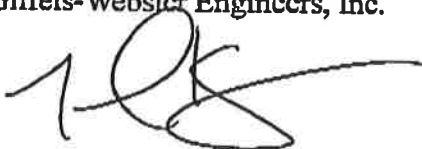

Mike Kozak, P.E.
Project Manager

Attachment – Exhibit A

cc: Eric Gold

2008 JUL 18 A 10:50

PETITION NO. 2860
GIFFELS-WEBSTER ENGINEERS INC.
67100 VAN DYKE
WASHINGTON TWP. MI. 48095
c/o MIKE KOZAK, P.E.
586 781-9812 FAX 586 336-9812



CANFIELD

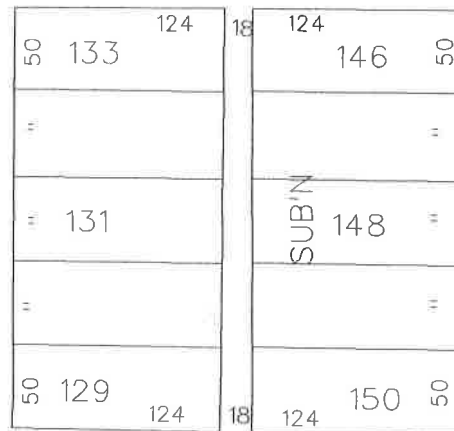

CALUMET AVE.

TRUMBULL

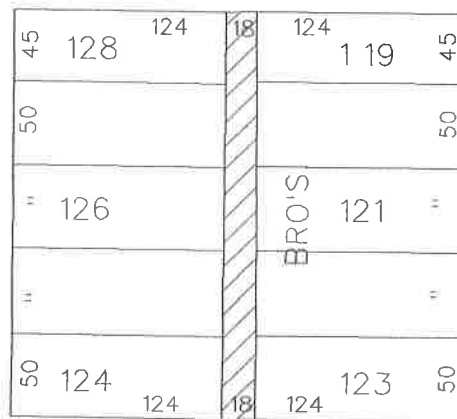

LINCOLN



- REQUESTED CONVERSION TO EASEMENT

(FOR OFFICE USE ONLY)

CARTO 30 D

B					REQUEST TO VACATE EX. 18' WD. PUBLIC ALLEY LYING APPROX. NORTH SOUTH BETWEEN TRUMBULL ST. (west) AND LINCOLN AVE. (east), AND CANFIELD AVW. (north) AND CALUMET AVE. (south)	CITY OF DETROIT CITY ENGINEERING DEPARTMENT SURVEY BUREAU
	A					
DESCRIPTION		DRWN	CHKD	APPD	DATE	DRWG. NO. x 2860.dgn
DRAWN BY KM		CHECKED				
DATE 11/7/08		APPROVED				