

City of Detroit
OFFICE OF THE CITY CLERK

Janice M. Winfrey
City Clerk

Vivian A. Hudson
Deputy City Clerk

DEPARTMENTAL REFERENCE COMMUNICATION

Friday, October 13, 2006

To: *The Department or Commission Listed Below*

From: *Janice M. Winfrey, Detroit City Clerk*

The following petition is herewith referred to you for report and recommendation to the City Council.

In accordance with that body's directive, kindly return the same with your report in duplicate within four (4) weeks.

CITY PLANNING COMMISSION PLANNING AND DEVELOPMENT DEPARTMENT
PUBLIC WORKS DEPARTMENT TRANSPORTATION DEPARTMENT

1028 *Detroit Ready Mix Concrete, et al, request closure of Alpine Street in area of 9000 Alpine at Westfield - Lot 25 North to East Lot 16 of Hills Industrial Subdivision.*

7f
LVM 159

RECEIVED
CITY ENGINEERING DIV.-DPW

OCT 16 2006

By _____

CBS
TBS
NOEL

October 4, 2006

05 9 : 53
Y CLSRK -

Honorable Janice M. Winfrey
Office of the City Clerk, Room 200
200 Coleman A. Young Municipal Center
Detroit, MI 48226

1028

Re: Petition to Close Alpine Street

Honorable Janice M. Winfrey:

The following business owners are petitioning for the right to close Alpine Street from 9000 Alpine - Lot 25 North to Westfield and then East on Westfield to the east lot line of Lot 16 of Hills Industrial Sub. The property on both sides of Alpine and Westfield are zoned heavy industrial and have limited usage. There is a chronic problem with dumping and crime.

We propose closing the street to through traffic from 6:00P.M. to 6:00A.M. There would not be a problem with emergency vehicles, since all the affected properties on Alpine are vacant. All of the property owners would have keys to the gates. If this is approved, we would like to accomplish this immediately.

If you have any questions, please contact Shelby Wheatley of Detroit Ready Mix at 313-931-7043.

American Auto Recycling
8951 Alpine
Detroit, MI 48204

Monamad Beychouni
Moe Beychouni
Owner

✓ Custom Limestone
9201 Central Ave.
Detroit, MI 48204

Glenn Placucci
Glenn Placucci
Owner

✓ Detroit Ready Mix
9189 Central Ave.
Detroit, MI 48204

Shelby Wheatley
Shelby Wheatley
President

Excell Metals
9301 Central Ave.
Detroit, MI 48204

Marin Ardelean
Marin Ardelean
Owner
Vice President

Joy Construction
7730 Joy Rd.
Detroit, MI 48204

W.L. Moore
W.L. Moore
President

Usher Oil
9000 Roselawn
Detroit, MI 48204

✓ Matt Usher
Matt Usher
Vice President

W. CHICAGO



ROSELAWN

EXCELL
VACANT

Building
EXCELL
METALS

WESTFIELD

PROPOSED
GATE

50'

Building - Lot #16
CUSTOM
LIMESTONE

USHER
VACANT

ALPINE 50'

DETROIT READY
MIX
VACANT

Building
DETROIT
READY
MIX

Building
USHER
OIL

CENTRAL 50'

Building
AMERICAN
AUTO
RECYCLE

PROPOSED
GATE

LOT #25
9000 Alpine

VACANT
Toy

VACANT

Building
Toy Coast

613-c

JOY ROAD

ALPINE

7F
LVM150

PETITION #1028
DETROIT READY MIX CONCRETE
9189 CENTRAL AVE.
DETROIT, MI 48204
c/o SHELBY WHEATLY
PHONE #313-931-7043



W. CHICAGO 66 FT. WD.

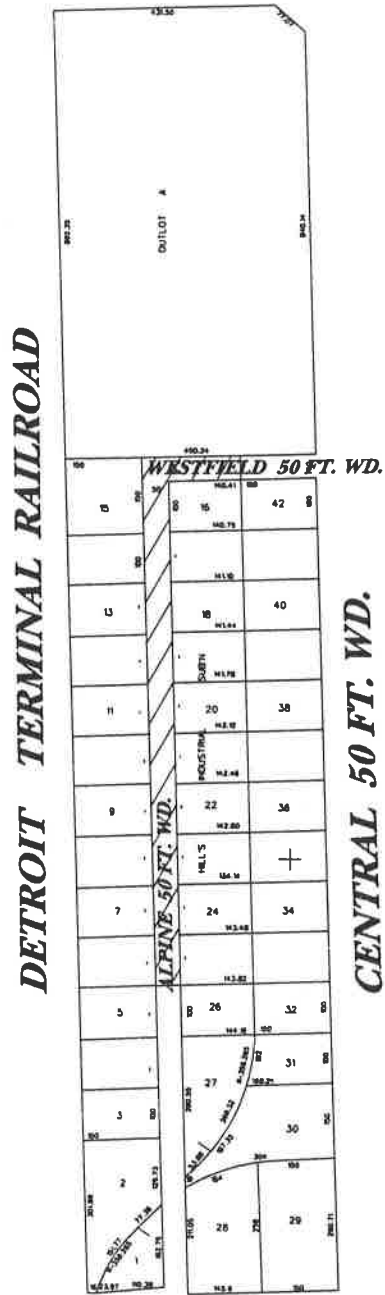

 - TEMPORARY CLOSURE

JOY RD. 58 FT. WD.

(FOR OFFICE USE ONLY)

WSM 16-M
CARTO 7f

B						REQUESTED TEMPORARY CLOSURE OF A PORTION OF ALPINE 50 FT. WD. AND WESTFIELD 50 FT. WD. IN THE AREA OF JOY RD., W. CHICAGO AND CENTRAL RAILROAD.	CITY OF DETROIT CITY ENGINEERING DEPARTMENT SURVEY BUREAU	
A								JOB NO. 01-01
DESCRIPTION		DRWN	CHKD	APPD	DATE			DRWG. NO. x1028.dgn
REVISIONS								
DRAWN BY		CHECKED						
DATE		APPROVED						
10/19/06								