

City of Detroit
OFFICE OF THE CITY CLERK

Jackie L. Currie
City Clerk

Vernon C. Allen
Deputy City Clerk

DEPARTMENTAL REFERENCE COMMUNICATION

January 12, 2005

To: The Department or Commission Listed Below

From: Jackie L. Currie
Detroit City Clerk

The following petition is herewith referred to you for report and recommendation to the City Council

In accordance with that body's directive, kindly return the same with your report in duplicate within four (4) weeks.

/POLICE/PUBLIC WORKS/TRANSPORTATION DEPARTMENTS/

3307 Barton Malow Company, for temporary street closures in area of Lafayette, Shelby, and Michigan.

RECEIVED
CITY ENGINEERING DIV.-DPW

JAN 19 2005

By _____

Peter Talley

January 11, 2005

City Clerk
City of Detroit

02 : 0 0 11 05

Attention: Ms Jackie Currie

-CITY CLERK-

Re: Lafayette Street closure between Shelby and Griswold

Dear Jackie:

Barton Malow is currently building an addition the Financial District Garage located on the corner of Shelby and Lafayette. We have been able to demolish the Olde Building, which occupied the site of the new addition utilizing a half street closure. The crane required by logistics to assemble the new structure will require a full street closure to allow material to flow and the crane to be operated safely.

We will fence the construction area and provide signage showing the existing business's daily operation information. We are scheduled to start assembling the crane February 25, 2005 and weather permitting finish the new addition April 15, 2005.

We request a full street closure for sixty days for the time period identified above.

Sincerely,

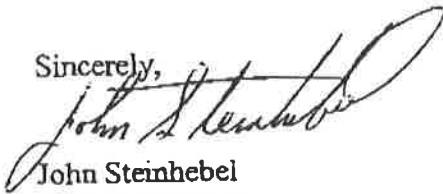

John Steinhebel
Project Manager
Barton Malow Company

Attached: Pictures and drawing of the street, which show the access to the business's affected by the street closure. It also shows the seven parking meters affected.

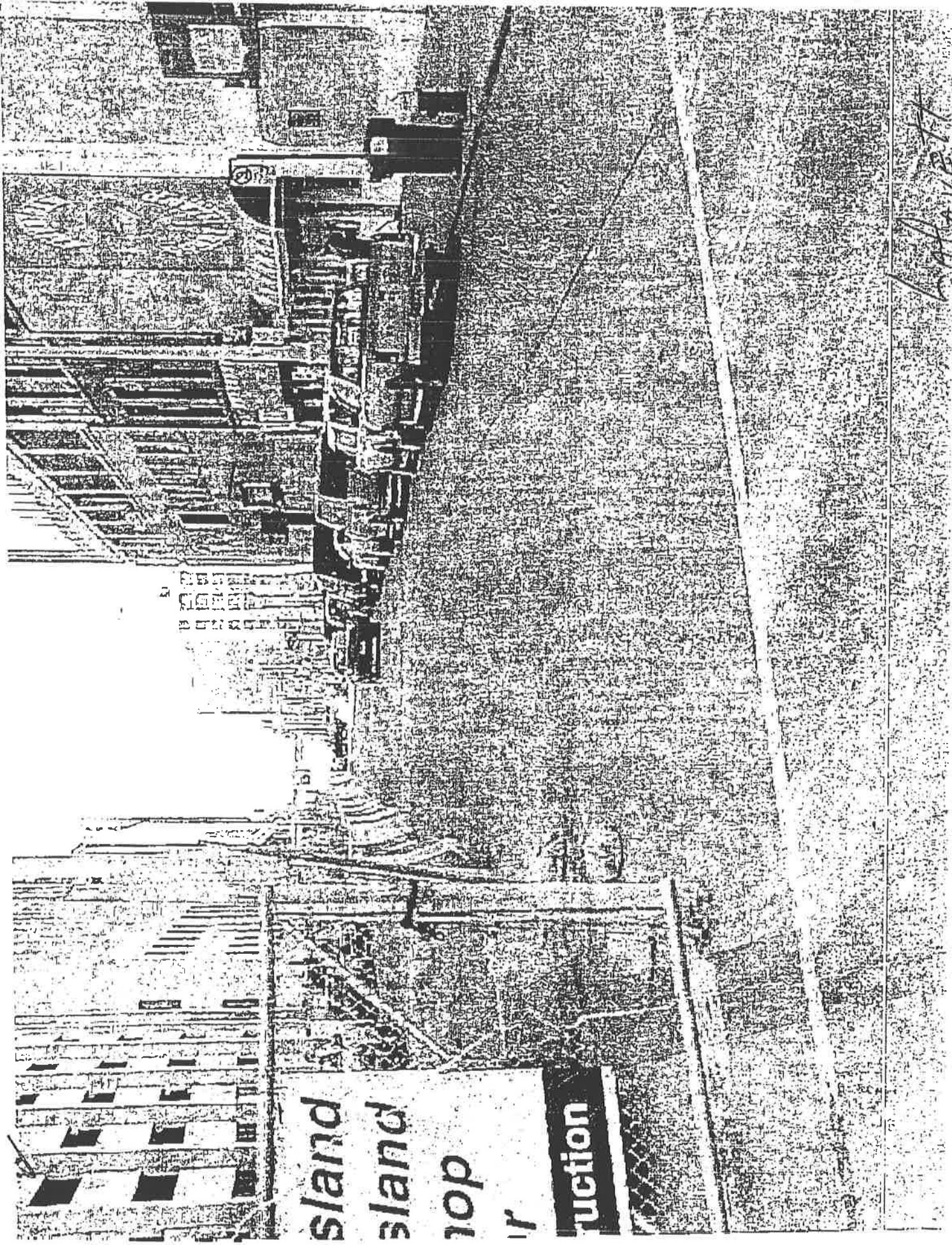

sland
sland
top
r
uction

LA 1277

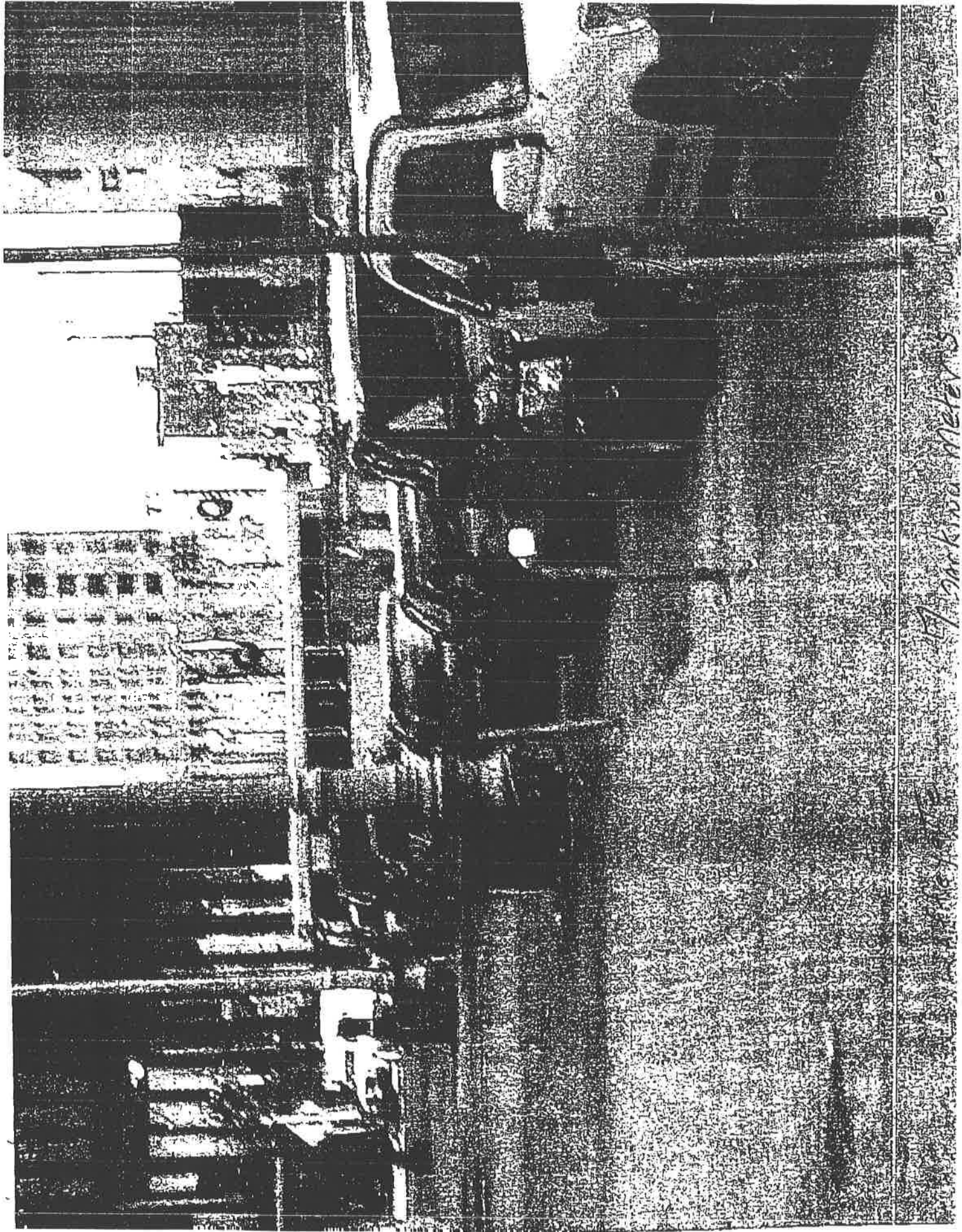

Jackie Meyer's

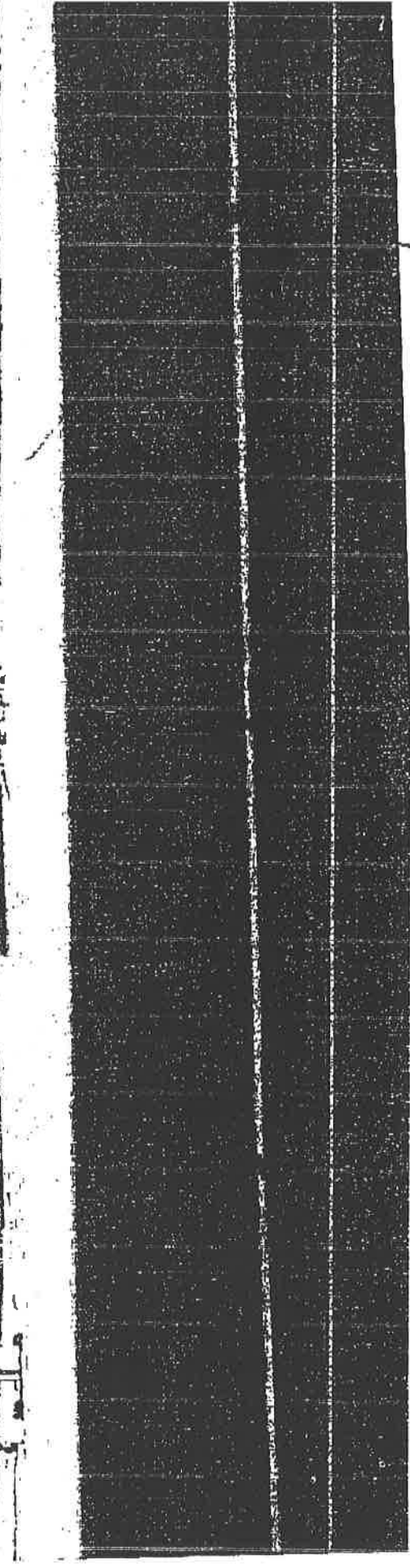
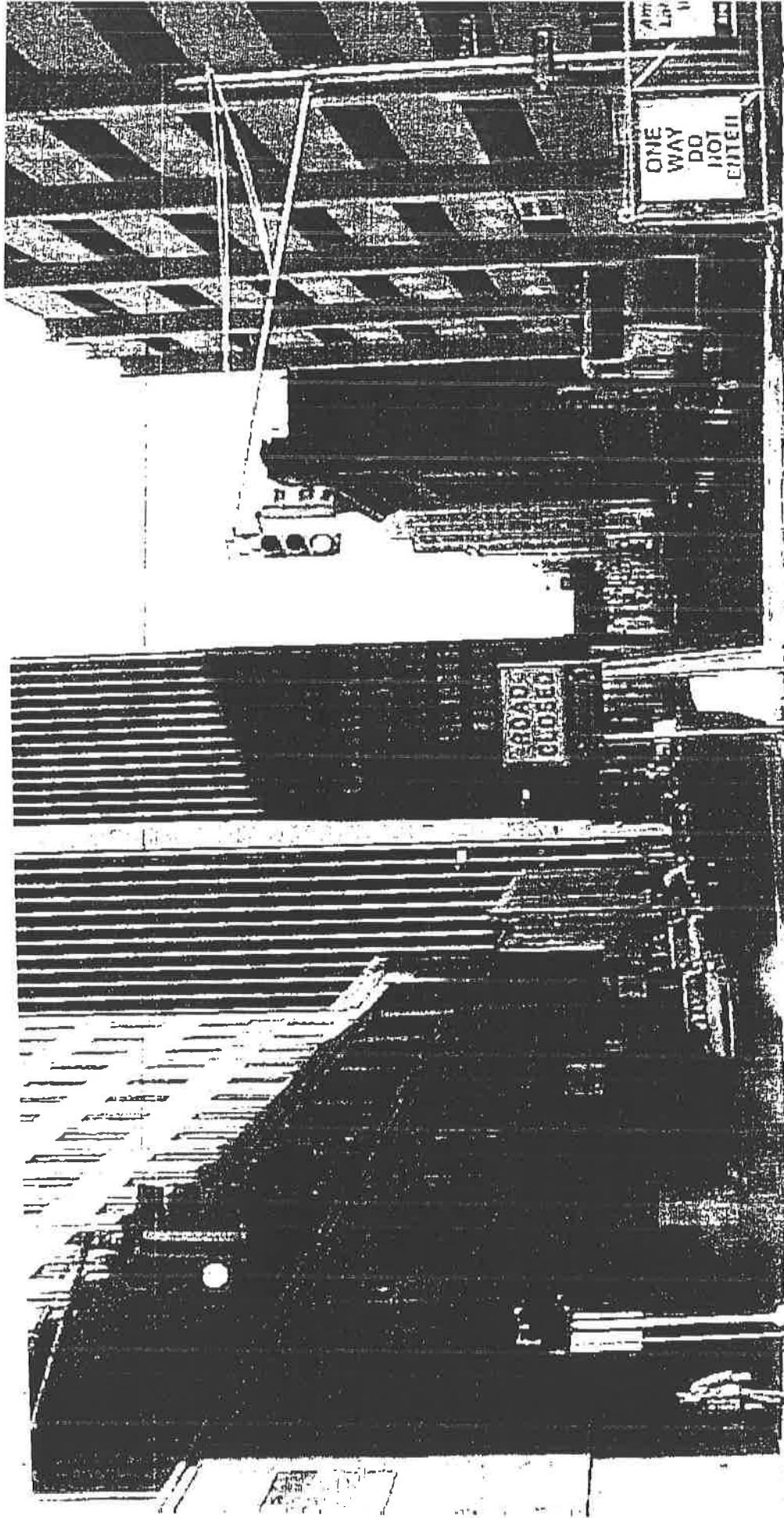

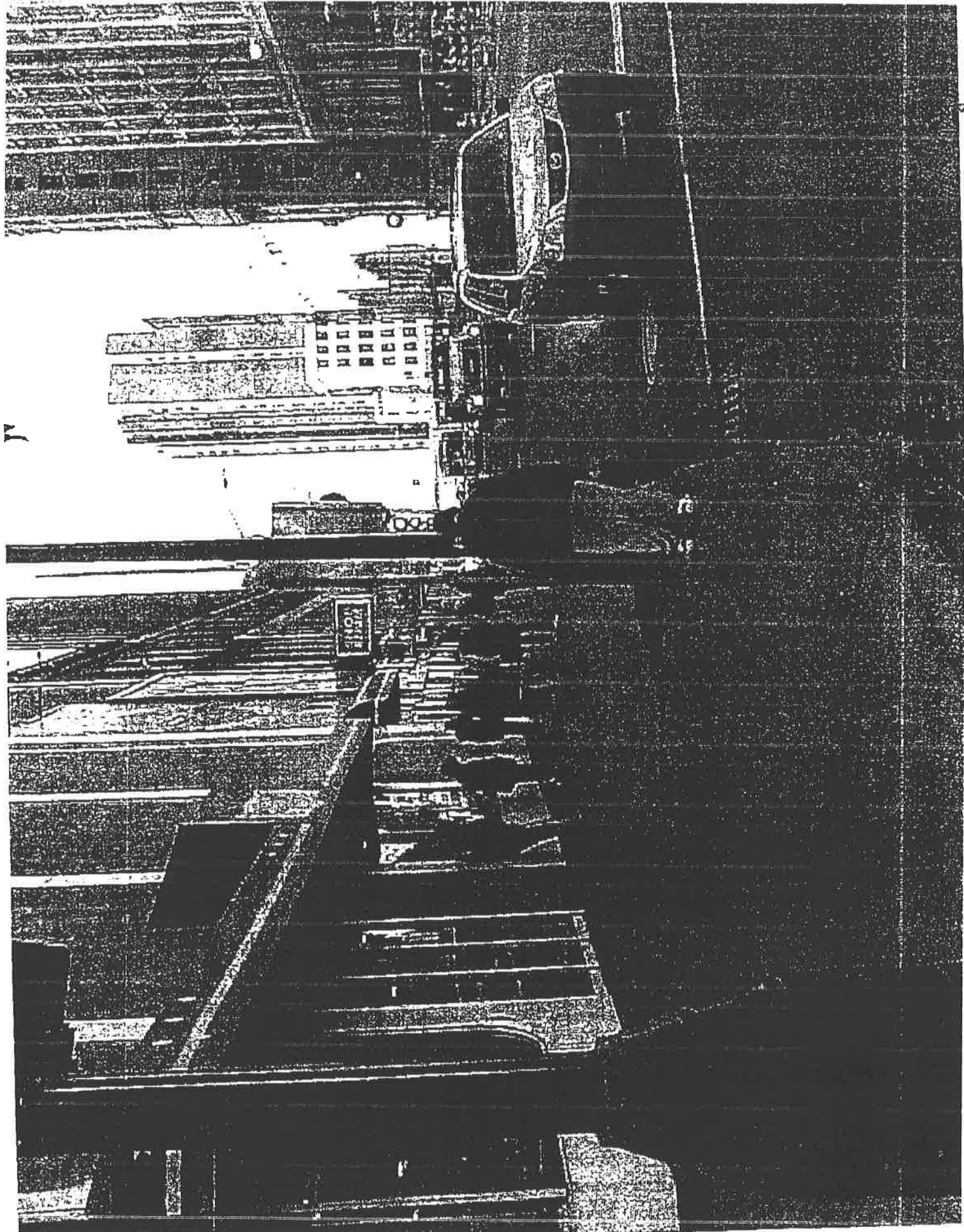

PROJECT: BARTON MALDOW
 739 GRISWOLD
 DETROIT, MICHIGAN 48226
 DATE: 10/15/88
 DRAWING NO: 100-100-100-100

**BARTON MALDOW
 739 GRISWOLD
 SUITE 1000
 DETROIT, MI 48226**



**FINANCIAL DISTRICT
 PARKING
 DECK PROJECT
 PHASE II
 SITE PLAN**

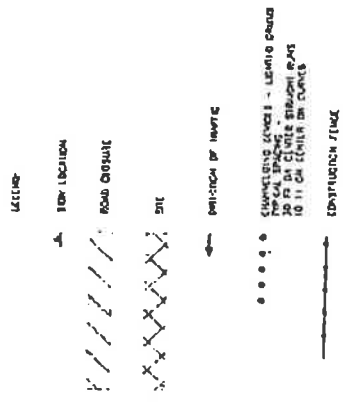
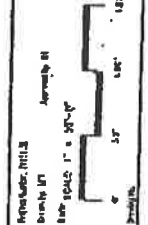

GENERAL NOTES:

- 1) SOURCE OF CONSTRUCTION MATERIALS AND REGULATORY AGENCIES TO BE CONSULTED SHALL BE DETERMINED BY THE ARCHITECT. THE ARCHITECT SHALL BE RESPONSIBLE FOR OBTAINING ALL NECESSARY PERMITS AND APPROVALS FROM ALL APPLICABLE AGENCIES. THE ARCHITECT SHALL BE RESPONSIBLE FOR OBTAINING ALL NECESSARY PERMITS AND APPROVALS FROM ALL APPLICABLE AGENCIES.
- 2) ALL TRAFFIC CONTROL DEVICES USED ON THE STREET SHALL MEET THE REQUIREMENTS OF THE MICHIGAN MANUAL OF UNIFORM TRAFFIC CONTROL DEVICES. ALL TRAFFIC CONTROL DEVICES SHALL BE INSTALLED AND MAINTAINED IN ACCORDANCE WITH THE MICHIGAN MANUAL OF UNIFORM TRAFFIC CONTROL DEVICES. ALL TRAFFIC CONTROL DEVICES SHALL BE INSTALLED AND MAINTAINED IN ACCORDANCE WITH THE MICHIGAN MANUAL OF UNIFORM TRAFFIC CONTROL DEVICES.
- 3) ALL TRAFFIC CONTROL DEVICES SHALL BE INSTALLED AND MAINTAINED IN ACCORDANCE WITH THE MICHIGAN MANUAL OF UNIFORM TRAFFIC CONTROL DEVICES. ALL TRAFFIC CONTROL DEVICES SHALL BE INSTALLED AND MAINTAINED IN ACCORDANCE WITH THE MICHIGAN MANUAL OF UNIFORM TRAFFIC CONTROL DEVICES.
- 4) ALL TRAFFIC CONTROL DEVICES SHALL BE INSTALLED AND MAINTAINED IN ACCORDANCE WITH THE MICHIGAN MANUAL OF UNIFORM TRAFFIC CONTROL DEVICES. ALL TRAFFIC CONTROL DEVICES SHALL BE INSTALLED AND MAINTAINED IN ACCORDANCE WITH THE MICHIGAN MANUAL OF UNIFORM TRAFFIC CONTROL DEVICES.
- 5) ALL TRAFFIC CONTROL DEVICES SHALL BE INSTALLED AND MAINTAINED IN ACCORDANCE WITH THE MICHIGAN MANUAL OF UNIFORM TRAFFIC CONTROL DEVICES. ALL TRAFFIC CONTROL DEVICES SHALL BE INSTALLED AND MAINTAINED IN ACCORDANCE WITH THE MICHIGAN MANUAL OF UNIFORM TRAFFIC CONTROL DEVICES.

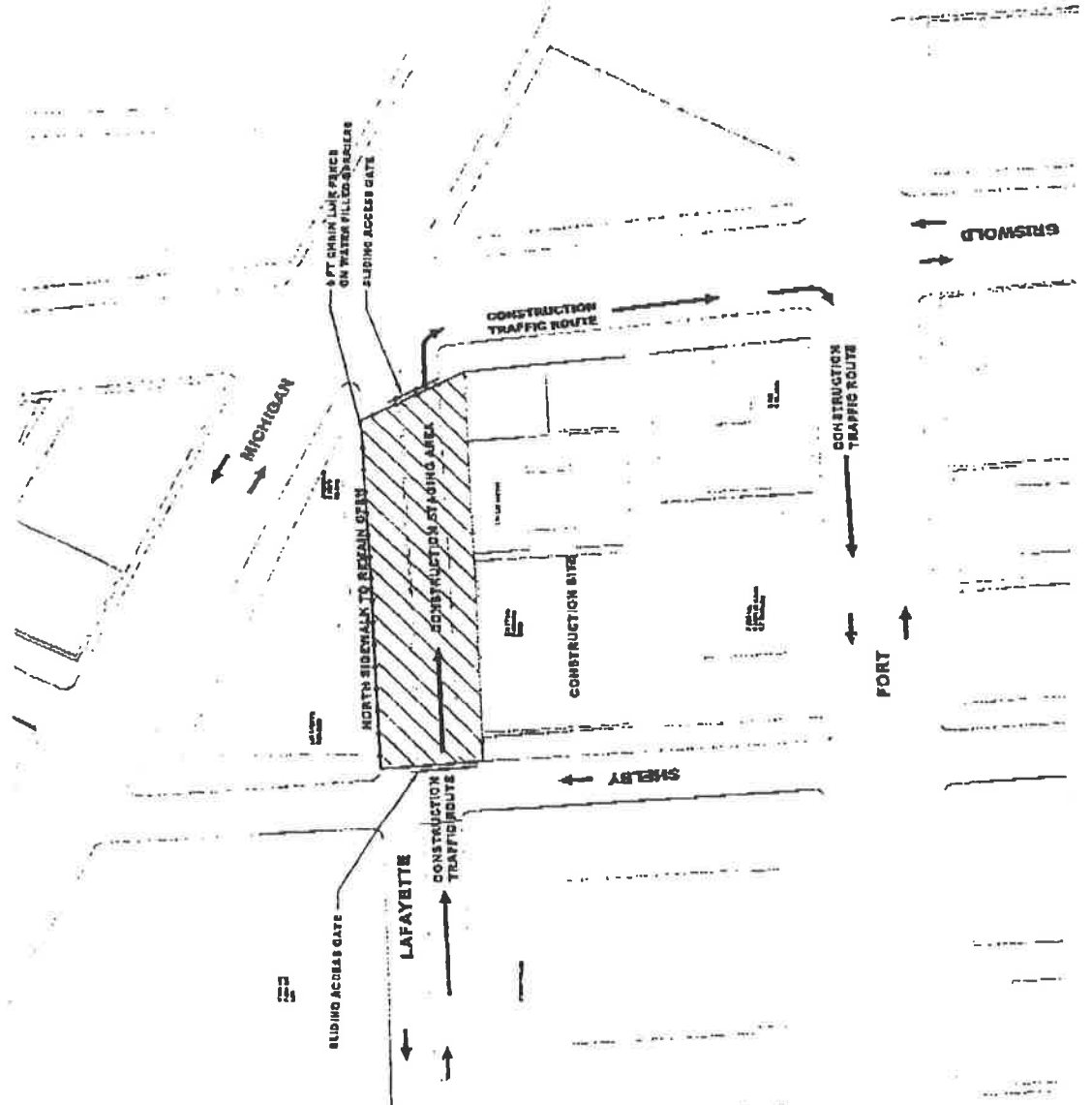

PLATE 1
 LAFAYETTE AND FORT TO GRISWOLD
 NORTH SIDEWALK TO REMAIN OPEN
 CONSTRUCTION PERIOD: 10/15/88 TO DECEMBER 1, 1988, 22 DAYS

Hamilton Anderson

ARCHITECTS PLANNERS AND ENGINEERS
1000 Woodward Avenue
Detroit, Michigan 48226
Telephone: 462-1500

Hamilton Anderson Associates
1000 Woodward Avenue
Detroit, Michigan 48226
Telephone: 462-1500

BY
BARTON MALOW
719 GRUBWOLD
DETROIT, MI 48226

DATE: _____
SCALE: _____
**FINANCIAL DISTRICT
PARKING
DECK PROJECT**
**PHASE II
PEDESTRIAN
CIRCULATION PLAN**

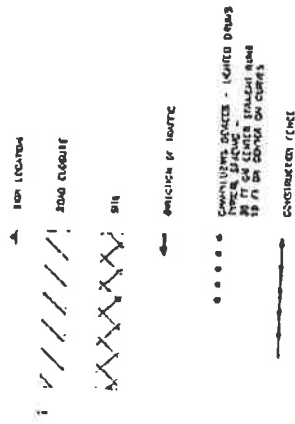
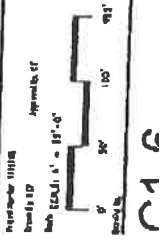

- 1) LOCATIONS OF CONSTRUCTION, INCLUDING THE EXISTING JOB, ARE IDENTIFIED AND MARKED WITH THE APPROPRIATE SYMBOLS AND DIMENSIONS. THE LOCATION OF THE JOB IS IDENTIFIED BY A DOTTED LINE AND THE LOCATION OF THE JOB IS IDENTIFIED BY A SOLID LINE.
- 2) ALL WORK NECESSARY FOR THE PROTECTION OF ALL PEDESTRIAN TRAFFIC SHALL BE IDENTIFIED BY A DOTTED LINE AND THE LOCATION OF THE JOB IS IDENTIFIED BY A SOLID LINE.
- 3) ALL SIDEWALKS SHALL BE IDENTIFIED BY A DOTTED LINE AND THE LOCATION OF THE JOB IS IDENTIFIED BY A SOLID LINE.
- 4) ALL SIDEWALKS SHALL BE IDENTIFIED BY A DOTTED LINE AND THE LOCATION OF THE JOB IS IDENTIFIED BY A SOLID LINE.
- 5) ALL SIDEWALKS SHALL BE IDENTIFIED BY A DOTTED LINE AND THE LOCATION OF THE JOB IS IDENTIFIED BY A SOLID LINE.
- 6) ALL SIDEWALKS SHALL BE IDENTIFIED BY A DOTTED LINE AND THE LOCATION OF THE JOB IS IDENTIFIED BY A SOLID LINE.
- 7) ALL SIDEWALKS SHALL BE IDENTIFIED BY A DOTTED LINE AND THE LOCATION OF THE JOB IS IDENTIFIED BY A SOLID LINE.
- 8) ALL SIDEWALKS SHALL BE IDENTIFIED BY A DOTTED LINE AND THE LOCATION OF THE JOB IS IDENTIFIED BY A SOLID LINE.
- 9) ALL SIDEWALKS SHALL BE IDENTIFIED BY A DOTTED LINE AND THE LOCATION OF THE JOB IS IDENTIFIED BY A SOLID LINE.
- 10) ALL SIDEWALKS SHALL BE IDENTIFIED BY A DOTTED LINE AND THE LOCATION OF THE JOB IS IDENTIFIED BY A SOLID LINE.

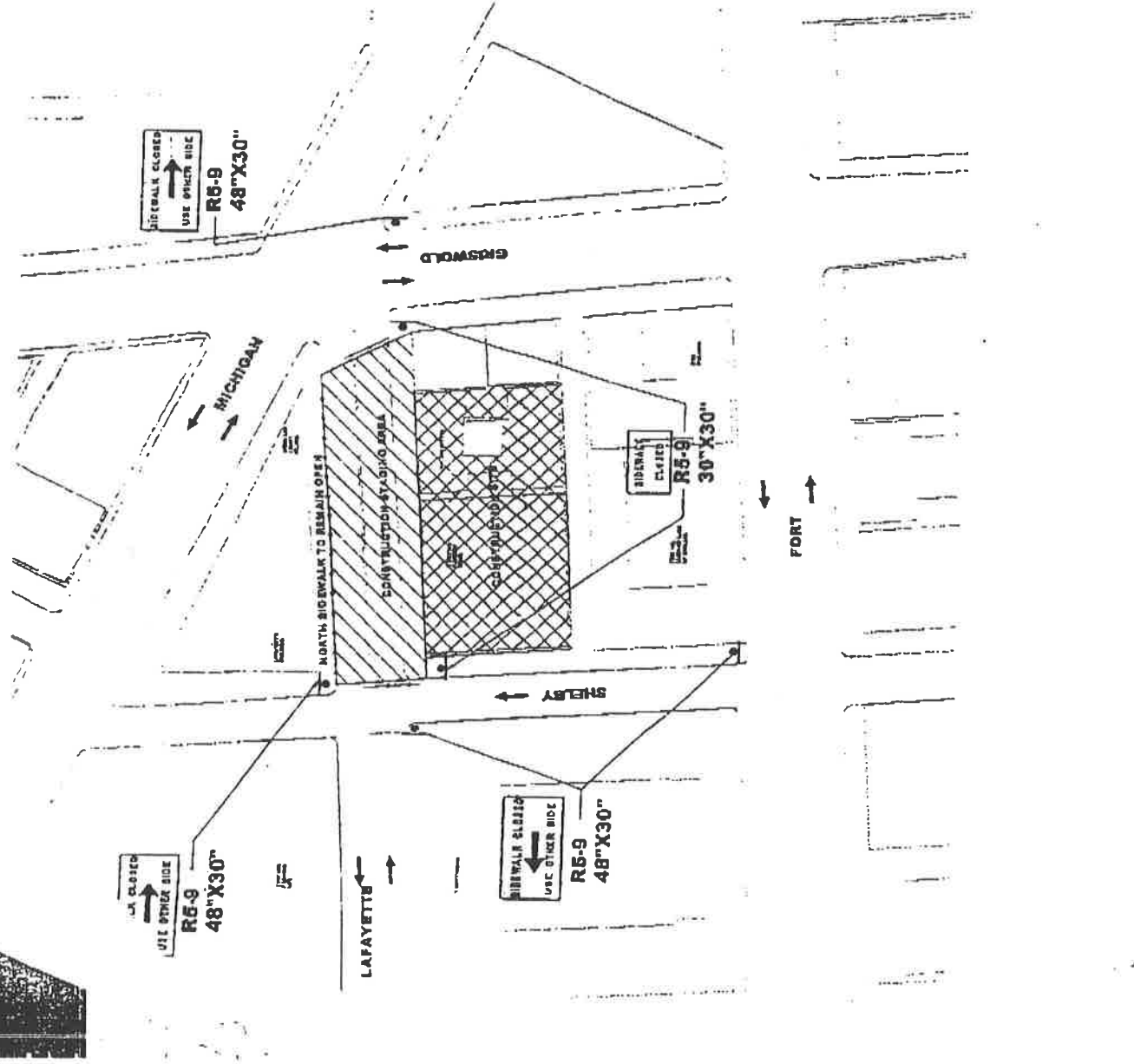

FIGURE 1

DATE: _____
SCALE: _____