

**City of Detroit**  
OFFICE OF THE CITY CLERK

Jackie L. Currie  
City Clerk

Vernon C. Allen  
Deputy City Clerk

**DEPARTMENTAL REFERENCE COMMUNICATION**

December 1, 2004

To: The Department or Commission Listed Below

From: Jackie L. Currie  
Detroit City Clerk

The following petition is herewith referred to you for report and recommendation to the City Council

In accordance with that body's directive, kindly return the same with your report in duplicate within four (4) weeks.

**/PUBLIC WORKS - CITY ENGINEERING DIVISION/**

**3216 National Specialties, Inc./Shoppers Lane, LLC, for vacation of alley in area of Eugene, Maynard and East Warren Avenue.**

*James Foster*

200 Coleman A. Young Municipal Center • Detroit, Michigan 48226-3400  
(313) 224-3260 • Fax (313) 224-1466

Carte 64D LVM 532

3216

# NATIONAL SPECIALTIES INC.

NATION WIDE INSTALLATION

20601 GLENDALE, DETROIT, MI 48223 USA  
PH # 313-387-7791 - FAX # 313-387-9707 EMAIL: [NATLSPECIALTIES@AOL.COM](mailto:NATLSPECIALTIES@AOL.COM)

November 10, 2004

Detroit City Council  
1340 Coleman A. Young Municipal Center  
Detroit, MI 48226

Subject: Petition for Alley Vacation  
Site Location: 12312 E. Warren Avenue

Dear Detroit City Council:

Shoppers Lane, LLC, is requesting a petition for an alley vacation in the area of Eugene and Maynard off of 12312 E. Warren Avenue.

Shoppers Lane, LLC owns all adjacent lots therefore they request to be granted a vacation of the existing alley. We have enclosed a map of the above stated property.

Thank you for your consideration on this matter. Should you have any questions please do not hesitate to contact me at (313) 387-7791, or the petitioner, Shoppers Lane, LLC: 20601 Glendale St. Detroit, MI 48223, at (313) 790-0129.

Best regards,  

Michael A. Beydoun  
President  
National Specialties, Inc.

MAB

27 11 50 AC

NY CLEM

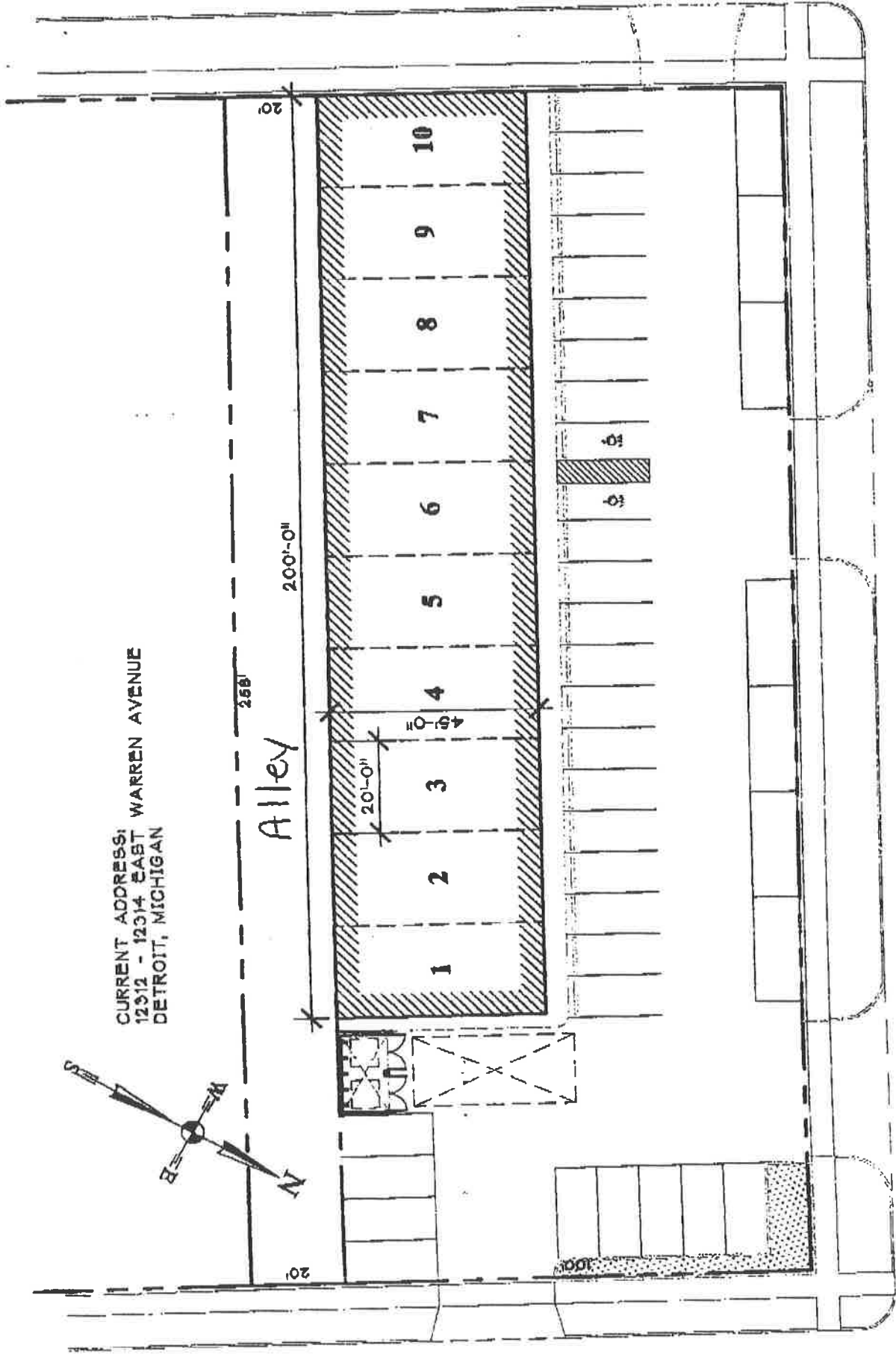

CURRENT ADDRESS:  
12312 - 12314 EAST WARREN AVENUE  
DETROIT, MICHIGAN

Alley

200'-0"

255'

10

9

8

7

6

5

4

3

2

1

20'-0"

MAYNARD

EAST WARREN AVENUE

BLDG. SIZE:  
45'-0" x 200'-0" = 9,000 SQFT.

UNIT SIZE:  
20'-0" x 45'-0" = 900 SQFT.  
NO. OF UNITS = 10

PROPOSED  
SITE PLAN



SCALE: 1/8" = 30'-0"  
APRIL 08, 2004  
RETAIL