

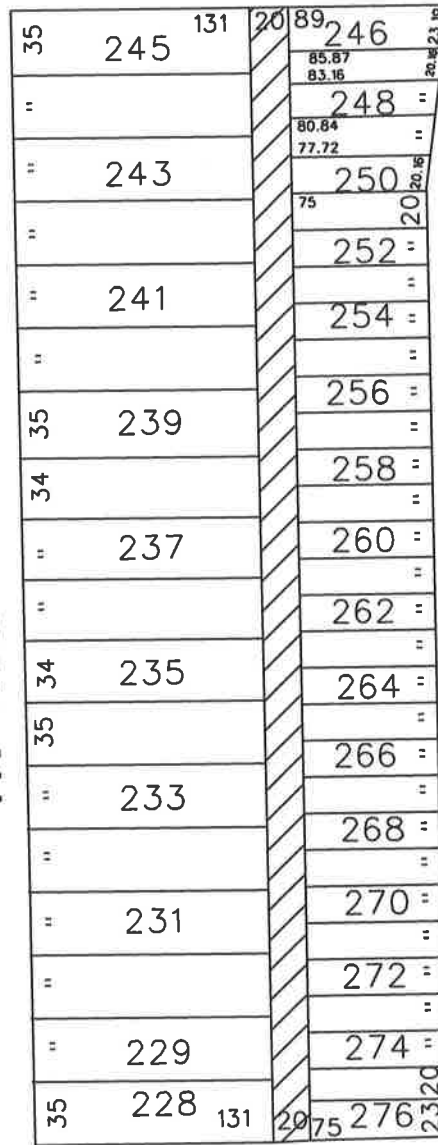

WHITLOCK 60 FT. WD.

WINTHROP 50 FT.WD.

GREENFIELD 106 FT.WD.



RADCLIFFE 50 FT.WD.



- REQUESTED TEMPORARY CLOSURE

(FOR OFFICE USE ONLY)

CARTO 98 A

B					
A					
DESCRIPTION		DRWN	CHEK	APPD	DATE
REVISIONS					
DRAWN BY	NP	CHECKED			
DATE	12-28-04	APPROVED			

**REQUESTED TEMPORARY CLOSURE
 THE NORTH - SOUTH PUBLIC ALLEY IN
 THE AREA OF WHITLOCK, RADCLIFFE,
 WINTHROP, AND GREENFIELD.**

CITY OF DETROIT	
CITY ENGINEERING DEPARTMENT	
SURVEY BUREAU	
JOB NO.	01-01
DRWG. NO.	x3102.dgn