

Department of Public Works
City Engineering Department
July 24, 1998

Honorable City Council:

Re: Petition No. 3681 — Phase Two, Lions Stadium Project, Detroit/Wayne County Stadium Authority (together with Planning & Development Department and Downtown Development Authority) Streets, Alleys and Utility Easements to Vacation in the area bounded by Brush, Fisher-Chrysler Freeway Interchange, and Adams.

City Council approved "Phase One" of Petition No. 3681 of "Detroit/Wayne County Stadium Authority" on April 23, 1998. The previously approved resolution vacated certain public streets, alleys and utility easements in the area bounded by Woodward Avenue, Brush Street, Adams Avenue, and the Fisher Freeway Service Drive; vicinity of the new "Tigers" stadium site, including related planning/construction activities.

"Phase Two" of Petition No. 3681 of "Detroit/Wayne County Stadium Authority" requests the following modifications of city rights-of-way; vicinity of the new "Lions" stadium site:

(1) Outright vacation of certain public streets, alleys, and utility easements within three "Lions Stadium" site development parcels; and

(2) Establish the eventual public street right-of-way of "Relocated" Montcalm-St. Antoine Street (60 feet wide, and variable width curved roadway); and

(3) Define by legal description(s) parcels to be acquired from the Michigan Department of Transportation for "Relocated" Montcalm-St. Antoine Street; Brush Street, (proposed) Montcalm-St. Antoine Street, and Adams Avenue, in general, bound the new Lions stadium "footprint".

City Council approved amendments (November 13, 1996 — J.C.C. page 2497; also April 11, 1997 — J.C.C. pages 785-86) to a tax increment financing plan and development plan for Area No. 1 to allow for the construction of the new Tigers and Lions stadia. City activities, within development agreements, includes various adjustments to public rights-of-way to accomplish the Tigers/Lions Stadia Complex Project.

The petition was referred to the City Engineering Division — DPW for investigation (utility clearances) and report. This is our report:

Traffic Engineering Division — DPW approved the public street closing(s); and the alignment of proposed "Relocated" Montcalm-St. Antoine Street (60 feet wide, and variable width curved roadway).

After State owned parcels are acquired from Michigan Department of Transportation, City Council is requested to accept them for the "Relocated" Montcalm-St. Antoine Street (60 feet wide, and variable width curved roadway).

Since, the outright vacations are the result of necessary public improvements, all private utility companies are required to relocate their facilities from the vacated streets, alleys, and utility easements. Planning and Development Department (working together with the "Downtown Development Authority", and "City/Wayne County Stadium Authority") must consult with the Law Department to determine which utility removal and/or relocation costs incidental to the Tigers/Lions Stadia Complex Project are properly payable under current law.

I am recommending adoption of the attached resolution.

Respectfully submitted,
SUNDAY JAIYESIMI
City Engineer

City Engineering Division — DPW
By Council Member Hood:

Whereas, City Council approved amendments (November 13, 1996 — J.C.C. page 2497; also April 11, 1997 — J.C.C. pages 785-86) to a tax increment financing plan and development plan for Area No. 1 to allow for the construction of the new Tigers and Lions stadia; and

Whereas, City Council activities, within development agreements, includes various adjustments to public rights-of-way to accomplish the Tigers/Lions Stadia Complex Project; and

Whereas, City Council approved "Phase One" of Petition No. 3681 of "Detroit/Wayne County Stadium Authority" on April 23, 1998. The previously approved resolution vacated certain public streets, alleys, and utility easements in the area bounded by Woodward Avenue, Brush Street, Adams Avenue, and the Fisher Freeway Service Drive; vicinity of the new "Tigers" stadium site, including related planning/construction activities; and

Whereas, "Phase Two" of Petition No. 3681 of "Detroit/Wayne County Stadium Authority" requests the following modifications of city rights-of-way:

(1) Outright vacation of certain public streets, alleys, and utility easements within three "Lions Stadium" site development parcels; and

(2) Establish the eventual public street right-of-way of "Relocated" Montcalm-St. Antoine Street (60 feet wide, and variable width curved roadway); and

(3) Define by legal description(s) parcels to be acquired from the Michigan Department of Transportation for "Relocated" Montcalm-St. Antoine Street; Brush Street (proposed) Montcalm-St. Antoine Street, and Adams Avenue, in general, bound the new Lions stadium "footprint"; therefore be it

Resolved: All of Elizabeth Street East,

56.50 and 60 feet wide, lying between the easterly line of Brush Street (50 feet wide) and the westerly line of Beaubien Street (40 feet wide); [NOTES: The northerly 6.50 feet of the westerly 18.00 feet of Lot 1; also the northerly 6.50 feet of Lots 2 through 9 of the "Plat of the South part of Out Lot 174, Lambert Beaubien Farm," City of Detroit, Wayne County, Michigan as recorded in Liber 1, Page 22, Plats, Wayne County Records; acquired for the widening of part of Elizabeth Street East, 56.50 feet wide, west of Beaubien Street; confirmed by Recorder's Court, December 8, 1869; accepted by City Council, December 21, 1869 — J.C.C. page 424]; also

All that part of Elizabeth Street East, 56.50 and 60 feet wide, lying between the easterly line of Beaubien Street (40 feet wide) and a westerly line of (proposed) Montcalm-St. Antoine Street (60 feet wide, and variable width curved roadway); [NOTES: The northerly 6.50 feet of Lots 1 through 7 of "Theodore and Denis J. Campau Subdivision of Out Lot 175, Lambert Beaubien Farm (Joseph Campau Estate, containing 4 01/100 acres)" City of Detroit, Wayne County, Michigan as recorded in Liber 2, Page 3, Plats, Wayne County Records; acquired for the widening of part of Elizabeth Street East, 56.50 feet wide, east of Beaubien Street; confirmed by Recorder's Court, December 8, 1869; accepted by City Council, December 21, 1869 — J.C.C. page 424; also the extension of Elizabeth Street, 50 feet wide, east of Beaubien Street through "Theodore and Denis J. Campau Subdivision of Out Lot 175, Lambert Beaubien Farm (Joseph Campau Estate, containing 4 01/100 acres)" City of Detroit, Wayne County, Michigan as recorded in Liber 2, Page 3, Plats, Wayne County Records; confirmed by Recorder's Court, May 10, 1863; accepted by City Council, February 16, 1864 — J.C.C. pages 303-04]; also

All of Columbia Street East, 50 feet wide, lying between the easterly line of Brush Street (50 feet wide) and the westerly line of Beaubien Street (40 feet wide); also

All of converted Columbia Street East, 50 feet wide, lying between the easterly line of Beaubien Street (40 feet wide) and the westerly line of St. Antoine Street (50 feet wide); [said part of Columbia Street, 50 feet wide, having been previously vacated and converted into a utility easement by City Council on May 29, 1962 — J.C.C. pages 1168-69; NOTES: Opening of Columbia Street East, 50 feet wide, between Beaubien and St. Antoine Streets; confirmed by Recorder's Court, July 1, 1867; accepted by City Council, July 9, 1867 — J.C.C. page 147]; also

All that part of Montcalm Street East, 50 feet wide, lying between a southerly line of (proposed) Montcalm-St. Antoine Street (60 feet wide, and variable width curved roadway) and the westerly line of Beaubien Street (40 feet wide); also

All that part of converted Montcalm Street East, 50 feet wide, lying between a southerly line of (proposed) Montcalm-St. Antoine Street (60 feet wide, and variable width curved roadway) and the easterly line of Beaubien Street (40 feet wide); [said part of Montcalm Street, 50 feet wide, having been previously vacated and converted into a utility easement by City Council on December 17, 1980 — J.C.C. pages 3066-68]; also

All that part of Beaubien Street, 40 feet wide, lying between a southerly line of (proposed) Montcalm-St. Antoine Street (60 feet wide, and variable width curved roadway) and the northerly line of Adams Avenue (60 feet wide); [NOTES: The easterly 10.00 feet of Lot 1, 18, 19, 36 and 37 of the "Plat of the South part of Out Lot 174; Lambert Beaubien Farm," City of Detroit, Wayne County, Michigan as recorded in Liber 1, Page 22, Plats, Wayne County Records; acquired for the

PETN. # 3681
Phase II

page 1 of 5

28-
29-F
7-31-98
2049-2058

REC

14

widening of Beaubien Street, 40 feet wide; confirmed by Recorder's Court, September 23, 1867; accepted by City Council, October 1, 1867 — J.C.C. page 257]; also

A strip of converted St. Antoine Street lying northerly of Elizabeth Street [said part of St. Antoine Street, 50 feet wide, having been previously vacated and converted into a utility easement by City Council on December 17, 1980 — J.C.C. pages 3066-68]; also

All of the east-west public alley (18 and 20 feet wide, and variable width) in the block bounded by Brush and Beaubien Streets, Adams Avenue, and Elizabeth Street; [NOTES: Opening of easterly part of east-west public alley, 18 feet wide and variable width, in the block bounded by Brush and Beaubien Streets, Adams Avenue, and Elizabeth Street through a northerly part of Lots 17 through 20 of the "Plat of the Subdivision of Out Lot 172 on the Lambert Beaubien Farm," City of Detroit, Wayne County, Michigan as recorded in Liber 31, Page 94, Deeds, Wayne County Records; confirmed by Recorder's Court, April 12, 1880; accepted by City Council, April 30, 1880 — J.C.C. page 255]; also

All of the east-west public alley, 15 and 20 feet wide, in the block bounded by Brush, Beaubien, Elizabeth and Columbia Streets; also

All of the east-west public alley, 15 and 20 feet wide, in the block bounded by Brush, Beaubien, Columbia and Montcalm Streets; also

All of the north-south public alley, 20 feet wide, in the block bounded by Beaubien and St. Antoine Streets, Adams Avenue, and Elizabeth Street; also

All that part of the converted east-west public alley, 20 feet wide, in the block bounded by Beaubien, St. Antoine, Elizabeth East and Columbia East Streets lying southerly of and abutting the south line of Lots 18 and 19; also lying northerly of and abutting the north line of Lots 8 and 9 of "Theodore and Denis J. Campau Subdivision of Out Lot 175, Lambert Beaubien Farm (Joseph Campau Estate, containing 4 01/100 acres)" City of Detroit, Wayne County, Michigan as recorded in Liber 2, page 3, Plats, Wayne County Records; also being the northerly 20.00 feet of the southerly 115.00 feet of the westerly 60.20 feet of Lot 1 of the "Plat of part of Antoine Beaubien Farm, North side of Elizabeth Street," City of Detroit, Wayne County, Michigan as recorded in Liber 41, Page 344, Deeds, Wayne County Records; [said part of east-west public alley, 20 feet wide, in said block having been previously vacated and converted into a utility easement by City Council on May 29, 1962 — J.C.C. pages 1168-69]; also

All that part of the converted north-south public alley, 20 feet wide, in the block bounded by Beaubien, St. Antoine, Columbia East and Montcalm East Streets lying easterly of and abutting the east line of the southerly 35.00 feet of Lot 13; also lying easterly of and abutting the east line of the east-west public alley, 20 feet wide, in said block; also lying easterly of and abutting the east line of Lot 8; also lying westerly of and abutting the west line of Lots 3 through 7 of "Re-Subdivision of Block 2, Van Dyke's Section of Antoine Beaubien Farm," City of Detroit, Wayne County, Michigan as recorded in Liber 14, Page 18, Plats, Wayne County Records; [said part of north-south public alley, 20 feet wide, in said block having been previously vacated and converted into a utility easement by City Council on May 29, 1962 — J.C.C. pages 1168-69]; also

All of the remaining part of the north-south public alley, 20 feet wide in the

block bounded by Beaubien, St. Antoine, Columbia East and Montcalm East Streets lying easterly of and abutting the east line of the northerly 60.00 feet of Lot 13; also lying westerly of and abutting the west line of the southern 26.11 feet of Lot 1 and Lot 2 of "Re-Subdivision of Block 2, Van Dyke's Section of Antoine Beaubien Farm," City of Detroit, Wayne County, Michigan as recorded in Liber 14, Page 18, Plats, Wayne County Records; also

All that part of the converted east-west public alley, 20 feet wide, in the block bounded by Beaubien, St. Antoine, Columbia East and Montcalm East Streets lying southerly of and abutting the south line of Lots 11 through 13; also lying northerly of and abutting the north line of Lots 8 through 10 of "Re-Subdivision of Block 2, Van Dyke's Section of Antoine Beaubien Farm," City of Detroit, Wayne County, Michigan as recorded in Liber 14, Page 18, Plats, Wayne County Records; also lying southerly of and abutting the south line of Lots 27 through 33; also lying northerly of and abutting the north line of Lots 20 through 26" Theodore and Denis J. Campau Subdivision of Out Lot 175, Lambert Beaubien Farm (Joseph Campau Estate, containing 4 01/100 acres)" City of Detroit, Wayne County, Michigan as recorded in Liber 2, Page 3, Plats, Wayne County Records; [said part of east-west public alley, 20 feet wide, in said block having been previously vacated and converted into a utility easement by City Council on May 29, 1962 — J.C.C. pages 1168-69]; said converted utility easements and/or public (street and alley) rights-of-way lying within the bounds of a land parcel; being more particularly described as follows:

Legal Description of Parcel G

Land in the City of Detroit, Wayne County, Michigan, being part of Lots 50 through 54 of "The north part of Out Lot No. 174 and the south of Out Lot No. 176 on the L. Beaubien Farm", as recorded in Liber 1 of Plats, Page 104, Wayne County Records; and a part of Lot 11 of "Plat of Brush Subdivision of part of Lot 5, and part of Brush Farm east of Park Lot 5 and 4" as recorded in Liber 45 of Deeds, Page 121, Wayne County Records; and all of Lots 8, 7, 16, 15, 23, 24, 31, 32, 39 and 40 of "Map of Houghton's Section of the Brush Farm as Subdivided into lots by J. Almy (June 1835)" as recorded in Liber 7, Page 174, City records; and all that part of a 20 feet wide public alley lying easterly of the easterly line of Brush Street (50 feet wide), southerly of the aforementioned Lot 11 and northerly of the aforementioned Lots 7 and 8, and all that part of a 20 feet wide public alley lying easterly of the easterly line of Brush Street (50 feet wide) and southerly of the aforementioned Lots 15 and 16, and northerly of the aforementioned Lots 23 and 24, and all that part of a 20 feet wide public alley lying southerly of the aforementioned Lots 31 and 32, and northerly of the aforementioned Lots 39 and 40, and Lots 1 through 44, inclusive, and part of Lot 45 of "Plat of the south part of Out Lot 174 Lambert Beaubien Farm" as recorded in Liber 1 of Plats, Page 22, Wayne County Records; and all that part of a 15 feet wide public alley lying westerly of the westerly line of Beaubien Street (40 feet wide) and southerly of the aforementioned Lots 37 through 45, and northerly of the aforementioned Lots 28 through 36, and all that part of a 15 feet wide public alley lying southerly of the aforementioned Lots 19 through 27, northerly of the aforementioned Lots 10 through 18; and Lots 17 through 20, inclusive, of "Plat of Subdivision of Out Lot 172 in the Lambert Beaubien Farm" as recorded in Liber 31 of Deeds, Page 94, Wayne County Records; and Lots 30 through 35, inclusive of "Crane and Wesson's Subdivision of Out Lot 173 Lambert Beaubien Farm" as recorded in Liber 35 of Deeds, Page 201, Wayne County Records; and Lots 1 through 33, inclusive,

page 2 of 5
and part of Lots 34 through 40 and all that part of a 20 feet wide vacated public alley lying northerly of the aforementioned Lots 8 through 12, and southerly of the aforementioned Lots 13 through 19, and all that part of a 20 feet wide public alley lying southerly of the aforementioned Lots 27 through 33, and northerly of aforementioned Lots 20 through 26; and all of Lots 35 through 37, inclusive, all of Lots 43 through 45, inclusive, and a part of Lots 38 through 42 of "Plat of Crane and Wesson's Section of Antoine Beaubien Farm", as recorded in Liber 35 of Deeds, Page 200 1/2, Wayne County Records; and all that part of a 20 feet wide public alley lying easterly of the aforementioned Lots 37 and 43 and westerly of the westerly line of the aforementioned Lots 38 through 42, and all that part of a 20 feet wide vacated public alley lying northerly of the north line of the aforementioned Lots 35 through 37, and southerly of the south line of the aforementioned Lots 43 through 45, and that part of Lot 1 lying westerly of the west line of St. Antoine Street (50 feet wide), northerly of the north line of Elizabeth Street (variable width), easterly of the easterly line of "Theo J. and Denis J. Campau Subdivision of Out Lot 175, Lambert Beaubien Farm, Joseph Campau Estate, containing 4 01/100 acres" as recorded in Liber 2 of Plats, Page 3, Wayne County Records; southerly of Columbia Street (50 feet wide), as widened, of "Plat of Antoine Beaubien Farm, North of Elizabeth Street" as recorded in Liber 41 of Deeds, Page 344, Wayne County Records; and the south 50 feet of the west 100 feet of Out Lot 175 lying north of and adjoining Elizabeth Street of said "Theo J. and Denis J. Campau Subdivision of Out Lot 175 Lambert Beaubien Farm", and Lots 7 through 13, inclusive, and a part of Lots 1 through 6, Block 2, including all of the vacated public alley adjoining Lots 1 through 13 of "Re-subdivision of Block 2 Van Dyke's Section of Beaubien Farm" as recorded in Liber 4 of Plats, Page 18, Wayne County Records; and a part of Lots 6 through 8, block 2, "Subdivision of Block 3 and 2, Van Dyke's Section of Antoine Beaubien Farm" as recorded in Liber 1 of Plats, Page 207, Wayne County Records; and a part of vacated St. Antoine Street (50 feet wide), lying northerly of the northerly line of Elizabeth Street (50 feet wide) and southerly of the Fisher-Chrysler Freeway Interchange; and all of Beaubien Street (40 feet wide) lying northerly of Adams Avenue (60 feet wide) and southerly of Montcalm Street (50 feet wide); and a part of Beaubien Street (40 feet wide) lying northerly of the south line of Montcalm Street (50 feet wide) and southerly of the Fisher-Chrysler Freeway Interchange; and a part of Montcalm Street, (50 feet wide) lying westerly of the west line of Beaubien Street (40 feet wide) and easterly of the east line of Brush Street (50 feet wide); and a part of vacated Montcalm Street (50 feet wide) lying easterly of the east line of Beaubien Street (40 feet wide) and westerly of the Fisher-Chrysler Freeway Interchange; and all of the Columbia Street (50 feet wide) lying easterly of Brush Street (50 feet wide) and westerly of St. Antoine Street (50 feet wide); and all of Elizabeth Street (variable width) lying easterly of the east line of Brush Street (50 feet wide) and westerly of the west line of Beaubien Street (40 feet wide); and a part of Elizabeth Street (variable width) lying easterly of Beaubien Street (40 feet wide) and westerly of St. Antoine Street (50 feet wide); and all being more particularly described as: Beginning at the intersection of the northerly line of Adams Avenue (60 feet wide) and the easterly line of Brush Street (50 feet wide), said point also being the southwest corner of Lot 39

of the aforementioned "Map of Houghton's Section of the Brush Farm as Subdivided into lots by J. Almy (June 1835)," thence N.26°32'38"W., 726.92 feet along said easterly line to a point on the southerly line of proposed relocated Montcalm Street (variable width); thence the following eleven courses along said southerly line, (1) N.62°39'01"E., 33.31 feet; and (2) along a curve to the left 176.57 feet, said curve having a radius of 330.00 feet, central angle of 30°39'26" and a long chord bearing of N.47°19'18"E., 174.47 feet, and (3) N.31°59'35"E., 108.00 feet, and (4) along a curve to the right 247.50 feet, said curve having a radius of 270.00 feet, central angle of 52°31'06" and long chord bearing of N.58°15'13"E., 238.93 feet, and (5) continuing along a curve to the right 61.16 feet, said curve having a radius of 570.00 feet, central angle of 06°08'53" and a long chord bearing of N.87°35'18"E., 61.13 feet, and (6) N00°39'44"E., 10.00 feet, and (7) along a curve to the right 183.17 feet, said curve having a radius of 580.00 feet, central angle of 18°05'41" and a long chord bearing of S.80°17'26"E., 182.41 feet, and (8) S.18°45'25"W., 10.00 feet, and (9) along a curve to the right 20.07 feet, said curve having a radius of 570.00 feet, central angle of 02°01'04" and a long chord bearing of S.70°14'03"E., 20.07 feet and (10) continuing along a curve to the right 231.46 feet, said curve having a radius of 295.00 feet, central angle of 44°57'18" and a long chord bearing of S.46°44'52"E., 225.57 feet, and (11) S.24°16'13"E., 497.16 feet to a point on the northerly line of Adams Avenue (60 feet wide); thence the following two courses along said northerly line, (1) S.63°54'49"W., 712.52 feet and (2) S.59°54'48"W., 91.05 feet to the point of beginning and containing about 642,910 square feet or 14.759 acres more or less; also

All that part of the east-west public alley (20 feet wide, and variable width as established within city records) in the block bounded by Brush, Beaubien and Montcalm Streets, and the Fisher Freeway [NOTES: Opening of part of said east-west public alley; confirmed by Recorder's Court, October 21, 1872; acquired from a triangular part of Lot 9 of "Plat of Brush Subdivision of Park Lot 5, and part of Brush Farm E. of and adjoining Park Lots 5 and 4, City of Detroit, made by Edmond Adelaide and Alfred Brush," City of Detroit, Wayne County, Michigan as recorded in Liber 45, Page 121, Deeds, Wayne County Records; also from parts of Lots 46 and 61 of "Subdivision of the North part of Out Lot 174 and the South part of Out Lot 176 on the Lambert Beaubien Farm," City of Detroit, Wayne County, Michigan as recorded in Liber 1, Page 104, Plats, Wayne County Records]; being described from 1872 city records as follows: Commencing at the southeastern corner of said Lot 9; thence S.60°W., along the southerly lot line, 12.86 feet; thence northeasterly, to the southwestern corner of said Lot 61, 38.40 feet; thence N.26°W., along the westerly lot line, 10.00 feet; thence N.64°E., easterly along a southerly line extended westerly of said Lot 61, 25.00 feet; thence S.26°E., southerly along the easterly line extended northerly of said Lot 46, 20.00 feet; thence S.64°W., 8.57 feet; thence southwesterly to the northeastern corner of Lot 10 of said "Plat of Brush Subdivision of Park Lot 5, and part of Brush Farm E. of and adjoining Park Lots 5 and 4," City of Detroit, Wayne County, Michigan as recorded in Liber 45, Page 121, Deeds, Wayne County Records; thence N.26°W., 20.05 feet to the place of beginning; said east-west public alley right-of-way lying within the bounds of a land parcel; being more particularly described as follows:

Legal Description of Parcel F-1

Land in the City of Detroit, Wayne County, Michigan, being Lot 9 and part of

29. 3 of 5

Lot 10 of "Plat of Brush Subdivision of Park Lot 5, and part of Brush Farm, east of and adjoining Park Lots 5 and 4, City of Detroit, made by Edmond Adelaide and Alfred Brush," as recorded in Liber 45 of Deeds, Page 121, Wayne County Records; and all that part of a 20 feet wide public alley lying southerly of said Lot 9 and northerly of said Lot 10; and a part of Lots 46 through 52, and part of Lots 55 through 61 of "The north part of Out Lot No. 174 and the south part of Out Lot No. 176 on the L. Beaubien Farm" as recorded in Liber 1 of Plats, Page 104, Wayne County Records; and all that part of a 20 feet wide public alley lying southerly of said Lots 55 through 61 and northerly of said Lots 47 through 52, all being more particularly described as: Commencing at the intersection of the northerly line of Adams Avenue (60 feet wide) and the easterly line of Brush Street (50 feet wide), said point also being the southwest corner of Lot 39 of "Map of Houghton's Section of the Brush Farm as Subdivided into lots by J. Almy (June 1835)," as recorded in Liber 7, Page 174, City Records; thence N.26°32'38"W., 786.93 feet along said easterly line to the point of beginning, said point being a point on the northerly line of proposed relocated Montcalm Street (variable width); thence continuing N.26°32'38"W., 224.17 feet to a point on the southerly line of the Fisher Freeway south service drive; thence the following eight courses along said southerly line (1) N.60°07'02"E., 50.00 feet, and (2) N.75°55'21"E., 5.83 feet, and (3) N.78°16'45"E., 40.69 feet, and (4) N.72°00'57"E., 20.21 feet, and (5) N.71°54'55"E., 20.39 feet, and (6) N.80°00'19"E., 135.38 feet, and (7) S.71°37'58"E., 42.11 feet, and (8) S.50°02'29"E., 24.60 feet to a point on the northerly line of proposed relocated Montcalm Street (variable width); thence the following four courses along said northerly line, (1) along a curve to the left 48.18 feet, said curve having a radius of 330.00 feet, central angle of 08°21'53" and a long chord bearing of S.36°10'32"W., 48.14 feet, and (2) S.31°59'35"W., 108.00 feet, and (3) along a curve to the right 144.47 feet, said curve having a radius of 270.00 feet, central angle of 30°39'26" and a long chord bearing of S.47°19'18"W., 142.75 feet, and (4) S.62°39'01"W., 32.47 feet to the point of beginning and containing about 47,565 square feet or 1.091 acres more or less; also

All that part of the converted St. Antoine Street utility easement, 50 feet wide, lying southerly of the Fisher-Chrysler Freeway Interchange (said part of St. Antoine Street, 50 feet wide, having been previously vacated and converted into a utility easement by City Council on December 17, 1980 — J.C.C. pages 3066-68); said converted utility easement and/or rights-of-way lying within the bounds of a land parcel; being more particularly described as follows:

Legal Description of Part of St. Antoine Utility Easement — Parcel H

Land in the City of Detroit, Wayne County, Michigan, being part of St. Antoine Street (50 feet wide) lying northerly of Columbia Street (50 feet wide) and southerly of the southerly line of the Fisher-Chrysler Freeway Interchange, more particularly described as follows: Commencing at the intersection of the northerly line of Adams Avenue (60 feet wide) and the easterly line of Brush Street (50 feet wide), said point also being the southwest corner of Lot 39 of "Map of Houghton's Section of the Brush Farm as Subdivided into lots by J. Almy (June 1835)," as recorded in Liber 7, Page 174, City Records; thence N.26°32'38"W., 786.93 feet to a point on

the northerly line of proposed relocated Montcalm Street (60 feet wide); thence the following four courses along said northerly line, (1) N.62°39'01"E., 32.47 feet, and (2) thence along a curve to the left 144.47 feet, said curve having a radius of 270.00 feet, central angle of 30°39'26", and a long chord bearing of N.47°19'18"E., 142.75 feet, and (3), thence N.31°59'35"E., 108.00 feet, and (4) thence along a curve to the right 237.44 feet, said curve having a radius of 330.0 feet, central angle of 41°13'30" and a long chord bearing of N.52°36'20"E., 232.35 feet to a point on the southerly line of the Fisher-Chrysler Freeway Interchange; thence the following five courses along said southerly line, (1) N87°56'42"E., 47.81 feet, and (2) S.86°34'22"E., 12.53 feet, and (3) S.84°16'35"E., 7.78 feet, and (4) along a curve to the right 243.13 feet, said curve having a radius of 617.30 feet, central angle of 22°34'00" and a long chord bearing of S.83°54'55"E., 241.56 feet, and (5) S.76°40'53"E., 83.30 feet to the point of beginning; thence continuing along said southerly line the following two courses, (1) S.76°39'08"E., 51.72 feet, and (2) N.67°54'58"E., 9.25 feet to the point on the easterly line of St. Antoine Street (50 feet wide); thence S.26°12'44"E., 63.83 feet to a point on the northeastern line of proposed relocated Montcalm Street (variable width); thence along a curve to the left 109.55 feet, said curve having a radius of 355.00 feet, central angle of 17°40'49", and a long chord bearing of N.52°57'22"W., 109.11 feet to the point of beginning and containing about 1,120 square feet or 0.025 acres more or less;

Be and the same are hereby (outright) vacated as public streets, alleys and utility easements to become a part of and parcel of the adjoining property; subject to the following provisions:

Provided, That the Planning and Development Department (working together with the "Downtown Development Authority", and "City/Wayne County Stadium Authority") is hereby authorized and directed to make the necessary arrangements for the relocation of public and private utilities from the vacated streets, alleys, and utility easements herein above described — to remaining public streets, alleys, and utility easements conveniently located in the area consistent with the public health, safety, convenience and general welfare; and further

Provided, That because the vacations are the result of necessary public improvements, all private utility companies are hereby directed to relocate their facilities from the vacated streets, alleys, and utility easements; and further

Provided, That prior to the processing of bills from utility companies and others for relocation of their equipment in connection with the Tigers/Lions Stadium Complex Project, the Planning and Development Department (working together with the "Downtown Development Authority", and "City/Wayne County Stadium Authority") shall consult with the Law Department to determine which utility removal and/or relocation costs incidental to the Tigers/Lions Stadium Complex Project are properly payable under current law. The Planning and Development Department (working together with the "Downtown Development Authority", and "City/Wayne County Stadium Authority") is hereby authorized to process only such billings as approved by the Law Department; and further

Provided, That the City Engineering Division — DPW, upon proper application and cash deposit, is hereby authorized and directed to issue permits to the private utility companies for relocation of their facilities from the vacated streets and alleys — to remaining city public streets and alleys consistent with the public health, safety, convenience and general welfare; and further.

16

Provided, This resolution — enacting the vacation of public streets, alleys, and utility easements within the Tigers/Lions Stadium Complex Project site — shall be effective upon the transfer of city property from the Planning and Development Department to the Downtown Development Authority (DDA); to be transferred to the City/Wayne County Stadium Authority through the DDA; and further

Provided, The City Clerk shall within 30 days record a certified copy of this resolution with the Wayne County Register of Deeds; and be it further

Resolved, The following described city-owned properties are hereby dedicated for public street purposes:

**Relocated Montcalm Street-
St. Antoine Street
(60 feet wide, and variable width
curved roadway)**

Land in the City of Detroit, Wayne County, Michigan being a part of Lots 10 and 11 of Plat of "Brush Subdivision of Park Lot 5, and a part of Brush Farm, east of and adjoining Park Lots 5 and 4" as recorded in Liber 45 of Deeds, Page 121, Wayne County Records; and a part of Lots 46 through 54 of "The north part of Out Lot No. 174 and the south part of Out Lot No. 176 on the L. Beaubien Farm", as recorded in Liber 1 of Plats, Page 104, Wayne County Records; and a part of Lots 34 through 46 of "Theo J. and Denis J. Campau Subdivision of Out Lot 175, Lambert Beaubien Farm (Joseph Campau Estate, containing 4 01/100 acres)" as recorded in Liber 2 of Plats, Page 3, Wayne County Records; and a part of Lots 5 through 8, Block 2 "Subdivision of Blocks 3 and 2, Van Dyke's Section of Antoine Beaubien Farm" as recorded in Liber 1 of Plats, Page 207, Wayne County Records; and a part of Lots 1 through 6 of "Re-Subdivision Block 2 Van Dyke's Section of A. Beaubien Farm", as recorded in Liber 4 of Plats, Page 18, Wayne County Records; and a part of Lots 30 through 35, Lots 49 through 55, Lots 62 through 64 of "Part of the Crane and Wesson's Section of Antoine Beaubien Farm, North of Elizabeth Street", as recorded in Liber 1 of Plats, Page 9, Wayne County Records; and a part of Lot 1 lying westerly of the west line of St. Antoine Street (50 feet wide), northerly of north line of Elizabeth Street (variable width), easterly of the easterly line of the aforementioned "Theo J. and Denis J. Campau Subdivision of Out Lot 175, Lambert Beaubien Farm", southerly of Columbia Street (50 feet wide) as widened, of "Plat of Antoine Beaubien Farm North of Elizabeth Street" as recorded in Liber 41 of Plats, Page 344, Wayne County Records; and a part of Lots 38 through 42 of "Plat of Crane and Wesson's Section of Antoine Beaubien Farm" as recorded in Liber 35 of Deeds, Page 200 1/2, Wayne County Records; and a part of Montcalm Street East (50 feet wide), lying between the easterly line of Brush Street (50 feet wide) and the westerly line of Beaubien Street (40 feet wide); and a part of Beaubien Street (40 feet wide) lying northerly of Montcalm Street east (50 feet wide) and southerly of the Fisher-Chrysler Freeway Interchange; and a part of a 20 feet wide public alley lying westerly of the westerly line of Beaubien Street (40 feet wide) and northerly of the northerly line of Montcalm Street (50 feet wide); and a part of a 20 feet wide vacated public alley lying easterly of the easterly line of Beaubien Street (40 feet wide), northerly of the northerly line of Montcalm Street East (50 feet wide), and westerly of the Fisher-Chrysler Freeway Interchange; and a part of vacated Montcalm Street East (50 feet wide) lying easterly of the easterly line of

Beaubien Street (40 feet wide), and westerly of the westerly line of the Fisher-Chrysler Freeway Interchange; and a part of a 20 feet wide public alley lying northerly of the northerly line of Montcalm Street East (50 feet wide) and easterly of the easterly line of Beaubien Street (40 feet wide) and southerly of the Fisher-Chrysler Freeway Interchange; and a part of the Fisher-Chrysler Freeway Interchange being a part of Lots 5 through 8, Block 2, "Subdivision of Blocks 3 and 2, Van Dyke's Section of Antoine Beaubien Farm," as recorded in Liber 1 of Plats, Page 207, Wayne County Records; and a part of vacated Fisher-Chrysler Freeway Interchange Service Drive being a part of Lots 1 through 3 of "Re-Subdivision of Block 2, Van Dyke's Section of Antoine Beaubien Farm," as recorded in Liber 4 of Plats, Page 18, Wayne County Records; and a part of vacated St. Antoine Street (50 feet wide) lying northerly of the north line of Elizabeth Street (variable width) and southerly of the southerly line of the Fisher-Chrysler Freeway Interchange; and a part of vacated Columbia Street (50 feet wide) lying easterly of the easterly line of St. Antoine Street and westerly of the southerly line of the Fisher-Chrysler Freeway Interchange; and all of St. Antoine Street (50 feet wide) lying southerly of the northerly line of Elizabeth Street (60 feet wide), and northerly of the north line of Adams Avenue (60 feet wide); and a part of vacated Elizabeth Street (60 feet wide) lying easterly of the easterly line of St. Antoine Street and westerly of the southerly line of the Fisher-Chrysler Freeway Interchange; and a part of Elizabeth Street (variable width) lying westerly of the westerly line of St. Antoine Street (50 feet wide), and easterly of the easterly line of Beaubien Street (40 feet wide); All being more particularly described as follows: Commencing at the intersection of the northerly line of Adams Avenue (60 feet wide) and the easterly line of Brush Street (50 feet wide), said point also being the southwest corner of Lot 39 of "Map of Houghton's Section of the Brush Farm as Subdivided into lots by J. Almy (June 1835)," as recorded in Liber 7, Page 174, City Records; thence N.26°32'38"W., 726.92 feet along said easterly line to the point of beginning; thence continuing N.26°32'38"W., 60.01 feet; thence N.62°39'01"E., 32.47 feet; thence along a curve to the left 144.47 feet, said curve having a radius of 270.00 feet, central angle of 30°39'26", and long chord bearing of N.47°19'18"E., 142.75 feet; thence N.31°59'35"E., 108.00 feet; thence along the curve to right 237.44 feet, said curve having a radius of 330.00 feet, central angle of 41°13'30" and long chord bearing of N.52°36'20"E., 232.35 feet to a point on the southerly line of the Fisher-Chrysler Freeway Interchange; thence the following five courses along said southerly line: (1) N.87°56'42"E., 47.81 feet, and (2) S.86°34'22"E., 12.53 feet, and (3) S.84°16'35"E., 7.78 feet, and (4) along a curve to the right 243.13 feet, said curve having a radius of 617.30 feet, central angle of 22°34'00" and long chord bearing of S.83°54'55"E., 241.56 feet, and (5) S.76°40'53"E., 83.30 feet; thence along a curve to the right 232.50 feet, said curve having a radius of 355.00 feet, central angle of 37°31'26" and long bearing of S.43°01'56"E., 228.36 feet; thence S.24°16'13"E., 501.33 feet to a point on the easterly line of St. Antoine (50 feet wide) and its extension thereof; thence N.26°08'14"W., 6.07 feet along said easterly line; thence S.63°54'49"W., 59.83 feet to a point on the northerly line of Adams Avenue (60 feet wide) and its extension thereof; thence N.24°16'13"W., 497.16 feet; thence along a curve to the left 231.46 feet, said curve having a radius of 295.00 feet, central angle of 44°57'18" and long chord bearing of N.46°44'52"W., 225.57 feet; thence continuing along a

curve to the left 20.07 feet, said curve having a radius of 570.00 feet, central angle of 02°01'04" and long chord bearing N.70°14'03"W., 20.07 feet; thence N.18°45'25"E., 10.00 feet; thence along a curve to the left 183.17 feet, said curve having a radius of 580.00 feet, central angle of 18°05'41" and chord bearing of N.80°17'28"W., 182.41 feet; thence S.00°39'44"W., 10.00 feet; thence along a curve to the left 61.16 feet, said curve having a radius of 570.00 feet, central angle of 06°08'53" and long chord bearing of S.87°35'18"W., 61.13 feet; thence continuing along a curve to the left 247.50 feet, said curve having a radius of 270.00 feet, central angle of 52°31'16" and long chord bearing of S.58°15'13"W., 238.93 feet; thence S.31°59'35"W., 108.00 feet; thence along a curve to the right 176.57 feet, said curve having a radius of 330.00 feet, central angle of 30°39'26" and a long chord bearing of S.47°19'18"W., 174.47 feet; thence S.62°39'01"W., 33.31 feet to the point of beginning and containing 2.07 acres; excepting therefrom the following three parcels [B, C, and D below] to be acquired from the Michigan Department of Transportation for "Relocated" Montcalm-St. Antoine Street;

**Michigan Department Of
Transportation Acquisition
Parcel B**

Land in the City of Detroit, Wayne County, Michigan, being a part of the Eastbound Fisher Freeway Service Drive lying easterly of Brush Street (50 feet wide), and westerly of the east line of Beaubien Street (40 feet wide) and northerly of Montcalm Street (50 feet wide), being more particularly described as follows: Commencing at the intersection of the northerly line of Adams Avenue (60 feet wide) and the easterly line of Brush Street (50 feet wide), said point also being the southwest corner of Lot 39 of "Map of Houghton's Section of the Brush Farm as Subdivided into lots by J. Almy (June 1835)," as recorded in Liber 7, Page 174, City Records; thence N.26°32'38"W., 786.93 feet along said easterly line to a point on the northerly line of proposed, relocated Montcalm Street (variable width); thence the following four courses along said northerly line: (1) N.62°39'01"E., 32.47 feet, and (2) along a curve to the left 144.47 feet, said curve having a radius of 270.00 feet, central angle of 30°39'26", and a long chord bearing of N.47°19'18"E., 142.75 feet; and (3) thence N.31°59'35"E., 108.00 feet, and (4) thence along a curve to the right 48.18 feet, said curve having a radius of 330.00 feet, central angle of 08°21'53" and a long chord bearing of N.36°10'32"E., 48.14 feet to the point of beginning; thence continuing along a curve to the right 52.50 feet, said curve having a radius of 330.00 feet, central angle of 09°06'57", and a long chord bearing N.44°54'46"E., 52.45 feet to a point on the easterly line of Beaubien Street (40 feet wide); thence S.26°11'43"E., 18.17 feet; thence S.63°58'04"W., 49.16 feet; thence N.49°57'11"W., 1.14 feet to the point of beginning and containing about 513 square feet or 0.012 acres more or less; also

**Michigan Department Of
Transportation Acquisition
Parcel C**

Land in the City of Detroit, Wayne County, Michigan, being a part of the Fisher-Chrysler Freeway Interchange lying easterly of Beaubien Street (40 feet wide) and westerly of St. Antoine Street (50 feet wide) and northerly of Montcalm Street (50 feet wide) and being more particularly described as follows: Commencing at the intersection of the northerly line of Adams Avenue (60 feet wide)

and the easterly line of Brush Street (50 feet wide), said point also being the southwest corner of Lot 39 of "Map of Houghton's Section of the Brush Farm as Subdivided into lots by J. Almy (June 1835), as recorded in Liber 7, Page 174, City Records; thence N.26°32'38"W., 786.93 feet along said easterly line to a point on the northerly line of proposed relocated Montcalm Street (variable width); thence N.62°39'01"E., 32.47 feet; thence along a curve to the left 144.47 feet, said curve having a radius of 270.00 feet, central angle of 30°39'26", and a long chord bearing of N.47°19'18"E., 142.75 feet; thence N.31°59'35"E., 108.00 feet; thence along a curve to the right 213.65 feet, said curve having a radius of 330.00 feet, central angle 37°05'40", and a long chord bearing of N.50°32'19"E., 209.94 feet to the point of beginning; thence N.26°11'43"W., 7.95 feet; thence N.88°47'44"E., 26.03 feet to a point on the northerly line of proposed relocated Montcalm Street (variable width); thence along said northerly line on a curve to the left 23.79 feet, said curve having a radius of 330.00 feet, central angle of 04°07'52", and a long chord bearing of S.71°09'41"W., 23.79 feet to the point of beginning and containing about 90 square feet or 0.002 acre more or less; also

**Michigan Department Of
Transportation Acquisition
Parcel D**

Land in the City of Detroit, Wayne County, Michigan, being a part of the Fisher-Chrysler Freeway Interchange lying easterly of Beaubien Street (40 feet wide) and westerly of St. Antoine Street (50 feet wide) and northerly of the southerly line Montcalm Street (50 feet wide) being more particularly described as follows: Commencing at the intersection of the northerly line of Adams Avenue (60 feet wide) and the easterly line of Brush Street (50 feet wide), said point also being the southwest corner of Lot 39 of "Map of Houghton's Section of the Brush Farm as Subdivided into lots by J. Almy (June 1835)" as recorded in Liber 7, Page 174, City Records; thence N.26°32'38"W., 786.93 feet along said easterly line to a point on the northerly line of proposed Relocated Montcalm Street (variable width); thence the following seven courses along said northerly line, (1) N.62°39'01"E., 32.47 feet, and (2) along a curve to the left 144.47 feet, said curve having a radius of 270.00 feet, central angle of 30°39'26", and along chord bearing of N.47°19'18"E., 142.75 feet, and (3) N.31°59'35"E., 108.00 feet, and (4) along a curve to the right 237.44 feet, said curve having a radius of 330.00 feet, central angle of 41°13'30" and a long chord bearing of N.52°36'20"E., 232.35 feet, and (5) N.87°56'42"E., 47.81 feet, and (6) S.86°34'22"E., 12.53 feet, and (7) S.84°16'35"E., 7.78 feet to the point of beginning; thence along a curve to the right 243.13 feet, said curve having a radius of 617.30 feet, central angle of 22°34'01", and a long chord bearing of S.83°54'55"E., 241.56 feet to a point on the southerly line of the Fisher-Chrysler Freeway Interchange; thence the following eight courses along said southerly line, (1) N.80°27'41"W., 20.40 feet, and (2) N.86°53'48"W., 13.12 feet, and (3) N.87°40'18"W., 28.36 feet, and (4) N.86°13'53"W., 46.27 feet, and (5) N.83°03'24"W., 47.77 feet, and (6) N.82°03'50"W., 48.32 feet, and (7) N.81°34'33"W., 19.44 feet, and (8) N.83°33'45"W., 18.07 feet to the point of beginning and containing 0.051 acres; and be it further

Resolved, It is the intent of City Council to accept State owned parcels [B, C, and D above] following acquisition, required by the Detroit/Wayne County Stadium Authority, for the "Relocated" Montcalm-St. Antoine Street (60 feet wide, and variable width curved roadway).

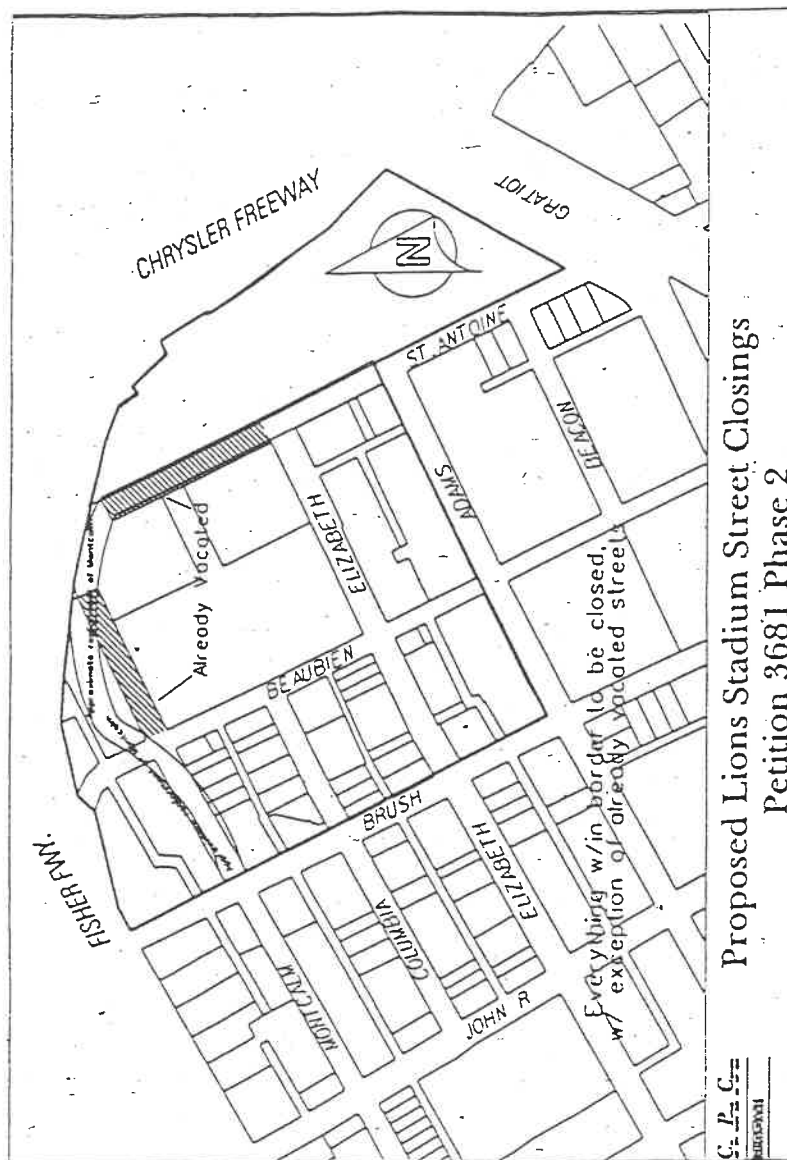

C. P. C.
HARRISON

Adopted as follows:
Yeas — Council Members Cleveland,
K. Cockrel, Jr., S. Cockrel, Everett, Hood,
Mahaffey, Scott, Tinsley-Williams, and
President Hill — 9.
Nays — None.

pg. 5 of 5

PHASE II

STATION PROJECT
CITY OF DETROIT
CITY ENGINEERING DIVISION
PHONE: 313.224.3953
FAX: 313.224.3471
OR RON FLIES
DETROIT ECONOMIC GROWTH CORPORATION
PHONE: 313.963.2940
FAX: 313.963.9790 OR 963.8839

REVISION !!!

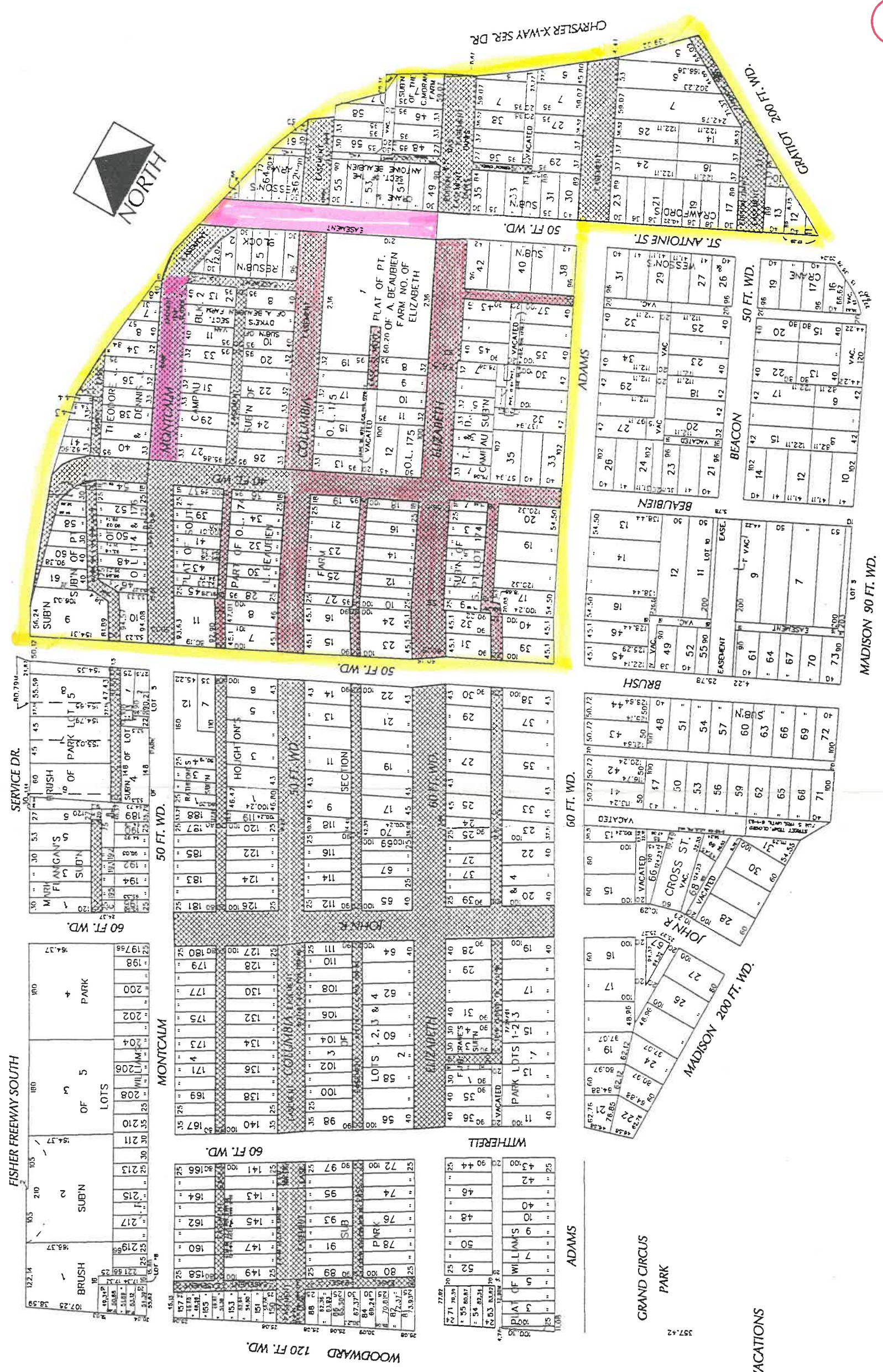

19

SCALE: 1" = 200'

(FOR OFFICE USE ONLY)

CARTOGRAPHIC MAP NO.'S 28A&29F

REVISIONS	DATE
DESCRIPTION	DATE
APPROVED	DATE
CHECKED	DATE
DATE	11.03.97

REQUESTED OUTRIGHT VACATION OF CERTAIN PUBLIC AND PRIVATE STREETS & ALLEYS
IN THE AREA BOUNDED BY WOODWARD, ST. ANTOINE, ADAMS & FISHER X-WAY SERVICE DRIVE
FOR STADIUM CONSTRUCTION.

CITY OF DETROIT
CITY ENGINEERING DEPARTMENT
SURVEY BUREAU
JOB NO. 01-01
DRAWING NO. X3681.DGN