

City of Detroit

OFFICE OF THE CITY CLERK

Sunday
Memo

Jackie L. Currie
City Clerk

Vernon C. Allen
Deputy City Clerk

DEPARTMENTAL REFERENCE COMMUNICATION

April 16, 1997

To: The Department or Commission Listed Below

From: The City Clerk

The following petition is herewith referred to you for report and recommendation to the City Council.

In accordance with that body's directive, kindly return the same with your report in duplicate within the usual time limit.

/ DPW - CITY ENGINEERING /

- 4004 PARSONS ENGINEERING SCIENCE, INC., requesting approval to install five permanent groundwater monitoring wells on behalf of Shell Oil Products Company.

CARTO. 19-F

SAUBOEN Vol. 1 pg. 28

Vol. 2 pg. 36



PARSONS ENGINEERING SCIENCE, INC.

4004

19101 Villaview Road, Suite 301 • Cleveland, Ohio 44119 • (216) 486-9005 • Fax (216) 486-6119

PARESC/497/Dec/PDB-22a

04 April 1997

ATTN: CITY CLERK
200 City County Building
Detroit, MI 48226

Reference: Petition Letter to City Council
Shell Retail Facility - WIC# 221-2491-4809
1715 Michigan Ave and Eleventh Street
Detroit, MI

Attention City Clerk:

Parsons Engineering Science (Parsons ES) is requesting your approval to install five permanent groundwater monitoring wells in the R/W on behalf of Shell Oil Products Company. See the attached site plan for boring/monitoring well locations. These wells will be installed to sample the soil and groundwater surrounding the Shell Retail facility at Michigan Ave and Eleventh St., as required by the Michigan Department of Environmental Quality (MDEQ).

I will be following up this letter by telephone in several days to request a petition number associated with this petition letter, so that I may complete my "encroachment permit" process with the City Engineering Division.

If you have any question regarding the attached application, please do not hesitate to contact me at (216) 486-9005.

Very truly yours,

PARSONS ENGINEERING SCIENCE



William G. Adams
Project Manager

WGA/dee

cc: Parsons ES File 730879

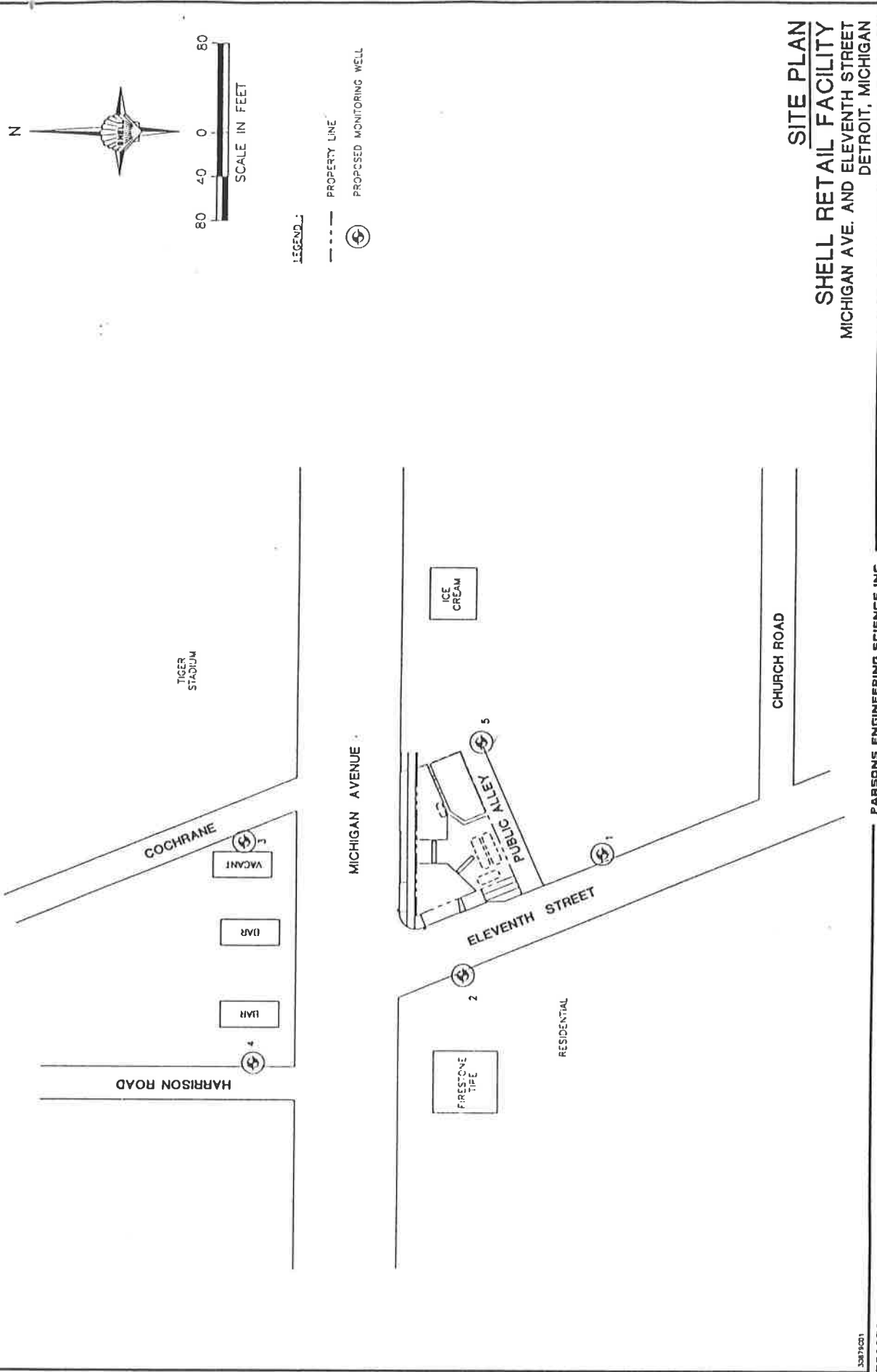

SITE PLAN
SHELL RETAIL FACILITY
 MICHIGAN AVE. AND ELEVENTH STREET
 DETROIT, MICHIGAN

PARSONS ENGINEERING SCIENCE, INC.