

July 31, 1996

Department Of Public Works
City Engineering Division

July 25, 1996

Honorable City Council:

Re: Petition No. 1705 Chrysler Corporation Detroit Axle Plant and UAW Local 961 Temporary Street Closing southern part of Carrie, north of Lynch

Petition No. 1705 of the "Chrysler Corporation, Detroit Axle Plant" at 6700 Lynch Road requests the temporary closing of a southern part of Carrie Avenue, 50 feet wide, north of Lynch Avenue.

The request was approved by the Traffic Engineering Division — DPW and the Fire Department with certain restrictions.

The Ameritech/Michigan Bell Telephone Company, Detroit Edison Company, Public Lighting Department, and the Water and Sewerage Department (all) will require unimpeded access to service their existing facilities. Any fence and gate installation must provide 15 feet horizontal and 15 feet vertical clearance(s) for utility maintenance vehicles.

All other city departments and privately owned utility companies have reported no objections to the closing, provided they have the right to ingress and egress at all times to their facilities.

I recommend granting the petition and adoption of the attached resolution.

Respectfully, submitted,

SUNDAY JAIYESIMI,

City Engineer

City Engineering Division — DPW

By Council Member Scott:

RESOLVED, The City Engineering Division — DPW is hereby authorized and directed to issue permits to the "Chrysler Corporation, Detroit Axle Plant" whose post office address is 6700 Lynch Road, Detroit, Michigan 48288-2919" to close the following public street right-of-way on a temporary basis to expire on September 1, 2001:

All that part of Carrie Avenue, 50 feet wide, north of Lynch Avenue lying westerly of and abutting the west line of Lot 43; also lying easterly of and abutting the east line of Lot 42 of "Harrah's Lynch Road Subdivision of the West 35 acres of the Easterly 60 acres of the South Half of Southeast Quarter of Section 16, Town 1 South, Range 12 East, Hamtramck Township," City of Detroit, Wayne County, Michigan as recorded in Liber 37, Page 45, Plats, Wayne County Records;

PROVIDED, The petitioner shall file with the Finance Department an indemnity agreement in form approved by the Law Department. The agreement shall save and protect the City of Detroit harmless from all claims, damages or expenses

thereof. Further, the petitioner shall agree to pay all claims, damages or expenses that may arise out of the maintenance of the temporary public street closing; and

PROVIDED, The permit shall be issued after the City Clerk has recorded a certified copy of this resolution with the Wayne County Register of Deeds; and

PROVIDED, The property owned by the petitioner and adjoining the temporary public street closing shall be subject to the proper zoning or regulated use (Board of Zoning Appeals Grant) over the total width and length of the street; and

PROVIDED, No building or other structure (except necessary line fence), shall be constructed on or over the street. The petitioner shall observe the rules and regulations of the City Engineering Division — DPW and the Fire Department. The City of Detroit retains all rights and interests in the temporarily closed public street. The city and all utility companies retain their rights to service, inspect, maintain, repair, install, remove or replace utilities in the temporarily closed public street. Further, the petitioner shall comply with all specific conditions imposed to insure unimpeded 24-hour-per-day access to the city and utility companies; and

PROVIDED, All of the petitioner's public property fence and gate installation(s) shall be subject to the review and approval of the City Engineering Division — DPW (if necessary, in conjunction with the Traffic Engineering Division — DPW and the Fire Department); and

PROVIDED, The petitioner's fence and gate installations shall provide 15 feet horizontal and 15 feet vertical clearance(s) for utility maintenance vehicles; and

PROVIDED, This resolution does not permit the storage of materials, display of merchandise, or advertising signs within the temporarily closed public street. Further, the placement of materials, merchandise, or advertising signs on any adjacent berm area is prohibited. It is the intent of this provision to prohibit private advertising within public rights-of-way, but not signs conforming to the current Michigan Manual of Uniform Traffic Control Devices; and

PROVIDED, That at the expiration of the permit, all obstructions shall be removed at the petitioner's expense. The public property shall be restored to a condition satisfactory to the City Engineering Division — DPW by the petitioner at the petitioner's expense; and

PROVIDED, This resolution is revocable at the will, whim or caprice of the City Council without cause. The petitioner waives the right to claim damages or compensation for removal of encroachments. Further, the permittee acquires no implied or other privileges hereunder not expressly stated herein. If this permit is continued for the five (5) year period, the City Council may (upon written request and if the circumstances justify accordingly) grant an extension thereto; and

PROVIDED, This permit shall not be assigned or transferred without the written approval of the City Council; and further

PROVIDED, That the City Clerk shall within 30 days record a certified copy of this resolution with the Wayne County Register of Deeds.

Adopted as follows:

Yeas — Council Members Cleveland, Cockrel, Everett, Hill, Hood, Ravitz, Scott, Tinsley-Williams and President Mahaffey — 9.

Nays — None.

PERMIT NO. 1705
 CHRYSLER'S DETROIT AXLE PLANT AND U.A.W. LOCAL 961
 6700 LYNCH ROAD
 C/O EDWIN KOLACKI
 PHONE: 313.252.2600

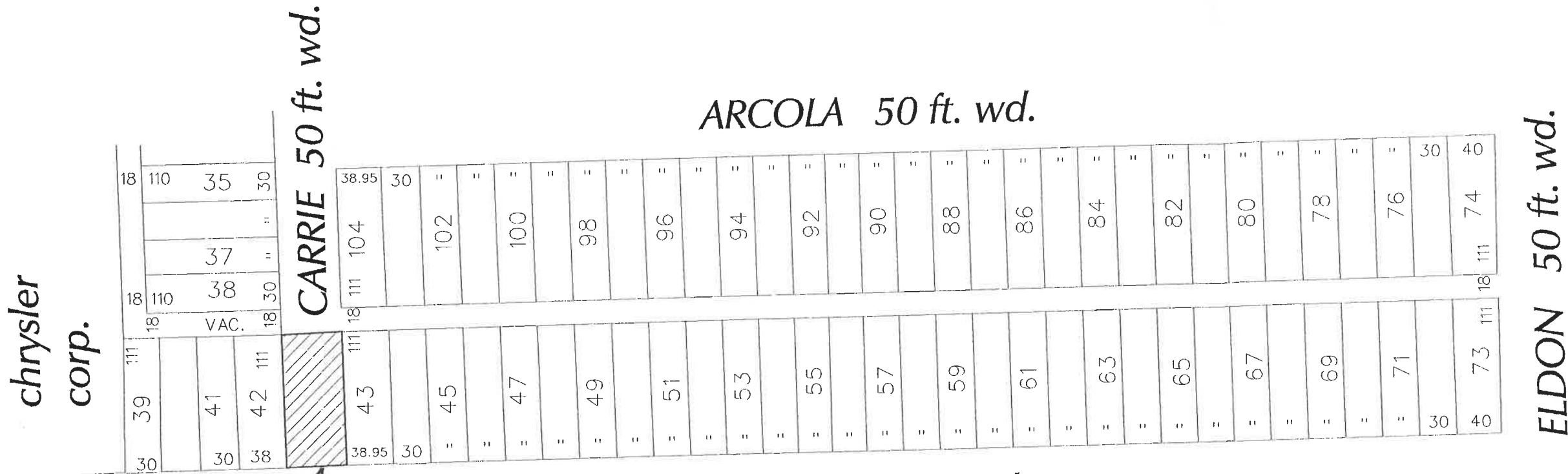

LEVEL 37
 EXPIRATION DATE - SEPT. 1, 2001

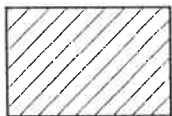

REQUESTED TEMPORARY CLOSING

July 31, 1996
✓ CC pgs. 1811-1812

HARRAH'S LYNCH ROAD SUBN.

(FOR OFFICE USE ONLY)

SCALE: 1"=100'
 CARTO. NO. MAP51F

B					
A					
DESCRIPTION					
DRAWN BY					
I. FOSTER					
CHECKED					

REQUESTED TEMPORARY CLOSING OF A PORTION OF CARRIE AVE. 50 FT. WD.
 BETWEEN LYNCH ROAD AND ARCOLA AVE., WEST OF ELDON AVE.

CITY OF DETROIT	
CITY ENGINEERING DEPARTMENT	
SURVEY BUREAU	
JOB NO.	01-01