

Adopted as follows:

Yeas — Council Members Ayers, Benson, Castaneda-Lopez, Cushingberry, Jr., Leland, Spivey, Tate, and President Jones — 8.

Nays — None.

**Department of Public Works
City Engineering Division**

May 5, 2015

Honorable City Council:

Re: Petition No. 441 — Giffels Webster, requesting the vacation of public streets and alleys in the area(s) of Carrie, St. Cyril, Georgia and Huber; Sherwood, St. Cyril, Miller, Georgia; and, Winfield, St. Cyril, Huber and Grinnell; all in order to re-develop parcels as defined in the I-94 Industrial Park Project.

Petition No. 441 of "Giffels Webster", 28 W. Adams, Suite 1200, Detroit, Michigan 48226, in behalf of the Economic Development Corporation of the City of Detroit (the "EDC") respectfully request to vacate (outright) all of the public streets and alleys within the area bounded by Carrie Street (50 feet wide), Georgia Street (60 feet wide), Huber Street (66 feet wide) and St. Cyril Street (50 feet wide); Also, the area bounded by Winfield Street (50 feet wide), Huber Street (50 feet wide), Grinnel Street (50 feet wide) and St. Cyril Street (50 feet wide); Also, the area bounded by Sherwood Street (50 feet wide), St. Cyril Street (50 feet wide), Miller Street (50 feet wide) and Georgia Street (50 feet wide); all as part of the I-94 Industrial Park Project ("the Project").

"The Project" is being undertaken by the "EDC" and will involve the development of a modern industrial park originally designated as one of six (6) Renaissance Zones established by the State of Michigan.

Many of the streets and alleys have been previously vacated as part of Phase One which covered all of Parcel Area 1 and a portion of Parcel Area 5, by resolution adopted on September 10, 2003; J.C.C. Pgs. 2757-62. This being Phase two of "the Project", is requesting to vacate (outright) those rights-of-way not previously vacated within Parcel Area 5; Parcel Area 6; Parcel Area 4 and a portion of Parcel Area 4.

The Traffic Engineering Division — DPW has no objection to the outright vacation of the public streets and alleys within the "the Project" provided that the "EDC" owns all the property adjacent to those rights-of-way to be vacated. The petition was referred to the City Engineering Division — DPW for investigation (utility review) and report. This is our report.

"The Project" was approved and established by the Detroit City Council on

August 4, 1999, to redevelop a blighted area of the City of Detroit into a modern Industrial Park. A Second Amendment of the Resolution of Necessity for "the Project" was approved by the Honorable City Council July 28, 2009, J.C.C. Pgs. 1808-1817, therefore authorizing the City's power of eminent domain and declaring this project as a public improvement for the benefit and use of the public. Also, your Honorable City Council has previously approved the "Funding Agreement" and "Transfer of Land Agreement" with "the EDC".

In order to implement and facilitate the accomplishment of certain changes in public rights-of-way, such as vacation and removal of streets, alleys or other public ways, and certain utilities and facilities, both public and private, the attached resolution respectfully request the approval of your Honorable Body authorizing the City of Detroit to require that these right-of-way changes take place.

A waiver of reconsideration is respectfully requested.

Respectfully submitted,
RICHARD DOHERTY, P.E.
City Engineer

City Engineering Division — DPW
By Council Member Benson:

Whereas, The I-94 Industrial Park Project ("the Project") was approved and established by the Detroit City Council on August 4, 1999; and

Whereas, "The Project" was approved and established by your Honorable Detroit City Council on August 4, 1999, to redevelop a blighted area of the City of Detroit into a modern Industrial Park. A Second Amendment of the Resolution of Necessity for "the Project" was approved by the Detroit City Council July 28, 2009; J.C.C. Pgs. 1808-1817, therefore authorizing the City's power of eminent domain and declaring this project as a public improvement for the benefit and use of the public. Also, your Honorable City Council has previously approved the "Funding Agreement" and "Transfer of Land Agreement" with "the EDC"; and

Whereas, Many of the streets and alleys have been previously vacated as part of Phase One which covered all of Parcel Area 1 and a portion of Parcel Area 5, by resolution adopted BY Detroit City Council on September 10, 2003; J.C.C. Pgs. 2757-62. This being Phase Two of "the Project", is requesting to vacate (outright) those rights-of-way not previously vacated within Parcel Area 5; Parcel Area 6; Parcel Area 4 and a portion of Parcel Area 4; and

Whereas, "The Project" continues to represents an exciting opportunity to redevelop a significant portion of vacant and dormant land, generating jobs and economic opportunity for the City of Detroit; therefore be it

STREETS

Resolved, All that part of Winfield Avenue, 50 feet wide, between Miller Avenue, 60 feet wide, and Georgia Avenue, 60 feet wide, described as lying easterly of and abutting the east line of Lots 167-184, both inclusive, and lying westerly of and abutting the west line of Lots 185-202, both inclusive, of "Bessenger & Moore's Field Avenue Subdivision" of the S. 1/2 of the S.W. 1/4 of the S.E. 1/4 of Sec. 21 T.1, S. R. 12 E., Hamtramck Township (now Detroit), Wayne Co., Michigan, as recorded in Liber 31, Page 62, Plats, Wayne County Records; Also, that part of Winfield Avenue, 50 feet wide, lying easterly of and abutting the east line of Lots 171-185, both inclusive, and lying westerly of and abutting the west line of Lots 186-200, both inclusive, as platted in "Wagner's Field Ave. Sub'n of part of S.E. 1/4 of Sec. 21" T.1, S. R. 12 E., City of Detroit, Wayne County, Michigan, as recorded in Liber 34, Page 75 of Plats, Wayne County Records;

Also, All that part of Winfield Avenue, 50 feet wide, between Georgia Avenue, 60 feet wide, and Marcus Avenue, 50 feet wide, described as lying westerly of and abutting the west line of Lots 1-5, both inclusive, and lying easterly of and abutting the east line of Lots 6-10, both inclusive, as platted in said "Wagner's Field Ave. Sub'n of part of S.E. 1/4 of Sec. 21" T.1, S. R. 12 E., City of Detroit, Wayne County, Michigan, as recorded in Liber 34, Page 75 of Plats, Wayne County Records; and that part of Winfield Avenue, 50 feet wide, lying westerly of and abutting the west line of Lots 200, 201, 202, Lots 212-227, both inclusive, and Lot 231 and lying easterly of and abutting the east line of Lots 180-199, both inclusive, as platted in "Bessenger & Moore's Mt. Elliott Ave. Subd'n of S. 1/2 of Lot 3 and Lots 4 and 5 of Sub. of S.W. 1/4 of Sec. 21 T.1, S. R. 12 E., as recorded in Liber 3, Page 12 of Plats and Lot 5 and part of Lot 6 of Sub. of Estate of James Dunn on S.W. 1/4 Sec. 21 T.1, S. R. 12 E., as recorded in Liber 61, Page 199 of Deeds, also part of Sec. 21 T.1, S. R. 12 E., Hamtramck Township", Wayne Co., Michigan, as recorded in Liber 33, Page 19 of Plats, Wayne County Records;

Also, All that part of said Winfield Avenue, 50 feet wide, between said Marcus Avenue, 50 feet wide, and Huber Avenue, 66 feet wide, described as lying westerly of and abutting the west line of Lots 232, 259, 260 and 292, and lying easterly of and abutting the east line of Lots 554-565, both inclusive, as platted in said "Bessenger & Moore's Mt. Elliott Ave. Subd'n of S. 1/2 of Lot 3 and Lots 4 and 5 of Sub. of S.W. 1/4 of Sec. 21 T.1, S. R. 12 E., as recorded in Liber 3, Page 12 of Plats and Lot 5 and part of Lot 6 of Sub.

of Estate of James Dunn of S.W. 1/4 Sec. 21 T.1, S. R. 12 E., as recorded in Liber 61, Page 199 of Deeds, also part of Sec. 21 T.1, S. R. 12 E., Hamtramck Township", Wayne Co., Michigan, as recorded in Liber 33, Page 19 of Plats, Wayne County Records;

Also, All that part of Carrie Avenue, 50 feet wide, between Miller Avenue, 66 feet wide, and Georgia Avenue, 60 feet wide, lying easterly of and abutting the east line of Lots 126-143, both inclusive, and lying westerly of and abutting the west line of Lots 144-161, both inclusive, of "Bessenger & Moore's Field Avenue Subdivision" of the S. 1/2 of the S.W. 1/4 of S.E. 1/4 of Sec. 21 T.1, S. R. 12 E., Hamtramck Township (now Detroit), Wayne Co., Michigan, as recorded in Liber 31, Page 62, Plats, Wayne County Records; Also, that part of Carrie Avenue, 50 feet wide, lying easterly of and abutting the east line of Lots 141-155, both inclusive, and lying westerly of and abutting the west line of Lots 156-170, both inclusive, as platted in "Wagner's Field Ave. Subd'n of part of S.E. 1/4 of Sec. 21" T.1, S. R. 12 E., City of Detroit, Wayne County, Michigan, as recorded in Liber 34, Page 75 of Plats, Wayne County Records;

Also, All that part of Helen Avenue, 50 feet wide, between Miller Avenue, 66 feet wide, and Georgia Avenue, 60 feet wide, lying easterly of and abutting the east line of Lots 85-102, both inclusive, and lying westerly of and abutting the west line of Lots 103-120, both inclusive, of "Bessenger & Moore's Field Avenue Subdivision" of the S. 1/2 of the S.W. 1/4 of the S.E. 1/4 of Sec. 21 T.1, S. R. 12 E., Hamtramck Township (now Detroit), Wayne Co., Michigan, as recorded in Liber 31, Page 62, Plats, Wayne County Records; Also, that part of Helen Avenue, 50 feet wide, lying easterly of and abutting the east line of Lots 111-125, both inclusive, and lying westerly of and abutting the west line of Lots 126-140, both inclusive, as platted in "Wagner's Field Ave. Subd'n of part of S.E. 1/4 of Sec. 21" T.1, S. R. 12 E., City of Detroit, Wayne County, Michigan, as recorded in Liber 34, Page 75 of Plats, Wayne County Records;

Also, All that part of Concord Avenue, 50 feet wide, between Miller Avenue, 66 feet wide, and Georgia Avenue, 60 feet wide, lying easterly of and abutting the east line of Lots 44-61, both inclusive, and lying westerly of and abutting the west line of Lots 62-79, both inclusive, of "Bessenger & Moore's Field Avenue Subdivision" of the S. 1/2 of the S.W. 1/4 of S.E. 1/4 of Sec. 21 T.1, S. R. 12 E., Hamtramck Township (now Detroit), Wayne Co., Michigan, as recorded in Liber 31, Page 62, Plats, Wayne County Records; Also, that part of Concord Avenue, 50 feet wide, lying easterly of and abutting the east line of Lots 81-95, both

inclusive, and lying westerly of and abutting the west line of Lots 96-110, both inclusive, as platted in "Wagner's Field Ave. Subd'n of part of S.E. 1/4 of Sec. 21" T.1, S. R. 12 E., City of Detroit, Wayne County, Michigan, as recorded in Liber 34, Page 75 of Plats, Wayne County Records;

Also, All that part of Sherwood Avenue, 50 feet wide, between Miller Avenue, 66 feet wide, and Georgia Avenue, 60 feet wide, lying easterly of and abutting the east line of Lots 3-20, both inclusive, and lying westerly of and abutting the west line of Lots 21-38, both inclusive, of "Bessenger & Moore's Field Avenue Subdivision" of the S. 1/2 of the S.W. 1/4 of the S.E. 1/4 of Sec. 21 T.1, S. R. 12 E., Hamtramck Township (now Detroit), Wayne Co., Michigan, as recorded in Liber 31, Page 62, Plats, Wayne County Records; Also, that part of Sherwood Avenue, 50 feet wide, lying easterly of and abutting the east line of Lots 51-65, both inclusive, and lying westerly of and abutting the west line of Lots 66-80, both inclusive, as platted in "Wagner's Field Ave. Subd'n of part of S.E. 1/4 of Sec. 21" T.1, S. R. 12 E., City of Detroit, Wayne County, Michigan, as recorded in Liber 34, Page 75 of Plats, Wayne County Records;

Also, All that part of Guthrie Avenue, 50 feet wide, between Winfield Avenue, 54 feet wide, and St. Cyril Avenue, 66 feet wide, lying northerly of and abutting the north line of Lots 34-44, both inclusive, and lying southerly of and abutting the south line of Lots 45-57, both inclusive, of "Geo. G. Epstean's Van Dyke Park Subdivision" of the Southerly 1/2 of Northerly 32 1/2 Acres of S.E. 1/4 of N.E. 1/4 of Sec. 21 T.1, S. R. 12 E., Hamtramck Township (now Detroit), Wayne County, Michigan, as recorded in Liber 32, Page 8 of Plats, Wayne County Records;

Also, All that part of Marjorie Avenue, 50 feet wide, between Winfield Avenue, 54 feet wide, and St. Cyril Avenue, 66 feet wide, lying northerly of and abutting the north line of Lots 120-137, both inclusive, and lying southerly of and abutting the south line of Lots 138-157, both inclusive, of "Geo. G. Epstean's Van Dyke Park Subdivision" of the Southerly 1/2 of Northerly 32-1/2 Acres of S.E. 1/4 of N.E. 1/4 of Section 21 T.1, S. R. 12 E., Hamtramck Township (now Detroit), Wayne County, Michigan, as recorded in Liber 32, Page 8 of Plats, Wayne County Records;

Also, All that part of Sheehan Street, 50 feet wide, between Winfield Avenue, 54 feet wide, and St. Cyril Avenue, 66 feet wide, lying southerly of and abutting the south line of Lots 14-41, both inclusive, and lying northerly of and abutting the north line of Lots 42-65, both inclusive, of "Oak Hill Rose & Sheehan's Sub." of part of Section 21 T.1, S. R. 12 E., Hamtramck

(now Detroit), Wayne County, Michigan, as recorded in Liber 13, Page 72, Plats, Wayne County Records; Also, that part of Sheehan Street, 50 feet wide, lying northerly of and abutting the north line of Lot 4 and lying southerly of and abutting the south line of Lot 5, of "Sheehan's Sub." of Lots 9, 10, 11, 12, 13, 66, 67, 68, 69 of Oak Hill Rose & Sheehan's Sub. of part of Section 21 T.1, S. R. 12 E., Hamtramck Twp. (now Detroit), Wayne County, Michigan, as recorded in Liber 36, Page 13, Plats, Wayne County Records;

Also, All that part of Roland Avenue, 50 feet wide, between said Winfield Avenue and St. Cyril Avenue, 60 feet wide, lying northerly of and abutting the north line of Lots 250-259, both inclusive, Also that part of Roland Avenue, 50 feet wide, lying southerly of and abutting the south line of Lots 260-270, both inclusive, as platted in said "Bessenger & Moore's Mt. Elliott Ave. Subd'n of S. 1/2 of Lot 3 and Lots 4 and 5 of Sub. of S.W. 1/4 of Sec. 21 T.1, S. R. 12 E., as recorded in Liber 3, Page 12 of Plats and Lot 5 and part of Lot 6 of Sub. of Estate of James Dunn on S.W. 1/4 Sec. 21 T.1, S. R. 12 E., as recorded in Liber 61, Page 199 of Deeds, also part of Sec. 21 T.1, S. R. 12 E., Hamtramck Township", Wayne Co., Michigan, as recorded in Liber 33, Page 19 of Plats, Wayne County Records;

Also, All that part of Marcus Avenue, 50 feet wide, between said Winfield Avenue and said St. Cyril Avenue, lying northerly of and abutting the north line of Lots 1-4, both inclusive, as platted in "Kebbe's Subdivision" of part of the N.E. 1/4 of the S.E. 1/4 of Sec. 21" T.1, S. R. 12 E., west of Center Line Road (now St. Cyril) City of Detroit, Wayne County, Michigan, as recorded in Liber 34, Page 11 of Plats, Wayne County Records; Also, that part of Marcus Avenue, 50 feet wide, lying northerly of and abutting the north line of Lots 228-231, both inclusive, and lying southerly of and abutting the south line of Lots 232-239, both inclusive, as platted in said "Bessenger & Moore's Mt. Elliott Ave. Subd'n of S. 1/2 of Lot 3 and Lots 4 and 5 of Sub. of S.W. 1/4 of Sec. 21 T.1, S. R. 12 E., as recorded in Liber 3, Page 12 of Plats and Lot 5 and part of Lot 6 of Sub. of Estate of James Dunn on S.W. 1/4 Sec. 21 T.1, S. R. 12 E., as recorded in Liber 61, Page 199 of Deeds, also part of Sec. 21 T.1, S. R. 12 E., Hamtramck Township", Wayne Co., Michigan, as recorded in Liber 33, Page 19 of Plats, Wayne County Records;

ALLEYS

Also, All of the public alleys, 16.00 feet wide, in the block bounded by Winfield Avenue, 50 feet wide, St. Cyril Avenue, 60 feet wide, Roland Avenue, 50 feet wide, and Huber Avenue, 66 feet wide, lying northerly of and abutting the north line of Lots 260-269, both inclusive, and lying

southerly of and abutting the south line of Lots 282-292, both inclusive, and lying west of and abutting the westerly line of Lots 270-281, both inclusive, and lying easterly of and abutting the east line of said Lots 269 and 282 as platted in "Bessenger & Moore's Mt. Elliott Ave. Subd'n of S. 1/2 of Lot 3 and Lots 4 and 5 of Sub. of S.W. 1/4 of Sec. 21 T.1, S. R. 12 E., as recorded in Liber 3, Page 12 of Plats and Lot 5 and part of Lot 6 of Sub. of Estate of James Dunn on S.W. 1/4 Sec. 21 T.1, S. R. 12 E., as recorded in Liber 61, Page 199 of Deeds, also part of Sec. 21 T.1, S. R. 12 E., Hamtramck Township", Wayne Co., Michigan, as recorded in Liber 33, Page 19 of Plats, Wayne County Records;

Also, All of the public alleys, 16.00 feet wide, in the block bounded by said Winfield Avenue, 50 feet wide, St. Cyril Avenue, 60 feet wide, Roland Avenue, 50 feet wide, and Marcus Avenue, 50 feet wide, lying northerly of and abutting the north line of Lots 232-238, both inclusive, and lying southerly of and abutting the south line of Lots 251-159, both inclusive, and lying westerly of and abutting the west line of Lots 239-250, both inclusive, and lying easterly of and abutting the east line of said Lots 238 and 251, as platted in "Bessenger & Moore's Mt. Elliott Ave. Subd'n of S. 1/2 of Lot 3 and Lots 4 and 5 of Sub. of S.W. 1/4 of Sec. 21 T.1, S. R. 12 E., as recorded in Liber 3, Page 12 of Plats and Lot 5 and part of Lot 6 of Sub. of Estate of James Dunn on S.W. 1/4 Sec. 21 T.1, S. R. 12 E., as recorded in Liber 61, Page 199 of Deeds, also part of Sec. 21 T.1, S. R. 12 E., Hamtramck Township", Wayne Co., Michigan, as recorded in Liber 33, Page 19 of Plats, Wayne County Records;

Also, All of the public alleys, in the block bounded by said Winfield Avenue, 50 feet wide, Said St. Cyril Avenue, 60 feet wide, Georgia Avenue, 60 feet wide; and said Marcus Avenue, 50 feet wide, lying northerly of and abutting the north line of Lot 202, and lying southerly of and abutting the south line of Lot 203, and lying westerly of and abutting the west line of Lots 203-211, both inclusive, and lying easterly of and abutting the east line of Lots 212-227, both inclusive, and lying northerly of and abutting the north line of Lot 227 and lying southerly of and abutting the south line of Lots 228 and 229 (as widened May 17, 1927) and Lot 230 and 231 as platted in "Bessenger & Moore's Mt. Elliott Ave. Subd'n of S. 1/2 of Lot 3 and Lots 4 and 5 of Sub. of S.W. 1/4 of Sec. 21 T.1, S. R. 12 E., as recorded in Liber 3, Page 12 of Plats and Lot 5 and part of Lot 6 of Sub. of Estate of James Dunn on S.W. 1/4 Sec. 21 T.1, S. R. 12 E., as recorded in Liber 61, Page 199 of Deeds, also part of Sec. 21 T.1, S. R. 12 E., Hamtramck Township", Wayne Co.,

Michigan, as recorded in Liber 33, Page 19 of Plats, Wayne County Records; and that part lying westerly of and abutting the west line of Lots 8, 9 and the vacated alley at the rear (deeded Oct. 28, 1924; vacated May 12, 1925) and Lots 10-14, both inclusive, and lying southerly of and abutting the south line of Lot 1, as platted in "Kebbe's Subdivision" of part of the N.E. 1/4 of the S.E. 1/4 of Sec. 21" T.1S. R.12E., west of Center Line Road (now St. Cyril) City of Detroit, Wayne County, Michigan, as recorded in Liber 34, Page 11 of Plats, Wayne County Records;

Also, All of the public alleys, 16.00 feet wide, in the block bounded by Sherwood Avenue, 50 feet wide, Concord Avenue, 50 feet wide, Miller Avenue, 66 feet wide and Georgia Avenue, 60 feet wide, lying northerly of and abutting the north line of Lots 38-44, both inclusive, and lying southerly of and abutting the south line of Lots 37 and 45; also lying easterly of and abutting the east line of Lot 21-37, both inclusive, and lying westerly of and abutting the west line of Lots 45-61, both inclusive, of "Bessenger & Moore's Field Avenue Subdivision" of the S. 1/2 of the S.W. 1/4 of the S.E. 1/4 of Sec. 21 T.1, S. R. 12 E., Hamtramck Township (now Detroit), Wayne Co., Michigan, as recorded in Liber 31, Page 62, Plats, Wayne County Records; and lying easterly of and abutting the east line of Lots 66-80, both inclusive, and lying westerly of and abutting the west line of Lots 81-95, both inclusive, as platted in "Wagner's Field Ave. Sub'n of part of S.E. 1/4 of Sec. 21" T.1, S. R. 12 E., City of Detroit, Wayne County, Michigan, as recorded in Liber 34, Page 75 of Plats, Wayne County Records;

Also, All of the public alleys, 16.00 feet wide, in the block bounded by Helen Avenue, 50 feet wide, Concord Avenue, 50 feet wide, Miller Avenue, 66 feet wide and Georgia Avenue, 60 feet wide, lying northerly of and abutting the north line of Lots 79-85, both inclusive, and lying southerly of and abutting the south line of Lots 78 and 86; also lying easterly of and abutting the east line of Lot 62-78, both inclusive, and lying westerly of and abutting the west line of Lots 86-102, both inclusive, of "Bessenger & Moore's Field Avenue Subdivision" of the S. 1/2 of the S.W. 1/4 of the S.E. 1/4 of Sec. 21 T.1, S. R. 12 E., Hamtramck Township (now Detroit), Wayne Co., Michigan, as recorded in Liber 31, Page 62, Plats, Wayne County Records; and lying easterly of and abutting the south 20.00 feet of the east line of Lot 96 and that east-west public alley, 16.00 feet wide (deeded October 25, 1921) lying southerly of and abutting the south line of Lot 125 as platted in "Wagner's Field Ave. Sub'n of part of S.E. 1/4 of Sec. 21" T.1, S. R. 12 E., City of Detroit, Wayne County, Michigan, as

recorded in Liber 34, Page 75 of Plats, Wayne County Records;

Also, All of the public alleys, 16.00 feet wide, in the block bounded by Helen Avenue, 50 feet wide, Carrie Avenue, 50 feet wide, Miller Avenue, 66 feet wide and Georgia Avenue, 60 feet wide, lying northerly of and abutting the north line of Lots 120-126, both inclusive, and lying southerly of and abutting the south line of Lots 119 and 127; also lying easterly of and abutting the east line of Lot 103-119, both inclusive, and lying westerly of and abutting the west line of Lots 127-143, both inclusive, of "Bessenger & Moore's Field Avenue Subdivision" of the S. 1/2 of the S.W. 1/4 of the S.E. 1/4 of Sec. 21 T.1, S. R. 12 E., Hamtramck Township (now Detroit), Wayne Co., Michigan, as recorded in Liber 31, Page 62, Plats, Wayne County Records; and lying easterly of and abutting the east line of Lots 126-140, both inclusive, and lying westerly of and abutting the west line of Lots 141-155, both inclusive, as platted in "Wagner's Field Ave. Sub'n of part of S.E. 1/4 of Sec. 21" T.1, S. R. 12 E., City of Detroit Wayne County, Michigan, as recorded in Liber 34, Page 75 of Plats, Wayne County Records;

Also, All of the public alleys, 16.00 feet wide, in the block bounded by Winfield Avenue, 50 feet wide, Carrie Avenue, 50 feet wide, Miller Avenue, 66 feet wide and Georgia Avenue, 60 feet wide, lying northerly of and abutting the north line of Lots 161-167, both inclusive, and lying southerly of and abutting the south line of Lots 160 and 168; also lying easterly of and abutting the east line of Lot 144-160, both inclusive, and lying westerly of and abutting the west line of Lots 168-184, both inclusive, of "Bessenger & Moore's Field Avenue Subdivision" of the S. 1/2 of the S.W. 1/4 of the S.E. 1/4 of Sec. 21 T.1, S. R. 12 E., Hamtramck Township (now Detroit), Wayne Co., Michigan, as recorded in Liber 31, Page 62, Plats, Wayne County Records; and lying easterly of and abutting the east line of Lots 156-170, both inclusive, and lying westerly of and abutting the west line of Lots 171-185, both inclusive, as platted in "Wagner's Field Ave. Sub'n of part of S.E. 1/4 of Sec. 21" T.1, S. R. 12 E., City of Detroit, Wayne County, Michigan, as recorded in Liber 34, Page 75 of Plats, Wayne County Records;

Also, All of the public alleys, 8.00 & 16.00 feet wide, in the block bounded by Winfield Avenue, 50 feet wide, St. Cyril Avenue, variable width, Miller Avenue, 66 feet wide and Georgia Avenue, 60 feet wide, lying northerly of and abutting the north line of Lots 202, 203, 204, and lying southerly of and abutting the south line of Lot 201; also lying easterly of and abutting the east line of Lots 185-201, both inclusive, of "Bessenger & Moore's Field

Avenue Subdivision" of the S. 1/2 of the S.W. 1/4 of the S.E. 1/4 of Sec. 21 T.1, S. R. 12 E., Hamtramck Township (now Detroit), Wayne Co., Michigan, as recorded in Liber 31, Page 62, Plats, Wayne County Records; and lying easterly of and abutting the east line of Lots 186-200, both inclusive, and lying westerly of and abutting the west line of Lots 201-215, both inclusive, as platted in "Wagner's Field Ave. Sub'n of part of S.E. 1/4 of Sec. 21" T.1, S. R. 12 E., City of Detroit, Wayne County, Michigan, as recorded in Liber 34, Page 75 of Plats, Wayne County Records; and lying westerly of and abutting the west line of Lots 1-12, both inclusive, of "Mt. Vernon Park Sub" of part of the S.E. 1/4 of S.E. 1/4 of Sec. 21, T.1, S. R. 12 E., City of Detroit, Wayne County, Michigan, as recorded in Liber 34, Page 16 of Plats, Wayne County Records; and lying northerly of and abutting the north line of Lots 6-13, both inclusive, and lying southerly of and abutting the south line of Lots 5 & 14, and lying westerly of and abutting the west line of Lot 14, and lying easterly of and abutting the east line of Lot 14 and lying westerly of and abutting the west line of Lots 1-5, both inclusive, and lying northerly of and abutting the north line of said Lot 14 of "Piscopin's Field Ave. Sub" of part of S.E. 1/4 of Sec. 21" T.1, S. R. 12 E., City of Detroit, Wayne County, Michigan, as recorded in Liber 36, Page 62, Plats, Wayne County Records;

Also, All of the public alleys, 8.00, 15.00 & 16.00 feet wide, in the block bounded by Winfield Avenue, 54 feet wide, St. Cyril Avenue, 66 feet wide, Sheehan Avenue, 50 feet wide, and Grinnell Avenue, 50 feet wide, lying westerly of and abutting the west line of Lots 11-17, both inclusive, and lying easterly of and abutting the east line of Lot 18 and the southeasterly line of Lot 19, and lying southerly of and abutting the south line of said Lot 19 and Lots 20-49, both inclusive, as platted in "Bessenger & Moore's Van Dyke Avenue Subdivision" of the north 8.158 acres of the S.E. 1/4 of N.E. 1/4 of Sec. 21 T.1, S. R. 12 E., Hamtramck Township (now Detroit), Wayne Co., Michigan, as recorded in Liber 33, Page 80, Plats, Wayne County Records; and lying easterly of and abutting the east line of Lot 14 and lying northerly of and abutting the north line of said Lot 14 and Lots 15-41, both inclusive, of "Oak Hill Rose & Sheehan's Sub" of part of Section 21 T.1, S. R. 12 E., Hamtramck (now Detroit), Wayne County, Michigan, as recorded in Liber 13, Page 72, Plats, Wayne County Records;

Also, All of the public alleys, 8.00, 15.00 & 16.00 feet wide, in the block bounded by Winfield Avenue, 54 feet wide, St. Cyril Avenue, 66 feet wide, Sheehan Avenue, 50 feet wide, and Marjorie Avenue, 50 feet wide, lying southerly of and abutting the

south line of Lots 42-65, both inclusive, and lying easterly of and abutting the east line of said Lot 65 of "Oak Hill Rose & Sheehans Sub" of part of Section 21 T.1, S. R. 12 E., Hamtramck (now Detroit), Wayne County, Michigan, as recorded in Liber 13, Page 72, Plats, Wayne County Records; and lying northerly of and abutting the north line of Lots 138-156, both inclusive, and lying easterly of and abutting the east line of said Lot 156, and westerly of and abutting the west line of Lots 157-162, both inclusive of "Geo. G. Epstean's Van Dyke Park Subdivision" of the Southerly 1/2 of Northerly 32-1/2 Acres of S.E. 1/4 of N.E. 1/4 of Section 21 T.1, S. R. 12 E., Hamtramck Township (now Detroit), Wayne County, Michigan, as recorded in Liber 32, Page 8 of Plats, Wayne County Records;

Also, All of the public alleys, 16.00 feet wide, in the block bounded by Winfield Avenue, 54 feet wide, St. Cyril Avenue, 66 feet wide, Guthrie Avenue, 50 feet wide, and Marjorie Avenue, 50 feet wide, lying northerly of and abutting the north line of Lots 45-56, both inclusive, and lying southerly of and abutting the south line of Lots 123-137, both inclusive, and lying westerly of and abutting the west line of Lot 57-120, both inclusive and lying easterly of and abutting the east line of Lot 56, Lot 121 and the southeasterly line of Lots 122 and 123 of "Geo. G. Epstean's Van Dyke Park Subdivision" of the Southerly 1/2 of Northerly 32-1/2 Acres of the S.E. 1/4 of N.E. 1/4 of Section 21 T.1, S. R. 12 E., Hamtramck Township (now Detroit), Wayne County, Michigan, as recorded in Liber 32, Page 8 of Plats, Wayne County Records;

Also, All of the public alleys, 8.0 & 16.00 feet wide, in the block bounded by

Winfield Avenue, 54 feet wide, St. Cyril Avenue, 66 feet wide, Guthrie Avenue, 50 feet wide, and Huber Avenue, 66 feet wide, lying southerly of and abutting the south line of Lots 35-44, both inclusive, and lying westerly of and abutting the west line of Lots 30-34, both inclusive, and lying easterly of and abutting the east line of Lot 35, of "Geo. G. Epstean's Van Dyke Park Subdivision" of the Southerly 1/2 of Northerly 32-1/2 Acres of S.E. 1/4 of N.E. 1/4 of Section 21 T.1, S. R. 12 E., Hamtramck Township (now Detroit), Wayne County, Michigan, as recorded in Liber 32, Page 8 of Plats, Wayne County Records;

Be and the same is hereby vacated (outright) as public street(s) and alley(s) to become part and parcel of the adjoining property;

Provided, That the City of Detroit Planning and Development Department is hereby authorized and directed to issue a "Quit Claim Deed" to the "EDC" for land dedicated to the City of Detroit May 17, 1927, for public alley purposes, said land described as:

Land in the City of Detroit, County of Wayne, State of Michigan, being the south 20.0 feet of Lots 125, as platted in "Wagner's Field Ave. Sub'n of part of S.E. 1/4 of Sec. 21" T.1, S. R. 12 E., City of Detroit, Wayne County, Michigan, as recorded in Liber 34, Page 75 of Plats, Wayne County Records; and further

Provided, That the City Clerk shall within 30 days record a certified copy of this resolution with the Wayne County Register of Deeds.

A waiver of reconsideration is hereby respectfully requested of your Honorable Body.

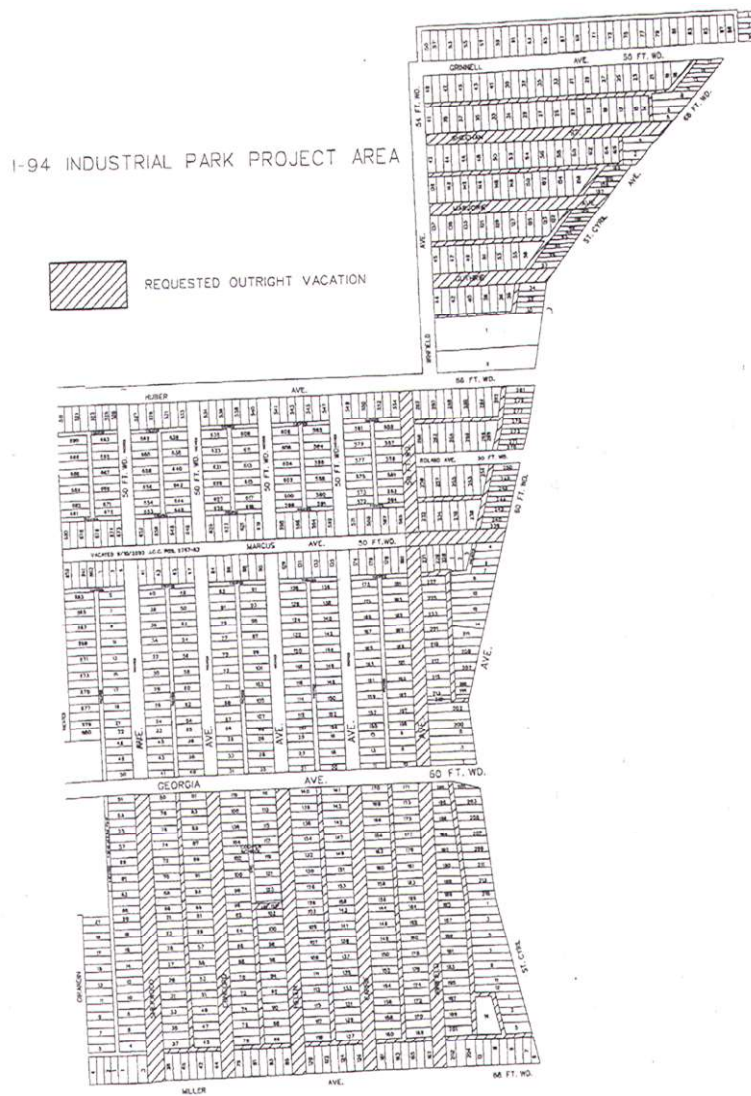

Adopted as follows:
 Yeas — Council Members Ayers, Benson, Castaneda-Lopez, Cushingberry, Jr., Leland, Spivey, Tate, and President Jones — 8.
 Nays — None.

**Department of Public Works
 City Engineering Division**
 April 30, 2015

Honorable City Council:
 Re: Petition No. 476 — The Lofts at Rivertown Condominium Association, request for an Encroachment permit to install a new fence, following right-of-way guidelines once the bridge reconstruction project has

been completed in February or March, 2015.

Petition No. 476 — The Lofts at Rivertown Association request to install and maintain an encroachment in the public right-of-way on the north side of Jefferson Avenue, 120 feet wide between Beaufait Avenue, 71 feet wide and Bellevue Avenue, 66 feet wide. The proposed encroachment is for a security fence.

The requested encroachment with a fence is to provide security to and from the Jefferson Avenue building entrance and the secured parking lot located on Beaufait Avenue.

The petition was referred to the City