

Adopted as follows:

Yeas — Council Members Bates, K. Cockrel, Jr., S. Cockrel, Collins, Everett, McPhail, Tinsley-Talabi, Watson, and President Mahaffey — 9.

Nays — None.

**Department of Public Works
City Engineering Division**

August 28, 2003

Honorable City Council:

Re: Petition No. 4356 — Planning and Development Department, requesting the vacation of streets and alleys in the area of Grinnell, Huber, Miller, Mt. Elliott and St. Cyril for proposed I-94 Industrial Park Project.

The I-94 Industrial Park Project ("the Project") was approved and established by the Detroit City Council on August 4, 1999. "The Project" is being undertaken by the Economic Development Corporation (the "EDC") and will involve the development of a modern industrial park, consisting of several large warehouses. The area will be divided into six (6) project area parcels. Attached you will find a resolution vacating the rights-of-way within Phase One of "the Project", which will cover Parcel Area 1 and Parcel Area 5.

Phase One being the vacation of all of the public streets and alleys in the area generally bounded by Georgia Avenue, 60 feet wide, Huber Avenue, 66 feet wide, the New York Central Belt Line R.O.W. and Winfield Avenue, 50 feet wide.

The Traffic Engineering Division — DPW has no objection to the outright vacation of the public streets and alleys within the "the Project" provided that the City owns all the property adjacent to those rights-of-way to be vacated. The petition was referred to the City Engineering Division — DPW for investigation (utility review) and report. This is our report:

Your Honorable City Council has previously approved the "Funding Agreement" and "Transfer of Land Agreement" with the "EDC" therefore authorizing the City's power of eminent domain and declaring this project as a public improvement for the benefit and use of the public.

In order to implement and facilitate the accomplishment of certain changes in public rights-of-way, such as vacation and removal of streets, alleys or other public ways, and certain utilities and facilities, both public and private, the attached resolution respectfully request the approval of your Honorable Body authorizing the City of Detroit to require that these right-of-way changes take place.

A waiver of reconsideration is respectfully requested.

Respectfully submitted,
SUNDAY JAIYESIMI

City Engineer
City Engineering Division — DPW

By Council Member Bates:

Whereas, The I-94 Industrial Park Project ("the Project") was approved and established by the Detroit City Council on August 4, 1999; and

Whereas, Your Honorable City Council has previously approved the "Funding Agreement" and "Transfer of Land Agreement" with the Economic Development Corporation therefore authorizing the City's power of eminent domain and declaring this project as a public improvement for the benefit and use of the public; and

Whereas, "The Project" represents an exciting opportunity to redevelop a significant portion of vacant and dormant land, generating jobs and economic opportunity for the City of Detroit; therefore be it

STREETS

Resolved, That all that part of Carrie Avenue, 50 feet wide, between Huber Avenue, 66 feet wide, and Marcus Avenue, 50 feet wide, described as lying easterly of and abutting the east line of Lot 547 and Lots 582-592, both inclusive, and lying westerly of and abutting the west line of Lot 548 and Lots 571-581, both inclusive, and that part of Carrie Avenue, 50 feet wide, between Marcus Avenue, 50 feet wide, and Georgia Avenue, 60 feet wide, lying easterly of and abutting the east line of Lots 135-154, both inclusive, and lying westerly of and abutting the west line of Lots 155-174, both inclusive, as platted in "Bessenger & Moore's Mt. Elliott Ave. Sub'd'n of S. 1/2 of Lot 3 and Lots 4 and 5 of Sub. of S.W. 1/4 of Sec. 21 T.1, S. R. 12 E., as recorded in Liber 3, Page 12 of Plats and Lot 5 and part of Lot 6 of Sub. of Estate of James Dunn on S.W. 1/4 Sec. 21 T.1, S. R. 12 E., as recorded in Liber 61, Page 199 of Deeds, also part of Sec. 21 T.1, S. R. 12 E., Hamtramck Township", Wayne Co., Michigan, as recorded in Liber 33, Page 19 of Plats, Wayne County Records; Also, all that part of Carrie Avenue, 50 feet wide, north of said Georgia Avenue, lying easterly of and abutting the east line of Lots 16-20, both inclusive, and lying westerly of and abutting the west line of Lots 11-15, both inclusive, as platted in "Wagner's Field Ave. Sub'n of part of S.E. 1/4 of Sec. 21" T.1, S. R. 12 E., City of Detroit, Wayne County, Michigan, as recorded in Liber 34, Page 75 of Plats, Wayne County Records;

All that part of Helen Avenue, 50 feet wide, between Huber Avenue, 66 feet wide, and Marcus Avenue, 50 feet wide, Lying easterly of and abutting the east line of Lot 540 and Lots 609-619, both inclusive, and lying westerly of and abutting the west line of Lot 541 and Lots 598-608, both inclusive, and that part of said Helen Avenue, between said Marcus Avenue and Georgia Avenue, 60 feet wide, described as lying easterly of and

abutting the east line of Lots 90-109, both inclusive, and lying westerly of and abutting the west line of Lots 110-129, both inclusive, as platted in said "Bessenger & Moore's Mt. Elliott Ave. Subd'n of S. 1/2 of Lot 3 and Lots 4 and 5 of Sub. of S.W. 1/4 of Sec. 21 T.1, S. R. 12 E.", as recorded in Liber 3, Page 12 of Plats and Lot 5 and part of Lot 6 of Sub. of Estate of James Dunn on S.W. 1/4 Sec. 21 T.1, S. R. 12 E., as recorded in Liber 61, Page 199 of Deeds, also part of Sec. 21 T.1, S. R. 12 E., Hamtramck Township", Wayne Co., Michigan, as recorded in Liber 33, Page 19 of Plats, Wayne County Records; Also, that part of Helen Avenue, 50 feet wide, lying easterly of and abutting the east line of Lots 26-30, both inclusive, and lying westerly of and abutting the west line of Lots 21-25, both inclusive, as platted in said "Wagner's Field Ave. Sub'n of part of S.E. 1/4 of Sec. 21" T.1, S. R. 12 E., City of Detroit, Wayne County, Michigan, as recorded in Liber 34, Page 75 of Plats, Wayne County Records;

All that part of Concord Avenue, 50 feet wide, between Huber Avenue, 66 feet wide, and Marcus Avenue, 50 feet wide, lying easterly of and abutting the east line of Lot 533 and Lots 636-649, both inclusive, and lying westerly of and abutting the west line of Lot 534 and Lots 625-635, both inclusive, and that part of said Concord Avenue between said Marcus Avenue and Georgia Avenue, 60 feet wide, described as lying easterly of and abutting the east line of Lots 47-65, both inclusive, and lying westerly of and abutting the west line of Lots 66-84, both inclusive, as platted in said "Bessenger & Moore's Mt. Elliott Ave. Subd'n of S. 1/2 of Lot 3 and Lots 4 and 5 of Sub. of S.W. 1/4 of Sec. 21 T.1, S. R. 12 E.", as recorded in Liber 3, Page 12 of Plats and Lot 5 and part of Lot 6 of Sub. of Estate of James Dunn on S.W. 1/4 Sec. 21 T.1, S. R. 12 E., as recorded in Liber 61, Page 199 of Deeds, also part of Sec. 21 T.1, S. R. 12 E., Hamtramck Township", Wayne Co., Michigan, as recorded in Liber 33, Page 19 of Plats, Wayne County Records; Also, that part of Concord Avenue, 50 feet wide, lying easterly of and abutting the east line of Lots 36-40, both inclusive, and lying westerly of and abutting the west line of Lots 31-35, both inclusive, as platted in said "Wagner's Field Ave. Sub'n of part of S.E. 1/4 of Sec. 21" T.1, S. R. 12 E., City of Detroit, Wayne County, Michigan, as recorded in Liber 34, Page 75 of Plats, Wayne County Records;

All that part of Sherwood Avenue, 50 feet wide, between Huber Avenue, 66 feet wide, and Marcus Avenue, 50 feet wide, lying easterly of and abutting the east line of Lot 526 and Lots 663-673, both inclusive, and lying westerly of and abutting the westerly line of Lot 527 and Lots 652-662, both inclusive, and that part of said

Sherwood Avenue between said Marcus Avenue and Georgia Avenue, 60 feet wide, described as lying easterly of and abutting the east line of Lots 4-22, both inclusive, and lying westerly of and abutting the west line of Lots 23-41, both inclusive, as platted in said "Bessenger & Moore's Mt. Elliott Ave. Subd'n of S. 1/2 of Lot 3 and Lots 4 and 5 of Sub. of S.W. 1/4 of Sec. 21 T.1, S. R. 12 E.", as recorded in Liber 3, Page 12 of Plats and Lot 5 and part of Lot 6 of Sub. of Estate of James Dunn on S.W. 1/4 Sec. 21 T.1, S. R. 12 E., as recorded in Liber 61, Page 199 of Deeds, also part of Sec. 21 T.1, S. R. 12 E., Hamtramck Township", Wayne Co., Michigan, as recorded in Liber 33, Page 19 of Plats, Wayne County Records; Also, that part of Sherwood Avenue, 50 feet wide, lying easterly of and abutting the east line of Lots 46-50, both inclusive, and lying westerly of and abutting the west line of Lots 41-45, both inclusive, as platted in said "Wagner's Field Ave. Sub'n of part of S.E. 1/4 of Sec. 21" T.1, S. R. 12 E., City of Detroit, Wayne County, Michigan, as recorded in Liber 34, Page 75 of Plats, Wayne County Records;

All that part of Girardin Avenue, 50 feet wide, between Huber Avenue, 66 feet wide, and Marcus Avenue, 50 feet wide, lying easterly of and abutting the east line of Lot 510 and Lots 719-729, both inclusive, and lying westerly of and abutting the west line of Lot 519 and Lots 680-690, both inclusive, as platted in said "Bessenger & Moore's Mt. Elliott Ave. Subd'n of S. 1/2 of Lot 3 and Lots 4 and 5 of Sub. of S.W. 1/4 of Sec. 21 T.1, S. R. 12 E.", as recorded in Liber 3, Page 12 of Plats and Lot 5 and part of Lot 6 of Sub. of Estate of James Dunn on S.W. 1/4 Sec. 21 T.1, S. R. 12 E., as recorded in Liber 61, Page 199 of Deeds, also part of Sec. 21 T.1, S. R. 12 E., Hamtramck Township", Wayne Co., Michigan, as recorded in Liber 33, Page 19 of Plats, Wayne County Records; and that remaining part of said Girardin Avenue, 50 feet wide, south of said Marcus Avenue, lying easterly of and abutting the east line of Lot 858 and Lots 895-898, both inclusive, and lying westerly of and abutting the west line of Lot 859 and Lots 863-866, both inclusive, as platted in "Bessenger & Moore's Mt. Elliott Ave. Subdivision No. 1" of part of N.E. 1/4 of S.W. 1/4 of Sec. 21 T.1, S. R. 12 E., City of Detroit, Wayne County, Michigan, as recorded in Liber 35, Page 40 of Plats, Wayne County Records;

All that part of Foster Avenue, 50 feet wide, between Huber Avenue, 66 feet wide, and Marcus Avenue, 50 feet wide, lying easterly of and abutting the east line of Lot 510 and Lots 719-729, both inclusive, and the vacated public alleys adjoining, and lying westerly of and abutting the west line of Lot 511 and Lots 708-716, both inclusive, as platted in said

"Bessenger & Moore's Mt. Elliott Ave. Subd'n of S. 1/2 of Lot 3 and Lots 4 and 5 of Sub. of S.W. 1/4 of Sec. 21 T.1, S. R. 12 E., as recorded in Liber 3, Page 12 of Plats and Lot 5 and part of Lot 6 of Sub. of Estate of James Dunn on S.W. 1/4 Sec. 21 T.1, S. R. 12 E., as recorded in Liber 61, Page 199 of Deeds, also part of Sec. 21 T.1, S. R. 12 E., Hamtramck Township", Wayne Co., Michigan, as recorded in Liber 33, Page 19 of Plats, Wayne County Records; Also, that remaining part of said Foster Avenue, 50 feet wide, south of said Marcus Avenue, lying between the north line extended easterly of Lot 924 and the north line of Lot 850 extended easterly to the north-west corner of Lot 851; also, that part of Foster Avenue, (vacated and converted to an easement August 29, 1979; J.C.C. Pgs. 2453-54) abutting the westerly line of Lot 916 and abutting the easterly line of the southerly 47.59 feet of Lot 917 as platted in "Bessenger & Moore's Mt. Elliott Ave. Subdivision No. 1" of part of N.E. 1/4 of S.W. 1/4 of Sec. 21 T.1, S. R. 12 E., City of Detroit, Wayne County, Michigan, as recorded in Liber 35, Page 40 of Plats, Wayne County Records;

Also, all that part of Marcus Avenue, 50 feet wide, between the east line of the New York Central Belt Line right-of-way and Winfield Avenue, 50 feet wide, described as lying southerly of and abutting the south line of Lots 565-571, both inclusive, Lots 592-598, both inclusive, Lots 619-625, both inclusive, Lots 646-652, both inclusive, Lots 673-680, both inclusive, Lots 701-708, both inclusive and Lots 729-732, both inclusive, also, lying northerly of and abutting the north line of Lots 1-4, both inclusive, Lots 41-47, both inclusive, Lots 84-90, both inclusive, Lots 129-135, both inclusive and Lots 174-180, both inclusive, as platted in said "Bessenger & Moore's Mt. Elliott Ave. Subd'n of S. 1/2 of Lot 3 and Lots 4 and 5 of Sub. of S.W. 1/4 of Sec. 21 T.1, S. R. 12 E., as recorded in Liber 3, Page 12 of Plats and Lot 5 and part of Lot 6 of Sub. of Estate of James Dunn on S.W. 1/4 Sec. 21 T.1, S. R. 12 E., as recorded in Liber 61, Page 199 of Deeds, also part of Sec. 21 T.1, S. R. 12 E., Hamtramck Township", Wayne Co., Michigan, as recorded in Liber 33, Page 19 of Plats, Wayne County Records; also, lying northerly of and abutting the north line of Lots 847-862, both inclusive, as platted in "Bessenger & Moore's Mt. Elliott Ave. Subdivision No. 1" of part of N.E. 1/4 of S.W. 1/4 of Sec. 21 T.1, S. R. 12 E., City of Detroit, Wayne County, Michigan, as recorded in Liber 35, Page 40 of Plats, Wayne County Records;

Also, all that part of Rugg Avenue, 55 feet wide, between the east line of the New York Central Belt Line right-of-way and Foster Avenue, 50 feet wide, lying

northerly of and abutting the north line of 924-927, both inclusive, and lying southerly of and abutting the south line of 932-935, both inclusive, as platted in "Bessenger & Moore's Mt. Elliott Ave. Subdivision No. 1" of part of N.E. 1/4 of S.W. 1/4 of Sec. 21 T.1, S. R. 12 E., City of Detroit, Wayne County, Michigan, as recorded in Liber 35, Page 40 of Plats, Wayne County Records;

ALLEYS

Also, all of the public alleys, in the block bounded by Carrie Avenue, 50 feet wide, Winfield Avenue, 50 feet wide, Marcus Avenue, 50 feet wide, and Huber Avenue, 66 feet wide, lying southerly of and abutting the south line of Lots 548-554, both inclusive, and lying easterly of and abutting the east line of Lots 572-581, both inclusive, and lying northerly of and abutting the north line of Lot 565-571, both inclusive, as platted in "Bessenger & Moore's Mt. Elliott Ave. Subd'n of S. 1/2 of Lot 3 and Lots 4 and 5 of Sub. of S.W. 1/4 of Sec. 21 T.1, S. R. 12 E., as recorded in Liber 3, Page 12 of Plats and Lot 5 and part of Lot 6 of Sub. of Estate of James Dunn on S.W. 1/4 Sec. 21 T.1, S. R. 12 E., as recorded in Liber 61, Page 199 of Deeds, also part of Sec. 21 T.1, S. R. 12 E., Hamtramck Township", Wayne Co., Michigan, as recorded in Liber 33, Page 19 of Plats, Wayne County Records;

Also, all of the public alleys, in the block bounded by Helen Avenue, 50 feet wide, Carrie Avenue, 50 feet wide, Marcus Avenue, 50 feet wide, and Huber Avenue, 66 feet wide, lying southerly of and abutting the south line of Lots 541-547, both inclusive, and lying easterly of and abutting the east line of Lots 599-608, both inclusive, and lying northerly of and abutting the north line of Lots 592-598, both inclusive, as platted in "Bessenger & Moore's Mt. Elliott Ave. Subd'n of S. 1/2 of Lot 3 and Lots 4 and 5 of Sub. of S.W. 1/4 of Sec. 21 T.1, S. R. 12 E., as recorded in Liber 3, Page 12 of Plats and Lot 5 and part of Lot 6 of Sub. of Estate of James Dunn on S.W. 1/4 Sec. 21 T.1, S. R. 12 E., as recorded in Liber 61, Page 199 of Deeds, also part of Sec. 21 T.1, S. R. 12 E., Hamtramck Township", Wayne Co., Michigan, as recorded in Liber 33, Page 19 of Plats, Wayne County Records;

Also, all of the public alleys, in the block bounded by Concord Avenue, 50 feet wide, Helen Avenue, 50 feet wide, Marcus Avenue, 50 feet wide, and Huber Avenue, 66 feet wide, lying southerly of and abutting the south line of Lots 534-540, both inclusive, and lying easterly of and abutting the east line of Lots 626-635, both inclusive, and lying northerly of and abutting the north line of Lots 619-625, both inclusive, as platted in "Bessenger & Moore's Mt. Elliott Ave. Subd'n of S. 1/2 of Lot 3 and Lots 4 and 5 of Sub. of S.W. 1/4 of Sec. 21 T.1, S. R. 12 E., as recorded in

Liber 3, Page 12 of Plats and Lot 5 and part of Lot 6 of Sub. of Estate of James Dunn on S.W. 1/4 Sec. 21 T.1, S. R. 12 E., as recorded in Liber 61, Page 199 of Deeds, also part of Sec. 21 T.1, S. R. 12 E., Hamtramck Township", Wayne Co., Michigan, as recorded in Liber 33, Page 19 of Plats, Wayne County Records;

Also, all of the public alleys, in the block bounded by Sherwood Avenue, 50 feet wide, Concord Avenue, 50 feet wide, Marcus Avenue, 50 feet wide, and Huber Avenue, 66 feet wide, lying southerly of and abutting the south line of Lots 527-533, both inclusive, and lying easterly of and abutting the east line of Lots 653-662, both inclusive, and lying northerly of and abutting the north line of Lots 646-652, both inclusive, as platted in "Bessenger & Moore's Mt. Elliott Ave. Subd'n of S. 1/2 of Lot 3 and Lots 4 and 5 of Sub. of S.W. 1/4 of Sec. 21 T.1, S. R. 12 E., as recorded in Liber 3, Page 12 of Plats and Lot 5 and part of Lot 6 of Sub. of Estate of James Dunn on S.W. 1/4 Sec. 21 T.1, S. R. 12 E., as recorded in Liber 61, Page 199 of Deeds, also part of Sec. 21 T.1, S. R. 12 E., Hamtramck Township", Wayne Co., Michigan, as recorded in Liber 33, Page 19 of Plats, Wayne County Records;

Also, all of the public alleys, in the block bounded by Girardin Avenue, 50 feet wide, Sherwood Avenue, 50 feet wide, Marcus Avenue, 50 feet wide, and Huber Avenue, 66 feet wide, lying southerly of and abutting the south line of Lots 519-526, both inclusive, and lying easterly of and abutting the east line of Lots 681-690, both inclusive, and lying northerly of and abutting the north line of Lots 673-680, both inclusive, as platted in "Bessenger & Moore's Mt. Elliott Ave. Subd'n of S. 1/2 of Lot 3 and Lots 4 and 5 of Sub. of S.W. 1/4 of Sec. 21 T.1, S. R. 12 E., as recorded in Liber 3, Page 12 of Plats and Lot 5 and part of Lot 6 of Sub. of Estate of James Dunn on S.W. 1/4 Sec. 21 T.1, S. R. 12 E., as recorded in Liber 61, Page 199 of Deeds, also part of Sec. 21 T.1, S. R. 12 E., Hamtramck Township", Wayne Co., Michigan, as recorded in Liber 33, Page 19 of Plats, Wayne County Records;

Also, all of the public alleys, in the block bounded by Foster Avenue, 50 feet wide, Girardin Avenue, 50 feet wide, Marcus Avenue, 50 feet wide, and Huber Avenue, 66 feet wide, lying southerly of and abutting the south line of Lots 511-518, both inclusive, and lying easterly of and abutting the east line of Lots 709-718, both inclusive, and lying northerly of and abutting the north line of Lots 701-708, both inclusive, as platted in "Bessenger & Moore's Mt. Elliott Ave. Subd'n of S. 1/2 of Lot 3 and Lots 4 and 5 of Sub. of S.W. 1/4 of Sec. 21 T.1, S. R. 12 E., as recorded in Liber 3, Page 12 of Plats and Lot 5 and part of Lot 6 of Sub. of Estate of James Dunn on S.W. 1/4 Sec. 21 T.1, S. R. 12 E.,

as recorded in Liber 61, Page 199 of Deeds, also part of Sec. 21 T.1, S. R. 12 E., Hamtramck Township", Wayne Co., Michigan, as recorded in Liber 33, Page 19 of Plats, Wayne County Records;

Also, all of the public alleys, in the block bounded by Carrie Avenue, 50 feet wide, Winfield Avenue, 50 feet wide, Georgia Avenue, 60 feet wide, and Marcus Avenue, 50 feet wide, lying southerly of and abutting the south line of Lots 174-180, both inclusive, and lying easterly of and abutting the east line of Lots 155-173, both inclusive, as platted in "Bessenger & Moore's Mt. Elliott Ave. Subd'n of S. 1/2 of Lot 3 and Lots 4 and 5 of Sub. of S.W. 1/4 of Sec. 21 T.1, S. R. 12 E., as recorded in Liber 3, Page 12 of Plats and Lot 5 and part of Lot 6 of Sub. of Estate of James Dunn on S.W. 1/4 Sec. 21 T.1, S. R. 12 E., as recorded in Liber 61, Page 199 of Deeds, also part of Sec. 21 T.1, S. R. 12 E., Hamtramck Township", Wayne Co., Michigan, as recorded in Liber 33, Page 19 of Plats, Wayne County Records; also, lying easterly of and abutting the east line of Lots 11-15, both inclusive, as platted in said "Wagner's Field Ave. Sub'n of part of S.E. 1/4 of Sec. 21" T.1, S. R. 12 E., City of Detroit, Wayne County, Michigan, as recorded in Liber 34, Page 75 of Plats, Wayne County Records;

Also, all of the public alleys, in the block bounded by Helen Avenue, 50 feet wide, Carrie Avenue, 50 feet wide, Georgia Avenue, 60 feet wide, and Marcus Avenue, 50 feet wide, lying southerly of and abutting the south line of Lots 129-135, both inclusive, and lying easterly of and abutting the east line of Lots 110-128, both inclusive, as platted in "Bessenger & Moore's Mt. Elliott Ave. Subd'n of S. 1/2 of Lot 3 and Lots 4 and 5 of Sub. of S.W. 1/4 of Sec. 21 T.1, S. R. 12 E., as recorded in Liber 3, Page 12 of Plats and Lot 5 and part of Lot 6 of Sub. of Estate of James Dunn on S.W. 1/4 Sec. 21 T.1, S. R. 12 E., as recorded in Liber 61, Page 199 of Deeds, also part of Sec. 21 T.1, S. R. 12 E., Hamtramck Township", Wayne Co., Michigan, as recorded in Liber 33, Page 19 of Plats, Wayne County Records; also, lying easterly of and abutting the east line of Lots 21-25, both inclusive, as platted in said "Wagner's Field Ave. Sub'n of part of S.E. 1/4 of Sec. 21" T.1, S. R. 12 E., City of Detroit, Wayne County, Michigan, as recorded in Liber 34, Page 75 of Plats, Wayne County Records;

Also, all of the public alleys, in the block bounded by Concord Avenue, 50 feet wide, Helen Avenue, 50 feet wide, Georgia Avenue, 60 feet wide, and Marcus Avenue, 50 feet wide, lying southerly of and abutting the south line of Lots 84-90, both inclusive, and lying easterly of and abutting the east line of Lots 66-83, both inclusive, as platted in "Bessenger & Moore's Mt. Elliott Ave.

Sub'd'n of S. 1/2 of Lot 3 and Lots 4 and 5 of Sub. of S.W. 1/4 of Sec. 21 T.1, S. R. 12 E., as recorded in Liber 3, Page 12 of Plats and Lot 5 and part of Lot 6 of Sub. of Estate of James Dunn on S.W. 1/4 Sec. 21 T.1, S. R. 12 E., as recorded in Liber 61, Page 199 of Deeds, also part of Sec. 21 T.1, S. R. 12 E., Hamtramck Township", Wayne Co., Michigan, as recorded in Liber 33, Page 19 of Plats, Wayne County Records; also, lying easterly of and abutting the east line of Lots 31-35, both inclusive, as platted in said "Wagner's Field Ave. Sub'n of part of S.E. 1/4 of Sec. 21" T.1, S. R. 12 E., City of Detroit, Wayne County, Michigan, as recorded in Liber 34, Page 75 of Plats, Wayne County Records;

Also, all of the public alleys, in the block bounded by Sherwood Avenue, 50 feet wide, Concord Avenue, 50 feet wide, Georgia Avenue, 60 feet wide, and Marcus Avenue, 50 feet wide, lying southerly of and abutting the south line of Lots 41-47, both inclusive, and lying easterly of and abutting the east line of Lots 23-40, both inclusive, as platted in "Bessenger & Moore's Mt. Elliott Ave. Sub'd'n of S. 1/2 of Lot 3 and Lots 4 and 5 of Sub. of S.W. 1/4 of Sec. 21 T.1, S. R. 12 E., as recorded in Liber 3, Page 12 of Plats and Lot 5 and part of Lot 6 of Sub. of Estate of James Dunn on S.W. 1/4 Sec. 21 T.1, S. R. 12 E., as recorded in Liber 61, Page 199 of Deeds, also part of Sec. 21 T.1, S. R. 12 E., Hamtramck Township", Wayne Co., Michigan, as recorded in Liber 33, Page 19 of Plats, Wayne County Records; also, lying easterly of and abutting the east line of Lots 41-45, both inclusive, as platted in said "Wagner's Field Ave. Sub'n of part of S.E. 1/4 of Sec. 21" T.1, S. R. 12 E., City of Detroit, Wayne County, Michigan, as recorded in Liber 34, Page 75 of Plats, Wayne County Records;

Also, all of the public alleys, in the block bounded by Girardin Avenue, 50 feet wide, Sherwood Avenue, 50 feet wide, Georgia Avenue, 60 feet wide, and Marcus Avenue, 50 feet wide, lying southerly of and abutting the south line of Lots 1-4, both inclusive, and lying wester-

ly of and abutting the west line of Lots 5-22, both inclusive, as platted in "Bessenger & Moore's Mt. Elliott Ave. Sub'd'n of S. 1/2 of Lot 3 and Lots 4 and 5 of Sub. of S.W. 1/4 of Sec. 21 T.1, S. R. 12 E., as recorded in Liber 3, Page 12 of Plats and Lot 5 and part of Lot 6 of Sub. of Estate of James Dunn on S.W. 1/4 Sec. 21 T.1, S. R. 12 E., as recorded in Liber 61, Page 199 of Deeds, also part of Sec. 21 T.1, S. R. 12 E., Hamtramck Township", Wayne Co., Michigan, as recorded in Liber 33, Page 19 of Plats, Wayne County Records; also, lying westerly of and abutting the west line of Lots 46-50, both inclusive, as platted in said "Wagner's Field Ave. Sub'n of part of S.E. 1/4 of Sec. 21" T.1, S. R. 12 E., City of Detroit, Wayne County, Michigan, as recorded in Liber 34, Page 75 of Plats, Wayne County Records; and lying southerly of and abutting the south line of Lots 859-862, both inclusive, and lying easterly of and abutting the east line of Lots 863-880, "Bessenger & Moore's Mt. Elliott Ave. Subdivision No. 1" of part of N.E. 1/4 of S.W. 1/4 of Sec. 21 T.1, S. R. 12 E. City of Detroit, Wayne County, Michigan, as recorded in Liber 35, Page 40 of Plats, Wayne County Records;

Also, all of the remaining public alleys, in the area generally bounded by Foster Avenue, 50 feet wide, Girardin, 50 feet wide, south of Marcus Avenue, 50 feet wide, lying southerly of and abutting the south line of Lots 851-858, both inclusive, and lying westerly of and abutting the west line of Lots 895-898, both inclusive, and Lots 881 and 936 as platted in "Bessenger & Moore's Mt. Elliott Ave. Subdivision No. 1" of part of N.E. 1/4 of S.W. 1/4 of Sec. 21 T.1, S. R. 12 E. City of Detroit, Wayne County, Michigan, as recorded in Liber 35, Page 40 of Plats, Wayne County Records;

Be and the same is hereby vacated (outright) as public street(s), alley(s) and easement(s) to become part and parcel of the adjoining property;

A waiver of reconsideration is hereby respectfully requested of your Honorable Body.

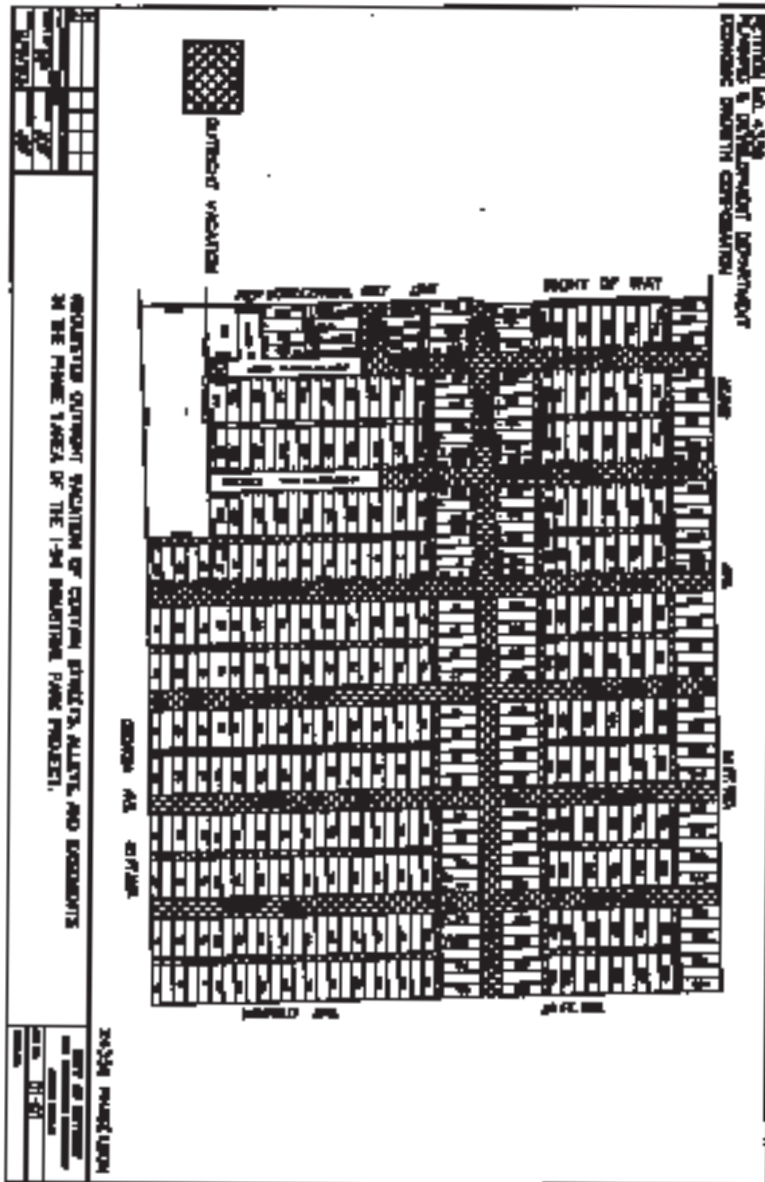

Adopted as follows:

Yeas — Council Members Bates, K. Cockrel, Jr., S. Cockrel, Collins, Everett, McPhail, Tinsley-Talabi, Watson, and President Mahaffey — 9.
Nays — None.

Local Development Finance Authority

September 3, 2003

Honorable City Council:

Re: City of Detroit Local Development Finance Authority Budget for Fiscal Year 2003-2004.

Enclosed please find a copy of the City of Detroit Local Development Finance Authority budget. Under the provisions of Act 281, Public Acts of Michigan, 1986, the Director of the Local Development Finance Authority (the "LDFA") shall prepare and submit to the City Council a budget for the operation of the LDFA for each fiscal year prior to such budget being adopted by the LDFA Board of Directors.

The enclosed budget for the City of