

PETITION NO. 141  
 PEA, INC.  
 2430 ROCHESTER CT., SUITE 100  
 TROY, MICHIGAN 48083  
 C/O EMIL S. BUNEK III, P.E.  
 PHONE NO. 248 689-9090



RIVARD ST. 50 FT. WD.

E. JEFFERSON AVE. 120 FT. WD.

E. LARNED ST. 120 FT. WD.

RUSSELL ST. 50 FT. WD. EASEMENT

RIOPELLE ST. 39.07 FT. WD.



- OUTRIGHT VACATION

(FOR OFFICE USE ONLY)

CARTO 38 D

B				REQUEST TO OUTRIGHT VACATE RUSSELL ST. 50 FT. WD. BETWEEN E. JEFFERSON AVE. AND E. LARNED ST.		CITY OF DETROIT CITY ENGINEERING DEPARTMENT	
A						SURVEY BUREAU	
DESCRIPTION		REVISED	CHKD	APPD	DATE	JOB NO.	01-01
DRAWN BY		WLW	CHKD	KSM		DRWG. NO.	X 141
DATE		04-17-18		APPROVED			

Adopted as follows:

Yeas — Council Members Benson, Castaneda-Lopez, Leland, McCalister, Jr., Sheffield, Spivey, Tate and President Jones — 8.

Nays — None.

**Department of Public Works  
 City Engineering Division**

December 4, 2018

Honorable City Council:

Re: Petition No. 349 — Cholada Chan, request for Outdoor Café permit for Midtown Shangri-La at 4710 Cass Avenue.

Petition No. 349 — Cholada Chan request for an encroachment with sidewalk café, awnings and railing on the east side of Cass Avenue, 80 feet wide, between Forest Avenue, 70 feet wide and Hancock Avenue, 70 feet wide.

The petition was referred to the City Engineering Division — DPW for investigation and report. This is our report.

The request is being made for an outdoor seating area at the existing restaurant Shangri-La.

The request was approved by the Solid Waste Division — DPW, and City Engineering Division — DPW, and Traffic Engineering Division — DPW (TED). TED has conditions that are a part of the resolution.

Detroit Water and Sewerage Department (DWSD) reports being involved, but they have no objection provided the DWSD encroachment provisions are followed. The DWSD provisions have been made a part of the resolution.

All other involved City Departments, including the Public lighting Authority and Public Lighting Department; also privately

owned utility companies have reported no objections to the encroachment. Provisions protecting all utility installations are part of the attached resolution.

I am recommending adoption of the attached resolution.

Respectfully submitted,  
RICHARD DOHERTY, P.E.  
City Engineer

City Engineering Division — DPW  
By Council Member Benson:

Resolved, That the Department of Public Works, City Engineering Division is hereby authorized and directed to issue permits to Midtown Shangri-La or their assigns to install and maintain encroachments with awnings, railings and a sidewalk café on the east side of Cass Avenue, 80 feet wide, between Forest Avenue, 70 feet wide and Hancock Avenue, 70 feet wide and being land in the City of Detroit, Wayne County, Michigan: Cass Avenue adjoining Lots B, and C "William McGrath's Section of Stimson's Subdivision of Park Lots 55, 56, 57, and 58" as recorded in Liber 1, Page 315 of Plats, Wayne County Records. Encroachments are further described as follows:

1) Railing, and outdoor seating area being 7.5 feet wide and 33.58 feet in length and lying west of and adjoining the west line of the north 21 feet of said Lot B and lying west of and adjoining the south 12.58 feet of said Lot C.

2) Awning, with steel support poles, over part of outdoor seating area being 8 feet wide and 16.17 feet in length and lying west of and adjoining the west line of the south 16.17 feet of the north 17.92 feet of said Lot B.

3) Awning, cantilevered off of building, being 3 feet wide and 16.75 feet in length and lying west of and adjoining the west line of the north 16.75 feet of the south 25.08 feet of said Lot B.

Provided, That if there is any cost for the removing and/or rerouting of any utility facilities, it shall be done at the expense of the petitioner and/or property owner; and be it further

Provided, That a minimum of 6.0 feet wide clear and unobstructed sidewalk shall be maintained for pedestrian traffic in front of the outdoor seating area at all times; and be it further

Provided, That access is maintained to all fire department connections, and be it further

Provided, That the proposed use does not hinder or impede the operation, maintenance or replacement of DTE Gas Company facilities, and be it further

Provided, That the remaining sidewalk width meets minimum ADA requirements and all City standards and policies are met; and be it further

Provided, That by approval of this petition the Detroit Water and Sewerage Department (DWSD) does not waive any

of its rights to its facilities located in the right-of-way, and at all times, DWSD, its agents or employees, shall have the right to enter upon the right-of-way to maintain, repair, alter, service, inspect, or install its facilities. All costs incident to the damaging, dismantling, demolishing, removal and replacement of structures or other improvements herein permitted and incurred in gaining access to DWSD's facilities for maintenance, repairing, alteration, servicing or inspection caused by the encroachment shall be borne by the petitioner. All costs associated with gaining access to DWSD's facilities, which could normally be expected had the petitioner not encroached into the right-of-way, shall be borne by DWSD; and be it further

Provided, That the petitioner maintain the DWSD required clearance of 18 feet above grade for maintenance access and repair, and be it further

Provided, That all construction performed under this petition shall not be commenced until after (5) days written notice to DWSD. Seventy-two (72) hours' notice shall also be provided in accordance with P.A. 53 1974, as amended, utilizing the MISS DIG one call system; and be it further

Provided, That construction under this petition is subject to inspection and approval by DWSD /forces. The cost of such inspection shall, at the discretion of DWSD, be borne by the petitioner; and be it further

Provided, That if DWSD facilities located within the right-of-way shall break or be damaged as the result of any action on the part of the petitioner, then in such event the petitioner agrees to be liable for all costs incident to the repair, replacement or relocation of such broken or damaged DWSD facilities; and be it further

Provided, That the petitioner shall hold DWSD harmless for any damages to the encroaching device constructed or installed under this petition which may be caused by the failure of DWSD's facilities; and be it further

Provided, Midtown Shangri-La or their assigns shall apply to the Buildings and Safety Engineering Department for a building permit prior to any construction. Also, if it becomes necessary to open cut public streets, bore, jack, occupy or barricade city rights-of-way for maintenance of encroachments such work shall be according to detail permit application drawings submitted to the City Engineering Division — DPW prior to any public right-of-way construction; and further

Provided, That the necessary permits shall be obtained from the City Engineering Division — DPW and the Buildings and Safety Engineering Department. The encroachments shall be constructed and maintained under their rules and regulations; and further

Provided, That all cost for the construction, maintenance, permits and use of the encroachments shall be borne by Midtown Shangri-La or their assigns, and further

Provided, That all costs incurred by privately owned utility companies and/or city departments to alter, adjust, and/or relocate their existing utility facilities located in close proximity to the encroachments shall be borne by Midtown Shangri-La or their assigns. Should damages to utilities occur Midtown Shangri-La or their assigns shall be liable for all incidental repair costs and waives all claims for damages to the encroaching installations; and further

Provided, That no other rights in the public streets, alleys or other public place shall be considered waived by this permission which is granted expressly on the condition that said encroachments shall be removed at any time when so directed by the City Council, and the public property affected shall be restored to a condition satisfactory to the City Engineering Division — DPW; and further

Provided, That the area being used as an Outdoor Café shall meet the general requirements set by the "Outdoor Café Guidelines" as adopted by the City Council and guided by Section 50-2-20 (aka code 1964 §58-2-8.1) of the City Code; and further

Provided, That the petitioner obtains all necessary licenses and permits every year from Departments having jurisdiction over the outdoor café process; and further

Provided, That said activities are conducted under the rules and regulations of the Department of Public Works and the supervision of the Police Department; and further

Provided, That the sale of food or soft drinks is held under the direction and inspection of the Detroit City Health Department; and further

Provided, That the "permittee" remit the required annual fee(s) to Department of Public Works-City Engineering Division for issuance of a use-permit and confirm license of the establishment in compliance with City Code; and further

Provided, That this use-permit shall be for a period of one year, after receiving approval of City Council, and may be

renewable thereafter on an annual basis; and further

Provided, That Midtown Shangri-La or their assigns shall file with the Department of Public Works — City Engineering Division an indemnity agreement in form approved by the Law Department. The agreement shall save and protect the City of Detroit from any and all claims, damages or expenses that may arise by reason of the issuance of the permits and the faithful or unfaithful performance of Midtown Shangri-La or their assigns of the terms thereof. Further, Midtown Shangri-La or their assigns shall agree to pay all claims, damages or expenses that may arise out of the use, repair and maintenance of the proposed encroachments; and further

Provided, That filing of said indemnity agreement shall be construed as acceptance of this Resolution by the "permittee"; and further

Provided, That the petitioner is responsible to obtain approval of the Michigan Liquor Control Commission, if necessary and approval from the Detroit Police Liquor License Bureau if serving liquor; and further

Provided, That the designated outdoor seating area shall be identified through the use of railings or other physical barrier in order to regulate the serving of liquor within the perimeter of the café; and further

Provided, That all cost for the construction, maintenance, permits and use of the encroachments shall be borne by Midtown Shangri-La, or their assigns; and further

Provided, That construction of the encroachments shall constitute acceptance of the terms and conditions as set forth in this resolution; and be it further

Provided, This resolution is revocable at the will, whim or caprice of the City Council, and Midtown Shangri-La acquires no implied or other privileges hereunder not expressly stated herein; and further

Provided, That the encroachment permits shall not be assigned or transferred without the written approval of the City Council; and be it further

Provided, That the City Clerk shall within 30 days record a certified copy of this resolution with the Wayne County Register of Deeds.

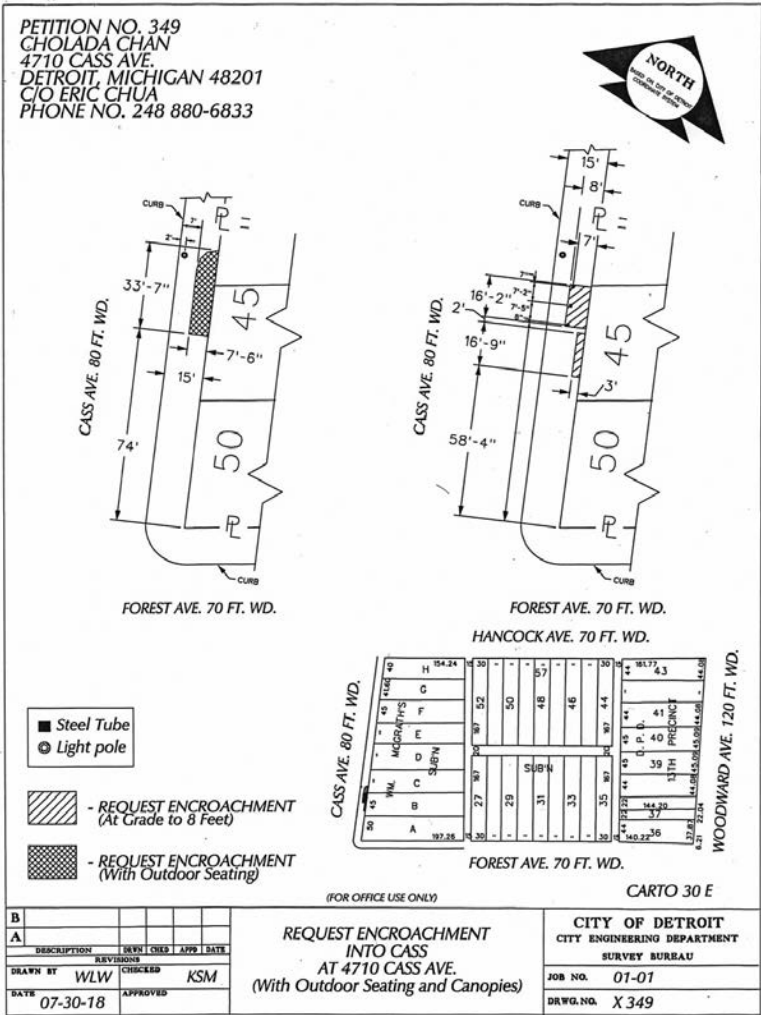

Adopted as follows:  
 Yeas — Council Members Benson, Leland, Castaneda-Lopez, McCalister, Jr., Sheffield, Spivey, Tate, and President Jones — 8.  
 Nays — None.

**Department of Public Works  
 City Engineering Division**  
 December 12, 2018

Honorable City Council:  
 Re: Petition No. 401 — Wayne County, request to vacate sewer easements for County Jail Project.

Petition No. 401 — Wayne County request to vacate sewer easements in Fredrick Avenue, 60 feet wide, from Chrysler Freeway Service Drive to Russell Street, 80 feet wide; also Kirby Avenue, 60 and 80 feet wide, from Chrysler Free-

way Service Drive to Russell Street; Rivard Street, 50 feet wide from 12.5 feet south of Frederick Avenue, to Ferry Street, 75 feet wide; also the east-west alley, 20 feet wide, in the block of Frederick Avenue, Kirby Avenue, Chrysler Freeway Service Drive, and Rivard Street; also the east-west alley, 20 feet wide, and north south alley, 18 feet wide, in the block of Frederick Avenue, Kirby Avenue, Rivard Street and Russell Street; also the east-west, 31.29 feet wide in the block of Kirby Avenue, Ferry Avenue, Chrysler Freeway Service Drive, and Rivard Street; also two (2) north-south alleys, 20 feet wide, and the north-south alley, 18 feet wide, and the two (2) east-west alleys, 20 feet wide, all in the block of Kirby Avenue, Ferry Avenue, Rivard Street and Russell Street; also the north 12.5 feet of the north-south