

**Department of Public Works  
City Engineering Division**

February 26, 2020

Honorable City Council:

Re: Petition Number 605 — DPW, City Engineering Division, request to dedicate a public street: Atwater Street from Civic Center Drive to Renaissance Drive.

Petition No. 605 — The Department of Public Works — City Engineering Division request to dedicate land for Atwater Street, variable width, from Civic Center Drive, variable width, to Renaissance Drive, 60 feet wide.

The petition was referred to the City Engineering Division — DPW for investigation (utility clearance) and report. This is our report.

The purpose of this request is to formally dedicate the previously constructed street. The street was rerouted and constructed in accordance with plans on file in the City Engineers office dated August 11, 1975. Atwater Street was rerouted and partially constructed through a tunnel to allow vehicular traffic to travel from the Renaissance Center to TCF Convention Center (formerly Cobo Center) while allowing Hart Plaza to be an open pedestrian plaza.

All other city departments and utilities have reported no objections to the proposed right- of-way dedication.

I am recommending adoption of the attached resolution.

Respectfully submitted,  
RICHARD DOHERTY, P.E.

City Engineer

City Engineering Division — DPW  
By Council Member Benson:

Resolved, That your Honorable Body authorize the acceptance of the following described properties owned by the City of Detroit for public street purposes:

Atwater Street, variable width, from Civic Center Drive, variable width, to Renaissance Drive, 60 feet wide, being described as follows:

LAND IN THE CITY OF DETROIT, COUNTY OF WAYNE, STATE OF MICHIGAN, BEING PART OF LOT 26, OF PLAT OF PETER BERTHELET'S SUBDIVISION, SECTION 4, AS RECORDED ON LIBER 3, PAGE 470, 472 & 473 OF CITY DETROIT RECORD OF SO CALLED WATER LOTS OF 189 THROUGH 192 AND VACATION RANDOLPH. ALSO PART OF LOTS 186 THROUGH 188 ON PLAT NAMED ADDITIONAL WATER LOTS SECTION 4 RECORDED ON LIBER 5 PAGE 197 OF CITY DETROIT RECORDS, ALSO PART OF LOTS 112 THROUGH 115, AND PART OF LOTS 118, 119 OF PLAT WATER LOTS, AND PLAT OF PART OF SECTION 3, GOVERNOR AND JUDGES PLAN, RECORDED ON LIBER 34 PAGE 548 OF CITY DETROIT AND PART OF

VACATED GRISWOLD STREET, AS RECORDED ON LIBER 34 PAGE 548 DEEDS WAYNE COUNTY RECORD, AND VACATED WOODWARD, PART OF LOT A OF PLAT OF THE JONES PROPERTY KNOWN AS THE BEARD AND GREELY CLAIMS, SECTION 3 GOVERNOR AND JUDGES PLAIN OF THE CITY OF DETROIT AS RECORDED IN LIBER 1, PAGE 290 OF PLATS, WAYNE COUNTY RECORDS. COMMENCING AT SOUTH WEST CORNER OF PRIVATE CLAIM NO. 1 WHICH IS S27°05'11" E 225.0 FEET TO EXISTING WITNESS CORNER (CONCRETE MONUMENT) WITH ALUMINUM CAP STAMPED (REMONUMENTATION) WAYNE COUNTY 49376 "CAA WIT COR" AND THIS WITNESS CORNER RECORDED IN LIBER 51903 PAGE 376, WAYNE COUNTY RECORDS: THENCE FROM SAID WITNESS CORNER S 54°40'00 E 65.36 FEET TO A POINT ON WEST LINE OF RENAISSANCE DRIVE AND CIVIC CENTER STREET, THENCE ALONG NORTH LINE OF ATWATER (VARIABLE WIDTH): (1) ALONG A CURVE TO THE RIGHT, 7.79 FEET, HAVING A RADIUS OF 5.21 FEET, A CENTRAL ANGLE OF 85°37'54", AND A LONG CHORD BEARING S 12°07'03" W, 7.08 FEET, AND (2) ALONG A CURVE TO THE RIGHT 33.73 FEET, HAVING RADIUS OF 59.42 FEET A CENTER ANGLE 32°31'20", LONG CHORD BEARING S 60°45'30" W, 33.28 FEET, AND (3) ALONG A CURVE TO THE RIGHT 58.50 FEET, HAVING RADIUS 70.35 FEET, A CENTRAL ANGLE 47°38'22", LONG CHORD BEARING N 76°17'13" W, 56.83 FEET, AND (4) N 51°29'15" W 62.92 FEET. AND (5) ALONG A TANGENT CURVE TO THE LEFT 79.61 FEET HAVING RADIUS 64.42 FEET, A CENTRAL ANGLE 70°48'05", LONG CHORD BEARING N 78°36'52" W 74.64 FEET, (6) S 59°49'57" W 318.29 FEET TO SE CORNER OF BATES STREET (60 FEET WIDE) AND ATWATER (48 FEET WIDE). THENCE S 59°49'57" W 60 FEET, THENCE S 59 DEGREES 49'57" W 44.33 FEET, THENCE ALONG TANGENT CURVE TO THE RIGHT 50.91 FEET HAVING RADIUS 188.66 FEET, A CENTRAL ANGLE 15°27'37", LONG CHORD BEARING S 61°50'11" W 50.75 FEET, THENCE 73°29'21" W, 118.34 FEET TO A POINT IS STARTING TUNNEL, THENCE S 73°36'01" W 347.90 FEET, TANGENT CURVE TO THE LEFT 250.70 FEET RADIUS 639.64 FEET, CENTRAL ANGLE 22°27'23", LONG CHORD BEARING S 62°03'01" W 249.10 FEET TO END OF TUNNEL, THENCE N 38°47'17" W 13.63 FEET, THENCE ALONG NORTH LINE ATWATER (VARIABLE WIDTHS ) S 51°42'44" W 225.20 FEET TO POINT OF INTERSECTION CIVIC CENTER DRIVE EASTLINE,

THENCE ACROSS ATWATER DRIVE S 38°17'16" E 59.73 FEET TO SOUTH LINE OF ATWATER, THENCE ALONG SOUTH LINE OF ATWATER (VARIABLE WIDTHS): (1) N 51°34'21" E 225.88 FEET. (2) ALONG TANGENT CURVE TO THE RIGHT 237.00 FEET HAVING RADIUS OF 592.99 FEET, A CENTRAL ANGLE 22°53'57", LONG CHORD BEARING N 62°29'15" E, 235.43 FEET. (3) N 73°30'01" E 354.83 FEET. (4) N 73°32'38" E 98.80 FEET. (5) ALONG TANGENT CURVE TO THE LEFT 50.94 FEET, HAVING RADIUS OF 234.72 FEET, A CENTRAL ANGLE 12°26'04", LONG CHORD BEARING N 67°19'36" E 50.84 FEET. (6) N 59°49'57" E 63.31 FEET. (7) N 59°49'57" E 60.00 FEET. (8) N 59°49'57" E 302.86 FEET. (9) ALONG A TANGENT CURVE TO THE RIGHT 35.09 FEET, HAVING RADIUS 28.39 FEET, CENTRAL ANGLE 70°48'28", LONG CHORD BEARING S 84°25'11" E 32.89 FEET. (10) S 49°39'10" E 57.95

FEET. (11) ALONG TANGENT CURVE TO THE LEFT 63.16 FEET HAVING RADIUS 119.95 FEET, CENTRAL ANGLE 30°10'08", LONG CHORD BEARING S 64°44'14" E 62.43 FEET. (12) ALONG TANGENT CURVE TO THE LEFT 99.76 FEET HAVING RADIUS 126.50 FEET, A CENTRAL ANGLE 45°11'10", LONG CHORD BEARING N 77°27'49" E, 97.20 FEET, THENCE N 30°51'32" W 59.58 FEET ACROSS ATWATER DRIVE TO THE POINT OF BEGINNING.

Provided, That any future work in reconstructing the street is to be performed in accordance with plans and specifications approved by City Engineering Division — DPW (CED) and constructed under the inspection and approval of CED; and further

Provided, That the City Clerk shall within 30 days record a certified copy of this resolution with the Wayne County Register of Deeds.

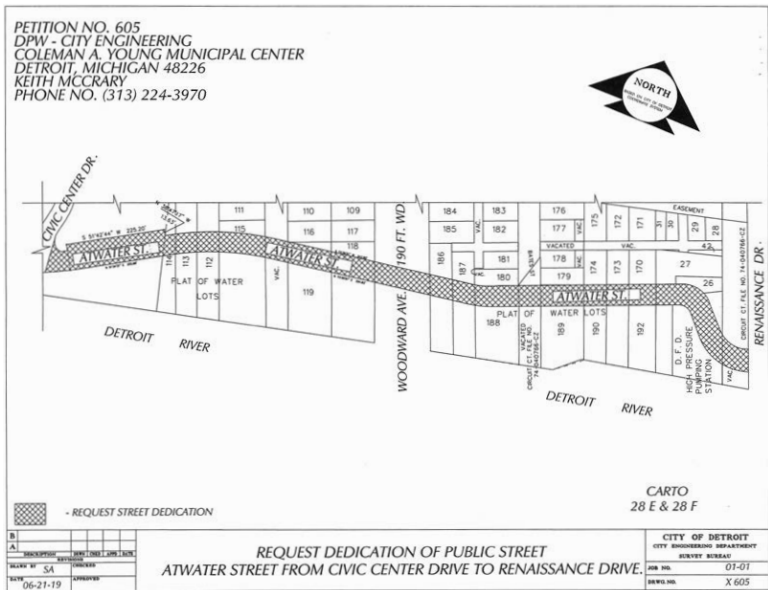

**LEGAL DESCRIPTION  
ATWATER STREET**

LAND IN THE CITY OF DETROIT, COUNTY OF WAYNE, STATE OF MICHIGAN, BEING PART OF LOT 26, OF PLAT OF PETER BERTHELETS SUBDIVISION, SECTION 4, AS RECORDED ON LIBER 3, PAGE 470,472 & 473 OF CITY DETROIT RECORD OF SO CALLED WATER LOTS OF 189 THROUGH 192 AND VACATION RANDOLPH. ALSO PART OF LOTS 186 THROUGH 188 ON PLAT NAMED ADDITIONAL WATER LOTS SECTION 4 RECORDED ON LIBER 5 PAGE 197 OF CITY DETROIT RECORDS, ALSO PART OF LOTS 112 THROUGH 115, AND PART OF LOTS 118, 119 OF PLAT WATER LOTS, AND PLAT OF PART OF SECTION 3, GOVERNOR AND JUDGES PLAN, RECORDED ON LIBER 34 PAGE 548 OF CITY DETROIT AND PART OF VACATED GRISWOLD STREET, AS RECORDED ON LIBER 34 PAGE 548 DEEDS WAYNE COUNTY RECORD, AND VACATED WOODWARD, PART OF LOT A OF PLAT OF THE JONES PROPERTY KNOWN AS THE BEARD AND GREELY CLAIMS, SECTION 3 GOVERNOR AND JUDGES PLAIN OF THE CITY OF DETROIT AS RECORDED IN LIBER 1, PAGE 290 OF PLATS, WAYNE COUNTY RECORDS. COMMENCING AT SOUTH WEST CORNER OF PRIVATE CLAIM NO.1 WHICH IS S27°05'11" E 225.0 FEET TO EXISTING WITNESS CORNER (CONCRETE MONUMENT) WITH ALUMINUM CAP STAMPED (REMONUMENTATION) WAYNE COUNTY 49376 "CAA WIT COR" AND THIS WITNESS CORNER RECORDED IN LIBER 51903 PAGE 376, WAYNE COUNTY RECORDS: THENCE FROM SAID WITNESS CORNER S 54° 40' 00 E 65.36 FEET TO A POINT ON WEST LINE OF RENAISSANCE DRIVE AND CIVIC CENTER STREET. THENCE ALONG NORTH LINE OF ATWATER (VARIABLE WIDTH): (1) ALONG A CURVE TO THE RIGHT, 7.79 FEET, HAVING A RADIUS OF 5.21 FEET, A CENTRAL ANGLE OF 85°37'54", AND A LONG CHORD BEARING S 12°07'03" W, 7.08 FEET, AND (2) ALONG A CURVE TO THE RIGHT 33.73 FEET, HAVING RADIUS OF 59.42 FEET A CENTRAL ANGLE 32°31'20", LONG CHORD BEARING S 60°45'30" W, 33.28 FEET, AND (3) ALONG A CURVE TO THE RIGHT 58.50 FEET, HAVING RADIUS 70.35 FEET, A CENTRAL ANGLE 47°38'22", LONG CHORD BEARING N 76°17'13" W, 56.83 FEET, AND (4) N 51°29'15" W 62.92 FEET. AND (5) ALONG A TANGENT CURVE TO THE LEFT 79.61 FEET HAVING RADIUS 64.42 FEET, A CENTRAL ANGLE 70°48'05", LONG CHORD BEARING N 78°36'52" W 74.64 FEET, (6) S 59°49'57" W 318.29 FEET TO SE CORNER OF BATES STREET (60 FEET WIDE) AND ATWATER (48 FEET WIDE). THENCE S 59°49'57" W 60 FEET, THENCE S 59 DEGREES 49'57" W 44.33 FEET, THENCE ALONG TANGENT CURVE TO THE RIGHT 50.91 FEET HAVING RADIUS 188.66 FEET, A CENTRAL ANGLE 15°27'37", LONG CHORD BEARING S 61°50'11" W 50.75 FEET, THENCE 73°29'21" W, 118.34 FEET TO A POINT IS STARTING TUNNEL, THENCE S 73°36'01" W 347.90 FEET, TANGENT CURVE TO THE LEFT 250.70 FEET RADIUS 639.64 FEET, CENTRAL ANGLE 22°27'23", LONG CHORD BEARING S 62°03'01" W 249.10 FEET TO END OF TUNNEL, THENCE N 38° 47' 17" W 13.63 FEET, THENCE ALONG NORTH LINE ATWATER (VARIABLE WIDTHS ) S 51°42'44" W 225.20 FEET TO POINT OF INTERSECTION CIVIC CENTER DRIVE EASTLINE, THENCE ACROSS ATWATER DRIVE S 38°17'16" E 59.73 FEET TO SOUTH LINE OF ATWATER, THENCE ALONG SOUTH LINE OF ATWATER (VARIABLE WIDTHS): (1) N 51°34'21" E 225.88 FEET (2) ALONG TANGENT CURVE TO THE RIGHT 237.00 FEET HAVING RADIUS OF 592.99 FEET, A CENTRAL ANGLE 22°53'57", LONG CHORD BEARING N 62°29'15" E, 235.43 FEET, (3) N 73°30'01" E 354.83 FEET, (4) N 73°32'38" E 98.80 FEET. (5) ALONG TANGENT CURVE TO THE LEFT 60.94 FEET, HAVING RADIUS OF 234.72 FEET, A CENTRAL ANGLE 12°26'04", LONG CHORD BEARING N 67°19'36" E 50.84 FEET. (6) N 59°49'57" E 63.31 FEET. (7) N 59°49'57" E 60.00 FEET (8) N 59°49'57" E 302.86 FEET. (9) ALONG A TANGENT CURVE TO THE RIGHT 35.09 FEET, HAVING RADIUS 28.39 FEET, CENTRAL ANGLE 70°48'28", LONG CHORD BEARING S 84°25'11" E 32.89 FEET. (10) S 49°39'10" E 57.95 FEET. (11) ALONG TANGENT CURVE TO THE LEFT 63.16 FEET HAVING RADIUS 119.95 FEET, CENTRAL ANGLE 30°10'08", LONG CHORD BEARING S 64°44'14" E 62.43 FEET. (12) ALONG TANGENT CURVE TO THE LEFT 99.76 FEET HAVING RADIUS 126.50 FEET, A CENTRAL ANGLE 45°11'10", LONG CHORD BEARING N 77°27'49" E, 97.20 FEET, THENCE N 30°51'32" W 59.58 FEET ACROSS ATWATER DRIVE TO THE POINT OF BEGINNING.



**ATWATER STREET**  
CITY OF DETROIT, WAYNE COUNTY, MICHIGAN

DPW – CITY ENGINEERING SURVEYOR: BASIL SIRIM 2 WOODWARD AVE #401 DETROIT, MI 48226 (313)628-0930	DATE:01-20-2018	CHECKED BY	DATE	SCALE: 1"=40'
	DRAWN: Phil B			SHEET:1 of 5
	DESIGN:			JOB NO: 01-2018L
	SECTION:			

Adopted as follows:  
 Yeas — Council Members Ayers, Benson, Castaneda-Lopez, Leland, McCalister, Jr., Sheffield, Spivey, Tate and President Jones — 9.  
 Nays — None.

**Department of Public Works  
 City Engineering Division**

February 26, 2020

Honorable City Council:  
 Re: Petition Number 609 — DPW, City Engineering Division, request to dedicate a public street: Rosa Parks Boulevard from West Grand Boulevard to Atkinson Avenue.

Petition No. 609 — The Department of Public Works — City Engineering Division request to dedicate land for the widening of Rosa Parks Boulevard from 66 feet wide to 120 feet wide, from West Grand Boulevard, 150 feet wide, to Atkinson Avenue, 66 feet wide.

The petition was referred to the City Engineering Division — DPW for investigation (utility clearance) and report. This is our report.

The purpose of this request is to formally dedicate the previously constructed street. The street was realigned and constructed in accordance with plans on file in the City Engineers office dated May 18, 1975. Rosa Parks Boulevard was widened from 66 feet wide to 120 feet wide from West Grand Boulevard to Atkinson Avenue as part of an effort by the Community and Economic Development Department to encourage redevelopment of the area. Part of widening was formally dedicated on November 17, 1993 in conjunction with the new development, the Virginia Park Estates Subdivision.

Background: The renaming of 12th Street to Rosa Parks Boulevard took place by action of City Council on February 11, 1976. The action was taken to recognize the Civil Rights activist Mrs. Rosa Parks a longtime resident of Detroit. All necessary actions to formally rename the street were filed with Wayne County and the State of Michigan by August 4, 1976.

All other city departments and utilities have reported no objections to the proposed right-of-way dedication.

I am recommending adoption of the attached resolution.

Respectfully submitted,  
 RICHARD DOHERTY, P.E.

City Engineer  
 City Engineering Division — DPW

By Council Member Benson:

Resolved, That your Honorable Body authorize the acceptance of the following described properties owned by the City of Detroit for public street purposes:

Rosa Parks widening to 120 feet wide from West Grand Boulevard to Atkinson Avenue being land in the City of Detroit,

Wayne County, Michigan described as follows:

1) A strip of land, 100 feet wide, east of and adjoining the east line of 12th Street, 66 feet wide, now known as Rosa Parks Boulevard described as: All of Lot 214 and the west 28.30 feet on the south line being the west 29.83 feet on the north line of Lot 213 and east-west alley adjoining, and the west 100 feet of Lots 215 through 235 and east-west alley adjoining said part of Lot 215, and including the west 100 feet of the south 18 feet of Lot 233 opened as an alley, all in "Lothrop and Duffield Boulevard Park Subdivision of part of Quarter Section 55 — 10,000 A.T. lying north of West Grand Boulevard, Detroit, Wayne County, Michigan" as recorded in Liber 28, Page 1 of Plats, Wayne County Records.

2) A strip of land, 100 feet wide, east of and adjoining the east line of 12th Street, 66 feet wide, now known as Rosa Parks Boulevard described as: west 100 feet of part of Quarter Section 55, Ten Thousand Acre Tract lying south of and adjoining Pallister Avenue, 70 feet wide, and lying north of and adjoining Bethune Avenue, 60 feet wide, and lying west of and adjoining Rosa Parks, 66 feet wide, included in the said west 100 feet described above is the vacated 7 feet of 12th Street (Now Rosa Parks) vacated on October 27, 1914.

3) A strip of land, 100 feet wide, east of and adjoining the east line of 12th Street, 66 feet wide, now known as Rosa Parks Boulevard described as: all of Lots 1 through 7 and all of Lots 10 through 16, both inclusive, and all of land platted for Park Purposes lying north of and adjoining said Lot 10 and lying south of and adjoining said Lot 7, together with Virginia Park, 80 feet wide, adjoining said land platted for Park Purposes; All in "Virginia Park Re-Subdivision of Lots 1-14 incl. and vacated alleys of Virginia Park Re-Subdivision of Lots 69, 70, 71, 72, 73 & 74 and vacated alleys Virginia Park Subdivision of Part of Quarter Section 55 10,000 Acre Tract, City of Detroit, Wayne County, Michigan" as recorded in Liber 31, Page 77 of Plats, Wayne County Records.

4) A strip of land, 100 feet wide, east of and adjoining the east line of 12th Street, 66 feet wide, now known as Rosa Parks Boulevard described as: all of Lots 52, 53, 54, 55, 56, and 57, and the west 10.00 feet of Lot 51 and the west 10 feet of Lot 58 and public alleys adjoining, and Euclid Avenue, adjoining, all in "The Howell-Mack Euclid Avenue Subdivision of Lots 20 and 21 and southerly 33 feet of westerly 1762.70 feet of 1/4 Section 46, 10,000 A.T., City of Detroit, Wayne County, Michigan" as recorded in Liber 26, Page 22 of Plats, Wayne County Records.

5) A strip of land, 100 feet wide, east of and adjoining the east line of 12th Street, 66 feet wide, now known as Rosa Parks