

**Department of Public Works  
City Engineering Division**

March 25, 2002

Honorable City Council:

Re: Petition No. 3134 (Addendum)  
Detroit Housing Commission, Jeffries Housing Development Phase II (Woodbridge Estates) requesting dedication and naming of new streets.

Petition No. 3134 (Addendum) of the Detroit Housing Commission requests in the second phase to dedicate land and name streets within the Jeffries Housing Development, related to the Hope VI Project (Woodbridge Estates). The first phase of the project included two (2) public alley vacations (adopted by City Council November 30, 2001) in the area bounded by Gibson, W. Alexandrine, Selden and Brooklyn. In order to establish the proposed Condominium Units, which street names will reflect on the "Motown" theme, it is necessary to set-aside land for the dedication of new public streets, widen Selden Avenue and to name the new dedicated streets.

The new dedicated public streets and street widening were approved by the City Engineering Division (CED) DPW/Street Design Bureau and the Traffic Engineering Division of DPW.

City Council is requested to accept the land for public street purposes; provided said property complies with the requirements of Detroit Codes and Ordinance No. 29-94, Detroit Code Sections 2-1-11 through 2-1-15 also known as the Environmental Review Guidelines, also, provided that the streets are built to City of Detroit standard specifications, under CED permits and inspection, with plans reviewed and approved by City Engineering Division — DPW Street Design Bureau and the Traffic Engineering Division of DPW.

Satisfactory arrangements have been made with all City departments and privately owned utility companies.

An appropriate resolution is attached for consideration by your Honorable Body.

Respectfully submitted,  
SUNDAY JAIYESIMI  
City Engineer

City Engineering Division — DPW

By Council Member S. Cockrel:

Resolved, The following Jeffries Housing Development Phase II (Woodbridge Estates) properties, which may include various public rights-of-way, are hereby dedicated for public street purposes:

**1. New Roadway Dedication, FIRST East of Gibson Avenue, between Selden Avenue and West Canfield Avenue.**

A part of Private Claim 24 in the City of Detroit, Wayne County, Michigan being a part of Lots 169 through 176 of "Albert

Crane's Section of the Labrosse and Baker Farms being Lots 34 and 40 inclusive of Wesson's Section of the Labrosse and Baker Farms" as recorded in Liber 1, Page 307 of Plats, Wayne County Records; also a part of Lots 47 through 54 and a part of Lots 71 through 78 of "Albert Crane's Section of the Labrosse and Baker Farms being Lots 20 to 33 inclusive of Wesson's Section of the Labrosse and Baker Farm" as recorded in Liber 1, Page 123 of Plats, Wayne County Records; also a part of Lots 1 through 4 of "Heber Crane's Subdivision of Lots 5, 8 and 11 of Albert Crane's Subdivision of 17, 18 and 19 Wesson's Section of the Labrosse and Baker Farms North of Grand River Road" as recorded in Liber 1, Page 11 of Plats, Wayne County Records; also part of Lots 2, 14, 17 and 20 of "Albert Crane's Subdivision of Lots 17 18 and 19 Wesson's Section of the Labrosse and Baker Farms North of Grand River Road" as recorded in Liber 1, Page 2 of Plats, Wayne County Records; also a part of Lots 36 through 42 of "Shultze Subdivision of Lots 14, 15, 16 and Lots 44, 45 and the East 12 feet of Lot 46 of Wesson's Section of Labrosse and Baker Farms" as recorded in Liber 3, Page 87 of Plats, Wayne County Records; also that part of vacated Calumet Avenue (50 feet wide), vacated Willis Avenue (50 feet wide), vacated Alexandrine Avenue (50 feet wide), vacated Selden Avenue (50 feet wide) and vacated public alleys lying within the bounds of this parcel, more particularly described as:

Commencing at the intersection of the southerly right-of-way line of Canfield Avenue, (60 feet wide), and the easterly right-of-way line of Gibson Avenue (variable width), thence along the southerly right-of-way line of Canfield Avenue N66°49'45"E, 77.27 feet to the point of beginning; thence N66°49'45"E, 60.00 feet; thence S23°14'06"E, 1417.66 feet to the northerly right-of-way line of Selden Avenue; thence along said northerly line S66°54'45"W, 60.00 feet; thence N23°14'06"W, 693.47 feet; thence N66°54'45"E, 1.70 feet; thence N23°37'38"W, 143.00 feet; thence S66°54'45"W, 0.72 feet; thence N23°14'06"W, 581.12 feet to the point of beginning.

**2. New Roadway Dedication, FIRST South of W. Canfield Avenue, between Gibson Avenue and the John C. Lodge Service Drive. (3 Separate Parcels)**

**PARCEL 1**

A part of Private Claim 246 in the City of Detroit, Wayne County, Michigan, being a part of Lots 98, 99, 108, 109 and 124 of "Albert Crane's Section of the Labrosse and Baker Farms being Lots 20 to 33 inclusive of Wesson's Section of the Labrosse and Baker Farms", as recorded

in Liber 1, Page 123 of Plats, Wayne County Records; also a part of Lots 125, 142, 152 and 153 of "Albert Crane's Section of the Labrosse and Baker Farms being Lots 34 and 40 inclusive of Wesson's Section of the Labrosse and Baker Farms," as recorded in Liber 1, Page 307 of Plats, Wayne County Records; also a part of Lots 7, 8 and 9 of "Nicholson's Re Sub of Lots 143 to 150 inclusive of Albert Crane's Section of Lots 34 to 40 of Wesson's Section of Labrosse and Baker Farms," as recorded in Liber 15, Page 99 of Plats, Wayne County Records; also that part of vacated Calumet Avenue (50 feet wide), vacated Sixth Street (50 feet wide) and vacated public alleys lying within the bounds of this parcel, more particularly described as follows:

Commencing at the intersection of the southerly right-of-way line of Canfield Avenue (60 feet wide), and the easterly right-of-way line of Gibson Avenue (variable width), thence N66°49'45"E, 846.56 feet along the southerly right-of-way line of Canfield Avenue to a point on the westerly right-of-way line of the westerly service drive of John C. Lodge Expressway, thence along said westerly line S22°44'42"E, 230.72 feet to the point of beginning; thence along said westerly line S22°44'42"E, 5.78 feet; thence along said westerly line S19°30'33"E, 54.33 feet; thence S66°45'54"W, 356.95 feet; thence N23°14'06"W, 53.94 feet; thence on a curve to the left of length 6.34 feet, radius 92.44 feet, delta 03°55'39" and chord bearing N40°12'31"W, 6.34 feet; thence N66°45'54"E, 362.38 feet to the point of beginning.

#### PARCEL 2

A part of Private Claim 24 in the City of Detroit, Wayne County, Michigan, being part of Lots 71 and 86 of "Albert Crane's Section of the Labrosse and Baker Farms being Lots 20 to 33 inclusive of Wesson's Section of the Labrosse and Baker Farms", as recorded in Liber 1, Page 123 of Plats, Wayne County Records; also a part of Lots 159 and 176 of "Albert Crane's Section of the Labrosse and Baker Farms being Lots 34 to 40 inclusive of Wesson's Section of the Labrosse and Baker Farms," as recorded in Liber 1, Page 307 of Plats, Wayne County Records; also that part of vacated Calumet Avenue (50 feet wide), vacated Brooklyn Avenue (60 feet wide) and vacated public alleys lying within the bounds of this parcel; more particularly described as follows:

Commencing at the intersection of the southerly right-of-way line of Canfield Avenue (60 feet wide), and the easterly right-of-way line of Gibson Avenue (variable width); thence N66°49'45"E, 137.27 feet along the southerly right-of-way line

of Canfield Avenue; thence S23°14'06"E, 231.50 feet to the point of beginning; thence N66°45'54"E, 174.85 feet; thence on a curve to the left of length 7.18 feet, radius 92.44 feet, delta 04°26'55", and chord bearing S06°31'20"E, 7.18 feet; thence S23°14'06"E, 53.13 feet; thence S66°45'54"W, 172.79 feet; thence N23°14'06"W, 60.00 feet to the point of beginning.

#### PARCEL 3

A part of Private Claim 24 in the City of Detroit, Wayne County, Michigan; being a part of Lot 70 of "Albert Crane's Section of the Labrosse and Baker Farms, being Lots 20 to 33, inclusive of Wesson's Section of the Labrosse and Baker Farms", as recorded in Liber 1, page 123 of Plats, Wayne County Records; also a part of Lot 177 of "Albert Crane's Section of the Labrosse and Baker Farms being Lots 34 and 40 inclusive of Wesson's Section of the Labrosse and Baker Farms," as recorded in Liber 1, Page 307 of Plats, Wayne County Records; also that part of vacated Calumet Avenue (50 feet wide) and vacated public alleys lying within the bounds of this parcel; more particularly described as follows:

Commencing at the intersection of the southerly right-of-way line of Canfield Avenue (60 feet wide), and the easterly right-of-way line of Gibson Avenue (variable width); thence S23°03'30"E, 231.83 feet along the easterly right-of-way line of Gibson Avenue to the point of beginning; thence N66°45'54"E, 77.98 feet; thence S23°14'06"E, 60.00 feet; thence S66°45'54"W, 78.17 feet to the easterly right-of-way line of Gibson Avenue, thence along said easterly line N23°03'30"W, 58.43 feet to the point of beginning.

### **3. New Roadway Dedication, SECOND South of W. Canfield Avenue, between Gibson Avenue and the John C. Lodge Service Drive. (3 Separate Parcels)**

#### PARCEL 1

A part of Private Claim 246 in the City of Detroit, Wayne County, Michigan; being a part of Lots 8, 9, 24, 25, 28, 97, 100, 101, 116 and 117 of "Albert Crane's Section of the Labrosse and Baker Farms being Lots 20 to 33, inclusive of Wesson's Section of the Labrosse and Baker Farms," as recorded in Liber 1, Page 123 of Plats, Wayne County Records; also that part of vacated Willis Avenue (50 feet wide), vacated Sixth Street (50 feet wide) and vacated public alleys lying within the bounds of this parcel; more particularly described as follows:

Commencing at the intersection of the southerly right-of-way line of Canfield Avenue (60 feet wide) and the easterly right-of-way of Gibson Avenue (variable width), thence N66°49'45"E, 846.56 feet

along the southerly right-of-way line of Canfield Avenue to point on the westerly right-of-way line of the westerly service drive of John C. Lodge Expressway, thence along said westerly line S22°44'42"E, 236.50 feet; thence along said westerly line S19°30'33"E, 288.80 feet to the point of beginning; thence along said westerly line S19°30'33"E, 60.13 feet; thence S66°45'54"W, 338.65 feet; thence on a curve to the left of length 2.99 feet, radius 88.23 feet, delta 01°58'19", and chord bearing N06°53'08"W, 2.98 feet; thence N23°14'06"W, 57.14 feet; thence N66°45'54"E, 341.71 to the point of beginning.

#### PARCEL 2

A part of Private Claim 24 in the City of Detroit, Wayne County, Michigan; being a part of Lots 46, 47, 78 and 79 of "Albert Crane's Section of the Labrosse and Baker Farms, being Lots 20 to 33, inclusive of Wesson's Section of the Labrosse and Baker Farms",

As recorded in Liber 1, Page 123 of Plats, Wayne County Records; also that part of vacated Willis Avenue (50 feet wide), vacated Brooklyn Avenue (60 feet wide) and vacated public alleys lying within the bounds of this parcel; more particularly described as follows:

Commencing at the intersection of the southerly right-of-way line of Canfield Avenue, (60 feet wide), and the easterly right-of-way line of Gibson Avenue (variable width), thence N66°49'45"E, 137.27 feet along the southerly right-of-way line of Canfield Avenue, thence S23°14'06"E, 525.48 feet to the point of beginning; thence N66°45'54"E, 172.79 feet; thence S23°14'06"E, 60.00 feet; thence S66°45'54"W, 172.79 feet; thence N23°14'06"W, 60.00 feet to the point of beginning.

#### PARCEL 3

A part of Private Claim 24 in the City of Detroit, Wayne County, Michigan; being a part of Lot 63 of "Albert Crane's Section of the Labrosse and Baker Farms, being Lots 20 to 33, inclusive of Wesson's Section of the Labrosse and Baker Farms," as recorded in Liber 1, Page 123 of Plats, Wayne County Records; also that part of vacated Willis Avenue (50 feet wide) and vacated public alley lying within the bounds of this parcel; more particularly described as follows:

Commencing at the intersection of the southerly right-of-way line of Canfield Avenue (60 feet wide), and the easterly right-of-way line of Gibson Avenue (variable width), thence N66°49'45"E, 137.22 feet along the southerly right-of-way line of Canfield Avenue, thence S23°14'06"E, 525.48 feet; thence S66°45'54"W, 60.00 feet to the point of beginning; thence S23°14'06"E, 55.58 feet; thence

S66°54'45"W, 79.06 feet to the easterly right-of-way line of Gibson Avenue, thence along said line N23°03'30"W, 55.37 feet; thence N66°45'54"E, 78.89 feet to the point of beginning.

#### 4. New Roadway Dedication, THIRD South of W. Canfield Avenue, between Gibson Avenue and the John C. Lodge Service Drive. (3 Separate Parcels)

##### PARCEL 1

A part of Private Claim 246, City of Detroit, Wayne County, Michigan being all of Lots 6, 9, 16 and 27, a part of Lots 5, 7, 8, 10, 15, 17, 26, and 28 of "Subdivision of Lots 12 and 13 of Wesson's Subdivision of Labrosse and Baker Farms" as recorded in Liber 1, Page 3 of Plats, Wayne County Records; also that part of vacated Sixth Street (50 feet wide), vacated Norwood Place (40 feet wide) and vacated public alleys lying within the bounds of this parcel, more particularly described as follows:

Commencing at the intersection of the southerly right-of-way line of Canfield Avenue (60 feet wide), and the easterly right-of-way line of Gibson Avenue (variable width); thence N66°49'45"E, 846.56 feet along the southerly line of Canfield Avenue to a point on the westerly right-of-way line of the westerly service drive of the John C. Lodge Expressway; thence along said westerly line S22°44'42"E, 236.50 feet; thence along said westerly line S19°30'33"E, 668.82 feet to the point of beginning; thence along said westerly line S19°30'33"E, 55.12 feet; thence S66°45'54"W, 382.94 feet; thence N23°14'06"W, 55.00 feet; thence N66°45'54"E, 366.52 feet to the point of beginning.

##### PARCEL 2

A part of Private Claim 24 and Private Claim 246 in the City of Detroit, Wayne County, Michigan, being a part of Lots 30 and 31 of "Subdivision of Lots 12 and 13 of Wesson's Subdivision of Labrosse and Baker Farms" as recorded in Liber 1, Page 3 of Plats, Wayne County Records; also all of Lot 18 and a part of Lots 13, 14, 17, 19 and 20 of "Albert Crane's Subdivision of Lots 17, 18 and 19 Wesson's Section of the Labrosse and Baker Farms" as recorded in Liber 1 Page 11 of Plats, Wayne County Records; also that part of vacated Brooklyn Avenue (60 feet wide) and vacated public alleys lying within the bounds of this parcel, more particularly described as follows:

Commencing at the intersection of the southerly right-of-way line of Canfield Avenue (60 feet wide), and the easterly right-of-way line of Gibson Avenue (variable width); thence N66°49'45"E, 137.27 feet along the southerly right-of-way line of Canfield Avenue; thence S23°14'06"E, 904.69 feet to the point of beginning; thence N66°45'54"E, 229.29 feet; thence

S23°14'06"E, 55.00 feet; thence S66°45'54"W, 229.29 feet; thence N23°14'06"W, 55.00 feet to the point of beginning.

#### PARCEL 3

A part of Private Claim 24 in the City of Detroit, Wayne County, Michigan, being a part of Lots 15, 16, 17, 20 and 21 of "Albert Crane's Subdivision of Lots 17, 18 and 19 Wesson's Section of the Labrosse and Baker Farms" as recorded in Liber 1, page 11 of Plats, Wayne County Records; also that part of vacated public alleys lying within the bounds of this parcel being more particularly described as follows:

Commencing at the intersection of the southerly right-of-way line of Canfield Avenue (60 feet wide), and the easterly right-of-way line of Gibson Avenue (variable width); thence N66°49'45"E, 137.27 feet along the southerly right-of-way line of Canfield Avenue; thence S23°14'06"E, 904.69 feet; thence S66°45'54"W, 60.00 feet to the point of beginning; thence S23°14'06"E, 55.00 feet; thence S66°45'54"W, 106.41 feet to the easterly line of Gibson Avenue, thence along said easterly line N23°46'42"W, 55.00 feet; thence N66°45'54"E, 106.93 feet to the point of beginning.

#### 5. New Roadway Dedication, FOURTH South of W. Canfield Avenue, WEST of the John C. Lodge Service Drive.

A part of Private Claim 246 in the City of Detroit, Wayne County, Michigan, being a part of Lots 3, 4 and 7 through 12 of "Heber Crane's Section of the Labrosse Farm being a subdivision of Lots 9, 10 and 11 Wesson's Section of the Labrosse and Baker Farms North of the Grand River Road, Detroit, Michigan", as recorded in Liber 1, Page 3 of Plats, Wayne County Records; also that part of vacated Frank Street (50 feet wide), vacated Sixth Street (50 feet wide) and vacated public alleys lying within the bound of this parcel; more particularly described as follows:

Commencing at the intersection of the southerly right-of-way line of Canfield Avenue, (60 feet wide), and the easterly right-of-way line of Gibson Avenue (variable width), thence along the southerly right-of-way line of Canfield Avenue N66°49'45"E, 846.56 feet to a point on the westerly right-of-way line of the westerly service drive of the John C. Lodge Expressway; thence along said westerly right-of-way line S22°44'42"E, 236.50 feet; thence along said westerly line S19°30'33"E, 909.35 feet to the point of beginning; thence along said westerly line S19°30'33"E, 55.12 feet; thence S66°45'54"W, 347.31 feet; thence N23°14'06"W, 55.00 feet; thence N66°45'54"E, 350.89 feet to the point of beginning.

#### 6. New Roadway Dedication, FIRST west of the John C. Lodge Service Drive.

A part of Private Claim 246 in the City of Detroit, Wayne County, Michigan, being a part of Lot 8 of "Subdivision of Lots 12 and 13 of Wesson's Subdivision of Labrosse and Baker Farms", as recorded in Liber 1, Page 3 of Plats, Wayne County Records; also a part of Lots 9 through 16 inclusive of "Albert Crane's Section of the Labrosse and Baker Farms, being Lots 20 through 33 inclusive of Wesson's Section of the Labrosse and Baker Farms, as recorded in Liber 1, page 123 of Plats, Wayne County Records; also that part of vacated Sixth Street (50 feet wide) and vacated Alexandrine Avenue (50 feet wide) lying within the bounds of this parcel; more particularly described as follows:

Commencing at the intersection of the southerly right-of-way line of Canfield Avenue (60 feet wide), and the easterly right-of-way line of Gibson Avenue (variable width), thence along the southerly right-of-way line of Canfield Avenue N66°49'45"E, 846.56 feet to a point on the westerly right-of-way line of the westerly service drive of the John C. Lodge Expressway; thence along said westerly line S22°44'42"E, 236.50 feet; thence along said westerly line S19°30'33"E, 348.93 feet; thence S66°45'54"W, 112.83 feet to the point of beginning; thence S23°14'06"E, 319.21 feet; thence S66°45'54"W, 55.00 feet; thence N23°14'06"W, 319.21 feet; thence N66°45'54"E, 55.00 feet to the point of beginning.

#### 7. New Roadway Dedication, FIRST west of the John C. Lodge Service Drive.

A part of Private Claim 246 in the City of Detroit, Wayne County, Michigan, being all of Lots 156 and 188 and a part of Lots 153, 154, 155, 157, 158 and 187 of "Albert Crane's Section of the Labrosse and Baker Farms, being Lots 34 and 40 inclusive of Wesson's Section of the Labrosse and Baker Farms", as recorded in Liber 1, Page 307 of Plats, Wayne County Records; also all of Lots 31 through 34 inclusive, 87 through 96 inclusive, a part of Lots 28, 29, 30, 35, 36, 37, 97 and 98 of "Albert Crane's Section of Labrosse and Baker Farms, being Lots 20 to 33, inclusive of Wesson's Section of the Labrosse and Baker Farms", as recorded in Liber 1, Page 123 of Plats, Wayne County Records; also part of Lots 29 through 35 inclusive of "Subdivision of Lots 12 and 13 of Wesson's Subdivision of Labrosse and Baker Farms," as recorded in Liber 1, Page 3 of Plats, Wayne County Records; also all of Lots 14 and 19, parts of Lots 15, 18 and 20 of "Heber Crane's Section of the Labrosse Farm,

being a subdivision of Lots 9, 10 and 11 Wesson's Section of the Labrosse and Baker Farms, North of the Grand River Road", as recorded in Liber 1, Page 3 of Plats, Wayne County Records; also all of Lot 14 and part of Lots 13 and 15 of "D. Griffins Subdivision of Lot 8 of Wesson's Section of the Labrosse and Baker Farms North of the Grand River Road," as recorded in Liber 6, Page 48 of Plats, Wayne County Records, also that part of vacated Calumet Avenue (50 feet wide); vacated Willis Avenue (50 feet wide); vacated Alexandrine Avenue (50 feet wide); vacated Norwood Place (40 feet wide); vacated Frank Street (50 feet wide); and vacated public alleys lying within the bounds of this parcel, more particularly described as follows:

Commencing at the intersection of the southerly right-of-way line of Canfield Avenue, (60 feet wide), and the easterly right-of-way line of Gibson Avenue (variable width), thence along the said southerly line of Canfield Avenue N66°49'45"E, 352.09 feet to the point of beginning; thence N66°49'45"E, 82.17 feet; thence S21°49'45"W, 6.64 feet; thence S23°14'06"E, 170.83 feet; thence on a curve to the right of length 85.32 feet, radius 92.44 feet, delta 50°37'34" (chord bearing S64°41'13"E, 82.33 feet); thence S23°14'06"E, 345.05 feet; thence on a curve to the right of length 78.29 feet, radius 88.23 feet, delta 50°50'43" (chord bearing S17°34'04"W, 75.75 feet); thence S23°14'06"E, 778.47 feet to the northerly line of Selden Avenue, thence along said northerly line S66°49'45"W, 75.00 feet; thence N23°14'06"W, 778.43 feet; thence on a curve to the right of length 75.42 feet, radius 92.44 feet, delta 46°44'53" (chord bearing N65°34'21"W, 73.50 feet); thence N23°14'06"W, 347.30 feet; thence on a curve to the right of length 85.93 feet, radius 92.44 feet, delta 53°15'45" (chord bearing N17°53'04"E, 82.87 feet); thence N23°14'06"W, 163.21 feet; thence N68°10'15"W, 17.65 feet to the point of beginning, excluding the following: S23°14'06"E, 264.74 feet; thence on a curve to the right of length 69.12 feet, radius 22.00 feet, delta 180°00'00"E (chord bearing N66°45'54"E, 44.00 feet); thence N23°14'06"W, 261.89 feet; thence on a curve to the right of length 69.12 feet, radius 22.00 feet, delta 180°00'00" (chord bearing S66°45'52"W, 44.00 feet); and be it further

Resolved, That seven new public street rights-of-way, dedicated (roadways) in this resolution, are hereby named as follows:

1. "Aretha Avenue" — The north-south public street (60 feet wide; first east of Gibson Avenue) adjoining Selden Avenue and West Canfield Avenue; also

2. "Four Tops Drive" — The east-west public street (60 feet wide; first south of W. Canfield Avenue) adjoining Gibson

Avenue and the John C. Lodge Service Drive.

3. "Temptation Lane" — The east-west public street (variable width; second south of W. Canfield Avenue) adjoining Gibson Avenue and the John C. Lodge Service Drive.

4. "Contour Lane" — The east-west public street (generally 55 feet wide; third south of W. Canfield Avenue) adjoining Gibson Avenue and the John C. Lodge Service Drive.

5. "Reeves Road" — The east-west public street (generally 55 feet wide; fourth south of W. Canfield Avenue) adjoining proposed new street No. 7 and the John C. Lodge Service Drive.

6. "Payne Place" — The north-south public street (55 feet wide; first west of the John C. Lodge Service Drive) adjoining proposed Temptation Lane and proposed Contour Lane.

7. "Miracle Boulevard" — The north-south public street (variable width; second east of Gibson Avenue) adjoining Selden Avenue and West Canfield Avenue; and be it further

Resolved, The following described Jeffries Housing Development Phase II (Woodbridge Estates) properties are hereby dedicated for public street purposes (the widening of a portion of Gibson and Selden Avenues):

#### **Gibson Avenue widening:**

A part of Private Claim 24 in the City of Detroit, Wayne County, Michigan being a part of Lots 177 through 184 of "Albert Crane's Section of the Labrosse and Baker Farms being Lots 34 and 40 inclusive of Wesson's Section of the Labrosse and Baker Farms" as recorded in Liber 1, Page 307 of Plats, Wayne County Records; also a part of Lots 63 through 70 of "Albert Crane's Section of the Labrosse and Baker Farms being Lots 20 to 33 inclusive of Wesson's Section of the Labrosse and Baker Farm" as recorded in Liber 1, Page 123 of Plats, Wayne County Records; also that part of vacated Calumet Avenue (50 feet wide), vacated Willis Avenue (50 feet wide) and vacated public alleys lying within the bounds of this parcel, more particularly described as follows:

Commencing at the intersection of the southerly right-of-way line of Canfield Avenue, (60 feet wide) and the easterly right-of-way line of Gibson Avenue (variable width), thence along the southerly right-of-way line of Canfield Avenue N66°49'45"E, 15.65 feet; thence S23°03'30"E, 581.01 feet to the southerly right-of-way line of Willis Avenue; thence along said southerly line S66°54'45"W, 12.22 feet to the easterly right-of-way line of Gibson Avenue; thence along said easterly line N23°37'39"W, 344.75 feet; thence S67°11'00"W, 1.00 foot; thence

N22°49'00"W, 236.25 feet to the point of beginning.

**Selden Avenue widening:**

A part of Private Claim 24 and 246 in the City of Detroit, Wayne County, Michigan, being a part of Lots 8 and 15 through 21 inclusive of "Plat of Subdivision of Lots 1, 2, 3 and 4 of Wesson's Section of the Labrosse and Baker Farms", as recorded in Liber 57, Page 3 of Plats, Wayne County Records; also part of Lots 1, 6 and 7 of "Plat of the Subdivision of Lot 5, Wesson's Section of the Labrosse and Baker Farms", as recorded in Liber 1, Page 42 of Plats, Wayne County Records; also parts of Lots 19, 20 and 21 of "Plat of Subdivision of Lots 6 and 7 of Wesson's Section of the Labrosse and Baker Farms", as recorded in Liber 65, Page 202 of Plats, Wayne County Records; also that part of vacated Selden Avenue (50 feet wide); vacated Brooklyn Avenue (60 feet wide); vacated Sixth Avenue (40 feet wide) and vacated public alleys within the bounds of this parcel, more particularly described as follows:

Commencing at the intersection of the southerly right-of-way line of Canfield Avenue, (60 feet wide), and the easterly line of Gibson Avenue (variable width); thence S23°03'30"E, 581.01 feet; thence N66°54'45"E, 79.78 feet; thence S23°37'38"E, 143.00 feet; thence S66°54'45"W, 92.00 feet; thence S23°40'46"E, 152.28 feet along the east-

erly line of Gibson Avenue; thence along said easterly line S66°54'44"W, 18.08 feet; thence along said easterly line S23°46'42"E, 441.23 feet; thence N66°54'45"E, 44.75 feet; thence N23°46'42"W, 20.00 feet; thence N66°54'45"E, 53.00 feet; thence S23°46'42"E, 120.00 feet to the point of beginning; thence N66°54'45"E, 707.35 feet; thence S24°24'24"E, 50.45 feet; thence S23°47'12"E, 4.57 feet; thence S66°54'45"W, 805.08 feet; thence N23°35'45"W, 55.00 feet; thence N66°54'45"E, 97.00 feet to the point of beginning; and be it further

Provided, That all taxes with respect to property of which the Dedication Area is a part shall be paid and proof thereof furnished to the Law Department; and

Provided, That proof of compliance with Detroit Ordinance No. 29-94, Detroit Code Sections 2-1-11 through 2-1-15 also known as the Environmental Review Guidelines, is furnished to the Law Department; and

Provided, The streets are built to City of Detroit standard specifications, under City Engineering Division — DPW permits and inspection, with plans reviewed and approved by the City Engineering Division — DPW Street Design Bureau and the Traffic Engineering Division of DPW, and

Provided, That the City Clerk shall within 30 days record a certified copy of this resolution with the Wayne County Register of Deeds.

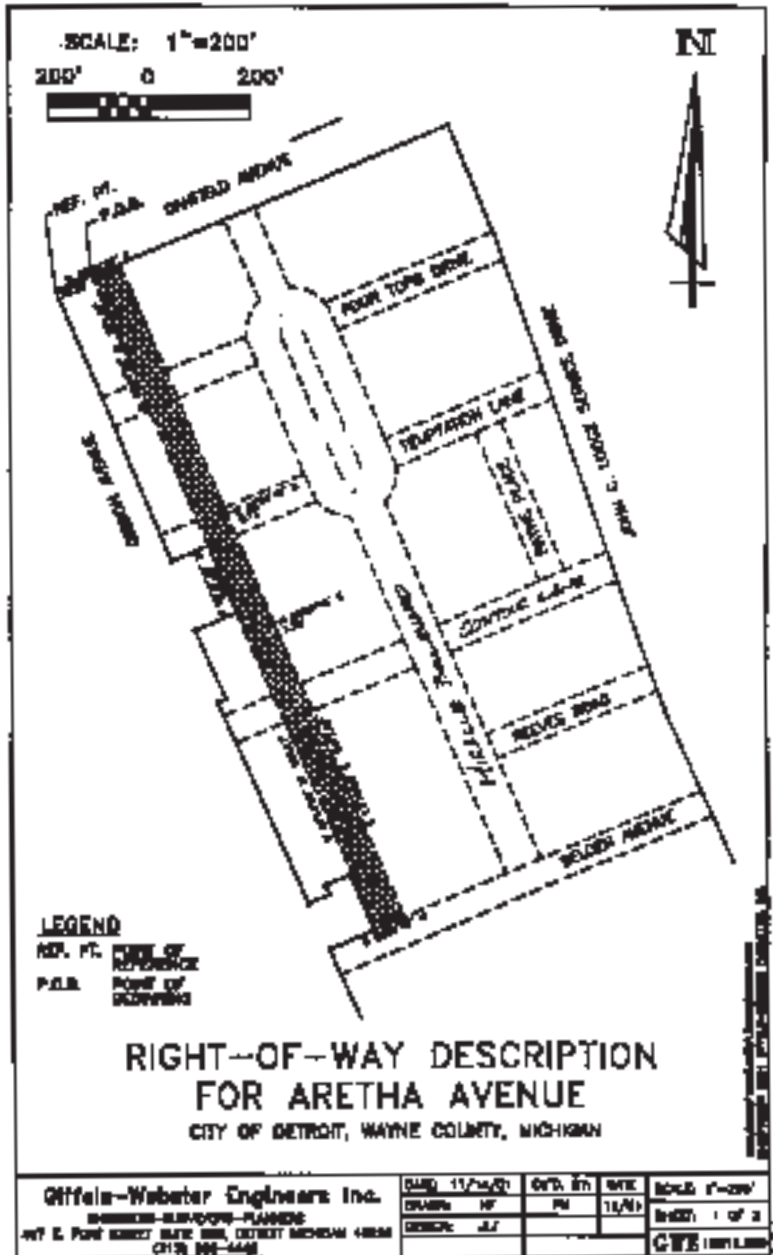

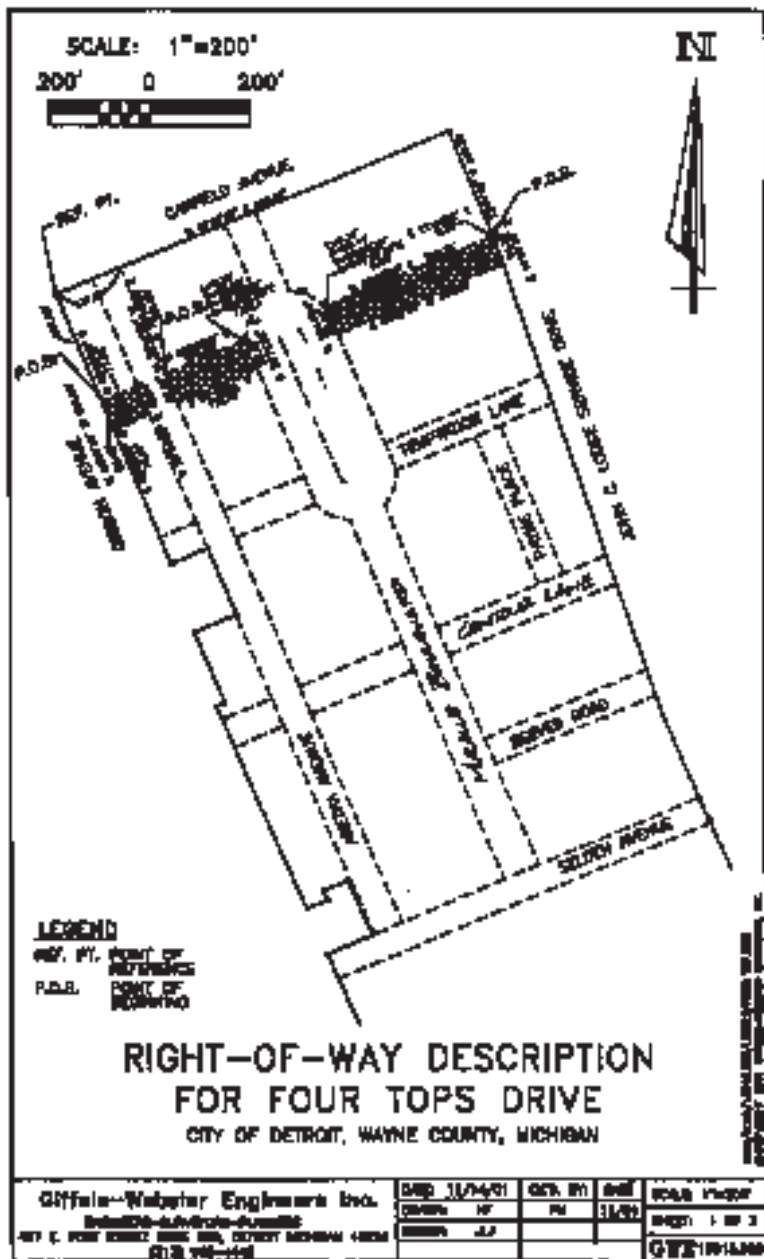



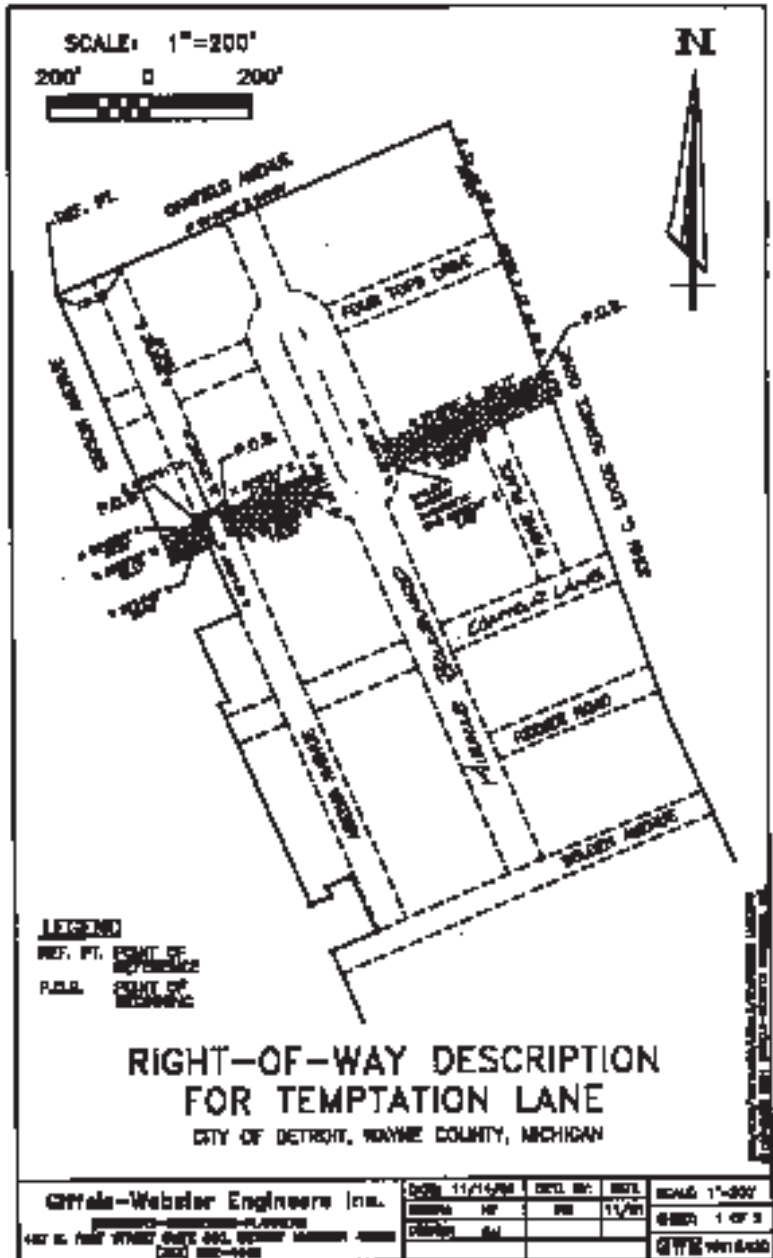

**Coffey-Webster Engineers Inc.**  
 ENGINEERING-PLANNING  
 487 E. FIVE SEVEN STREET SUITE 200, DETROIT MICHIGAN 48226  
 (313) 522-9922

DATE: 11/15/98	DRAWN BY: BRL	SCALE: 1"=200'
CHECKED BY: JPB	DATE: 11/21	SHEET: 1 OF 3
PROJECT: 841		CITY OF DETROIT

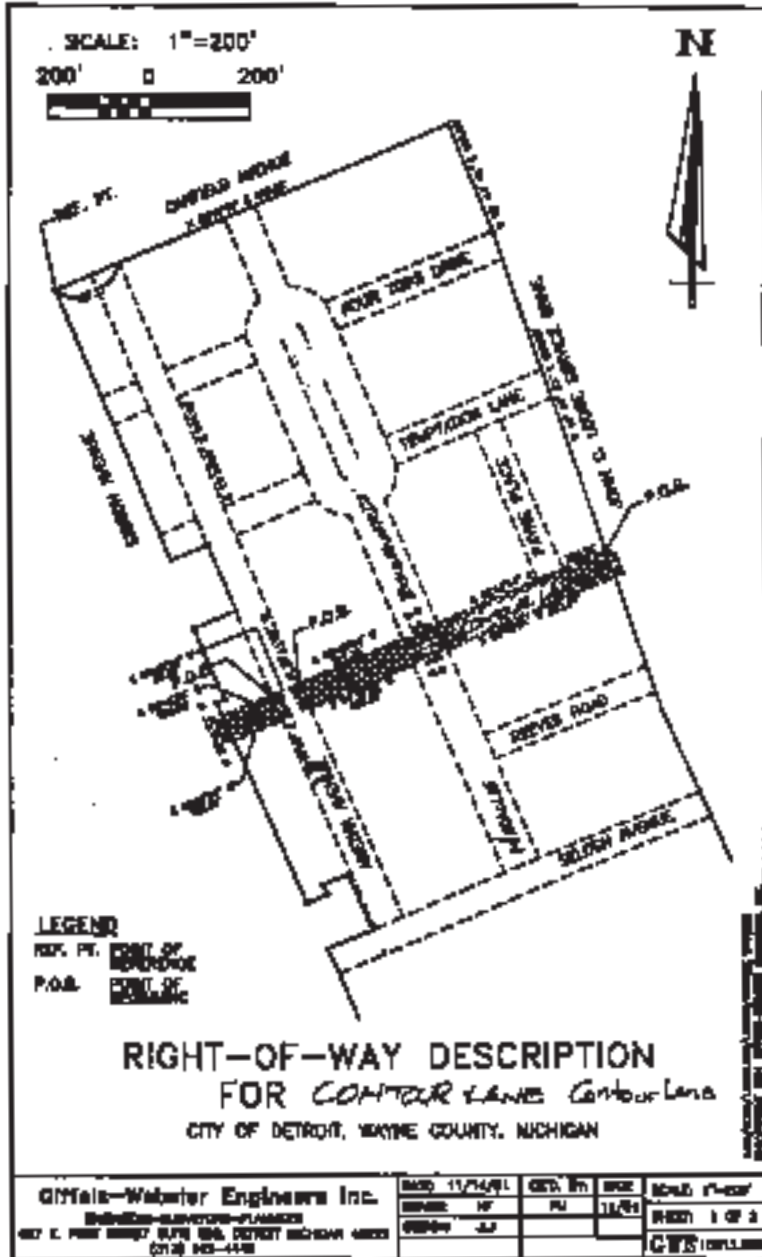

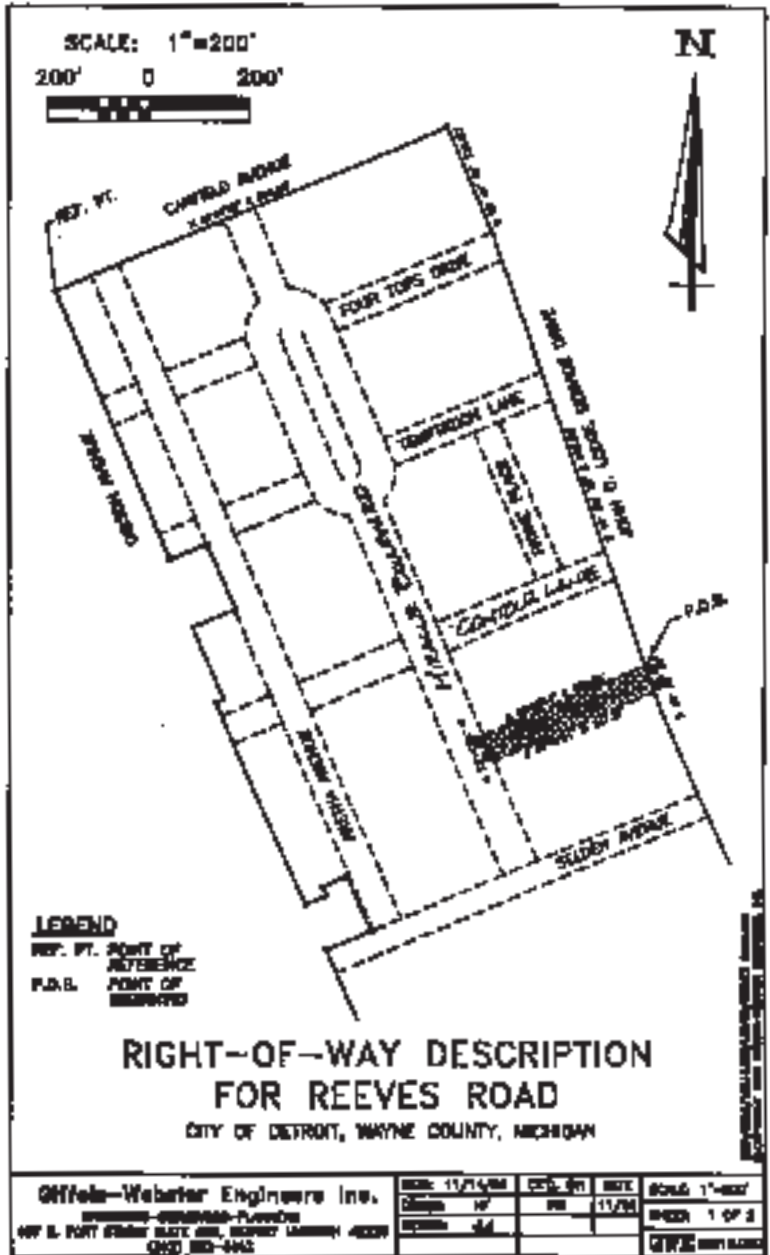

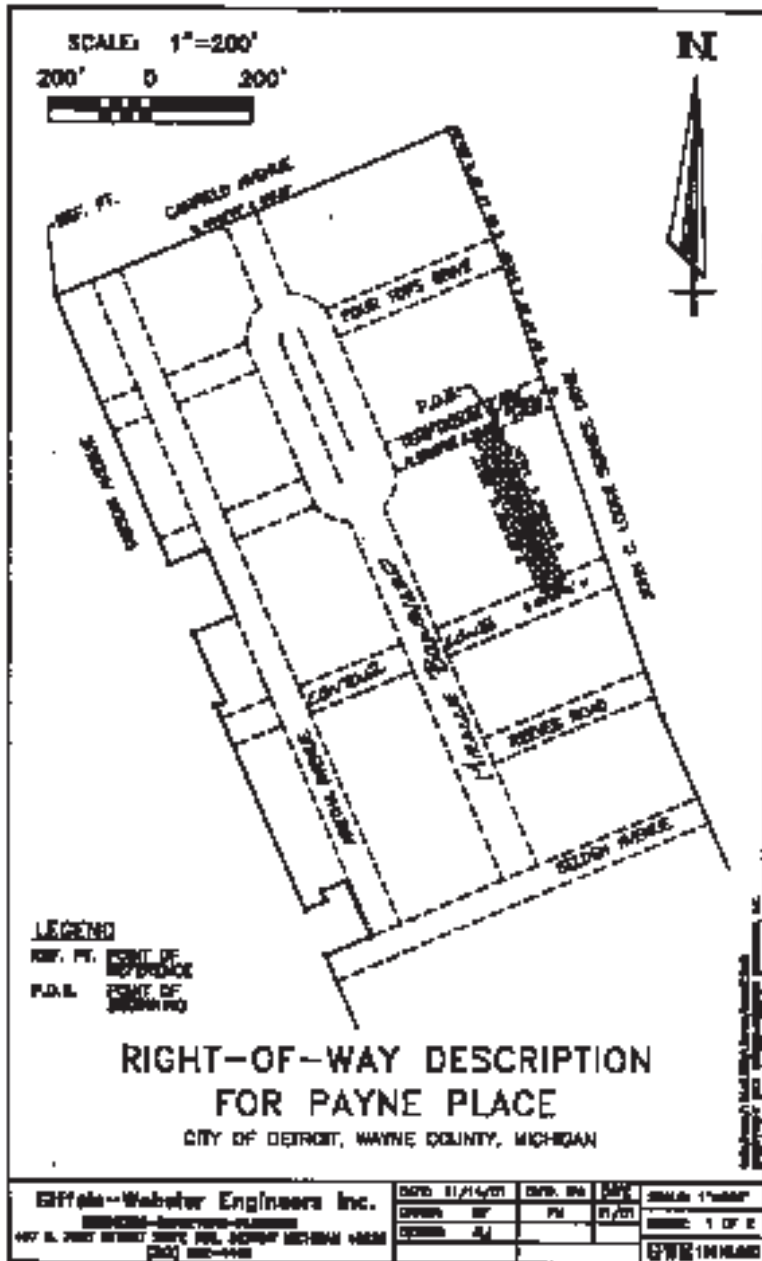

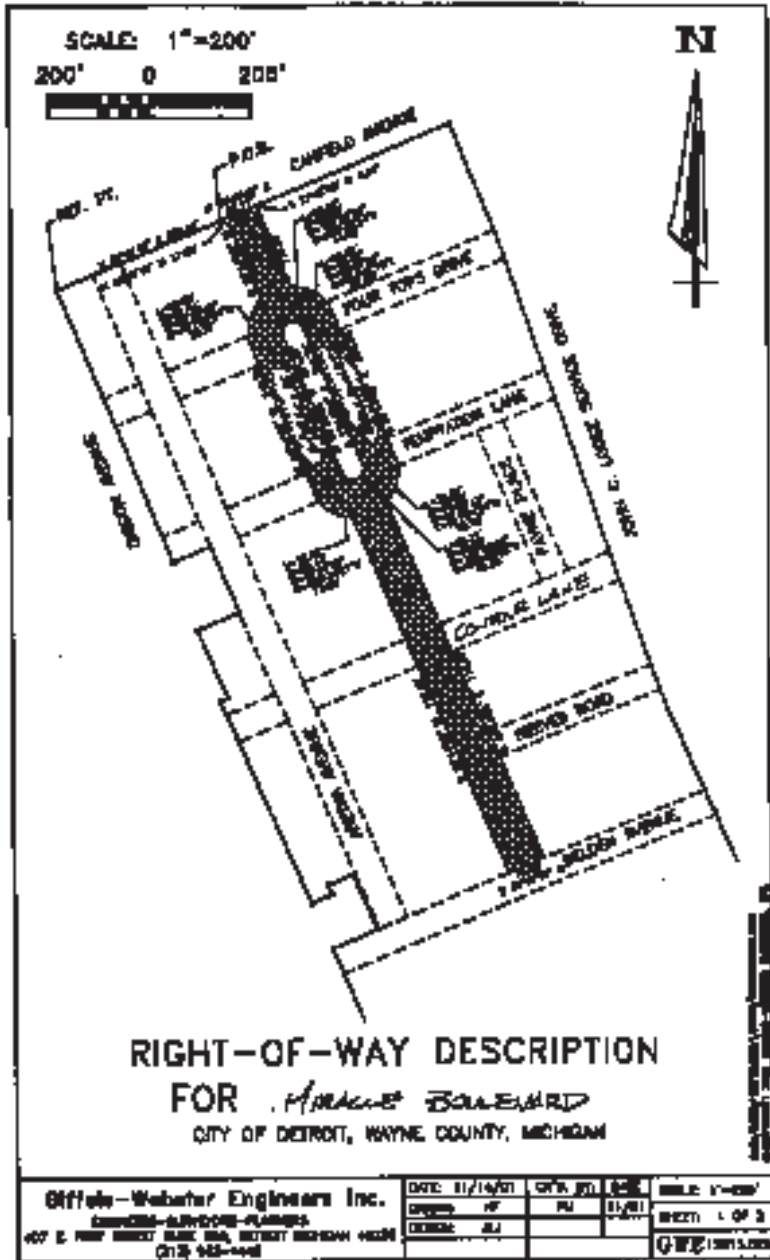

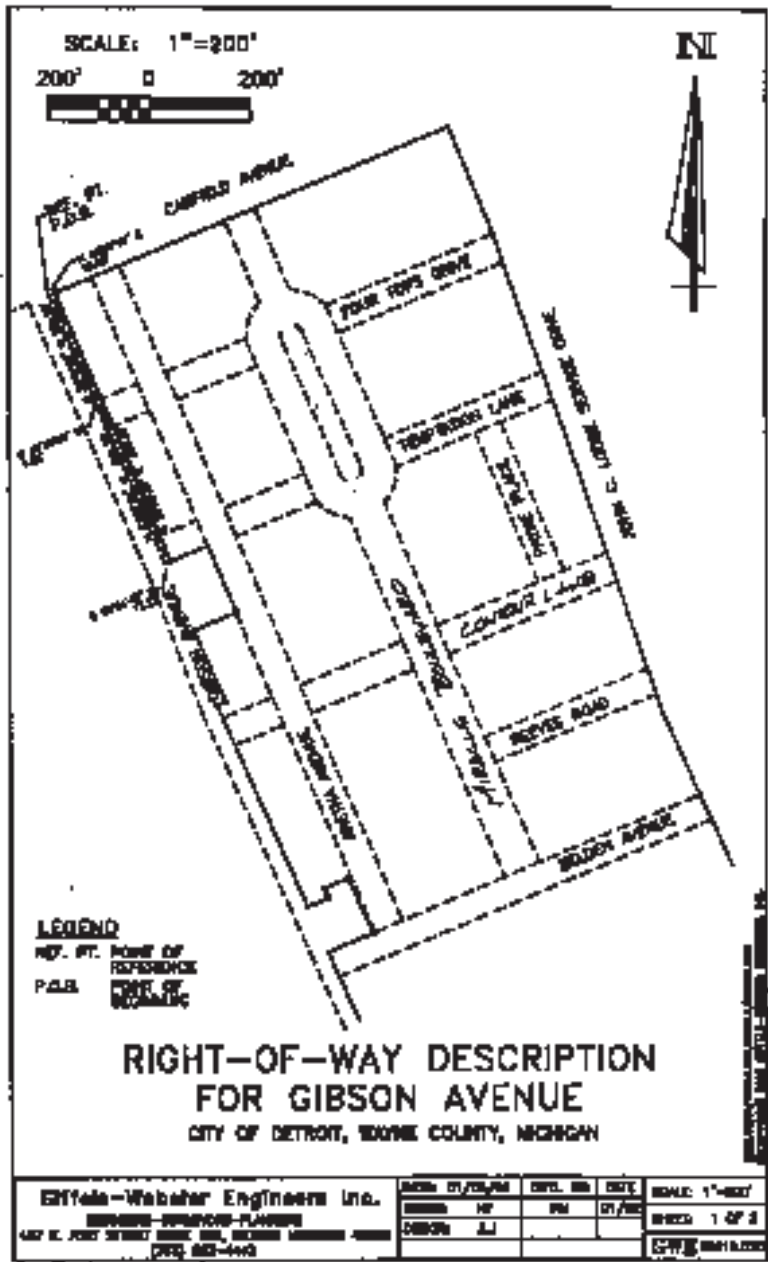

**LEGEND**  
 REF. PT. POINT OF REFERENCE  
 P.O.B. POINT OF BEGINNING

**RIGHT-OF-WAY DESCRIPTION  
 FOR GIBSON AVENUE  
 CITY OF DETROIT, WAYNE COUNTY, MICHIGAN**

<b>Entfeldt-Webster Engineers Inc.</b> ENGINEERS-DRAWNERS-PLANNERS 447 E. FORT STREET DETROIT, MICHIGAN 48226-4400 (313) 962-4400	DRAWN BY/DATE J.L./	DESIGNED BY J.L.	DATE 07/92	SCALE: 1"=200' SHEET 1 OF 2 CITY OF DETROIT
	CHECKED BY J.L.	DATE 07/92	PROJECT NO. 92-001	SHEET NO. 1 OF 2

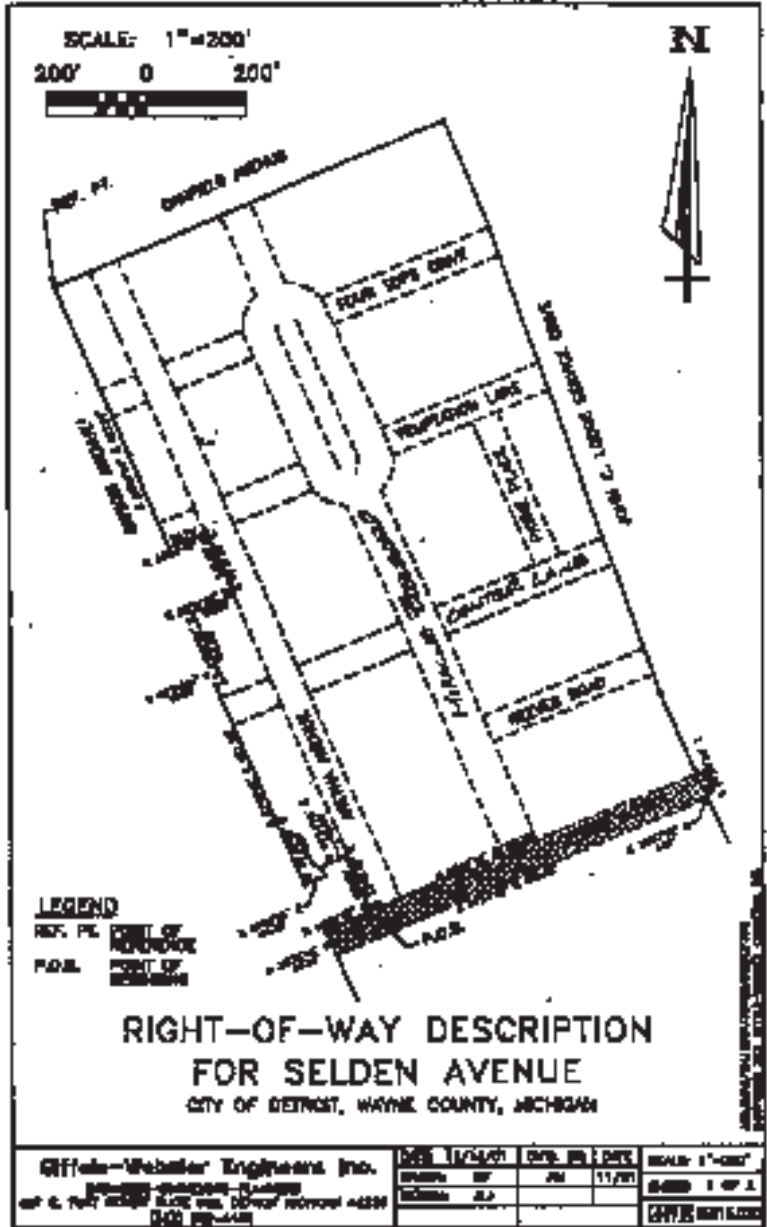

Adopted as follows:

Yeas — Council Members Bates, K. Cockrel, Jr., S. Cockrel, Collins, Everett, McPhail, Scott, Tinsley-Talabi, and President Mahaffey — 9.  
 Nays — None.

**REPORTS OF THE  
 COMMITTEE OF THE WHOLE  
 WEDNESDAY, MARCH 27th**  
 Council Member K. Cockrel, Jr., submit-

ted the following Committee Report for the above date and recommended its adoption.

**Permit**

Honorable City Council:

To your Committee of the Whole was referred petition of Vistas Neugas Head Start (#099), for parade. After consultation with the concerned departments and careful consideration of the request, your