

SIX MILE ROAD

VAUGHAN AVE. TO SOUTHFIELD RD.

TYPICAL CROSS-SECTION

BUTT JOINT

The Butt Joint shall be prepared by sawing through the total thickness of asphaltic concrete surfacing.

JOINT LEGEND

- B MSHD Std Plan E-4A-33 F Detail #2
- D MSHD Std Plan E-4A-33 F Detail #1
- B-D Optional B or D Joint
- C MSHD Std Plan E-4A-33 F Detail #6
- E MSHD Std Plan E-4A-33 F Detail #7
- U Transverse Weakened Plane Joint for Concrete Base Course - W/CRC Std Plan C-17-2A

Note: Unless otherwise shown on Plans, Transverse Weakened Plane Joints shall be placed at 25 intervals

GENERAL NOTES

The location of all Public Utilities is taken from the best available data. The Board of Wayne County Road Commissioners will not be responsible for any omissions or variations from the locations shown. Before starting construction the Contractor shall check with the Utilities the location of existing facilities whether or not shown on the Plans. Any casting damaged by the Contractor at his own expense shall be replaced by the Contractor at his own expense. The Board of Wayne County Road Commissioners will furnish drainage structure castings for the Contractor's track at the Board's location in the City of Detroit. The removal of vertical tile catch basins and sewer traps to existing manholes and catch basins shall be considered as incidental to the work of sewer construction. The removal of manholes, catch basins, inlets shall be considered as incidental to the work of Earth Excavation, Pavement removal and replacement where required shall be paid for as "Pavement Removal" and "9" Concrete Base and AC Surfacing of 9" Conc. Pavt." Adjusting to grade all public utility structure castings except water will be done by others. The edge of existing pavement shall be cleaned of earth or other foreign material with a wire broom. All street return man' shall be 20' Use 2 1/2' radius curve each side of concrete driveway at back of curb.

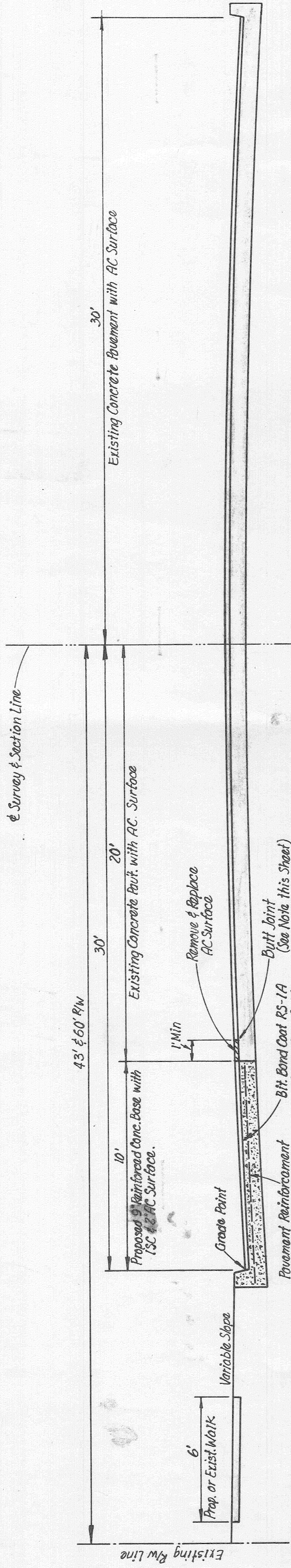

WESTMORELAND TO SOUTHFIELD

SCALE 1" = 4'-0"

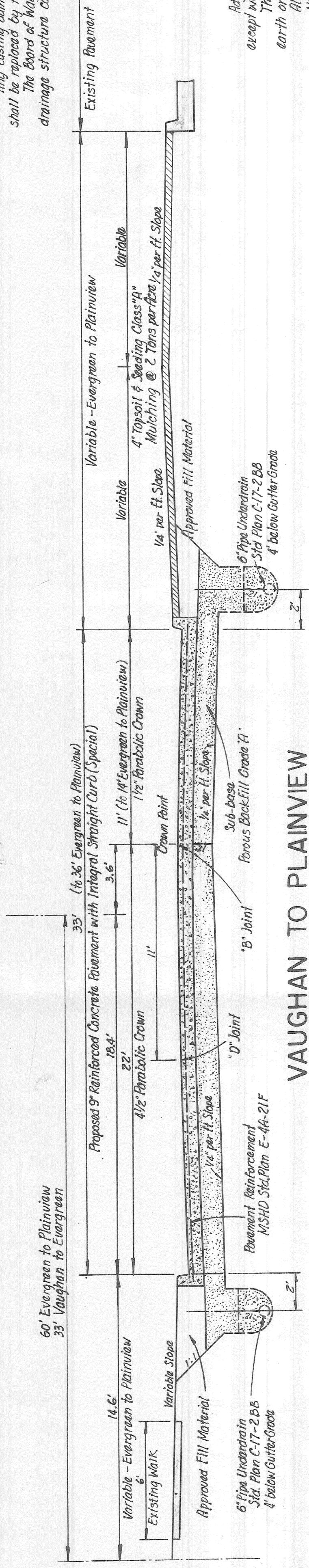

VAUGHAN TO PLAINVIEW

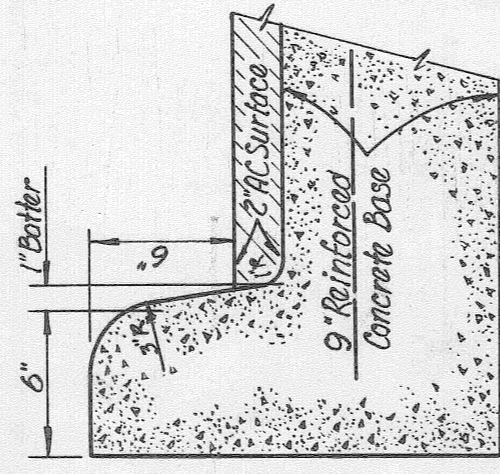

INTEGRAL STRAIGHT CURB TYPE A

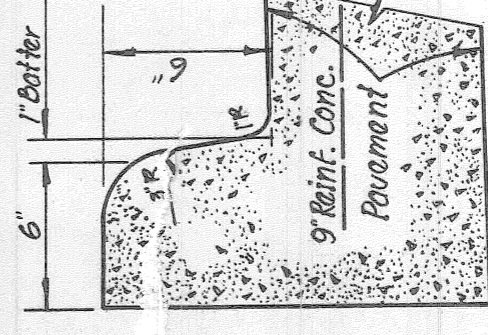

INTEGRAL STRAIGHT CURB TYPE A

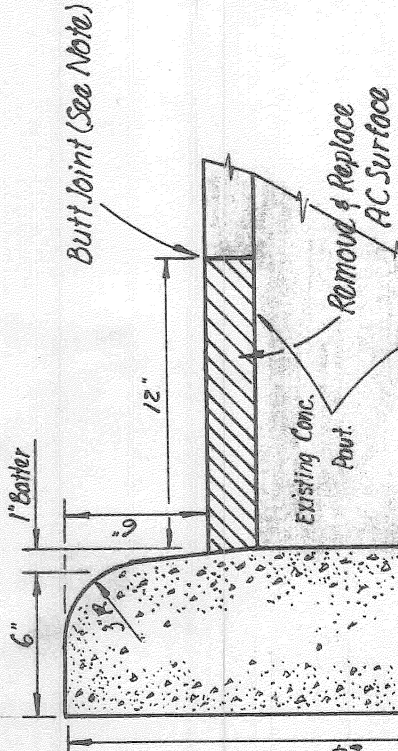

SIX MI

MILE RD
 FIELD TO
 AUGHAN

END HEADER

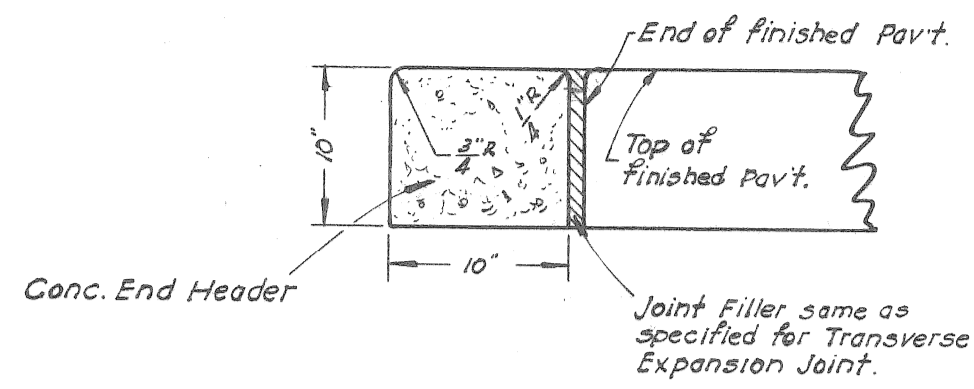

Place Conc. End Headers at all street returns not meeting exist. conc. or where directed by the Engineer.

**SIX MILE ROAD
GRAND RIVER TO WESTMORELAND
1956 CONSTRUCTION
TYPICAL CROSS-SECTION**

SCALE: 1" = 4'

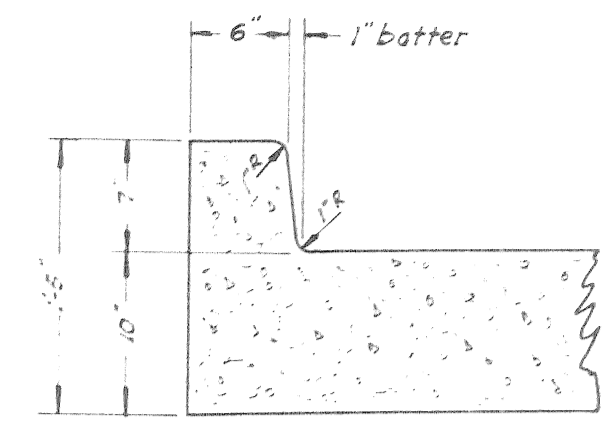

INTEGRAL STRAIGHT CURB

SCALE: 1" = 1'

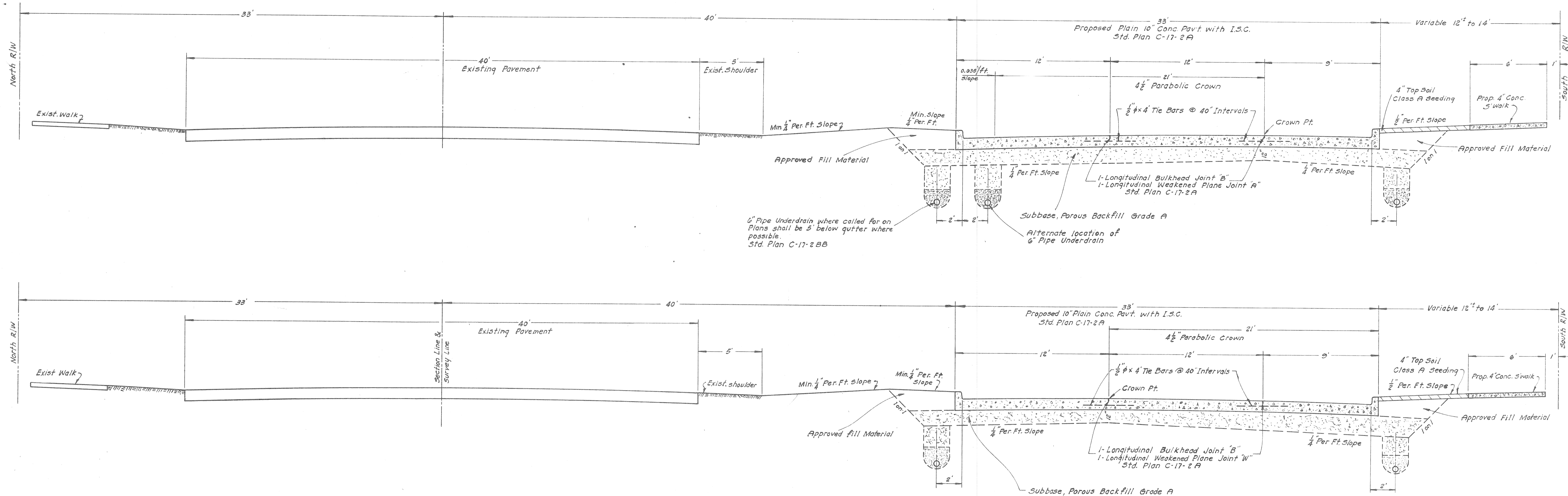

Remove & Replace A.C. Surf. 1' or as directed by the Engineer

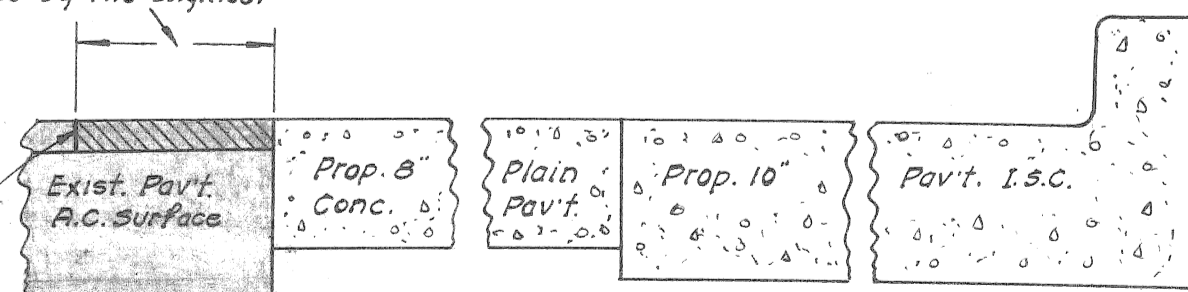

BUTT JOINT: The Butt Joint shall be prepared by sawing through total depth of A.C. Surfacing.

GENERAL NOTES

The location of all Public Utilities shown on these Plans is taken from the best available data. The Board of Wayne County Road Commissioners will not be responsible for omissions or variations from the locations shown. Before starting construction the contractor shall check with the Utilities the location of existing structures whether or not indicated on plans. Any existing castings damaged by the Contractor in the course of work shall be replaced by the Contractor at his own expense. The removal of fence and Vertical tile C.B. shall be considered as incidental to the work of Earth Excavation.

PLAINVIEW TO WESTMORELAND

1956 Proj. 1

CORRECT:	_____	REG. PROF. ENG.
	Engineer of Highway Design	
APPROVED:	_____	REG. PROF. ENG.
	Engineer of Highways	

PLAN SURVEYED PLOTTED
 NOTE BOOK (CHECKED) CHECKED
 No. DATE BY

PROFILE SURVEYED PLOTTED
 NOTE BOOK (CHECKED) CHECKED
 No. DATE BY

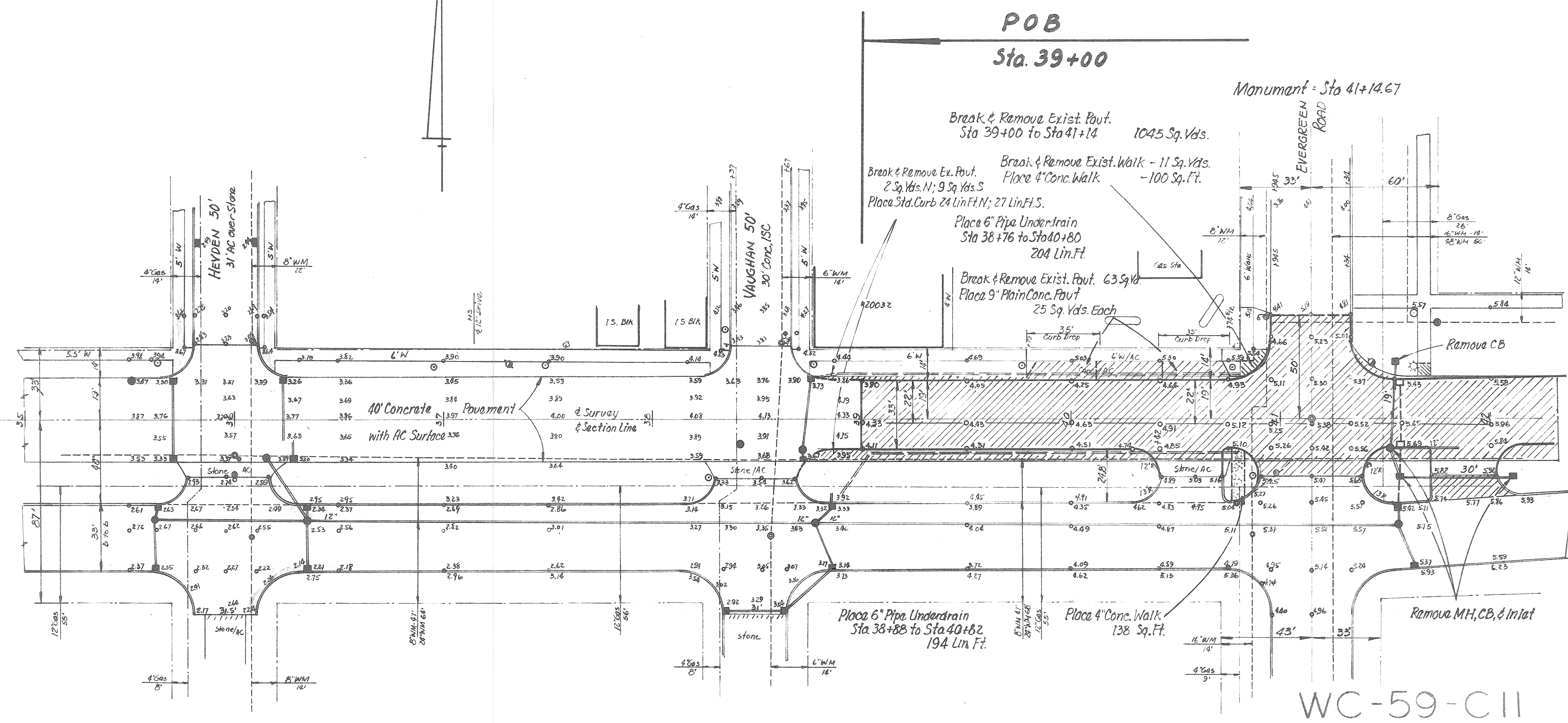

Handwritten note: 5' Sandstone
 2' Soil from below

REVISIONS							
NO.	ITEM	BY	DATE	NO.	ITEM	BY	DATE

BOARD OF WAYNE COUNTY ROAD COMMISSIONERS
 DETROIT 26, MICHIGAN
 CHAIRMAN VICE-CHAIRMAN
 COMMISSIONER

SCALE 1" = 40'
 DATE April '33
 TRANSIT BOOK 7-15-9
 LEVEL BOOK L-15-13
 DRAWN BY GIBBETT
 CHECKED BY [Signature]
 APPROVED [Signature]
 APPROVED [Signature]

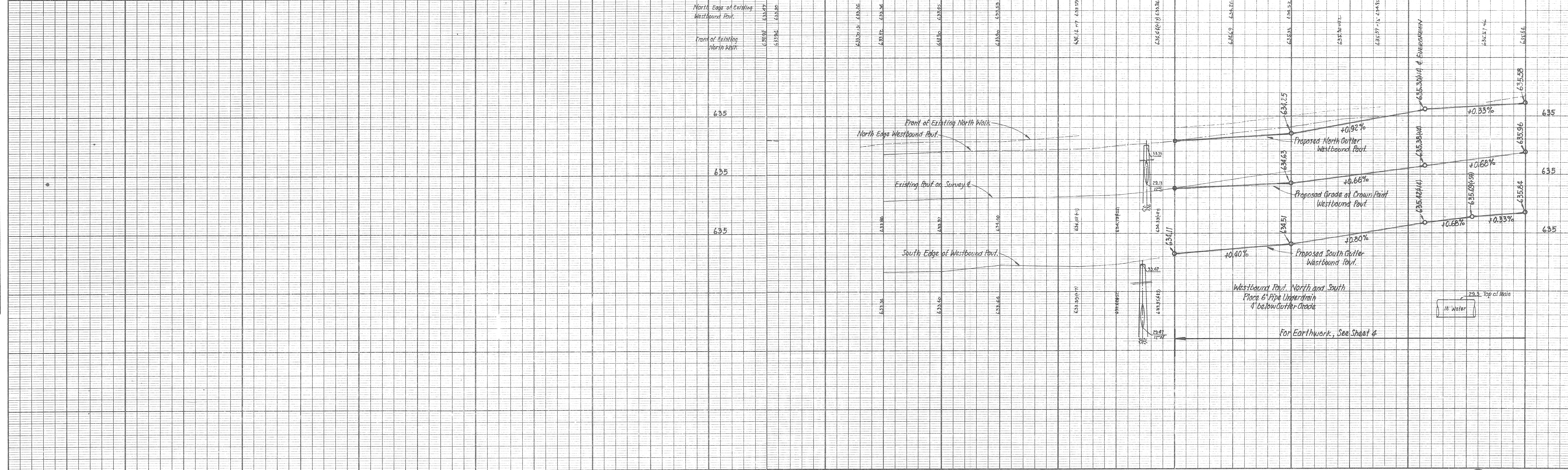

BM#7 Elev. 636.34
 "Dot" on Hydrant NE Corner
 VAUGHAN & SIX MILE

BM#9 Elev. 636.59
 Horiz Spike South side Signal
 Guy Pole NE Corner EVERGREEN
 24' Lt; Sta 41+67

BM#B Elev. 636.70
 SE Corner of Step
 walk at Church
 in walk 15' back of
 entrance Sta 45+30, Lt.

BM#C Elev. 639.74
 Horiz Spike N Side 19' Elm N.W.
 Corner ANNCHESTER, Sta 40+26, 47' Lt.

PLAN	SURVEYED	DATE
NOTE BOOK	ALIGNED	CHECKED
BY	BY	BY
No.	No.	No.

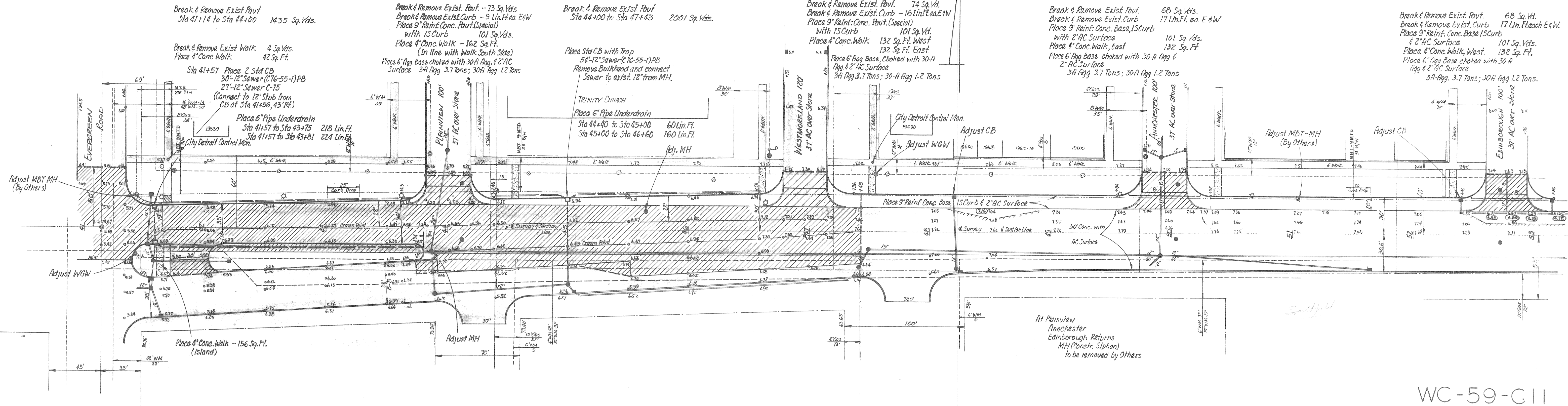

WC-59-C11

REVISIONS					
NO.	ITEM	BY	DATE	NO.	ITEM

BOARD OF
 WAYNE COUNTY ROAD COMMISSIONERS
 DETROIT 26, MICHIGAN

CHAIRMAN: _____
 VICE-CHAIRMAN: _____
 COMMISSIONER: _____

SCALE
 1" = 40'

DATE
 April 59

TRANSIT BOOK
 T-15-9

LEVEL BOOK
 L-15-13

SIX MILE ROAD

DRAWN BY: _____
 CHECKED BY: _____

APPROVED: _____

PROFILE	SURVEYED	DATE
NOTE BOOK	GRADES CHECKED	CHECKED
BY	BY	BY
No.	No.	No.

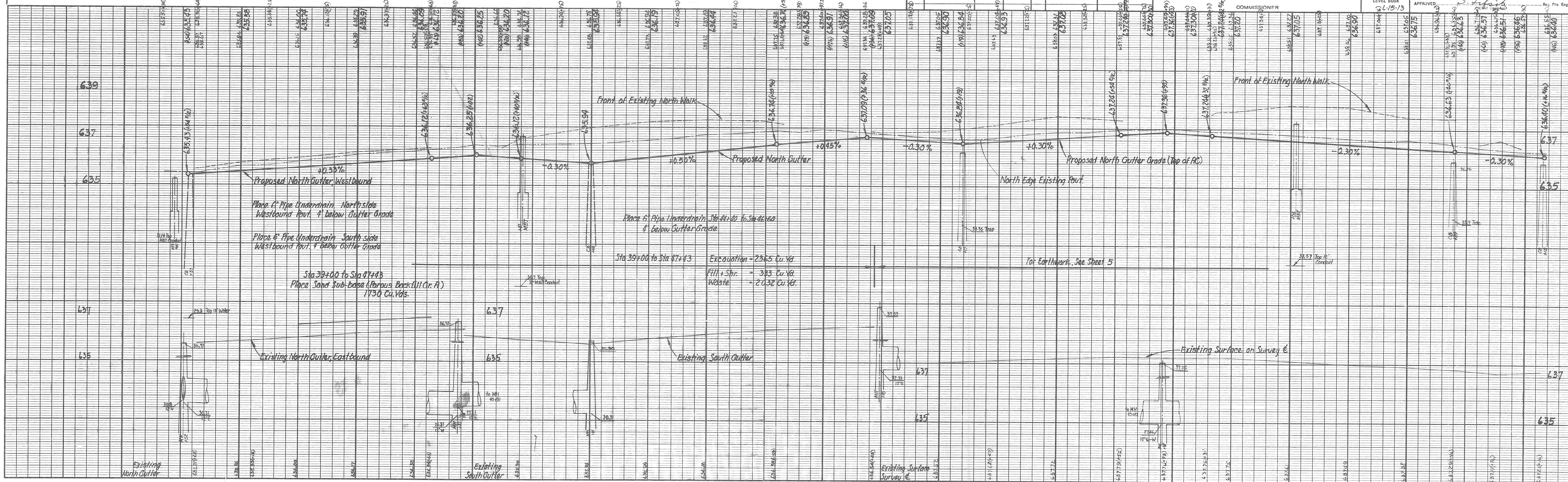

DATE	
BY	
PLAN SURVEYED	
NOTED	
PLOTTED	
ALIGNMENT CHECKED	
RT. OF WAY CHECKED	
No.	

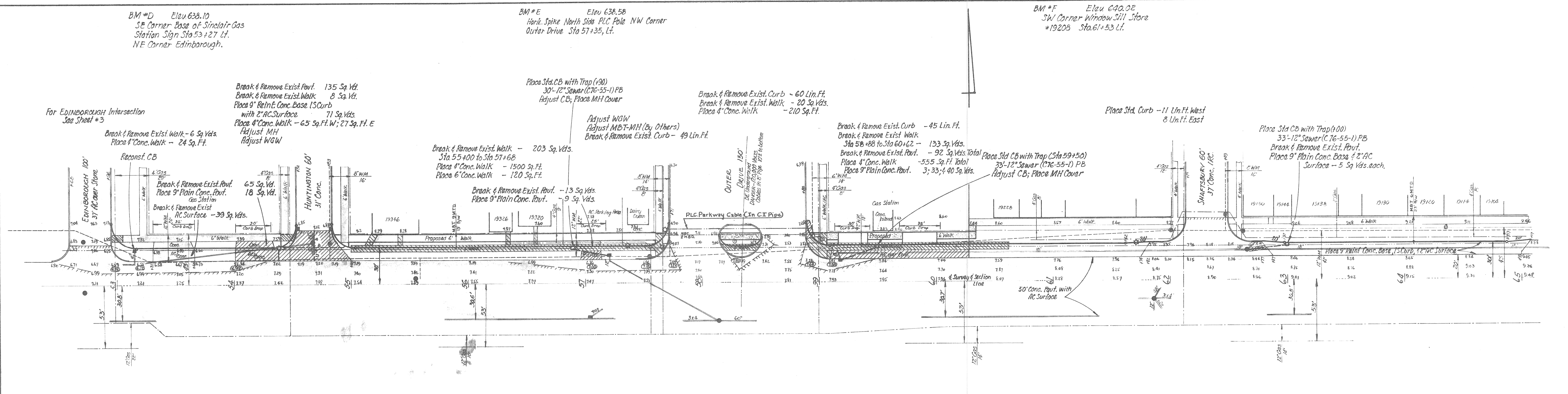

DATE	
BY	
PROFILE SURVEYED	
NOTED	
CHANGES CHECKED	
B.M.'S NOTED	
STRUCTURE NOTATIONS CHECKED	
No.	

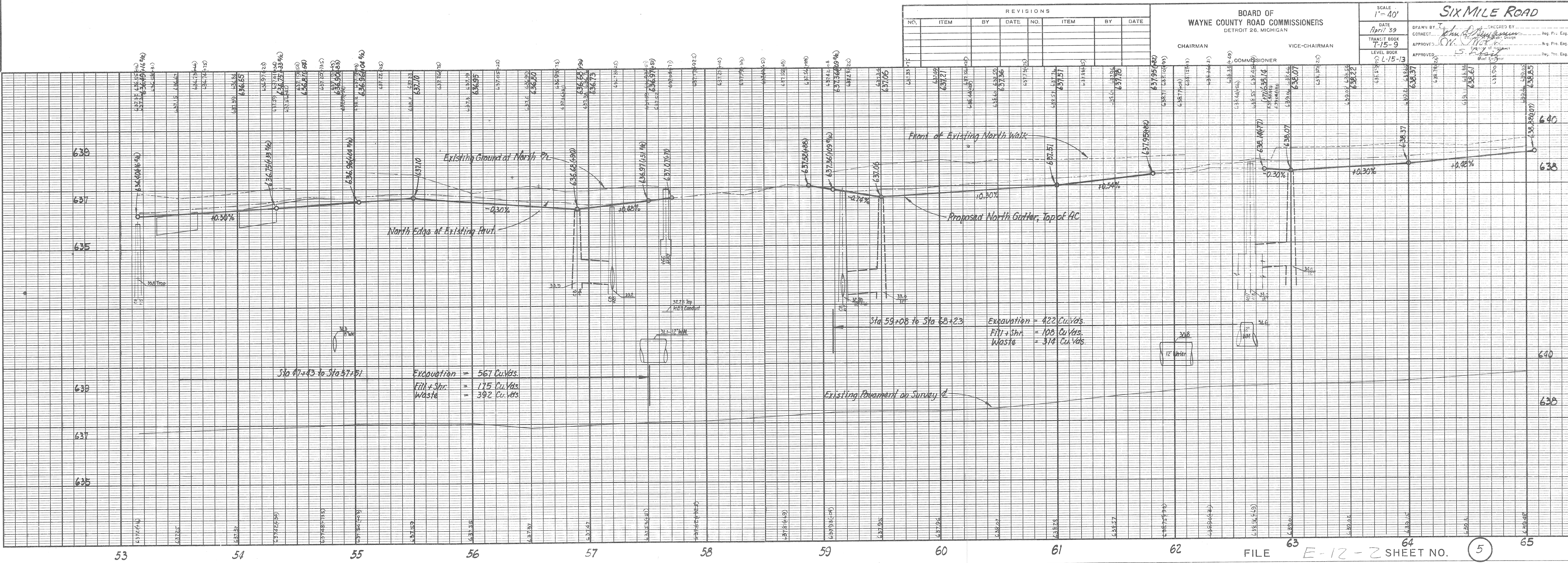

WC-59-C11

SIX MILE ROAD

SCALE: 1" = 40'
DATE: April 59
TRANSPORT BOOK: T-15-9
LEVEL BOOK: L-15-13
DRAWN BY: [Signature]
CHECKED BY: [Signature]
APPROVED: [Signature]

PLAN	SURVEYED	DATE
	PLOTTED	BY
	CHECKED	
	BY	
	NO. OF WAY CHECKED	
	No.	

PROFILE	SURVEYED	DATE
	PLOTTED	BY
	CHECKED	
	BY	
	NO. OF WAY CHECKED	
	No.	

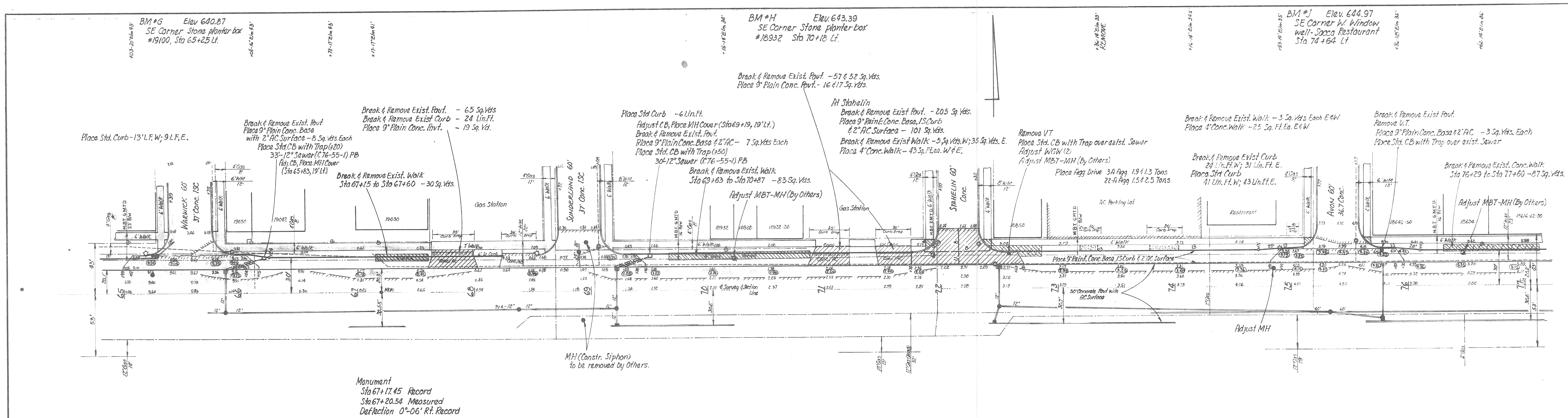

Manument
Sta 67+17.45 Record
Sta 67+20.54 Measured
Deflection 0'-06" Rt. Record

MH (Constr. Siphon)
to be removed by Others.

WC-59-C11

REVISIONS				REVISIONS			
NO.	ITEM	BY	DATE	NO.	ITEM	BY	DATE

BOARD OF
WAYNE COUNTY ROAD COMMISSIONERS
DETROIT 26, MICHIGAN

CHAIRMAN: _____
VICE-CHAIRMAN: _____
COMMISSIONER: _____

SCALE 1"=40'

DATE: April 50

TRANSIT BOOK T-15-9

LEVEL BOOK L-15-13

DESIGNED BY: _____

CHECKED BY: _____

APPROVED BY: _____

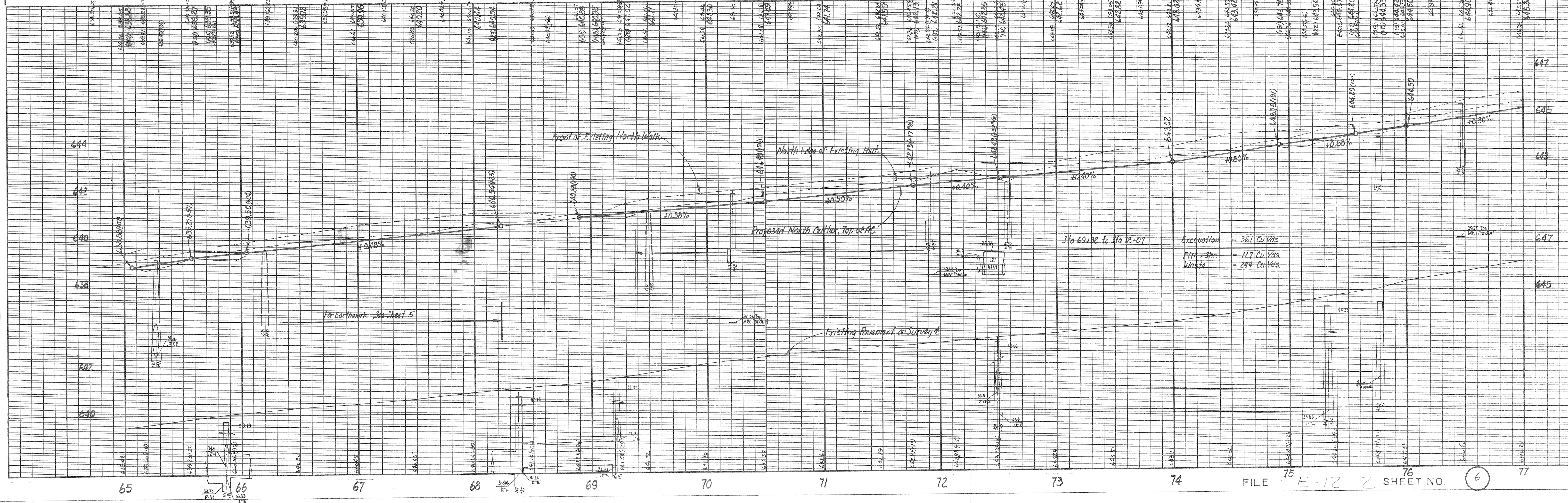

For Earthwork, See Sheet 5

Sta 69+38 to Sta 70+07

Excavation = 361 Cu. Yds.
Fill + 3hr. Waste = 117 Cu. Yds., 244 Cu. Yds.

DATE	
BY	
SURVEYED	
NOTE BOOK	
ALIGNMENT CHECKED	
RT. OF WAY CHECKED	
No.	

DATE	
BY	
SURVEYED	
GRADE CHECKED	
B. M.'S NOTED	
STRUCTURE NOTATION OK'D	
No.	

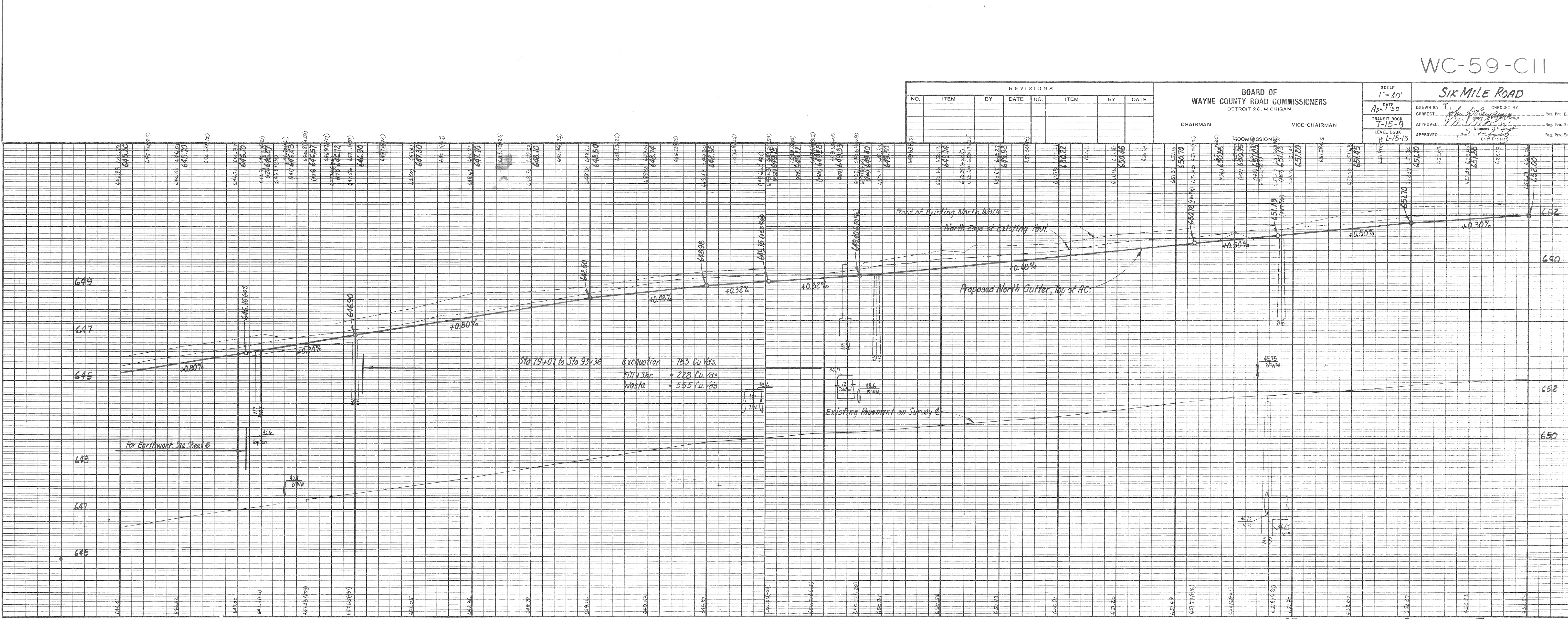
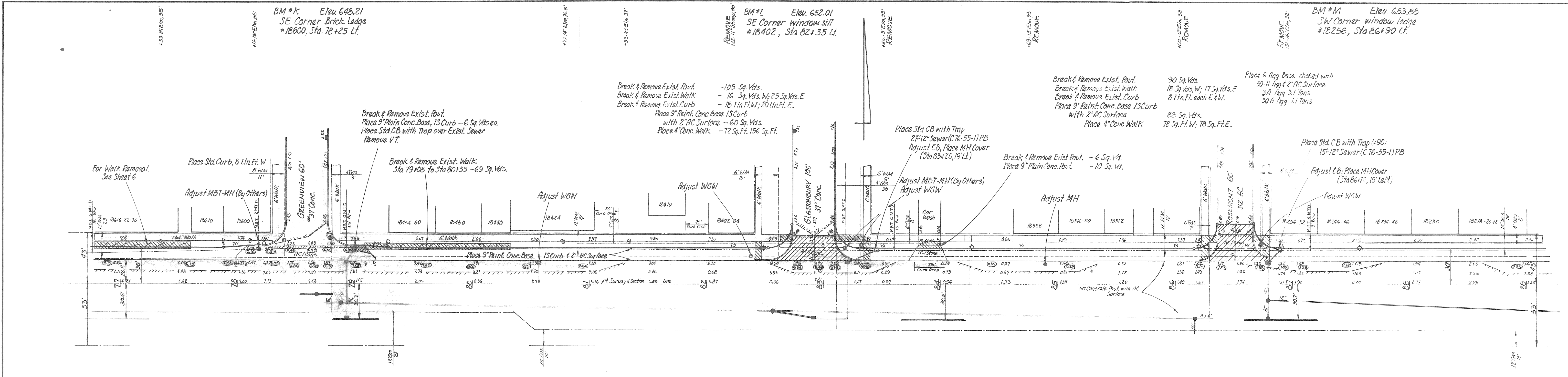

REVISIONS							
NO.	ITEM	BY	DATE	NO.	ITEM	BY	DATE

BOARD OF WAYNE COUNTY ROAD COMMISSIONERS
 DETROIT 26, MICHIGAN
 CHAIRMAN: _____ VICE-CHAIRMAN: _____

SCALE 1" = 40'
 DATE April '59
 TRANSIT BOOK 7-15-9
 LEVEL BOOK 12-15-13
 DRAWN BY: _____ CHECKED BY: _____
 APPROVED: _____
 APPROVED: _____

WC-59-C11

SIX MILE ROAD