

BOARD OF
WAYNE COUNTY ROAD COMMISSIONERS

DETROIT, MICHIGAN

MICHAEL J. O'BRIEN
 COMMISSIONER

CHARLES L. WILSON
 VICE-CHAIRMAN

WILLIAM E. KREGER
 CHAIRMAN

PLAN AND PROFILE OF PROPOSED

KELLY ROAD

INDEX TO SHEETS

Sheet No.	Title Sheet
1	Typical Cross Section
2-2A	Plan & Profile
3-7	Quantity Sheets
8-11	

STANDARD PLANS

- C-17-2A
- C-17-28B
- C-17-2D



P.O.E. STA. 88+19
 1957 PROJ.

P.O.B. STA. 23+96
 1957 PROJ.

Kelly Rd. Moross to 3 Mile Rd.

*Kelly Rd.
 Moross to 3 Mi. Rd.*

WC-57-C9

CORRECT *John E. Hill*
 APPROVED County Highway Engineer

KELLY ROAD MOROSS RD. TO BASE LINE RD TYPICAL CROSS-SECTION

Scale: 1" = 4' Unless Shown Otherwise

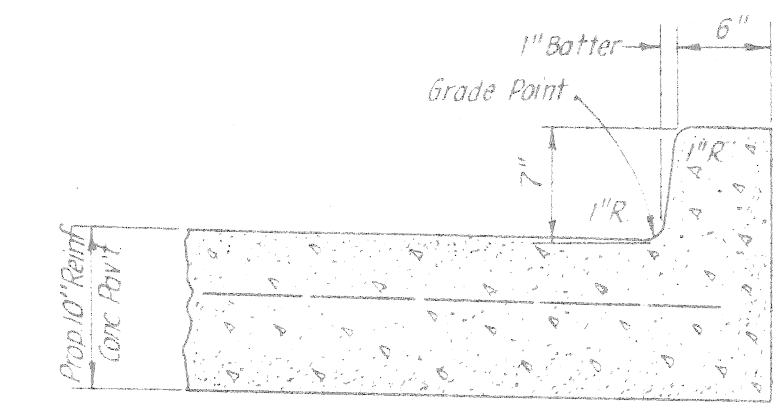
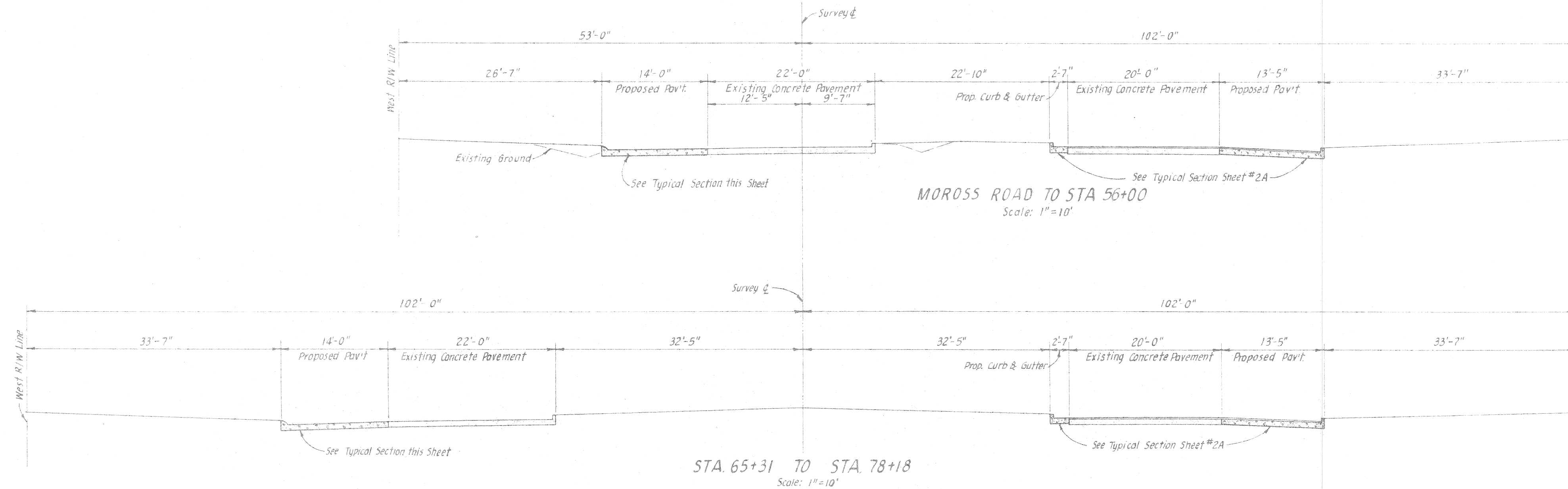

INTEGRAL STRAIGHT CURB
Scale: 1" = 1'-0"

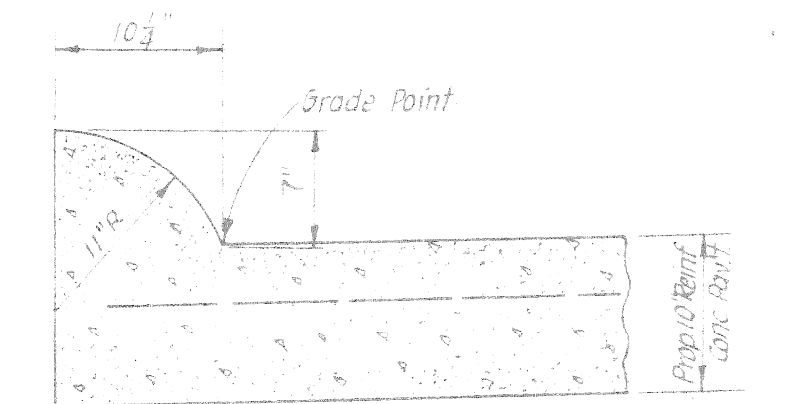

INTEGRAL ROLL CURB
Scale: 1" = 1'-0"

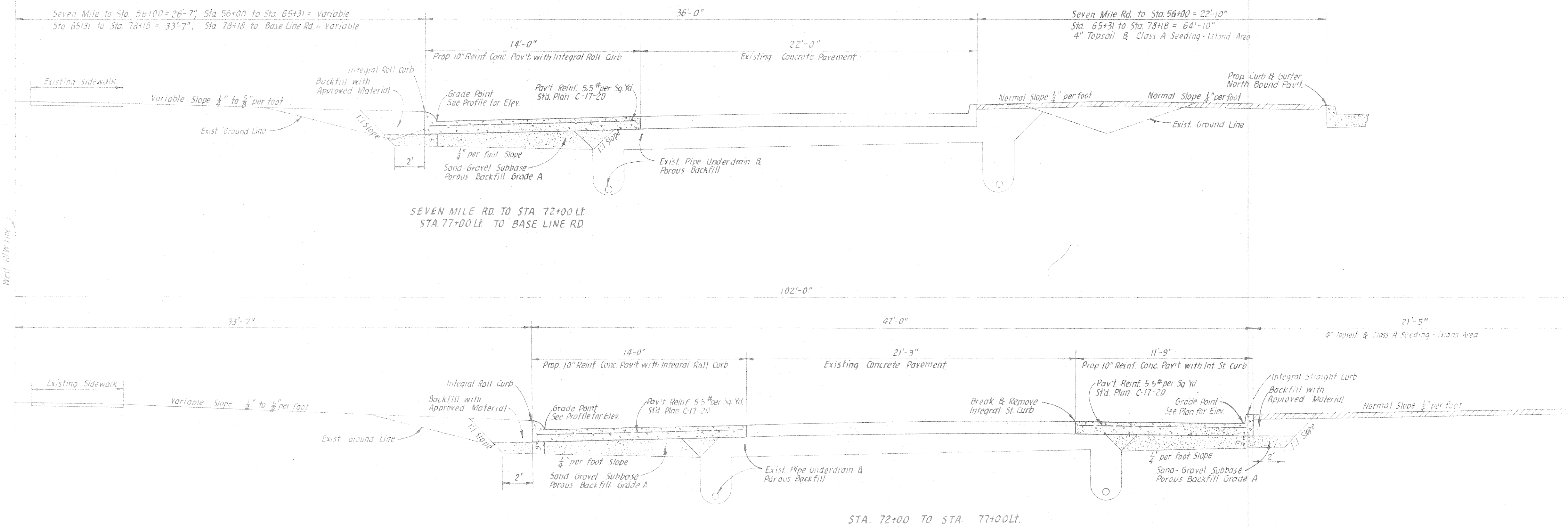

GENERAL NOTES

- The location of all Public Utilities shown on these Plans is taken from the best available data. The Board of Wayne County Road Commissioners will not be responsible for any omissions or variations from the locations shown. Before starting construction the Contractor shall check with the Utilities the location of existing structures whether or not indicated on the Plans.
- Any existing castings damaged by the Contractor in the course of work shall be replaced by the Contractor at his own expense.
- The removal of pipe culverts, sewer pipe and catch basins shall be considered as incidental to the work of Earth Excavation.
- Edge of existing pavement shall be cleaned of earth or other foreign material with a wire broom immediately before the pouring of concrete for curb and gutter or concrete pavement.
- All street returns shall be 3' wide back to back of curb unless noted otherwise. Street return radii shall be 20' unless noted otherwise.
- Mowing Hydrants and Adjusting to grade all Public Utility structures except water will be done by others.
- Place Aggregate Drives as noted on the Plans or as directed by the Engineer.
- Place 3" Concrete Sidewalk as indicated on the Plans or as directed by the Engineer.
- Tops to existing catch basin or manhole will not be paid for separately.

CORRECTED: *[Signature]* PLS. 111.514
APPROVED: *[Signature]* PLS. 111.514

KELLY ROAD MOROSS RD. TO BASE LINE RD. TYPICAL CROSS-SECTION

Scale: 1" = 4'-0" Unless Otherwise Shown

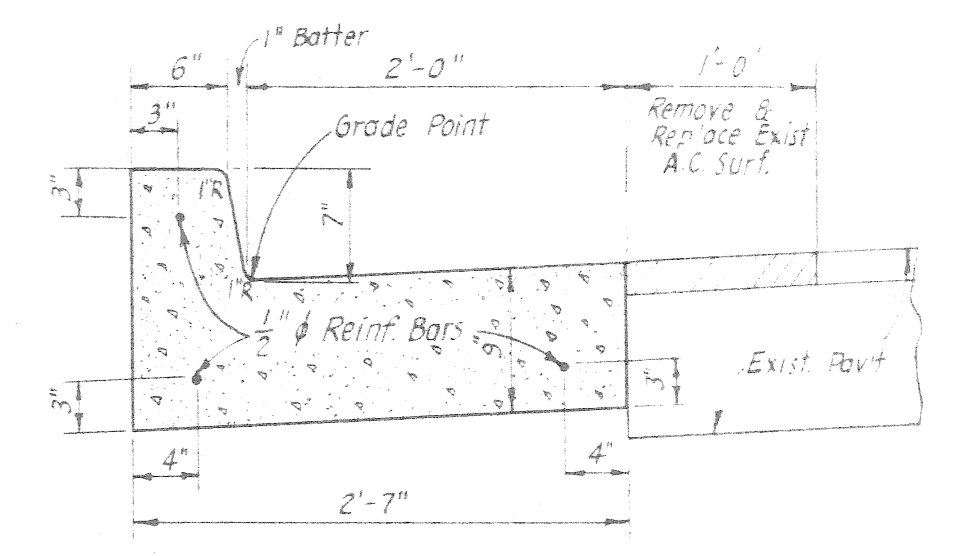
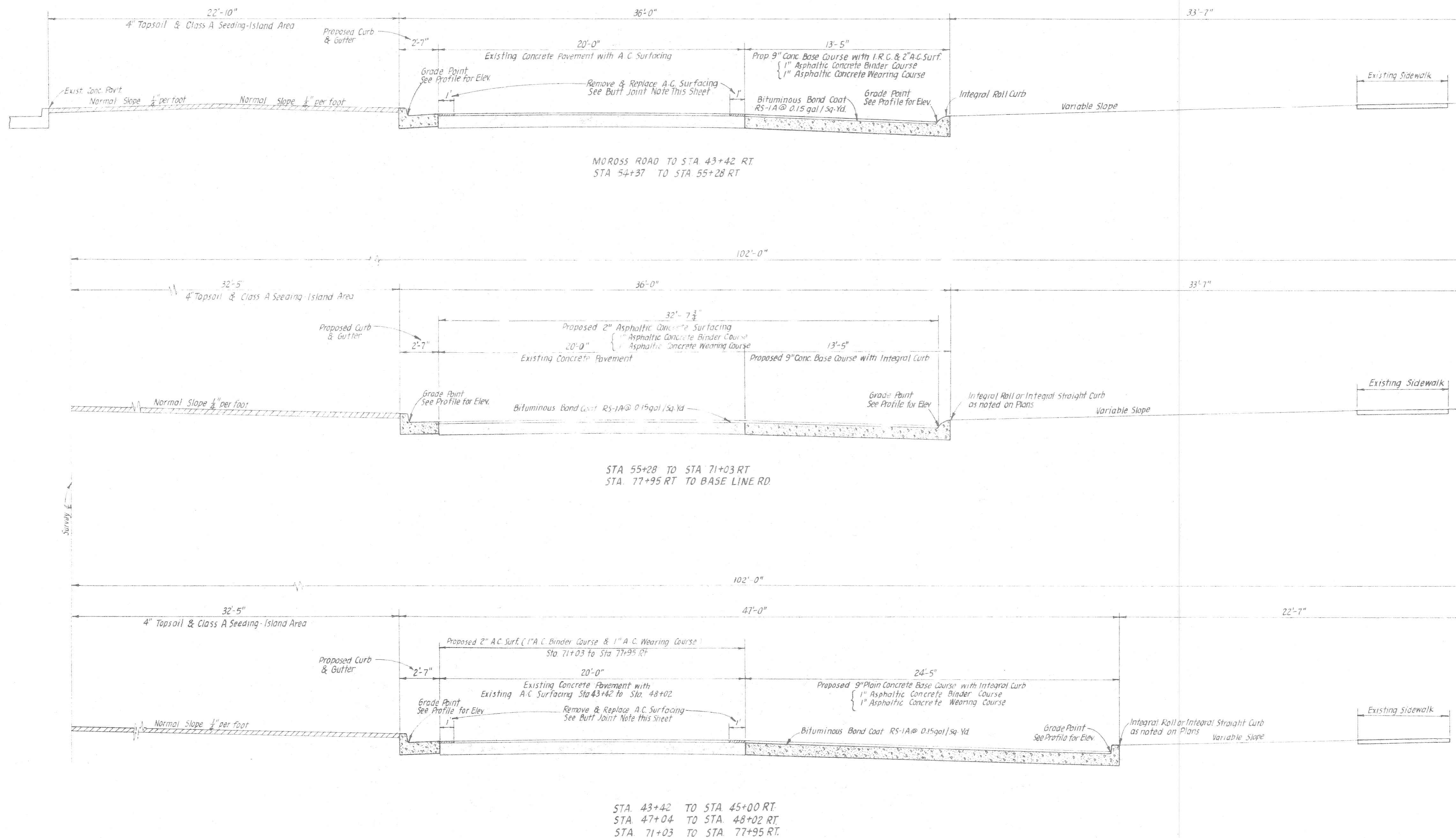

CONCRETE CURB & GUTTER
Scale: 1" = 1'-0"

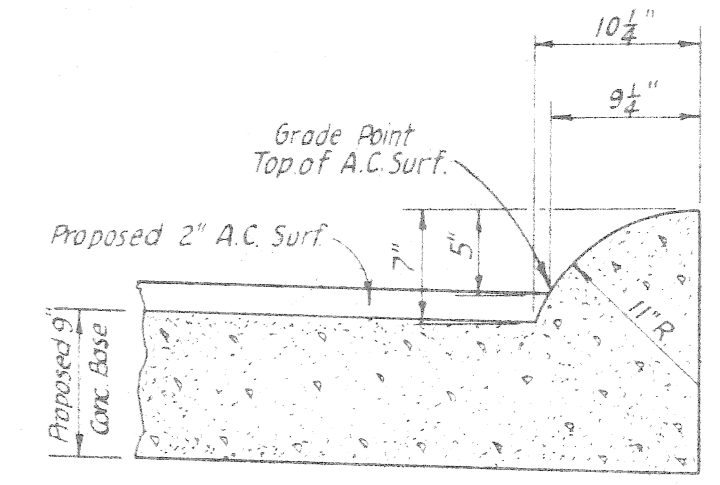

INTEGRAL ROLL CURB
Scale: 1" = 1'-0"

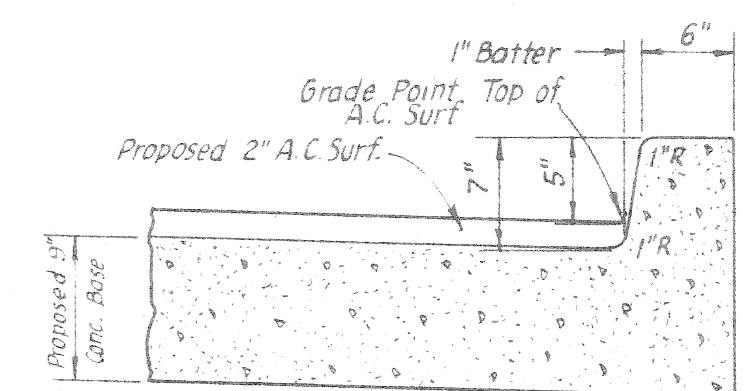

INTEGRAL STRAIGHT CURB
Scale: 1" = 1'-0"

BUTT JOINT
The Butt Joint shall be prepared by sawing through the total thickness of Asphaltic Surfacing

CORRECT: *Paul E. Hill*
Engineer of Highway
APPROVED: _____
County Highway Engineer

BY: _____ DATE: _____
 SURVEYED _____
 PLOTTED _____
 NOTE BOOK _____
 NO. _____
 CHECKED _____
 RE. OF WAY CHECKED _____

BY: _____ DATE: _____
 SURVEYED _____
 PLOTTED _____
 NOTE BOOK _____
 NO. _____
 CHECKED _____
 RE. OF WAY CHECKED _____

BM #3 Elev. 605.76
 "Del" on hydr. at Coram

BM Elev. 602.75
 "in West Walk at Sta. 43+00

BM #5 Elev. 603.87
 "Del" on hydr. at Liberal

BM #6 Elev. 603.15
 "Del" on hydr. at Manning

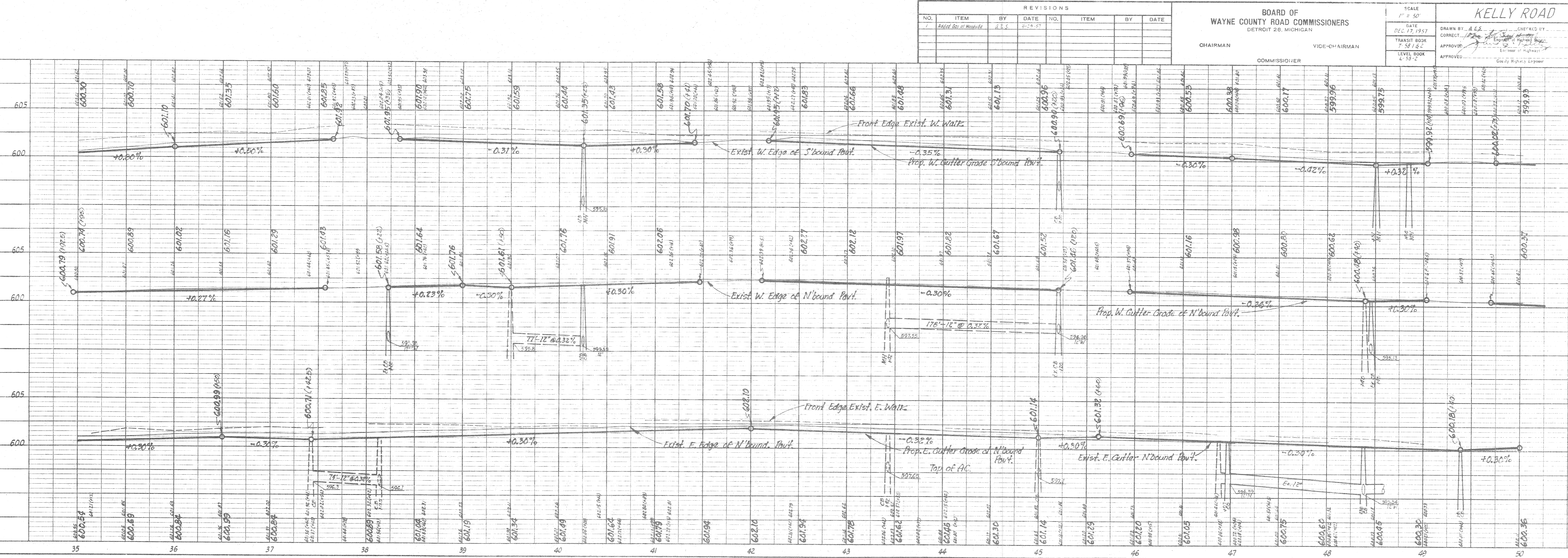
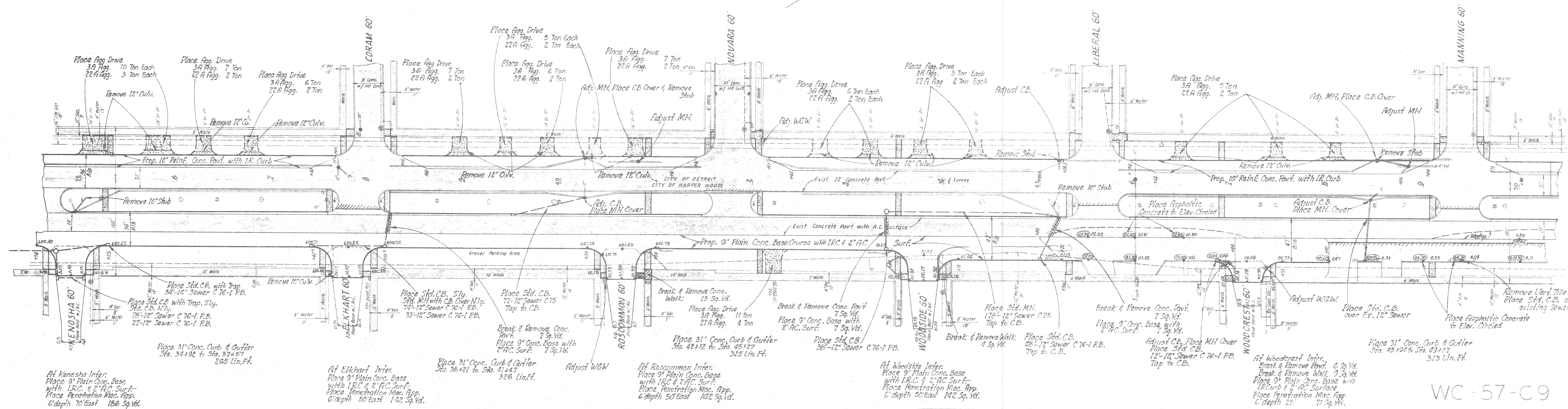

REVISIONS					
NO.	ITEM	BY	DATE	NO.	ITEM
1	Added Sta. of Woodside	J. S. J.	12-9-57		

BOARD OF WAYNE COUNTY ROAD COMMISSIONERS
 DETROIT 26, MICHIGAN

CHAIRMAN _____ VICE-CHAIRMAN _____
 COMMISSIONER _____

SCALE 1" = 50'

DATE DEC. 17, 1957
 CORRECTED _____
 TRANSIT BOOK T. 58182
 LEVEL BOOK L. 33-2

KELLY ROAD
 DRAWN BY A. E. J. CHECKED BY _____
 APPROVED _____
 APPROVED _____

DATE	
BY	
SUPERVISED	
ALIGNMENT CHECKED	
NOTE BOOK	
RT. OF WAY CHECKED	
NO.	

DATE	
BY	
SUPERVISED	
GRADES CHECKED	
B. M. NOTED	
STRUCTURE NOTATIONS CHECKED	
NO.	

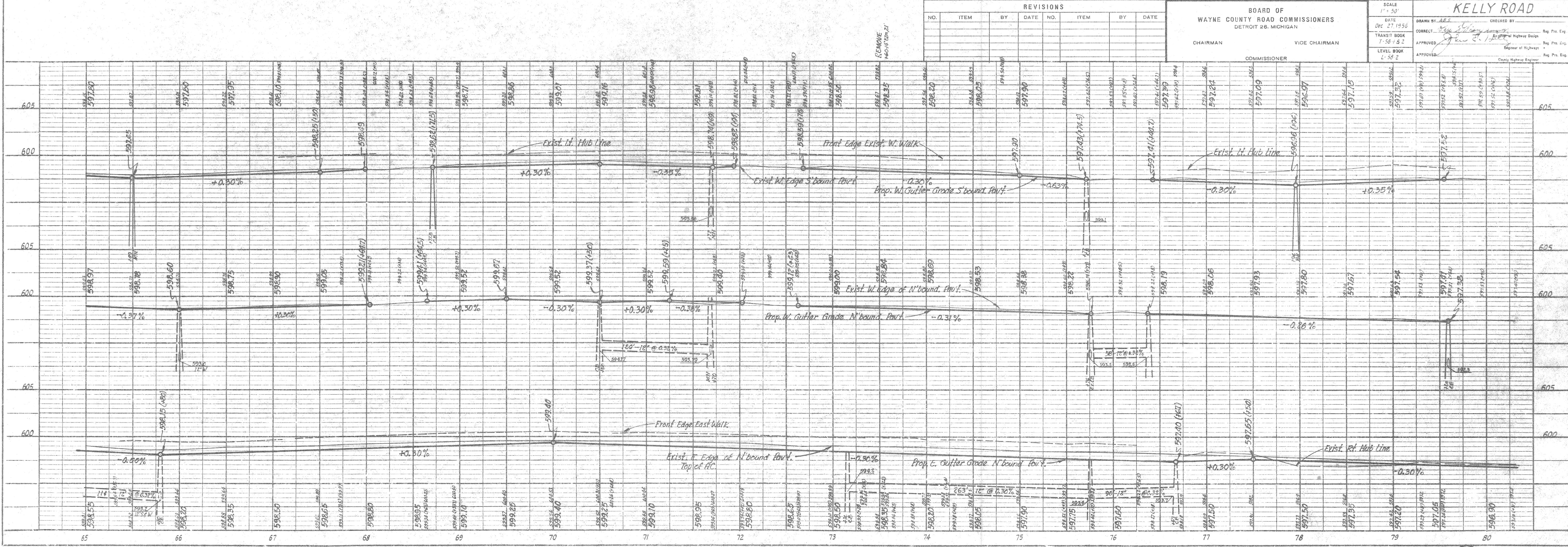
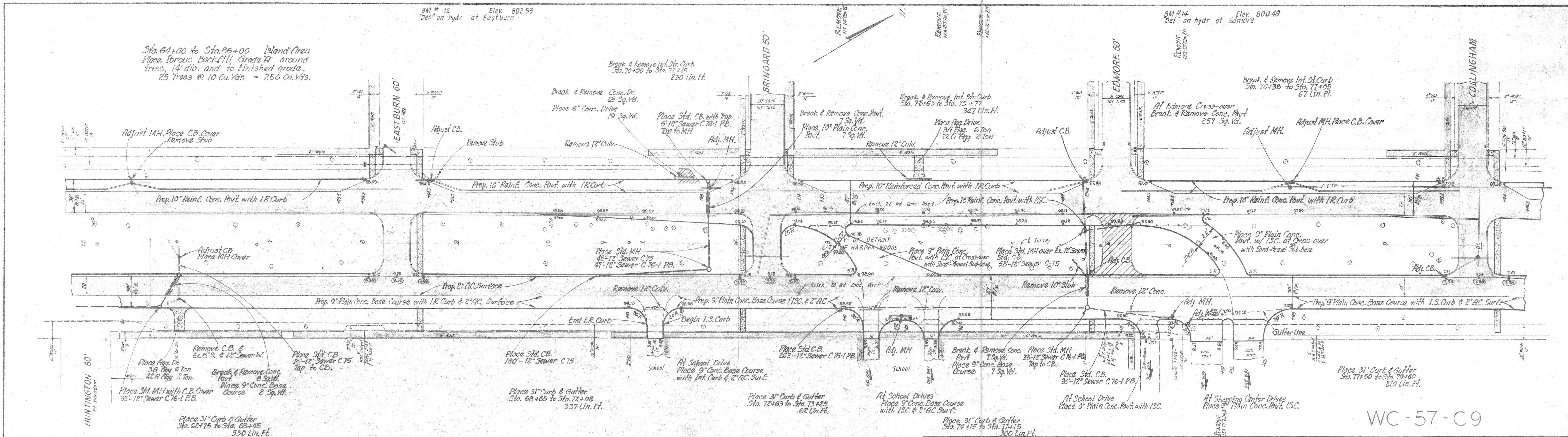

PLATE 1—PLAN PROFILE R. P. A. STANDARD
FREDERICK POST CO. CHICAGO - 2814

REVISIONS					
NO.	ITEM	BY	DATE	NO.	ITEM

BOARD OF WAYNE COUNTY ROAD COMMISSIONERS DETROIT 26, MICHIGAN		SCALE 1" = 50'	KELLY ROAD	
CHAIRMAN	VICE CHAIRMAN	DATE DEC 27 1956	DRAWN BY A.E.S.	CHECKED BY
		TRANSIT BOOK 7-58-1-B-2	APPROVED <i>[Signature]</i>	
		LEVEL BOOK L-58-2	APPROVED <i>[Signature]</i>	

BM#15 Elev. 600.56
S.E. cor. of Arch # 20355

BM#16 Elev. 598.20
Spike in 18" maple Sta 82+60 E. of Old Pav't

BM#19 Elev. 598.77
City Control Mon of Base Line & Kelley Rd.

DATE	
BY	
SURVEYED	
PLANNED	
NOTED	
CHECKED	
NO. OF WAY CHECKED	

DATE	
BY	
SURVEYED	
PLANNED	
NOTED	
CHECKED	
NO. OF WAY CHECKED	

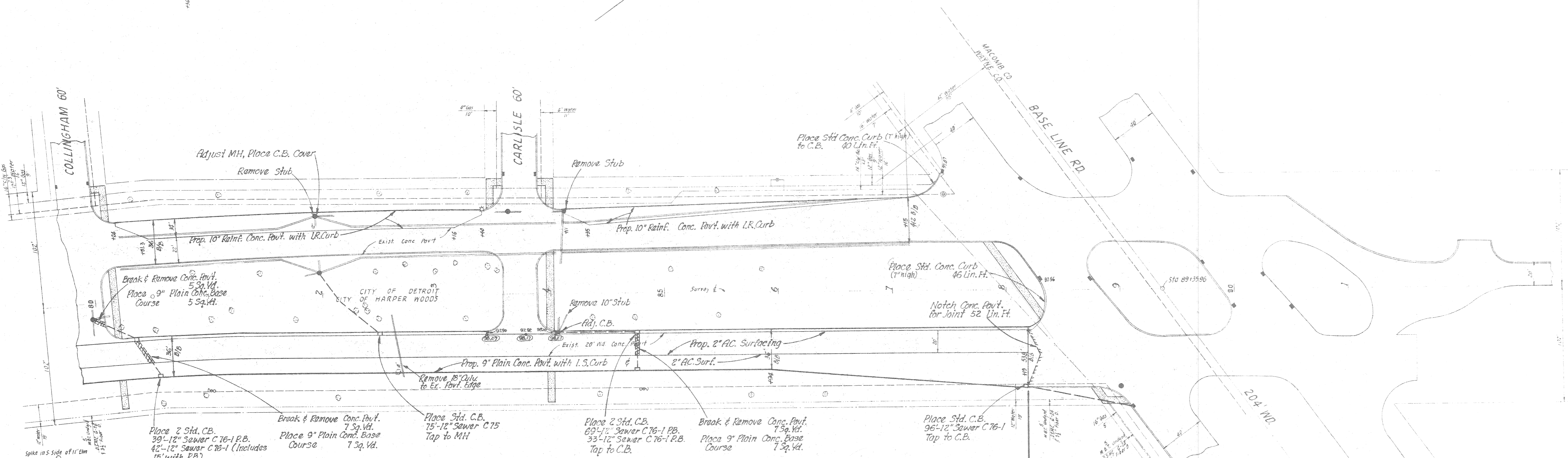

WC-57-C9

REVISIONS					
NO.	ITEM	BY	DATE	NO.	DATE

BOARD OF
WAYNE COUNTY ROAD COMMISSIONERS
DETROIT 26, MICHIGAN

CHAIRMAN VICE CHAIRMAN
COMMISSIONER

SCALE
1" = 50'

DATE
1-4-57

TRANSIT BOOK
T-584 R-2

LEVEL BOOK
L-58-2

KELLY ROAD

DRAWN BY: [Signature]
CHECKED BY: [Signature]

APPROVED: [Signature]
[Signature]

