

BUILDING SCHEDULE

BLDG. NO.	COMBINATIONS	DWELL. UNITS	TOTAL BLDGS.
1	A G	9	16
2	A H H	11	12
3	A H H H	15	8
4	A I H	11	16
5	B B B B	8	10
6	B B B B B	10	4
7	C C	6	14
8	C G	9	10
9	C I	7	14
10	C B C	8	24
11	C G G B	11	28
12	C G G C	12	10
13	C H C	10	4
14	C I B	9	14
15	C B B C	10	12
16	H	4	5
17	G	6	20
18	G G	12	10
19	G I	10	2

Total - 2150 DWELLING UNITS
 - 1731 CAR. SPACES
 - 81% PARKING

NUMBER OF ROOMS IN DWELLING UNITS

1-F-0-2-R-2 UNIT A - 11 x 52 UNITS	= 572
2-R-2	= 1200
2-F-1-1-R-3	= 2323
2-R-2-4-F-1	= 2120
4-F-2	= 1148
4-F-3	= 1012
TOTAL	8400 ROOMS

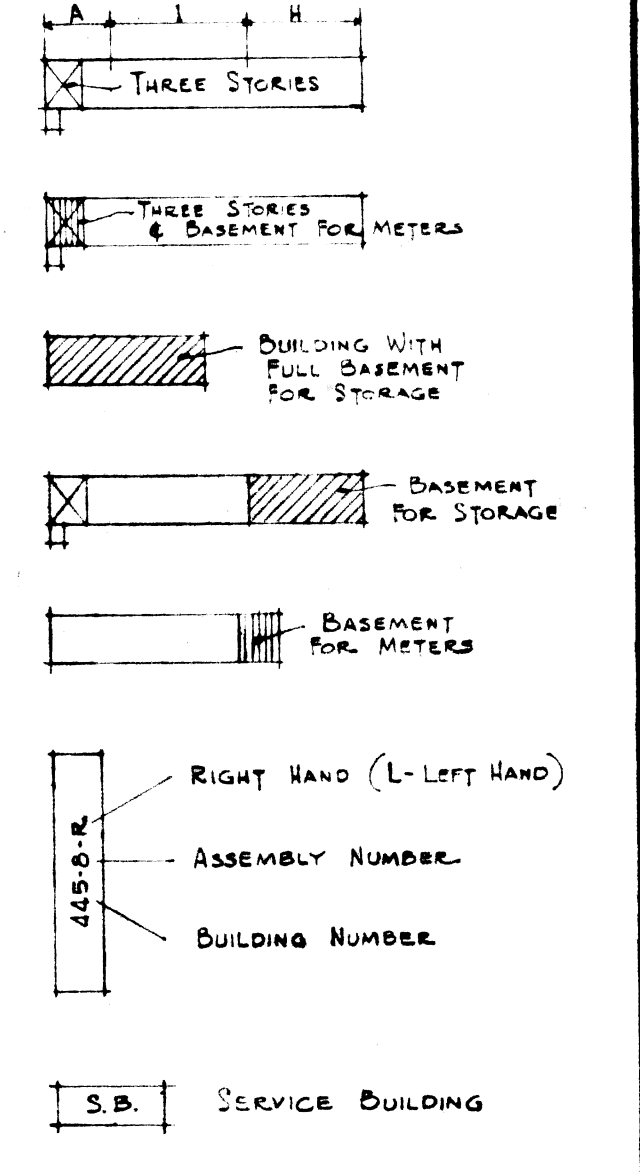

DETROIT HOUSING COMMISSION
 JAMES HERMAN GARDENS HOUSING PROJECT
 U. S. W. A. PROJECT NO. MICH. 1-4

GEORGE D. MASON ASSOCIATES
 ARCHITECTS & ENGINEERS
 1 G. LINNARD & E. A. EICHSTEDT
 ASSOCIATED LANDSCAPE ARCHITECTS
 404 GRISWOLD ST. DETROIT, MICH.

REVISIONS	DATE	BY	BULLETIN	TRCD BY - A.T.B.	SHEET NO.

DRAWN BY - A.T.B.
 CHECKED BY - A.T.B.
 APPR. BY -
 DATE -

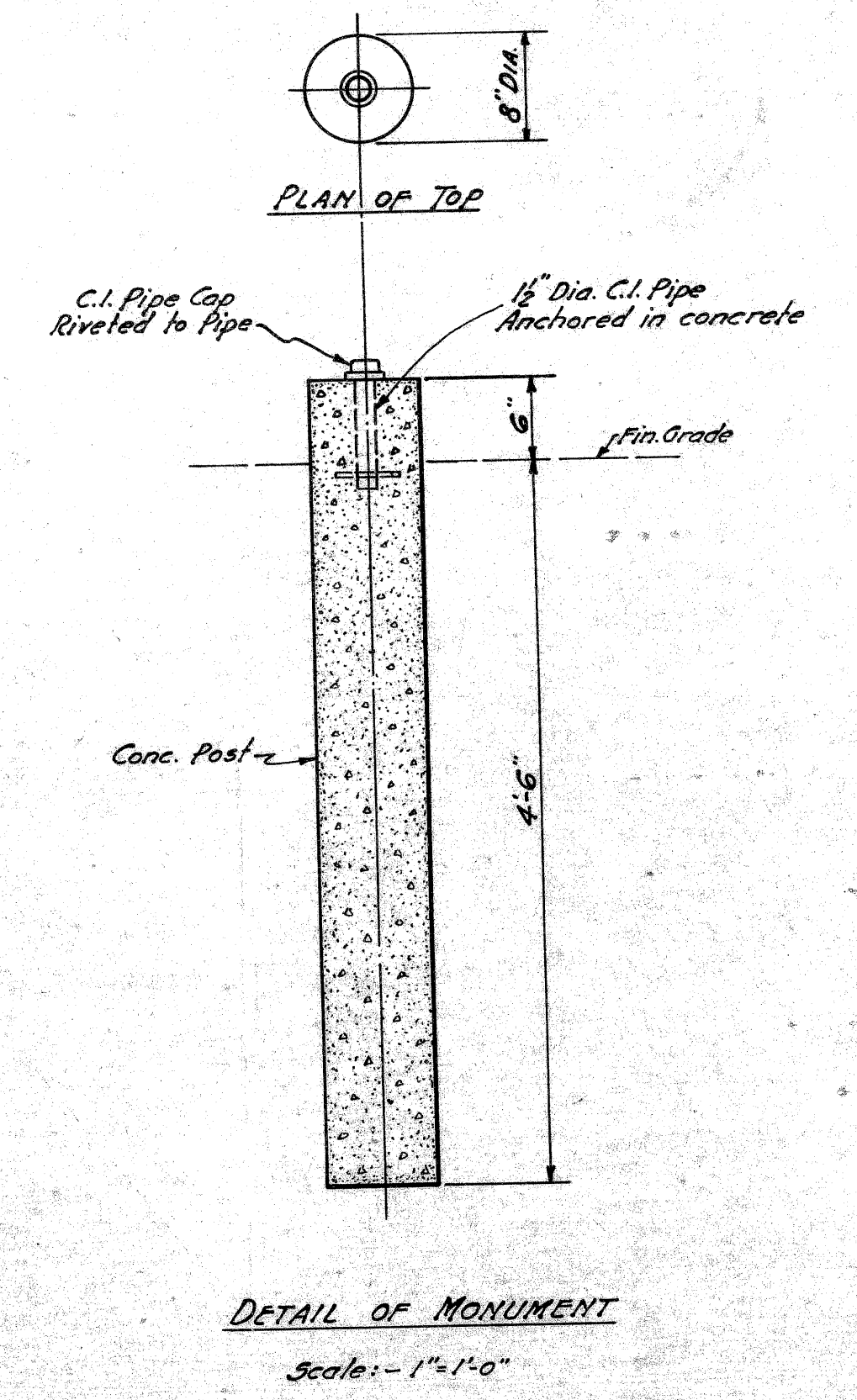
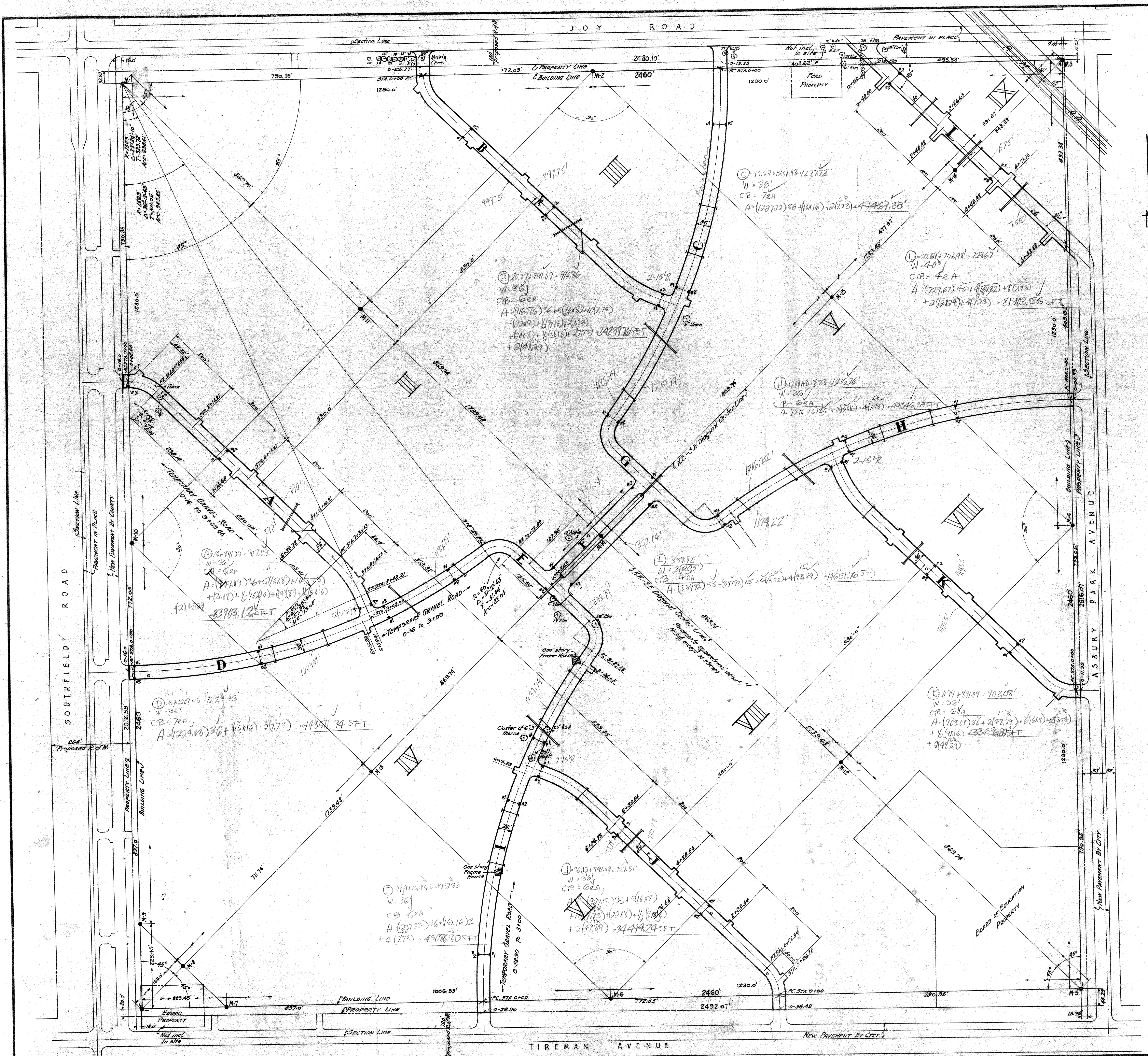

M-1 to M-12 INCL. 5'-0" LONG AS SHOWN
M-13 to M-16 INCL. 10'-0" LONG
TOTAL REQUIRED - 16 MONUMENTS

GENERAL NOTES

Grades shown on profiles are at top of curbs.
All driveway approaches are to be paved to back line of walk.
All driveways are 16' wide except as shown on 1" = 20' ST.
Provide curbs on all pavements as shown on typical sections.
Pavements in this contract to extend to property lines except at Joy Rd. Pavements at Joy Road to extend to present pavement.
Streets C, D, E, G, H, I, J, K, L, M, N, O, P, Q, R, S, T to be 36' pavements on E of 70' R/W with 5' sidewalk on each side of street. Sidewalk 1' back from curb line.
Streets U, V, W, X, Y, Z to be 36' pavements on E of 54' R/W with 7' sidewalks on each side of street. Sidewalk 0'-6" back of curb line.
T St. has a 15' partway between two 20'-6" pavements on E of 30' R/W with 5'-0" sidewalks. Sidewalk 1' back of curb line.
U St. is a 40'-0" pavement with 20'-0" additional widening contemplated within the 86'-0" R/W having 6' sidewalk on each side of street. Sidewalk 6' back from northeast curb line, and 26' back from southwest curb line.

CATCH BASINS:

#1. Roadway Catch Basins not trapped.
#2. Roadway Catch Basins trapped.
All trapped trees within 35 feet of curb shall be protected by a fence. All trees within the pavement shall be cut down and removed from the site, including all stumps & roots.
Superstructure of houses within pavement to be removed by others. Foundations of entire house to be removed by this Contractor.

SLEEVE LEGEND:

Elec. & Tel. ——— & Cast Iron Pipe sleeve to extend 2'-0" beyond pavement unless otherwise noted.
Heating Pipe ——— 48" I.D. Extra strength reinforced concrete culvert pipe.
See detail mechanical drawings for location & elevations of sleeves under roads.

No sidewalks are to be included in this contract.

36,087
40,120

486682
SCALE: 1"=100'

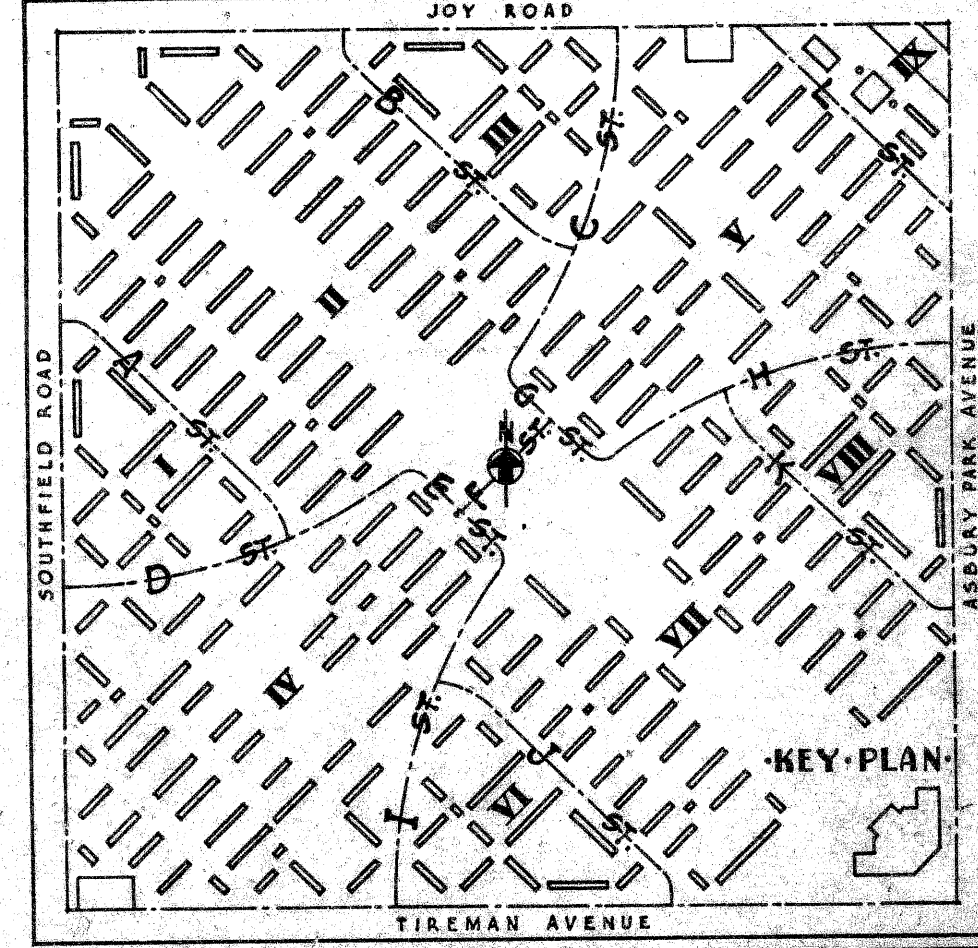

REVISIONS	DATE	NO.	DESCRIPTION	APP'D.	DEPT.	CHK'D.	APP'D.	DRAWN	P.B.R.

GENERAL PLAN OF DEDICATED STREETS

GEORGE D. MASON ASSOCIATES ARCHITECTS & ENGINEERS
L. G. LINNARD & E. A. EICHSTEDT ASSOCIATED LANDSCAPE ARCHITECTS
487 CRIEWOOD STREET DETROIT, MICHIGAN

S. JAMES HERMAN GARDENS U.S.A. PROJECT MICH. 1-4
FOR THE DETROIT HOUSING COMMISSION
CITY OF DETROIT, MICHIGAN

SHEET NO. **300**

DATE 12-12-39

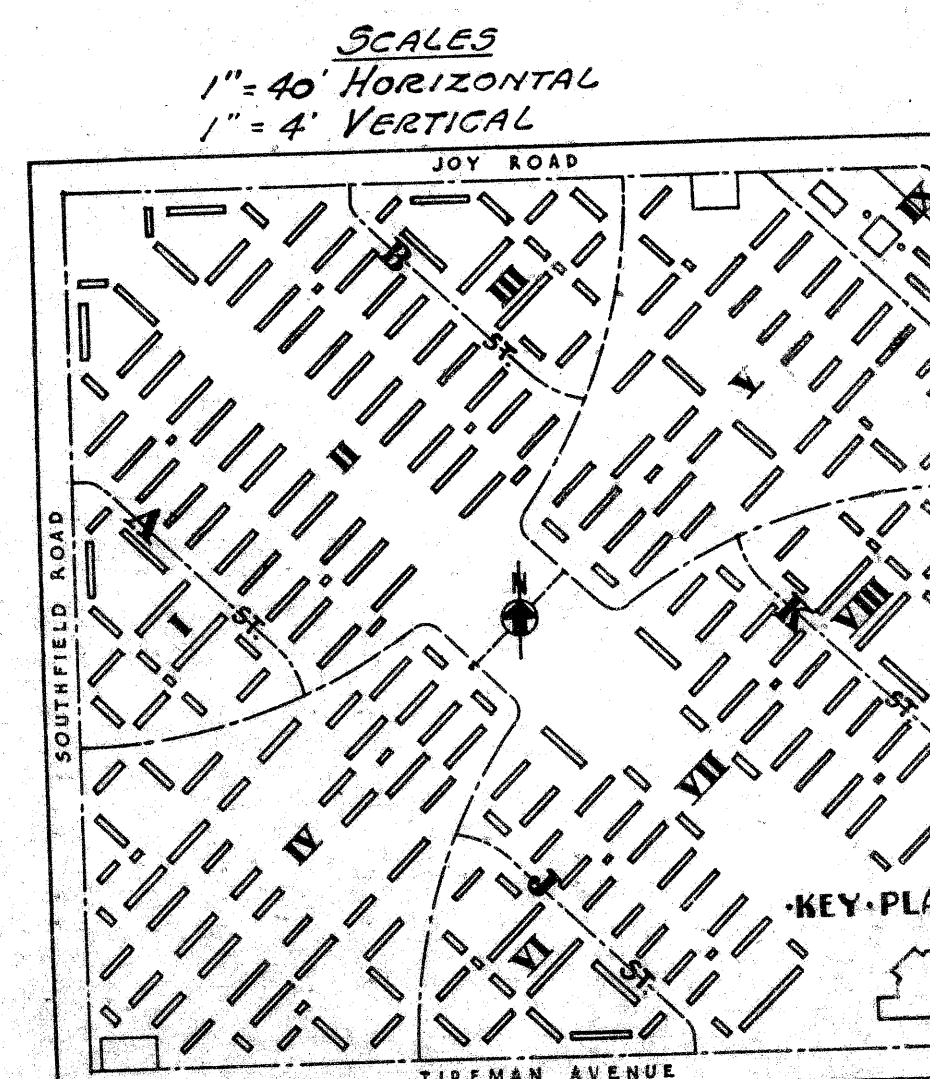
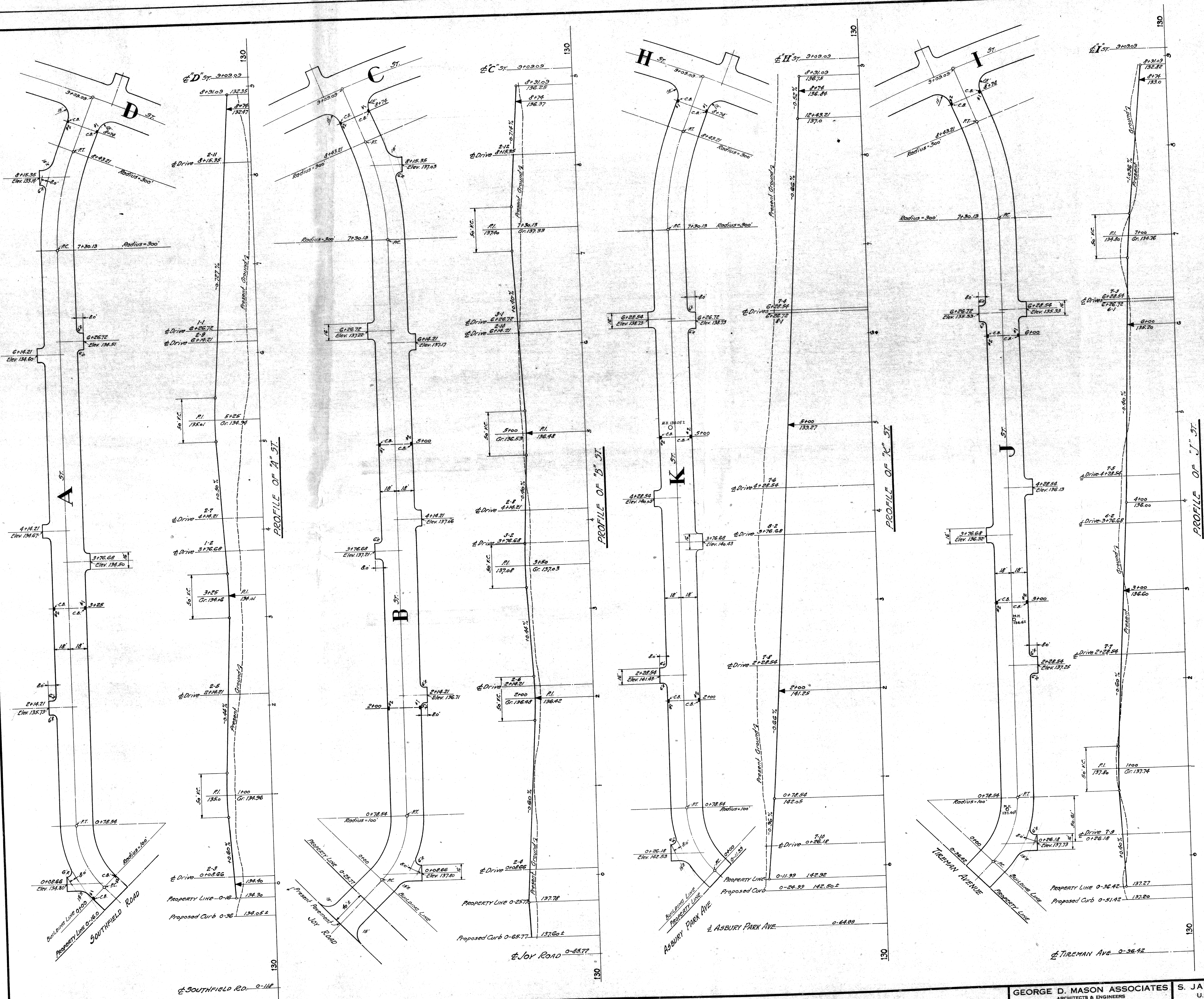

REVISIONS	DATE	NO.	DESCRIPTION	APPR.	DEPT.	CHGD.	APPR.	DRAWN	P.B.K.

PLAN AND PROFILES STREETS A, B, J AND K

GEORGE D. MASON ASSOCIATES
ARCHITECTS & ENGINEERS
L. G. LINNARD & E. A. EICHTSTEDT
ASSOCIATED LANDSCAPE ARCHITECTS
439 GRIEWOLD STREET
DETROIT, MICHIGAN

S. JAMES HERMAN GARDENS
U.S.H.A. PROJECT MICH. 1-4
FOR THE
DETROIT HOUSING COMMISSION
CITY OF DETROIT, MICHIGAN

SHEET NO.
303
S-646

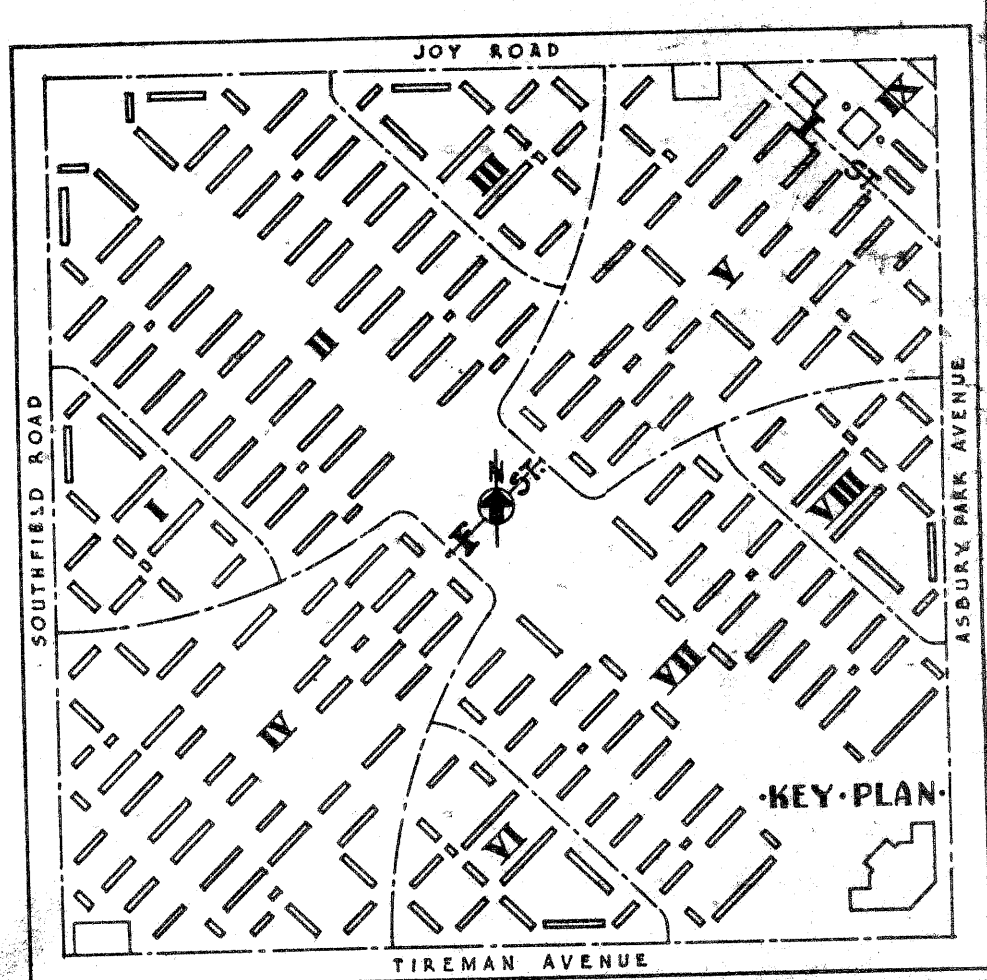
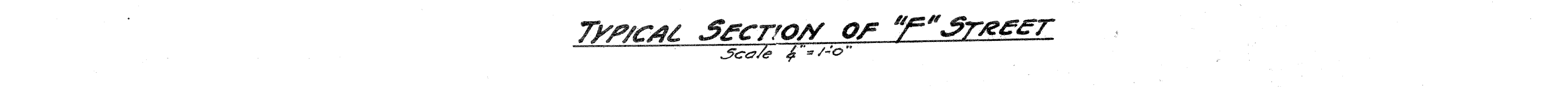
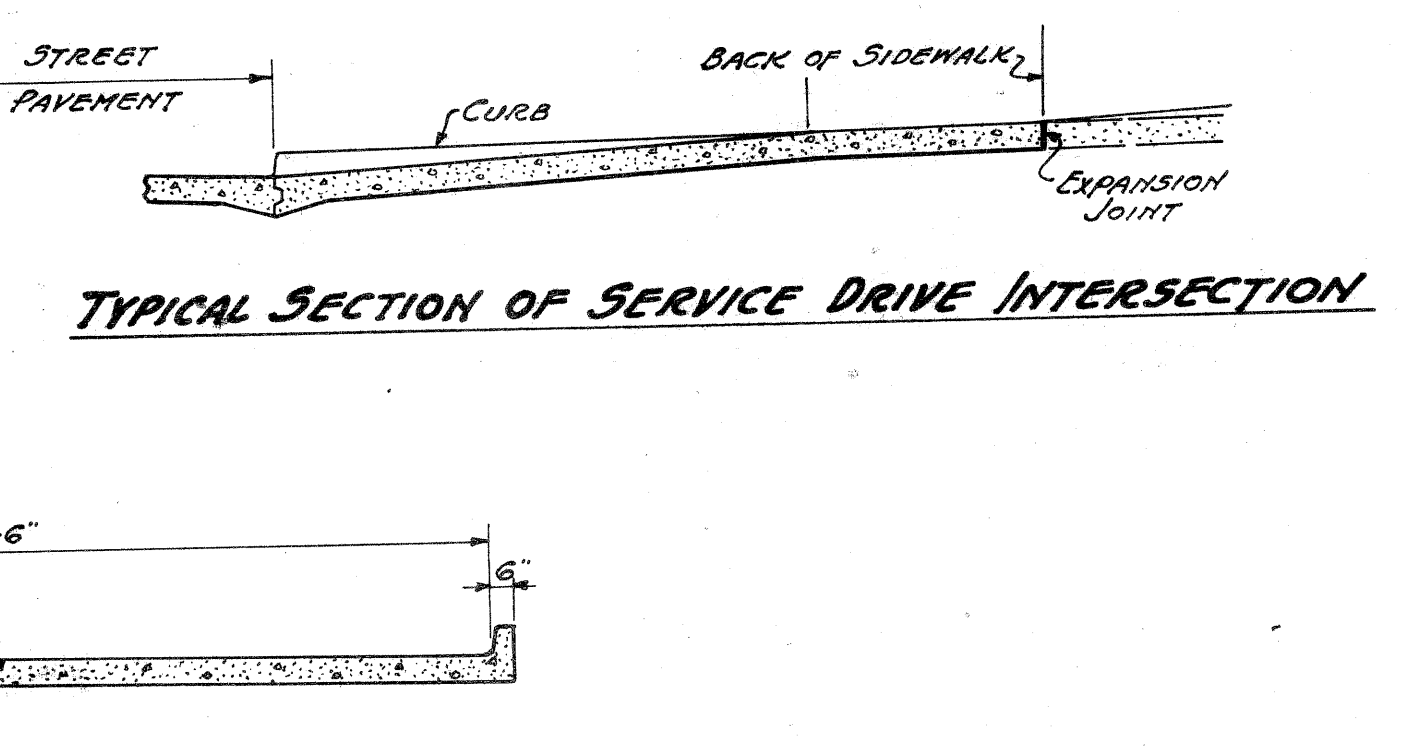
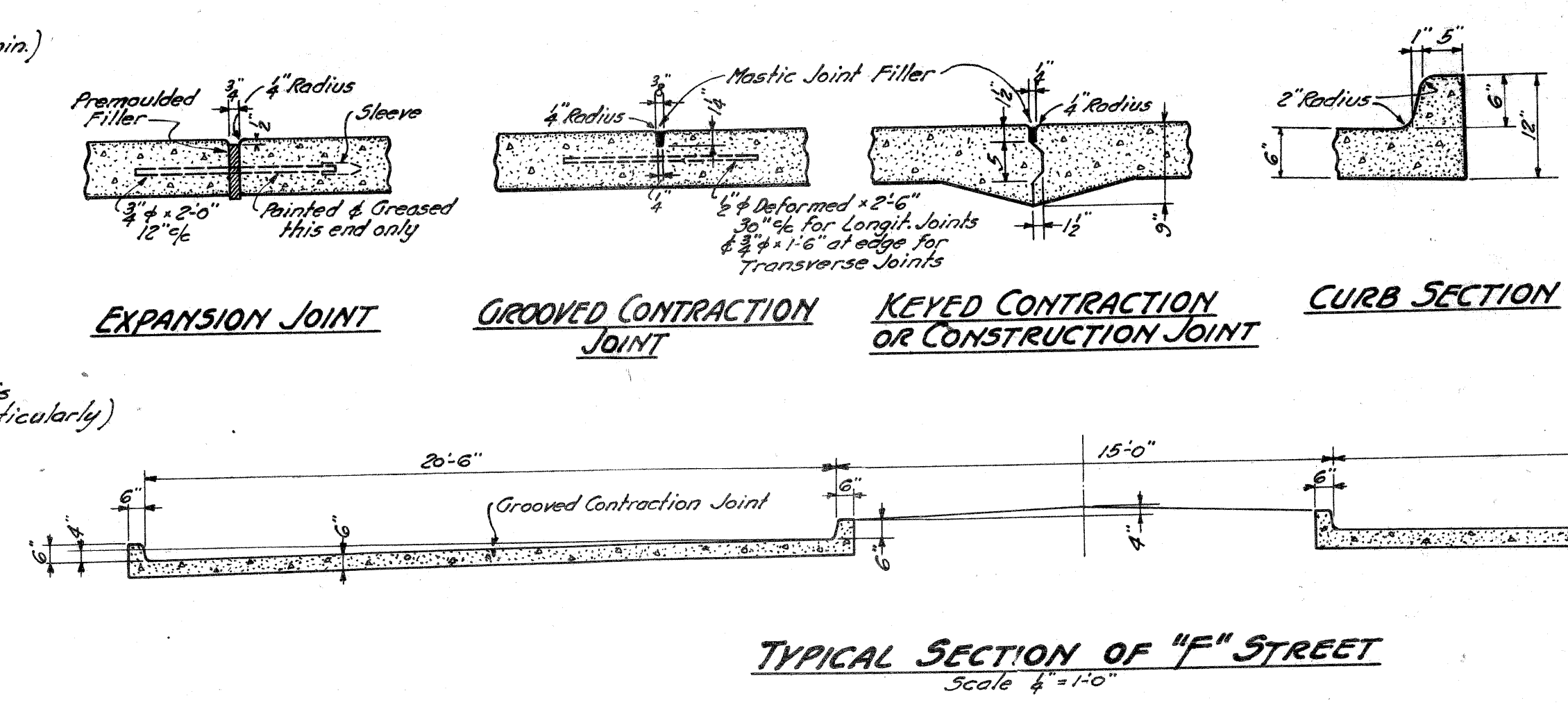
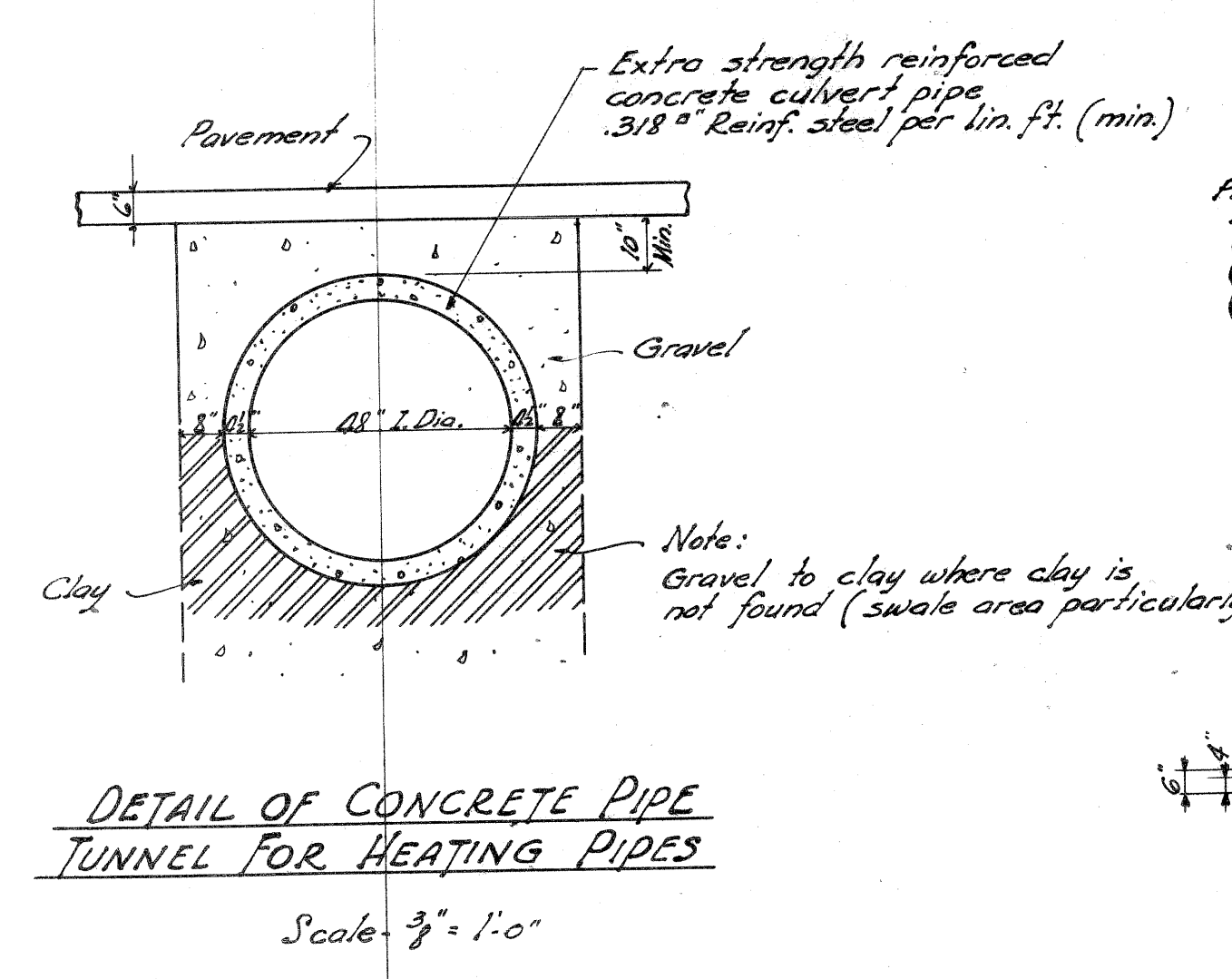
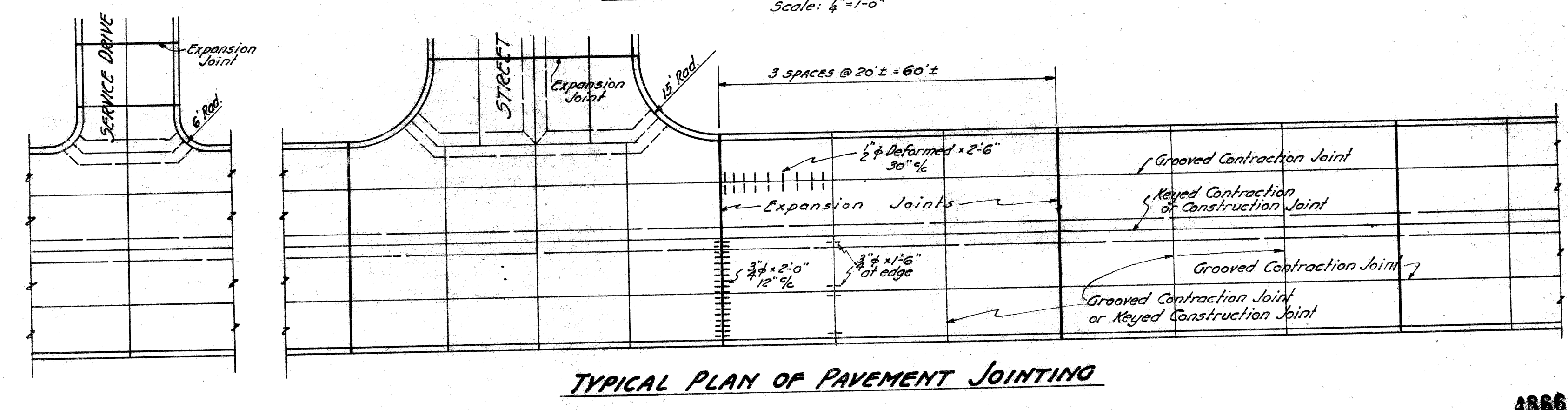
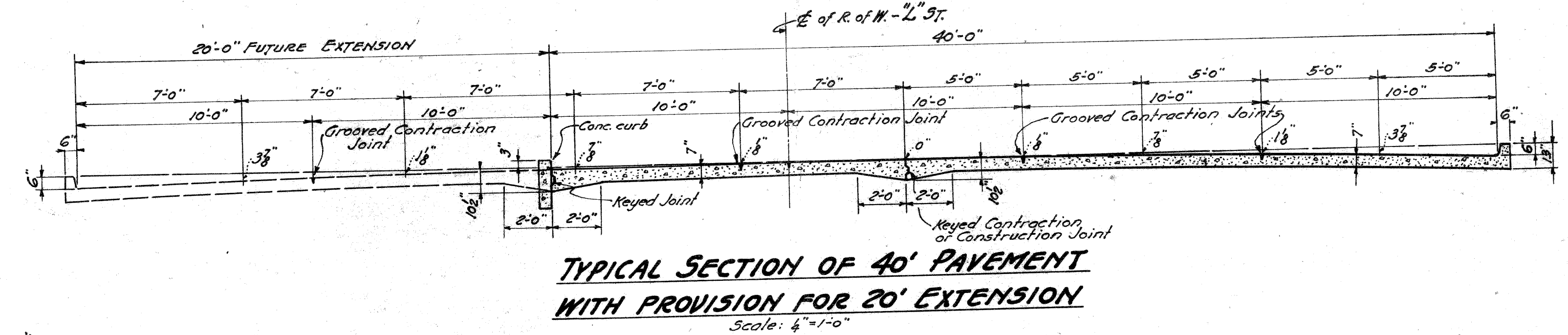
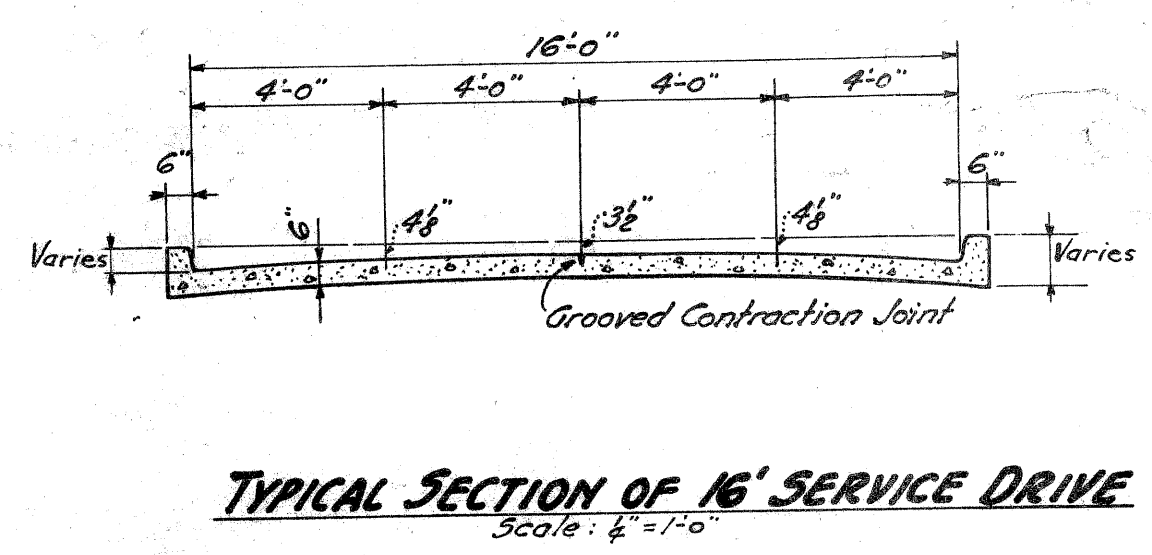
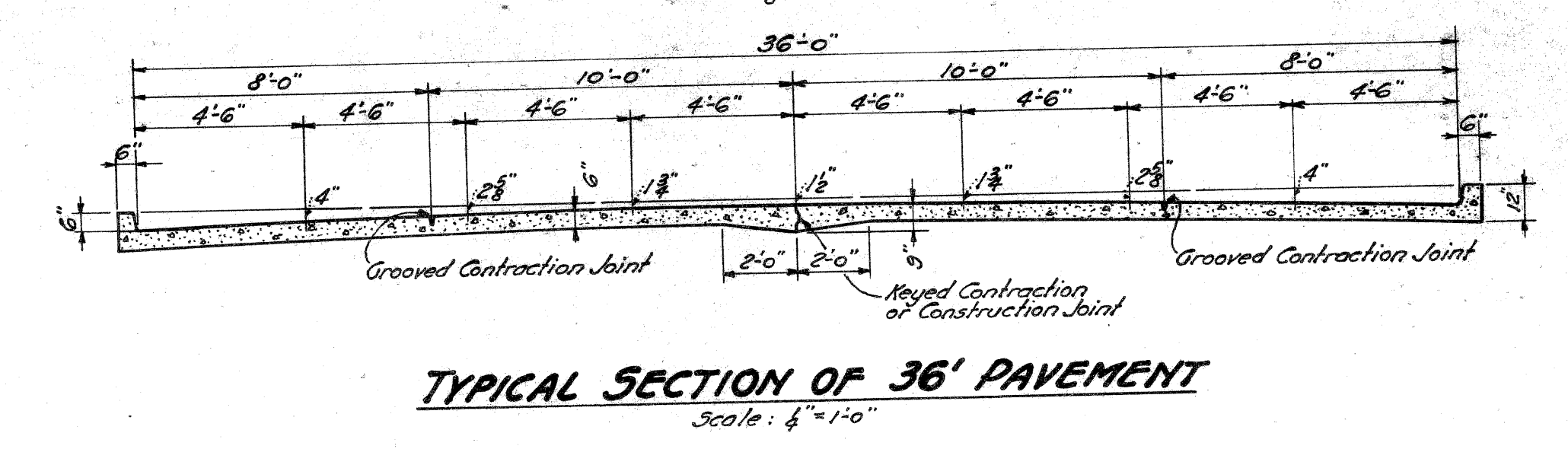
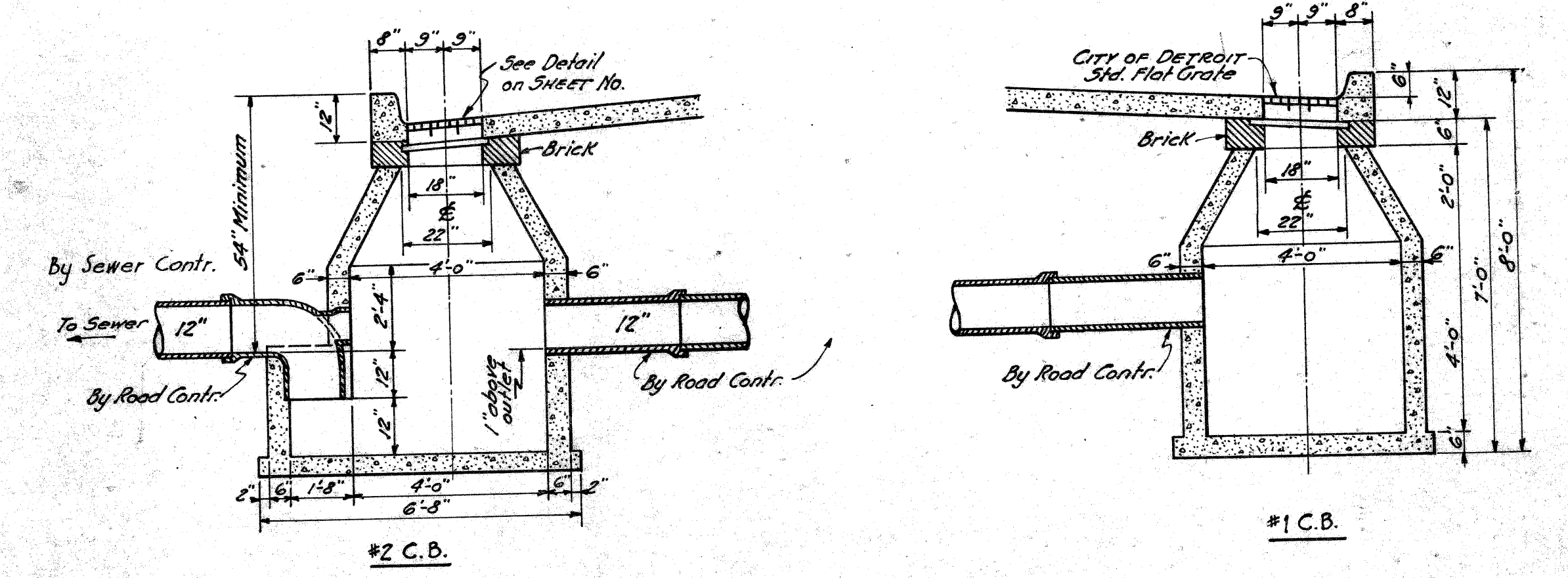
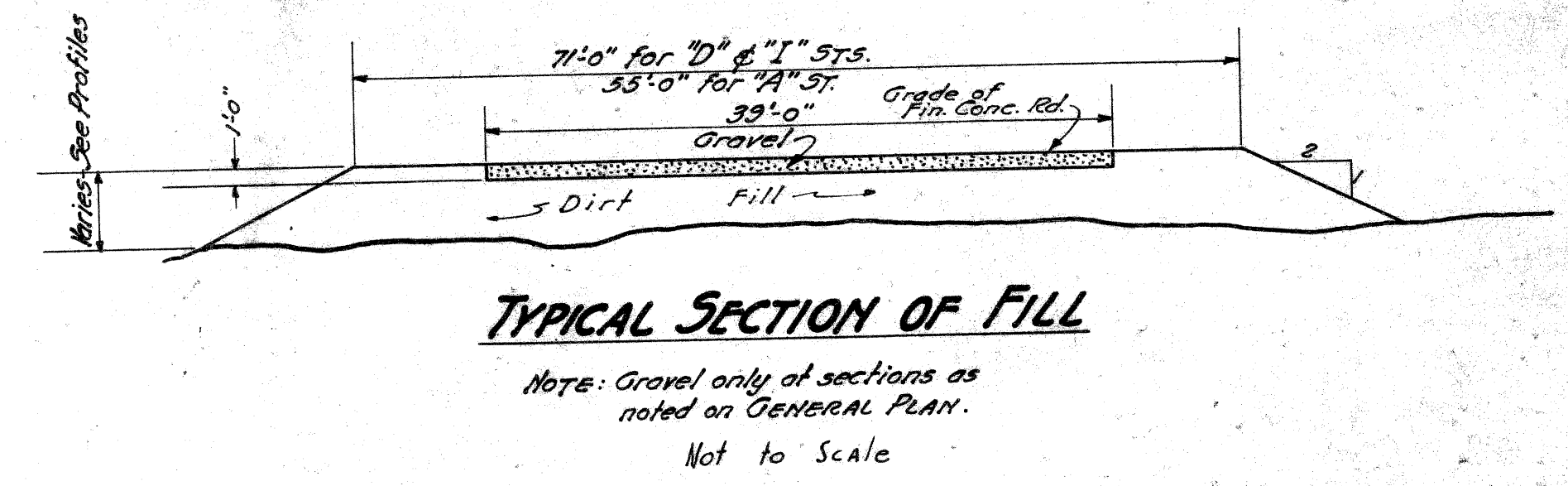
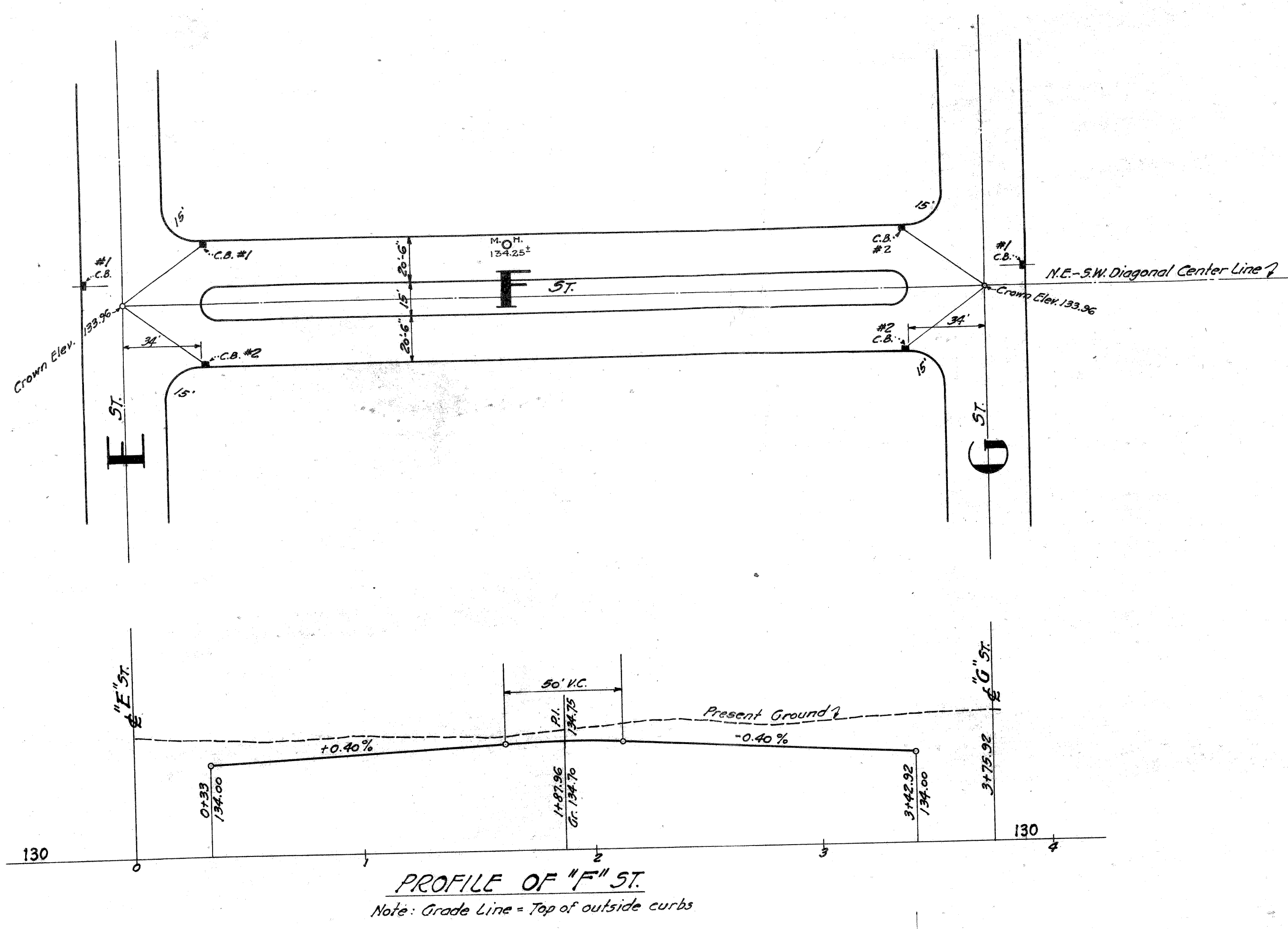
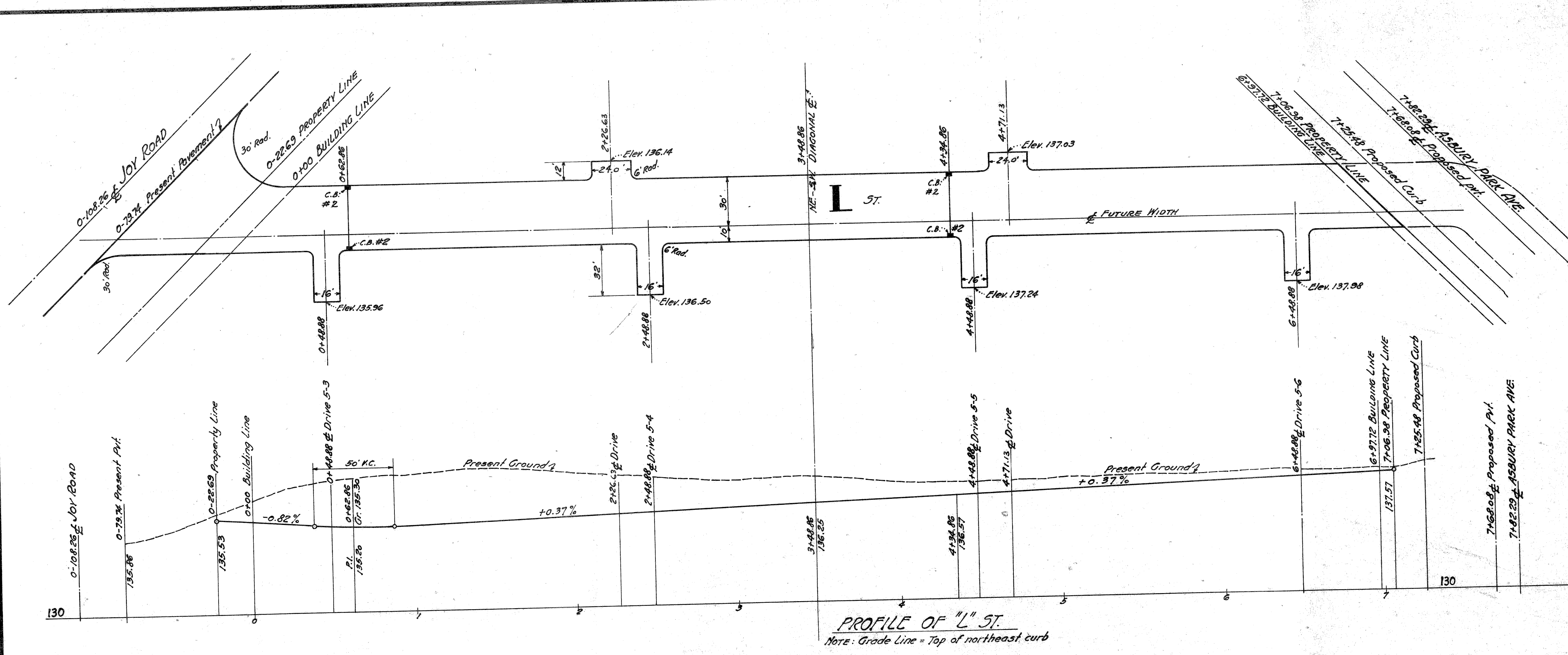

REVISIONS	DATE NO.	DESCRIPTION	APP'D.	DEPT.	CHK'D.	APP'D.	DATE

PLAN AND PROFILES STREETS F AND L
 TYPICAL SECTIONS AND DETAILS

GEORGE D. MASON ASSOCIATES ARCHITECTS & ENGINEERS
 L. G. LINNARD & E. A. EICHSTEDT ASSOCIATED LANDSCAPE ARCHITECTS
 409 GRISWOLD STREET DETROIT, MICHIGAN

S. JAMES HERMAN GARDENS U.S.A. PROJECT MICH. 1-4
 FOR THE DETROIT HOUSING COMMISSION
 CITY OF DETROIT, MICHIGAN

SHEET NO. **304**
 S-646

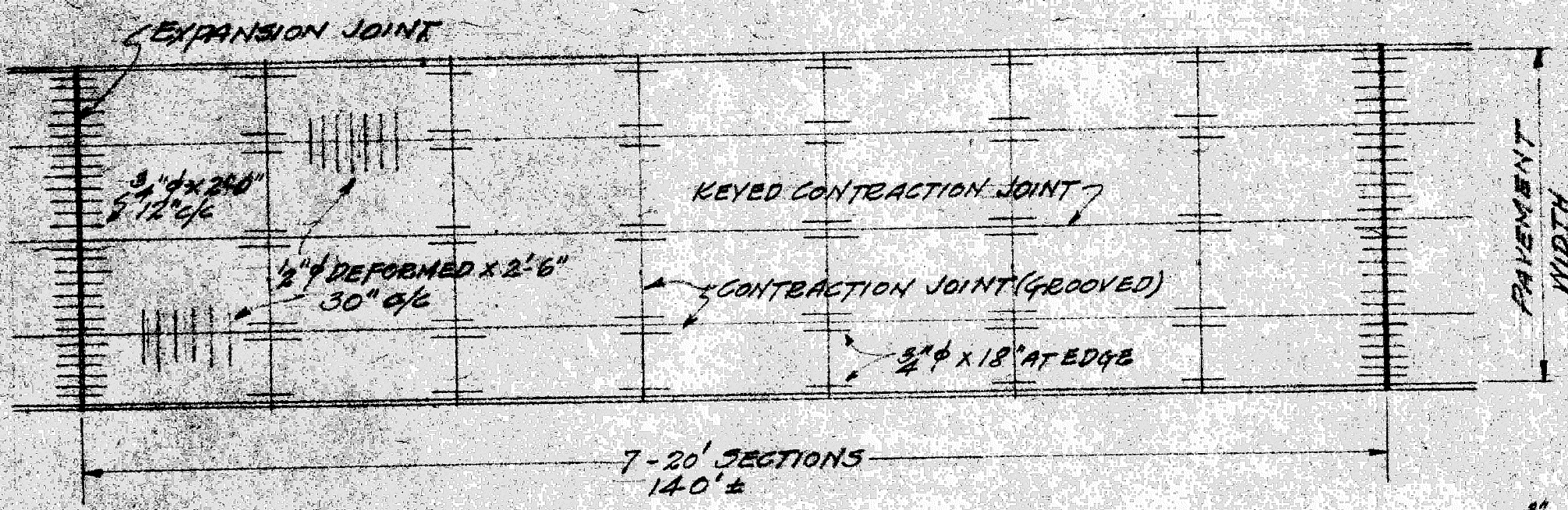
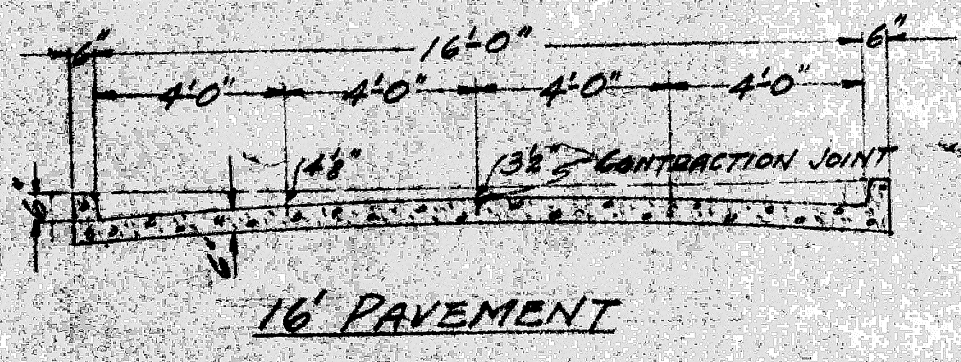
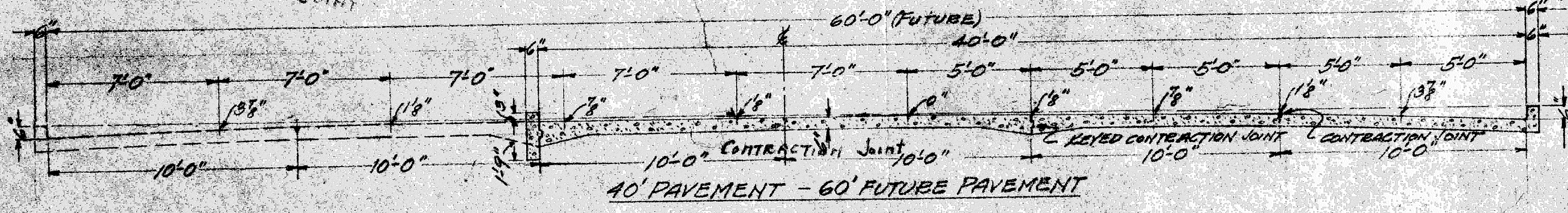
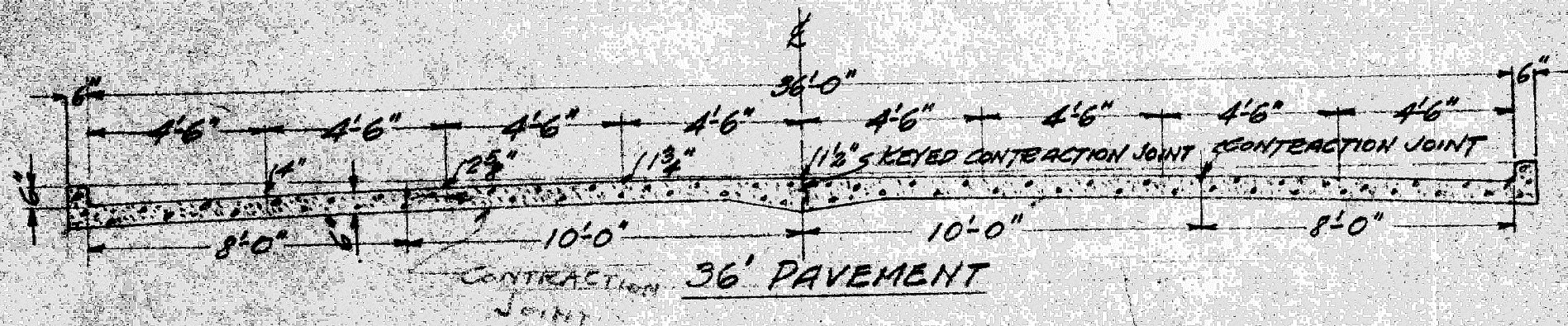

TYPICAL JOINTING PLAN
 (SEE SECTIONS FOR LOCATION)

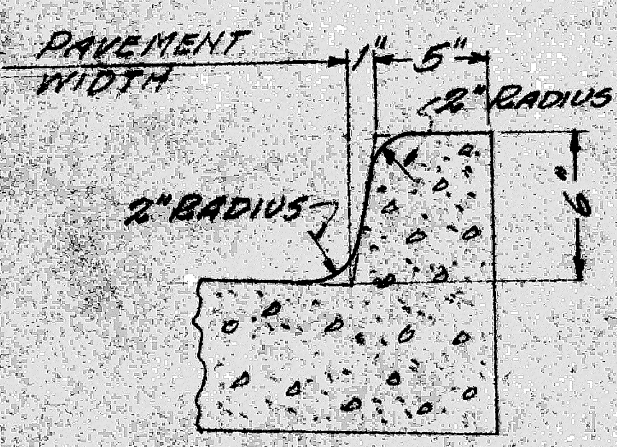
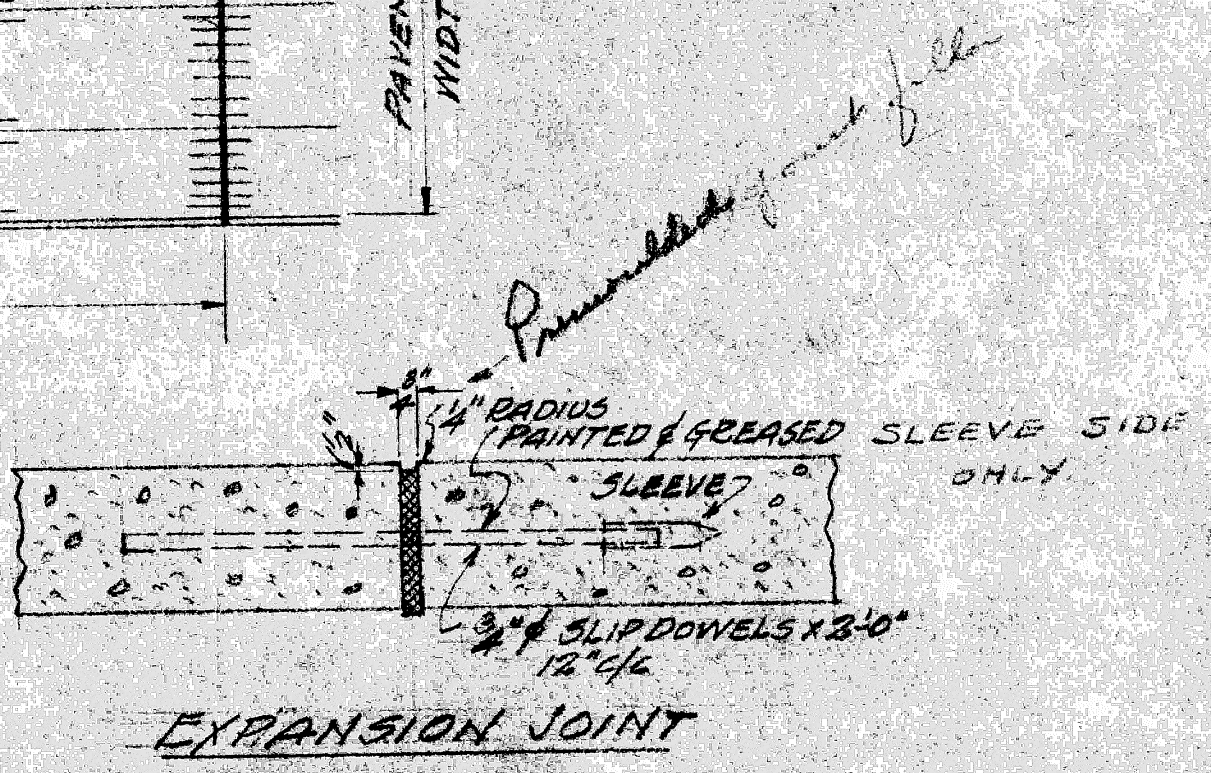

CURB SECTION

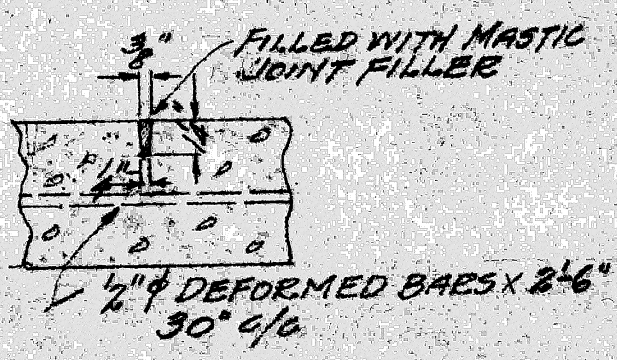

CONTRACTION JOINT GROOVED

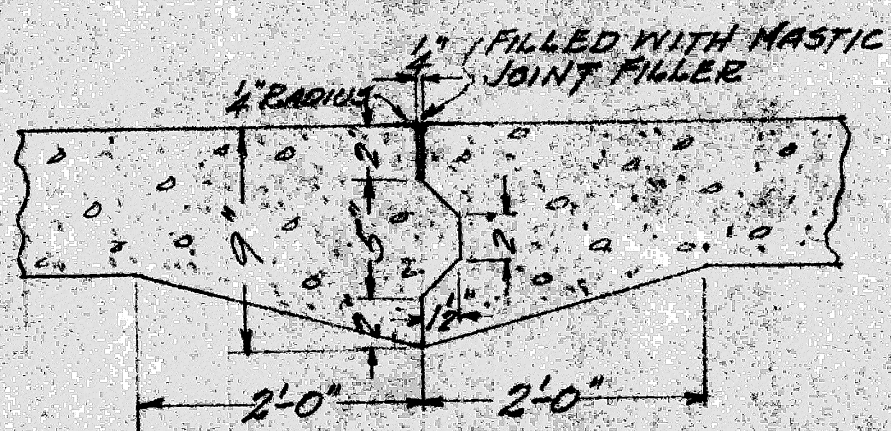

CONTRACTION JOINT KEYPED

FOUNDATIONS: Thoroughly drained & compacted to avoid settlement and frost action.

CONCRETE: See City of Detroit Planing Spec. for details of mix, min. 28 day compressive strength, etc.

APPROVED
 BY *J.P. Thompson* DATE *Feb 9, 1939*
 CITY ENGINEER
 BY *W. J. Williams* DATE *Jan 4, 1939*
 ENGINEER OF STREETS

TYPICAL PAVEMENT DETAILS

DETROIT HOUSING COMMISSION
 5. JAMES HERMAN GARDENS HOUSING PROJECT
 U.S.H.A. PROJECT NO. MICH. 1-A
 GEORGE D. MASON ASSOCIATES
 ARCHITECTS & ENGINEERS
 L.G. LINNARD & E.A. EICHSTEDT
 ASSOCIATED LANDSCAPE ARCHITECTS
 409 GRISWOLD ST. DETROIT, MICH.

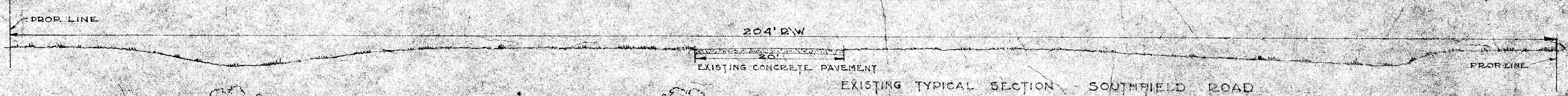
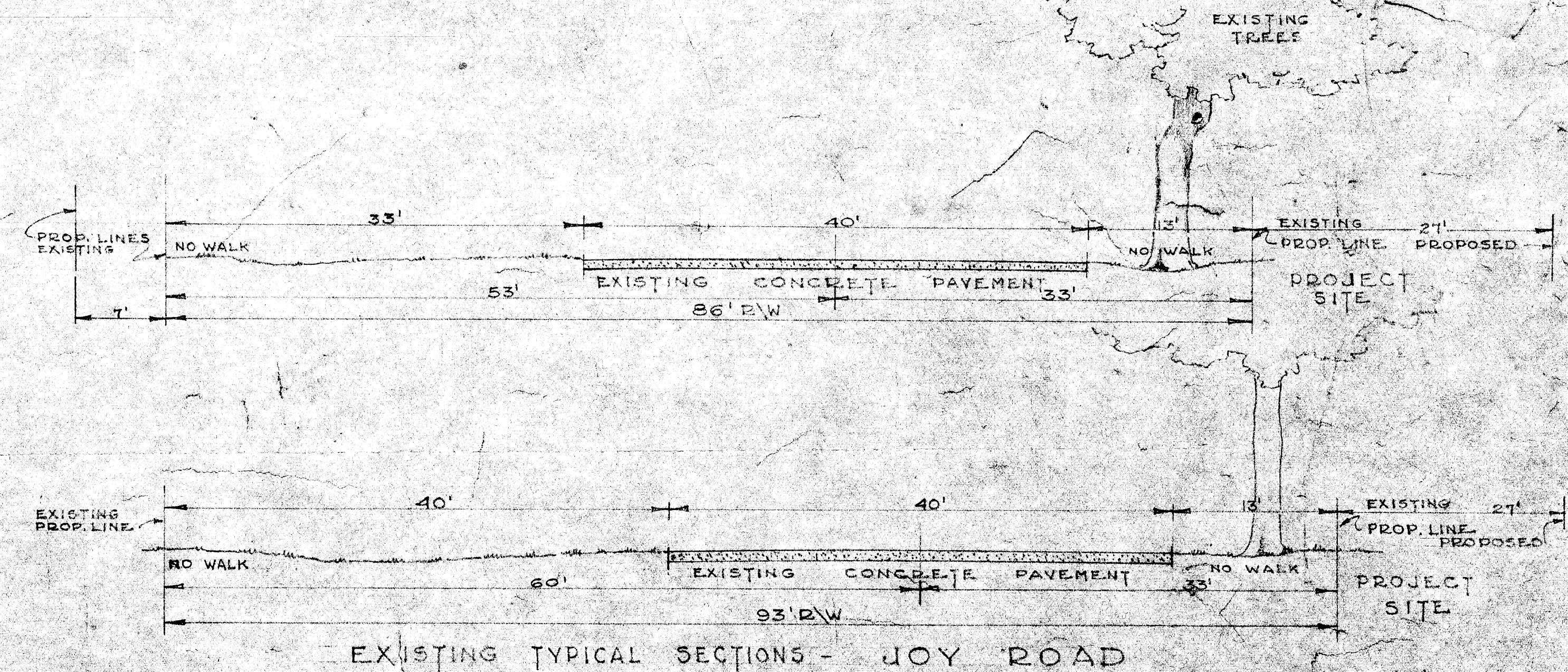
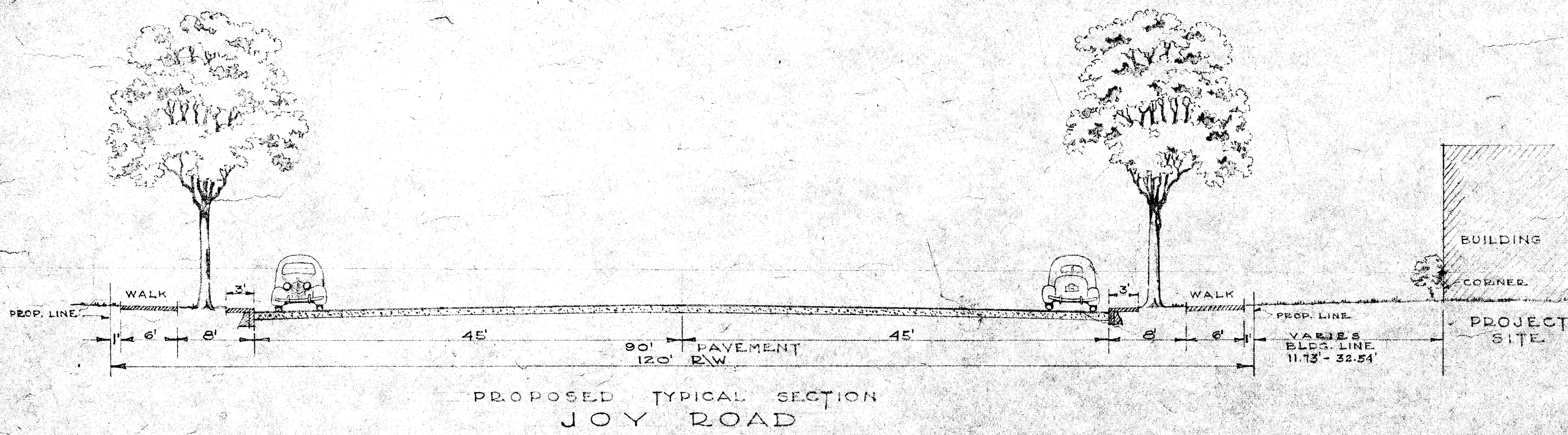
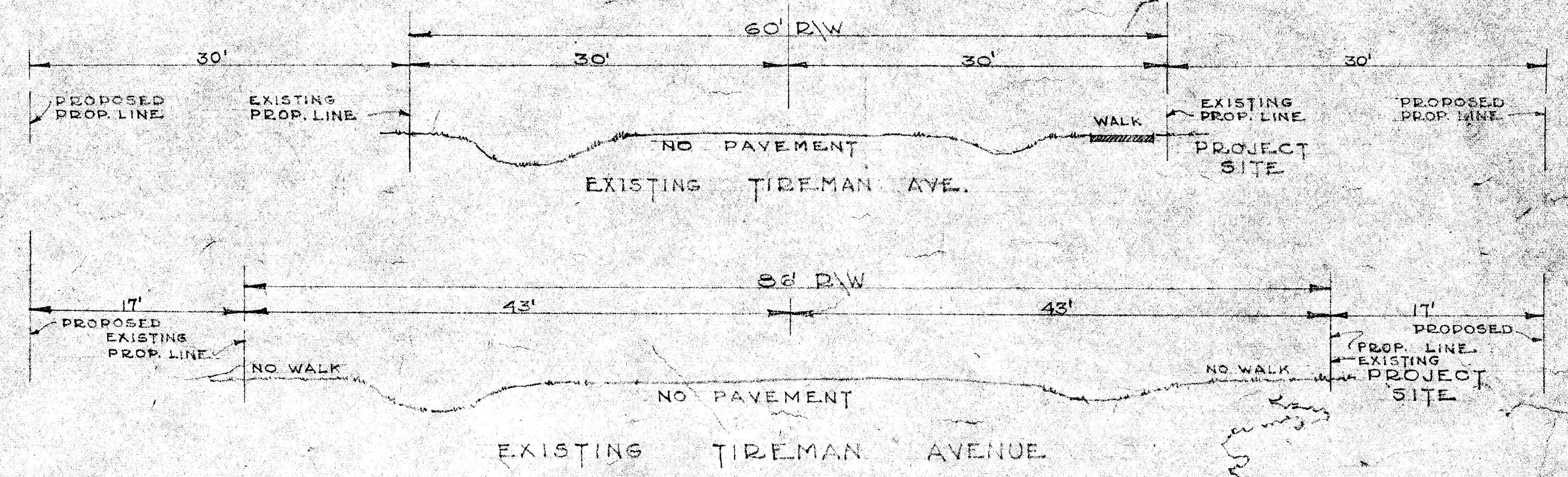
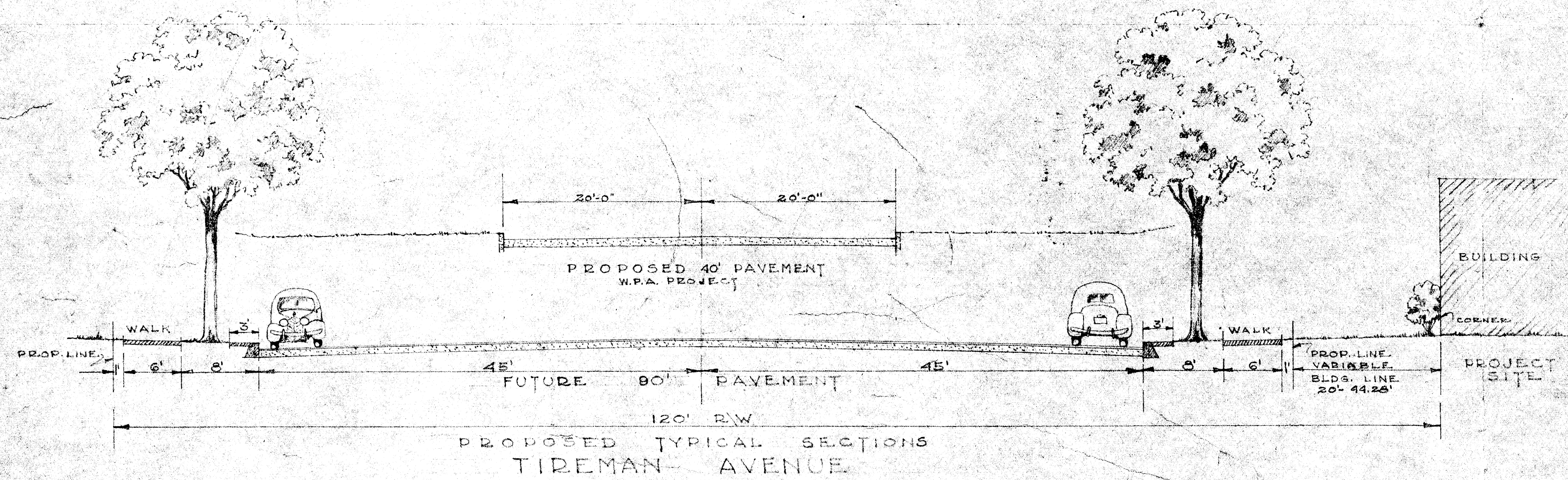
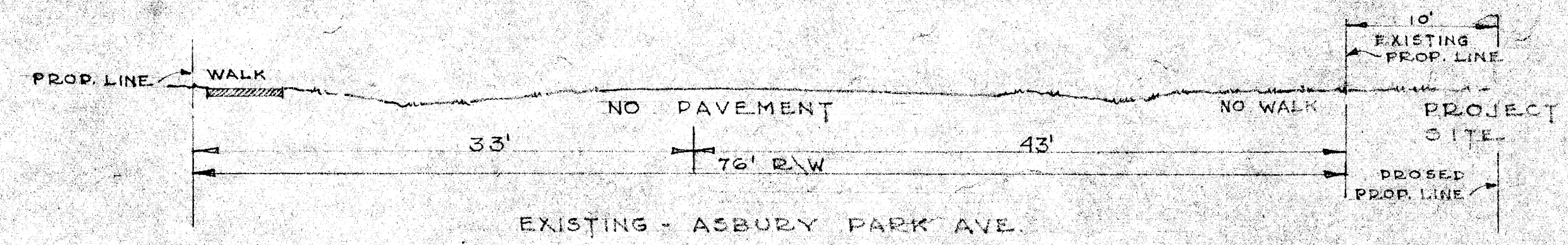
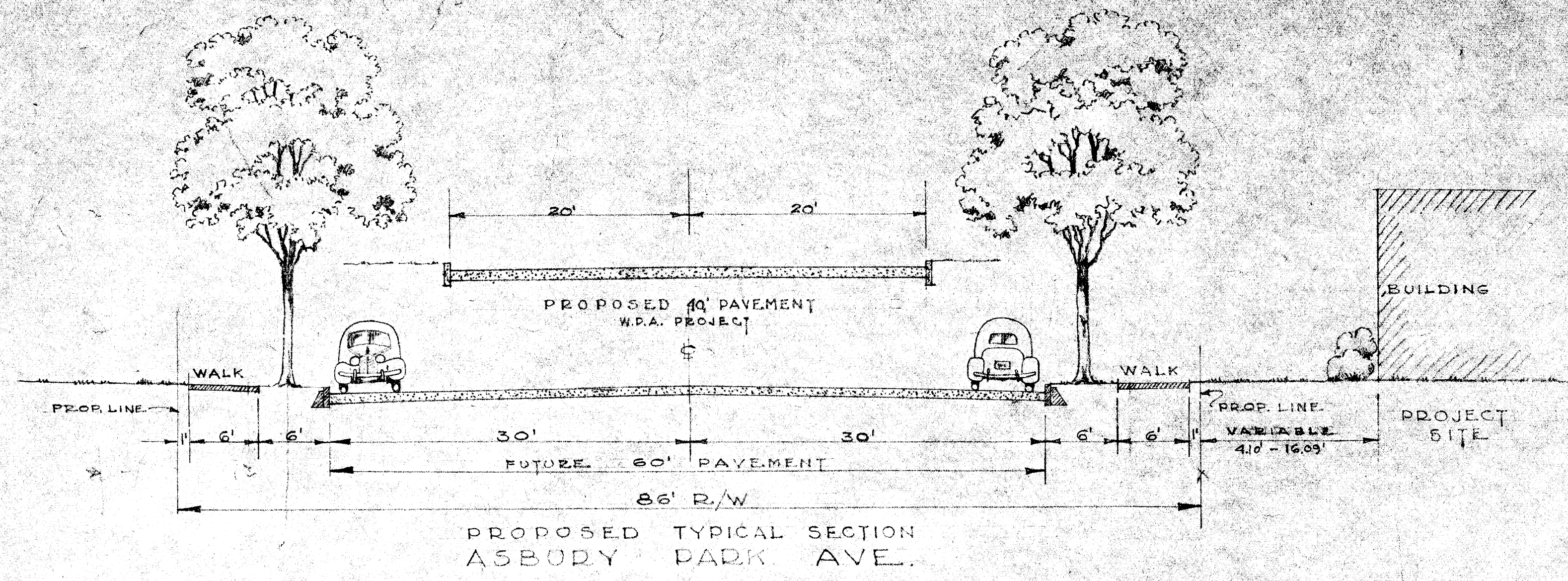

S. JAMES HEARNER GARDENS
HOUSING PROJECT PHASE 4

GEORGE HASON ASSOCIATES ARCHITECTS ENGINEERS
LEONARD E. F. ELLIOTT ASSOCIATES LANDSCAPE ARCHITECTS
404 BROADWAY ST. DETROIT, MICH.

SCALE: 1" = 20'