

Curve Data

Station	Delta	Radius	Tangent	Angle	Shift	P.C.
①	3° 25' 42"	1911.5'	57.21'	114.38'	38.23'	STA 2+11.86
②	3° 15' 42"	1968.5'	54.05'	112.06'	39.37'	STA 6+36.98

TYPE OF PAVEMENT 10:5:10 ONE COURSE CONCRETE
 INTEGRAL CURBS 33 FT. WD. 10" UNIFORM AT INTER-
 SECTION EXCEPT AS NOTED.

- BENCH MARKS**
- P.L.B.M. # 62-250A NE. COR. CONNER & AVONDALE EL. 94.0138
 - C.B.M. # HYD. COR. AVONDALE & CONNER EL. 97.35
 - C.B.M. # 444 NAVAHOE EL. 97.07
 - C.B.M. R.R. SPK. DET. ED. POLE NE COR. KITCHENER & AVONDALE EL. 95.62

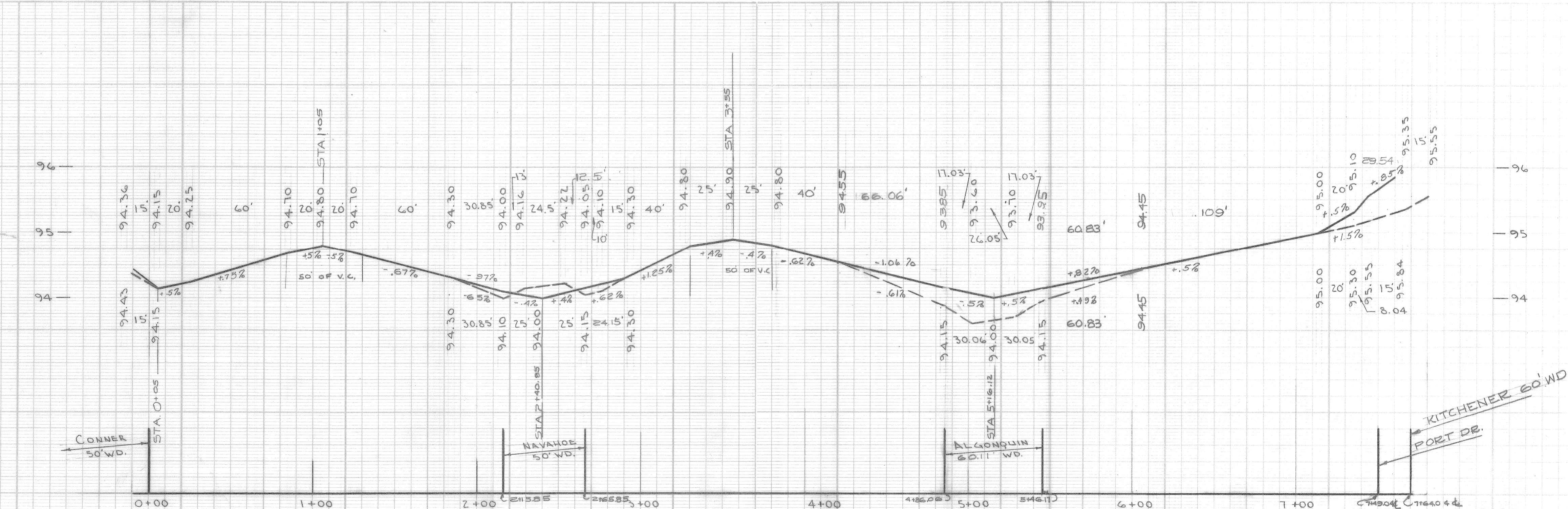

REFERENCE DRAWINGS	DESIGNED BY	APPROVED:
ADDED GAS LINE AT NAVAHOE 7/15/68	W. J. ...	J. Erickson
ADDED GAS LINE 7/15/68	L. Chipman	W. A. ...
ADDED P.L.C. LINES & M.I. TO AVONDALE 2.12.68
	SEWERS APPROVED	ADMINISTRATIVE ENGINEER
	FINAL CHECK	REVIEW
		HEAD CIVIL ENGINEER

CITY OF DETROIT
 DEPARTMENT OF PUBLIC WORKS
 CITY ENGINEERS OFFICE
 FOR
 DETROIT BOARD OF EDUCATION

PAVING OF RELOCATED AVONDALE
 FROM CONNER TO KITCHENER
 PAVING PLAN

SCALE

HORIZONTAL	1" = 40'
VERTICAL	1" = 1'
INDEX NO	TOP NO
31	62

SHEET 3 OF 3 SHEETS
 P.W. NO. 7227
 M.O. NO. 2-700
 DATE JULY 22, 1968