

CITY OF DETROIT
 COLEMAN A. YOUNG - MAYOR
 CITY ENGINEERING DEPARTMENT

PLANS FOR PROPOSED
 PAVING AND MISCELLANEOUS CONSTRUCTION
 ON WEST GRAND BOULEVARD
 FROM TOLEDO TO 800' NORTH OF TOLEDO

INDEX OF SHEETS

- 1 TITLE SHEET
- 2 PAVING PLAN
- 3 QUANTITY SHEET

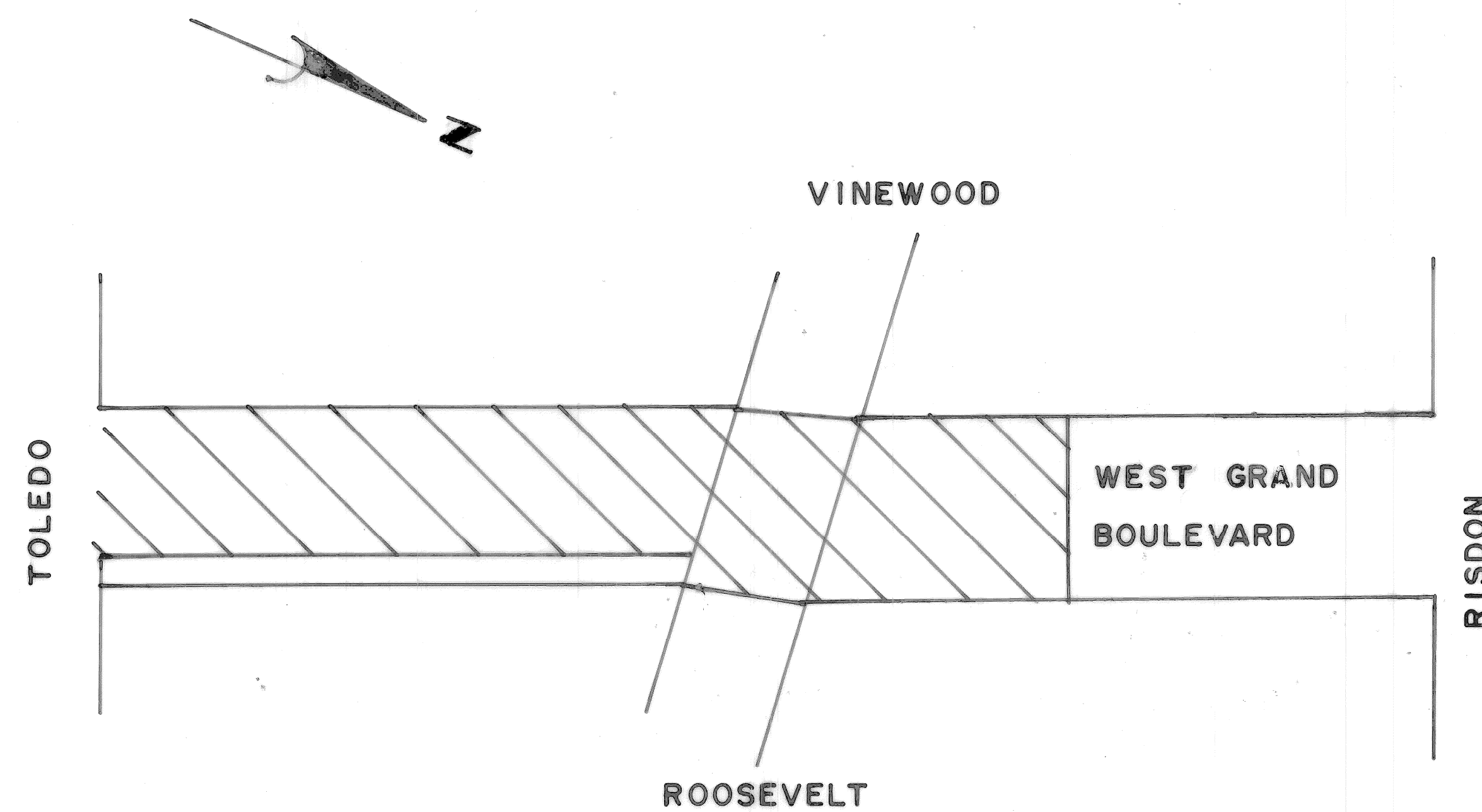

CONSTRUCTION AREA

W. GRAND BLVD.

PROJECT: PAVING AND MISCELLANEOUS CONSTRUCTION ON WEST GRAND BOULEVARD FROM TOLEDO TO 800' NORTH OF TOLEDO	CONTRACT NO. PW- 6675R
---	----------------------------------

PLANS PREPARED BY
 CITY ENGINEERING DEPARTMENT

RECOMMENDED FOR APPROVAL	 ENGINEER OF INSPECTION	11-5-84 DATE
RECOMMENDED FOR APPROVAL	 ENGINEER OF STREETS	1/5/84 DATE
APPROVED	 ASSISTANT CITY ENGINEER	1/5/84 DATE
APPROVED	 DIRECTOR	1-5-84 DATE

DATE 1-5-84	DRWG. NO. 1 OF 3
-------------	------------------

NOTE #5
 CONSTRUCT NEW 'BT' CATCH BASINS @ STA 3+00 AND STA 9+50 ON BOTH SIDES OF WEST GRAND BOULEVARD AND CONNECT INTO EXISTING SEWER LINES

- LEGEND**
- ▨ SIDEWALK REPLACEMENT REMOVING BITUMINOUS SURFACE
 - ▨ SEPARATE TYPE CURB REPLACEMENT-NON-REINF.
 - ⊙ ADJUST EXISTING CATCH BASINS-SEE NOTE #3
 - ⊙ ADJUST EXISTING MANHOLES
 - ⊙ CONSTRUCT STD. CATCH BASIN
 - ⊙ RESET EXISTING CATCH BASIN
 - ⊙ RESET EXISTING MANHOLES
 - ⊙ SIDEWALK RAMP TYPE III
 - ⊙ SIDEWALK RAMP TYPE I
 - ⊙ REMOVE AND CONSTRUCT NEW 'BT' CATCH BASIN-SEE NOTE #5

BENCH MARKS

MARKS	ELEV
P.B.M. #19-252 N.W. COR. RISON & 24 TH	118.02
P.B.M. #19-251B N.E. COR. RISON & VINEWOOD	115.98
C.B.M. #HYD. S.E. COR. RISON & ROOSEVELT	120.93
C.B.M. #HYD. S.E. COR. RISON & W. GD. BLVD.	120.28
C.B.M. #HYD. 1/2 W. GD. BLVD. 150' S. OF RISON	117.28
C.B.M. #HYD. 1/2 W. GD. BLVD. 75' N. OF R.R. VIADUCT	109.49
C.B.M. #HYD. 1/2 W. GD. BLVD. 42' S. OF R.R. VIADUCT	107.69
C.B.M. #HYD. 1/2 W. GD. BLVD. 225' N. OF TOLEDO	116.31
C.B.M. #HYD. N.W. COR. W. GD. BLVD. @ TOLEDO	120.34
C.B.M. #HYD. 1/2 RISON @ ALLEY W. OF W. GD. BLVD.	120.18

HORIZONTAL CONTROL

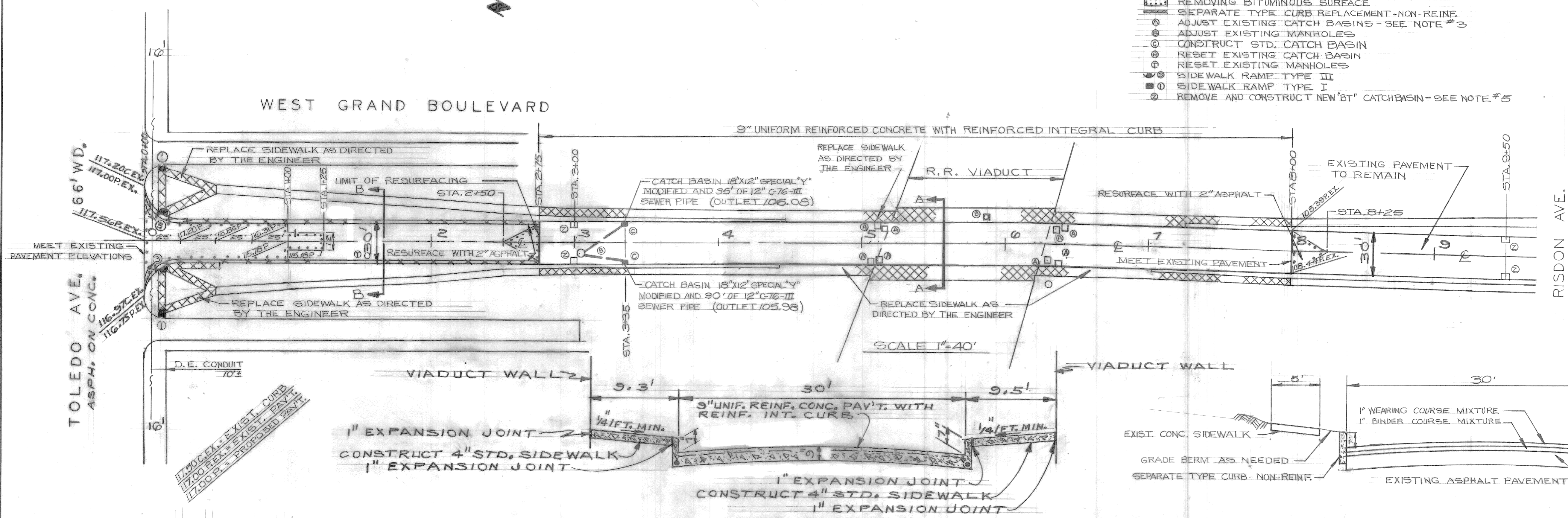

- NOTES**
- ALL CURB HEIGHTS ARE 7" UNLESS OTHERWISE INDICATED OR AS DIRECTED BY THE ENGINEER
 - REPLACE SIDEWALKS AT LOCATIONS SHOWN ON THE DRAWING OR AS DIRECTED BY THE ENGINEER
 - ADJUST CATCH BASINS AT STA. 6+30 ON E/S AND STA. 6+35 ON W/S TO INSURE PROPER DRAINAGE
 - CONSTRUCT CATCH BASIN 'A' @ COR. OF WEST GRAND BOULEVARD & RISON AND CONNECT INTO EXIST. CATCH BASIN
 - SEE NOTE #5 IN BOX AT TOP OF SHEET.

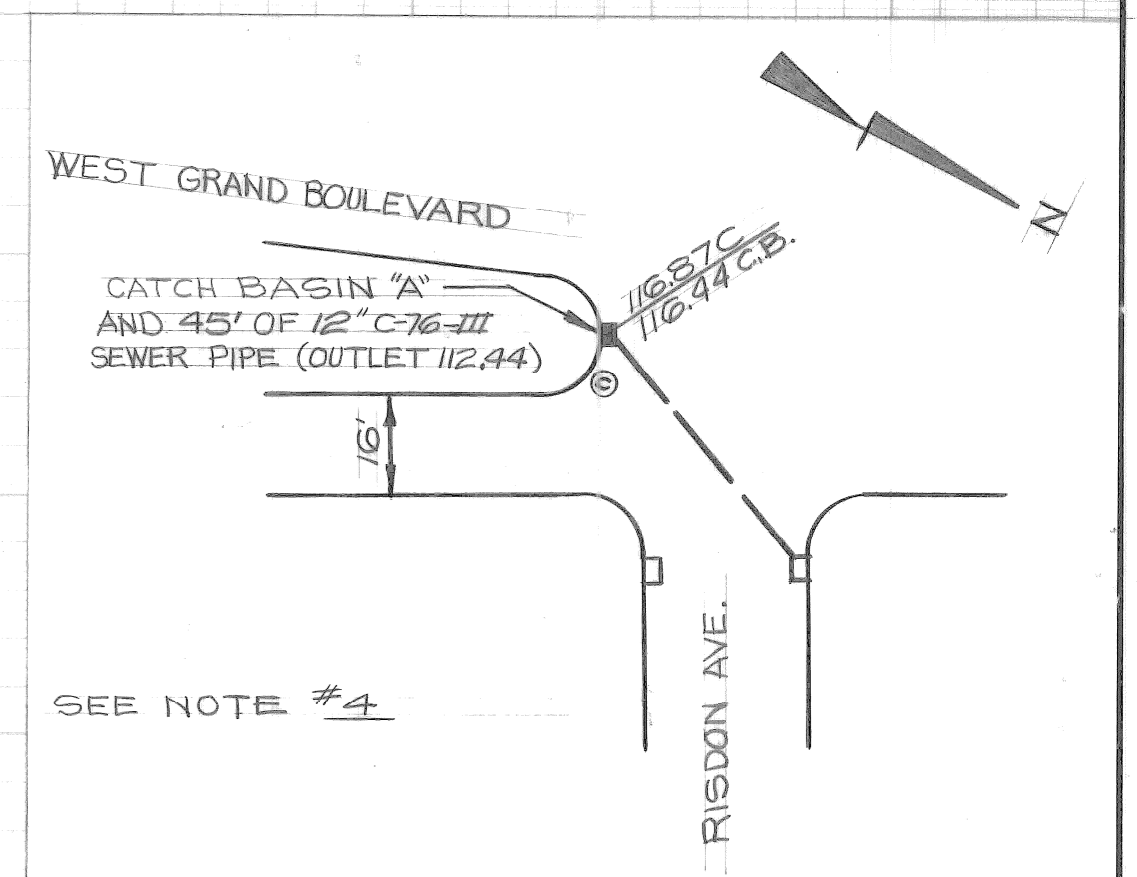
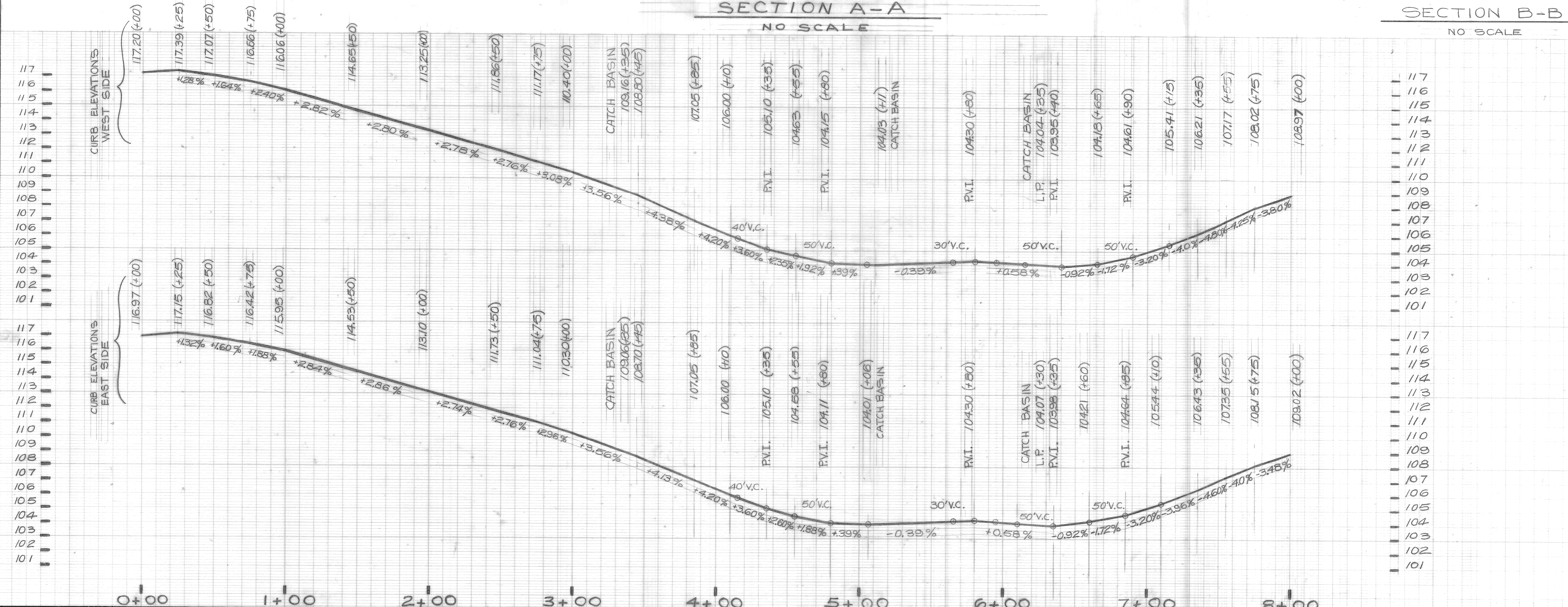

Sewer Design Approval
 P. D. Dwyer
 7/18/82

PLAN BY D. G. U. CHECKED BY TALLEY APPROVED: Naim J. Sawalas ENGINEER OF STREETS		CITY OF DETROIT CITY ENGINEERING DEPARTMENT BUREAUS OF STREETS AND HIGHWAYS FOR W. GRAND BLVD.	PAVING AND MISCELLANEOUS CONSTRUCTION ON WEST GRAND BOULEVARD FROM TOLEDO TO 800' NORTH OF TOLEDO PAVING PLAN	INDEX NO. 42 SHEET 2 OF 3 SHEETS CONTRACT NO. PW-6675R ASSIGNMENT NO. 81-22-08 DATE 1-5-84
GRADE BY D. G. U. CHECKED BY TALLEY ESTIMATE CHECK TALLEY REVIEW				
REVISIONS		CITY ENGINEER		

ITEM NO.	DESCRIPTION OF ITEM	UNIT	TOTAL																	
	EXCAVATION	CYDS.	375																	
	FILL (GRADE A)	CYDS.	39																	
	MANHOLE ADJUSTMENT	EACH	2																	
	REMOVING EXISTING CATCH BASINS	EACH	4																	
	CATCH BASIN ADJUSTMENT	EACH	8																	
	REMOVE EXISTING CONCRETE BASE	SYDS	30																	
	REPLACEMENT CONCRETE BASE WITH GRADE A CONCRETE	SYDS	30																	
	CATCH BASIN - "A"	EACH	1																	
	CATCH BASIN - 18" X 12" SPECIAL "Y" MODIFIED	EACH	2																	
	CATCH BASIN "B" WITH TRAP	EACH	4																	
	SEWERS - 12" PIPE C-76-III	LFT	65																	
	SEWERS UNDER PAVEMENT - 12" PIPE C-76-III	LFT	45																	
	PAVEMENT - 5" UNIFORM REINFORCED CONCRETE WITH REIN. INTEGRAL CURB	SYDS	1808																	
	TEST CORES	EACH	2																	
	6" SIDEWALK REPLACEMENT	SFT	172																	
	CONCRETE SAWING	LFT	100																	
	4" SIDEWALK REPLACEMENT	SFT	7818																	
	SEPARATE TYPE CURB REPLACEMENT - NON-REINFORCED	LFT	578																	
	CLEANING	SYDS	467																	
	CONDITIONING	SYDS	95																	
	REMOVING BITUMINOUS SURFACE	SYDS	480																	
	RESETTING MANHOLES	EACH	1																	
	CLEANING STRUCTURES	EACH	1																	
	BITUMINOUS BOND COAT	GALS	149																	
	MAINTAINING TRAFFIC	LUMP SUM	LUMP SUM																	
	SOD REPLACEMENT	SYDS	450																	
	RESURFACING MIXTURE IN PLACE (NATURAL AGGREGATE)																			
	A) FINE BINDER COURSE MIXTURE - 25A	TONS	82																	
	RESURFACING MIXTURE IN PLACE (BLAG AGGREGATE)																			
	A) FINE BINDER COURSE MIXTURE - 25A	TONS	75																	
	B) WEARING SURFACE MIXTURE - 31A(CD)	TONS	55																	

COORD. DESCRIPTION DR'N CK'D AP'VD DATE REVISIONS LOCATED BY COORDINATES ON SHEET		REFERENCE DRAWINGS DESIGNED BY DRAWN BY JONES TRACED BY CHECKED BY	APPROVED: <i>Norm O'Neil</i> ENGINEER OF STREETS	CITY OF DETROIT CITY ENGINEERING DEPARTMENT BUREAUS OF STREETS AND HIGHWAYS FOR W. GRAND BLVD.	PAVING AND MISCELLANEOUS CONSTRUCTION ON WEST GRAND BOULEVARD FROM TOLEDO TO 800' NORTH OF TOLEDO QUANTITY SHEET	SHEET 3 OF 3 SHEETS CONTRACT NO. PW-6675R ASSIGNMENT NO. 81-22-08 DATE 1-5-84
--	--	--	--	--	---	--