

- NOTES**
- BEFORE STARTING CONSTRUCTION-CONTRACTOR MUST CHECK WITH UTILITIES FOR LOCATIONS OF EXISTING STRUCTURES WHETHER OR NOT INDICATED ON THE PLANS.
 - REPLACE ALL CURBS IN THIS CONTRACT EXCEPT AS INDICATED.
 - CONSTRUCT INTEGRAL CURB AND SIDEWALK IN THIS CONTRACT EXCEPT AT TREE LOCATIONS-SEE DETAIL THIS SHEET.
 - BACKFILLING OF THE BEEM AREA WITH SELECTED EXCAVATED MATERIAL OR TOPSOIL SHALL BE INCIDENTAL TO THE COST OF BEEM GRADING.
 - THE REPLACEMENT OF WALKS AND DRIVES SHALL BE AT SUCH LOCATIONS AS DESIGNATED BY THE ENGINEER.
 - FOR DETAILED QUANTITIES AND CROSS-SECTIONS SEE SHEET # 2.
 - FOR UTILITY LEGEND SEE STD. DET. DWG. NO. G-202-A
 - WHERE SIDEWALK REPLACEMENT IN DRIVEWAY AREA IS DIRECTED BY THE ENGINEER CONSTRUCT 6" SIDEWALK

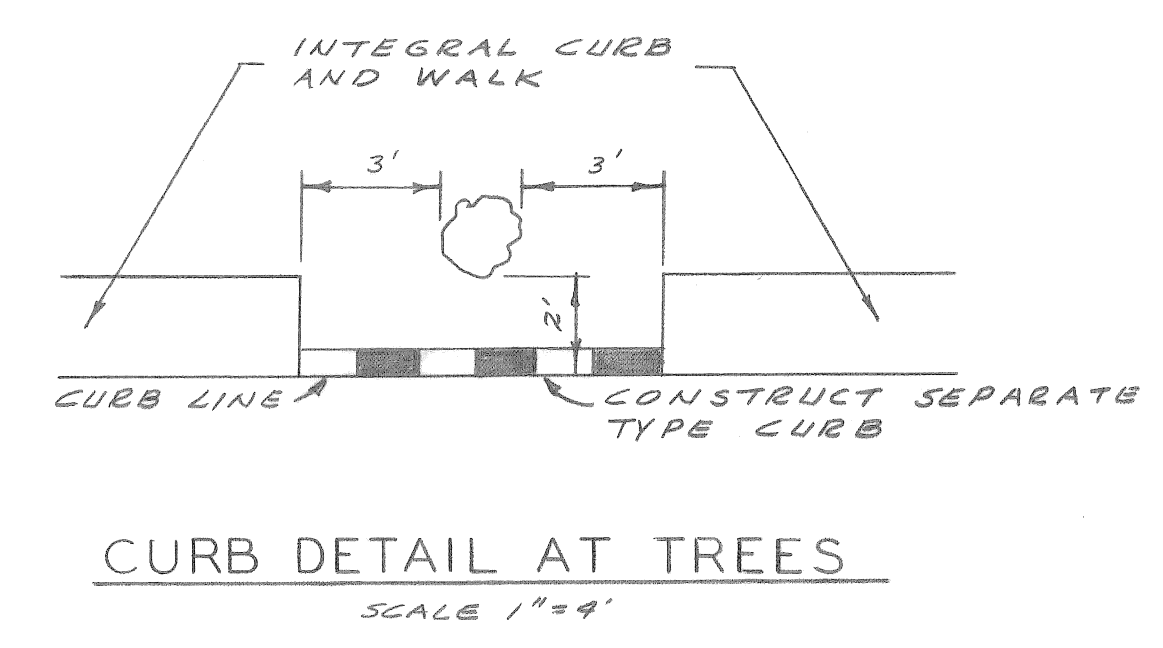

SCALE: 1" = 40'

46806

1973 - GROUP NO. 1

DESIGNED BY <i>TALLEY</i>		APPROVED: <i>J. Prichard</i> ENGINEER OF STREETS		CITY OF DETROIT DEPARTMENT OF PUBLIC WORKS CITY ENGINEERS OFFICE FOR COMMUNITY DEVELOPMENT COMMISSION	CURB AND WALK REPLACEMENT ON: PHILADELPHIA-FROM TWELFTH TO JOHN C. LODGE WEST SERVICE DRIVE VIRGINIA-PARK FROM BYRON TO JOHN C. LODGE WEST SERVICE DRIVE SEWARD-FROM WOODROW WILSON TO JOHN C. LODGE WEST SERVICE DRIVE VIRGINIA PARK N DP MICH. A-4-2	SHEET 3 OF 4 SHEETS	
DRAWN BY <i>TALLEY</i>		APPROVED: <i>Allen E. Regan</i> ENGINEER OF EXPRESSWAYS				CONTRACT NO. PW 6529	
TRACED BY		CHECKED BY <i>DE. M. N. K...</i>				ASSIGN. NO. AO 2132	
REVISIONS LOCATED BY COORDINATES ON SHEET		DATE 12-21-72				PLAN	

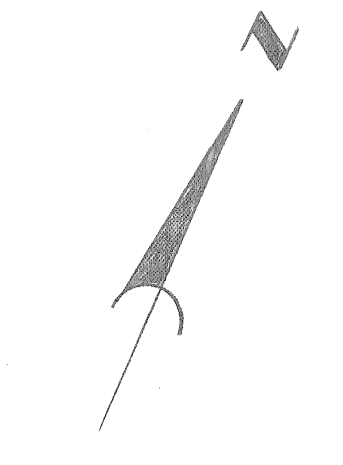
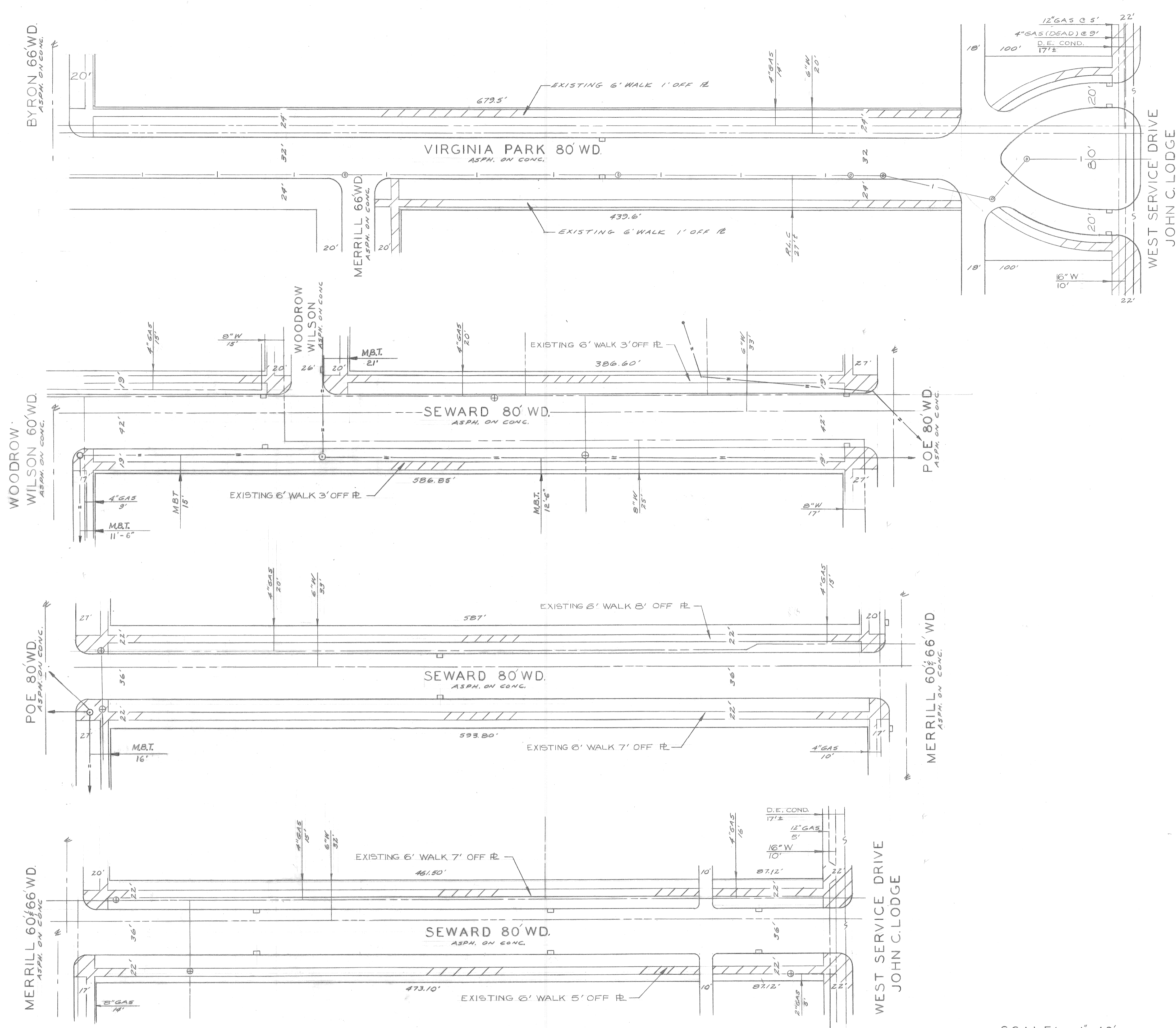

FOR NOTES SEE SHEET 2 OF 4

SCALE: 1" = 40'

446377

1973 - GROUP NO. 1

DESIGNED BY	TALLEY
DRAWN BY	TALLEY
TRACED BY	
CHECKED BY	D.E.M. N. KANWIS
APPROVED:	<i>J. Erickson</i> ENGINEER OF STREETS
	<i>Allen R. Payne</i> ENGINEER OF EXPRESSWAYS

CITY OF DETROIT
 DEPARTMENT OF PUBLIC WORKS
 CITY ENGINEERS OFFICE
 FOR
 COMMUNITY DEVELOPMENT COMMISSION

CURB AND WALK REPLACEMENT ON:	
PHILADELPHIA-FROM TWELFTH TO JOHN C. LODGE WEST SERVICE DRIVE	
VIRGINIA PARK - FROM BYRON TO JOHN C. LODGE WEST SERVICE DRIVE	
SEWARD-FROM WOODROW WILSON TO JOHN C. LODGE WEST SERVICE DRIVE	
VIRGINIA PARK NDP MICH. A-4-2	
SHEET	4 OF 4 SHEETS
CONTRACT NO.	PW 6529
ASSIGN. NO.	AO 2132
DATE	12-21-72

PLAN