

CITY OF DETROIT
 DEPARTMENT OF PUBLIC WORKS
 CITY ENGINEERS OFFICE

PLANS FOR PROPOSED
 PAVEMENT REMOVAL AND MISCELLANEOUS CONSTRUCTION

PEMBROKE

PINEHURST TO ILENE
 FOR
 DETROIT BOARD OF EDUCATION

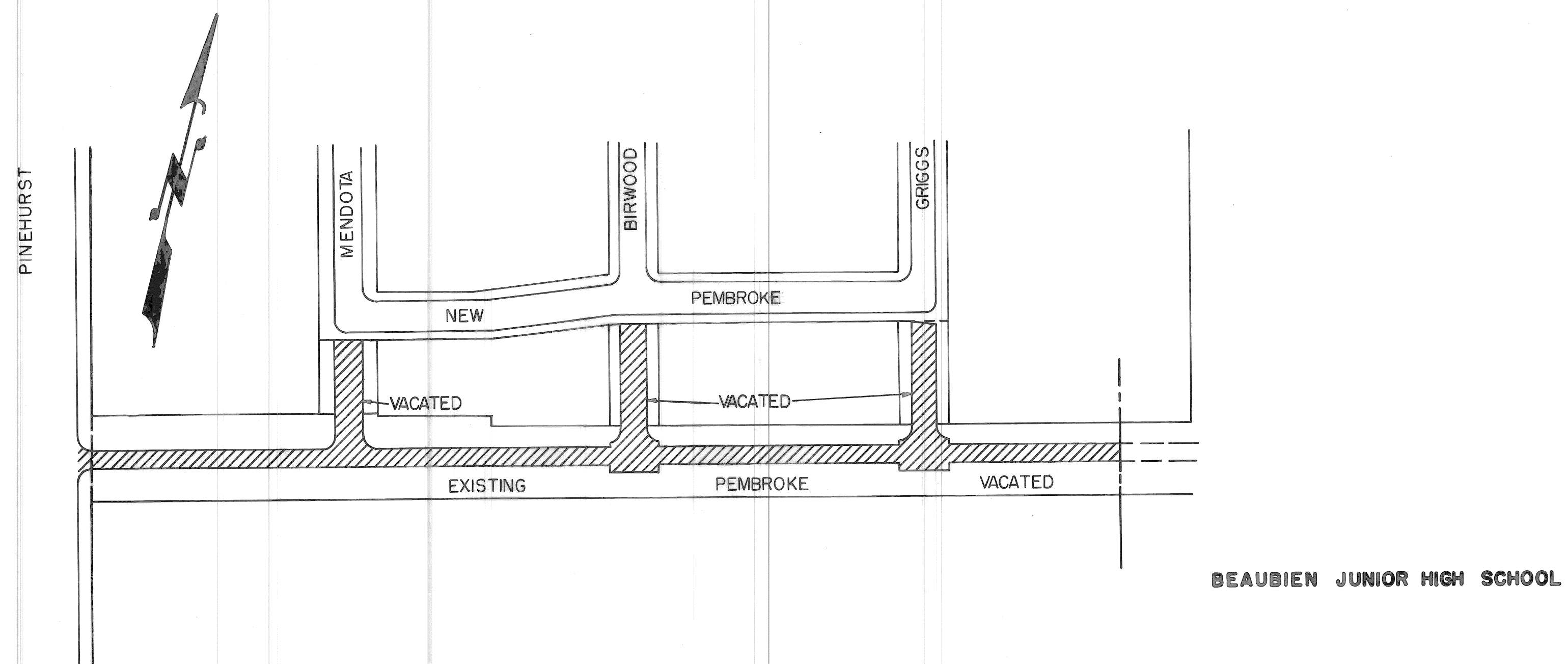

INDEX OF SHEETS

- 1 TITLE SHEET
- 2 REMOVAL PLAN & MISCELLANEOUS DETAILS

STREET PAVING STANDARDS ATTACHED

PROJECT: PAVEMENT REMOVAL AND MISCELLANEOUS CONSTRUCTION — PEMBROKE — PINEHURST TO ILENE		CONTRACT NO. PW 5768
PLANS PREPARED BY DEPARTMENT OF PUBLIC WORKS CITY ENGINEERS OFFICE		
RECOMMENDED FOR APPROVAL	<i>R. C. Monahan</i> ENGINEER OF INSPECTION	7-2-68 DATE
RECOMMENDED FOR APPROVAL	<i>Christopher C. Fedor</i> HEAD ENGINEER	6-28-68 DATE
APPROVED	<i>R. R. Hicke</i> ASSISTANT CITY ENGINEER	7-3-68 DATE
APPROVED	<i>Alfred Bernarducci</i> CITY ENGINEER	7-3-68 DATE
A.C.C. 2-18-69		
DATE JUNE 10 1968		DRWG. NO. 1 OF 2

GENERAL NOTES

BEFORE STARTING CONSTRUCTION, CONTRACTOR MUST CHECK WITH UTILITIES FOR LOCATIONS OF EXISTING STRUCTURES WHETHER OR NOT INDICATED ON THE DRAWING.

ALL TREES WITHIN THE RIGHT OF WAY ARE TO REMAIN.

THE REMOVAL OF EXISTING STONE AND OILED SURFACE WILL BE PAID FOR IN CUBIC YARDS OF EXCAVATION.

THE BULKHEADING OF EXISTING CATCH BASIN LINES WHICH ARE MARKED ON THE DRAWING IS INCIDENTAL TO THE COST OF ABANDONING CATCH BASINS.

REMOVAL LEGEND

- BULKHEAD EXISTING CATCH BASIN LINE
- STREET PAVEMENT REMOVAL (INCL. CURB)
- WALK REMOVAL
- EXCAVATION
- CONSTRUCT SEPARATE CURB

UTILITY LEGEND

- EXISTING PUBLIC SEWER LINE
- EXISTING WATER LINE
- EXISTING GAS LINE
- EXISTING LATERAL SEWER LINE
- EXISTING CATCH BASIN
- EXISTING SEWER MANHOLE
- EXISTING WATER MANHOLE
- EXISTING FIRE DEPARTMENT HYDRANT

CONSTRUCTION LEGEND

- CONSTRUCT STANDARD CATCH BASIN
- ADJUST EXISTING MANHOLE
- ABANDON EXISTING CATCH BASIN
- CONSTRUCT STANDARD 4' CONCRETE SIDEWALK

DESCRIPTION OF ITEM	PAY UNIT	QUANTITY
1. STREET PAVEMENT REMOVAL	SYDS.	11349
2. SIDEWALK REMOVAL	SFT.	19994
3. CONCRETE SLAB REMOVAL	SYDS.	20
4. REINFORCED CONCRETE SLAB REMOVAL	CYDS.	2
5. EXCAVATION	CYDS.	559
6. BERM GRADING	SYDS.	127
7. STREET GRADING	SYDS.	11005
8. FILL GRADE A	CYDS.	10
9. MANHOLE - ADJUSTMENT	EACH	7
10. MANHOLE - RECONSTRUCT CONE	EACH	1
11. CATCH BASIN - ABANDONMENT	EACH	4
12. CATCH BASIN - NEW	EACH	1
13. SEWER 12" PIPE	LFT.	65
14. PRIME COAT	GALS.	76
15. PAVING BASE COURSE	SYDS.	72
16. SEPARATE CURB TYPE II	LFT.	113
17. SIDEWALK 4' STANDARD	SFT.	912
18. RESURFACING MIXTURES IN PLACE (ALL NATURAL AGGREGATES) WEARING SURFACE MIX 31A	TONS	25
19. RESURFACING MIXTURES IN PLACE (ALL SLAG AGGREGATES) WEARING SURFACE MIX 31A	TONS	24

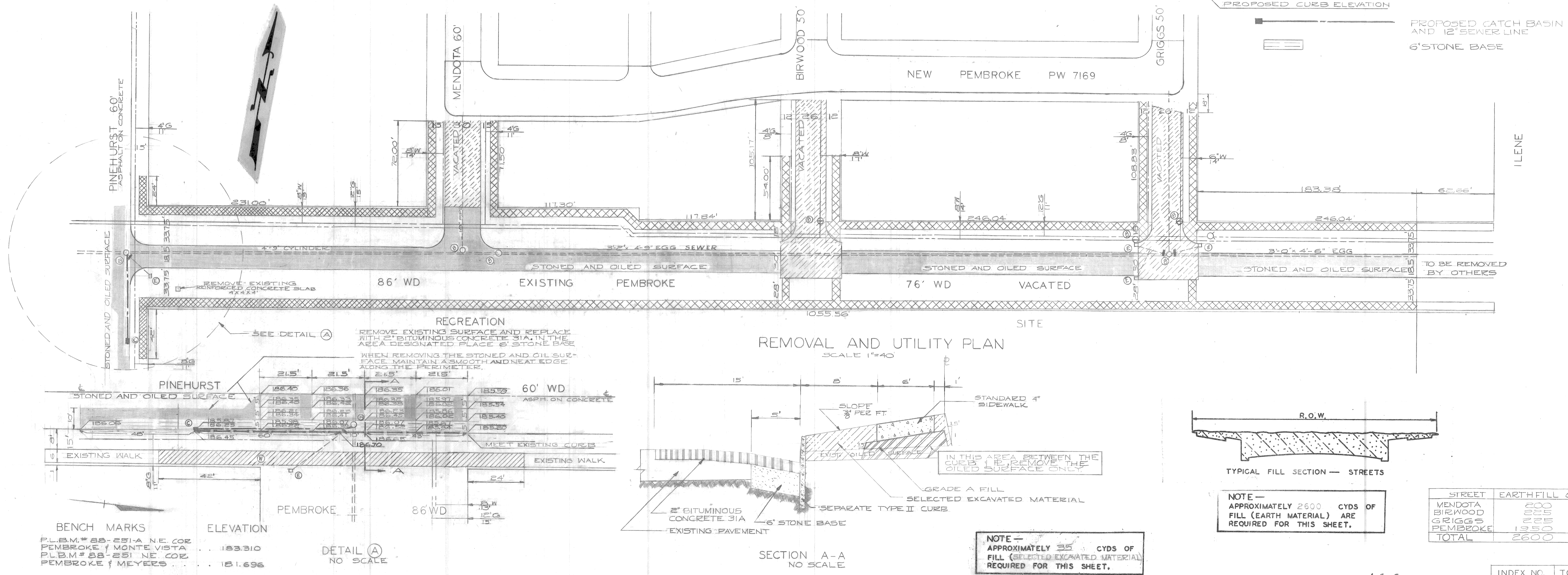

DESIGNED BY: <i>Walter J. Williams</i> DRAWN BY: <i>Walter J. Williams</i> SEWER APPR. BY: <i>Walter J. Williams</i> CHECKED BY: <i>Walter J. Williams</i>		APPROVED: <i>J. Erickson</i> ENGINEER OF STREETS <i>W. R. Bannard</i> ADMINISTRATIVE ENGINEER <i>A. L. Sedler</i> HEAD CIVIL ENGINEER		CITY OF DETROIT DEPARTMENT OF PUBLIC WORKS CITY ENGINEERS OFFICE FOR DETROIT BOARD OF EDUCATION	PAVEMENT REMOVAL AND MISCELLANEOUS CONSTRUCTION - PEMBROKE PINEHURST TO ILENE	INDEX NO. 61 SHEET 2 OF 2 SHEETS P.W. No. 5768 A.O. No. 1860 DATE 6-10-68
---	--	--	--	---	---	---

A.C.C. 2-18-69