

CITY OF DETROIT  
 City Engineering Department  
 MOUNT ELLIOT - MOUND ROAD  
 GRADE SEPARATION  
 GENERAL PLAN - PHASE I

SCALE: VERT. AS NOTED  
 HORIZ. AS NOTED  
 DATE: MARCH 23, 1953

REVISIONS	NAME	DATE

- ITEMS FOR PHASE I:
1. Remove existing concrete deck from Spans 1, 2, 3, 4, 5, 6, 7, 8, 9, 10, 11, 12, 13, 14, 15, 16, 17, 18, 19, 20, 21, 22, 23, 24, 25, 26, 27, 28, 29, 30, 31, 32, 33, 34, 35, 36, 37, 38, 39, 40, 41, 42, 43, 44, 45, 46, 47, 48, 49, 50, 51, 52, 53, 54, 55, 56, 57, 58, 59, 60, 61, 62, 63, 64, 65, 66, 67, 68, 69, 70, 71, 72, 73, 74, 75, 76, 77, 78, 79, 80, 81, 82, 83, 84, 85, 86, 87, 88, 89, 90, 91, 92, 93, 94, 95, 96, 97, 98, 99, 100.
  2. Repair Abutments A and B, and Piers 1, 2, 3, 4, 5, 6, 7, 8, 9, 10, 11, 12, 13, 14, 15, 16, 17, 18, 19, 20, 21, 22, 23, 24, 25, 26, 27, 28, 29, 30, 31, 32, 33, 34, 35, 36, 37, 38, 39, 40, 41, 42, 43, 44, 45, 46, 47, 48, 49, 50, 51, 52, 53, 54, 55, 56, 57, 58, 59, 60, 61, 62, 63, 64, 65, 66, 67, 68, 69, 70, 71, 72, 73, 74, 75, 76, 77, 78, 79, 80, 81, 82, 83, 84, 85, 86, 87, 88, 89, 90, 91, 92, 93, 94, 95, 96, 97, 98, 99, 100.
  3. Reposition Steel Spans 1, 2, and 3.
  4. Pour new concrete deck for Spans 1, 2, 3, 4, 5, 6, 7, 8, 9, 10, 11, 12, 13, 14, 15, 16, 17, 18, 19, 20, 21, 22, 23, 24, 25, 26, 27, 28, 29, 30, 31, 32, 33, 34, 35, 36, 37, 38, 39, 40, 41, 42, 43, 44, 45, 46, 47, 48, 49, 50, 51, 52, 53, 54, 55, 56, 57, 58, 59, 60, 61, 62, 63, 64, 65, 66, 67, 68, 69, 70, 71, 72, 73, 74, 75, 76, 77, 78, 79, 80, 81, 82, 83, 84, 85, 86, 87, 88, 89, 90, 91, 92, 93, 94, 95, 96, 97, 98, 99, 100.
  5. Remove asphalt patches from Spans 1, 2, 3, 4, 5, 6, 7, 8, 9, 10, 11, 12, 13, 14, 15, 16, 17, 18, 19, 20, 21, 22, 23, 24, 25, 26, 27, 28, 29, 30, 31, 32, 33, 34, 35, 36, 37, 38, 39, 40, 41, 42, 43, 44, 45, 46, 47, 48, 49, 50, 51, 52, 53, 54, 55, 56, 57, 58, 59, 60, 61, 62, 63, 64, 65, 66, 67, 68, 69, 70, 71, 72, 73, 74, 75, 76, 77, 78, 79, 80, 81, 82, 83, 84, 85, 86, 87, 88, 89, 90, 91, 92, 93, 94, 95, 96, 97, 98, 99, 100.
  6. Remove and patch cracked and deteriorated areas of asphalt.
  7. Open bridge to traffic.
- Note: The bridge is closed to traffic until the work is completed. Redirection traffic will be allowed to use the sidewalk on east side between spans 5 and 15.

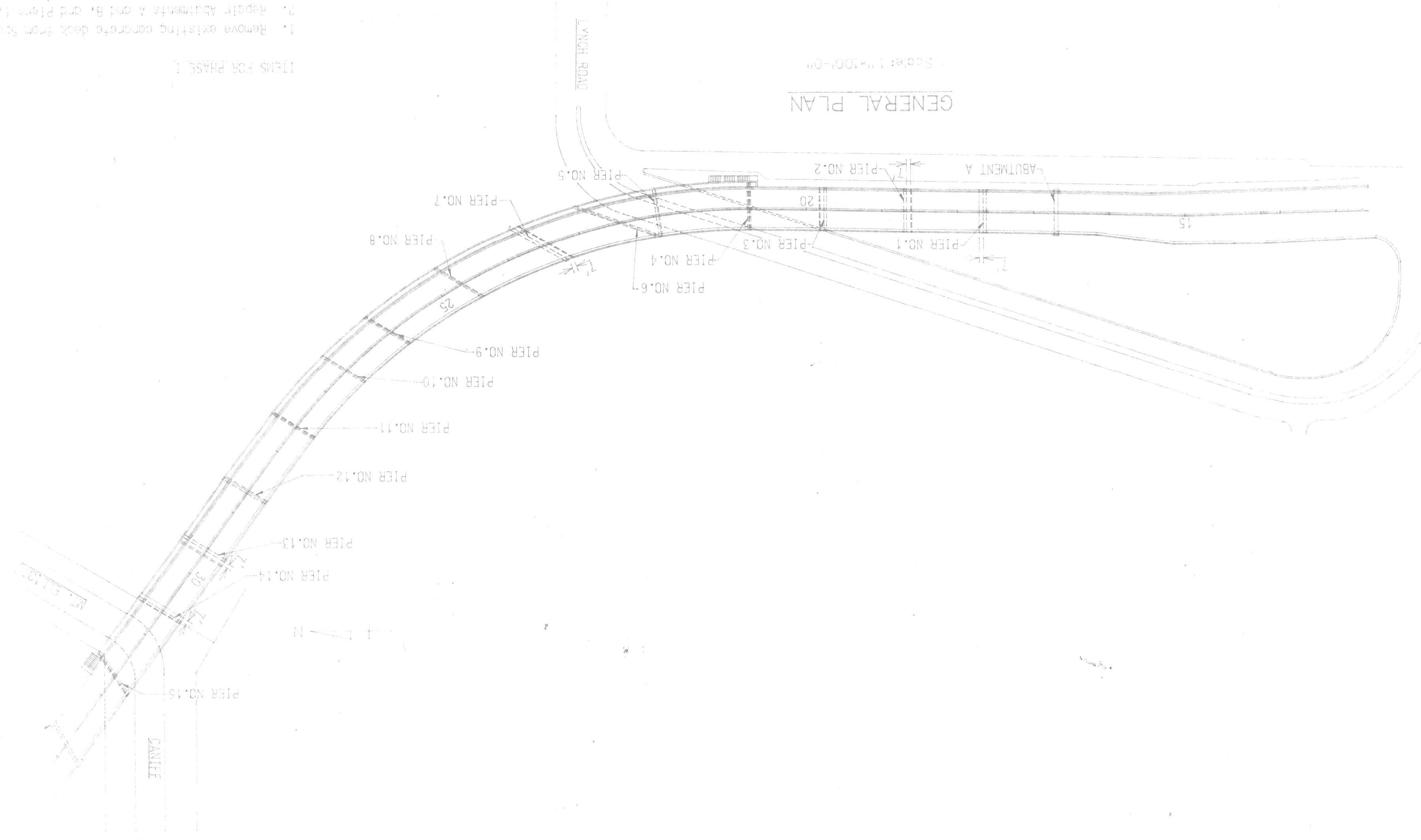

GENERAL PLAN  
 Scale: 1" = 100'-0"

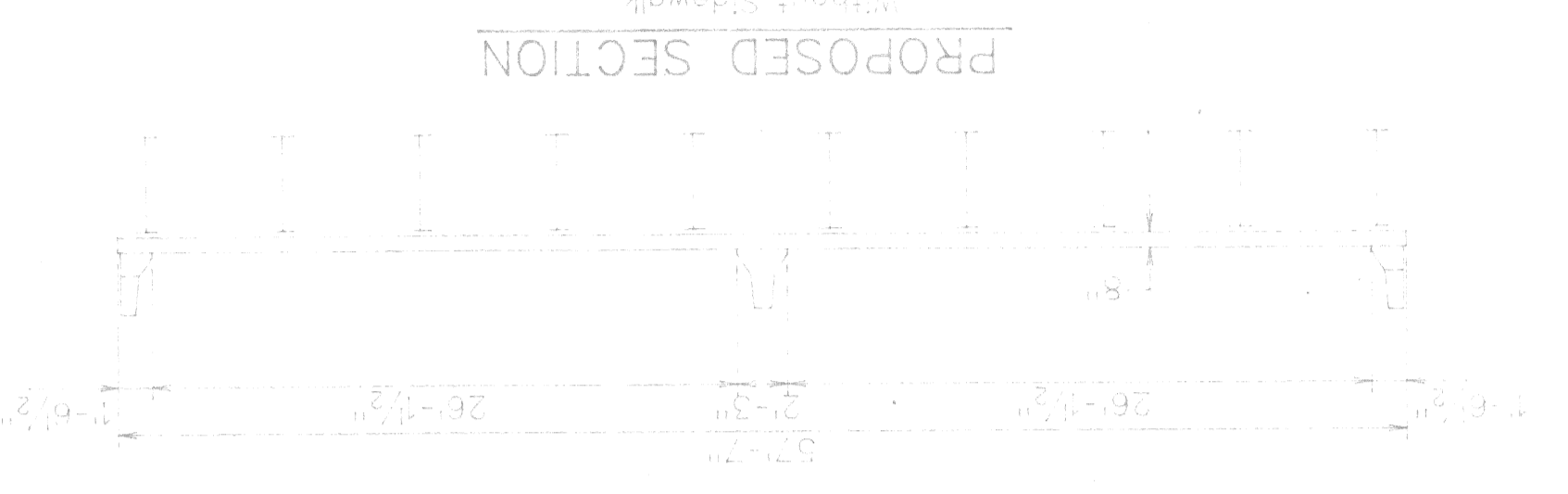

PROPOSED SECTION  
 Scale: 1" = 1'-0"

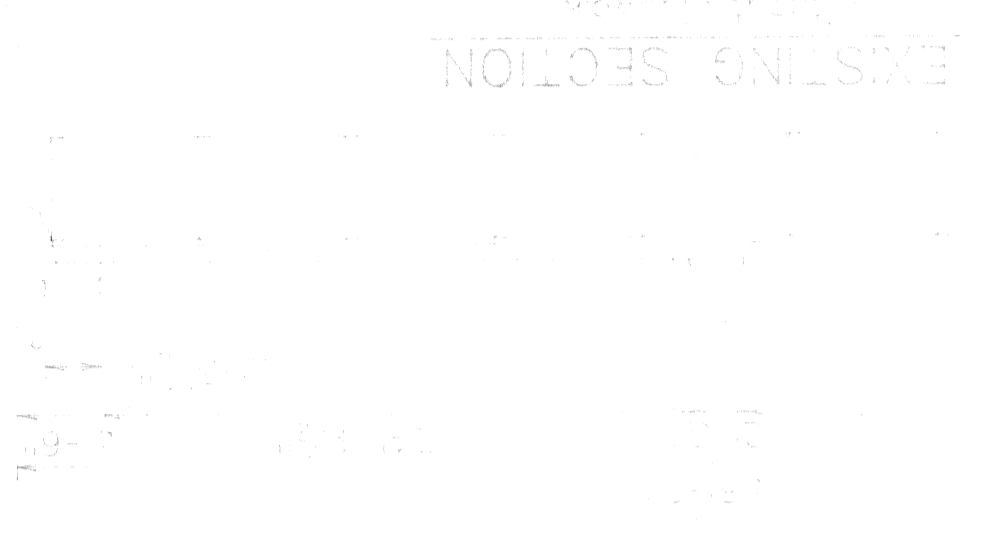

EXISTING SECTION  
 Scale: 1" = 1'-0"

CITY OF DETROIT  
 City Engineering Department  
 MOUNT ELLIOT - MOUND ROAD  
 GRADE SEPARATION  
 GENERAL PLAN - PHASE IIA

DRAWN BY: WTA  
 CHECKED BY: RL

DATE: MARCH 23, 1993  
 SCALE: HORIZ. AS NOTED  
 VERT. AS NOTED

REVISIONS	NAME	DATE

- Items for Phase IIA
1. Route traffic to one-ten foot lane in each direction on the Northbound lanes, and use temporary concrete barriers to restrict the traffic.
  2. Remove the concrete deck from Spans 3 to 15.
  3. Place new concrete as shown in the Proposed Section.
  4. Reroute traffic to one-ten foot lane in each direction on the Southbound lanes, and use temporary concrete barriers to restrict the traffic.
  5. Remove the concrete deck from Spans 3 to 15.
  6. Place new concrete as shown in the Proposed Section.
  7. Repair substructure units Piers 3 to 14.
  8. Open bridge to traffic.
- Note: Half of the bridge will be open to traffic at one time. Pedestrian traffic will be allowed to use the sidewalk on the east side of the bridge while construction is in progress on the Southbound lanes only. No pedestrian traffic will be allowed on the bridge during the construction of the Northbound lanes.

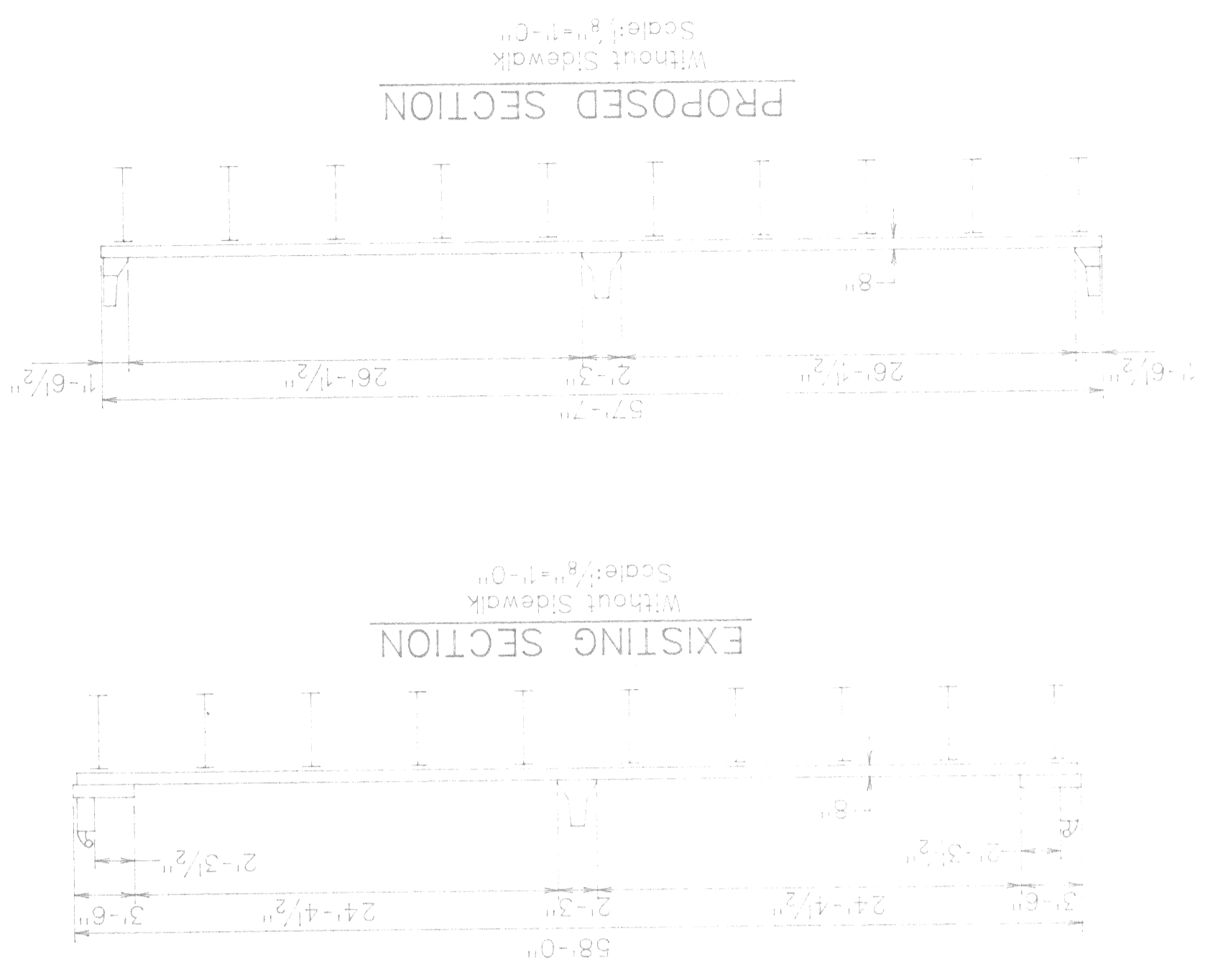
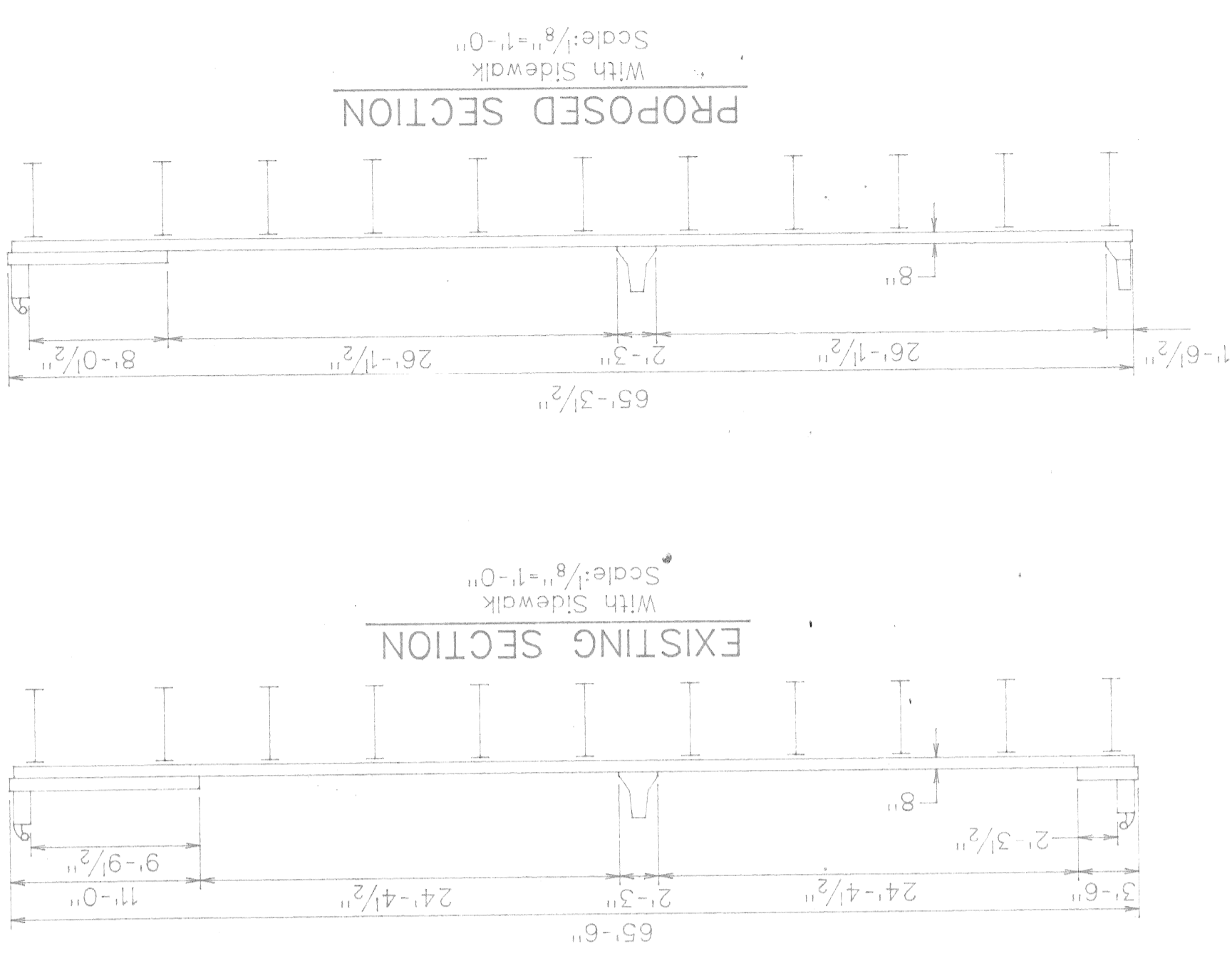
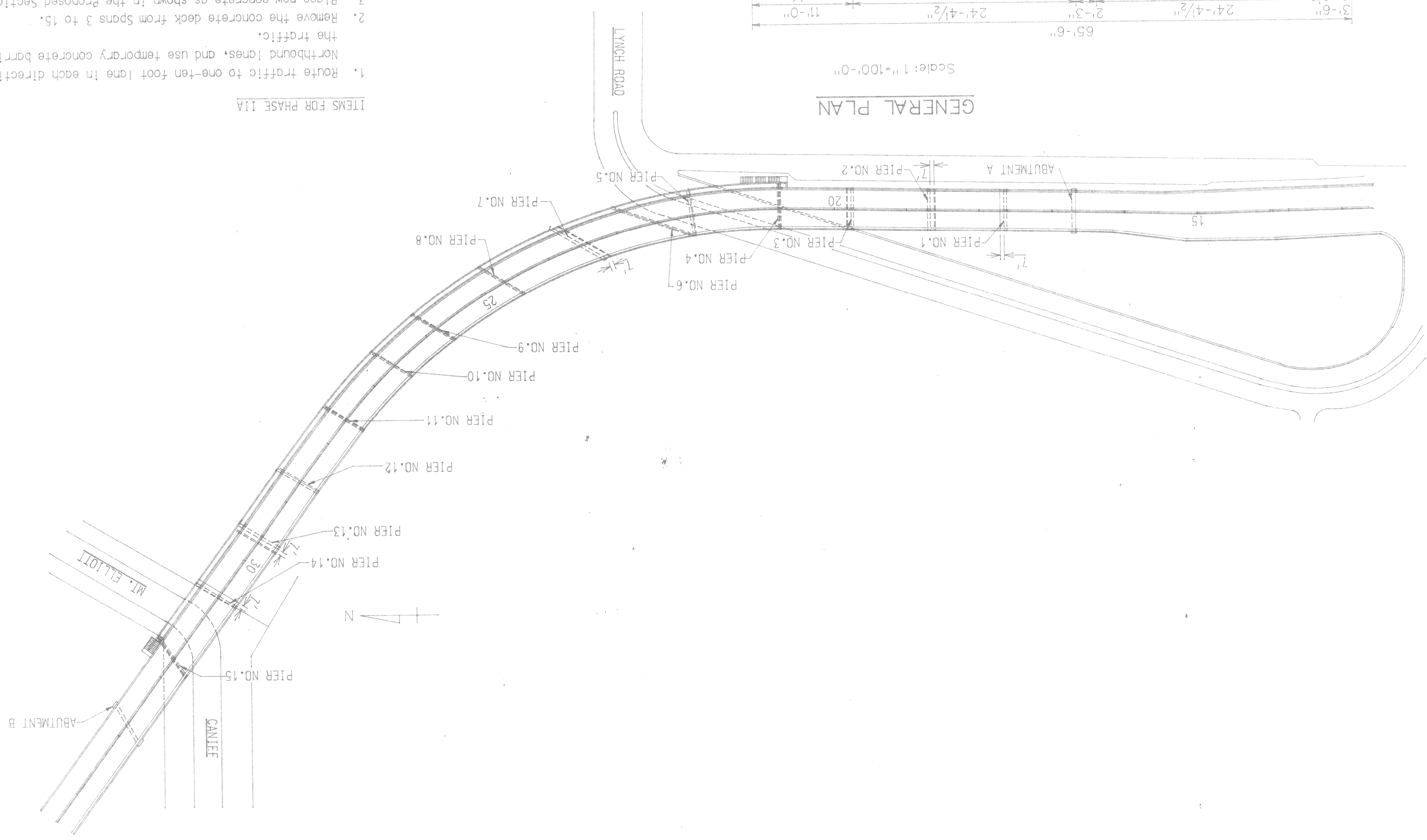

CITY OF DETROIT  
 City Engineering Department  
 MOUNT ELLIOT - MOUND ROAD  
 GRADE SEPARATION  
 GENERAL PLAN - PHASE IIB

DRAWN BY: WTA  
 CHECKED BY: RL

REVISIONS	NAME	DATE

SCALE: VERT. AS NOTED  
 HORIZ. 1/8"=1'-0"

DATE: MARCH 23, 1993

Note: Half of the bridge will be open to traffic at one time. Pedestrian traffic will be allowed to use the sidewalk on the east side of the bridge while construction is in progress on the Southbound lanes only. No pedestrian traffic will be allowed on the bridge during the construction of the Northbound lanes.

- ITEMS FOR PHASE IIB
1. Route traffic to one-ten foot lane in each direction on the Northbound lanes, and use temporary concrete barriers to restrict traffic.
  2. Remove outside parapet and safety walk, and median barrier wall. Scarify the Southbound lanes 1/4", hydrodemolish the deck so that the shear studs extend at least 2" out of the concrete slab. Remove the existing top mat of reinforcing bars.
  3. Scarify the Southbound lanes 1/4", hydrodemolish the deck so that the shear studs extend at least 2" out of the concrete slab. Remove the existing top mat of reinforcing bars.
  4. Place Epoxy-coated reinforcement bars for new top mat.
  5. Place new concrete to original thickness as shown in the Proposed Section.
  6. Route traffic to one-ten foot lane in each direction on the Southbound lanes, and use temporary concrete barriers to restrict the traffic.
  7. Remove outside parapet, safety walk and sidewalk.
  8. Scarify the Northbound lanes 1/4", hydrodemolish the deck so that shear studs extend at least 2" out of the concrete slab. Remove the existing top mat of reinforcing bars.
  9. Place Epoxy-coated reinforcement bars for new top mat.
  10. Place new concrete to original thickness as shown in the Proposed Section.
  11. Repair substructure units Piers 3 to 14.
  12. Open bridge to traffic.

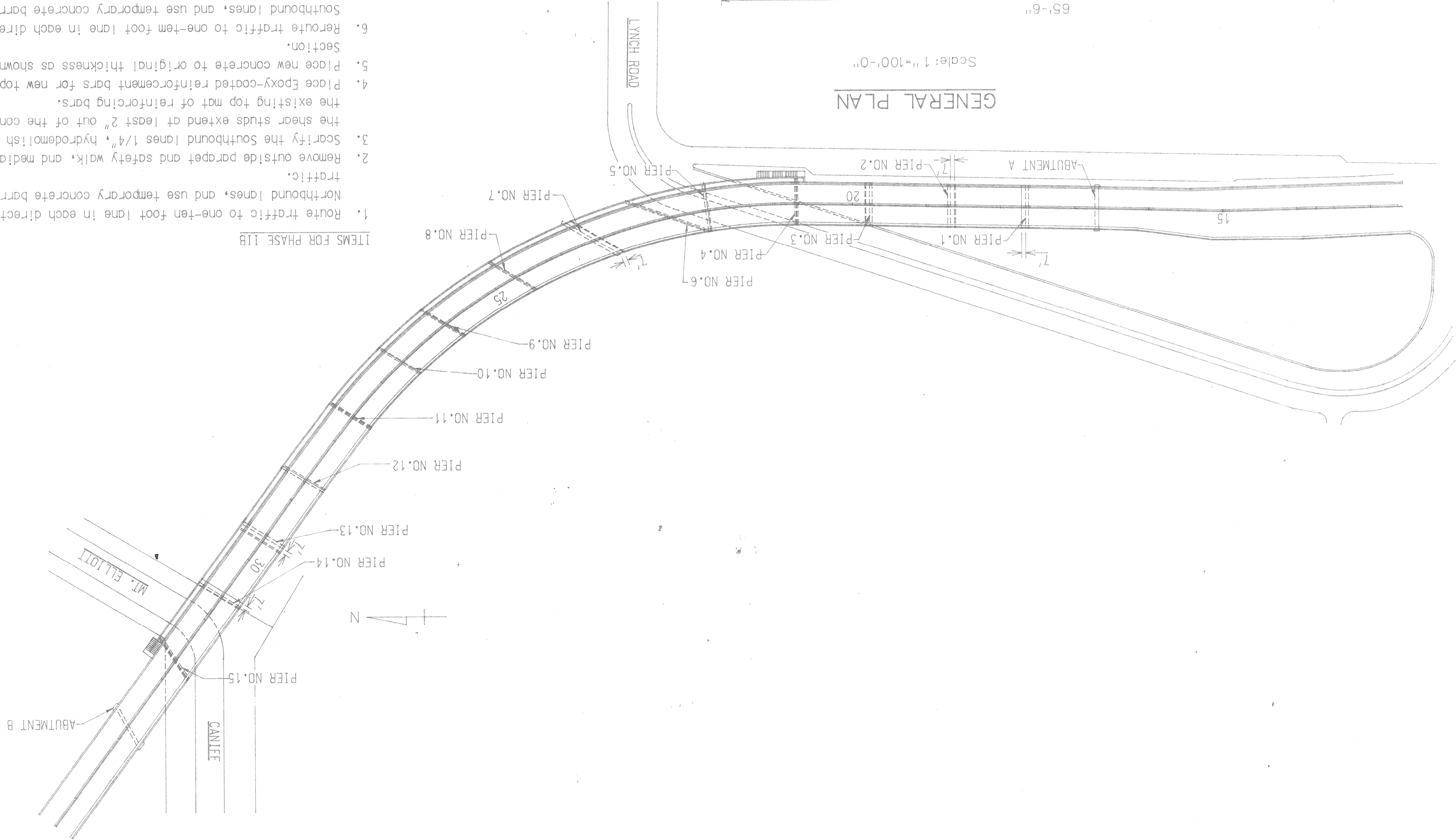

PROPOSED SECTION  
 With Sidewalk  
 Scale: 1/8"=1'-0"

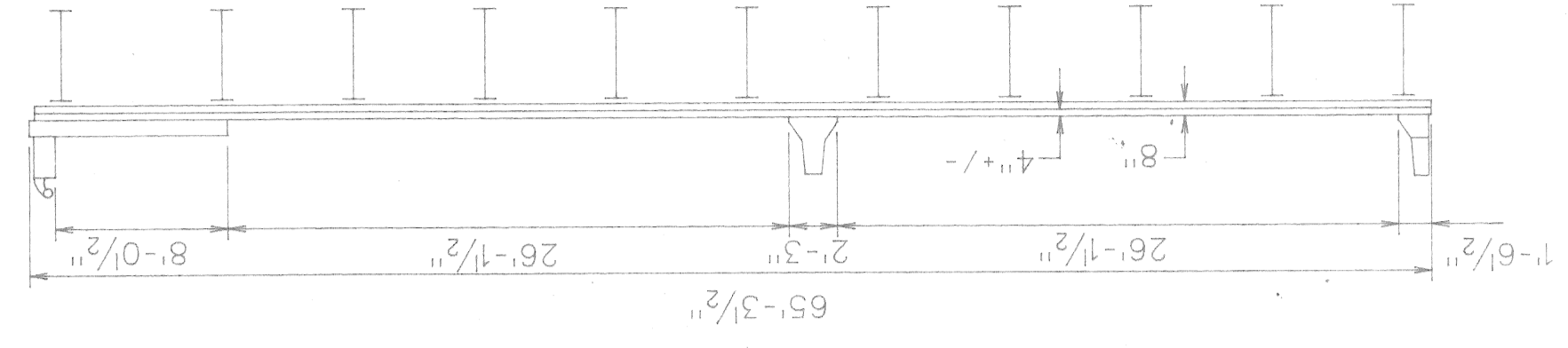

EXISTING SECTION  
 With Sidewalk  
 Scale: 1/8"=1'-0"

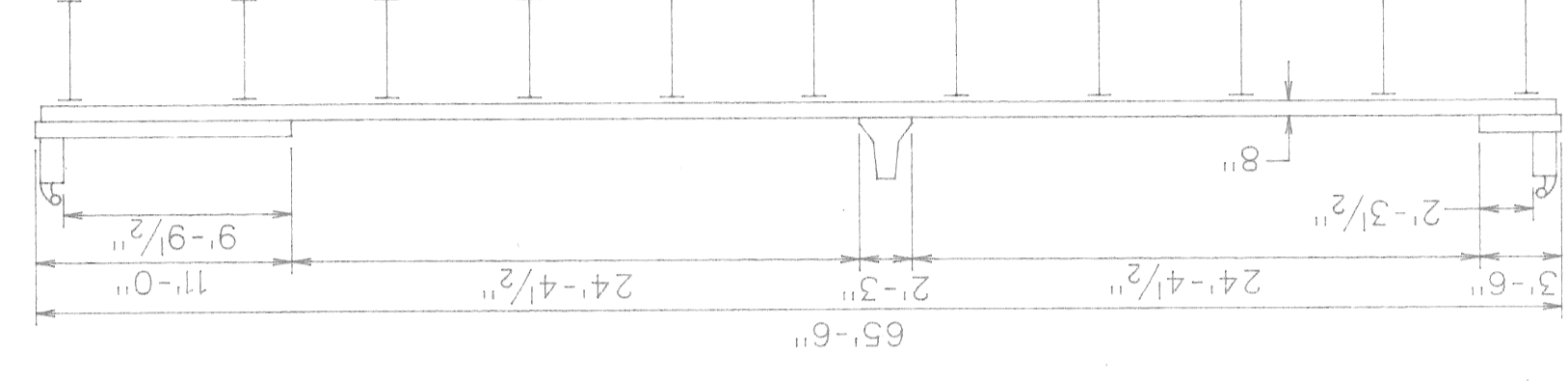

PROPOSED SECTION  
 Without Sidewalk  
 Scale: 1/8"=1'-0"

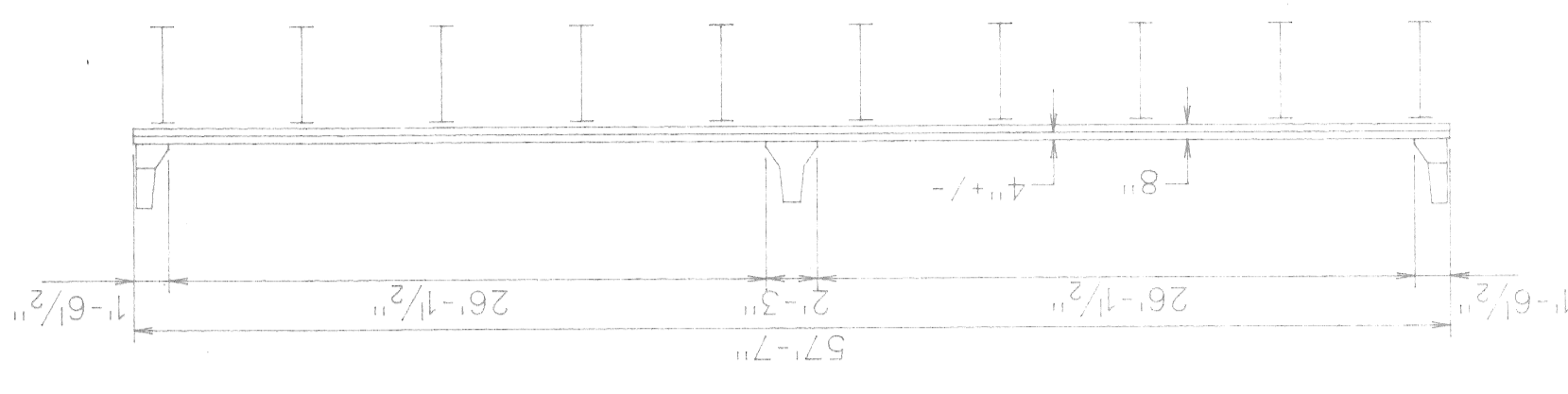

EXISTING SECTION  
 Without Sidewalk  
 Scale: 1/8"=1'-0"

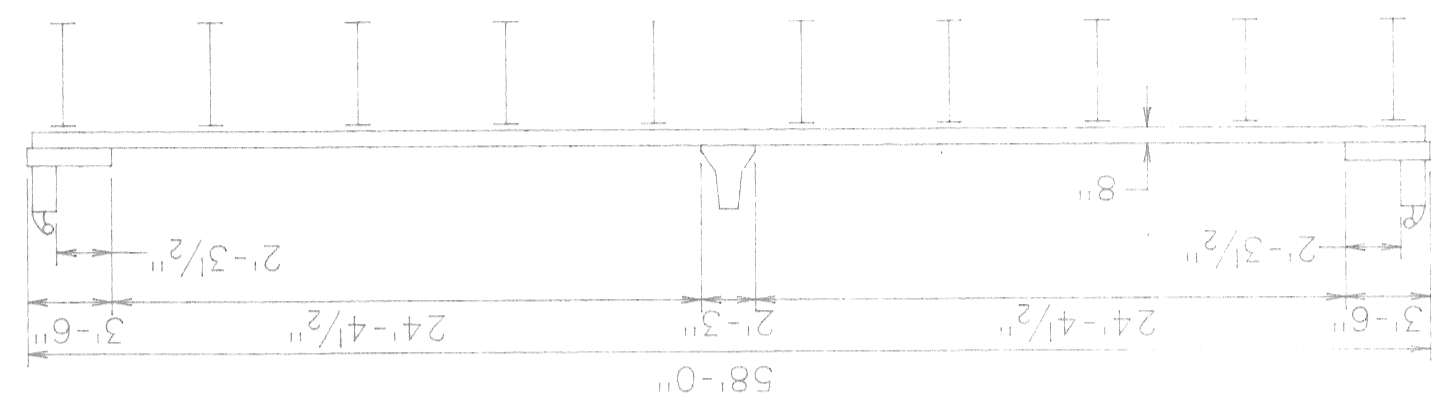

CITY OF DETROIT  
 City Engineering Department  
 MOUNT ELLIOT - MOUND ROAD  
 GRADE SEPARATION  
 GENERAL PLAN - PHASE IIC

SCALE: VERT. AS NOTED  
 HORIZ. AS NOTED  
 DATE: MARCH 23, 1993  
 DRAWN BY: WTA  
 CHECKED BY: RL

REVISIONS	NAME	DATE

- ITEMS FOR PHASE IIC
1. Route traffic to one-ten foot lane in each direction on the Northbound lanes, and use temporary concrete barriers to restrict traffic.
  2. Remove outside parapet and safety walk, and median barrier wall.
  3. Scarify the Southbound lanes 1/4", hydrodemolish the deck 1-1/2".
  4. Place new concrete outside parapet and median as shown in the Proposed Section, and place new latex-modified concrete overlay on the Southbound lanes only.
  5. Reroute traffic to one-ten foot lane in each direction on the Southbound lanes.
  6. Remove outside parapet, safety walk and sidewalk.
  7. Scarify the Northbound lanes 1/4", hydrodemolish the deck 1-1/2".
  8. Place new concrete outside parapet, sidewalk, and solid parapet as shown in the Proposed Section.
  9. Repair substructure units Piers 3 to 14.
  10. Open bridge to traffic.
- Note: Half of the bridge will be open to traffic at one time. Pedestrian traffic will be allowed to use the sidewalk on the east side of the bridge while construction is in progress on the Southbound lanes only. No pedestrian traffic will be allowed on the bridge during the construction of the Northbound lanes.

