

CITY OF DETROIT
 City Engineering Department
 MOUNT ELLIOT - MOUND ROAD
 GRADE SEPARATION
 GENERAL PLAN - PHASE I

SCALE: VERT. AS NOTED
 HORIZ. AS NOTED
 DRAWN BY: WTA
 CHECKED BY: RL
 DATE: MARCH 23, 1993

REVISIONS	NAME	DATE

1. Remove existing concrete deck from Spans 1, 2, and 16.
 2. Repair Abutments A and B, and Piers 1, 2, and 15.
 3. Reposition Steel Spans 1, 2, and 16.
 4. Pour new concrete deck for Spans 1, 2, and 16 as shown in Proposed Section.
 5. Remove asphalt patches from Spans 3 to 15. Hand-ship delaminated portions of the deck that shows signs of imminent spalling. These areas and those that have already spalled are to be repaired with asphalt.
 6. Remove and patch cracked and delaminated areas in the approach slab areas.
 7. Open bridge to traffic.
- Note: The bridge is closed to traffic until Item 6 is completed. Pedestrian traffic will be allowed to use the sidewalk on the east side between spans 5 and 15.

ITEMS FOR PHASE I

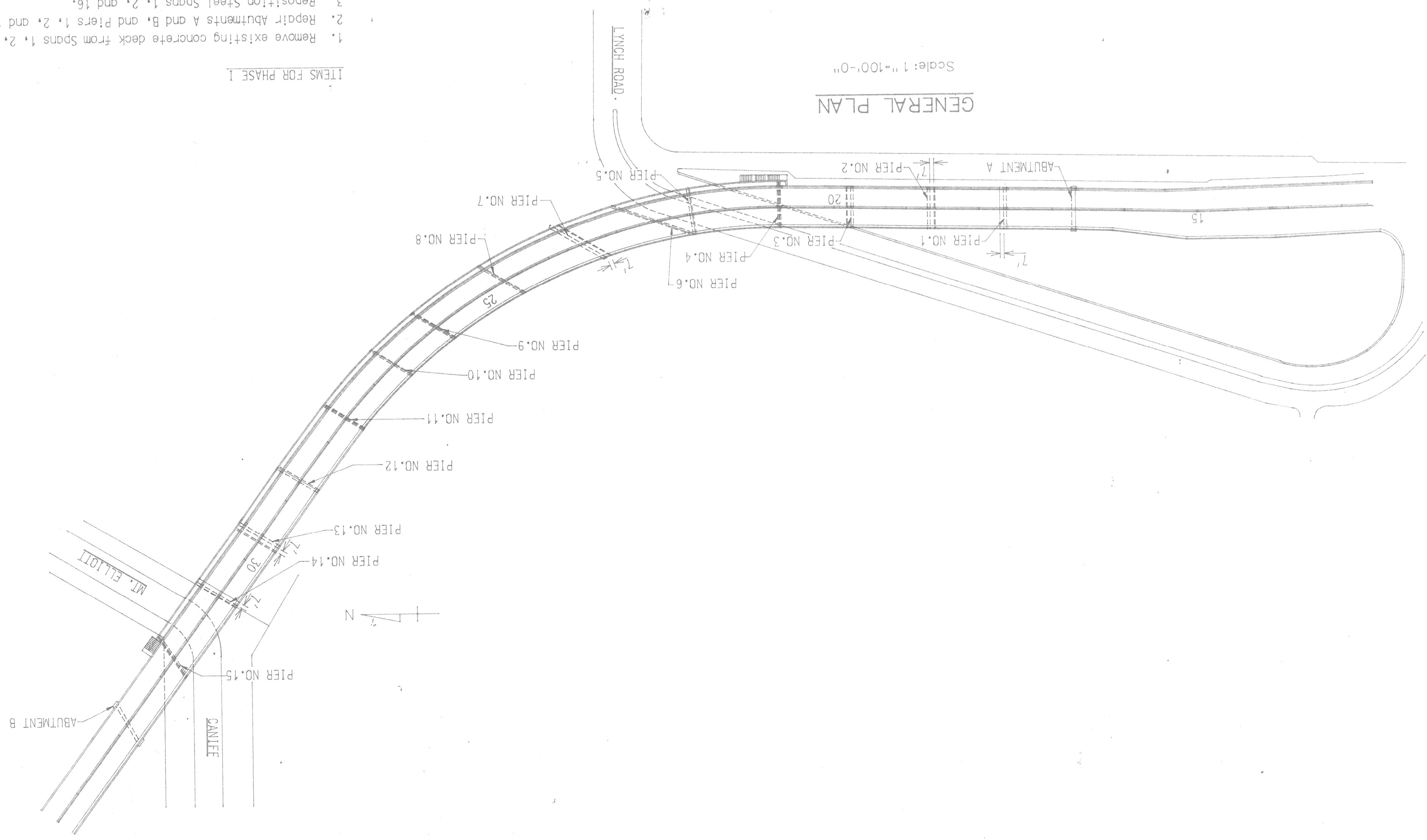

PROPOSED SECTION
 Scale: 1/8"=1'-0"
 Without Sidewalk

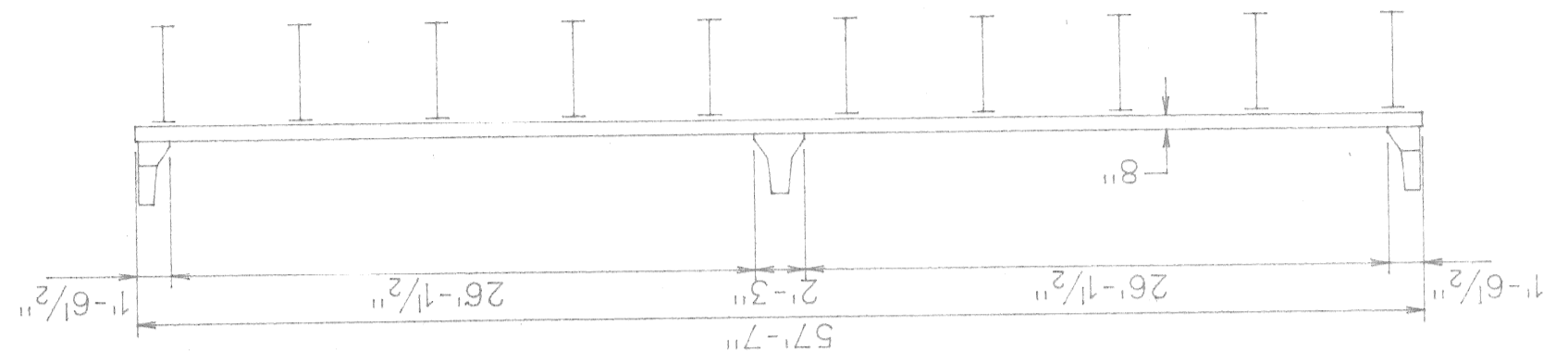

EXISTING SECTION
 Scale: 1/8"=1'-0"
 Without Sidewalk

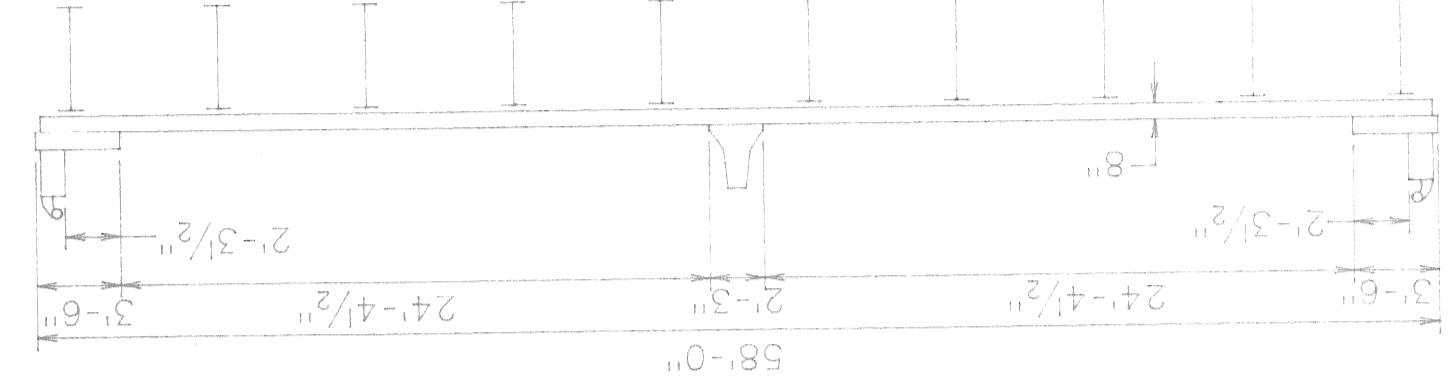

CITY OF DETROIT
 City Engineering Department
 MOUNT ELLIOT - MOUND ROAD
 GRADE SEPARATION
 GENERAL PLAN - PHASE IIA

DRAWN BY: WTA
 CHECKED BY: RL

DATE: MARCH 23, 1993
 SCALE: HORIZ. AS NOTED
 VERT. AS NOTED

REVISIONS	NAME	DATE

- Items for Phase IIA:
1. Route traffic to one-ten foot lane in each direction on the Northbound lanes, and use temporary concrete barriers to restrict the traffic.
 2. Remove the concrete deck from Spans 3 to 15.
 3. Place new concrete as shown in the Proposed Section.
 4. Repoute traffic to one-ten foot lane in each direction on the Southbound lanes, and use temporary concrete barriers to restrict the traffic.
 5. Remove the concrete deck from Spans 3 to 15.
 6. Place new concrete as shown in the Proposed Section.
 7. Repair substructure units Piers 3 to 14.
 8. Open bridge to traffic.
- Note: Half of the bridge will be open to traffic at one time. Pedestrian traffic will be allowed to use the sidewalk on the east side of the bridge while construction is in progress on the Southbound lanes only. No pedestrian traffic will be allowed on the bridge during the construction of the Northbound lanes.

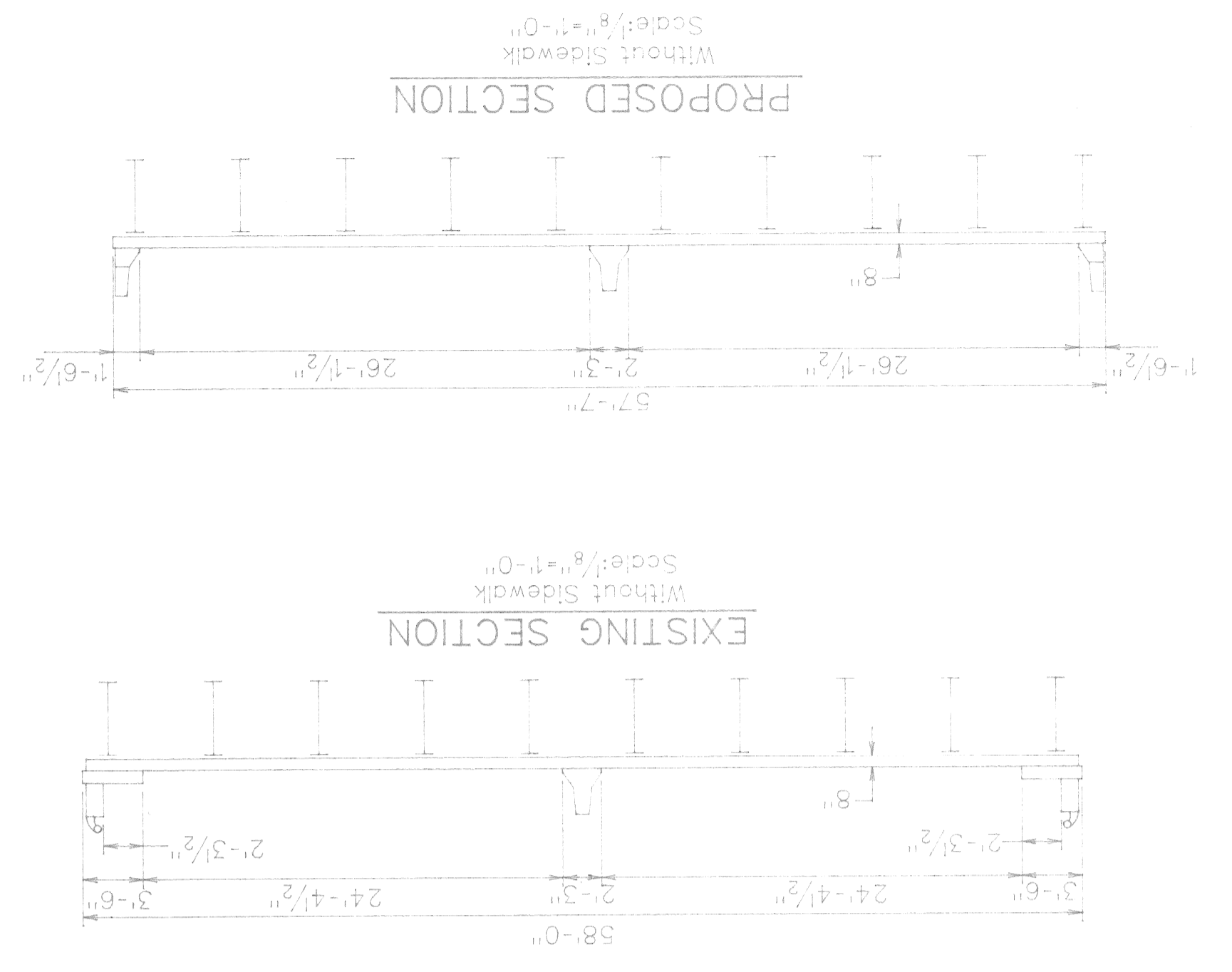
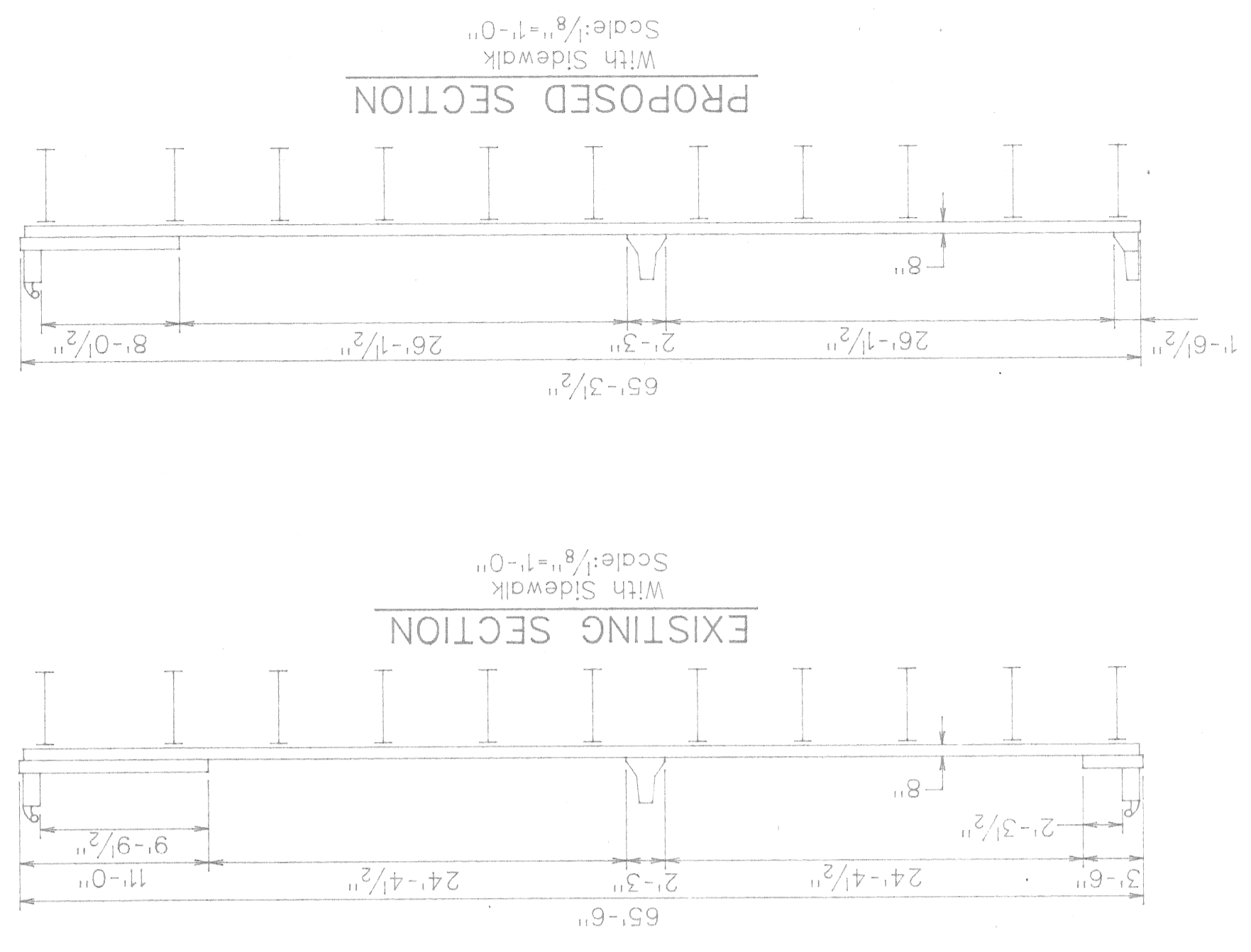
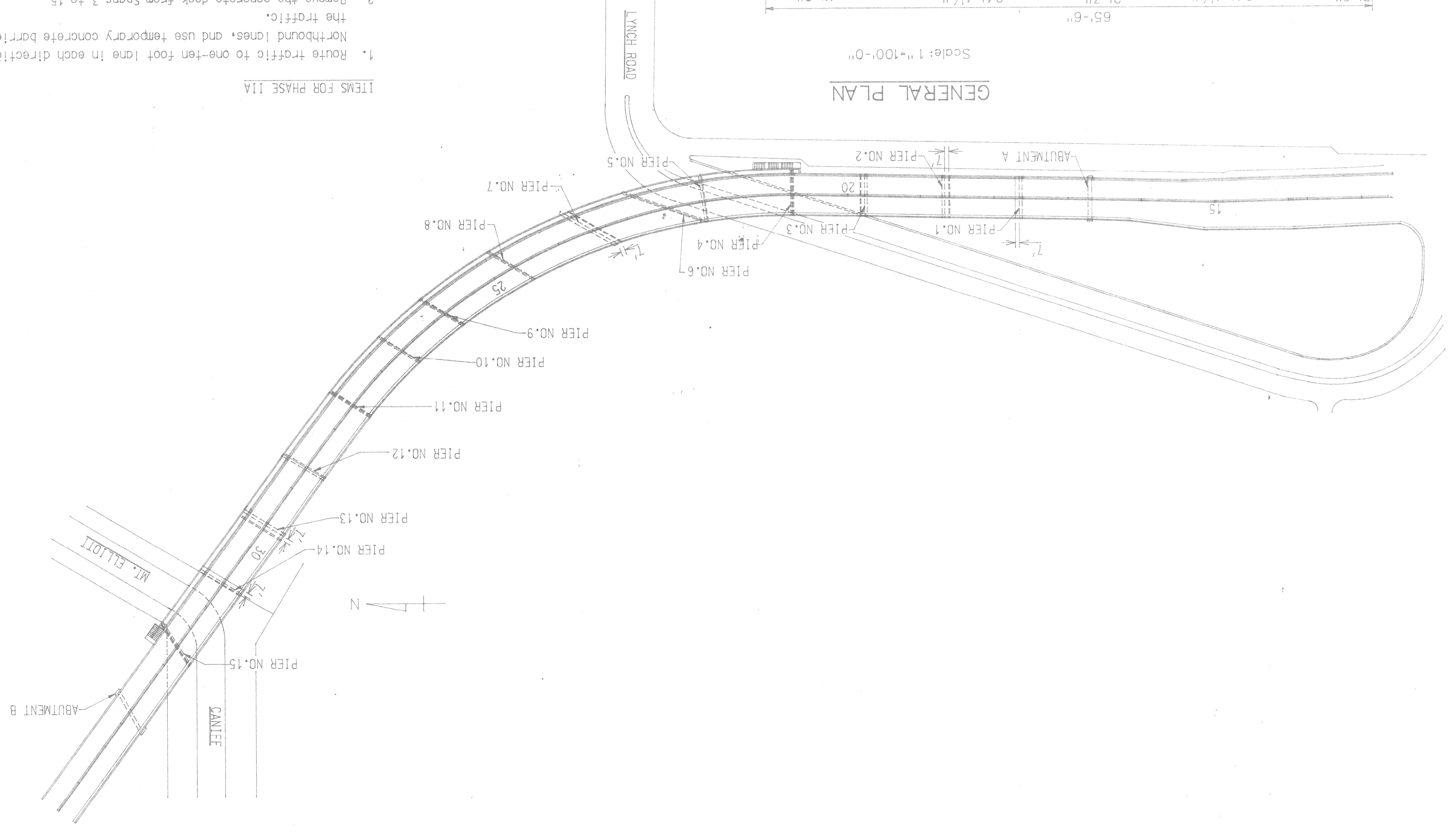

CITY OF DETROIT
 City Engineering Department
 MOUNT ELLIOT - MOUND ROAD
 GRADE SEPARATION
 GENERAL PLAN - PHASE IIB

SCALE: VERT. AS NOTED
 HORIZ. AS NOTED
 DRAWN BY: WTA
 CHECKED BY: RL

DATE: MARCH 23, 1993

REVISIONS	NAME	DATE

- ITEMS FOR PHASE IIB
1. Route traffic to one-way traffic in each direction on the Northbound lanes, and use temporary concrete barriers to restrict traffic.
 2. Remove outside parapet and safety walk, and median barrier wall. Scoreify the Southbound lanes 1/4", hydrodemolish the deck so that the shear studs extend at least 2" out of the concrete slab. Remove the existing top mat of reinforcing bars.
 3. Place Epoxy-coated reinforcing bars for new top mat.
 4. Place new concrete to original thickness as shown in the Proposed Section.
 5. Route traffic to one-way traffic in each direction on the Southbound lanes, and use temporary concrete barriers to restrict the traffic.
 6. Remove outside parapet, safety walk and sidewalk. Scoreify the Northbound lanes 1/4", hydrodemolish the deck so that shear studs extend at least 2" out of the concrete slab. Remove the existing top mat of reinforcing bars.
 7. Place Epoxy-coated reinforcing bars for new top mat.
 8. Place new concrete to original thickness as shown in the Proposed Section.
 9. Repair substructure units Piers 3 to 14.
 10. Open bridge to traffic.
- Note: Half of the bridge will be open to traffic at one time. Pedestrian traffic will be allowed to use the sidewalk on the east side of the bridge while construction is in progress on the Southbound lanes only. No pedestrian traffic will be allowed on the bridge during the construction of the Northbound lanes.

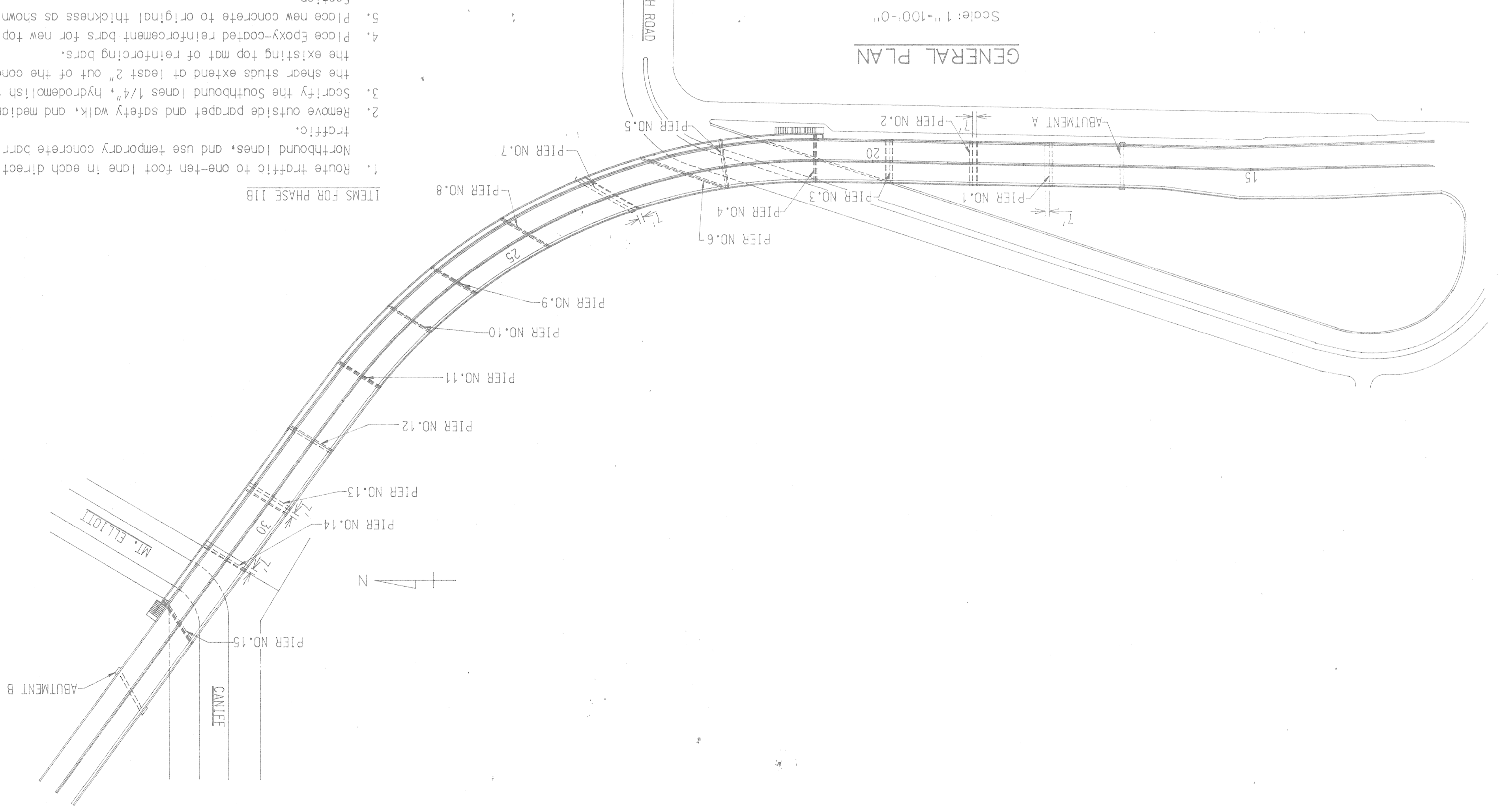
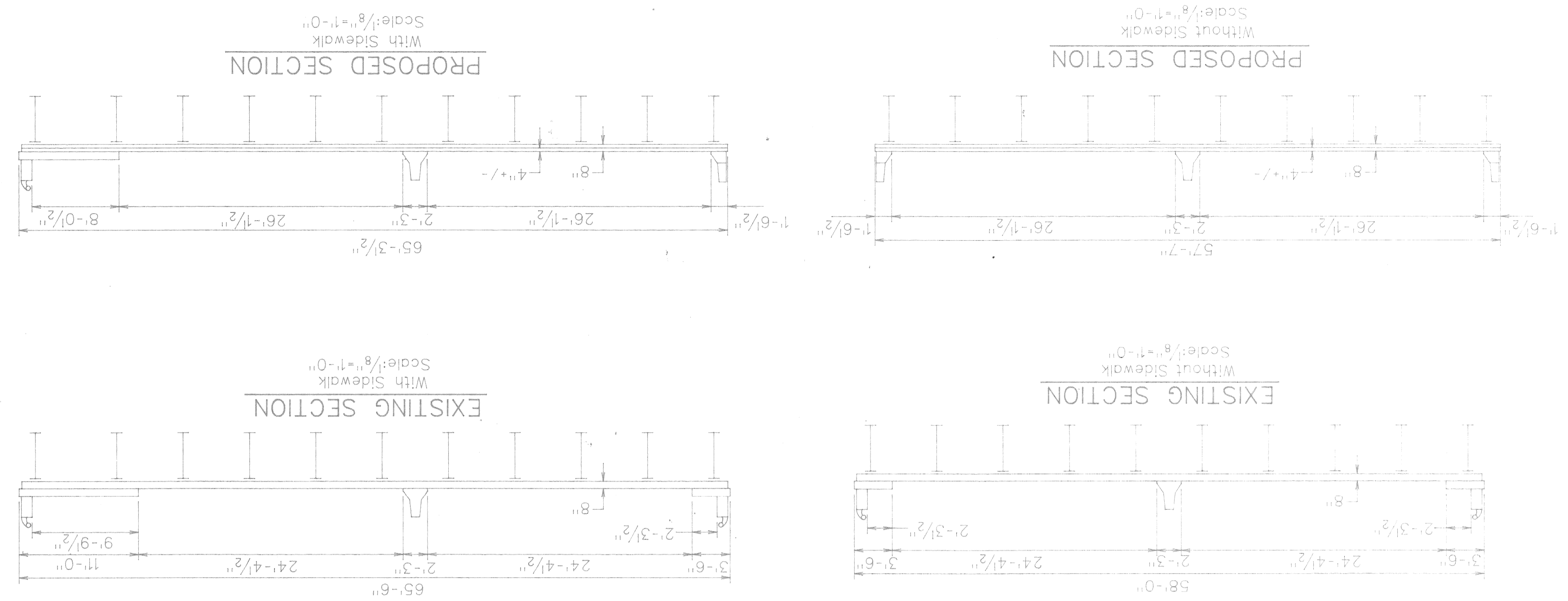

CITY OF DETROIT
 City Engineering Department
 MOUNT ELLIOT - MOUND ROAD
 GRADE SEPARATION
 GENERAL PLAN - PHASE IIC

DRAWN BY: WTA
 CHECKED BY: RL

SCALE: HORIZ. AS NOTED
 VERT. AS NOTED
 DATE: MARCH 23, 1993

REVISIONS	NAME	DATE

1. Route traffic to one-ten foot lane in each direction on the Northbound lanes, and use temporary concrete barriers to restrict traffic.
2. Remove outside parapet and safety walk, and median barrier wall. Scarify the Southbound lanes 1/4", hydrodemolish the deck 1-1/2".
3. Scarify the Southbound lanes 1/4", hydrodemolish the deck 1-1/2". Place new concrete outside parapet and median as shown in the Proposed Section, and place new latex-modified concrete overlay on the Southbound lanes only.
4. Place new concrete outside parapet and median as shown in the Proposed Section, and place new latex-modified concrete overlay on the Southbound lanes only.
5. Route traffic to one-ten foot lane in each direction on the Southbound lanes.
6. Remove outside parapet, safety walk and sidewalk.
7. Scarify the Northbound lanes 1/4", hydrodemolish the deck 1-1/2". Place new concrete outside parapet, sidewalk, and solid parapet as shown in the Proposed Section.
8. Place new concrete outside parapet, sidewalk, and solid parapet as shown in the Proposed Section.
9. Repair substructure units Piers 3 to 14.
10. Open bridge to traffic.
- Note: Half of the bridge will be open to traffic at one time. Pedestrian traffic will be allowed to use the sidewalk on the east side of the bridge while construction is in progress on the Southbound lanes only. No pedestrian traffic will be allowed on the bridge during the construction of the Northbound lanes.

ITEMS FOR PHASE IIC

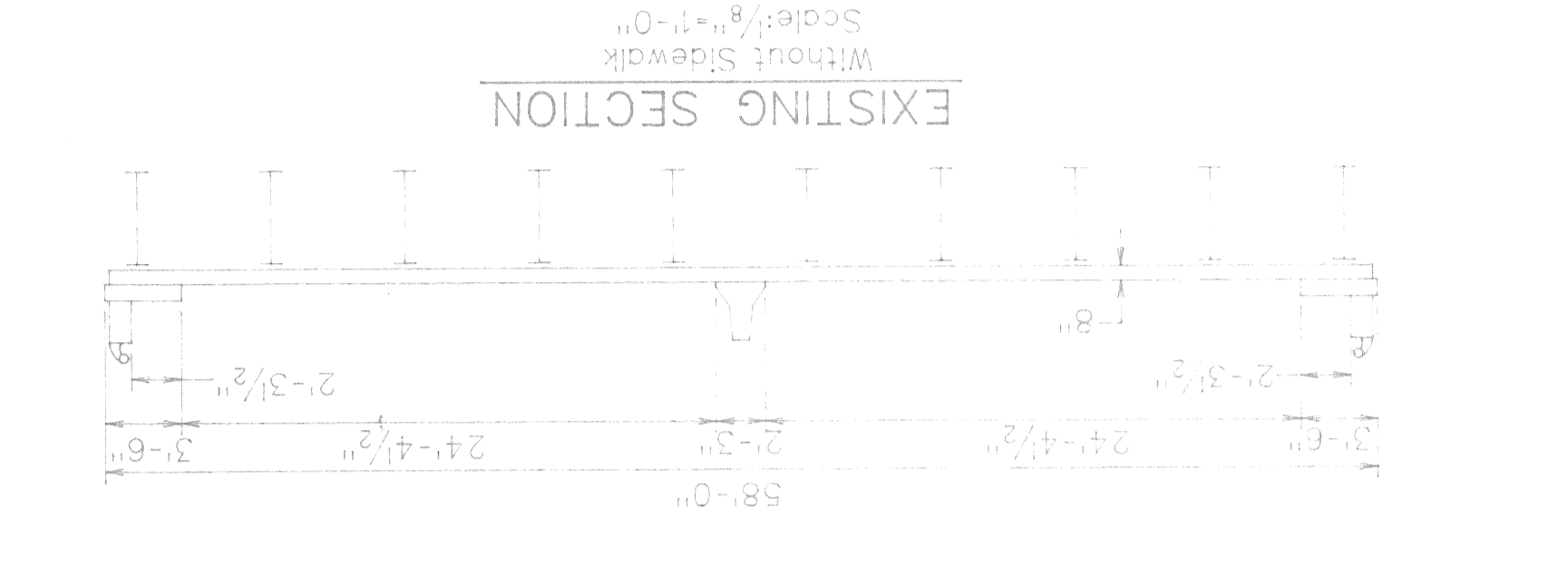
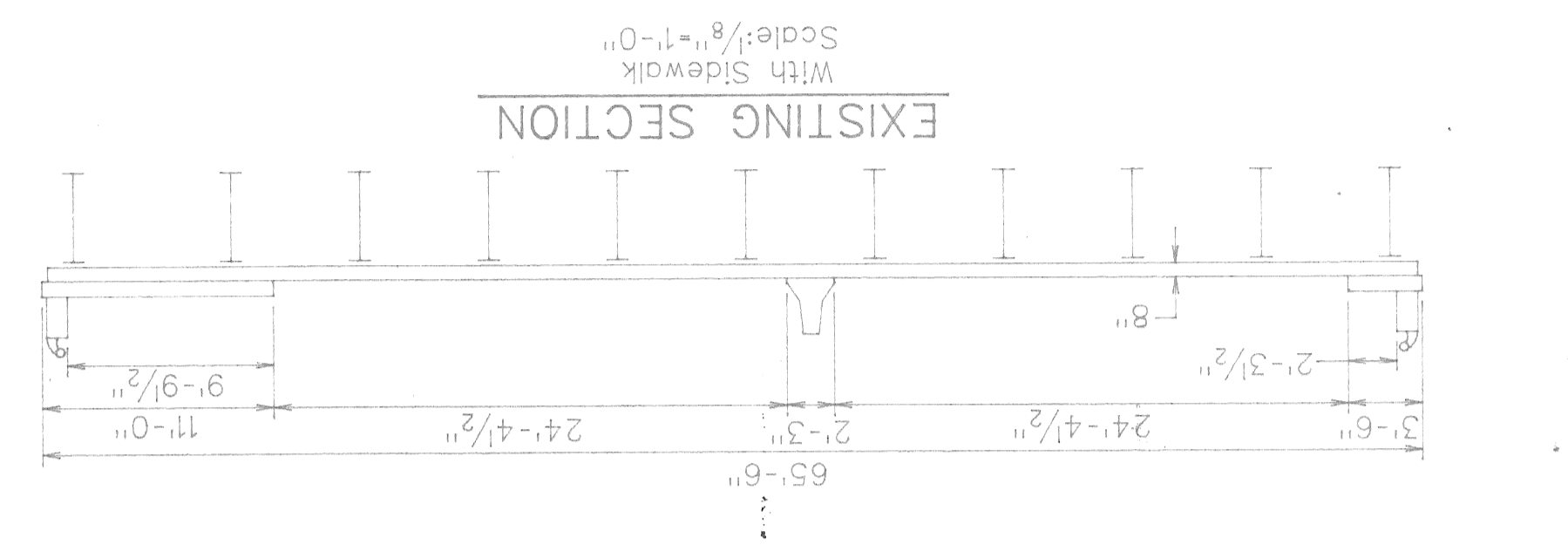
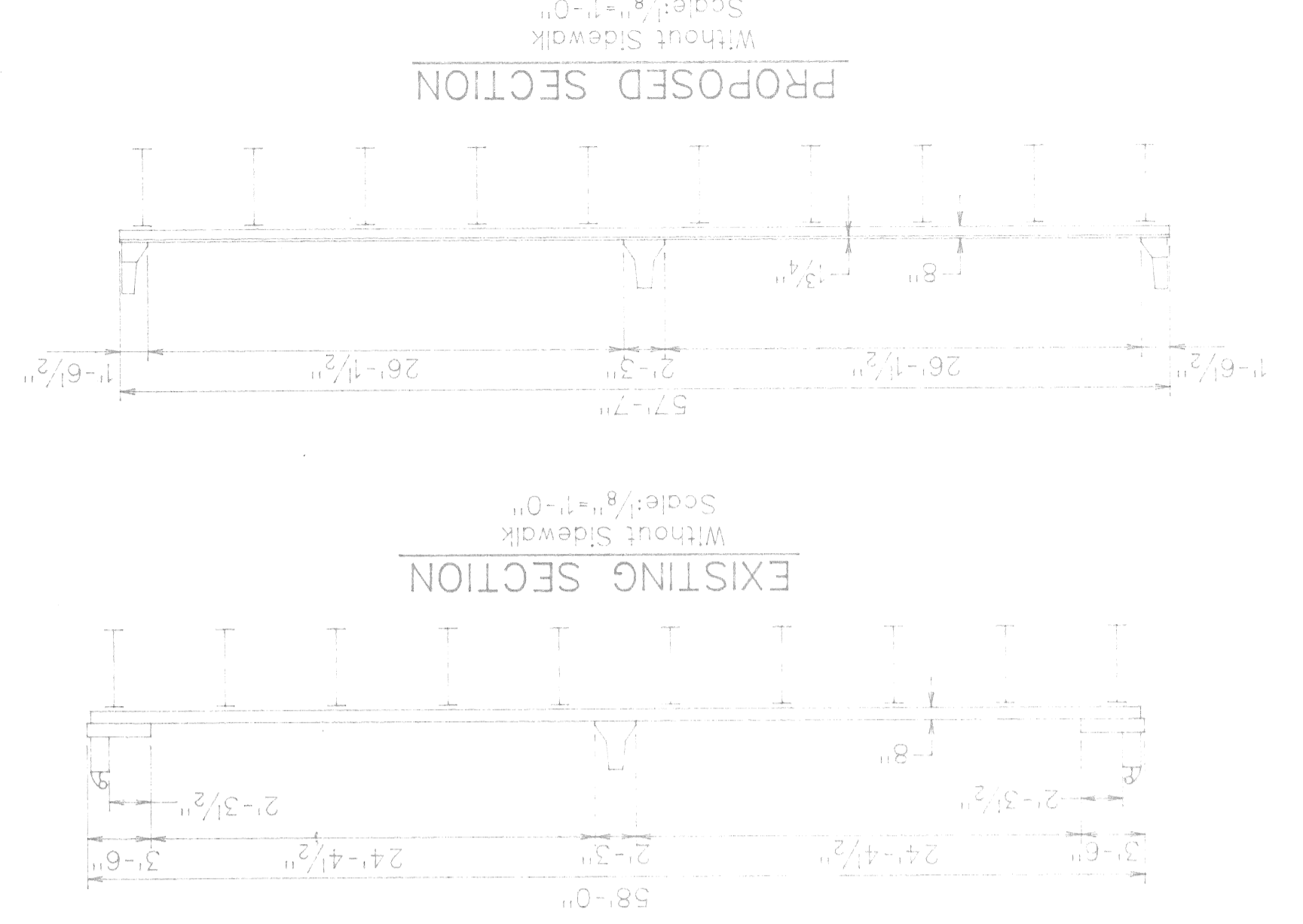
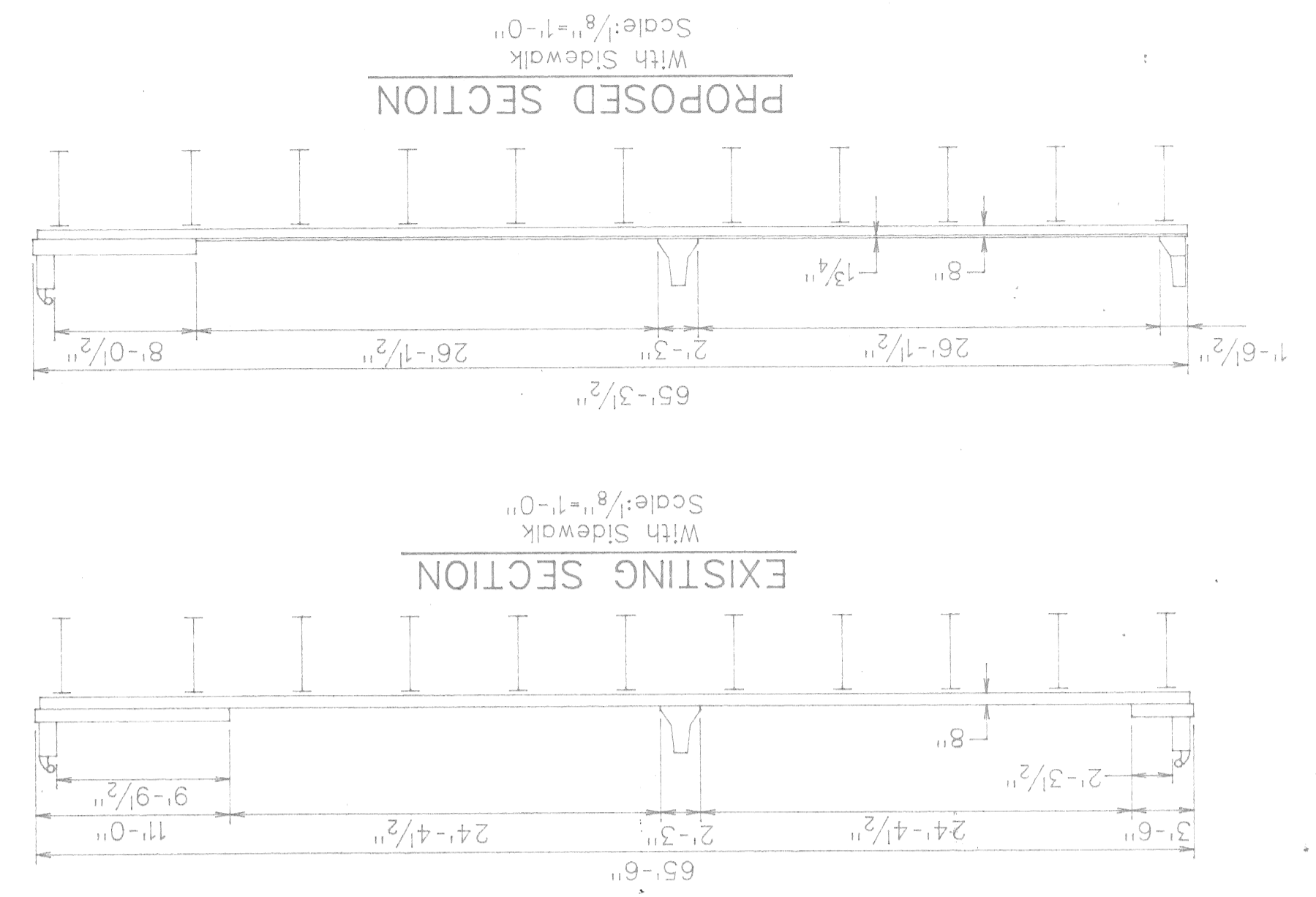
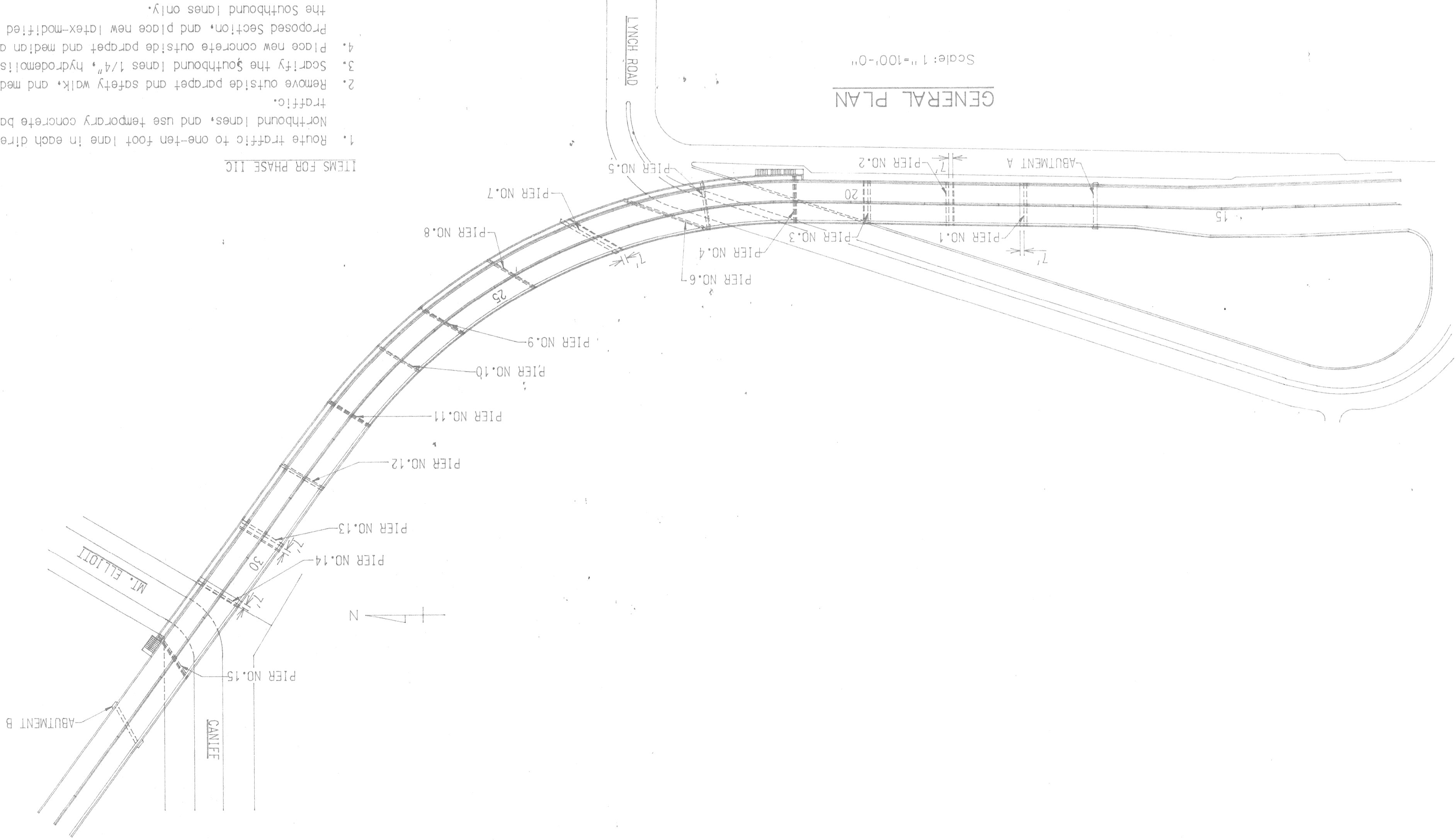

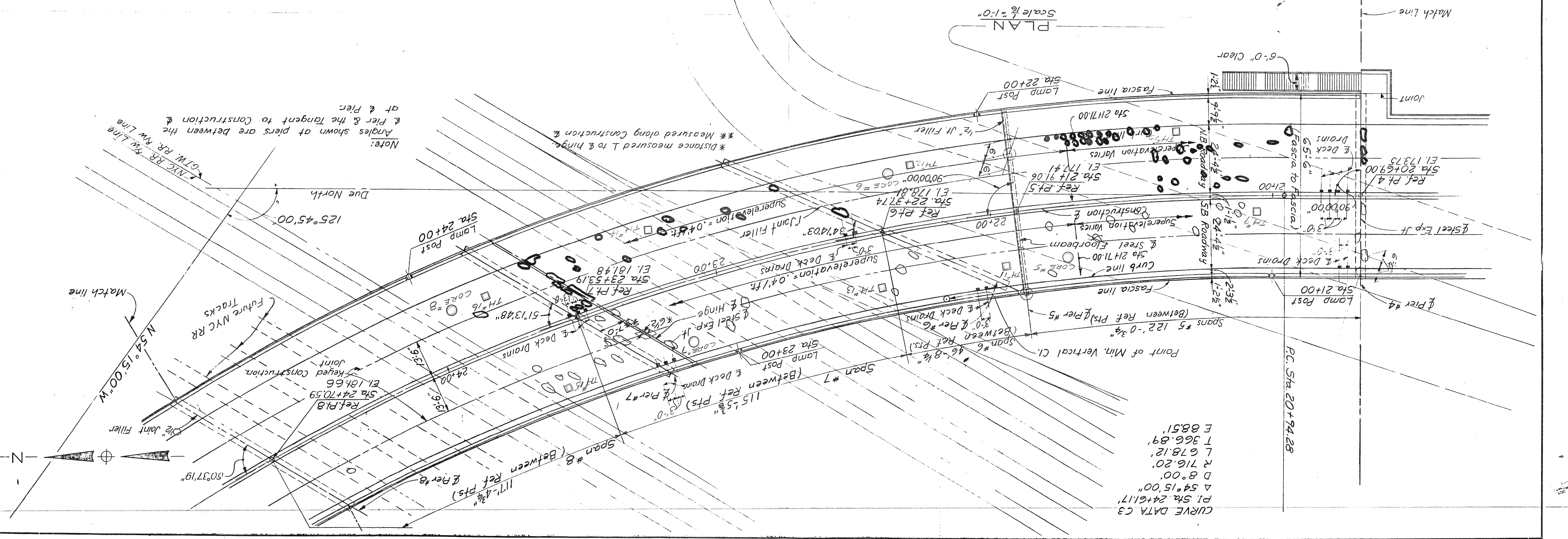
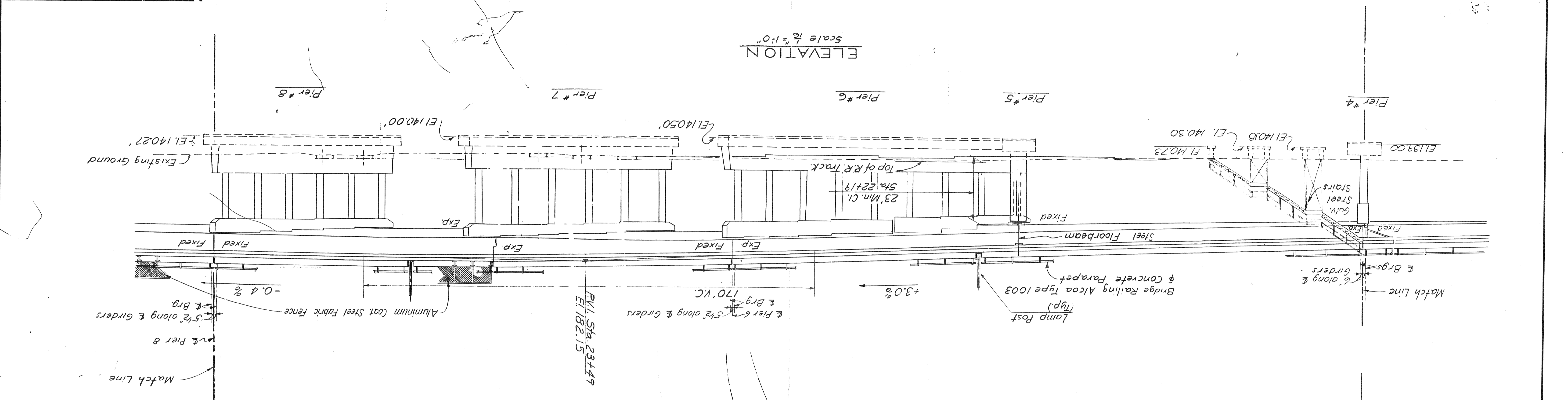

STATE	FILE
BRIDGE	ROAD

