

KEY PLAN

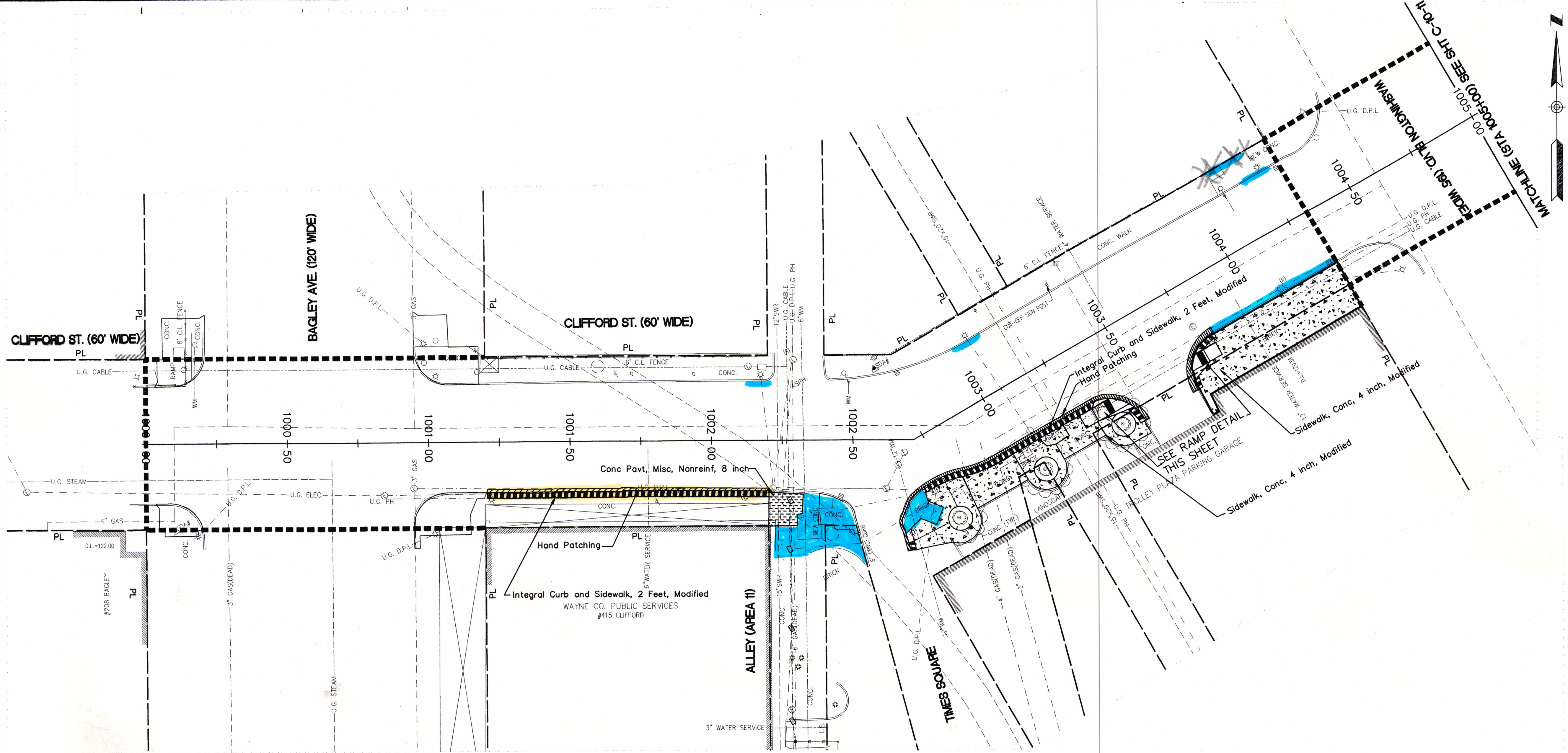

- CONSTRUCTION LEGEND**
- Sidewalk, Conc. 4 inch, Modified
  - Sidewalk, Conc. 6 inch, Modified
  - Integral Curb and Sidewalk, Conc. 4 inch, Modified
  - Integral Curb and Sidewalk, Conc. 6 inch, Modified
  - Integral Curb and Sidewalk, 2 Feet, Modified
  - Conc Pavt, Misc, Nonreinf, 8 inch
  - Hand Patching
  - Brick Paving, Modified
  - LIMITS OF CONSTRUCTION ON CROSS STREET
  - PROPERTY LINE

NOTE:  
FOR SIDEWALK CONSTRUCTION OVER VAULTS DETAILS SEE SHT # X-1.

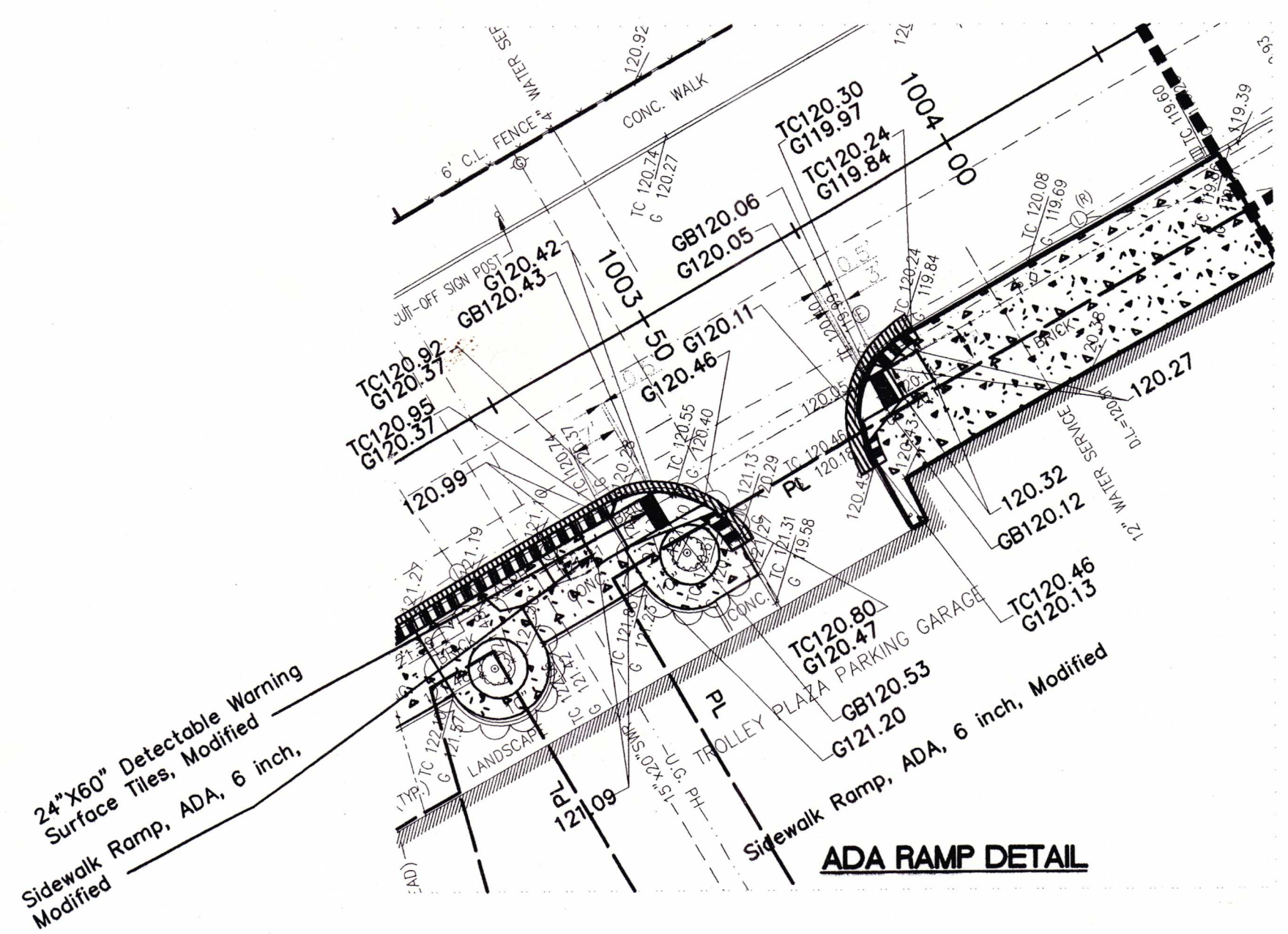

**NON PARTICIPATING QUANTITIES, THIS SHEET**

PAY ITEM	UNIT	QUANTITY
Integral Curb and Sidewalk, 2 Feet, Modified	Ft	218
Sidewalk, Conc. 4 inch, Modified	Sft	2054
Sidewalk, Conc. 6 inch, Modified	Sft	-
Conc Pavt, Misc, Nonreinf, 8 inch, Modified	Syd	14
Hand Patching	Ton	5
Sidewalk Ramp, ADA, 6 inch, Modified	Syd	19
24"X60" Detectable Warning Surface Tiles, Modified	Ea	2

**AS-BUILT**

3 WORKING DAYS BEFORE YOU DIG. CALL MISS DIG. 1-800-482-7171

BASE BID

F				
E				
D				
C				
B				
A				
DESCRIPTION	CHK'D	APP'VD	DATE	
REVISIONS				

DRAWN BY: MW  
DESIGNED BY: KD  
CHECKED BY: MH  
APPROVED BY: MH

LOWER WOODWARD CROSS STREETS IMPROVEMENTS  
CITY OF DETROIT - DOWNTOWN DEVELOPMENT AUTHORITY

CONSTRUCTION PLAN  
CLIFFORD - BAGLEY TO MATCHLINE (STA 1005+00)

SCALE: 1"=20'  
DATE: 08-28-08

220 W. CONGRESS, SUITE 400  
DETROIT, MI 48226  
PHONE: (313) 967-4700  
FAX: (313) 967-4707  
www.spaldingdecker.com

**hamiltonanderson**  
Hamilton Anderson Associates  
1435 Randolph Suite 200, Detroit, Michigan 48226  
P: 313 964 0270 | F: 313 964 0170  
www.hamiltonanderson.com

16500 Wyoming Avenue  
DETROIT, MI 48221-2982  
PHONE: (313) 341-5797  
FAX: (313) 341-0205  
www.consultang.com

**UES**  
20349 Alderton Street, Suite 200  
DETROIT, MI 48219-9550  
PHONE: (313) 434-8282  
FAX: (313) 537-7945  
www.urbanengineeringolutions.com

**DA**

CITY OF DETROIT  
DOWNTOWN DEVELOPMENT AUTHORITY

500 Griswold, Suite 2200,  
Detroit, MI 48226  
P: (313) 963-2940  
F: (313) 963-8893

M.D.P.H./D.N.R. PERMIT NO.

REF. NO. DE06001OT

CONTRACT NO.

FILE NO.

DRAWING NO. C-10-10