

C.S.E. 7-14-73 FINAL B.D.W.

CITY OF DETROIT
DEPARTMENT OF PUBLIC WORKS
 IN CO-OPERATION WITH
MICHIGAN DEPARTMENT OF STATE HIGHWAYS
 AND
FEDERAL HIGHWAY ADMINISTRATION
 PLAN AND PROFILE OF PROPOSED
FEDERAL AID URBAN PROJECT NO. MICHIGAN M-5142 (00)
JOB No. 05304

THE IMPROVEMENTS COVERED BY THESE PLANS SHALL BE DONE IN ACCORDANCE WITH THE MICHIGAN DEPARTMENT OF STATE HIGHWAYS CURRENT STANDARD SPECIFICATIONS AND SUPPLEMENTAL SPECIFICATIONS.

B.P.R. DIV. NO.	STATE	PROJECT NO.	FISCAL YEAR	SHEET NO.	TOTAL SHEETS
4	MCH.	05304			
STREET	CITY	COUNTY	TWP.	SHEET NO.	TOTAL SHEETS
	DETROIT	WAYNE		500	2

CONTRACT FOR PLYMOUTH AVE. ROW, MANSFIELD TO GREENFIELD

LOCAL AUTHORITY APPROVAL
 CITY OF DETROIT
 DEPARTMENT OF PUBLIC WORKS
 GOVERNMENTAL AGENCY

RECOMMENDED FOR APPROVAL M. S. Progn 3-9-73
 HIGHWAY ENGINEER DATE

APPROVED BY [Signature] ASST. CITY ENGINEER DATE

APPROVED BY [Signature] CITY ENGINEER 3-1-73 DATE

LOCAL AUTHORITY APPROVAL
 CITY OF DETROIT
 DEPARTMENT OF STREETS AND TRAFFIC
 GOVERNMENTAL AGENCY

APPROVED BY R. R. Hicks 3-9-73
 DIRECTOR OF DEPT. OF STREETS & TRAFFIC DATE

RECOMMENDED FOR APPROVAL

BY _____ ENGINEER OF TRAFFIC AND SAFETY DATE

BY _____ CONSTRUCTION ENGINEER DATE

BY _____ F.A.S. ENGINEER DATE

PLANS CHECKED BY _____ DATE

DEPARTMENT OF STATE HIGHWAYS APPROVAL
 APPROVED FOR COMMISSION

BY _____ DEPUTY DIRECTOR DATE

PREPARED UNDER SUPERVISION OF

REGISTERED PROFESSIONAL ENGINEER REGISTRATION NO. _____

CITY OF DETROIT ORGANIZATION

DETROIT, MICHIGAN ADDRESS

(SEAL)

U. S. DEPARTMENT OF TRANSPORTATION
 FEDERAL HIGHWAY ADMINISTRATION

APPROVED _____
 DISTRICT ENGINEER DATE

FILE NO.	STATE	PROJECT	FEDERAL PROJECT	SHEET NO.	TOTAL SHEETS
R 82571	MI	05304		500	2

INDEX OF SHEETS

STANDARD PLANS

SEE SHEET No. 2

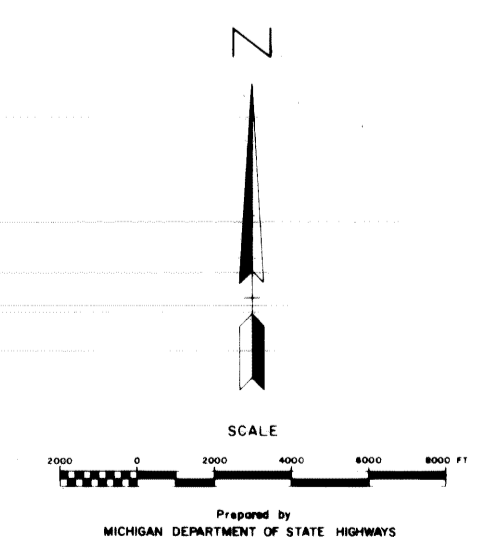
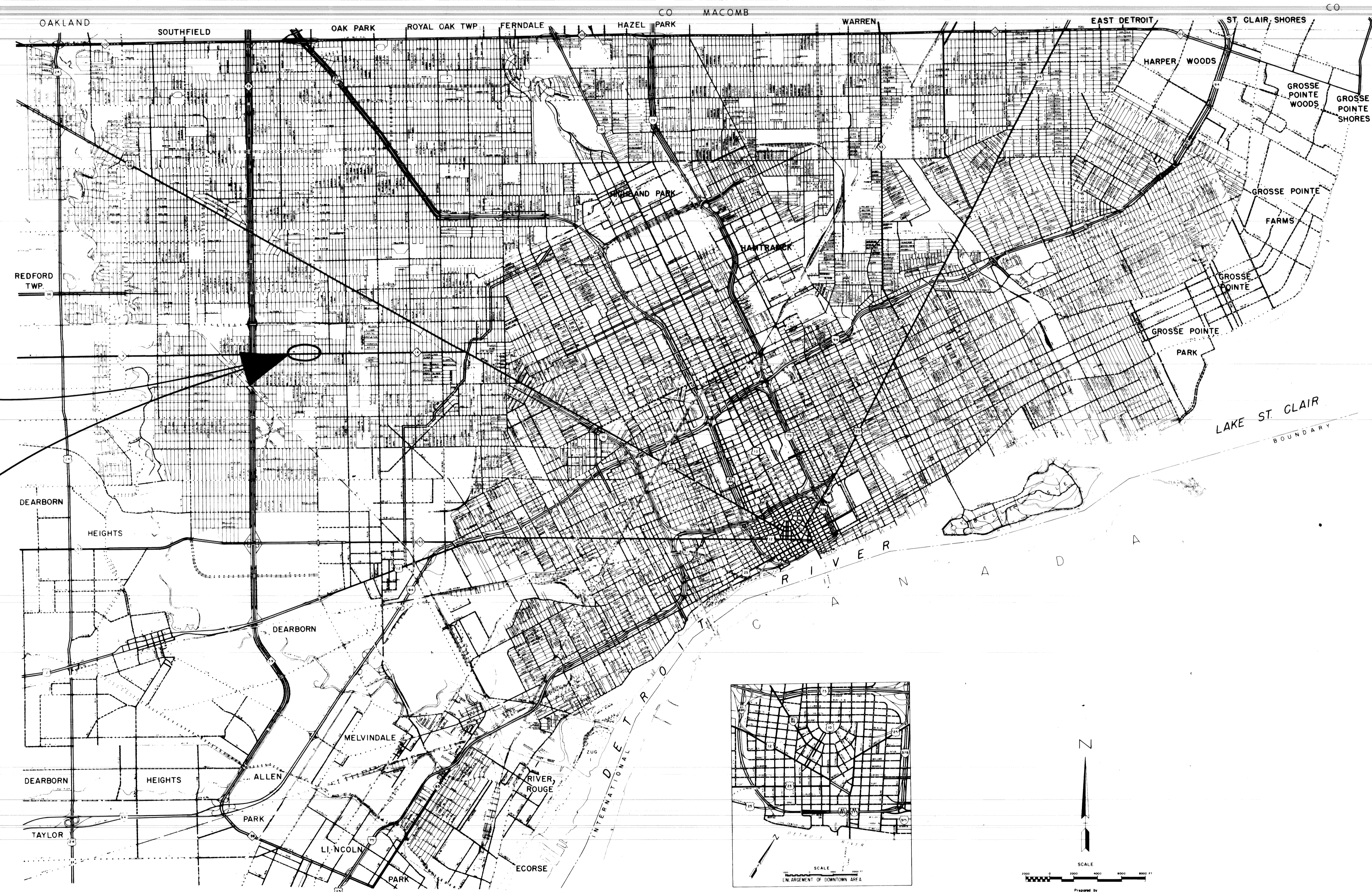

R.O.W. SECTION M-5142(00) JOB NUMBER 05304

This sheet sent with R.O.W. Drawing Mansfield to Greenfield

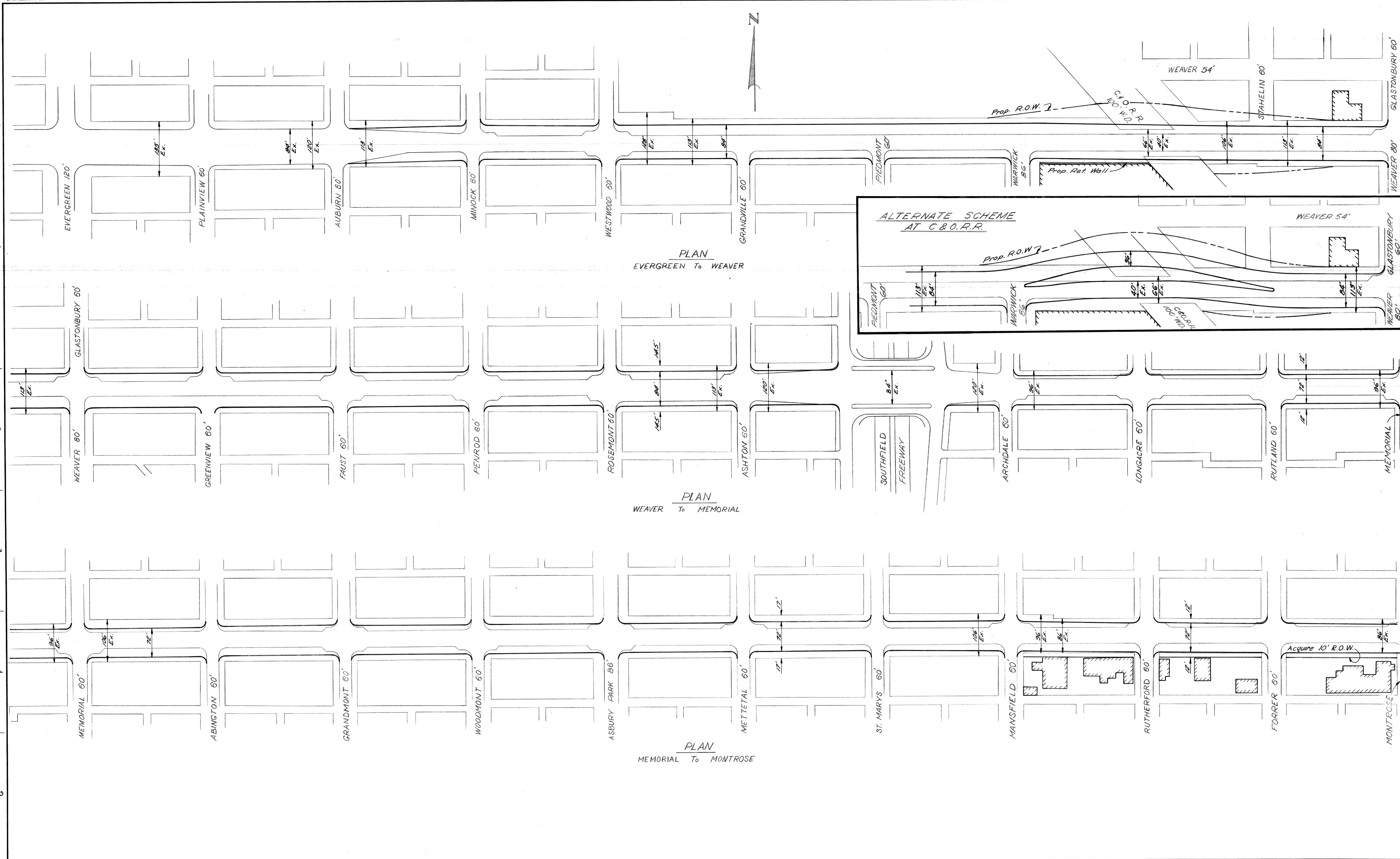

PLAN
EVERGREEN To WEAVER

PLAN
WEAVER To MEMORIAL

PLAN
MEMORIAL To MONTROSE

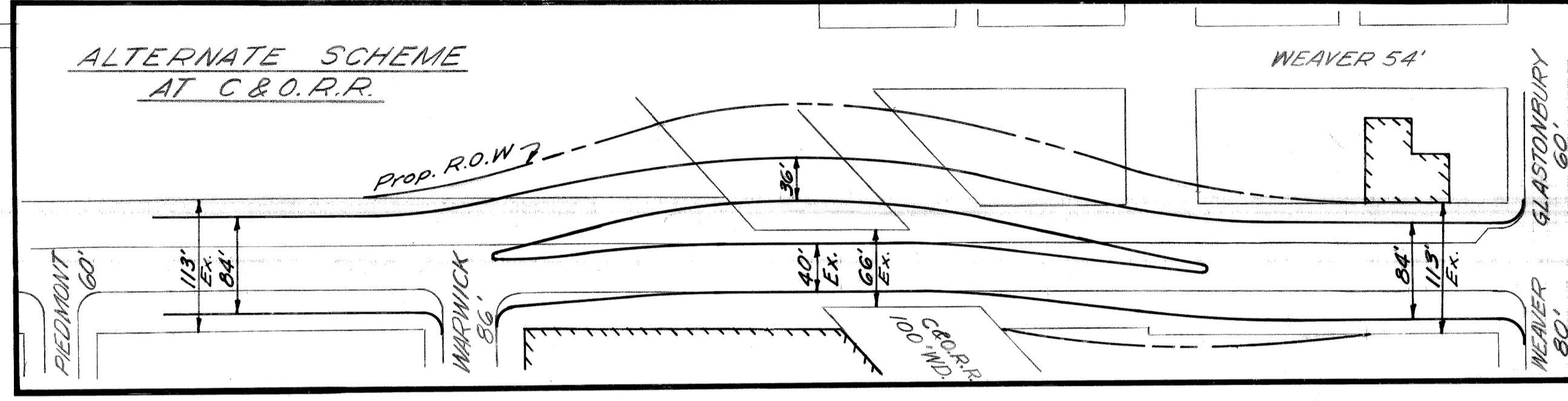

ALTERNATE SCHEME
AT C & O.R.R.

COORD	DESCRIPTION	DRN	CKD	APYD	DATE

REFERENCE DRAWINGS

DESIGNED BY	
DRAWN BY	G. HABERER
TRACED BY	
CHECKED BY	

APPROVED:	

CITY OF DETROIT
 DEPARTMENT OF PUBLIC WORKS
 BUREAU of HIGHWAYS & EXPRESSWAYS

PROPOSED WIDENING
 PLYMOUTH ROAD — M14
 EVERGREEN TO MONTROSE

SHEET 1 OF 2 SHEETS
CONTRACT No.
DRWG NO.
DATE

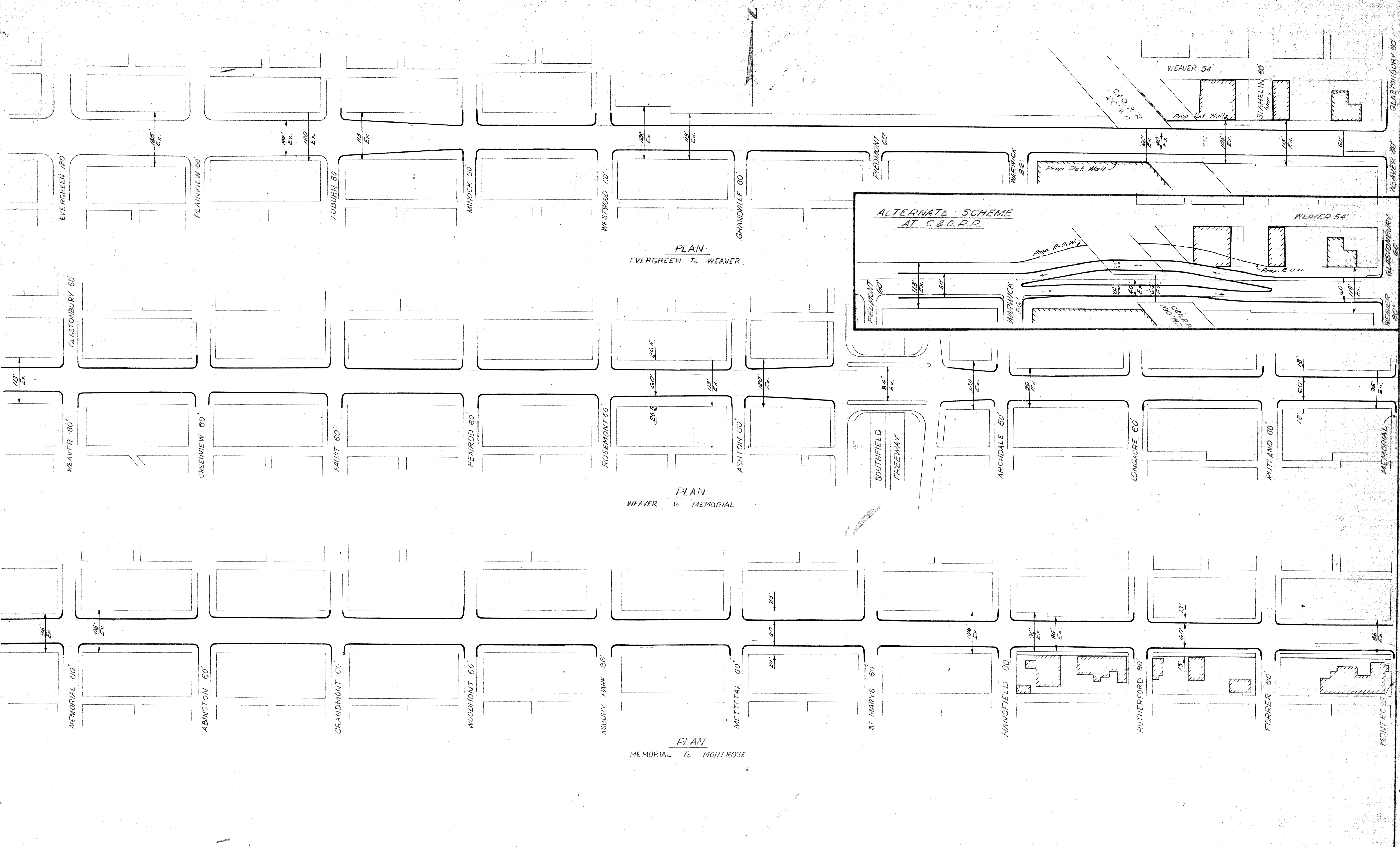
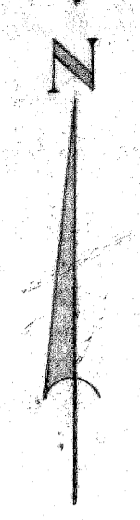

PLAN
EVERGREEN To WEAVER

PLAN
WEAVER To MEMORIAL

PLAN
MEMORIAL To MONTROSE

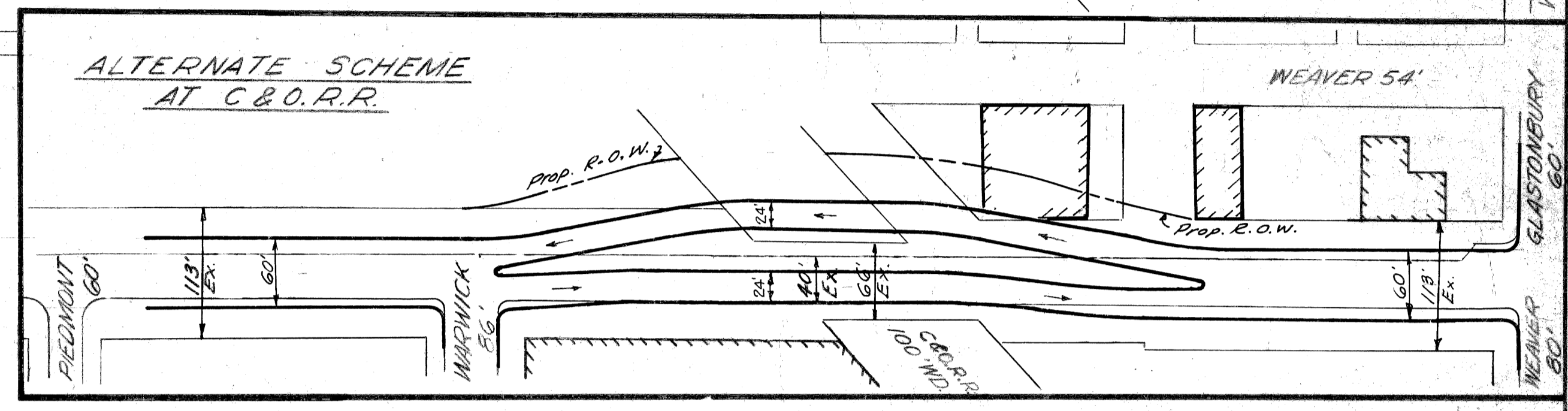

ALTERNATE SCHEME
AT C & O. R.R.

60' Pav'th. Width & Underpass		FC	2-69	REFERENCE DRAWINGS	DESIGNED BY	APPROVED:	<p align="center">CITY OF DETROIT DEPARTMENT OF PUBLIC WORKS BUREAU of HIGHWAYS & EXPRESSWAYS</p>	<p align="center">PROPOSED WIDENING PLYMOUTH ROAD — M14 EVERGREEN TO MONTROSE</p>	PROPOSED 60 FT. PAVEMENT	
DRAWN BY		G. HABERER		TRACED BY		SHEET 1 OF 2 SHEETS				
CHECKED BY				CITY ENGINEER		CONTRACT No.				
REVISIONS LOCATED BY COORDINATES ON SHEET						DRWG No. (A)				
1	2	3	4	5	6	7	8	9	10	11

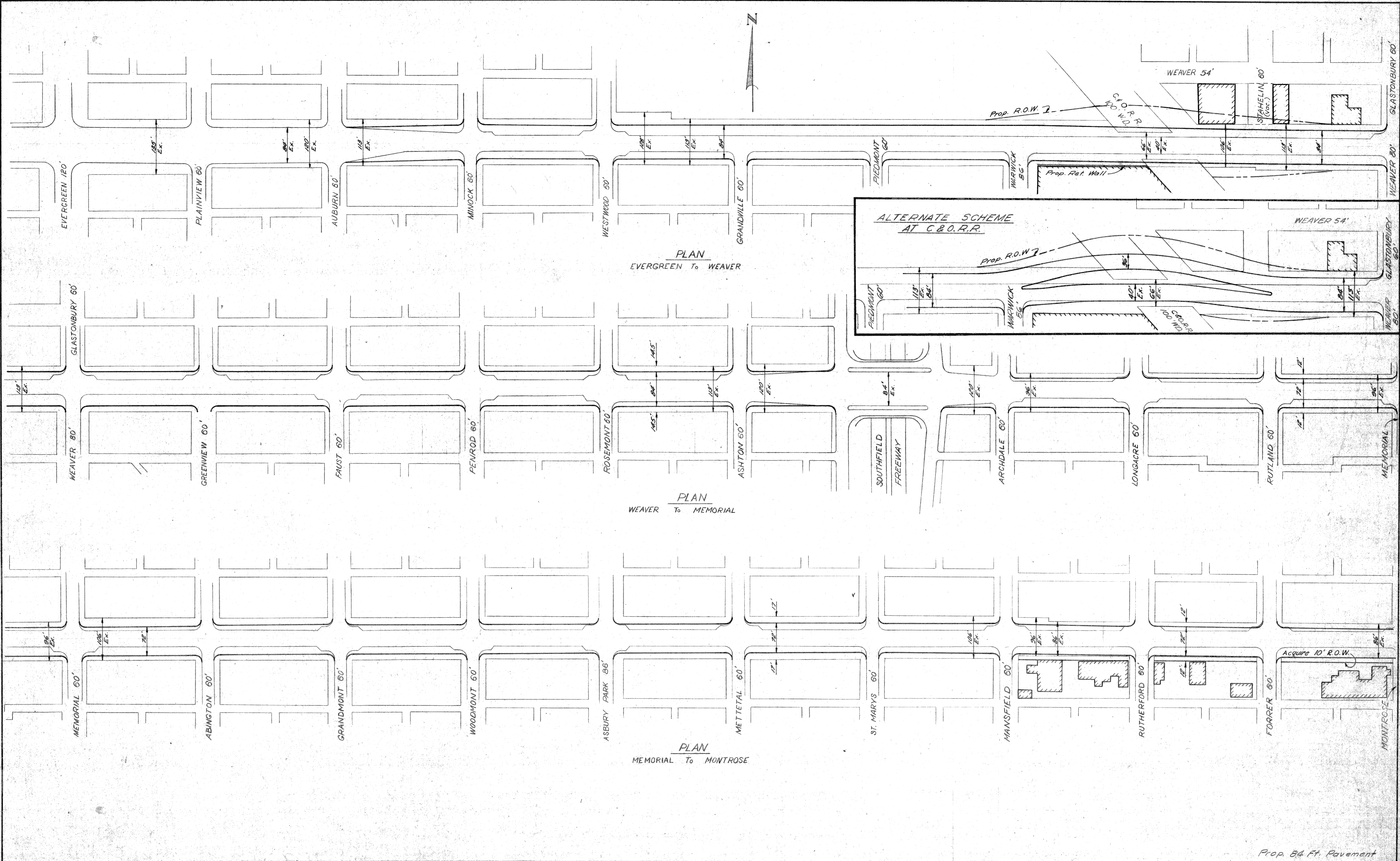

PLAN
EVERGREEN To WEAVER

PLAN
WEAVER To MEMORIAL

PLAN
MEMORIAL To MONTROSE

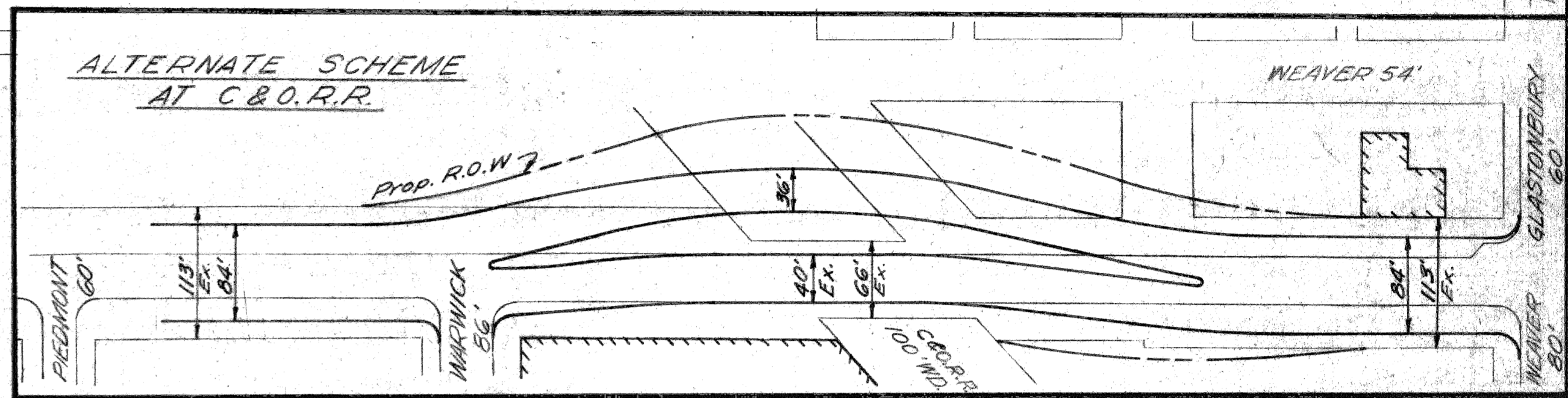

REFERENCE DRAWINGS DESIGNED BY DRAWN BY G. HABERER TRACED BY CHECKED BY		APPROVED: CITY ENGINEER	CITY OF DETROIT DEPARTMENT OF PUBLIC WORKS BUREAU of HIGHWAYS & EXPRESSWAYS	PROPOSED WIDENING PLYMOUTH ROAD — M14 EVERGREEN TO MONTROSE	SHEET 1 OF 2 SHEETS CONTRACT No. (B) DRWG No. DATE 7-65
COORD	DESCRIPTION	DRW	CHKD	APPROV	DATE
REVISIONS LOCATED BY COORDINATES ON SHEET					

Prop. 84 Ft. Pavement

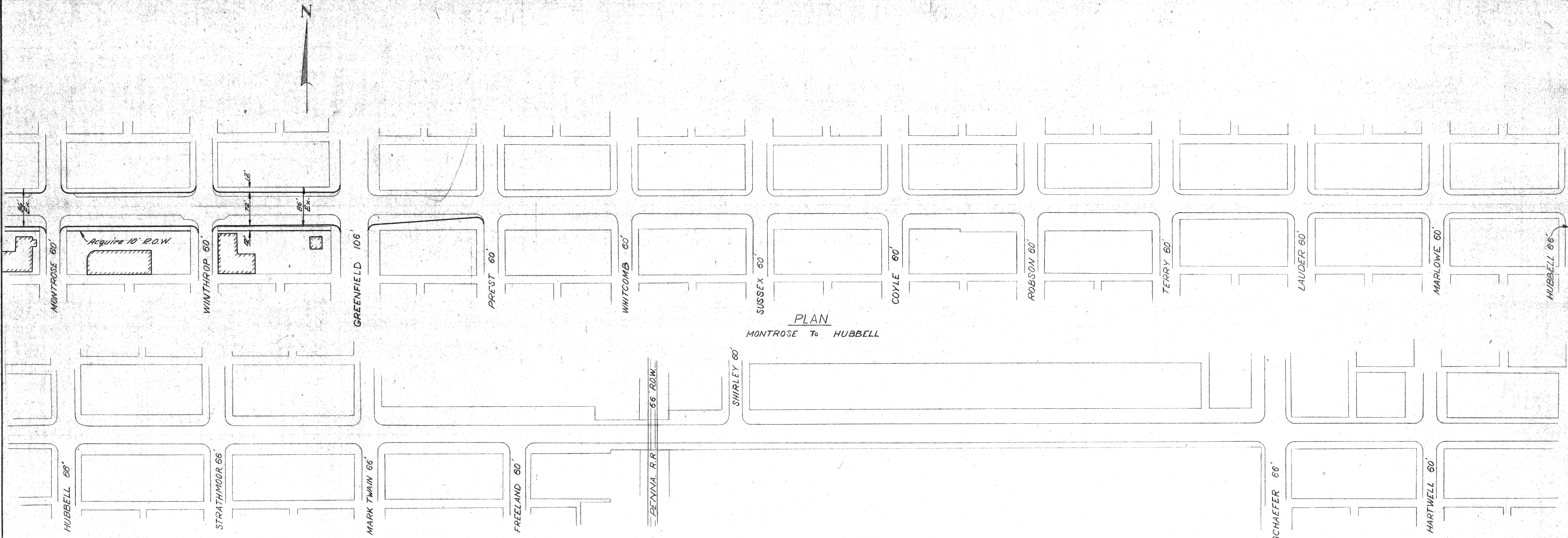

PLAN
MONTROSE To HUBBELL

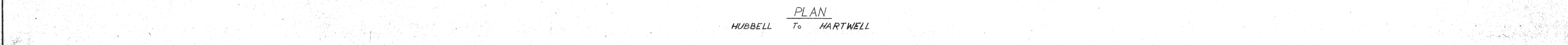

PLAN
HUBBELL To HARTWELL

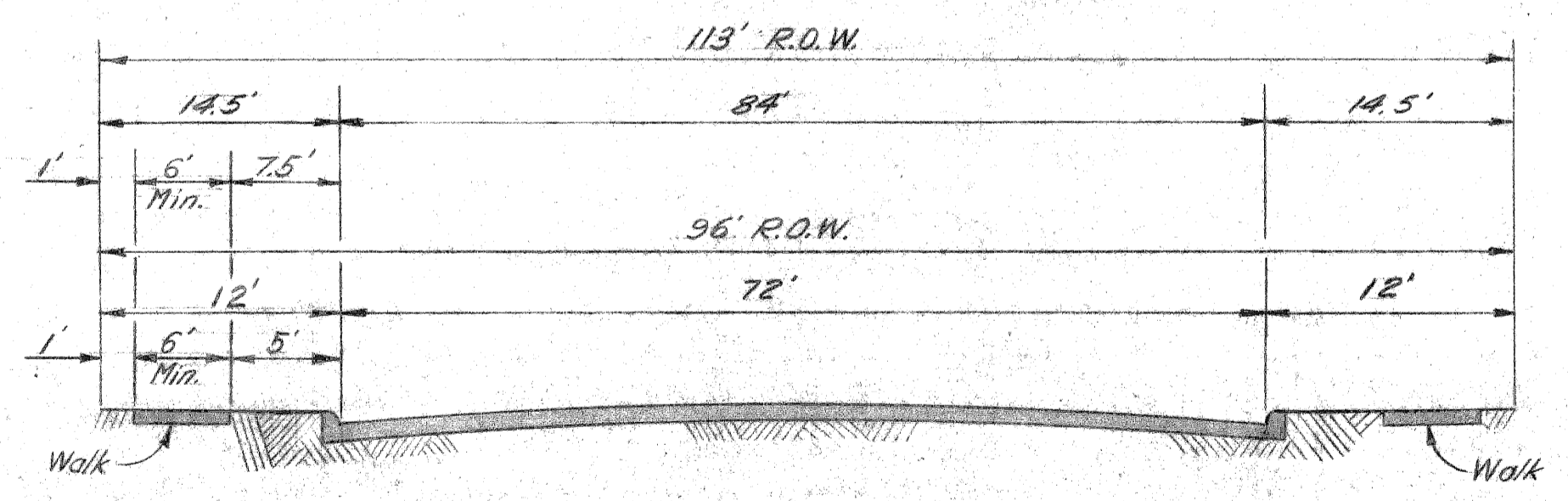

TYPICAL CROSS-SECTION

Prop. 84 Ft. Pavement

Curb/Gutter to Curb Only Typical Cross-Section		C.M.	72715	REFERENCE DRAWINGS	DESIGNED BY	APPROVED:	<p align="center">CITY OF DETROIT DEPARTMENT OF PUBLIC WORKS BUREAU OF HIGHWAYS & EXPRESSWAYS</p>	<p align="center">PROPOSED WIDENING PLYMOUTH ROAD - M14 MONTROSE TO SCHAEFER</p>	SHEET 2 OF 2 SHEETS
					DRAWN BY G. HABERER				CONTRACT NO.
					TRACED BY				DRWG NO. (B)
					CHECKED BY				DATE 7-65
COORD.	DESCRIPTION	BY	CHK'D	APPROV'D	DATE	CITY ENGINEER			



C 40 P.E. - 10' B.O.M.

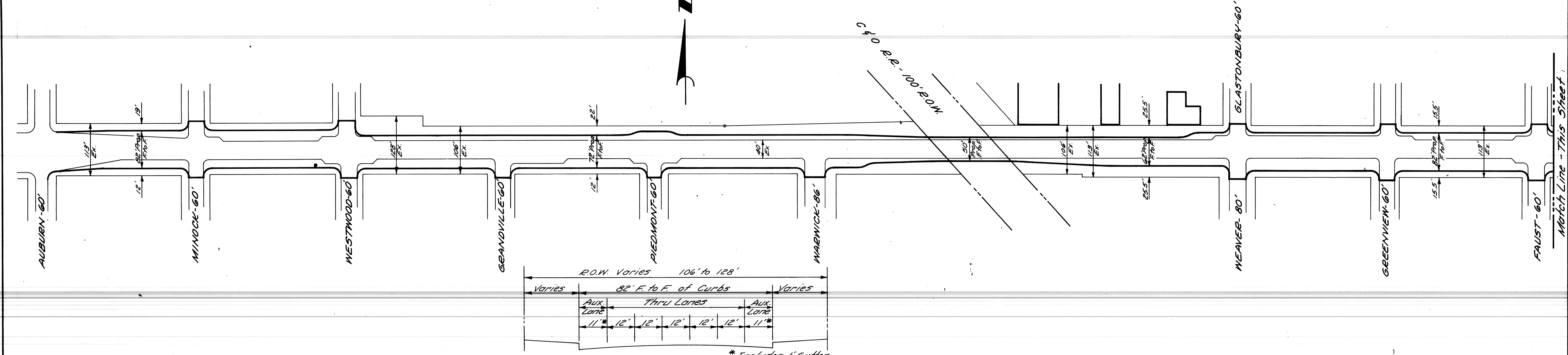

TYPICAL SECTION
AUBURN TO WESTWOOD-GREENVIEW TO SOUTHFIELD
*Includes 1' gutter

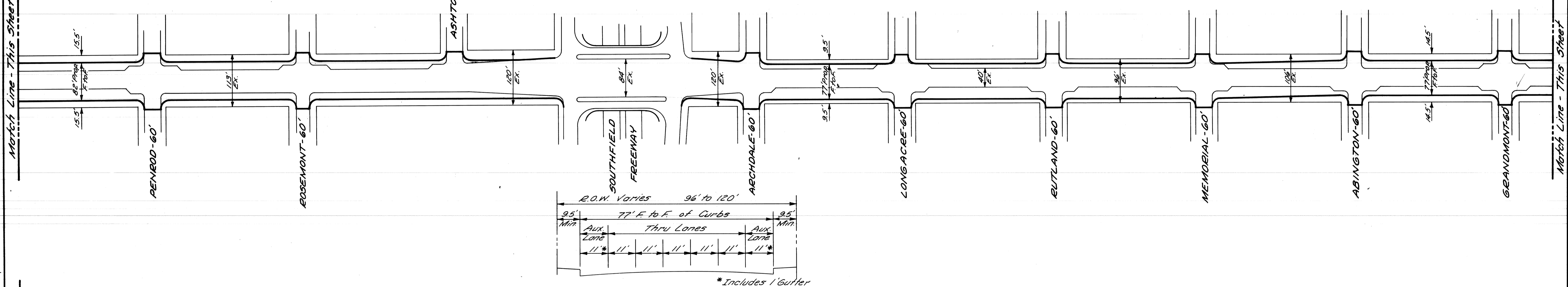

TYPICAL SECTION
SOUTHFIELD TO GREENFIELD
*Includes 1' gutter

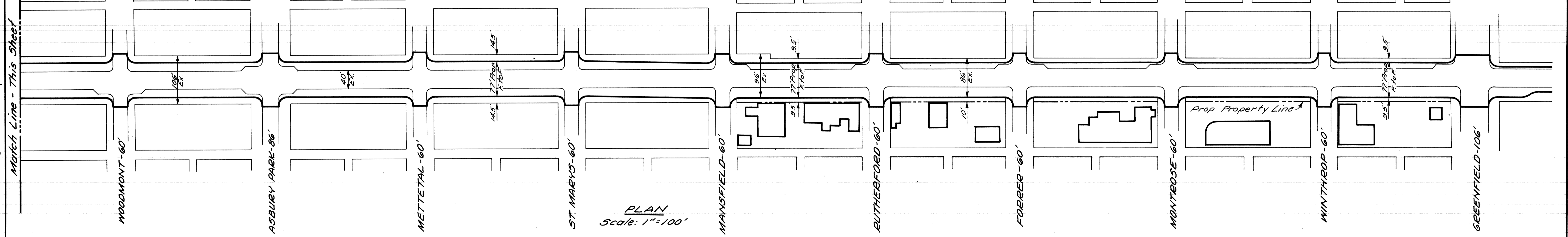

PLAN
Scale: 1" = 100'

COORD. DESCRIPTION REVISIONS LOCATED BY COORDINATES ON SHEET	DESIGNED BY	APPROVED: CITY ENGINEER	CITY OF DETROIT DEPARTMENT OF PUBLIC WORKS CITY ENGINEERS OFFICE FOR	PLYMOUTH RD. WIDENING - MI4 AUBURN TO GREENFIELD	SHEET ___ OF ___ SHEETS
	DRAWN BY				CONTRACT No.
	TRACED BY				DRWG No.
	CHECKED BY				DATE 1-5-73

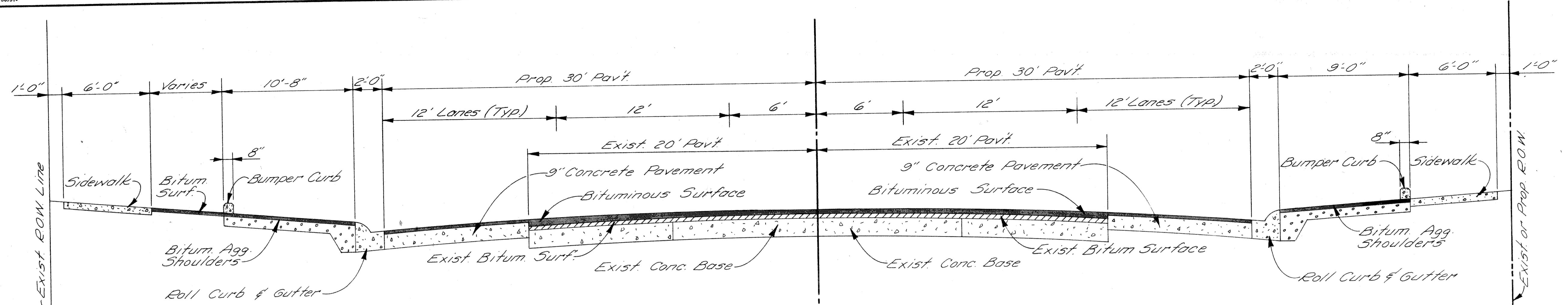

TYPICAL HALF SECTION
MARGINS BETWEEN 18 & 23 FEET
WITH PARKING
 NO SCALE

TYPICAL HALF SECTION
18 FOOT MARGIN WITH PARKING
 NO SCALE

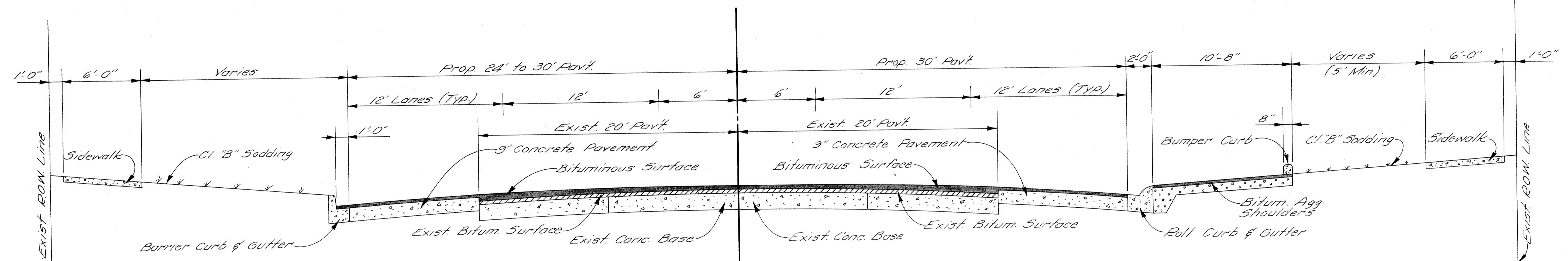

TYPICAL HALF SECTION
VARIABLE MARGIN WITH NO PARKING
 NO SCALE

TYPICAL HALF SECTION
VARIABLE MARGIN WITH SODDING & PARKING
 NO SCALE

NO.	DESCRIPTION	OWN	CHKD	APPROV	DATE

DESIGNED BY		APPROVED:	
DRAWN BY	M. POLITO		
TRACED BY			
CHECKED BY			

CITY OF DETROIT
 DEPARTMENT OF PUBLIC WORKS
 CITY ENGINEERS OFFICE
 FOR

PLYMOUTH RD. WIDENING - M-14
TYPICAL CROSS-SECTIONS
AUBURN TO SUSSEX

SHEET <u>2</u> OF <u>4</u> SHEETS
CONTRACT NO.
DRWG. NO.
DATE FEB 22, 1972

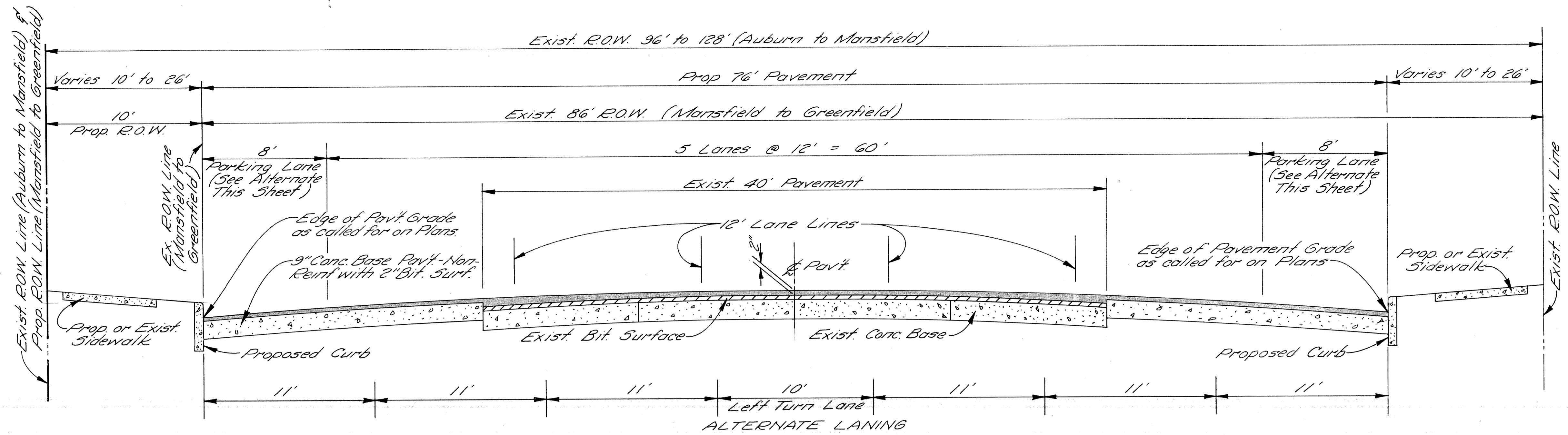

TYPICAL CROSS - SECTION
PLYMOUTH RD. WIDENING AND RESURFACING
 NO SCALE

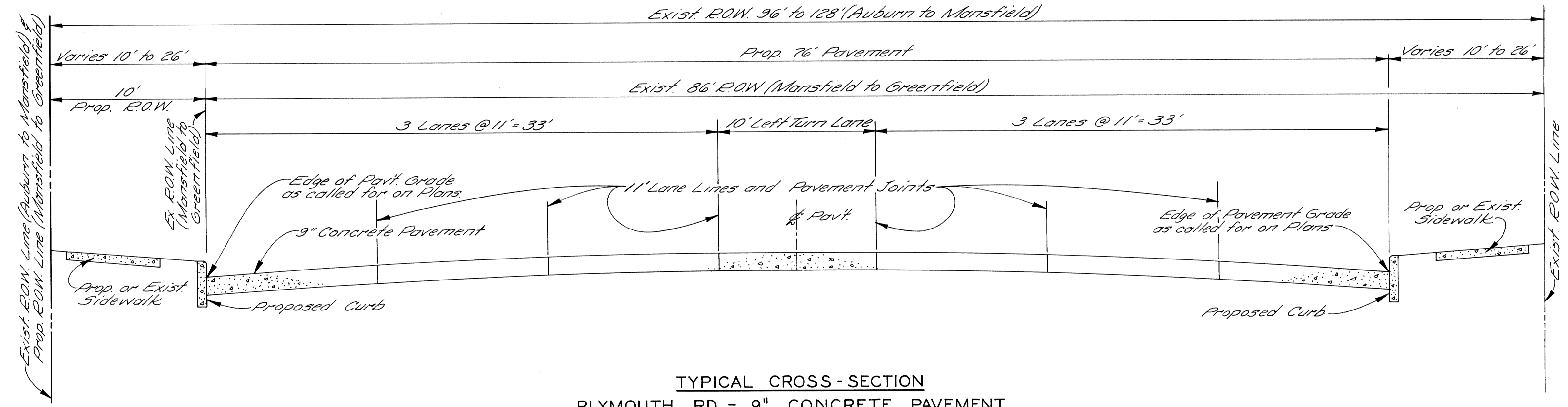

TYPICAL CROSS - SECTION
PLYMOUTH RD. - 9" CONCRETE PAVEMENT
 NO SCALE

COORD. DESCRIPTION REVISIONS LOCATED BY COORDINATES ON SHEET		REFERENCE DRAWINGS	DESIGNED BY DRAWN BY M.A.P. TRACED BY CHECKED BY	APPROVED: HIGHWAY & EXPRESSWAY ENGINEER	CITY OF DETROIT DEPARTMENT OF PUBLIC WORKS HIGHWAY & EXPRESSWAY DIVISION	PROPOSED PLYMOUTH ROAD WIDENING - M14 TYPICAL CROSS-SECTIONS AUBURN TO PREST	SHEET ___ OF ___ SHEETS JOB No. DRWG No. DATE 9-15-70
---	--	--------------------	---	--	--	--	--

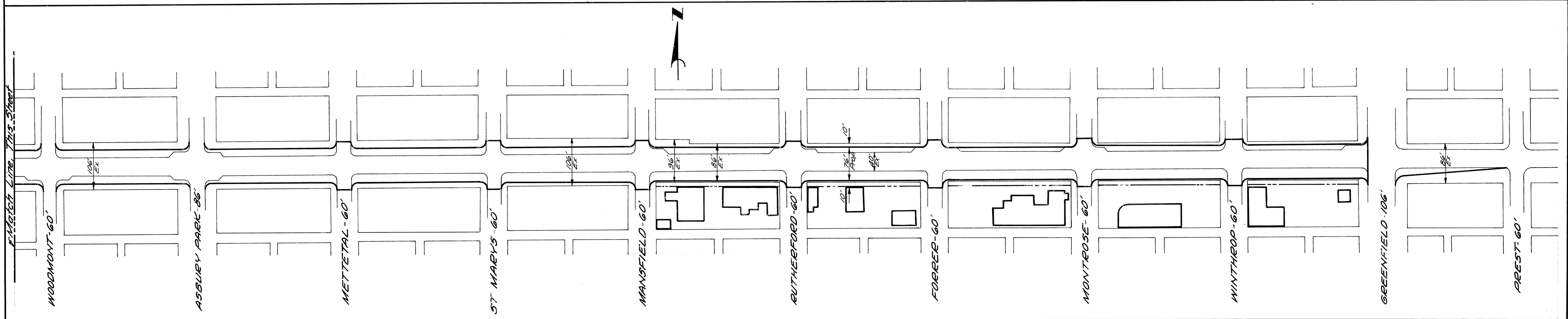
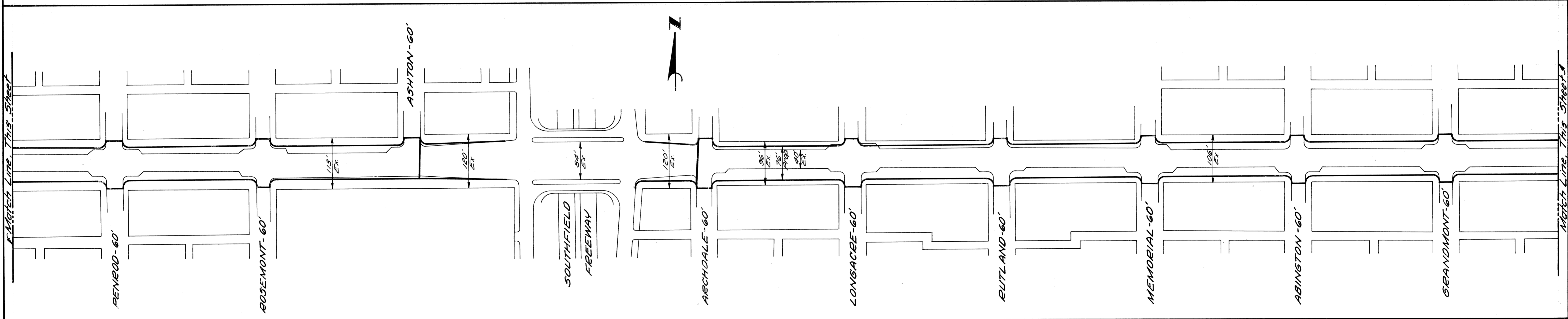
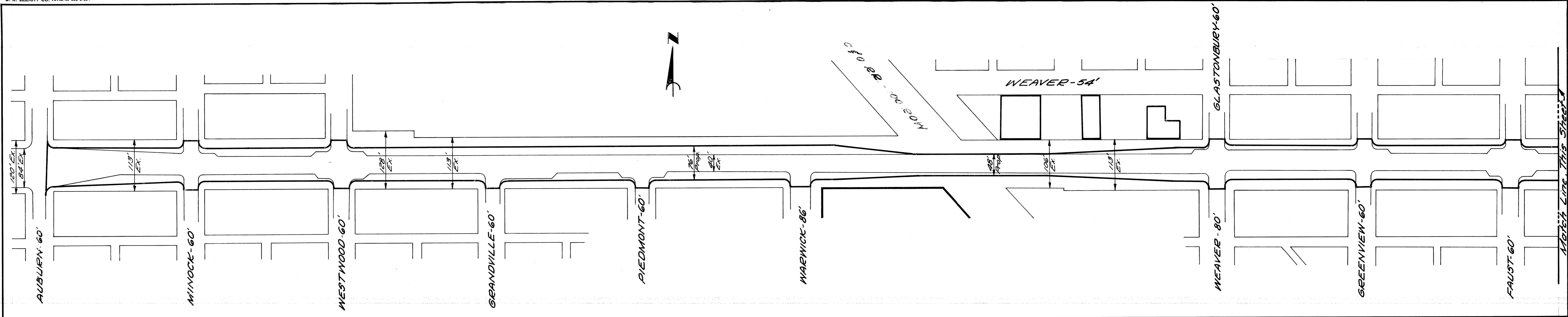

COORD	DESCRIPTION	DRN	CHK	AP'D	DATE

REVISIONS LOCATED BY COORDINATES ON SHEET

DESIGNED BY	M. A. P
DRAWN BY	
TRACED BY	
CHECKED BY	

APPROVED:	
HIGHWAY & EXPRESSWAY ENGINEER	

CITY OF DETROIT
 DEPARTMENT OF PUBLIC WORKS
 HIGHWAY & EXPRESSWAY DIVISION

PROPOSED PLYMOUTH RD. WIDENING - M14
 AUBURN TO PREST

SHEET	___	OF	___	SHEETS
JOB No.				
DRWG No.				
DATE	9 - 15 - 70			

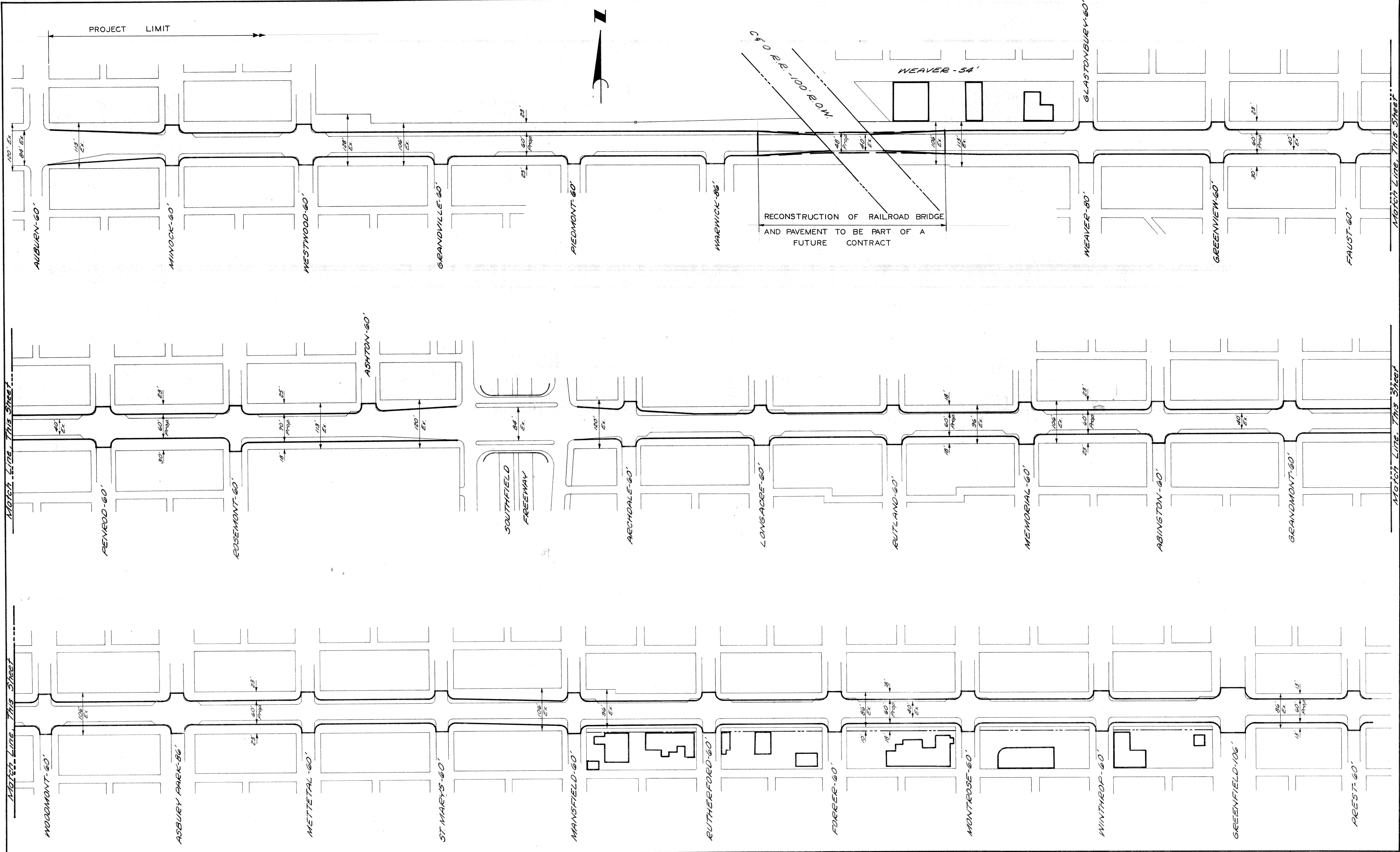

COORD.	DESCRIPTION	DWN.	CHK.	APVD.	DATE
REVISIONS LOCATED BY COORDINATES ON SHEET					

DESIGNED BY	M. POLITO
DRAWN BY	
TRACED BY	
CHECKED BY	

APPROVED:	
HIGHWAY & EXPRESSWAY ENGINEER	

CITY OF DETROIT
 DEPARTMENT OF PUBLIC WORKS
 HIGHWAY & EXPRESSWAY DIVISION

PLYMOUTH RD. WIDENING - M14
 PROP. 60 FT. PAVEMENT
 AUBURN TO PREST

SHEET 3 OF 4 SHEETS
JOB No.
DRWG No.
DATE FEB. 8, 1972

C&G 7/6/73 Final ROW
 C&G 8/15/73 4'-26" ROW 16'9" of 16/156

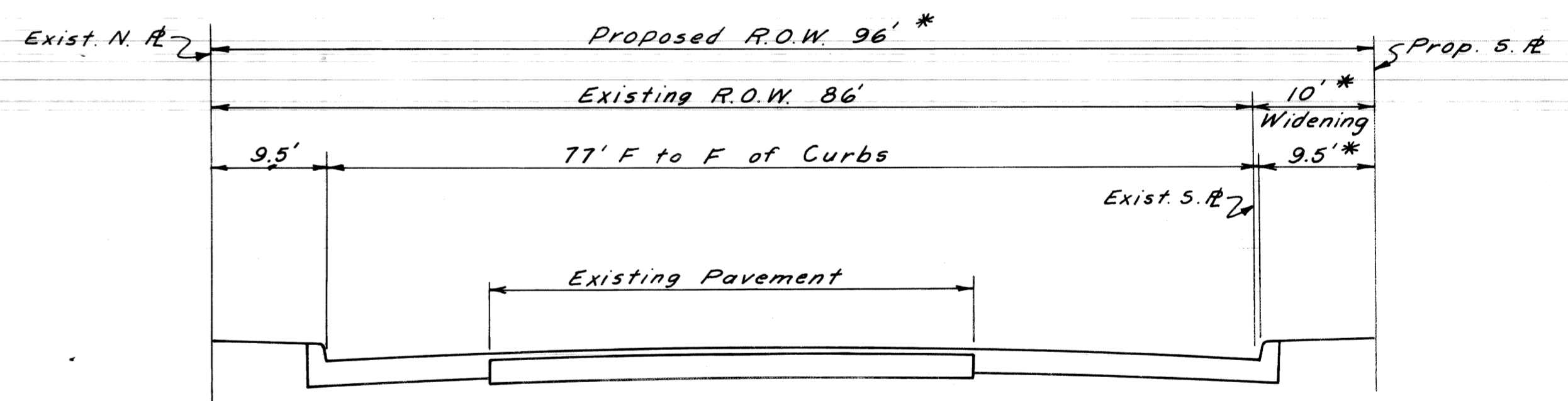
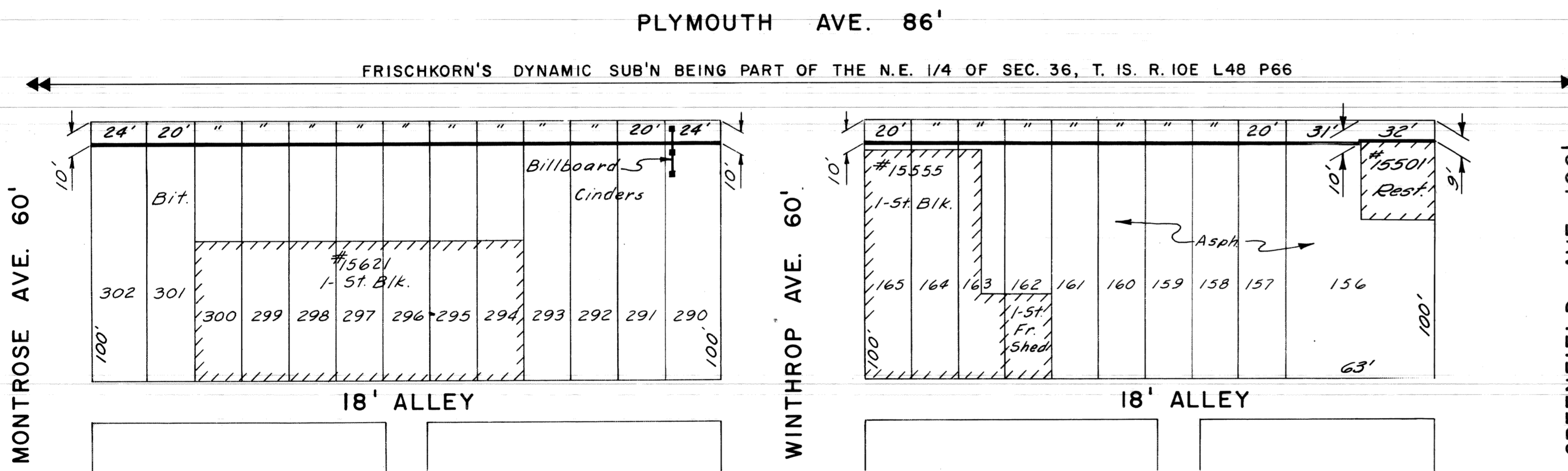
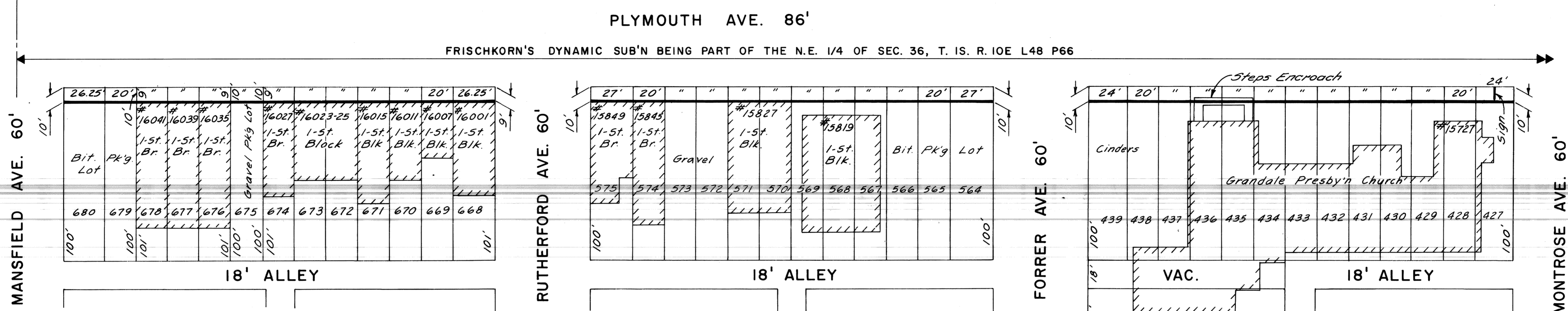

* Reduce dimensions by 1 foot at buildings located between Mansfield & Rutherford, & Winthrop & Greenfield.

CROSS SECTION

R 82571 JN 05304

Revised ROW & Relocated Bldg. in Lot # 36 M.P. 8/6/73		REFERENCE DRAWINGS	DESIGNED BY	APPROVED:	CITY OF DETROIT DEPARTMENT OF PUBLIC WORKS CITY ENGINEERS OFFICE FOR	PLYMOUTH AVE. WIDENING - M14 R.O.W. - MANSFIELD TO GREENFIELD	SHEET 501 OF 2 SHEETS
			DRAWN BY				CONTRACT No.
			TRACED BY				DRWG No.
			CHECKED BY <i>A. Proyer</i>	CITY ENGINEER			DATE 3-9-73

COORD. DESCRIPTION DW. C&G APVD. DATE
 REVISIONS LOCATED BY COORDINATES ON SHEET

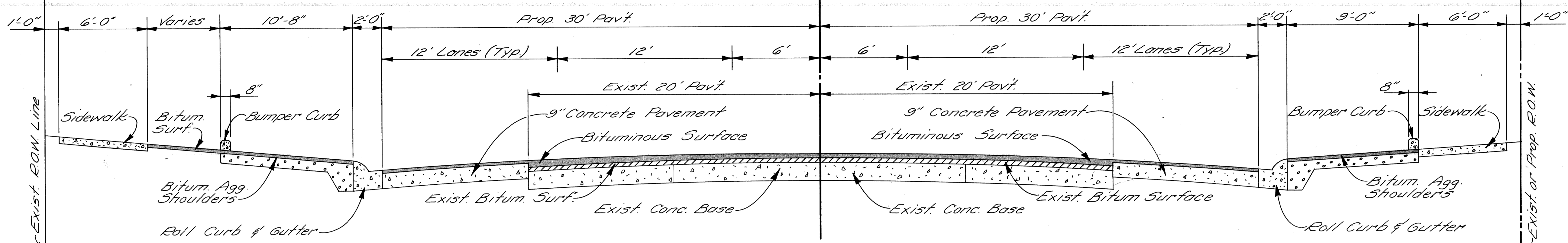

TYPICAL HALF SECTION
MARGINS BETWEEN 18 & 23 FEET
WITH PARKING
NO SCALE

TYPICAL HALF SECTION
18 FOOT MARGIN WITH PARKING
NO SCALE

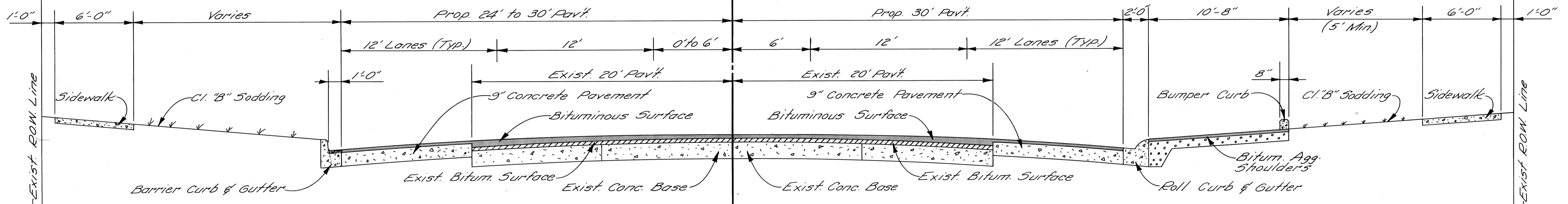

TYPICAL HALF SECTION
VARIABLE MARGIN WITH NO PARKING
NO SCALE

TYPICAL HALF SECTION
VARIABLE MARGIN WITH SODDING & PARKING
NO SCALE

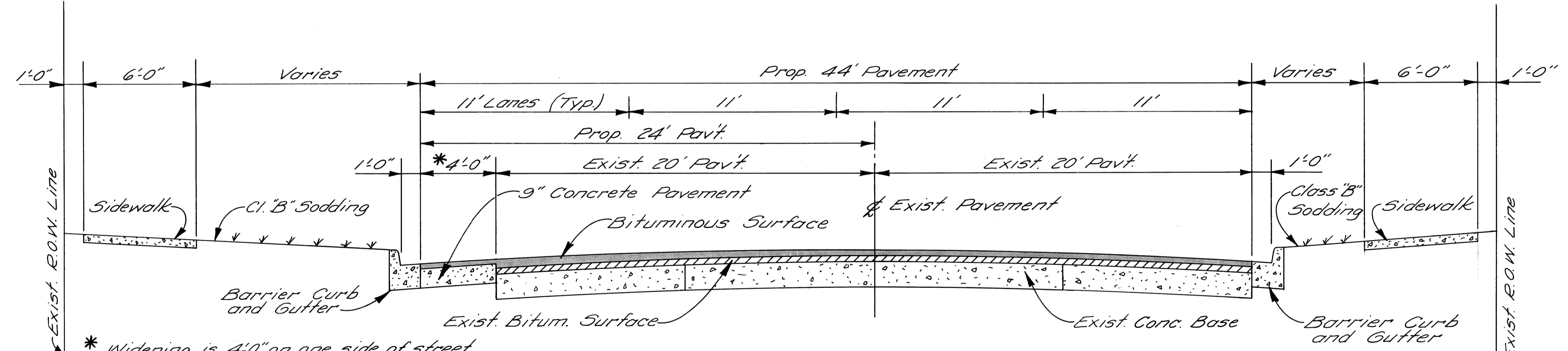

TYPICAL CROSS SECTION
44 FT. PAVEMENT - VARIABLE MARGIN WITH NO PARKING
NO SCALE

* Widening is 4'-0" on one side of street only, or 2'-0" on each side of street. In both cases there will be new curbs on each side.

DESIGNED BY		APPROVED:		CITY OF DETROIT DEPARTMENT OF PUBLIC WORKS CITY ENGINEERS OFFICE FOR	PLYMOUTH RD. WIDENING - M-14 TYPICAL CROSS-SECTIONS	SHEET <u>2</u> OF <u>3</u> SHEETS
DRAWN BY						CONTRACT NO.
TRACED BY						DRWG NO.
CHECKED BY						DATE FEB. 22, 1972
COORD.	DESCRIPTION	DRN	CKD	APVD	DATE	
REVISIONS LOCATED BY COORDINATES ON SHEET						

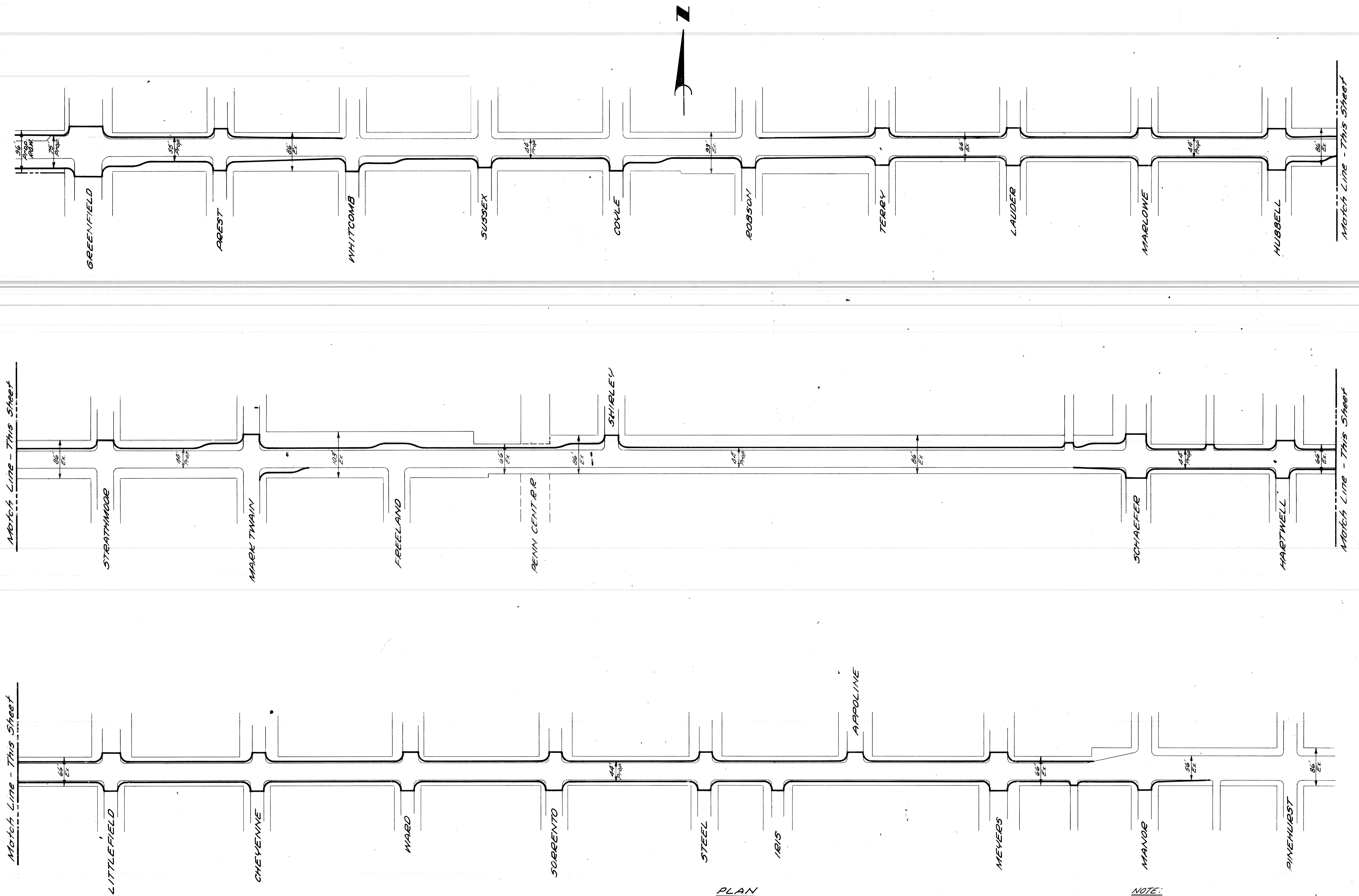

PLAN
Scale: 1"=100'

NOTE:
Pavt widths do not include curb offset.

1-2-73 Align Change @ Grt Rd. Bus Boys Added M.P.				
COORD	DESCRIPTION	DRN	CKD	APVD DATE
REVISIONS LOCATED BY COORDINATES ON SHEET				

DESIGNED BY	M. POLITO
DRAWN BY	
TRACED BY	
CHECKED BY	

APPROVED:	
HIGHWAY & EXPRESSWAY ENGINEER	

CITY OF DETROIT
 DEPARTMENT OF PUBLIC WORKS
 HIGHWAY & EXPRESSWAY DIVISION

PLYMOUTH RD. WIDENING - M-14
PROP. 44 FT. PAVEMENT
GREENFIELD TO MANOR

SHEET <u>3</u> OF <u>3</u> SHEETS
JOB No.
DRWG No.
DATE FEB. 11, 1972