

# GRAND RIVER ~ SUPERHIGHWAY

## TYPICAL CROSS-SECTION

Open tracks paved as follows:  
 Greenfield to 6 mi. 1930  
 Compounded concrete by D.S.R.  
 6 mi. to Bedford Rd.  
 Paved concrete, for D.S.R. by Wayne Co. Rd.

*Note:*

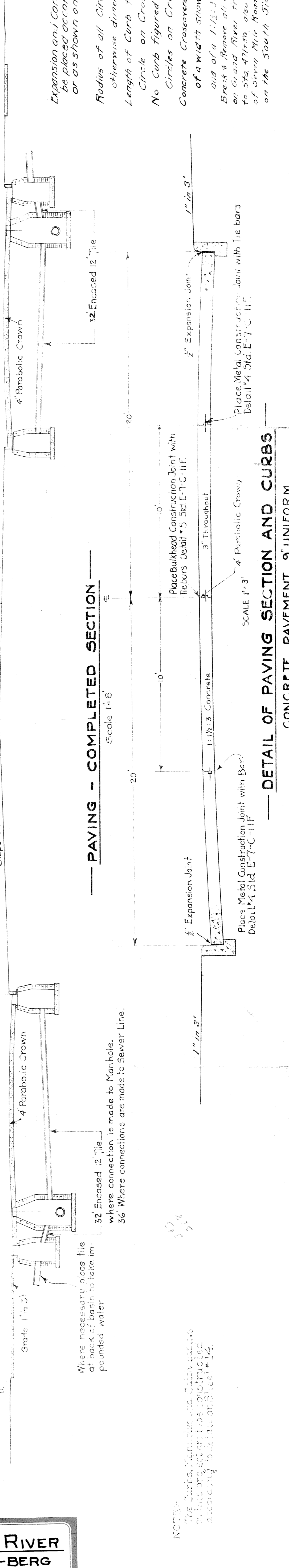
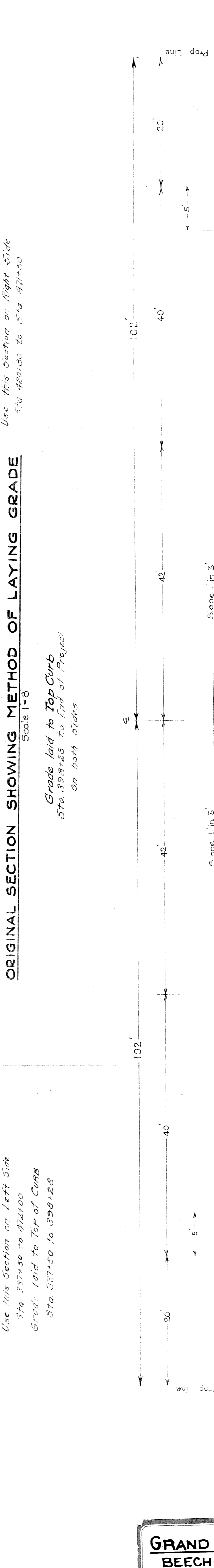
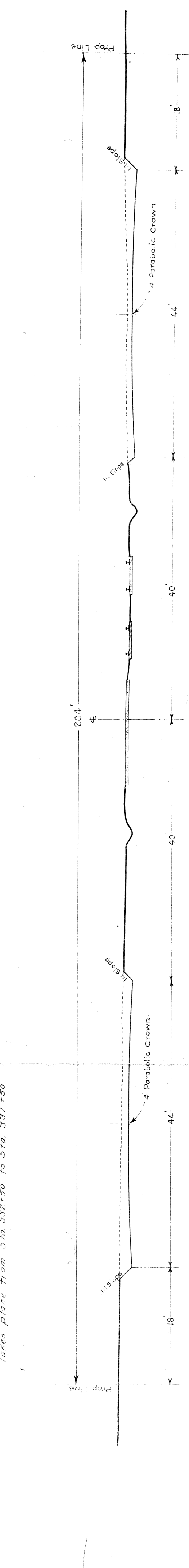
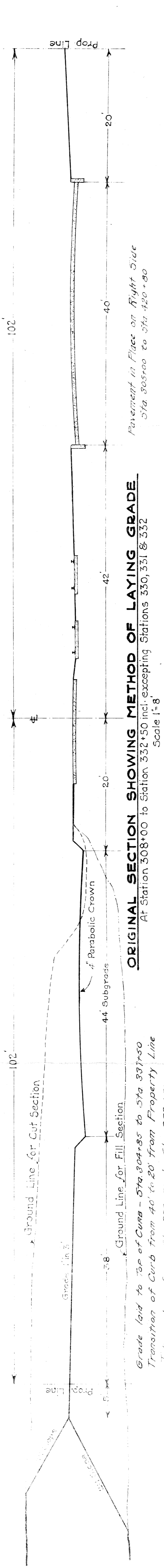

Expansion and Construction joints are to be placed according to Sid E-7-C-11F or as shown on these plans.

Radius of all circles 20', unless otherwise dimensioned.

Length of Curb figured to end of Circle on Crossovers.

No Curb figured between ends of Concrete Crossovers.

Concrete Crossovers are to be 9' thick and of a 1:1.25:3 Mix.

Back & Remove along the Old 16' Pavement on Grand River from Sta. 337+50 to Sta. 471+50, also the Inter-connection of Grand River Road to the Property Line on the South Side.

B.M. #2 Elev. 626.03  
 Spike in 12" tile  
 1/16 Lt Sta. 307+10

B.M. #1 - Elev. 629.98  
 Spike in 18" tile  
 98' Lt Sta. 306+80

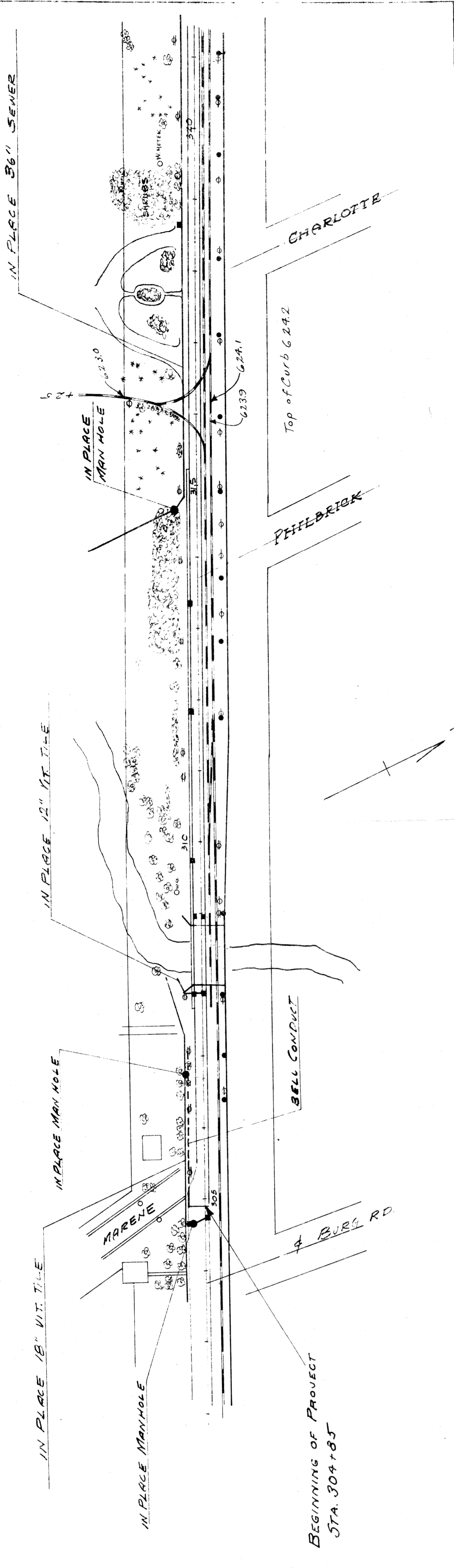

BOARD OF  
 WAYNE COUNTY ROAD COMMISSIONERS  
 DETROIT, MICHIGAN  
 WILLIAM E. BUTLER, JOHN W. CASPER, JOSEPH W. LINDSEY, EDWARD N. PINES, COMMISSIONERS

PLAN AND PROFILE  
 GRAND RIVER ROAD - MILE  
 F.O.A.D. - MILE  
 DRAWN BY: J.M.W.  
 SCALE: 1" = 100'  
 DATE: 12/2/97

CUT = 3312.7 CU.YD.  
 FILL 15% = 376.1 CU.YD.

CUT = 837.5 CU.YD.  
 FILL 15% = 30,128.9 CU.YD.  
 BORROW = 26,354.8 CU.YD.  
 No Overhaul allowance.

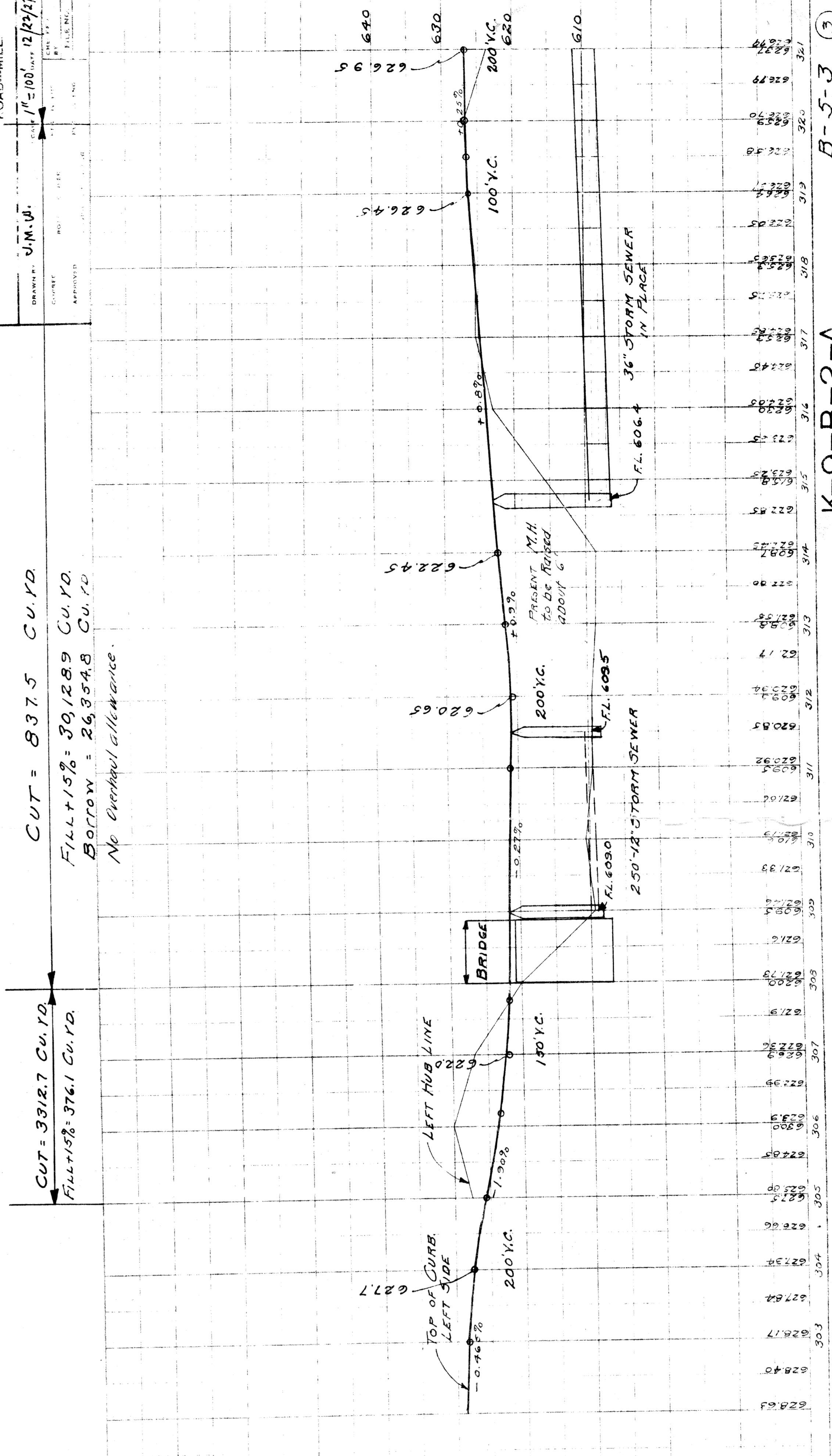

K-9-B-2-A  
 B-5-3

The borrow for this project is coming from the old Cemetery opposite Stations 251 to 261. The expense for Earth Excavation at this location borrow will cost in excess of method.

B.M. #3 - Elev 6247.3  
Spike in 6" Maple  
112' Rt. Sta. 327+50

B.M. #4 - Elev 635.38  
12" Maple  
102' Lt. Sta. 333+70

B.M. #5 - Elev 629.70  
Nail in Tel. Pole with Fire Alarm Box  
90' Rt. Sta. 339+60

B.M. #6 - Elev 628.83  
Nail in Tel. Pole  
90' Rt. Sta. 347+70

PROJ.	COUNTY	TOWNSHIP	SHEET TOTAL
U.S. 6	Wayne	Wayne	4

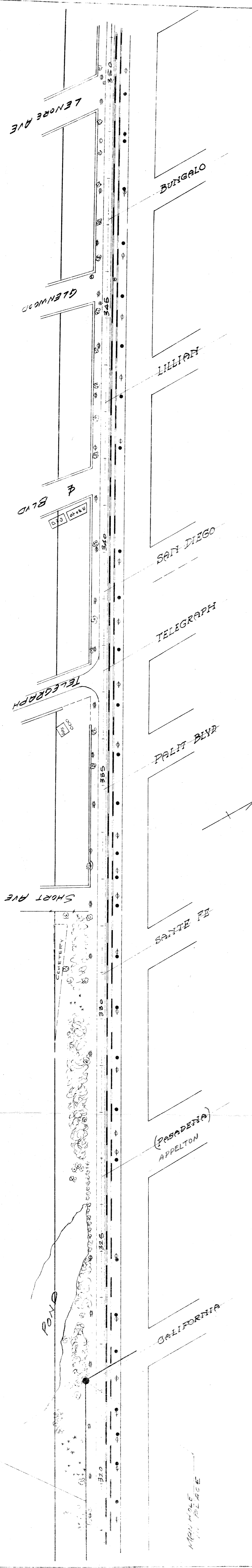

BOARD OF  
WAYNE COUNTY ROAD COMMISSIONERS  
DEPT. MICHIGAN  
WILLIAM E. BUTLER,  
EDWARD N. MINES,  
JAMES J. HASKERTY,  
JOHN S. HASKERTY,  
JAMES J. HASKERTY,  
JAMES J. HASKERTY

PLAN AND PROFILE  
GRAND RIVER  
ROAD - MILE

CHECKED BY: J.M.W.  
APPROVED BY: J.M.W.  
ENGINEER

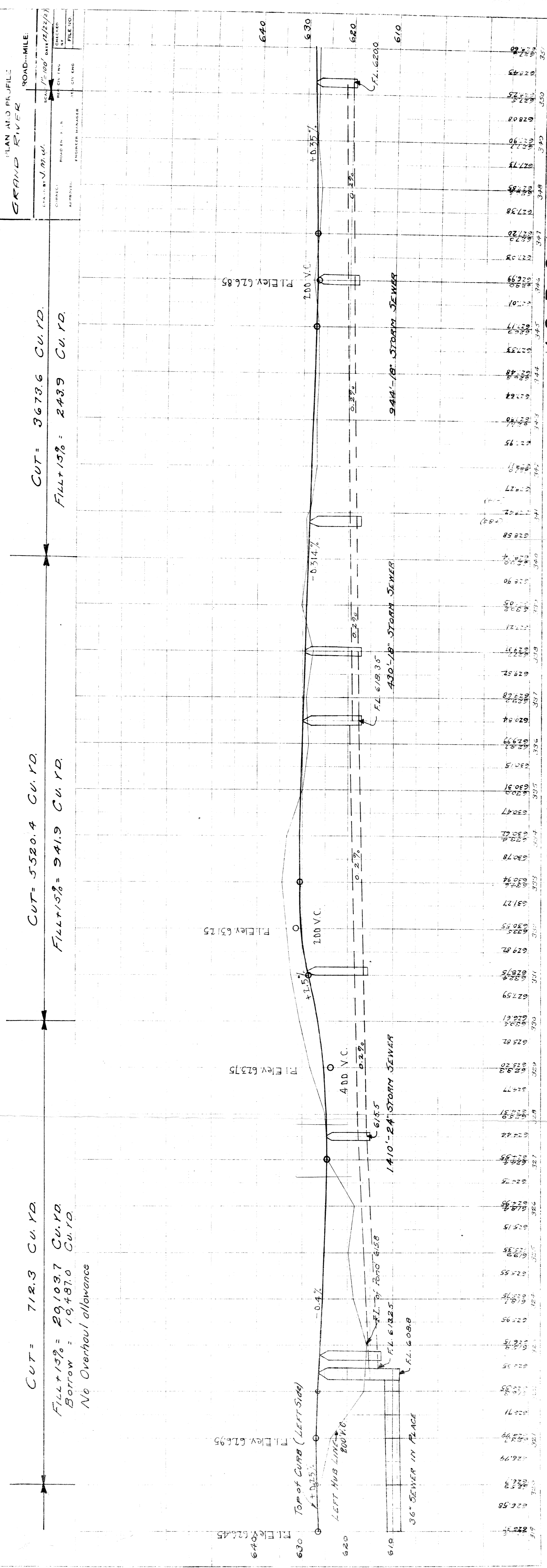

K-9-B-2-A  
B-5-3  
4

B.M. #7 - Elev. 631.74  
Nail in Tel. Pole  
90' Rt. Sta. 357+10

B.M. #8 - Elev. 638.87  
Nail in 24" Maple  
100' Rt. Sta. 368+50

B.M. #9 - Elev. 639.10  
"D" of Detroit on Fire Hydrant  
100' Rt. Sta. 376+25

PROV. NO. COUNTY TOWN-SHIP SHEET NO. DISTRICT NO. SHEET TOTAL NO. SHEETS  
US/16 Mac-6 Wayne Franklin 5

IN PLACE 18" TILE

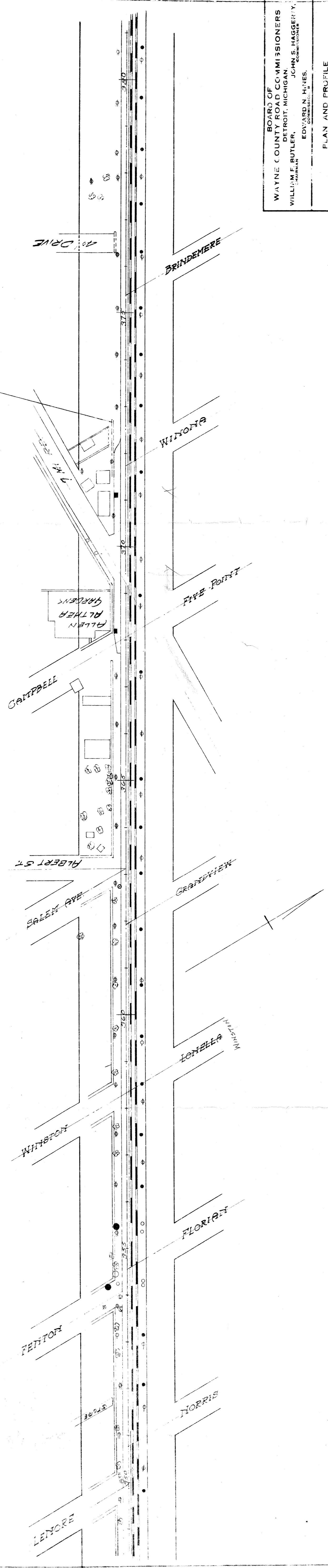

BOARD OF  
WAYNE COUNTY ROAD COMMISSIONERS  
DETROIT, MICHIGAN  
WILLIAM F. BUTLER, CHAIRMAN  
EDWARD N. HAYES, COMMISSIONER

PLAN AND PROFILE  
GRAND RIVER

ROAD-MILE:  
DATE: 12/22/22  
FILE NO.

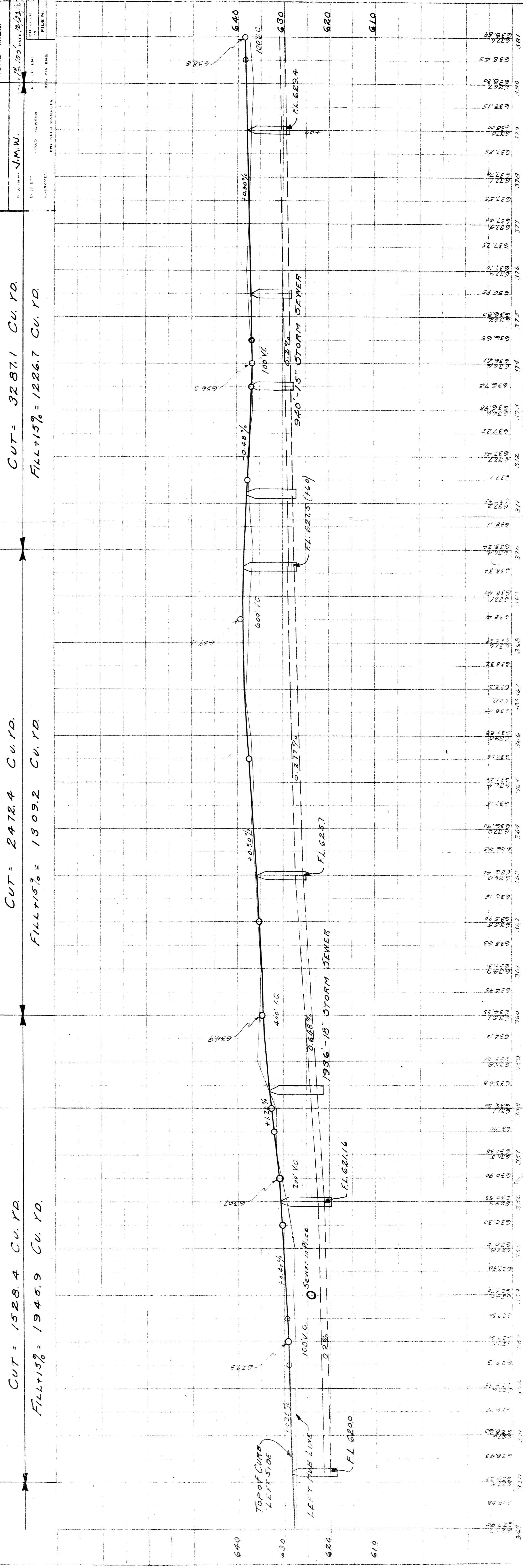

K-9-B-2-A

B-5-3

5

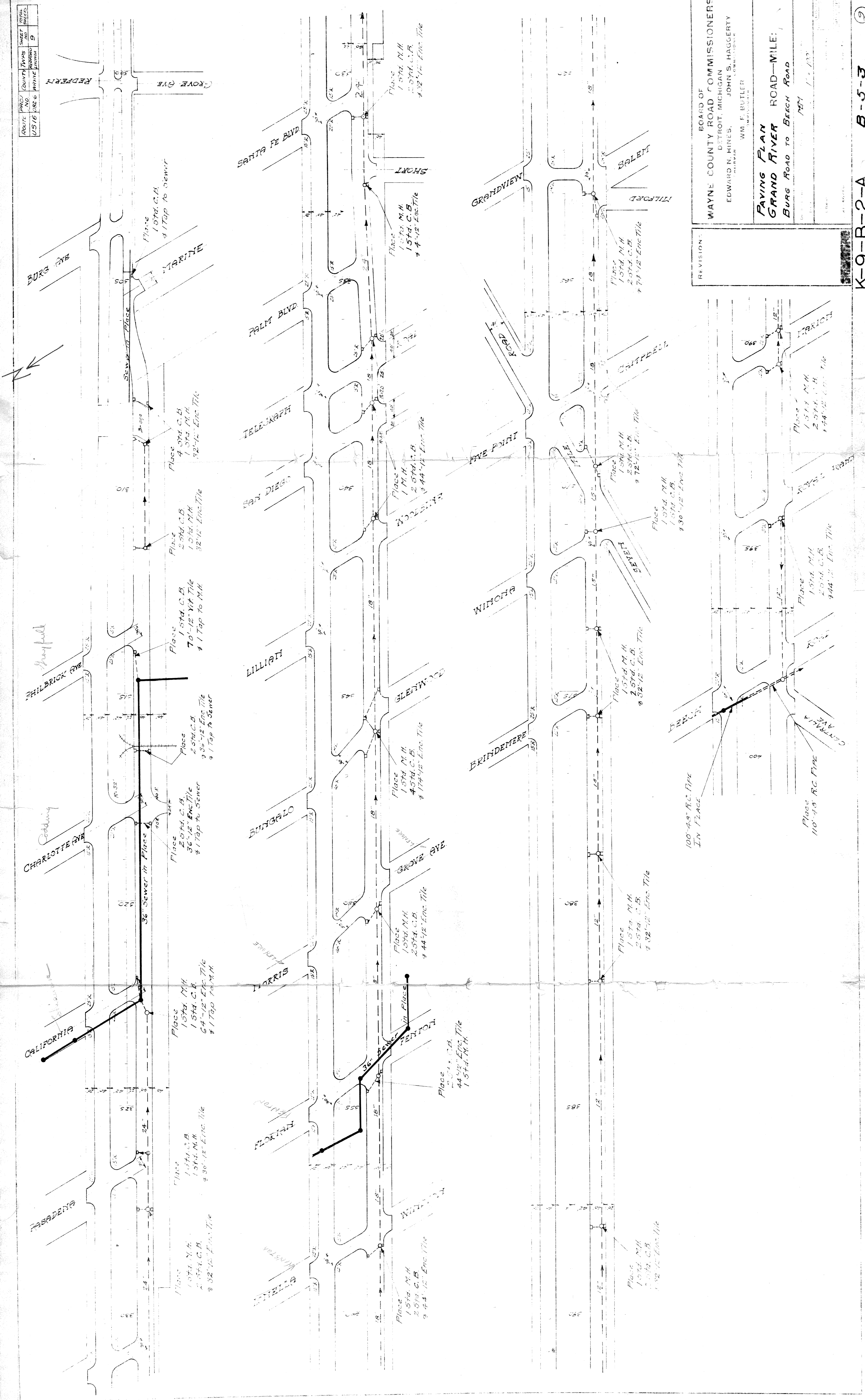

REVISIONS:

BOARD OF  
 WAYNE COUNTY ROAD COMMISSIONERS  
 EDWARD N. HINES, CHAIRMAN  
 DETROIT, MICHIGAN  
 JOHN S. HARRIS, SECRETARY  
 WM. F. BUTLER, ENGINEER

**PAVING PLAN**  
**GRAND RIVER ROAD—MILE:**  
**BURG ROAD TO BEACH ROAD**

DATE: MAY 1, 1924