

**LOCATION PLAN**

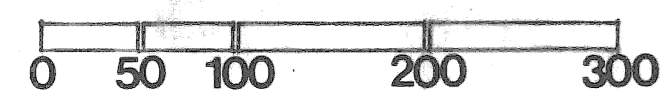

**INDEX**

- 1 INDEX, LOCATION PLAN
- 2 SITE PLAN
- 3 LANDSCAPE PLAN
- 4 DETAIL PLAN
- 5 DETAIL PLAN
- 6 DETAIL PLANS
- 7 PAVING DETAILS
- 8 LANDSCAPE DETAILS
- 9 RECURRING PLANS & SECTIONS

**GREEKTOWN  
AREA  
IMPROVEMENT**  
DETROIT, MICHIGAN

PLANS PREPARED BY:

**CHRISTOPHER WZACNY & ASSOC., INC.**  
ARCHITECTS & PLANNERS

CITY OF DETROIT  
COMMUNITY & ECONOMIC DEVELOPMENT DEPARTMENT  
350 E. CONGRESS, DETROIT, MICHIGAN 48226

C.O. NO.	REVISION	DATE	DATE	JOB TITLE	DRAWING NO.
ISSUED FOR	DATE	DR.	DATE		
PRELIM	1-19-76		3-11-76		
BIDDING	4-12-76	IN CHG.			
CONTRACT NO. 2276		<i>C. Wzacny</i>	<i>C. Wzacny</i>	ADMIN. ENGINEER	<b>1</b>

MONROE

NOTES: OF ALL THE ITEMS LOCATED ON MUNICIPAL PARKING GARAGE PROPERTY, THOSE FUNDED BY THE MUNICIPAL PARKING DEPARTMENT ARE:

- 1 340 L.F. TIMBER RETAINING WALL 8" WIDE X 2'-0" HIGH
- 2 225 CY. TOPSOIL
- 3 11 BENCHES
- 4 78 SHRUB RELOCATION
- 5 3 TREE RELOCATION

THESE ITEMS ARE INCLUDED IN THE BASE BID PROPOSAL AND SHALL NOT BE BID ON SEPARATELY.

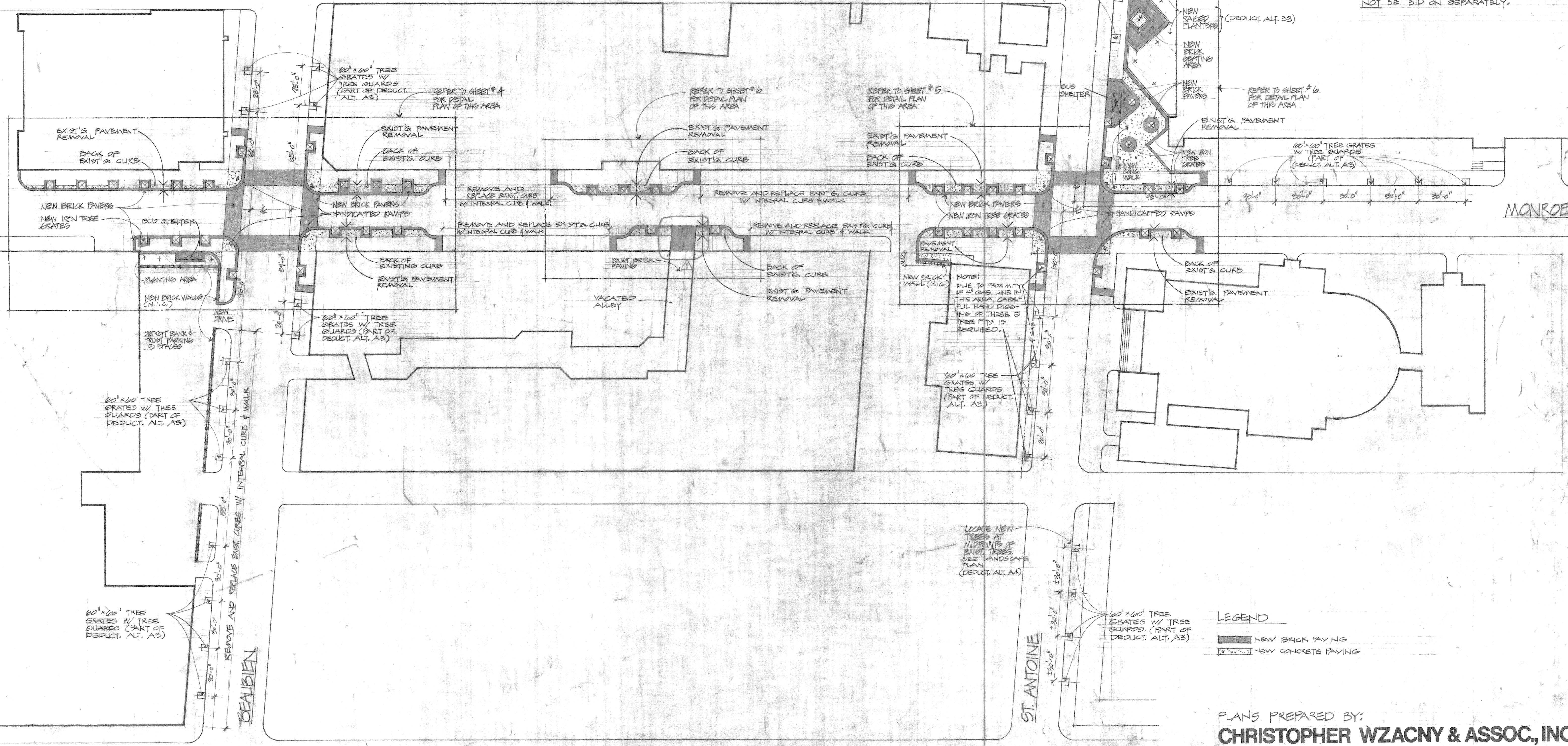

NOTES: DUE TO PROXIMITY OF GAS LINE IN THIS AREA, CARE-FUL HAND DIGGING OF THESE 5 TREE PITS IS REQUIRED.

LEGEND

- [Hatched Pattern] NEW BRICK PAVING
- [Hatched Pattern] NEW CONCRETE PAVING

PLANS PREPARED BY:  
**CHRISTOPHER WZACNY & ASSOC., INC.**  
 ARCHITECTS & PLANNERS

CITY OF DETROIT  
 COMMUNITY & ECONOMIC DEVELOPMENT DEPARTMENT  
 350 E. CONGRESS, DETROIT, MICHIGAN 48226

C.O. NO.	REVISION	DATE
3	ALTERATIONS TO TRAFFER'S ALLEY ENTR	7-22-78
AS-BUILT 1-9-78		
ISSUED FOR	DATE	DR: CAGAI
PRELIM	1-19-78	DATE
BIDDING	4-12-78	IN CHG:
CONTRACT NO. 2296		APPROVED: <i>[Signature]</i>

JOB TITLE	SHEET TITLE	DRAWING NO.
GREEN TOWN AREA IMPROVEMENT	SITE PLAN 1" = 30'-0"	2

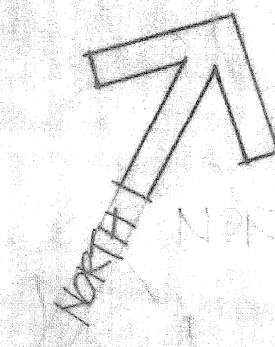

C-5270

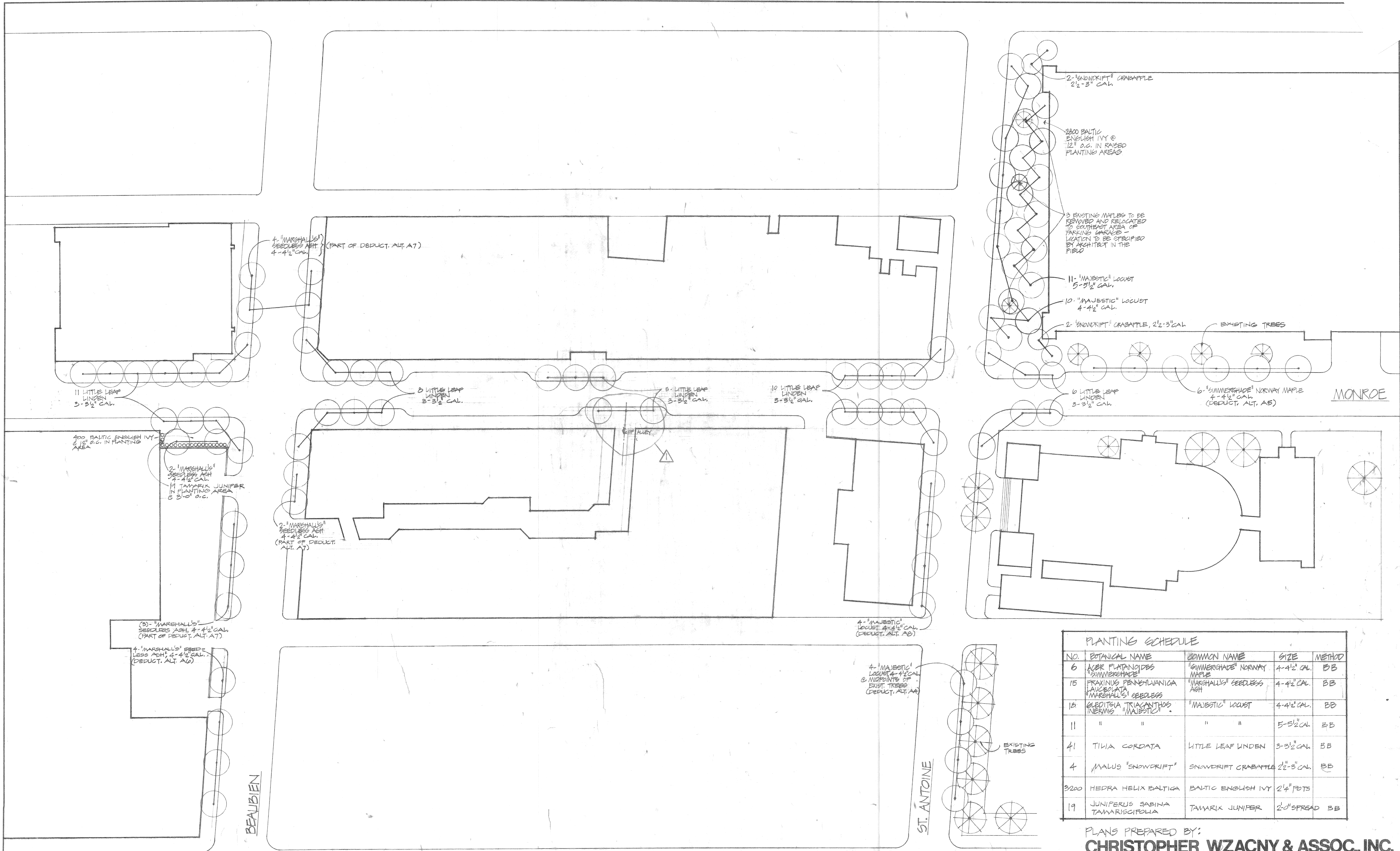

PLANTING SCHEDULE

NO.	BOTANICAL NAME	COMMON NAME	SIZE	METHOD
6	ACER PLATANOIDES "SUMMERHADE"	"SUMMERHADE" NORWAY MAPLE	4-4 1/2" CAL.	BB
15	FRAXINUS PENNSYLVANICA LAUCEOLATA "MARSHALL'S" SEEDLESS	"MARSHALL'S" SEEDLESS ASH	4-4 1/2" CAL.	BB
12	QUERCUS TRIACANTHOS INERMIS "MAJESTIC"	"MAJESTIC" LOCUST	4-4 1/2" CAL.	BB
11	"	"	5-5 1/2" CAL.	BB
41	TILIA CORDATA	LITTLE LEAF LINDEN	3-3 1/2" CAL.	BB
4	MALUS "SNOWDRIFT"	SNOWDRIFT CRABAPPLE	2 1/2-3" CAL.	BB
3200	HEPRA HELIX BALTICA	BALTIC ENGLISH IVY	2 1/4" POTS	
19	JUNIPERUS SABINA TAMARISCIFOLIA	TAMARIX JUNIPER	2'0" SPREAD	BB

PLANS PREPARED BY:  
**CHRISTOPHER WZACNY & ASSOC., INC.**  
 ARCHITECTS & PLANNERS

CITY OF DETROIT  
 COMMUNITY & ECONOMIC DEVELOPMENT DEPARTMENT  
 350 E. CONGRESS, DETROIT, MICHIGAN 48226

C.O. NO.	REVISION	DATE
3	ALTERATIONS TO TRAFFIC SUBMITTER	7/22/76

ISSUED FOR	DATE	DR.	DATE	JOB TITLE	SHEET TITLE	DRAWING NO.
PRELIM	1-19-76	TR.	1-19-76	CREATION	LANDSCAPE PLAN 1" = 30'-0"	3
BIDDING	4-12-76	IN CHG.		AREA IMPROVEMENT		
CONTRACT NO. 2276		C. Wzacny		ADMIN. ENGINEER		

C-5270

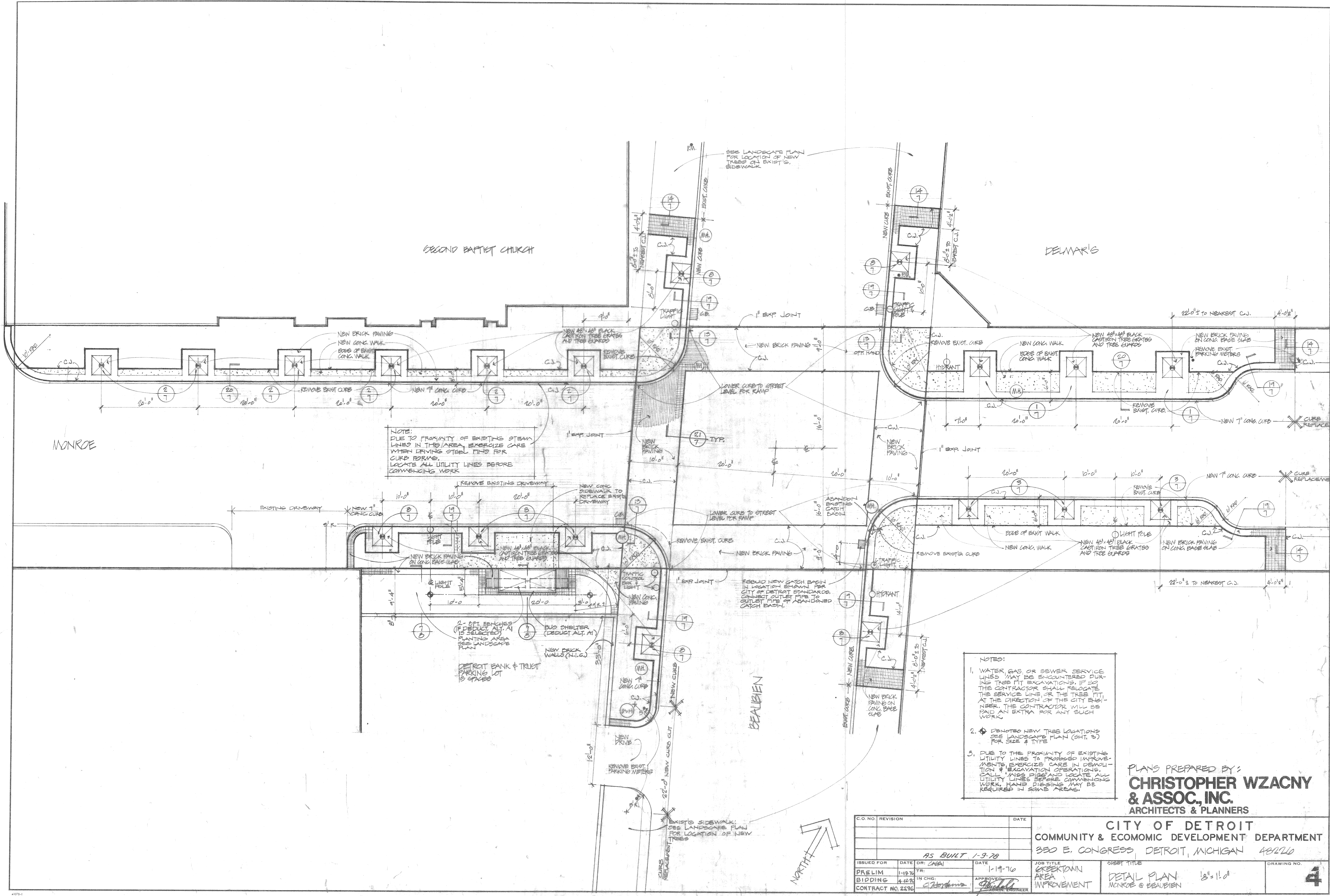

NOTE:  
 DUE TO PROXIMITY OF EXISTING STEAM LINES IN THIS AREA, EXERCISE CARE WHEN DRIVING STEEL PILING FOR CURB FORMS. LOCATE ALL UTILITY LINES BEFORE COMMENCING WORK.

- NOTES:
1. WATER, GAS OR SEWER SERVICE LINES MAY BE ENCOUNTERED DURING TREE FIT EXCAVATIONS. IF SO THE CONTRACTOR SHALL RELOCATE THE SERVICE LINE, OR THE TREE FIT, AT THE DIRECTION OF THE CITY ENGINEER. THE CONTRACTOR WILL BE PAID AN EXTRA FOR ANY SUCH WORK.
  2. ♦ DENOTES NEW TREE LOCATIONS SEE LANDSCAPE PLAN (SHT. 2) FOR SIZE & TYPE.
  3. DUE TO THE PROXIMITY OF EXISTING UTILITY LINES TO PROPOSED IMPROVEMENTS, EXERCISE CARE IN DEMOLITION & EXCAVATION OPERATIONS. CALL "X" MARKS AND LOCATE ALL UTILITY LINES BEFORE COMMENCING WORK. HAND DIGGING MAY BE REQUIRED IN SOME AREAS.

PLANS PREPARED BY:  
**CHRISTOPHER WZACNY & ASSOC., INC.**  
 ARCHITECTS & PLANNERS

C.O. NO. REVISION		DATE	CITY OF DETROIT COMMUNITY & ECONOMIC DEVELOPMENT DEPARTMENT	
ISSUED FOR		DATE	350 E. CONGRESS, DETROIT, MICHIGAN 48226	
PRELIM		1-19-76	JOB TITLE CREEKSTOWN AREA IMPROVEMENT	
BIDDING		4-12-76	SHEET TITLE DETAIL PLAN MONROE @ BEAUBIEN	
CONTRACT NO. 2476		AS BUILT 1-9-78	DRAWING NO. <b>4</b>	

C-5270

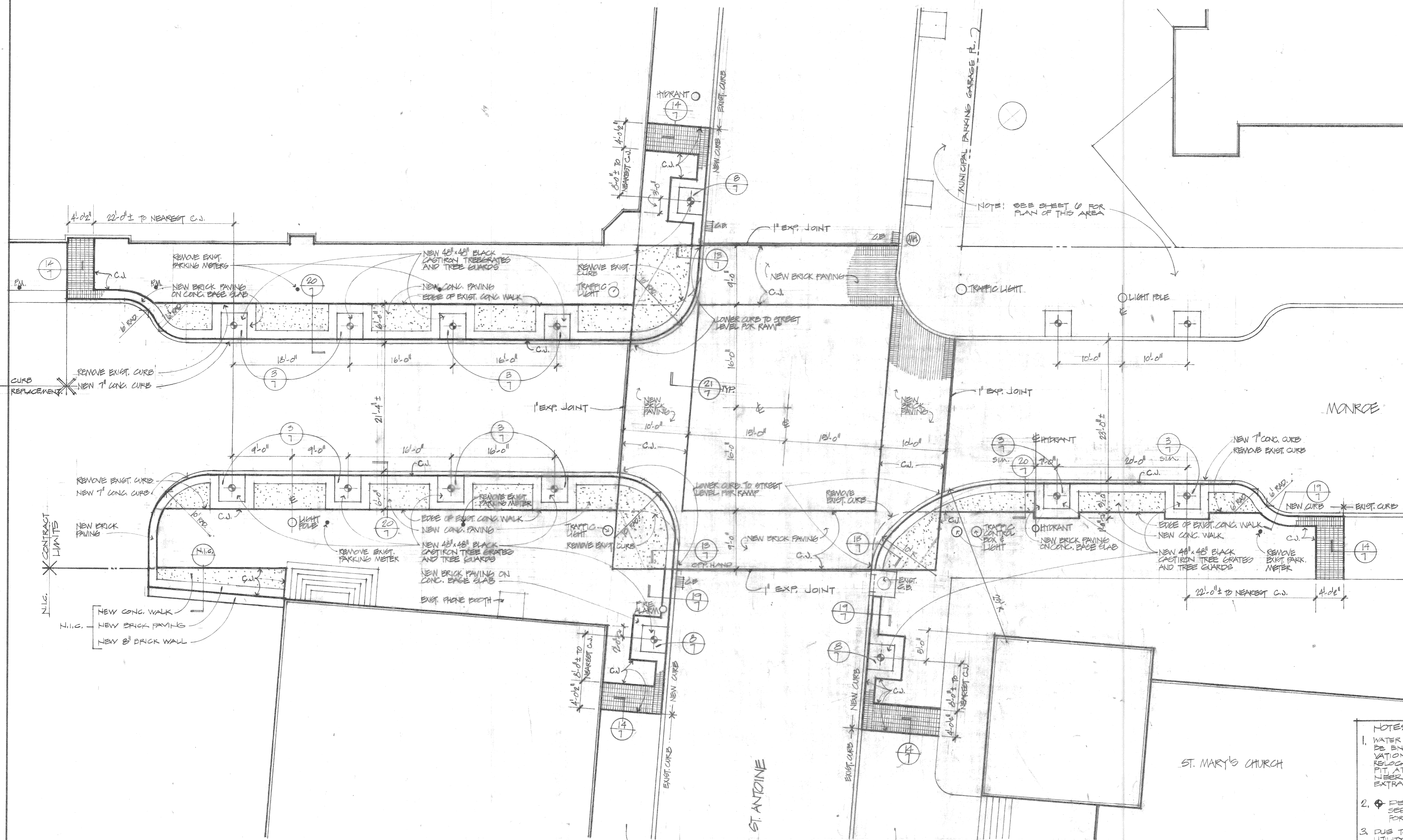

NOTE: SEE SHEET 6 FOR PLAN OF THIS AREA

NOTE: SEE LANDSCAPE PLAN (SHT #3) FOR LOCATION OF ADDITIONAL TREES IN EXIST'G. SIDEWALK

- NOTES:
1. WATER, GAS, OR SEWER SERVICE LINES MAY BE ENCOUNTERED DURING TREE FIT EXCAVATIONS, IF SO, THE CONTRACTOR SHALL RELOCATE THE SERVICE LINE OR THE TREE FIT AT THE DIRECTION OF THE CITY ENGINEER. THE CONTRACTOR WILL BE PAID AN EXTRA FOR ANY SUCH WORK.
  2. ♦ DENOTES NEW TREE LOCATIONS SEE LANDSCAPE PLAN (SHT #3) FOR SIZE & TYPE
  3. DUE TO THE PROXIMITY OF EXISTING UTILITY LINES TO PROPOSED IMPROVEMENTS, EXERCISE CARE IN REMOVAL AND EXCAVATION OPERATIONS, CALL "MISS DIGS" AND LOCATE ALL UTILITY LINES BEFORE COMMENCING WORK. HAND DIGGING MAY BE REQUIRED IN SOME AREAS

PLANS PREPARED BY:  
**CHRISTOPHER WZACNY & ASSOC., INC.**  
 ARCHITECTS & PLANNERS



C.O. NO. REVISION		DATE	CITY OF DETROIT	
			COMMUNITY & ECONOMIC DEVELOPMENT DEPARTMENT	
			350 E. CONGRESS, DETROIT, MICHIGAN 48226	
ISSUED FOR		DATE	JOB TITLE	SHEET TITLE
PRELIM		1-19-76	GREENWATER AREA IMPROVEMENT	DETAIL PLAN: 18" x 110"
BIDDING		4-12-76		MONROE & ST. ANTOINE
CONTRACT NO 2296				DRAWING NO. <b>5</b>

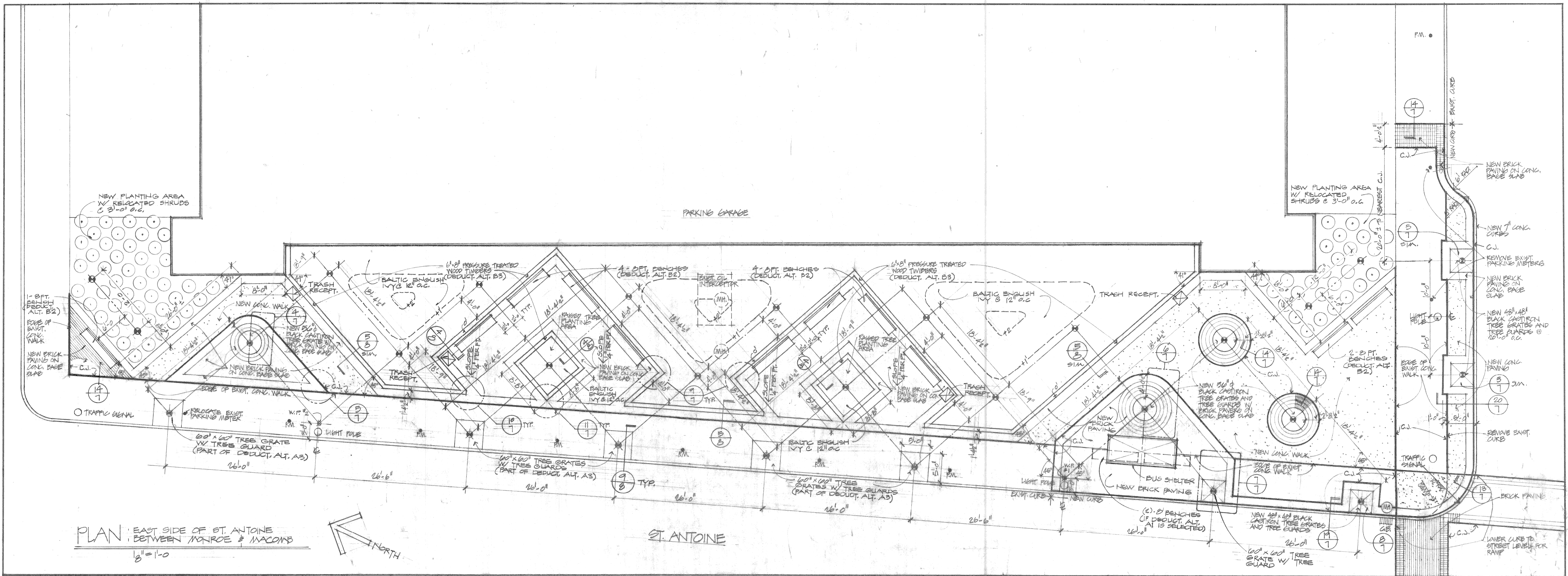

PLAN EAST SIDE OF ST. ANTOINE BETWEEN MONROE & MACOMB  
1/8" = 1'-0"

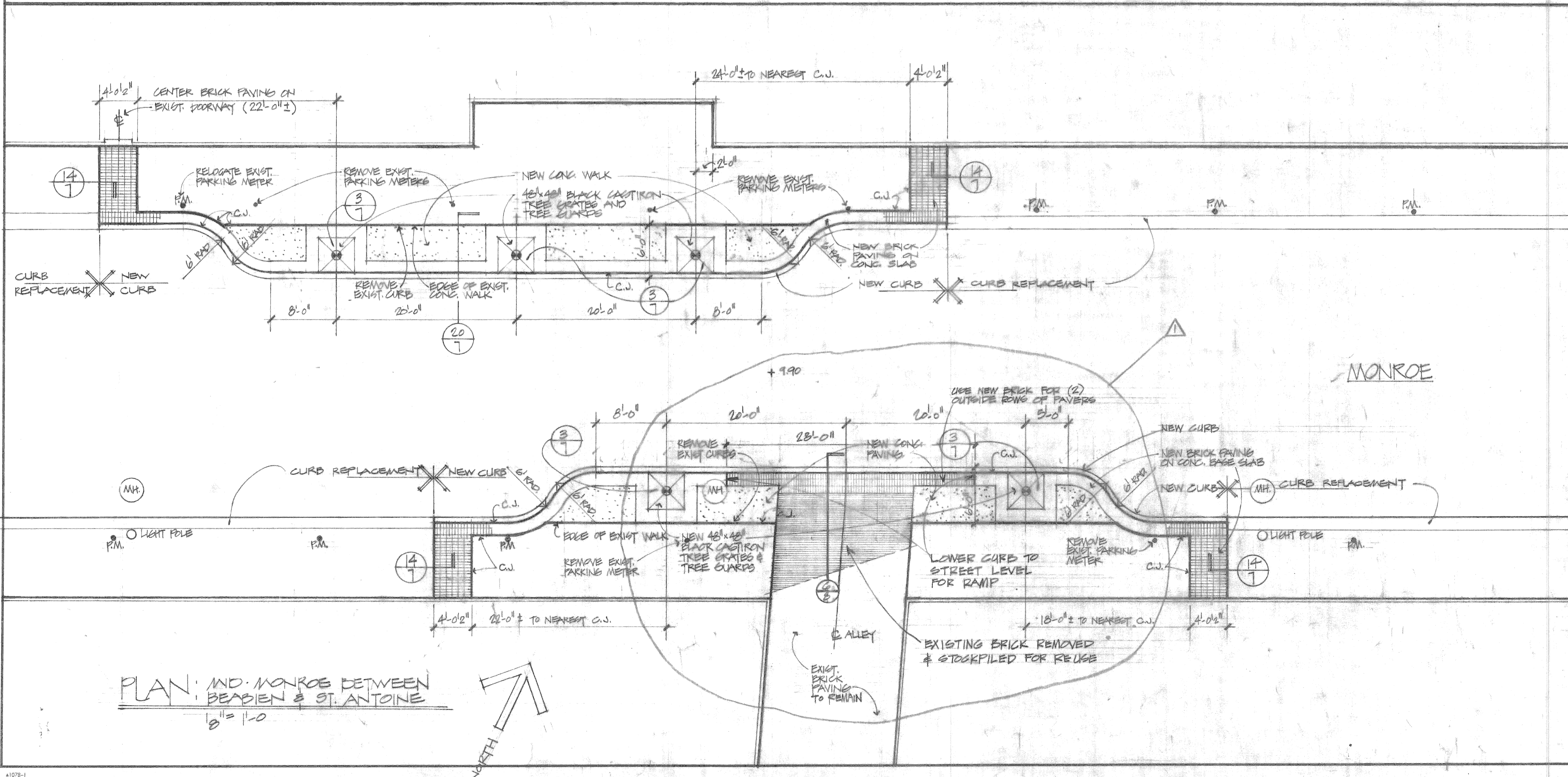

PLAN W. SIDE MONROE BETWEEN BEAUBIEN & ST. ANTOINE  
1/8" = 1'-0"

- NOTES:
1. WATER, GAS, OR SEWER SERVICE LINES MAY BE ENCOUNTERED DURING TREE PIT EXCAVATIONS, IF SO, THE CONTRACTOR SHALL RELOCATE THE SERVICE LINE OR THE TREE PIT, AT THE DIRECTION OF THE CITY ENGINEER, THE CONTRACTOR WILL BE PAID AN EXTRA FOR ANY SUCH WORK.
  2. Ⓢ DENOTES NEW TREE LOCATIONS SEE LANDSCAPE PLAN (SHT 5) FOR SIZE & TYPE
  3. DUE TO THE PROXIMITY OF EXISTING UTILITY LINES TO PROPOSED IMPROVEMENTS, EXERCISE CARE IN DEMOLITION & EXCAVATION OPERATIONS, CALL "MISS DIG" AND LOCATE ALL UTILITY LINES BEFORE COMMENCING WORK, HAND DIGGING MAY BE REQUIRED IN SOME AREAS

PLANS PREPARED BY:  
**CHRISTOPHER WZACNY & ASSOC., INC.**  
ARCHITECTS & PLANNERS

C.O. NO. REVISION		DATE	CITY OF DETROIT	
3	ALTERATIONS TO TRAPPERS ALLEY ENTRY	7/22/76	COMMUNITY & ECONOMIC DEVELOPMENT DEPARTMENT	
AS BUILT 1-9-78			350 E. CONGRESS, DETROIT, MICHIGAN 48226	
ISSUED FOR	DATE	DR. NAME	DATE	JOB TITLE
PRELIM	1-19-76	TR	1-19-76	WORKTOWN AREA IMPROVEMENT
BIDDING	4-12-76	IN CHG.	APPROVED	SHEET TITLE
CONTRACT NO. 2296		C. Kozlowski		DETAIL PLANS 1/8" = 1'-0"
				ST. ANTOINE @ PARKING GARAGE
				DRAWING NO. <b>6</b>

C-5270



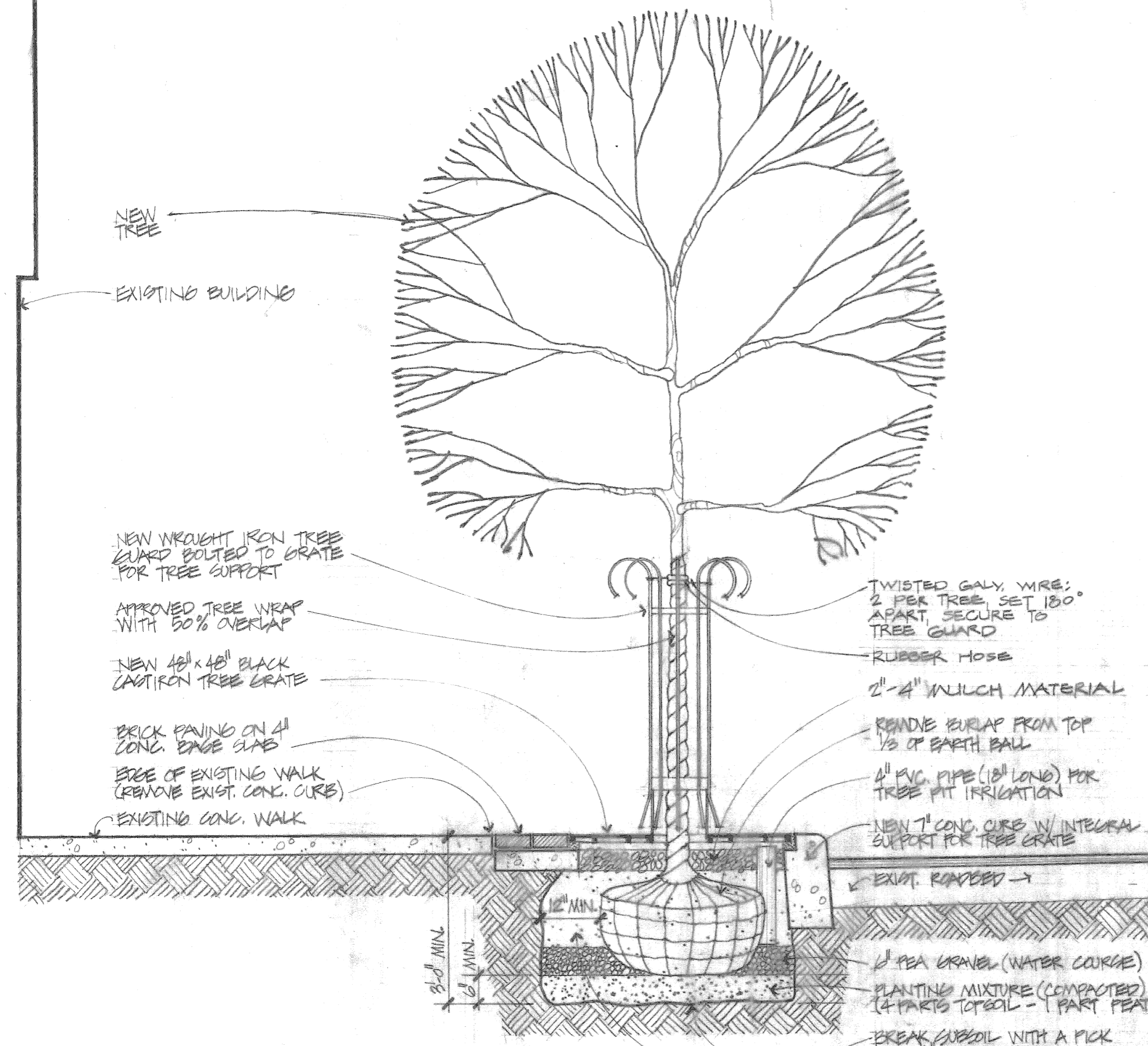

3 TYP. PLANTING DETAIL @ TREES W/ CAST IRON GRATES & GUARDS  
 8 GRATE INSTALLATION SHOWN HERE IS FOR 50" & 48" X 48" GRATES SEE DETAIL (1) FOR INSTALLATION OF 60" X 60" GRATES

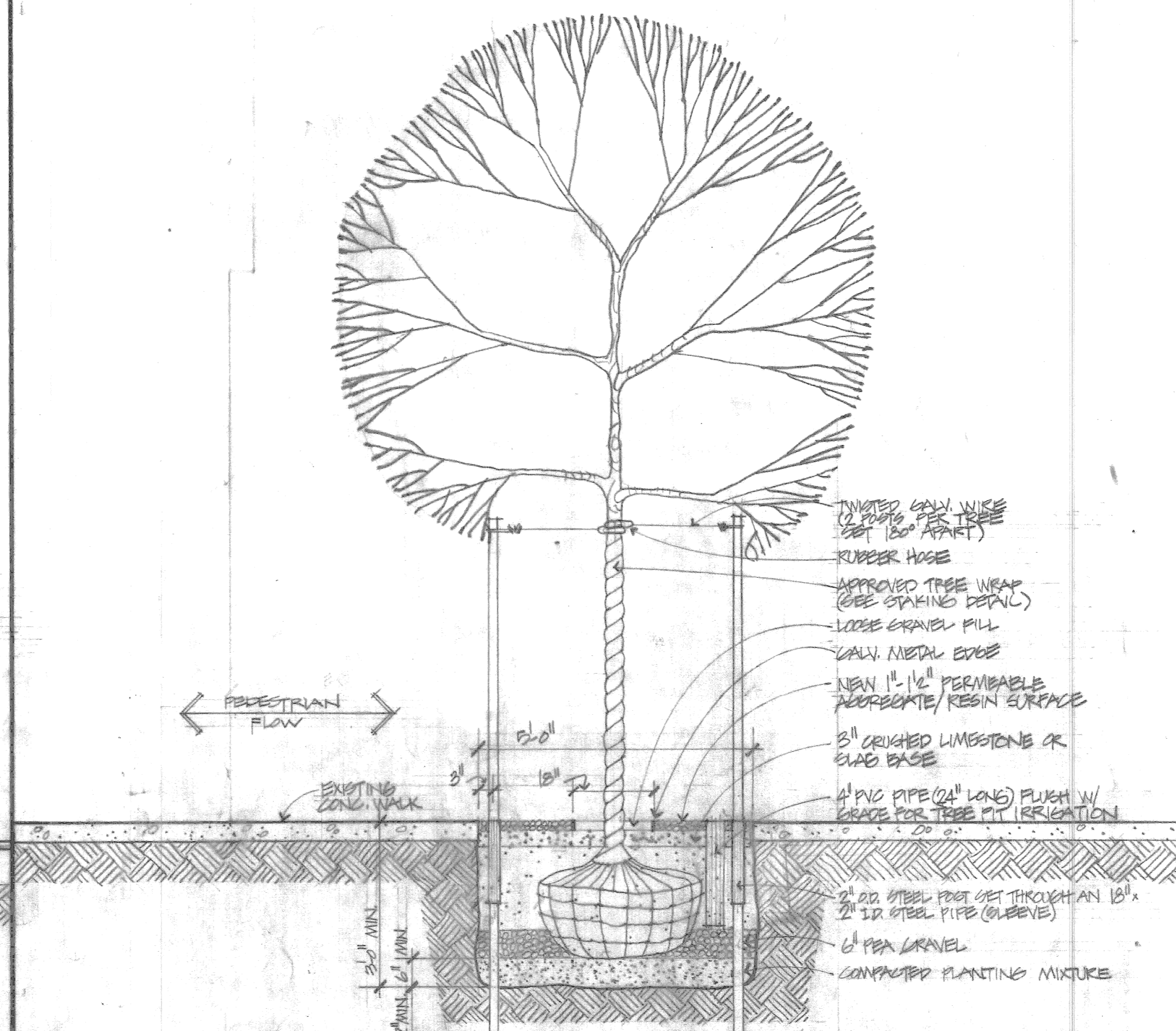

2 TYP. PLANTING DETAIL @ TREES W/ AGGREGATE/RESIN SURFACES  
 8 NO SCALE  
 NOTE: THIS DETAIL IS TO BE USED ONLY IF DEDUCTIVE ALTERNATE A3 IS SELECTED.

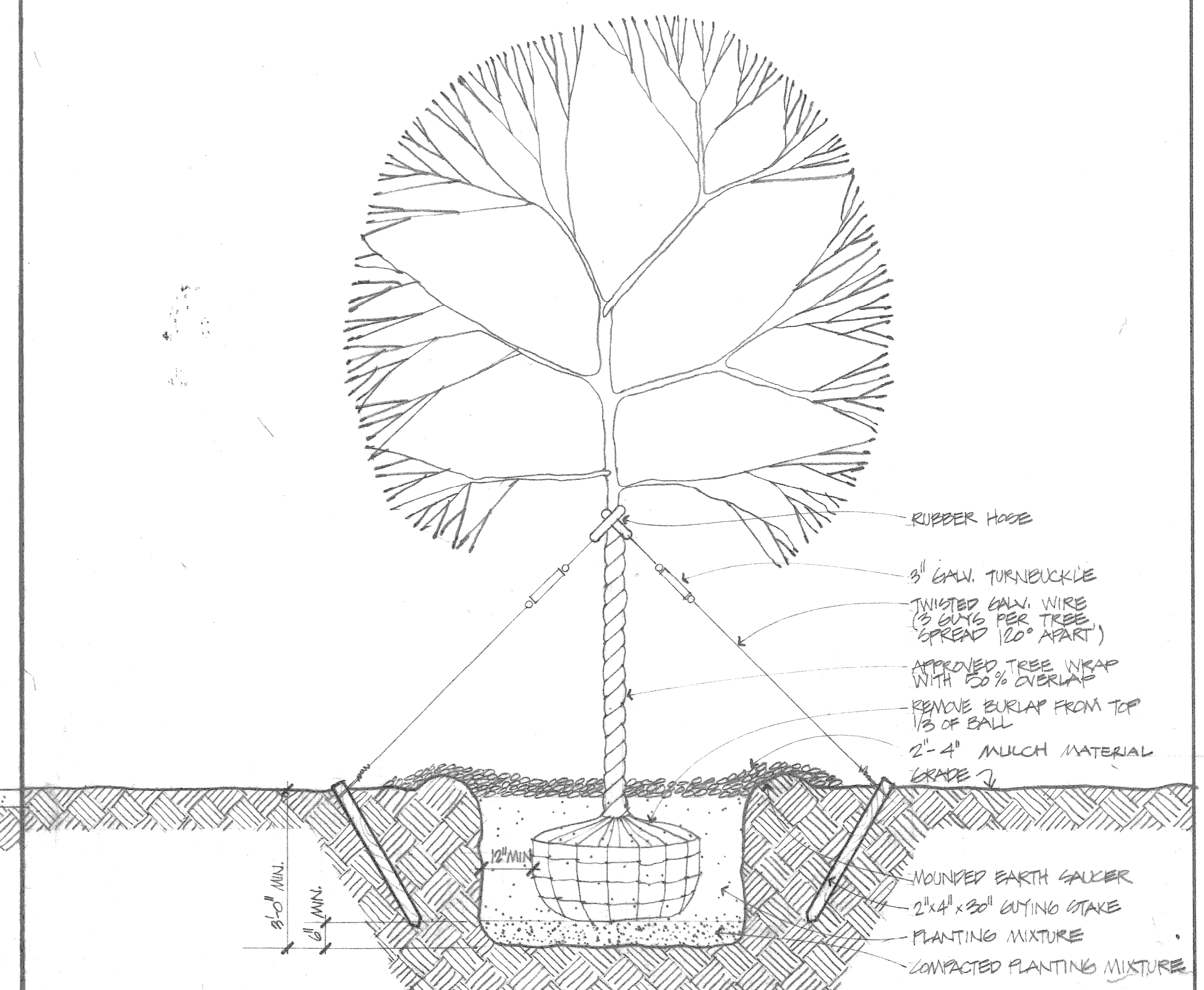

1 TYP. PLANTING DETAIL IN GENERAL PLANTING AREAS  
 8 NO SCALE

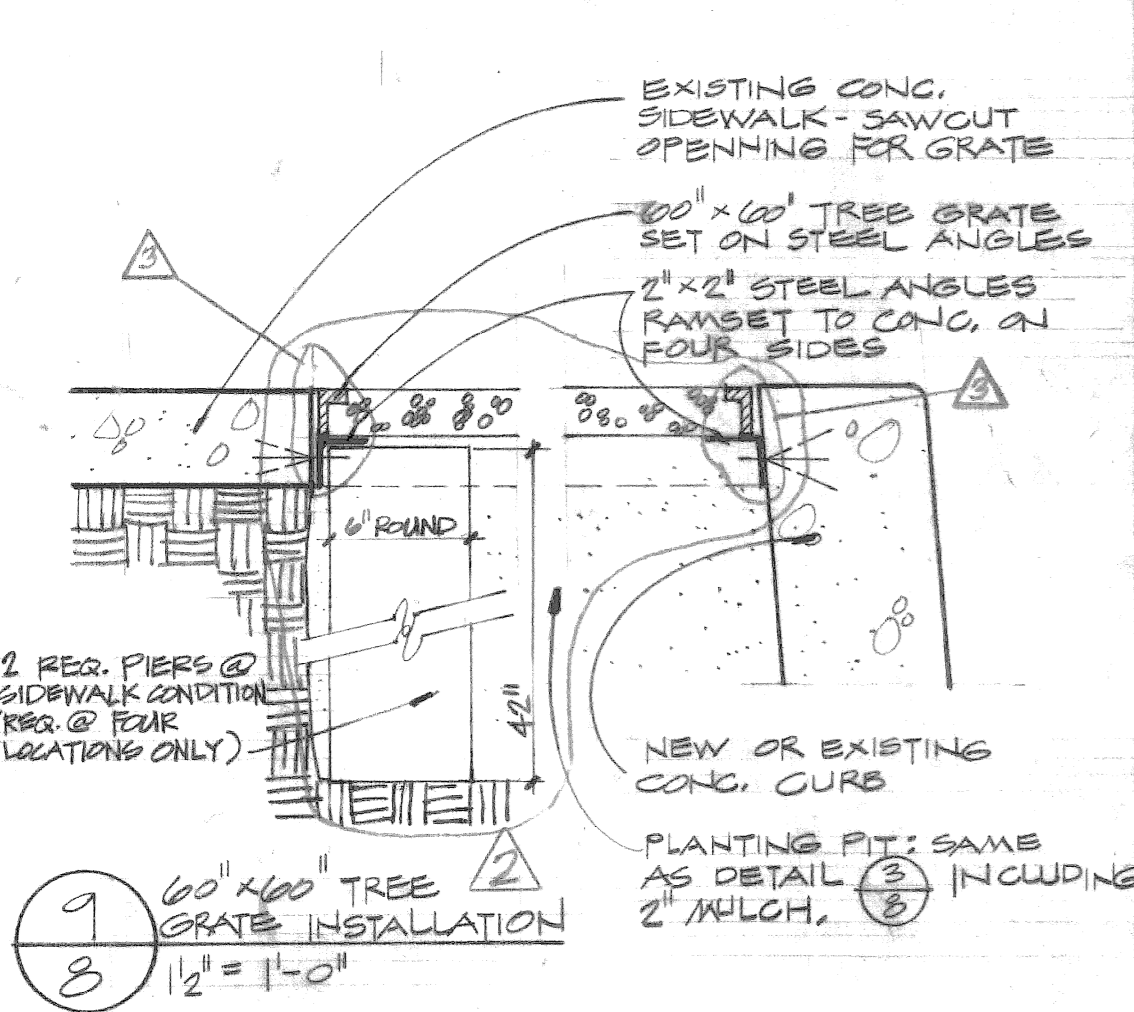

9 60" X 60" TREE GRATE INSTALLATION  
 8 1/2" = 1'-0"

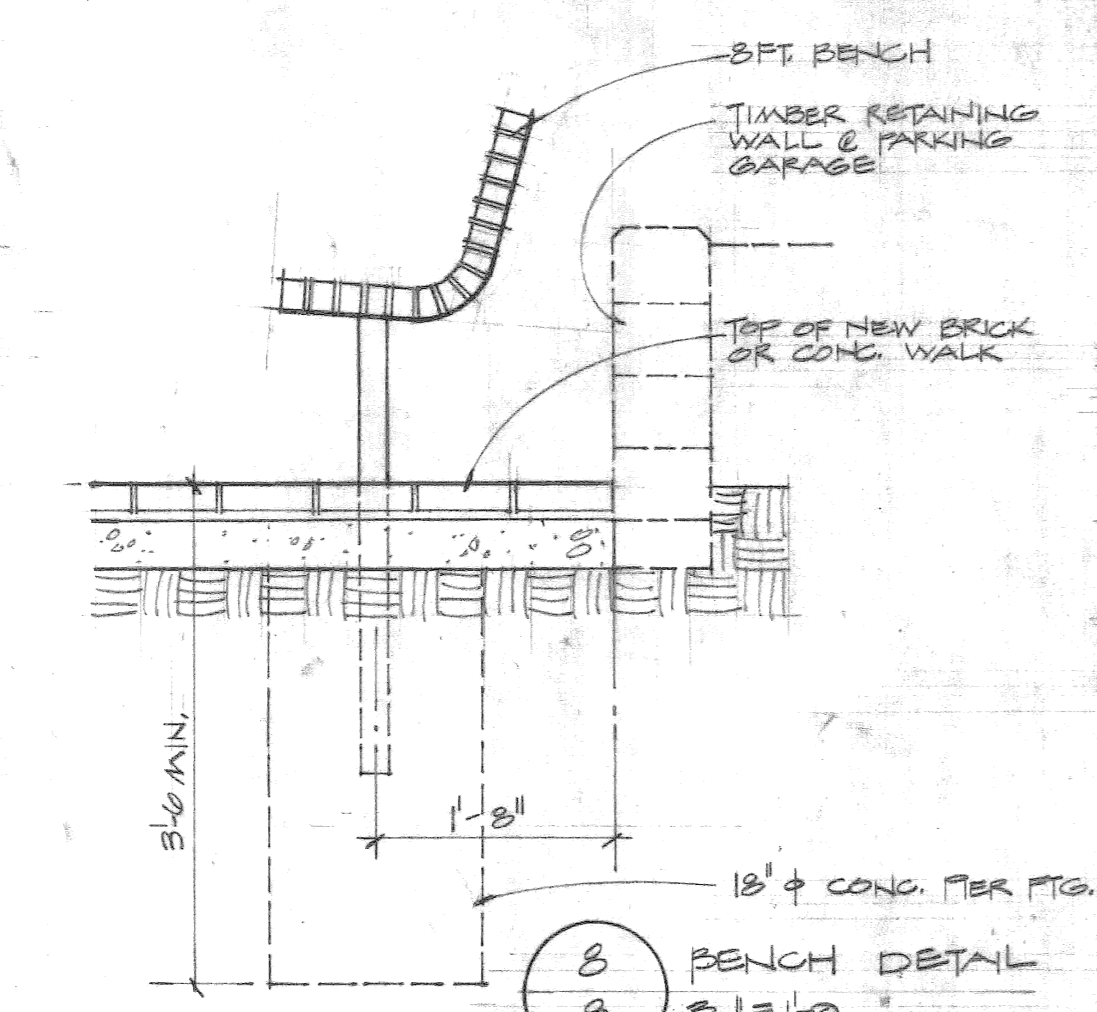

3 BENCH DETAIL  
 8 3/4" = 1'-0"

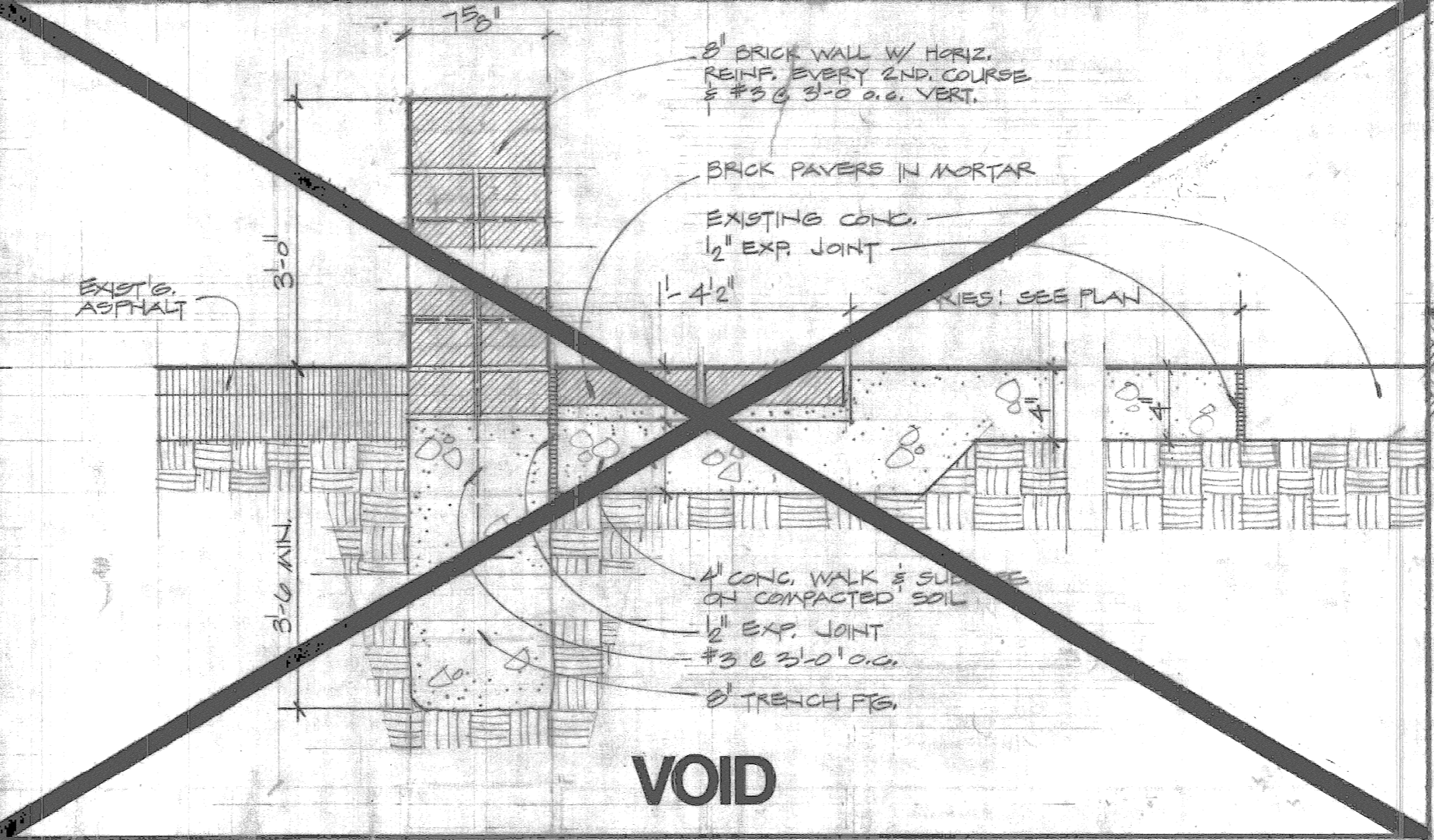

VOID

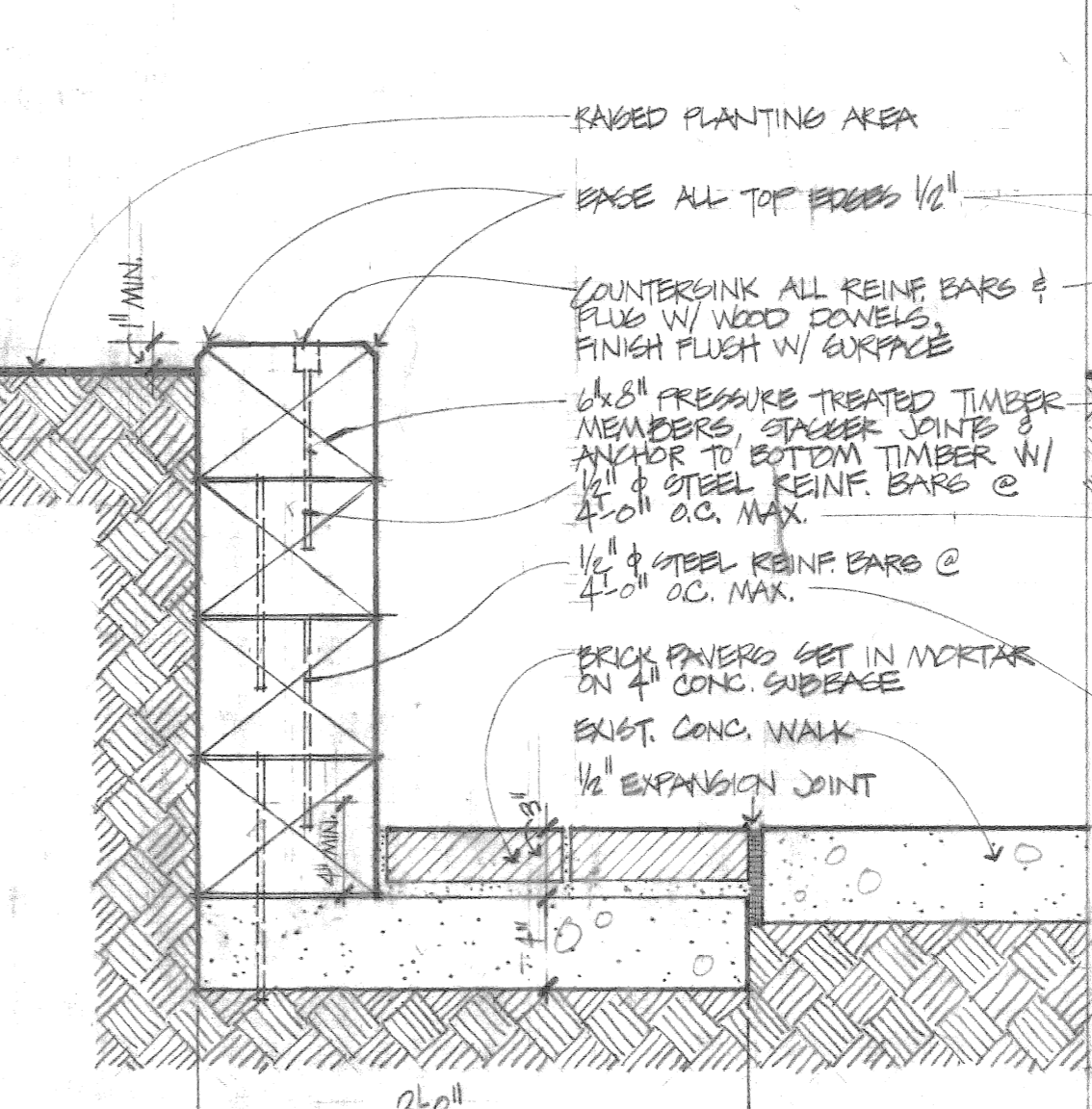

5 SECTION @ WOOD RET. WALL  
 8 1/2" = 1'-0"

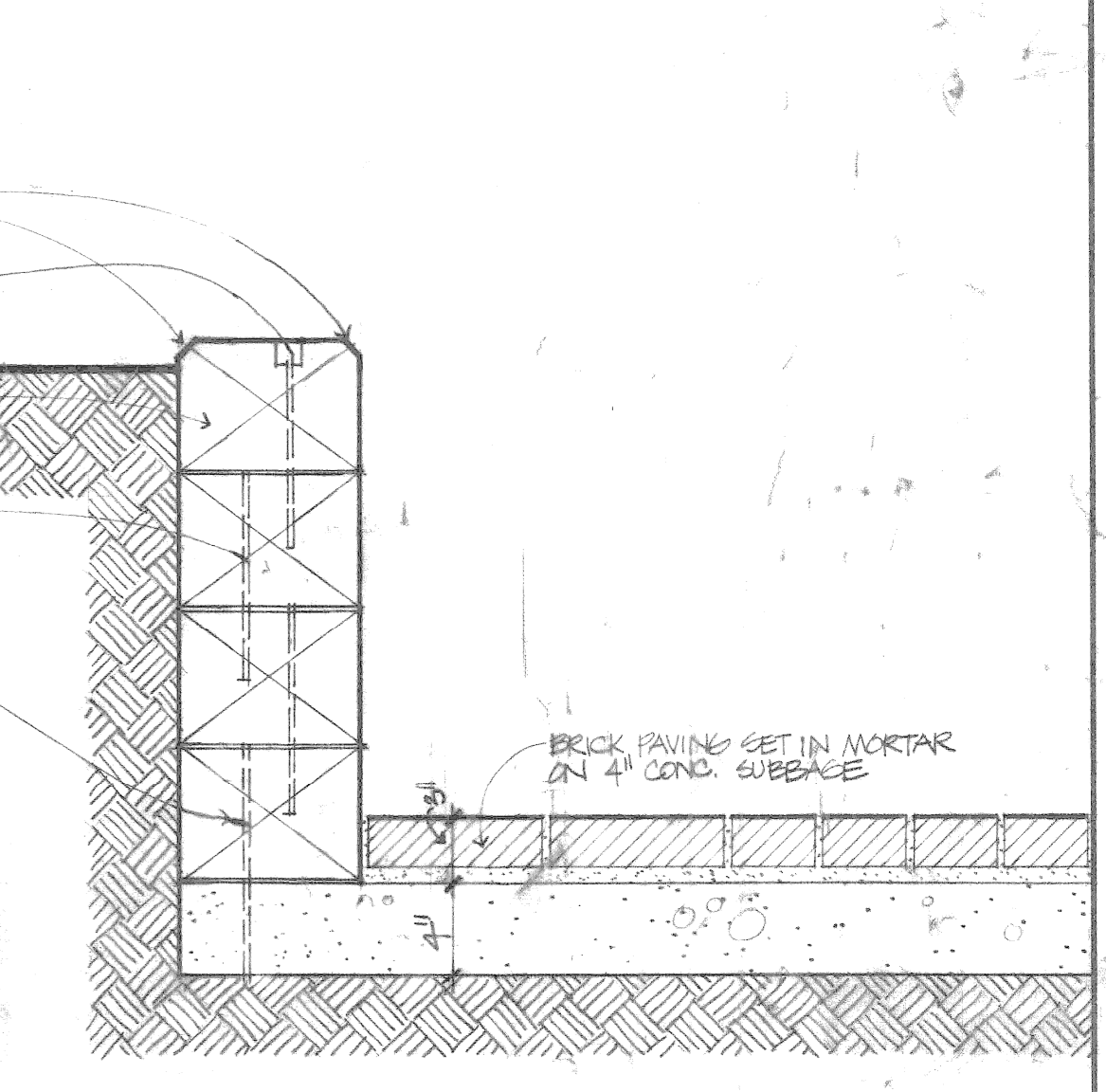

4 SECTION @ WOOD RET. WALL  
 8 1/2" = 1'-0"

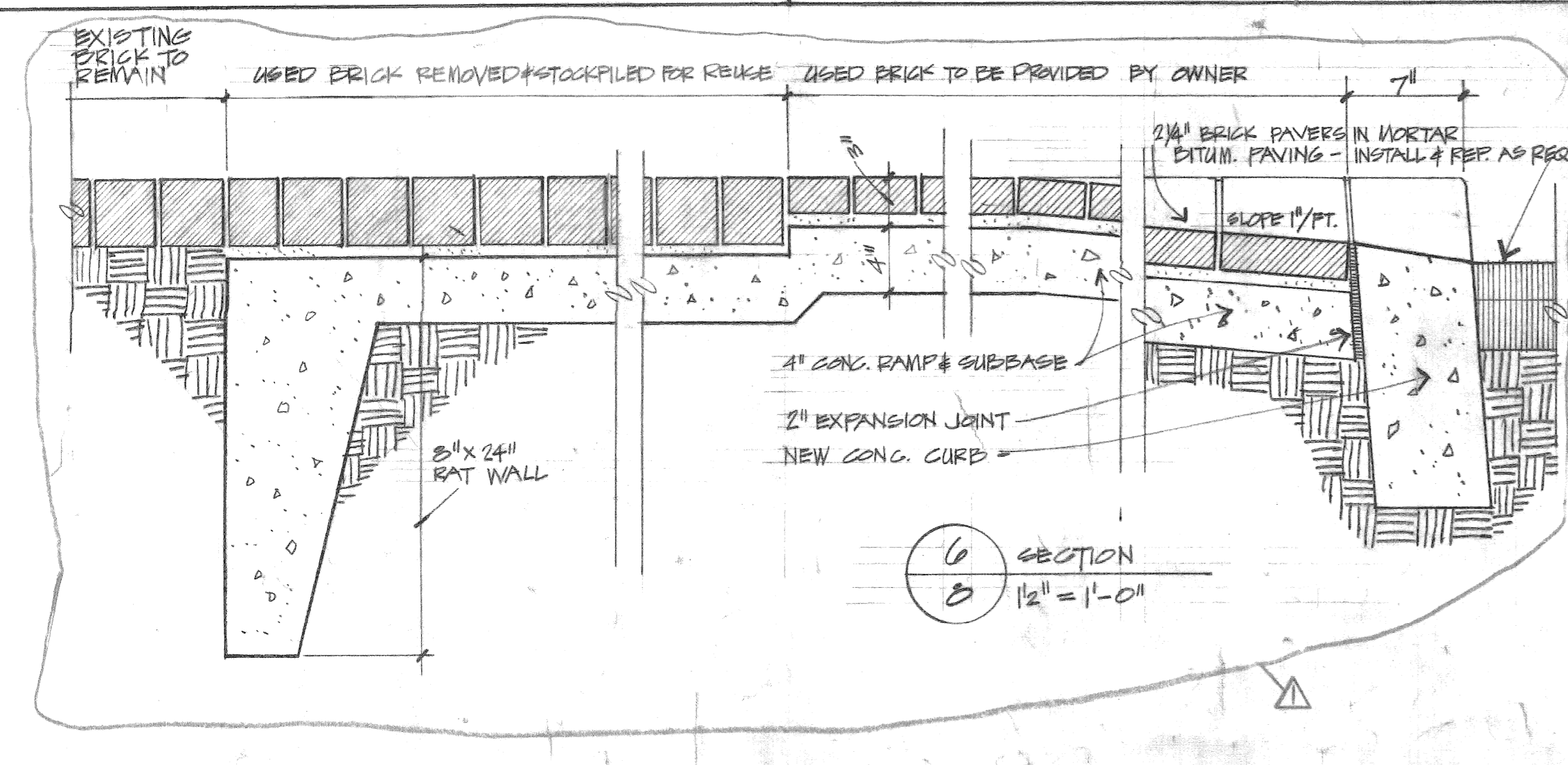

6 SECTION  
 8 1/2" = 1'-0"

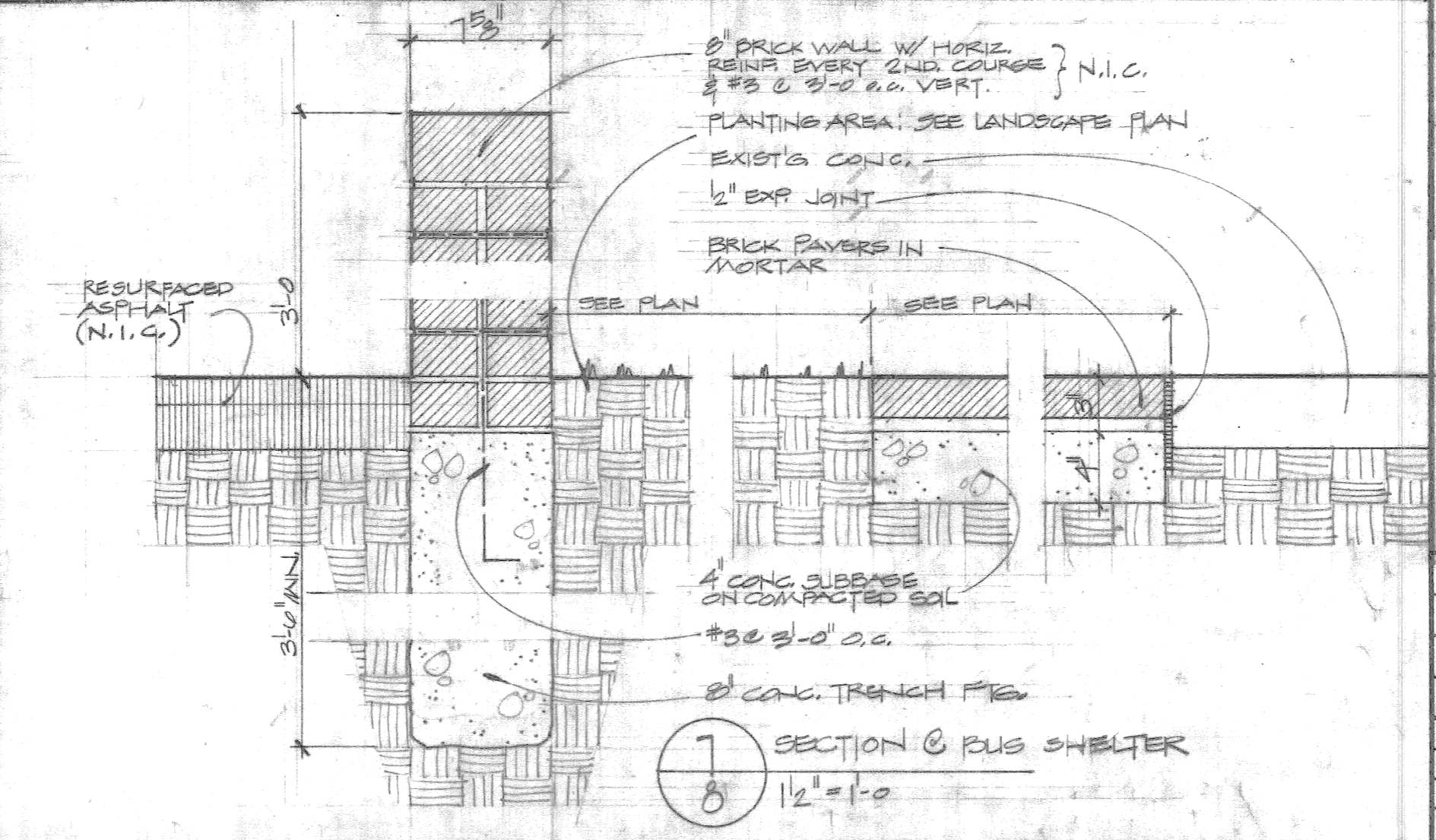

7 SECTION @ BUS SHELTER  
 8 1/2" = 1'-0"

PLANS PREPARED BY:  
**CHRISTOPHER WZACNY & ASSOC., INC.**  
 ARCHITECTS & PLANNERS

**CITY OF DETROIT**  
 COMMUNITY & ECONOMIC DEVELOPMENT DEPARTMENT  
 350 E. CONGRESS, DETROIT, MICHIGAN 48226

C.O. NO.	REVISION	DATE
3	ALTERATIONS TO TRAPPERS ALLEY ENTR.	7/22/76
2	ALTERATIONS TO TREE GRATE DETAIL	
1	TREE GRATE WELDING	AS-BUILT 1-9-75

ISSUED FOR: PRELIM BIDDING CONTRACT NO. 2296  
 DATE: 1-19-76  
 DR: GAGAN / SHOG  
 TR: 1-19-76  
 IN CHG: [Signature]  
 APPROVED: [Signature]

JOB TITLE: CREEK TOWN AREA IMPROVEMENT  
 SHEET TITLE: LANDSCAPING DETAILS  
 DRAWING NO: 8



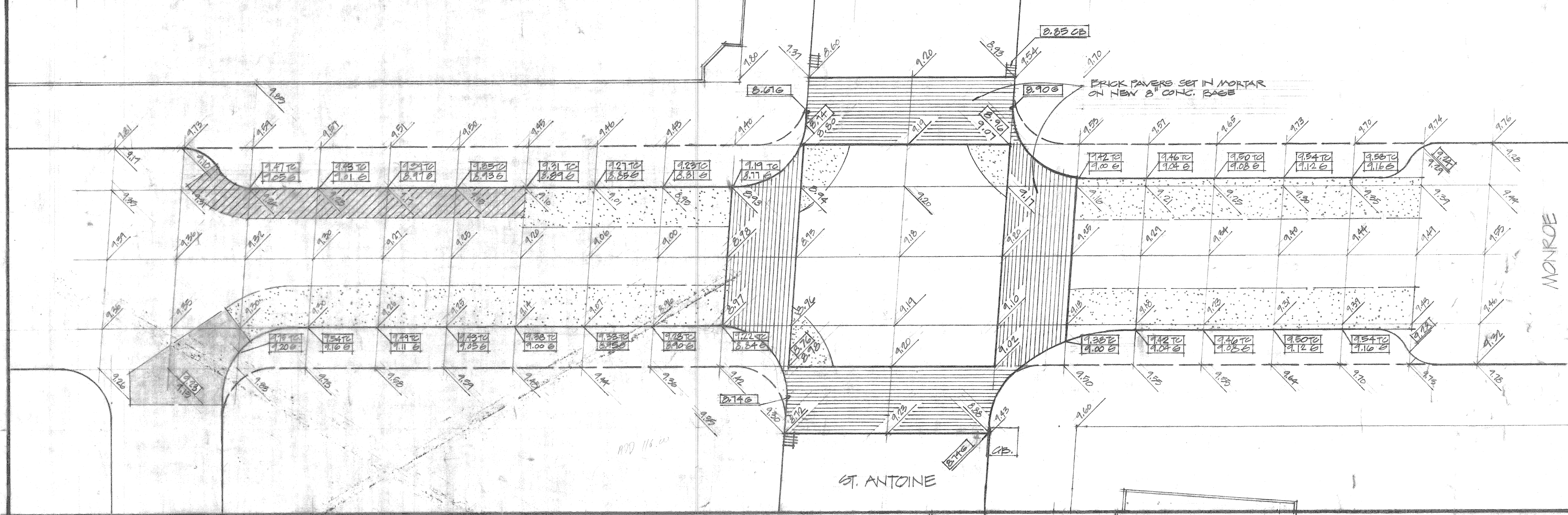
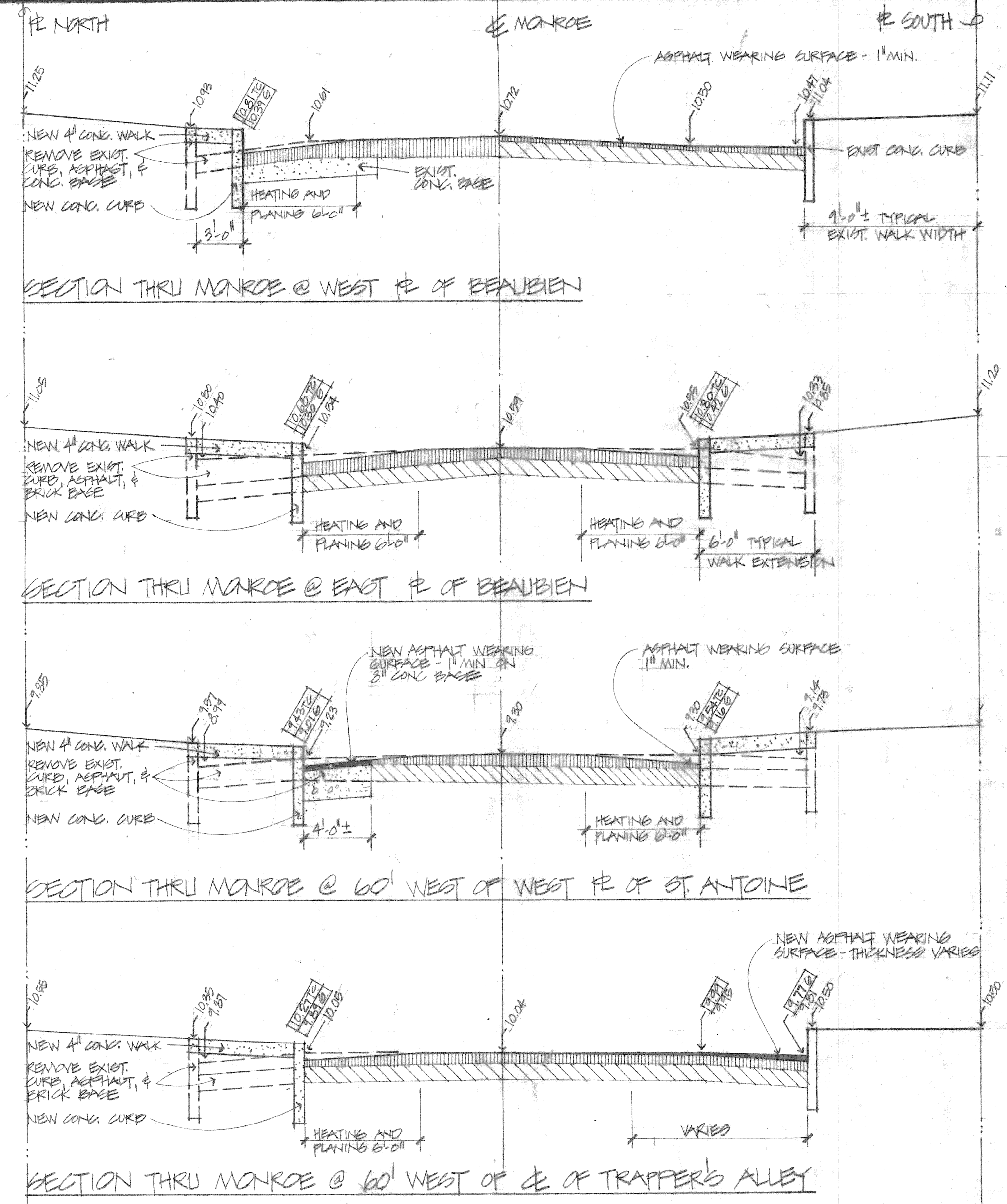
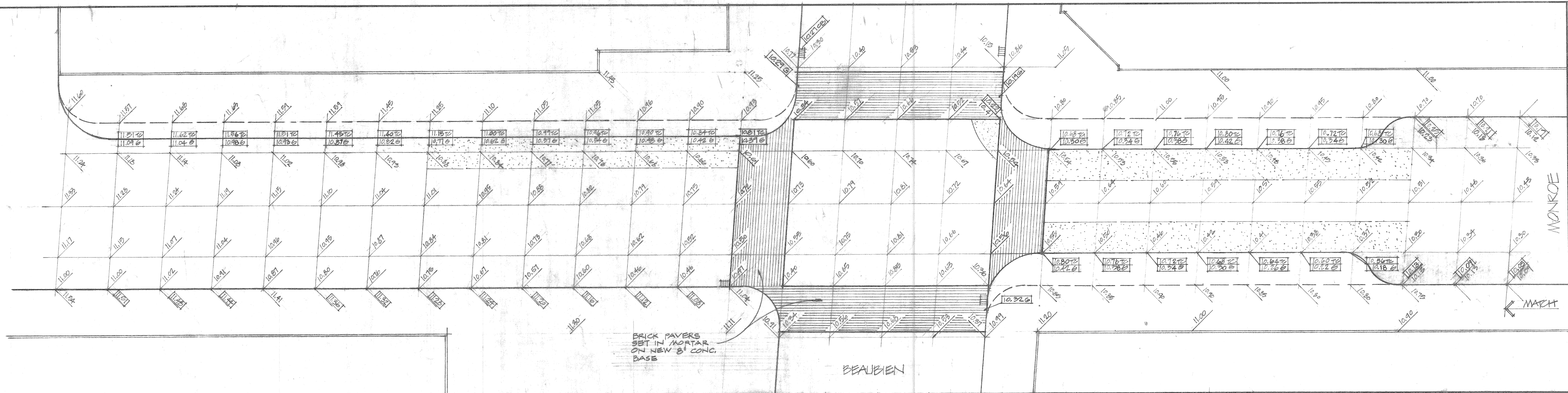

**NOTE:**  
 ALL BEGINNINGS AND ENDINGS, POINTS, AND EXACT EXTENT OF HEATING AND PLANING, AND OF NEW ASPHALT WEARING SURFACE, TO BE DETERMINED IN THE FIELD BY ARCHITECT AND/OR CITY ENGINEER.

00.00TC = NEW ELEVATION @ TOP OF CURB  
 00.00G = NEW ELEVATION @ GUTTER  
 00.00 = EXISTING ELEVATION

**SECTION KEY**

- ASPHALT PAVING (EXISTING)
- BRICK SUBBASE
- ASPHALT PAVING (NEW)
- NEW CONCRETE

**PLAN KEY**

- APPROXIMATE EXTENT OF HEATING & PLANING
- APPROXIMATE EXTENT OF NEW WEARING SURFACE ON EXISTING PAVEMENT
- APPROXIMATE EXTENT OF NEW WEARING SURFACE ON NEW CONCRETE BASE

C.O. NO. / REVISION		DATE	CITY OF DETROIT COMMUNITY & ECONOMIC DEVELOPMENT DEPARTMENT 350 E. CONGRESS, DETROIT, MICHIGAN 48226	
ISSUED FOR		DATE	JOB TITLE	CHEAT TITLE
AS-BUILT 1-9-78		1-17-76	GREEN TOWN AREA IMPROVEMENT	RECURFACING PLANS 1"=10'-0" AND SECTIONS
PAULIM	4-12-76	TR: [Signature]	APPROVED: [Signature]	DRAWING NO. <b>9</b>
CONTRACT NO. 2296		IN CHG: [Signature]	REGISTERED ENGINEER	

C-5270