

PROPOSED RIGHT TURN ROADWAYS AT EAST GRAND BLVD. & JEFFERSON

CITY OF DETROIT DEPARTMENT OF PUBLIC WORKS CITY ENGINEER'S OFFICE BUREAU OF

Table with columns: REVISIONS, DATE, DESCRIPTION, DRAWN BY, CHECKED BY, ENGINEER OF RECORD, APPROVED. Includes names like SIL AGRESTA and dates like 4-30-53.

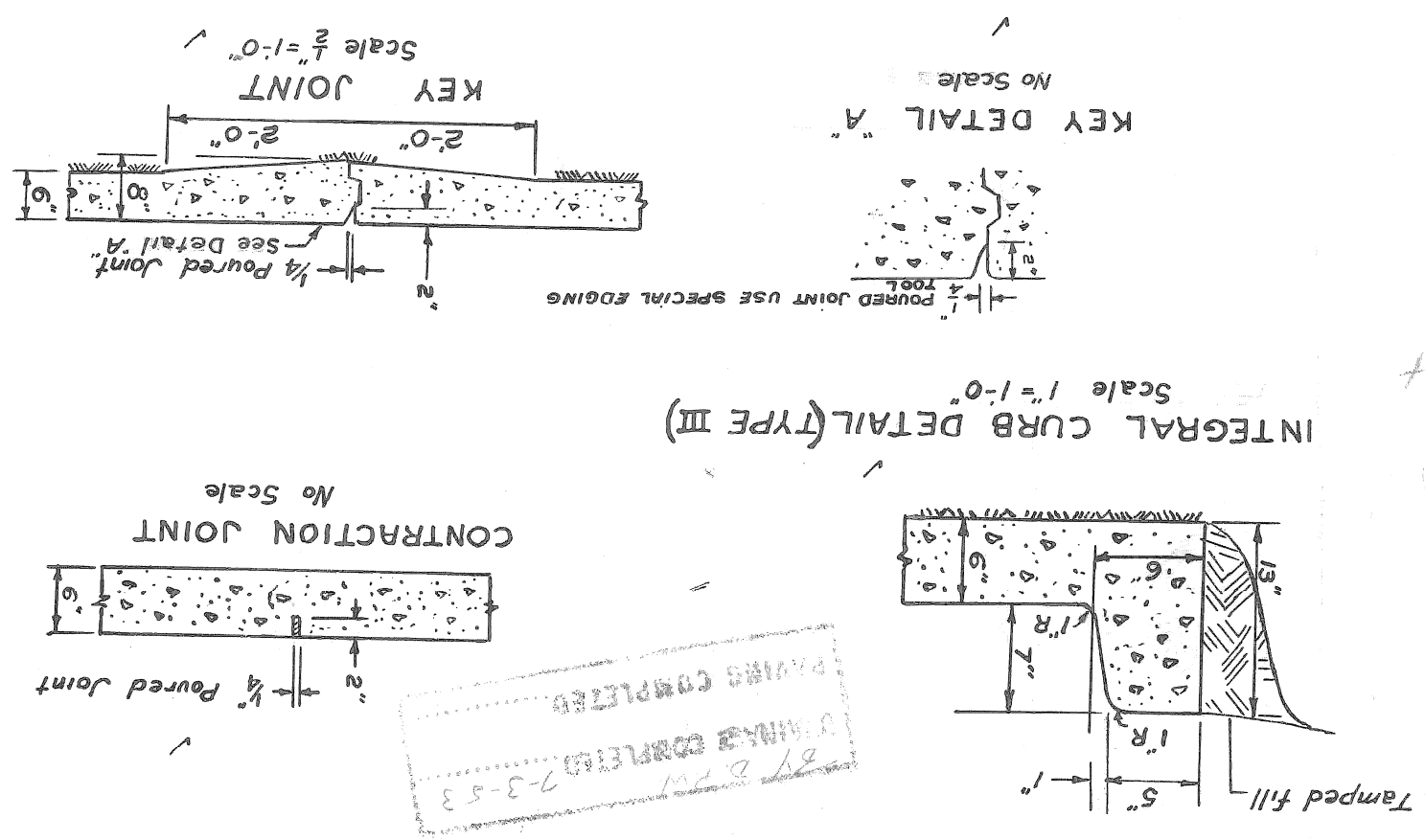

D.P.W. To start this project on June 1st 1953 4-27-53

REMOVAL QUANTITIES table: CURB 279 LIN. FT., WALK 7181 SQ. FT., TREES 0-12" SIZE 3.

CONSTRUCTION QUANTITIES table: EXCAVATION 754 CU. YDS., PAVEMENT 8:6:8 CONC. 2700 SQ. YDS., CATCH BASINS NEW 9, MANHOLE STD. 1, ASPHALT-STRIP & RESURFACE 267 SQ. YDS.

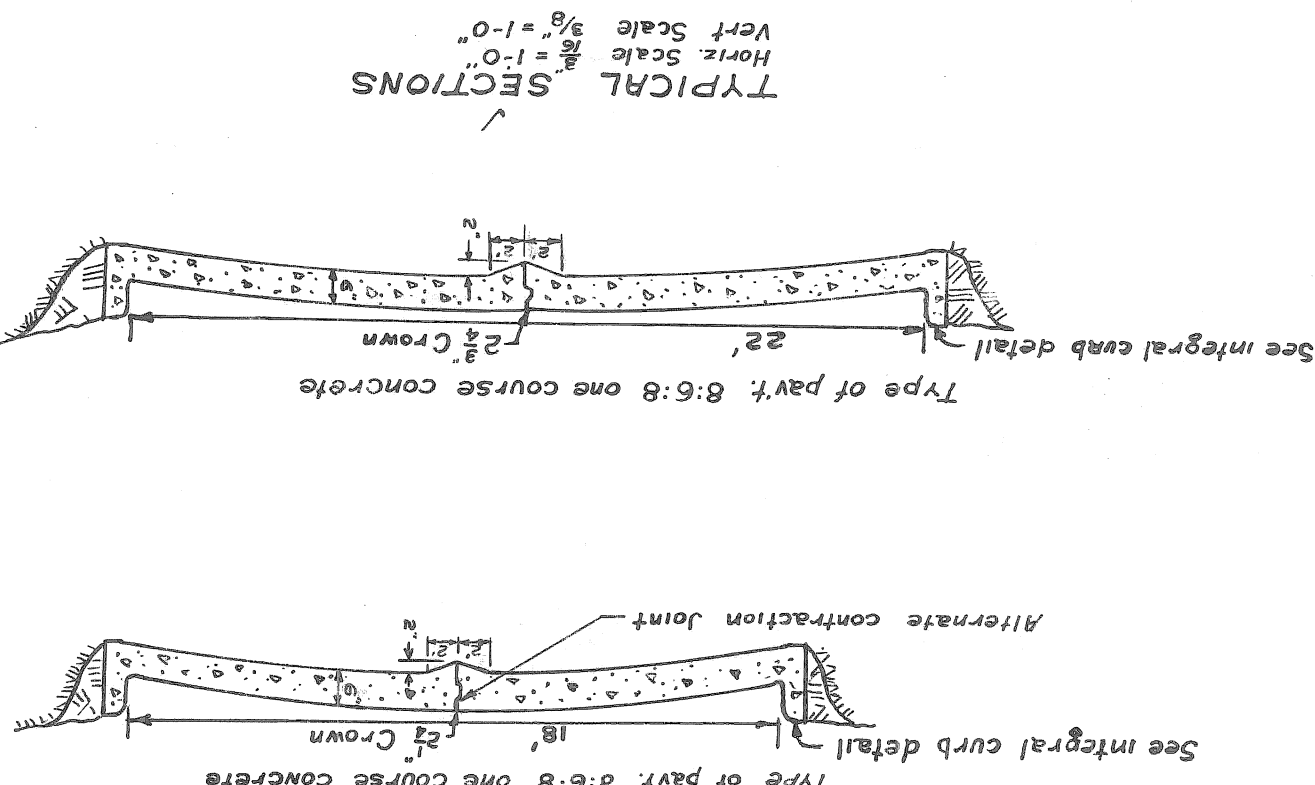

LEGEND table: PROPOSED CURB, EXISTING CURB, PROPOSED WATER LINES, EXISTING WATER LINES, etc.

BENCH MARKS ELEV. table with columns for stationing and elevation.

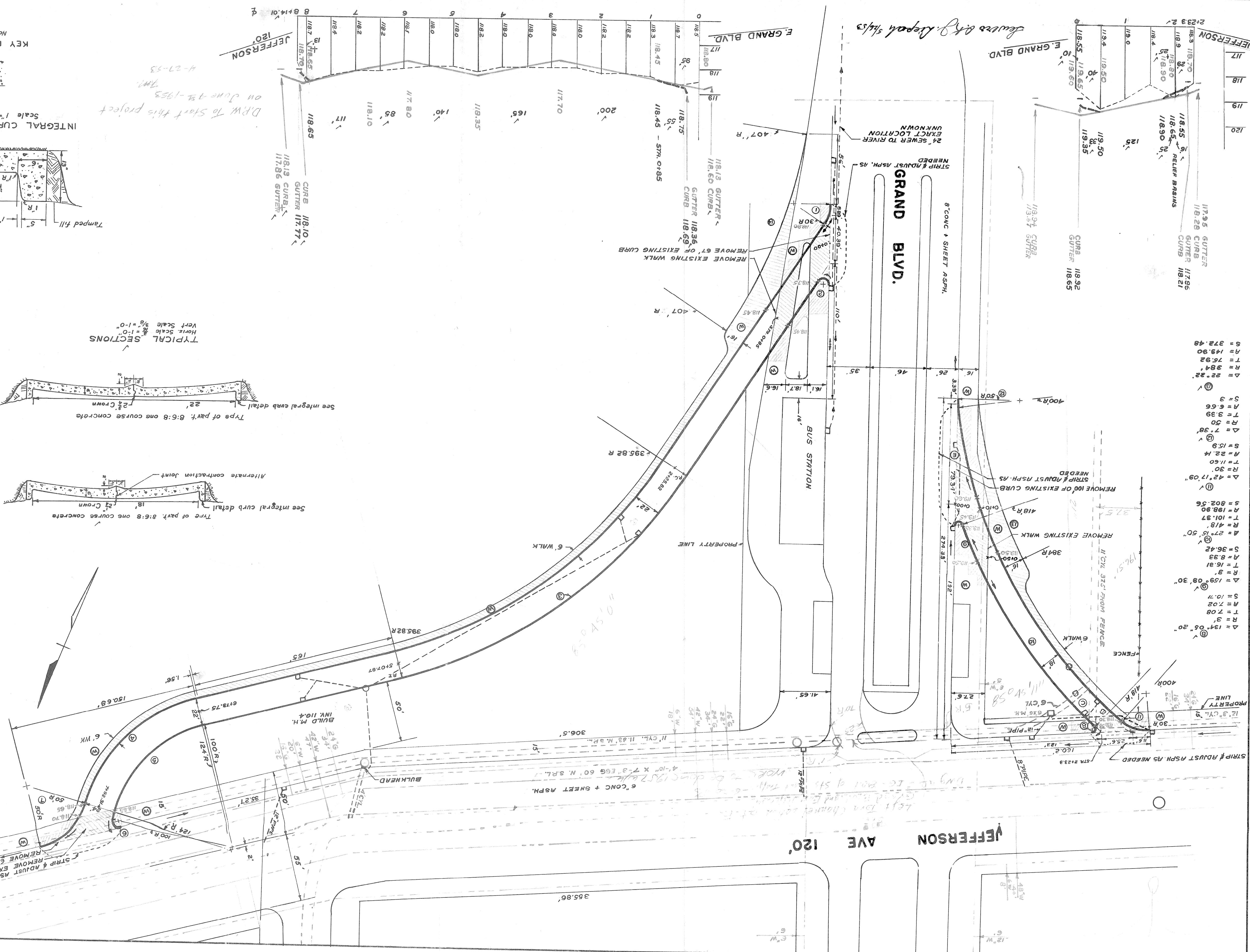

Table of stationing and elevations along the right turn roadway, listing station numbers and corresponding elevations.