

2-D. BL. 2-10-50  
1-14-50  
1-18

DUBOIS AVE. 50' WD.

CHENE AVE. 66' WD.

PALMER AVE. 60' WD. 7" REINFORCED CONC. PAV'T.

FERRY AVE. 60' WD.

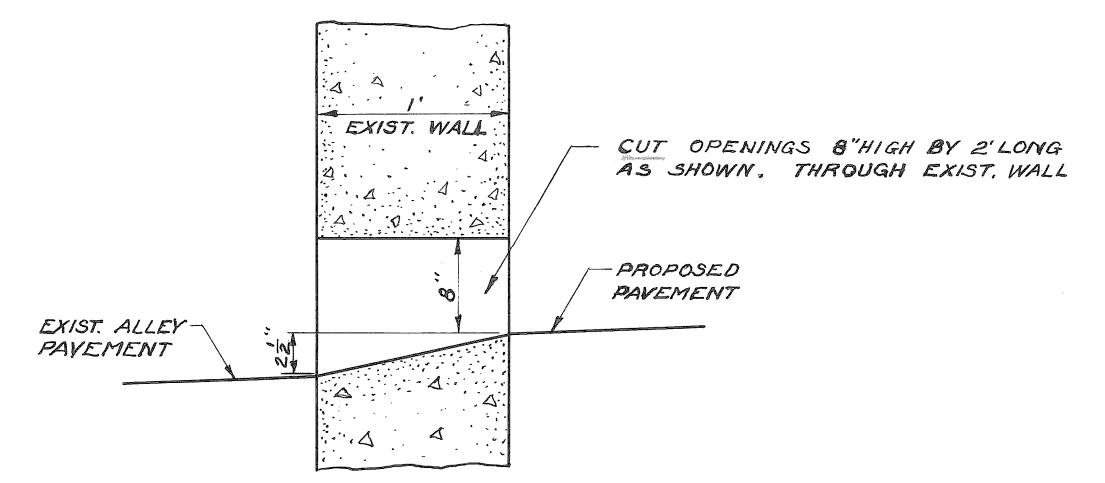

NOTE -  
AREA WITHIN HEAVY LINE TO BE PAVED WITH 6" MACADAM BASE COURSE & 2" ASPHALTIC CONCRETE SURFACE COURSE.  
AT (Z) CONSTRUCT 8" OIL MACADAM BASE COURSE & 2" ASPHALTIC CONCRETE SURFACE COURSE.  
AT (W) REPLACE 72 SQ. FT. OF STD. 4" SIDEWALK.  
AT (A) CONSTRUCT 1'-18" x 12" Y. BASIN WITH FLAT TYPE FRAME AND GRATE. (SEE STD. DWG. C-326-A)

- LEGEND
- EXISTING CATCH BASIN
  - EXISTING MANHOLE
  - ⊙ FIRE HYDRANT
  - PROPOSED 18" x 12" Y. BASIN
  - ⊗ PROPOSED FUTURE MANHOLE
  - EXISTING LATERAL SEWER.
  - - - EXISTING PUBLIC SEWER
  - GAS MAIN
  - WATER MAIN
  - PROPOSED SEWER
  - - - PROPOSED FUTURE SEWER.
  - ABOVE LINE DENOTES PROPOSED FINISHED GRADE.
  - - - BELOW LINE DENOTES EXISTING GRADE.

SUPPLEMENTARY DETAIL DRAWINGS  
CITY OF DETROIT STANDARD DRAWINGS NO. C-586  
C-739 B

SUMMARY OF QUANTITIES					
ITEM	UNIT	BID QUANTITIES	CHANGE	NEW QUANTITIES	FINAL PAYMENT QUANTITIES
EXCAVATION	CU. YDS.	2556	+ 70	2626	
6" MACADAM BASE COURSE	SQ. YDS.	5628	+ 104	5732	
2" ASPHALTIC CONCRETE SURFACE	SQ. YDS.	5875	+ 104	5979	
ASPHALT EMULSION	GALLONS	7285	+ 130	7415	
8" MACADAM BASE COURSE - DRIVE	SQ. YDS.	47	- 10	37	
TYPE II CONCRETE CURB	LIN. FT.	40	- 7	33	
4" SIDEWALK	SQ. FT.	72		72	
4 1/2" O.D. x 4 FT. LG. (157/FI) STEEL PIPE POSTS	EACH	89		89	
STD. 18" x 12" Y. CATCH BASIN	EACH	1		1	
12" PIPE SEWER	LIN. FT.	30		30	
4 1/2" O.D. x 6 FT. LG. (157/FI) STEEL PIPE POSTS		11		11	

SEWERAGE COMPLETED.....  
PAVING COMPLETED 11-15-50

42492

A.O. # 374

DESIGNED BY	
DRAWN BY	J. ERICKSON
TRACED BY	
CHECKED BY	ROBERT ROOM
DESCRIPTION	REVISIONS
DRW.	CKD.
APR.	DATE

APPROVED  
*J.P. Barton*  
ENGINEER OF  
*Wm. Wallace*  
*Walter R. Fisher*  
DEPUTY CITY ENGINEER

CITY OF DETROIT  
DEPARTMENT OF PUBLIC WORKS  
CITY ENGINEER'S OFFICE  
BUREAU OF STREETS  
FOR BUREAU OF MARKET  
CONTRACT NO. P.S. - 2

CHENE - FERRY - MARKET  
PARKING AREA  
BOOK NO. 1638 FINAL - BOOK NO. 1068  
PAGE NO. 56 59  
SCALE 1" = 20'  
DATE 2-7-50  
DWG. NO. C-1465  
SHEET 1 OF 2

55

Draw. 8



2-BL 2-10-50  
 25-BL 4-14-50  
 1-BL

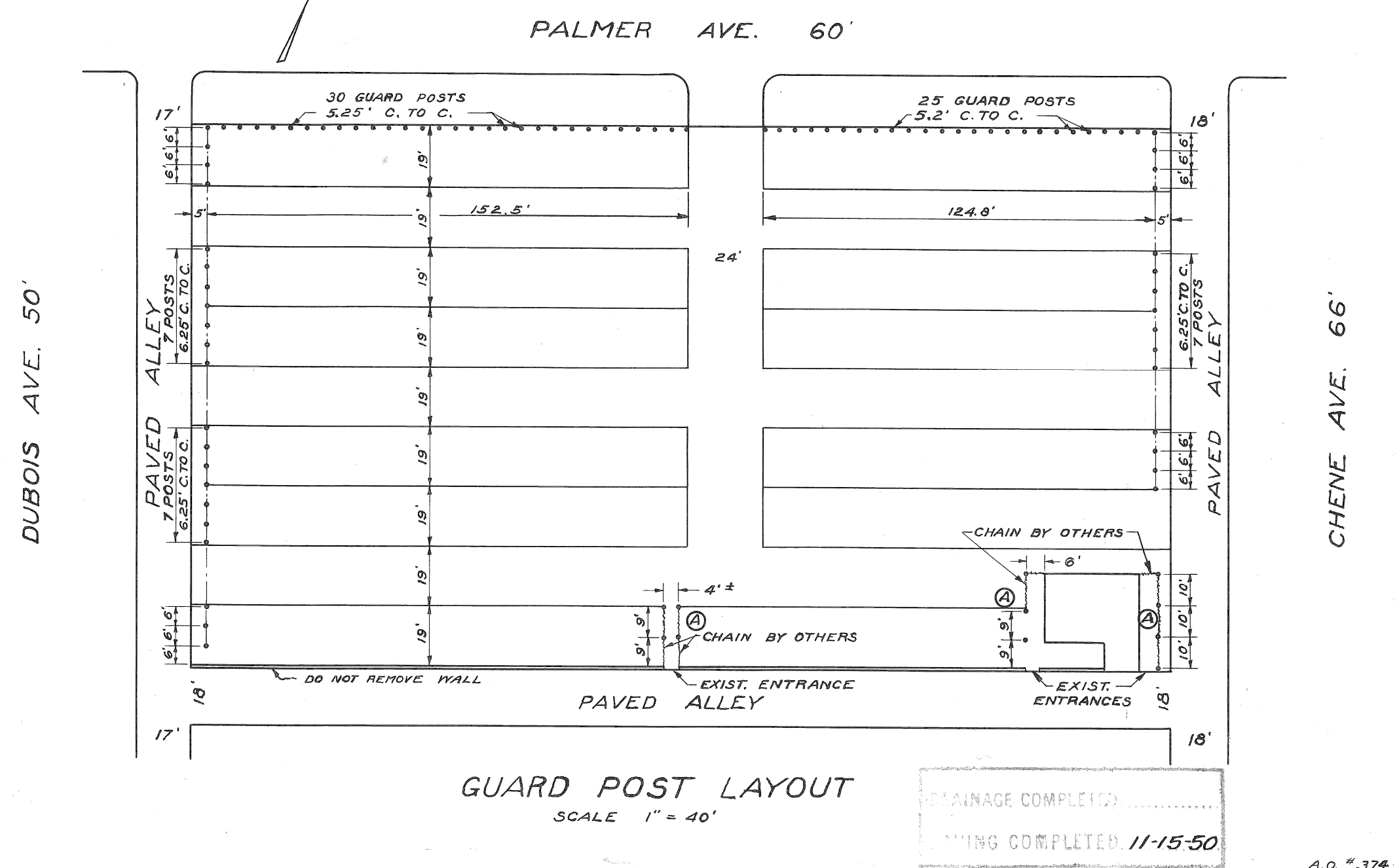
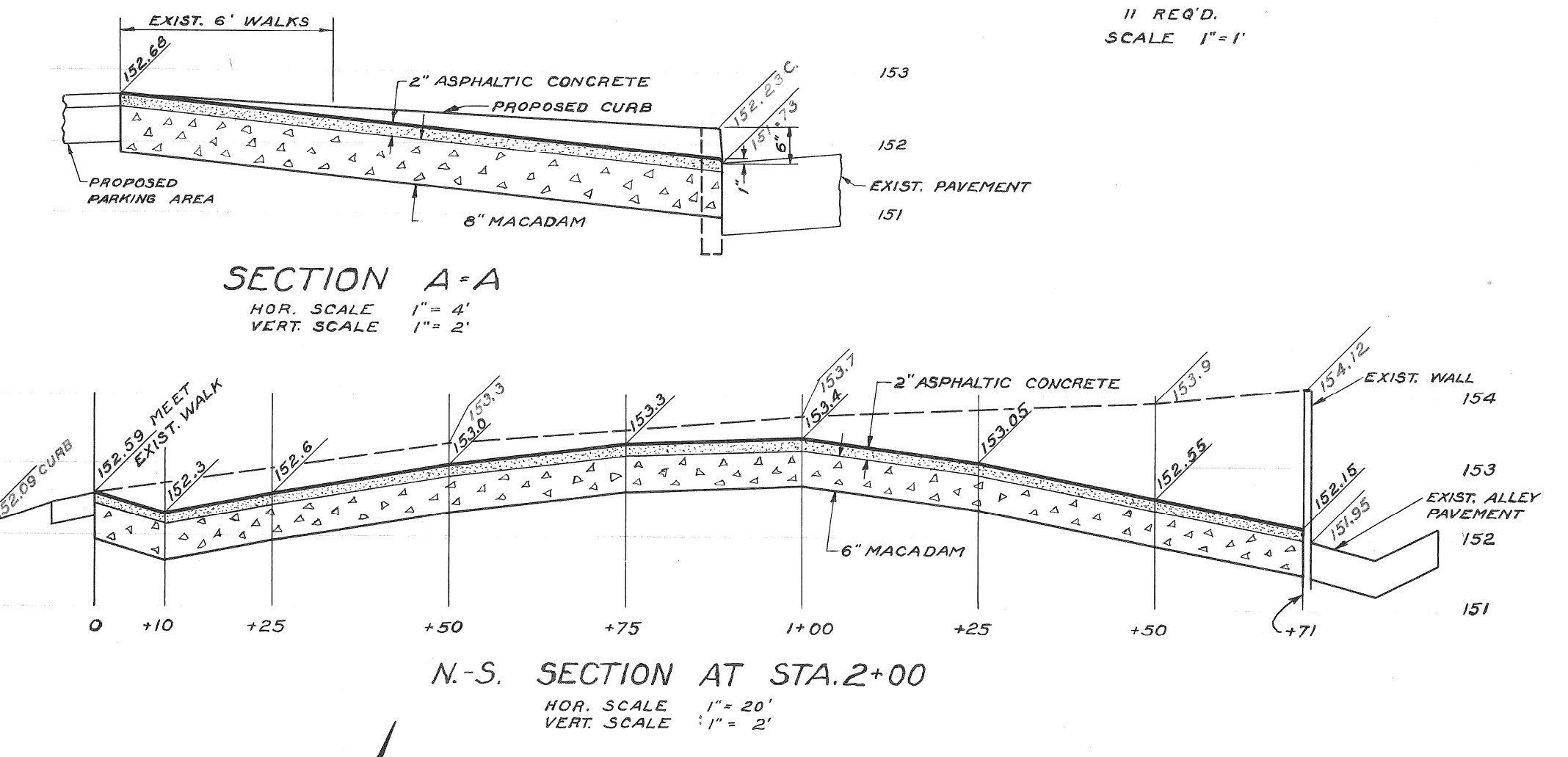
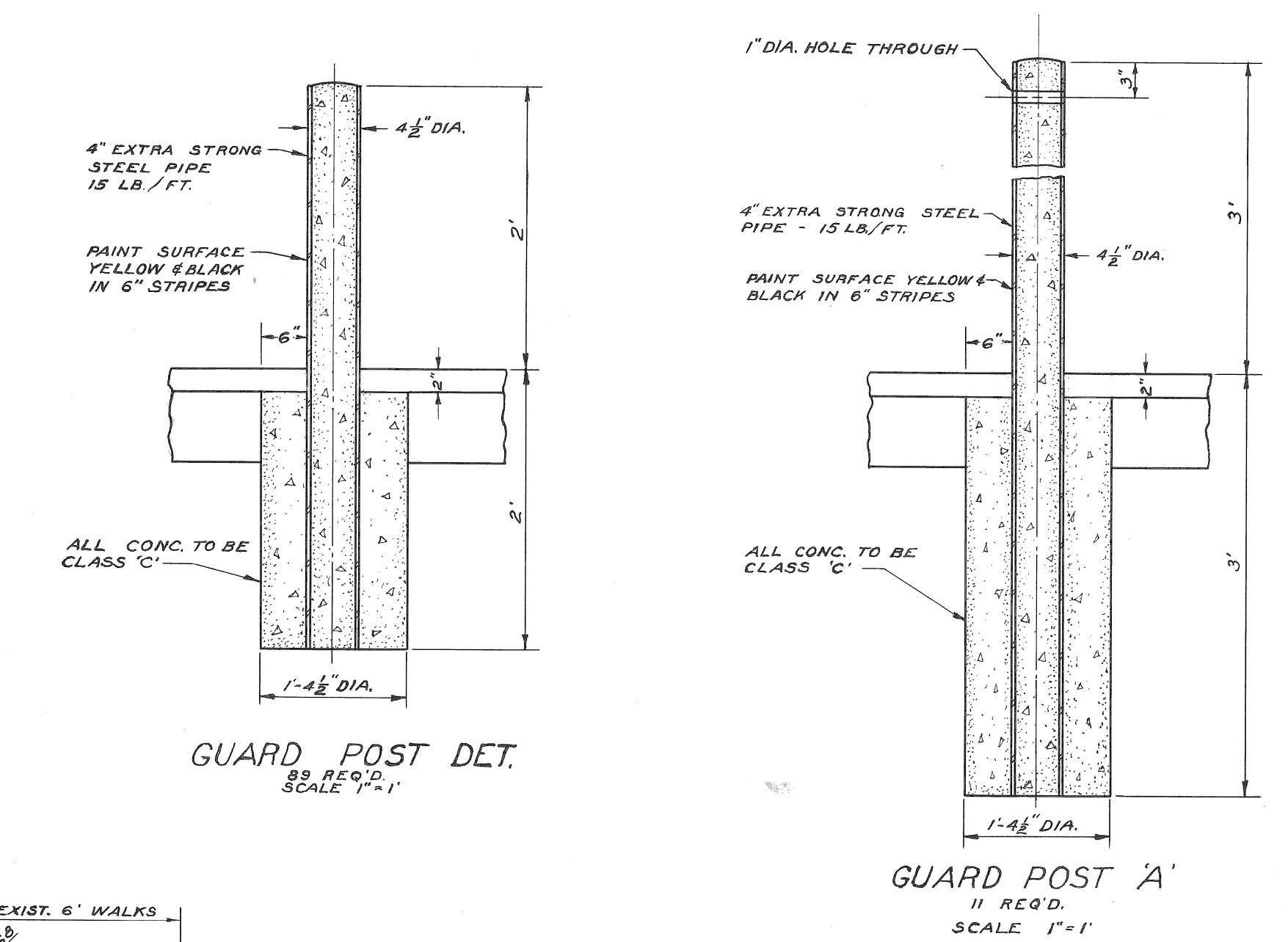
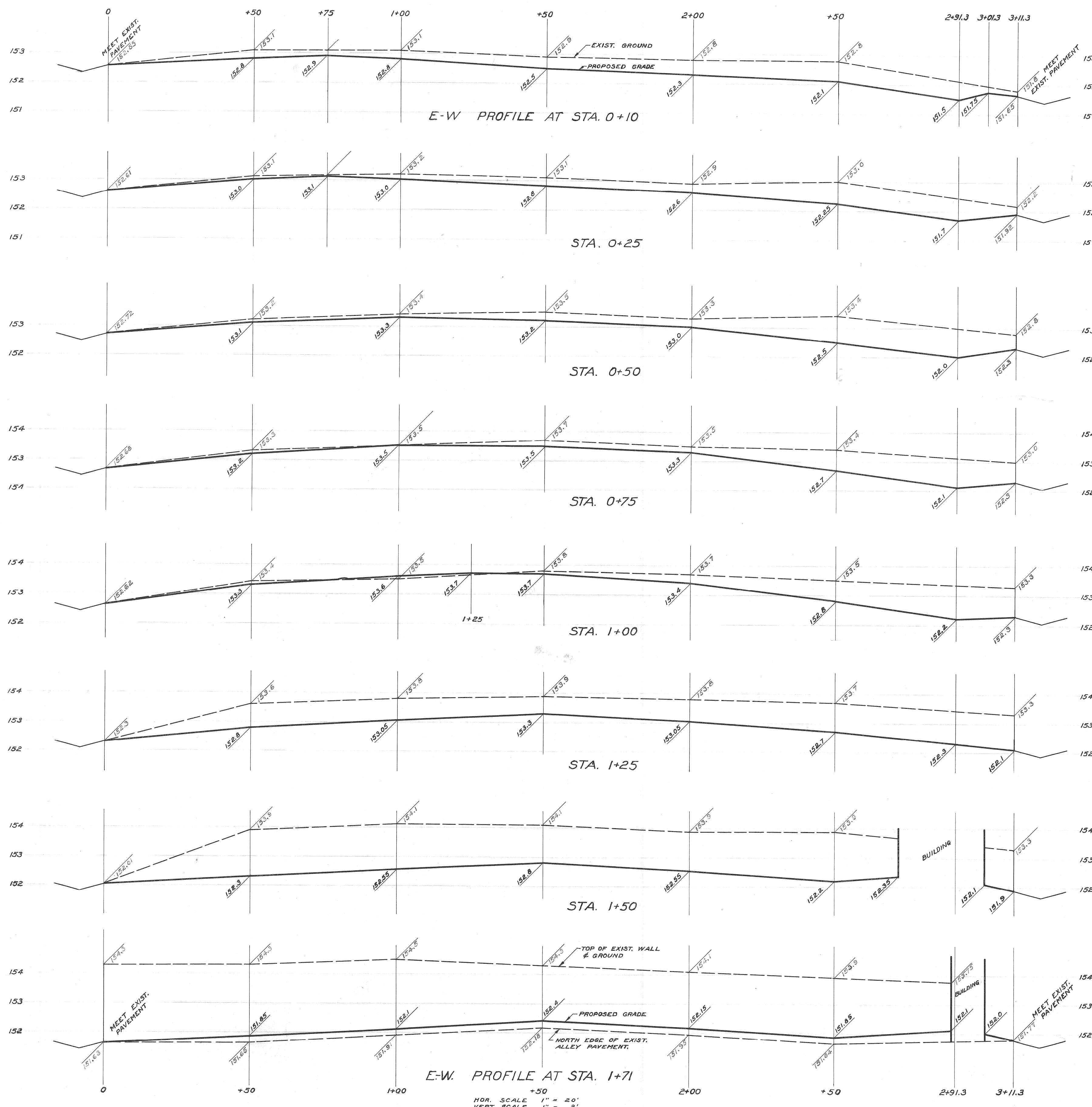

F E D C B A DESCRIPTION REVISIONS DRW. CKD. APP. DATE	DESIGNED BY	APPROVED	CITY OF DETROIT DEPARTMENT OF PUBLIC WORKS CITY ENGINEER'S OFFICE BUREAU OF STREETS CONTRACT NO. P.S.-2	CHENE-FERRY-MARKET PARKING AREA BOOK NO. 1638 PAGE NO. 56 SCALE AS SHOWN DATE 2-7-50 DWG. NO. C-1465 SHEET 2 OF 2
	DRAWN BY J. ERICKSON	<i>J. L. Barton</i>		
	TRACED BY	<i>Wallace</i>		
	CHECKED BY <i>Robert R. Room</i>	<i>Martin R. Fisher</i> DEPUTY CITY ENGINEER		
	FOR BUREAU OF MARKET			