

UTILITY LEGEND

- 12" Existing Lateral Sewer & Manhole
- 15" Existing Public Sewer & Manhole
- Existing Gas Line & Manhole
- Existing Water Main & Manhole
- Existing Michigan Bell Telephone Duct & Manhole
- Existing PLC Ducts & Manhole
- Detroit Edison Electric Conduits & Manhole
- PLC Light Pole
- Mail Box
- PLC Pole

Curb Line

- Proposed C.B., MH & Inlet Sewer
- Existing C.B., MH. & Inlet Sewer

REMOVAL LEGEND

- Pavement Removal
- Sidewalk Removal
- Driveway Removal
- Separate Type Curb Removal-Unreinforced

PLAN
Scale: 1" = 20'

PROJECT ITEMS	Quantity & Pay Unit
* Separate Curb-Type II	302 Lin. Ft.
9" Concrete Base Pavement-Unreinforced	44 Sq. Yds.
Binder Course Mixture 25A	2.2 Tons
Wearing Surface Mixture 31A	2.2 Tons
Bituminous Bond Coat	6 Gals.
4" Sidewalk	42 Sq. Ft.
8" Driveway	118 Sq. Ft.
Corrugated Concrete Divider	89 Sq. Yds.
Bituminous Concrete Rumble Strip	90 Sq. Yds.
Excavation	26 Cu. Yds.
Top Soil	7 Cu. Yds.
Sodding	55 Sq. Yds.
Catch Basin-New	1 Each
Sewers Under Pavement-12"	3 Lin. Ft.
Street Pavement Removal	126 Sq. Yds.
Sidewalk Removal	44 Sq. Ft.
Driveway Removal	207 Sq. Ft.
Separate Type Curb Removal-Unreinforced	170 Lin. Ft.
Maintaining Traffic	Lump Sum

* Both Separate and Integral Curbs are included in this item.

DESIGNED BY B.J.T.		APPROVED: <i>[Signature]</i> ENGINEER OF EXPERTS		CITY OF DETROIT DEPARTMENT OF PUBLIC WORKS CITY ENGINEERS OFFICE	RECONSTRUCTION OF THE WEST GRAND BOULEVARD - MAGNOLIA INTERSECTION REMOVAL AND UTILITY PLAN	SHEET 1 OF 2 SHEETS	
DRAWN BY G.D.M.		ADMINISTRATIVE ENGINEER <i>[Signature]</i> HEAD CIVIL ENGINEER				CONTRACT NO.	ASSIGNMENT NO - AO-1940
REVISIONS LOCATED BY COORDINATES ON SHEET							

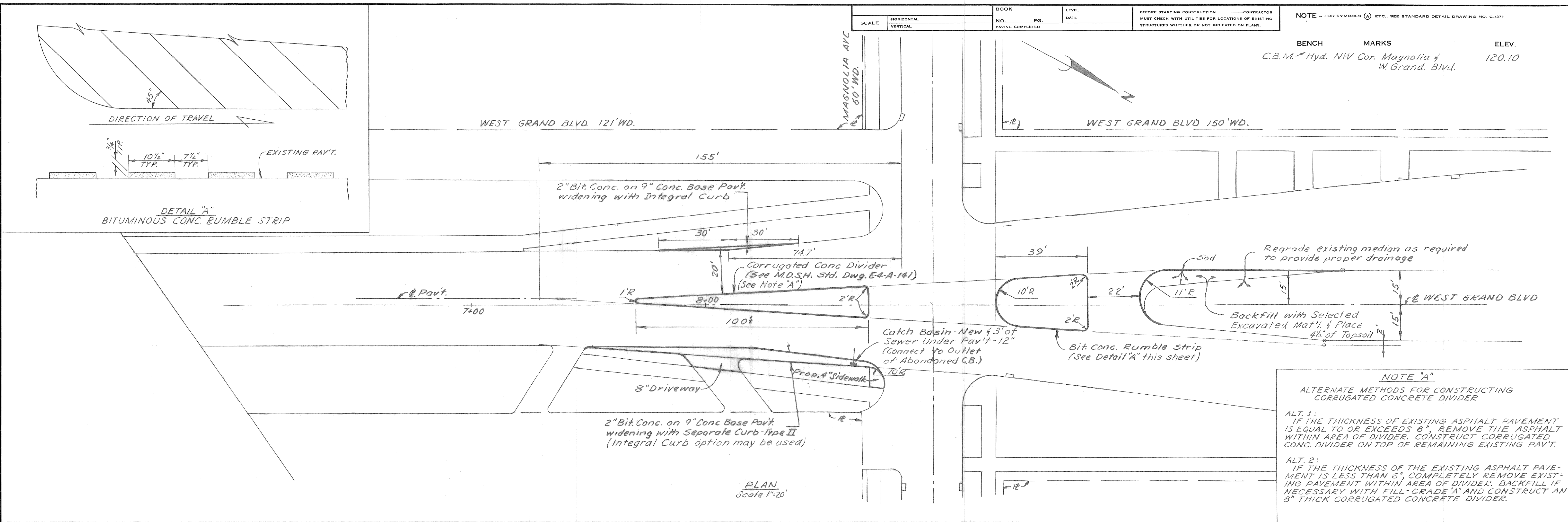

NOTE "A"
 ALTERNATE METHODS FOR CONSTRUCTING CORRUGATED CONCRETE DIVIDER

ALT. 1:
 IF THE THICKNESS OF EXISTING ASPHALT PAVEMENT IS EQUAL TO OR EXCEEDS 6", REMOVE THE ASPHALT WITHIN AREA OF DIVIDER. CONSTRUCT CORRUGATED CONC. DIVIDER ON TOP OF REMAINING EXISTING PAV'T.

ALT. 2:
 IF THE THICKNESS OF THE EXISTING ASPHALT PAVEMENT IS LESS THAN 6", COMPLETELY REMOVE EXISTING PAVEMENT WITHIN AREA OF DIVIDER. BACKFILL IF NECESSARY WITH FILL-GRADE "A" AND CONSTRUCT AN 8" THICK CORRUGATED CONCRETE DIVIDER.

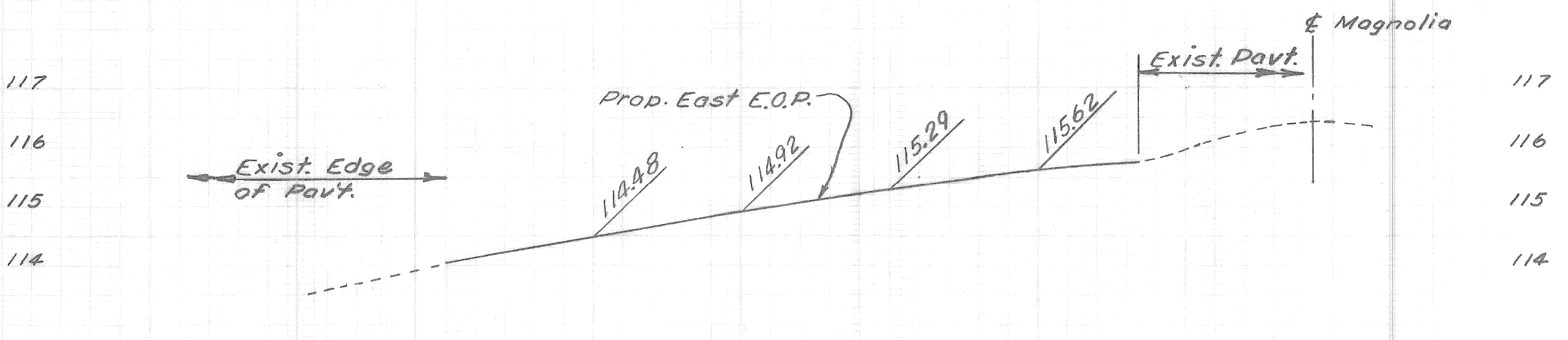
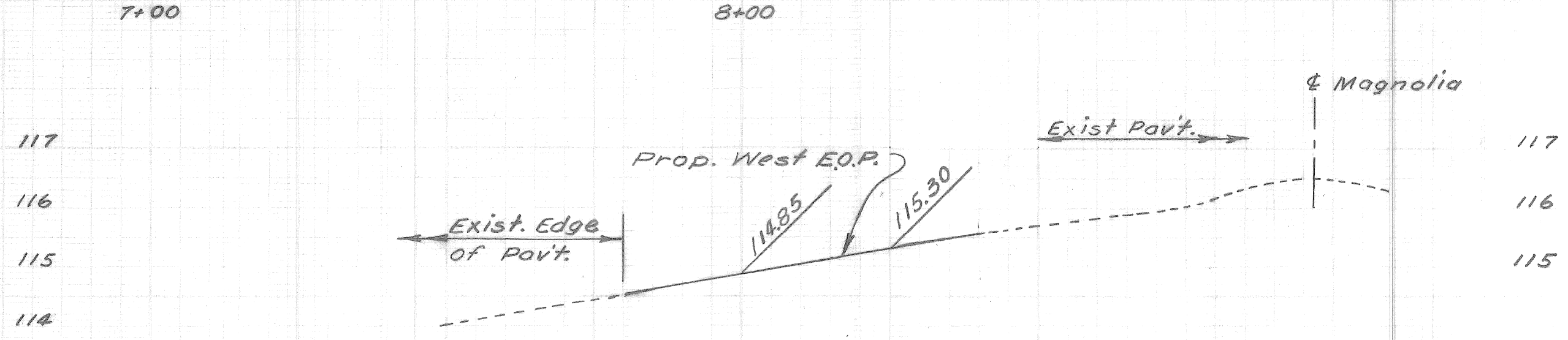

PROFILE
 Scale: Horz: 1"=20'
 Vert: 1"=2'

DESCRIPTION	DRN	CK'D	AP'D	DATE
REVISIONS				
BY	B.J.T.	CHECKED BY	G.D.M.	APPROVED
GRADE	B.J.T.		G.D.M.	<i>G.D.M.</i>
ESTIMATE	G.D.M.		B.J.T.	ADMINISTRATIVE ENGINEER
FINAL				<i>Craig W. ...</i> HEAD CIVIL ENGINEER

CITY OF DETROIT
 DEPARTMENT OF PUBLIC WORKS
 CITY ENGINEERS OFFICE

RECONSTRUCTION OF THE WEST GRAND BOULEVARD-MAGNOLIA INTERSECTION
 ALIGNMENT, PLAN AND PROFILE

INDEX NO.	SHEET 2 OF 2 SHEETS
CONTRACT NO.	
ASSIGNMENT NO.	AO-1940
DATE	April 7, 1970