

SHEET NO.	TOTAL SHEETS
1	1

BOARD OF
WAYNE COUNTY ROAD COMMISSIONERS
 DETROIT, MICHIGAN

CHARLES L. WILSON MICHAEL J. O'BRIEN JOHN P. O'HARA
COMMISSIONER CHAIRMAN VICE CHAIRMAN

**PLAN AND PROFILE OF PROPOSED
 FIVE MILE WIDENING
 AND
 RESURFACING**

INDEX TO SHEETS
 WYOMING to TELEGRAPH (WIDEN TO 40)
 Sheet #1 Title Sheet
 1A Typical Cross Section
 2 Standard Manhole
 3-13 Plan & Profile
 14-23 Conc. Cully
 24-25 Plan Pavt Widen
 TELEGRAPH to BEECH (WIDEN TO 42')
 Sheet #1 Title Sheet
 26 Typical Cross Section
 27-31 Plan & Profile
 WYOMING to SOUTHFIELD (WIDEN OVER 40')
 Sheet #1 Title Sheet
 3-20 Plan & Profile

1950 PROJECT { GRAND RIVER to EVERGREEN (A.C. RESURFACING)
 Sheet #1 Title Sheet
 2C Typical Cross-section
 3-7 Plan & Profile
 8 Special Detail
 STANDARDS
 C-17-2A
 C-17-2B

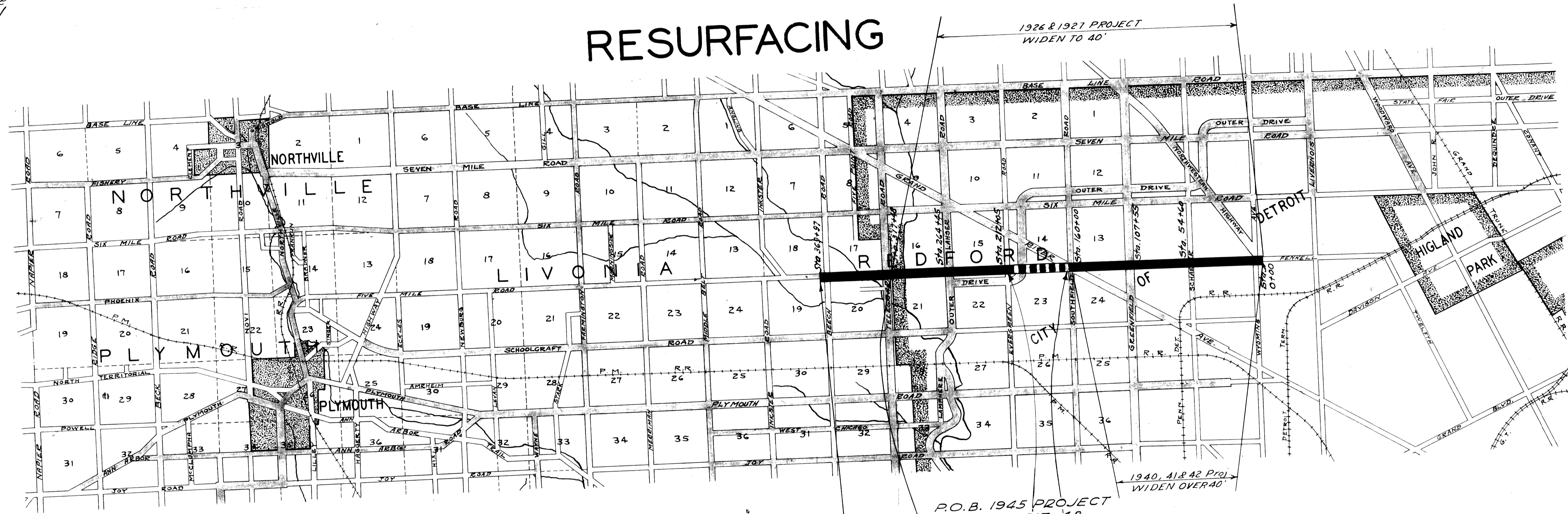

P.O.E. 1945 PROJECT STATION -369+97 P.O.E. 1950 PROJECT STATION 212+45 P.O.B. 1950 PROJECT STATION 164+65

FENKELL
 SOUTHFIELD TO
 EVERGREEN

Southfield to Evergreen
Fenckell Ave
widening + Resurfacing
5-19-1950

CORRECT *[Signature]* ROAD ENGINEER
 APPROVED _____ ENGINEER MANAGER

Fenckell Ave Southfield to Evergreen

FILE A-8-1-1-82 ①

TYPICAL CROSS-SECTION

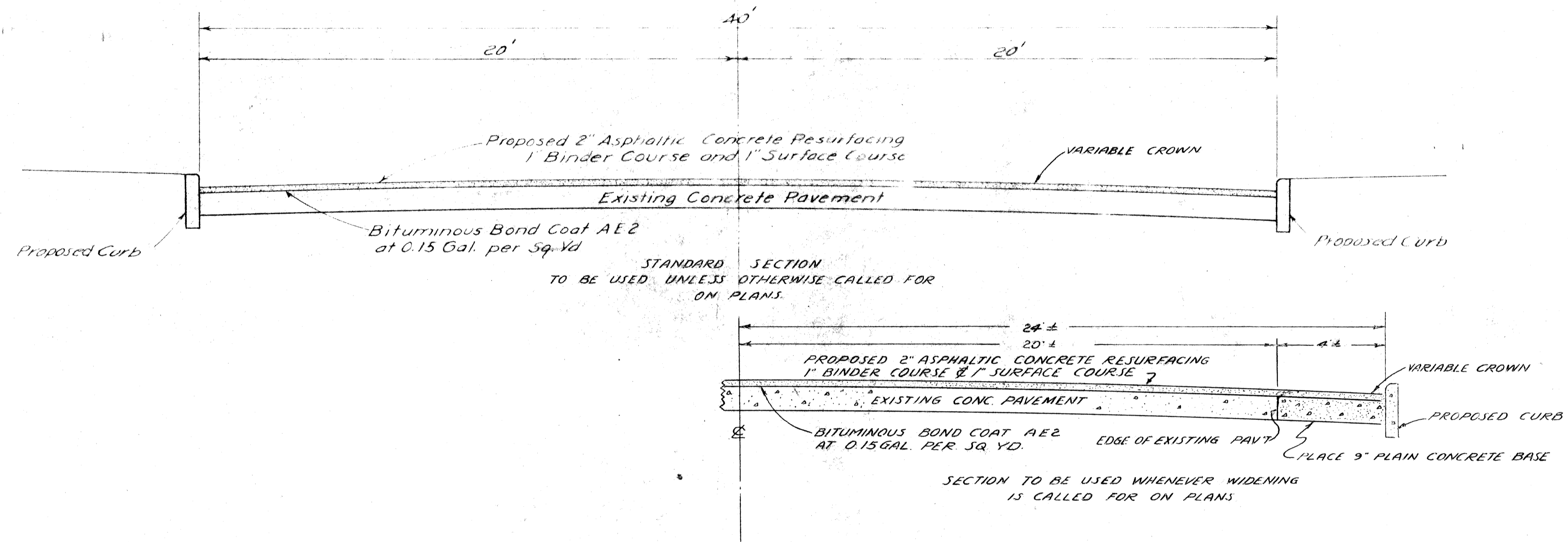

LEVELING OPERATION

Depressions in the existing surface shall be brought to a uniform contour by using Asphaltic Concrete Binder Course Mixture before placing the Binder Course. The Material used for the Leveling Operation will be paid for at the Contract Unit Price per Ton of Asphaltic Concrete Binder Course Mixture.

PAVEMENT PATCHING

Concrete Pavement removed shall be replaced with 9" Concrete Base Course in Accordance with detail shown on Standard Plan C-17-2A as directed by the Engineer.

GENERAL NOTES

The location of all Public Utilities shown on these Plans is taken from the best available data. The Board of Wayne County Road Commissioners will not be responsible for any omissions or variations from the locations shown.

Before starting construction the Contractor shall check with the "Utilities" the location of existing structures whether or not indicated on plans.

Any existing castings damaged by the Contractor in the course of work shall be replaced by the Contractor at his own expense.

The Board of Wayne County Road Commissioners will furnish all Drainage Structure Castings to B the Contractor's Truck at the Board's Yard located at Michigan Avenue and Howe Road near the Village of Wayne.

All Joint Material required for pavement construction shall be furnished by the Contractor.

Bulk Cement will be furnished by the Board to b. the Contractors Set-up at the site.

DATE	BY
8-29-44	K. W. G. G.
7-17-44	G. G. G.
SURVEYED	
NOTE BOOK	
ALIGNMENT CHECKED	
RT. OF WAY CHECKED	
NO. 7-4-7	

DATE	BY
8-15-49	K. W. G. G.
7-17-49	G. G. G.
SURVEYED	
NOTE BOOK	
ALIGNMENT CHECKED	
B.M.'S NOTED	
STRUCTURE NOTATIONS CHECKED	
NO. 7-4-7	

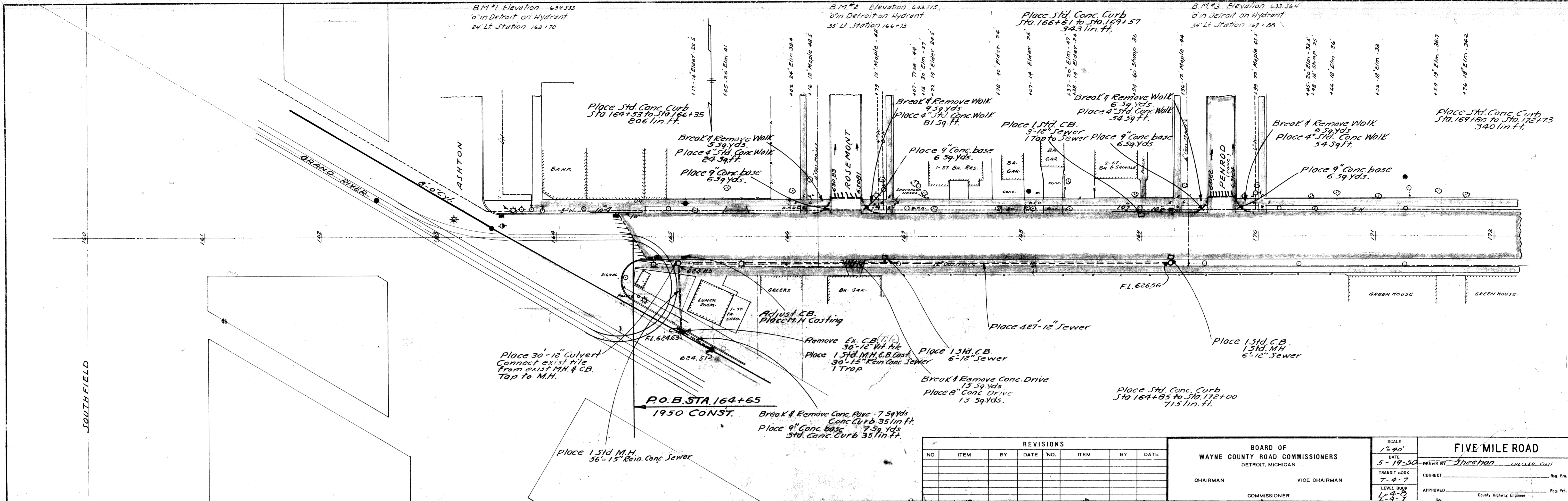

REVISIONS					
NO.	ITEM	BY	DATE	NO.	DATE

BOARD OF WAYNE COUNTY ROAD COMMISSIONERS
DETROIT, MICHIGAN

CHAIRMAN: _____ VICE CHAIRMAN: _____

COMMISSIONER: _____

SCALE: 1" = 40'

DATE: 5-19-50

DRAWN BY: Sheehan

CHECKED: G. G. G.

APPROVED: _____ County Highway Engineer

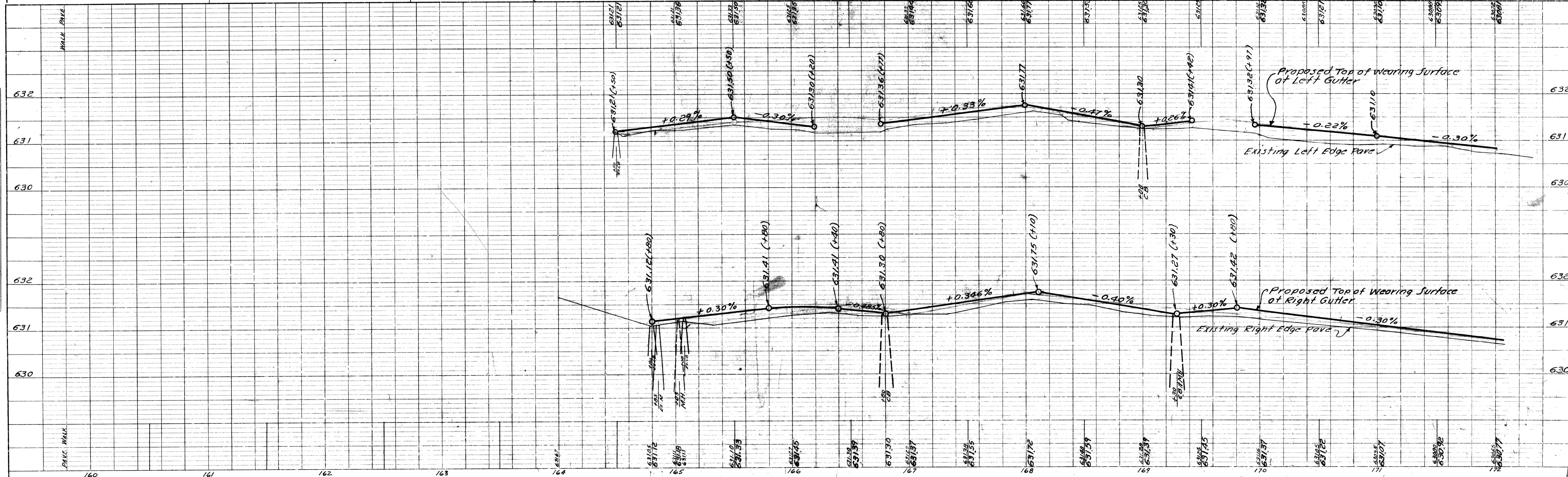

DATE 8-29-54
BY A. W. G. [Signature]
SURVEYED [Signature]
NOTE BOOK [Signature]
NO. 7-4-7

DATE 9-15-54
BY K. W. G. [Signature]
SURVEYED [Signature]
NOTE BOOK [Signature]
NO. 7-4-7

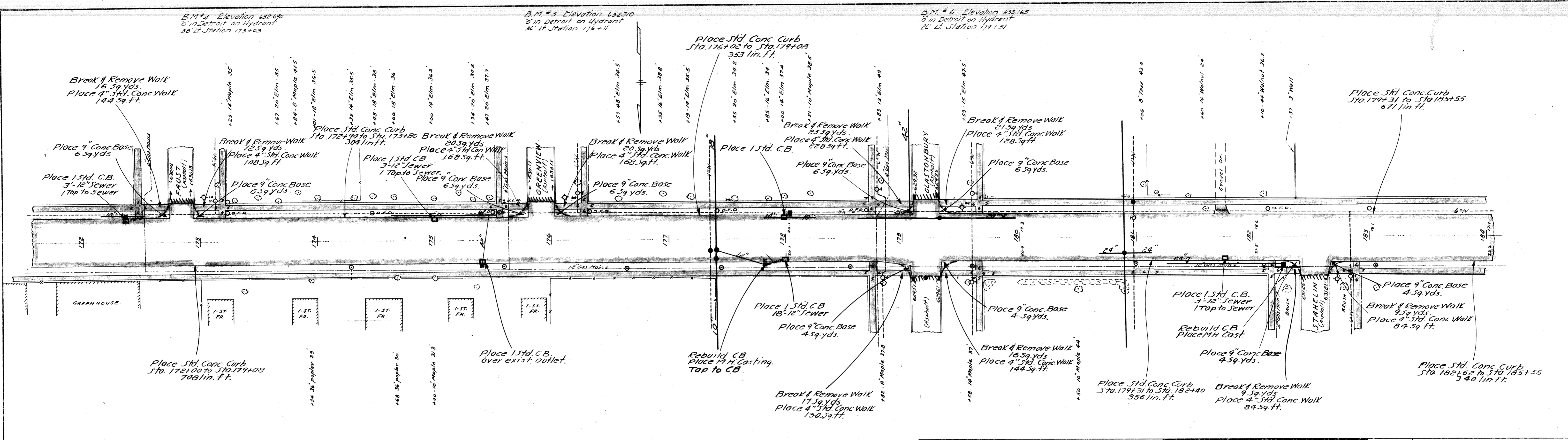

REVISIONS							
NO.	ITEM	BY	DATE	NO.	ITEM	BY	DATE

BOARD OF WAYNE COUNTY ROAD COMMISSIONERS
DETROIT, MICHIGAN
CHAIRMAN [Signature] VICE CHAIRMAN [Signature]
COMMISSIONER [Signature]

SCALE 1" = 40'
DATE 5-19-50
TRANSIT BOOK 7-4-7
LEVEL BOOK L-4-B
DRAWN BY Sheehan
CORRECT
APPROVED [Signature]
FIVE MILE ROAD
Reg. Prof. Eng. [Signature]
County Highway Engineer [Signature]

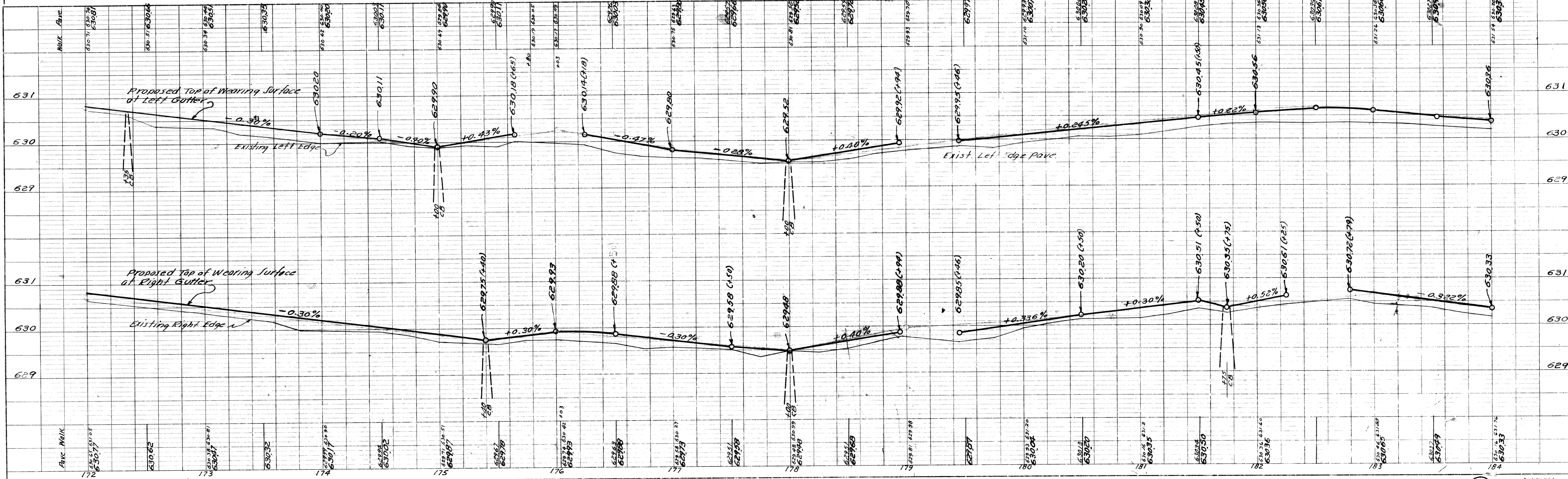

DATE: 8-12-46
 BY: [Signature]
 CHECKED: [Signature]
 PLAN NO. 7-4-7

DATE: 8-12-46
 BY: [Signature]
 CHECKED: [Signature]
 PROFILE NO. 7-4-7

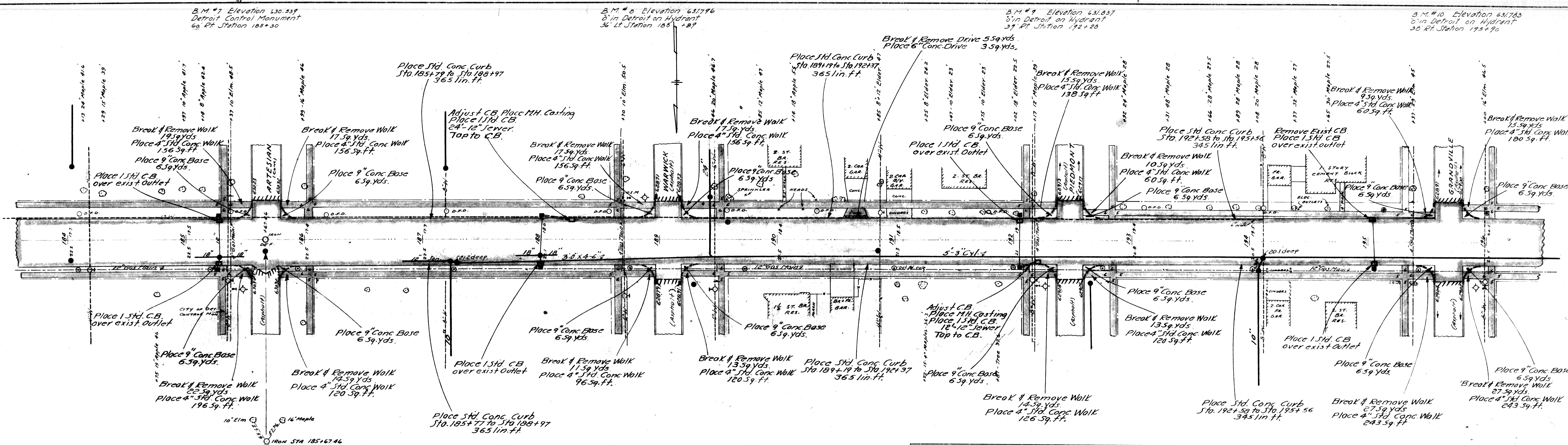

REVISIONS					
NO.	ITEM	BY	DATE	NO.	ITEM

BOARD OF WAYNE COUNTY ROAD COMMISSIONERS
 DETROIT, MICHIGAN

CHAIRMAN: [Signature]
 VICE CHAIRMAN: [Signature]
 COMMISSIONER: [Signature]

SCALE: 1"=40'
 DATE: 5-19-50
 TRANSIT BOOK: 7-4-7
 LEVEL BOOK: L-4-B

DRAWN BY: Sheehan
 CHECKED BY: [Signature]
 APPROVED: [Signature]

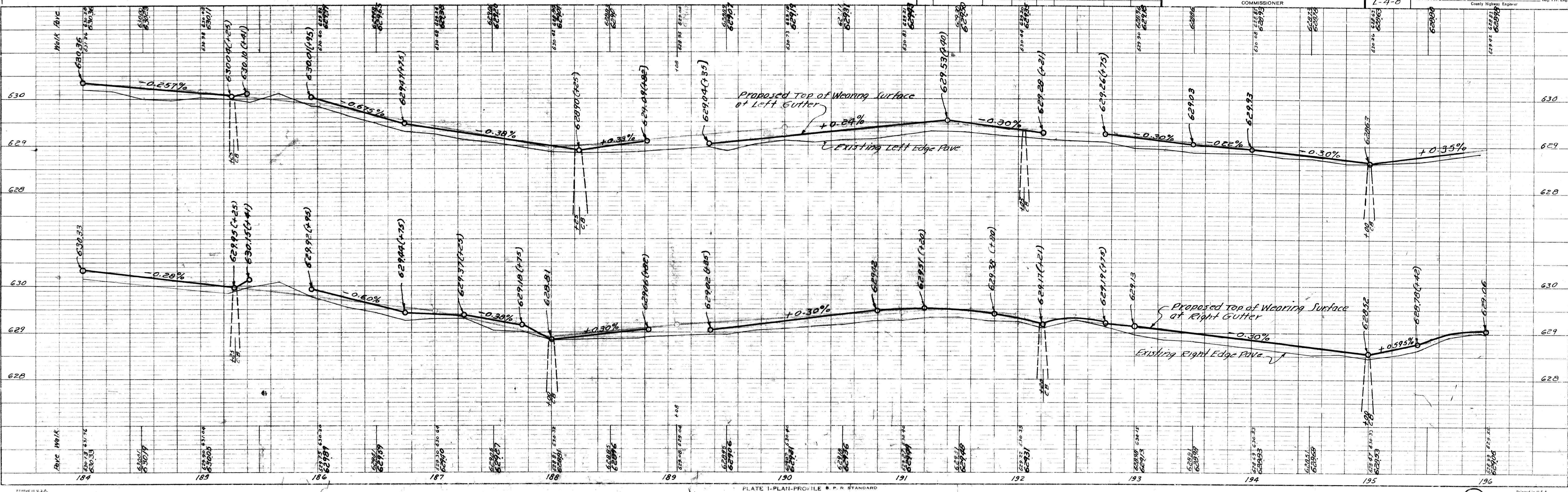

DATE: 5-19-50
 BY: K. J. GREGG
 SURVEYED: 5-19-50
 NOTE BOOK: 7-4-7
 ALIGNMENT CHECKED: [initials]
 BT. OF WAY CHECKED: [initials]

DATE: 5-19-50
 BY: K. J. GREGG
 SURVEYED: 5-19-50
 NOTE BOOK: 7-4-7
 GRADES CHECKED: [initials]
 B.M.'S NOTED: [initials]
 STRUCTURE NOTATIONS CHECKED: [initials]

B.M. #11 Elevation 432.463
 8" in Detroit on Hydrant
 30 ft Station 198+62

B.M. #12 Elevation 632.084
 8" in Detroit on Hydrant
 42 ft Station 202+05

B.M. #13 Elevation 629.429
 Detroit Control Monument
 37 ft Station 205+10

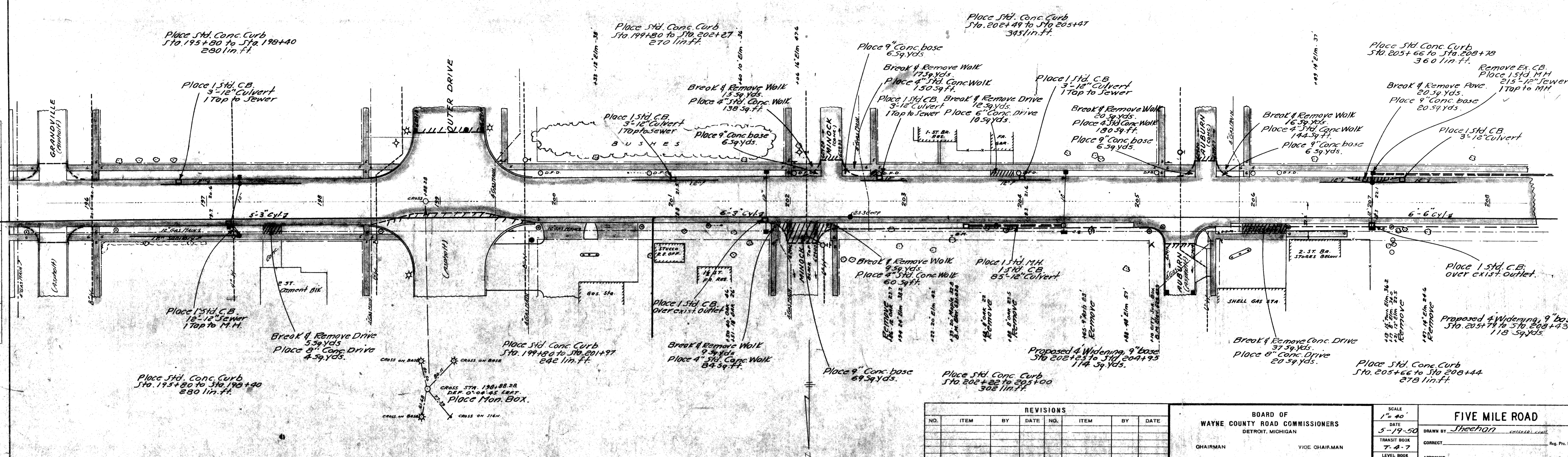

REVISIONS					
NO.	ITEM	BY	DATE	NO.	DATE

BOARD OF WAYNE COUNTY ROAD COMMISSIONERS
 DETROIT, MICHIGAN
 CHAIRMAN: [blank] VICE CHAIRMAN: [blank]
 COMMISSIONER: [blank]

SCALE: 1" = 40'
 DATE: 5-19-50
 DRAWN BY: Sheehan
 CORRECT: [blank]
 APPROVED: [blank]
FIVE MILE ROAD
 County Highway Engineer

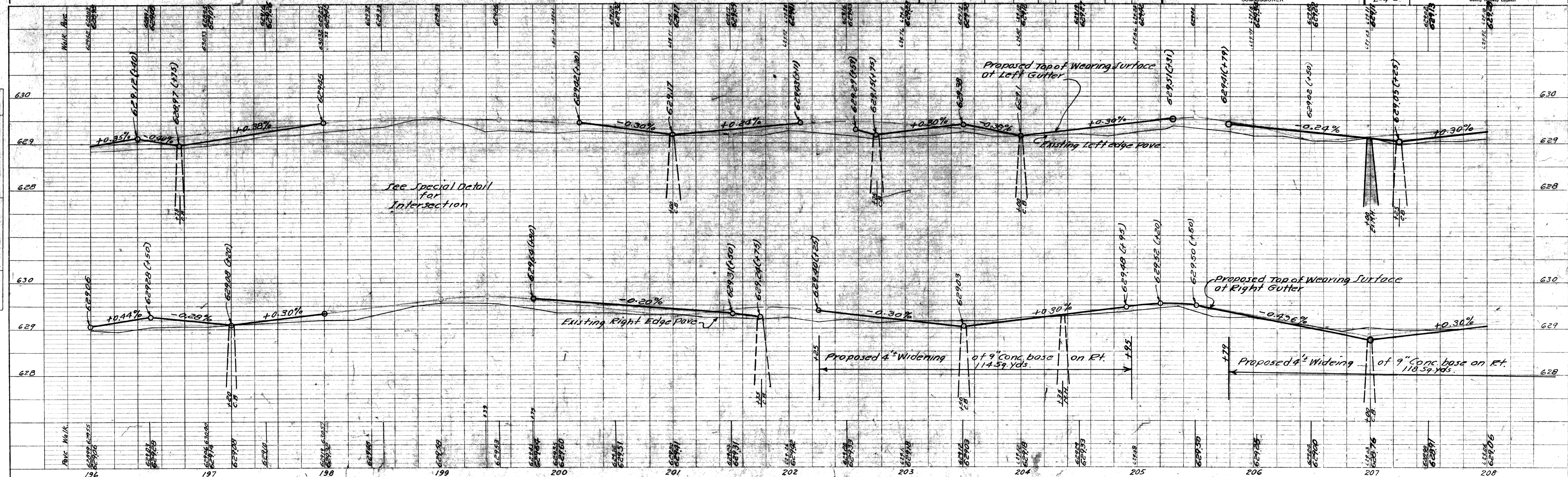

DATE	BY
8-13-50	J. W. M. T.
9-13-54	G. G. G.
SURVEYED	
ALIGNED CHECKED	
RT. OF WAY CHECKED	
PLAN	
NOTE BOOK	
NO. 7-4-7	

DATE	BY
8-13-50	J. W. M. T.
9-13-54	G. G. G.
SURVEYED	
ALIGNED CHECKED	
RT. OF WAY CHECKED	
PROFILE	
NOTE BOOK	
NO. 7-4-7	

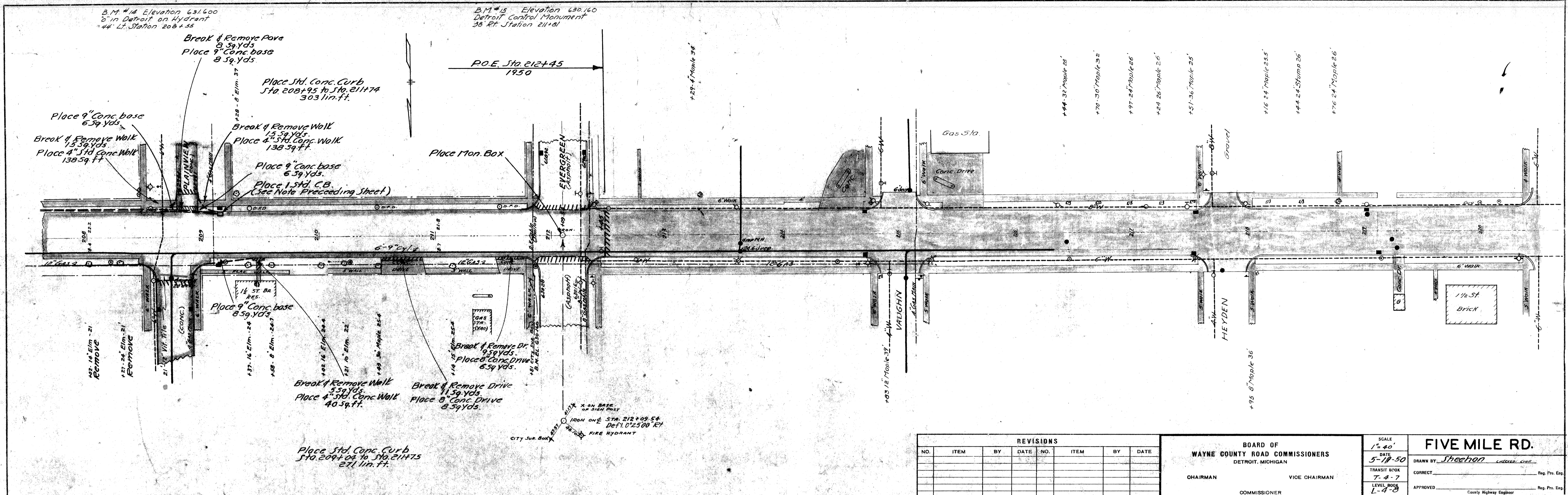

REVISIONS							
NO.	ITEM	BY	DATE	NO.	ITEM	BY	DATE

BOARD OF WAYNE COUNTY ROAD COMMISSIONERS DETROIT, MICHIGAN		SCALE 1"=40'	FIVE MILE RD. DRAWN BY <i>Sheehan</i>
		DATE 5-18-50	
CHAIRMAN		VICE CHAIRMAN	CORRECT
COMMISSIONER		APPROVED	County Highway Engineer

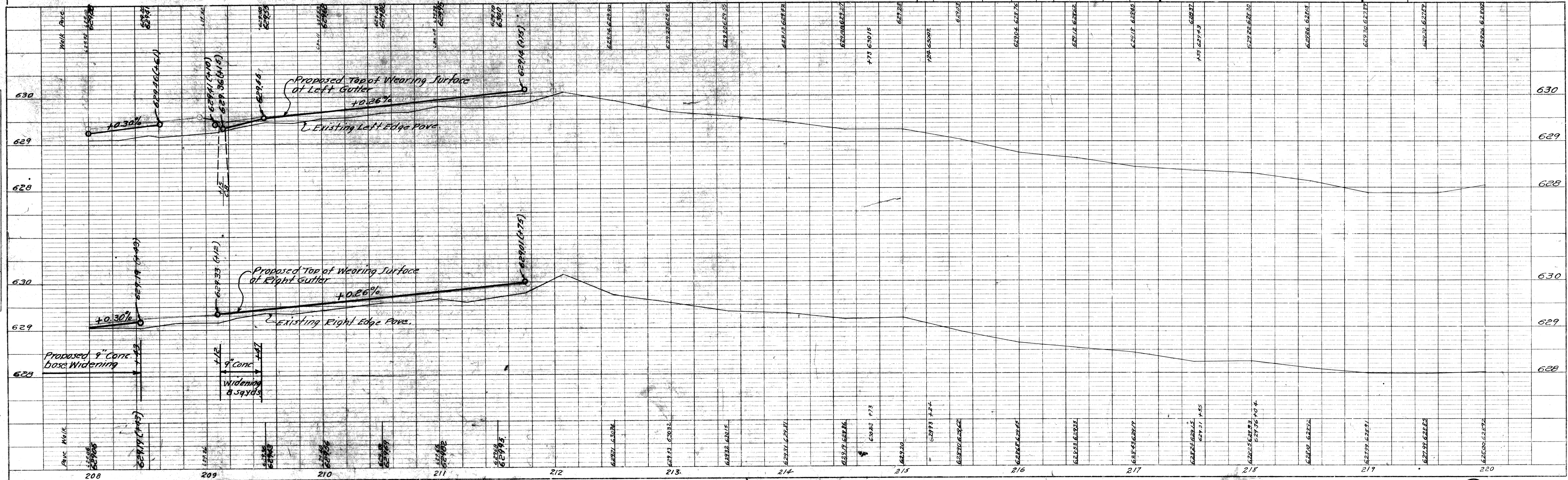

B.M. #11 Elev. 632.463
 0' in Detroit on Hydrant
 50' Lt. Station 198+62

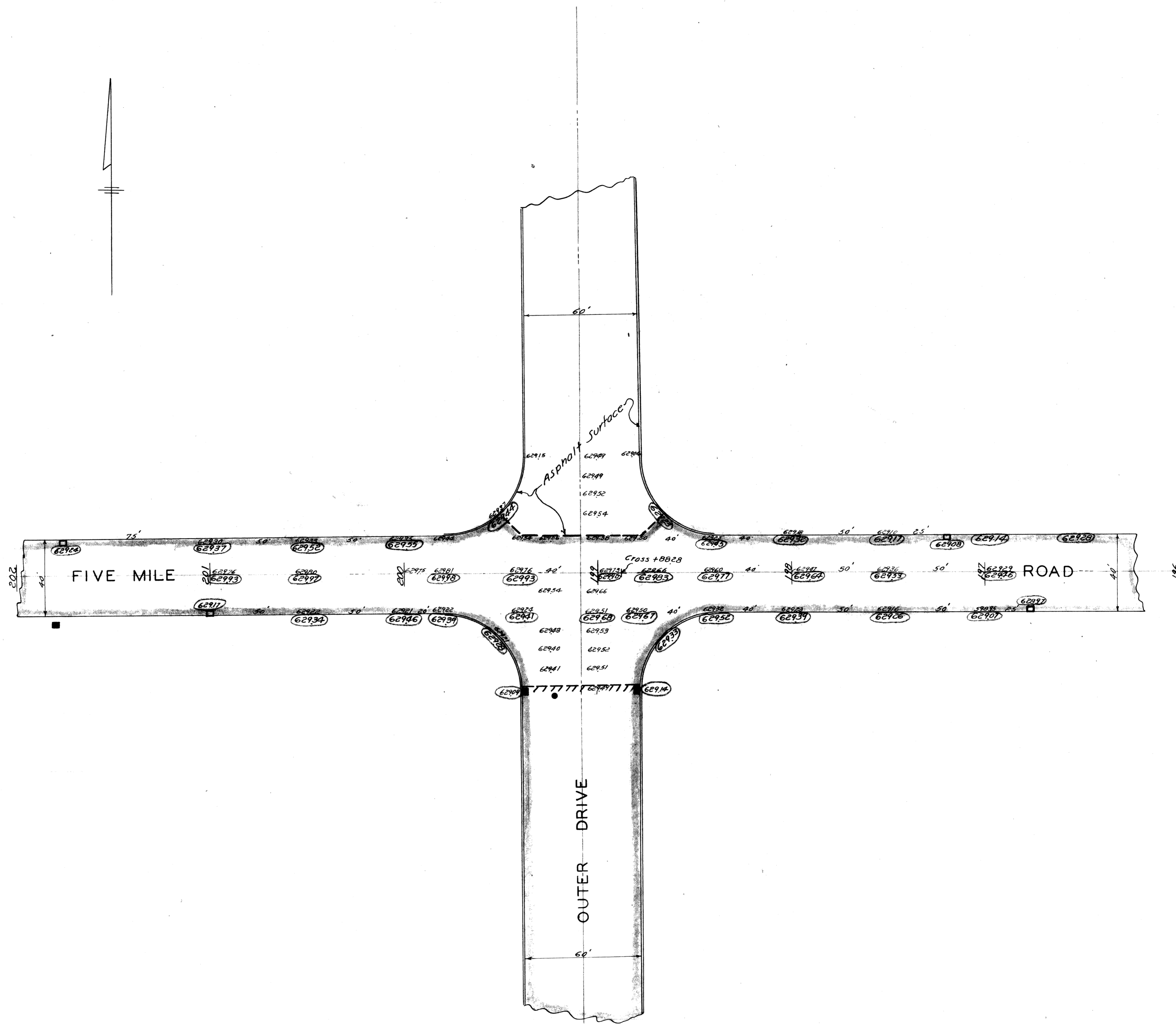

Proposed Top of Wearing Surface Marked thus (62840)

REVISIONS							
NO.	ITEM	BY	DATE	NO.	ITEM	BY	DATE

BOARD OF
 WAYNE COUNTY ROAD COMMISSIONERS
 DETROIT 26, MICHIGAN

CHAIRMAN _____ VICE-CHAIRMAN _____
 COMMISSIONER _____

SCALE
 1" = 30'

DATE
 3-27-50

TRANSIT BOOK _____
 LEVEL BOOK _____

DRAWN BY M.T.S. CHECKED BY _____
 CORRECTED _____ Engineer of Highway Design Reg. Pro. Eng.
 APPROVED _____ Engineer of Highways Reg. Pro. Eng.
 APPROVED _____ County Highway Engineer Reg. Pro. Eng.

FILE A-3-2 SHEET NO. 8

E TRANSVERSE EXPANSION JOINT

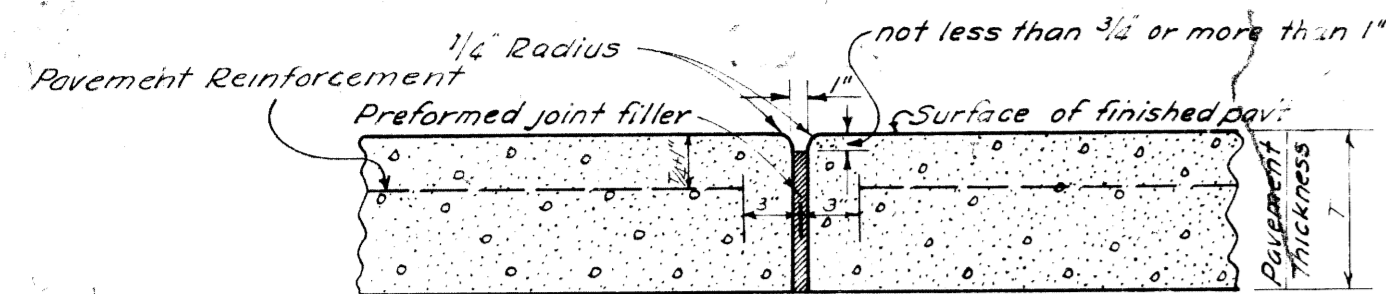

Expansion joint filler shall be preformed cork or fiber filler, conforming to type I, II, or III of A. S. T. M. specification D-544-41 or the latest revision thereof.

The preformed filler material shall be placed not less than 3/4" and not more than 1" below the finished surface of the pavement. Additional joint filler will be poured by the Maintenance Division of the Board of Wayne County Road Commissioners.

Transverse expansion joints shall be placed at 100' intervals unless otherwise directed.

W TRANSVERSE WEAKENED PLANE JOINT

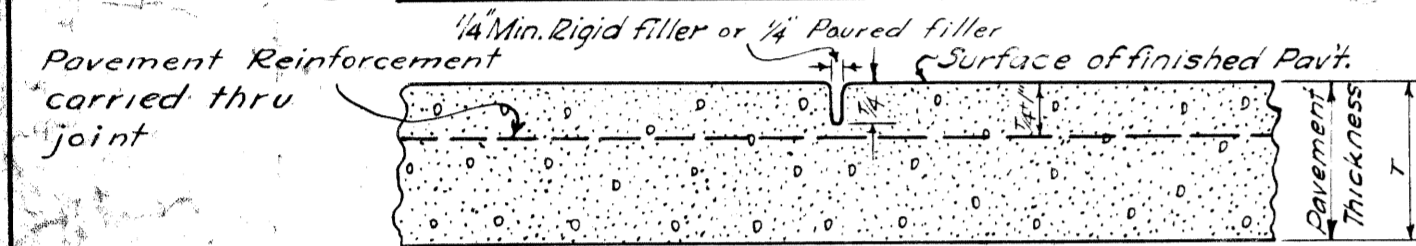

Joint shall be formed immediately following the finishing machine operations and shall not vary more than 1/4" from designated alignment.

The groove shall be filled with bituminous preformed filler conforming to the requirements of A. A. S. H. O. specifications M-33.

Transverse weakened plane joints shall be placed at 20 foot intervals between transverse expansion joints, unless otherwise directed.

Transverse weakened plane joints shall be edged as directed by the engineer.

REV 5-27-47

B LONGITUDINAL BULKHEAD JOINT

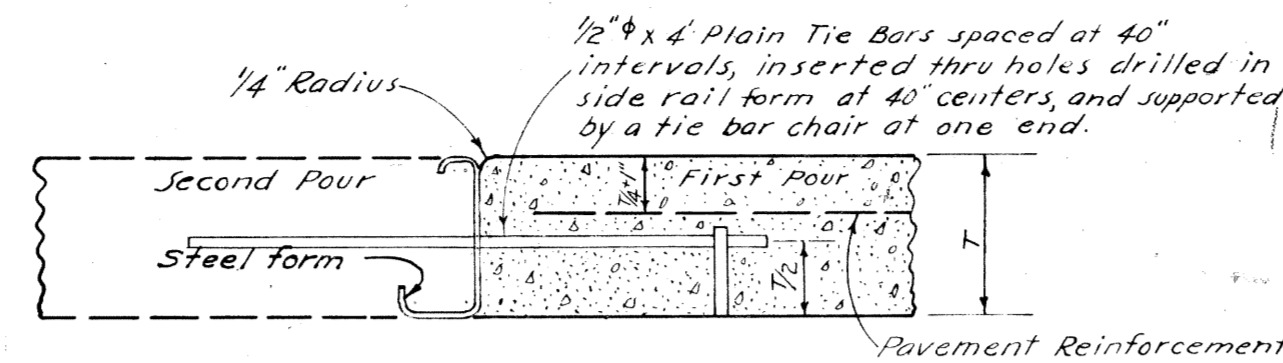

This joint shall be used at all longitudinal bulkhead construction joints. This will be considered a part of pavement construction.

After the concrete has hardened sufficiently the form shall be removed and the edges rounded to 1/4" radius.

W LONGITUDINAL WEAKENED PLANE JOINT

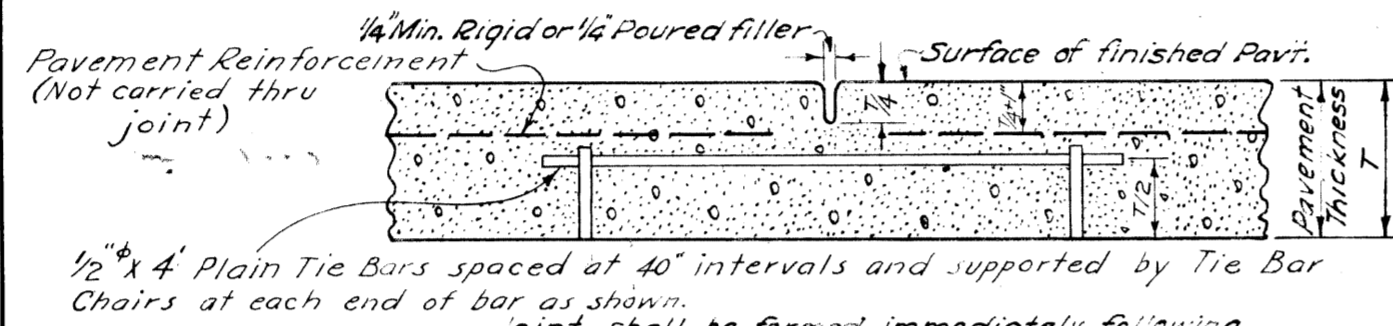

Joint shall be formed immediately following the finishing machine operations and shall not vary more than 1/4" from designated alignment.

The groove shall be filled with bituminous preformed filler conforming to the requirements of A. A. S. H. O. specifications M-33, Asphaltic Cement 50-A (85-100 penetration) or Tar T-12. The joint filler shall be poured or placed so as to completely fill and seal the joint without overflowing the pavement.

Joints shall be edged as directed by the engineer.

REV 5-27-47

CONCRETE CURB (STRAIGHT)

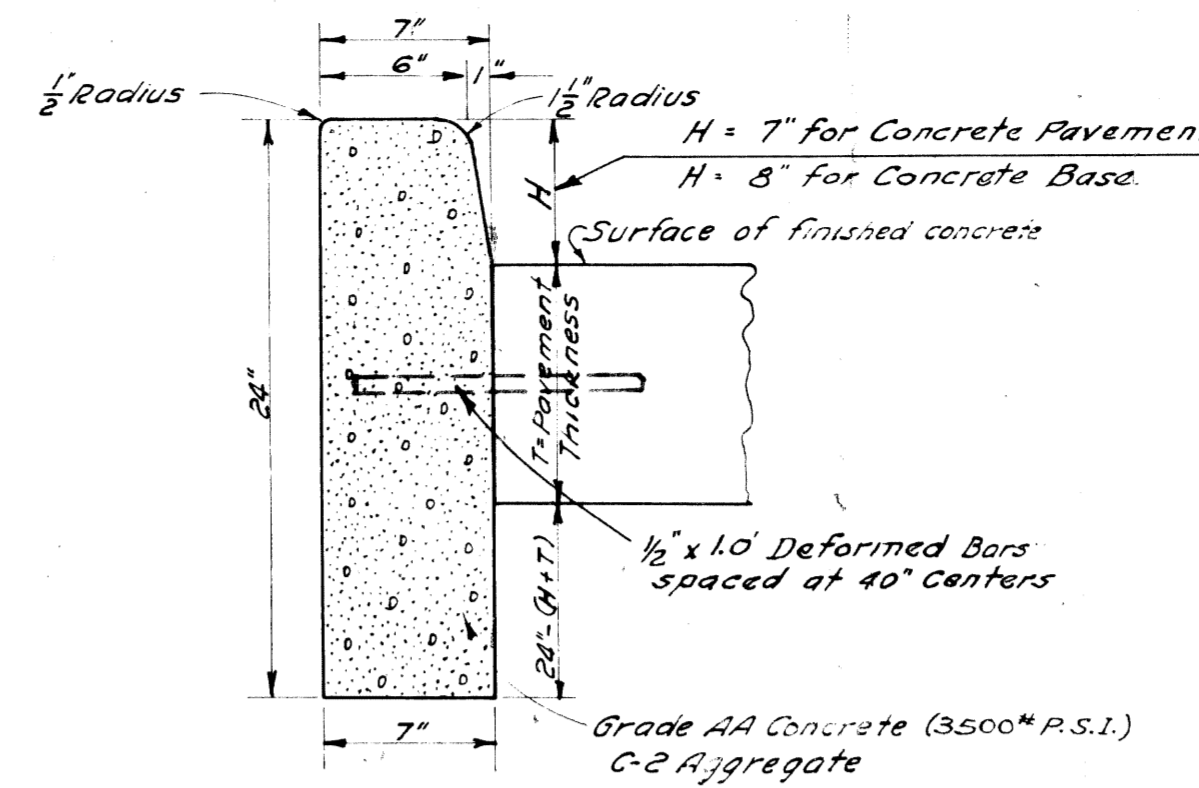

Expansion joints, consisting of 1" preformed joint filler conforming to Types I, II or III of A. S. T. M. specifications D-544-41 or latest revision thereof, shall be placed in line with all expansion joints in the abutting pavement.

In addition to the expansion joints, 1/8" steel divider plates shall be used to form joints in line with all transverse joints in the abutting pavement.

Where no expansion joints are to be placed in the abutting pavement, curb expansion joints shall be placed at 75' intervals and 1/8" cut joints shall be placed 25' on each side of the expansion joints.

On short radius curves and at intersections curb shall be constructed in 6' sections and 1/2" preformed joint filler conforming to the requirements of A. A. S. H. O. specifications M-33, placed at each joint.

END AREA = 1.14 Sq. feet
VOLUME = 4.22 Cu. yds per 100'

REV 6-27-47

GRAVEL APPROACH and SHOULDER

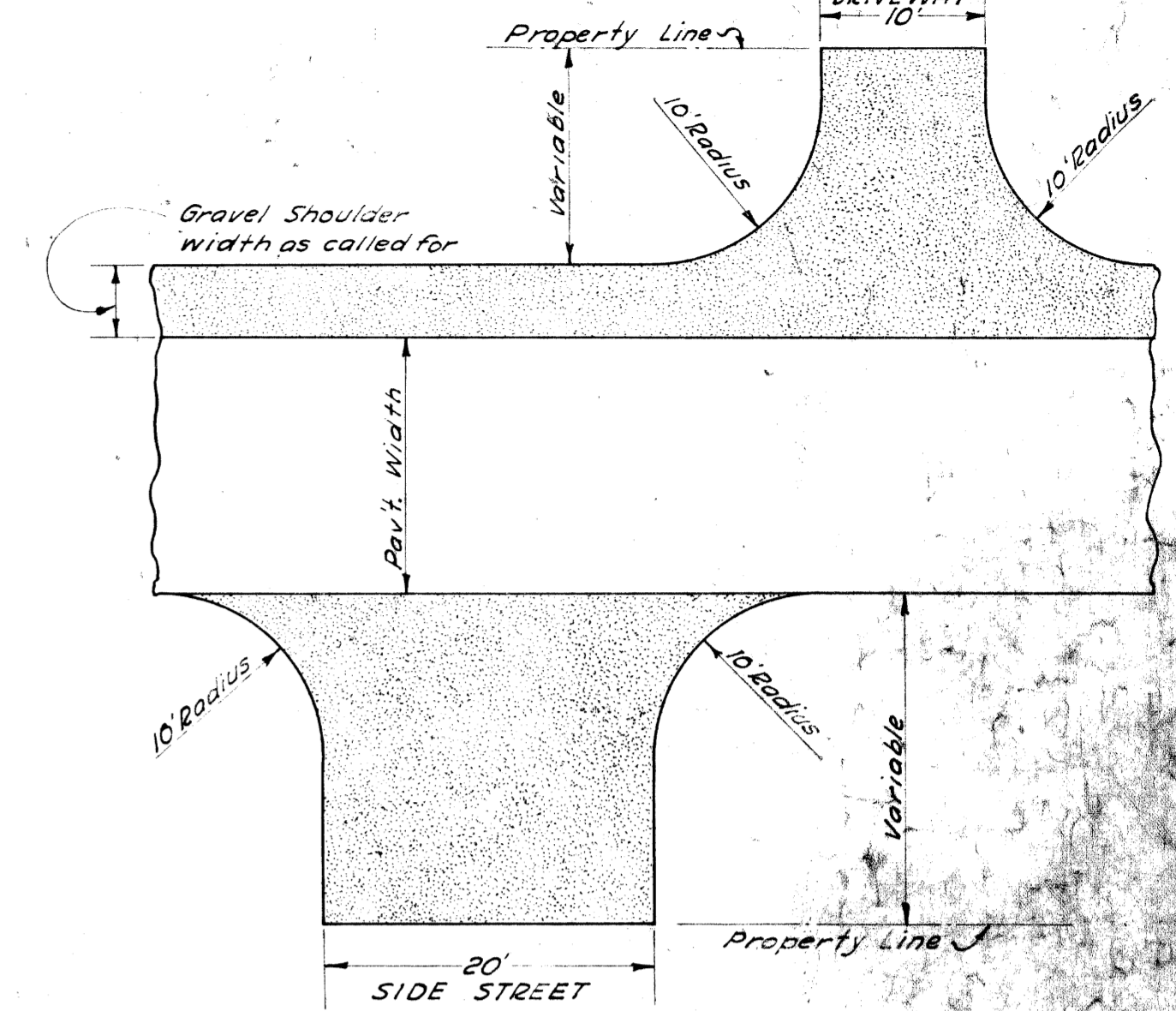

Gravel Approaches and Shoulders shall consist of a single course of gravel 4" thick, unless otherwise directed, placed and compacted on the prepared sub-grade.

The material shall meet the physical requirements for aggregates for surfaces other than concrete pavement (see general specifications Section 84-3) except for limits of silt and clay. Material shall meet the grading requirements for M-1A aggregates, Table M-10 of the general specifications.

Gravel Approaches and Shoulders shall be measured in square yards compacted in place, and will be paid for at the contract unit price per square yard compacted.

CONCRETE SIDEWALK

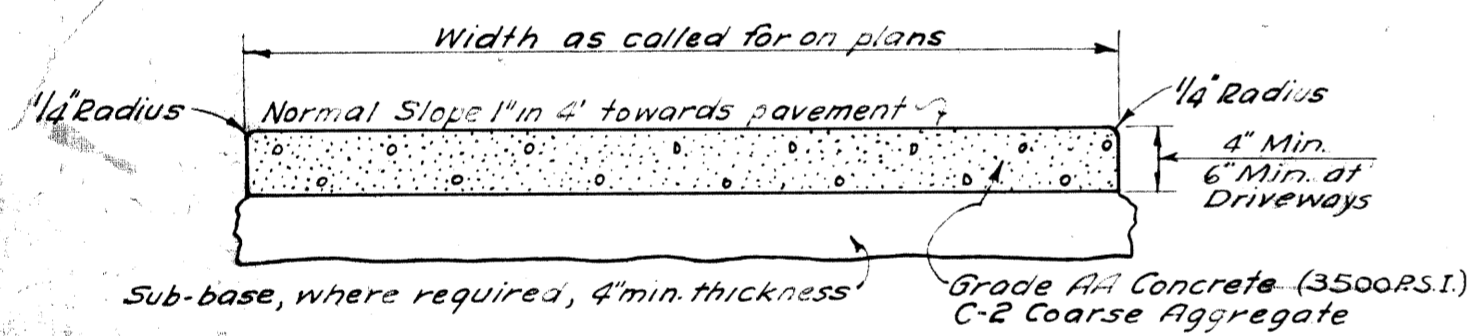

Sidewalk shall be laid in slabs approximately square, provided no slab shall be greater than 7'1/2'; sidewalk shall be scored to a depth of 3/4" at right angles to the forms. Expansion joint material, 1/2" thick, shall be placed at approximate intervals of 48' and between abutting parallel curb and sidewalk or buildings. 1" expansion joint material shall be placed between curb returns and the sidewalk.

Sub-base, where specified shall consist of Grade A Fill material, otherwise suitable fill material from the project shall be used.

Unless otherwise shown on the plans, sub-base will be considered as incidental to construction of concrete sidewalk. Sub-base where ordered by the Engineer and not called for on the plans will be paid for separately.

REV 9-12-49

TRANSVERSE WEAKENED PLANE JOINT FOR CONCRETE BASE COURSE

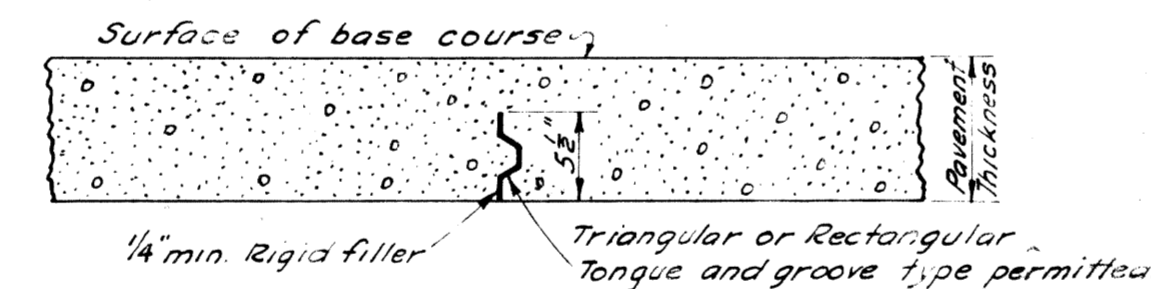

Transverse weakened plane joints in concrete base course shall consist of 1/4" min. bituminous preformed filler conforming to the requirements of A. A. S. H. O. specifications M-33.

Joint material shall be firmly fastened to the sub-grade in a vertical position and held in true alignment by iron pins or other approved methods.

The base course material shall be poured on both sides simultaneously so as to insure true position of joint material.

Joints shall be placed at 25' intervals unless otherwise directed.

ASPHALTIC CONCRETE SURFACE

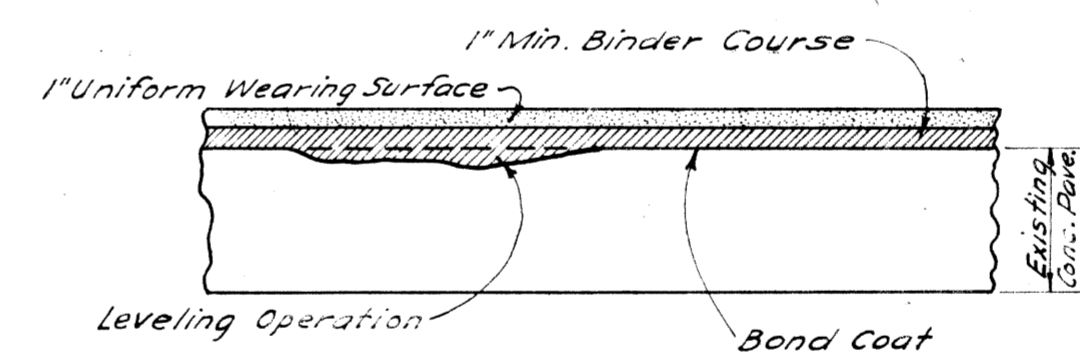

Where Asphaltic Concrete Surfacing is placed on an existing concrete pavement all existing bituminous patches shall be stabilized by heating with mechanized equipment and then rolling in aggregate so as to provide stability. All loose material and dust shall be removed. Depressions in the existing surface shall be brought to uniform contour by using Asphaltic Concrete Binder Mixture before placing the binder course. This will be known as the leveling operation.

Material used for the leveling operation will be paid for at the contract unit price per ton of Asphaltic Concrete Binder Course.

The bond coat shall consist of an application of Emulsified Asphalt Applied at a rate varying from 0.05 to 0.15 gallons per square yard.

HEADER JOINT

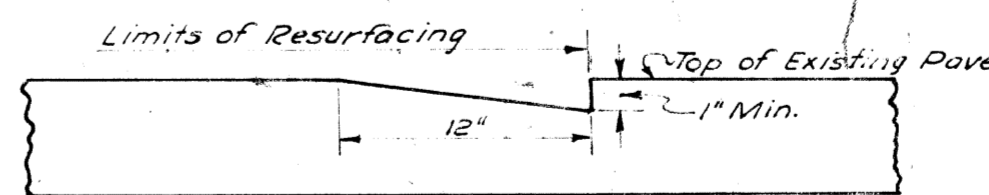

Connections to existing surfaces at the beginning and end of resurfacing sections and at all intersections shall be made by cutting old pavement as shown.

10X PAVEMENT TRANSITION

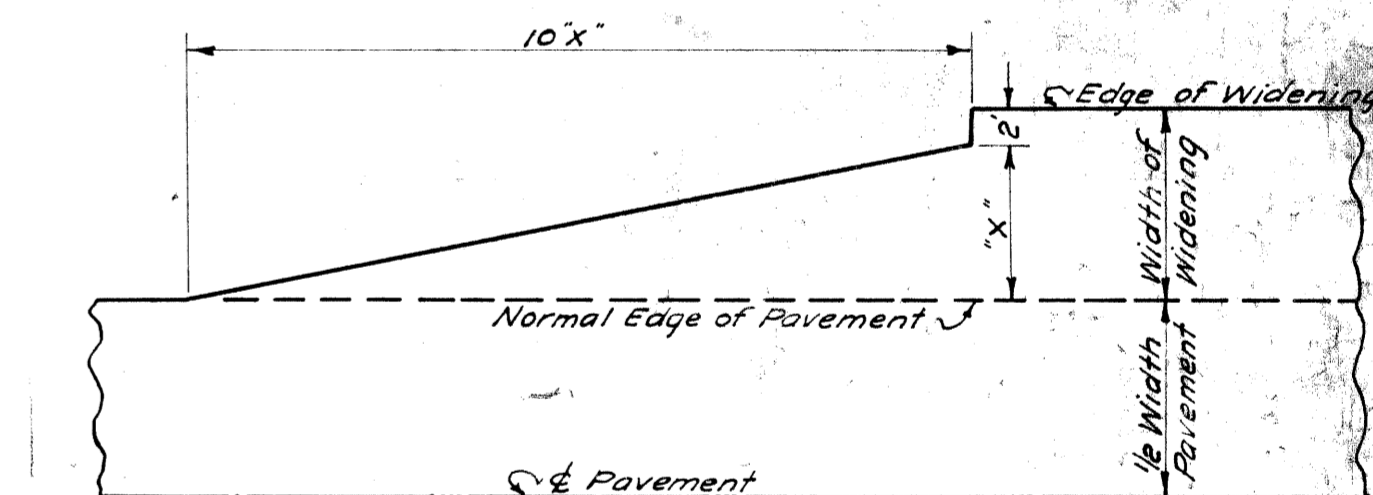

This type transition to be used where new pavement is increased or decreased in width.

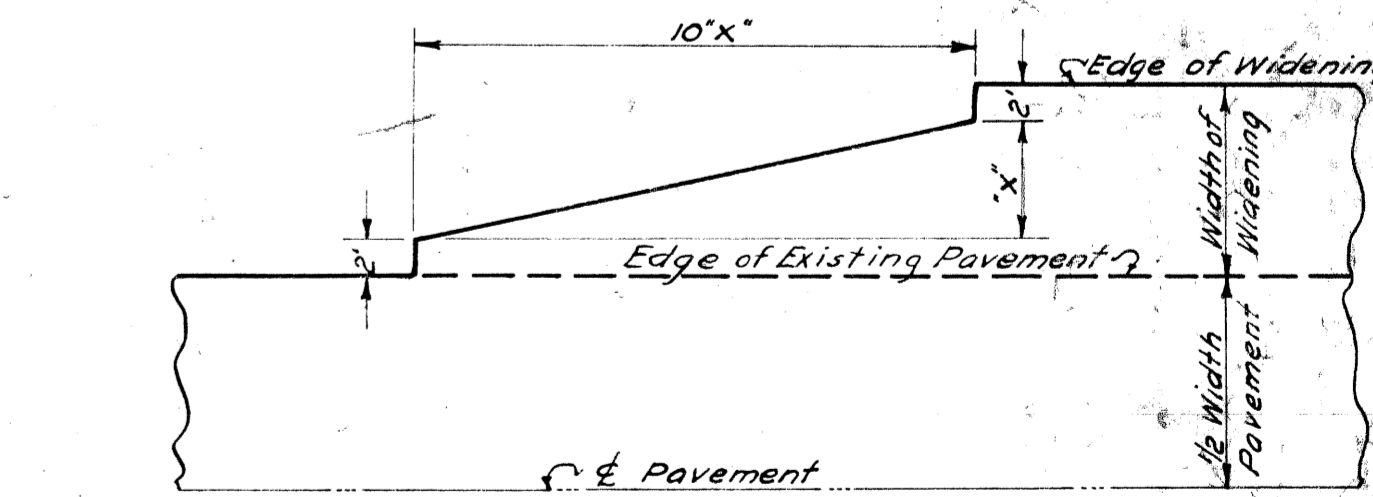

This type of transition to be used where existing pavement is increased or decreased in width.

REVISIONS 4-10-45 - J.G.S. 6-14-45 - H. (Curb) 7-15-46 - M. (Curb) 5-27-47 - Joints 6-27-47 - Spacing	BOARD OF WAYNE COUNTY ROAD COMMISSIONERS DETROIT 26, MICHIGAN	DATE 3-12-45 SCALE 1/2" = 1'-0" DRAWN BY G. J. G. (Curb) CORRECTED BY K. J. G. (Curb) APPROVED
--	---	--