

-NOTES-
 Elevations shown are Wayne County Datum for Davison Avenue Paving.
 To obtain City of Highland Park Elevations, deduct 480.938'.
 To obtain City of Detroit Elevations, deduct 480.30'.
 To obtain G.T.W.R.R. Elevations, deduct 0.364'.

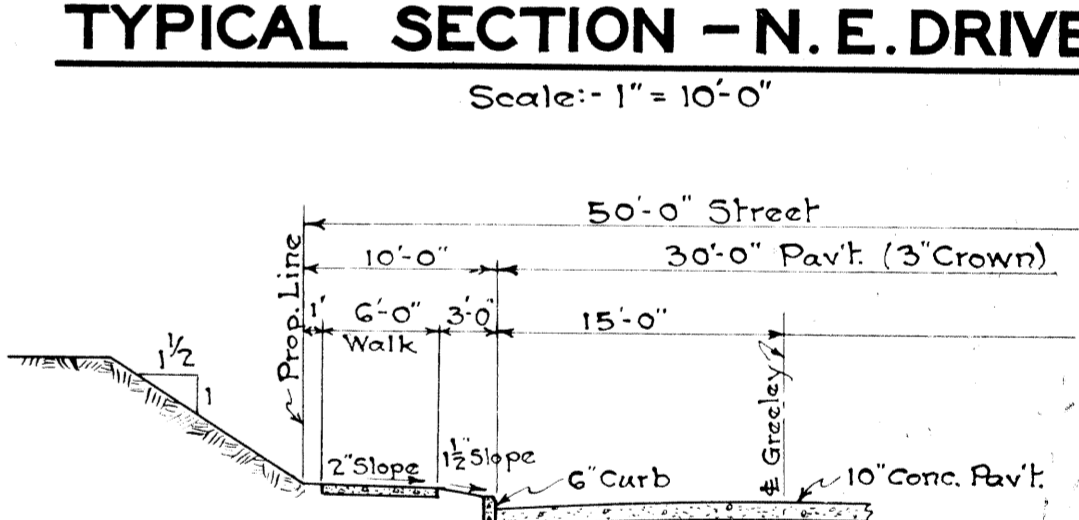

P.W.A. DOCKET NO. MICH. 1120-F

BOARD OF WAYNE COUNTY ROAD COMMISSIONERS
 DETROIT, MICHIGAN
 MICHAEL J. O'BRIEN, CHAIRMAN
 JOHN F. BREINING, VICE-CHAIRMAN
 CHARLES L. WILSON, COMMISSIONER

GENERAL DRAWING
DAVISON AVE - G.T.W.R.R.
 GRADE SEPARATION

Drawn by F.H.C. Tracked by C.R.C. 10-17-38
 Date T-20-38 Scale As Noted Checked by J. M. ... Chief Designer

JOB NO. 546

APPROVED: *W. H. ...* REG. CIVIL ENGR.
 APPROVED: *Leo ...* COUNTY HIGHWAY ENGINEER

ISSUE NO. DATE

SCHEME 'B'

SHEET NO. 1

DATE	
BY	
SURVEYED	
PLOTTED	
ALIGNED CHECKED	
BY	
NO.	

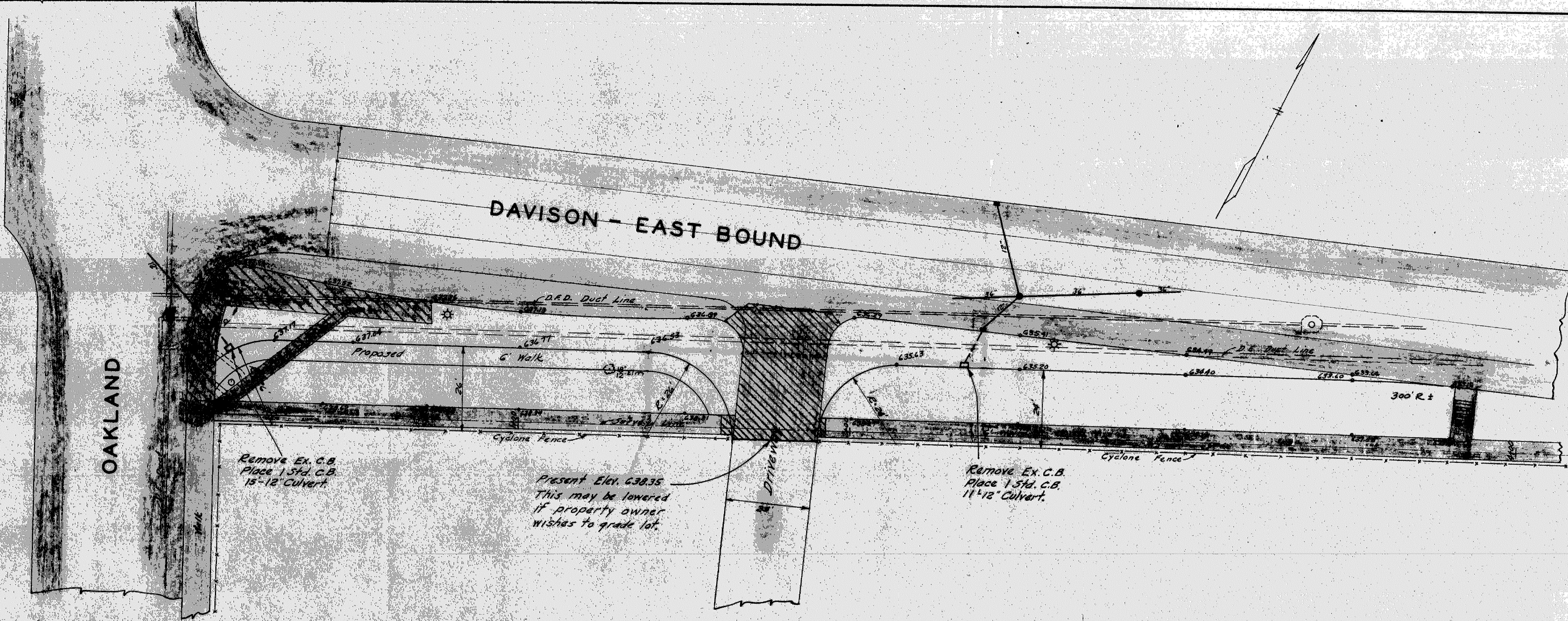

Estimate of Quantities.

Removing Ex. Catch Basins	2 Each.
Removing Ex. Curb	435 Lin. Ft.
Removing Ex. Walk	120 Sq. Yd.
Removing Ex. Conc. Pavement	118 Sq. Yd.
Moving Signal Poles	2 Each
Moving Light Bases	2 Each
Adjusting Water Gate Well Covers	1 Each
Adjusting Fire Dept. Manhole	1 Each
Removing & Relaying Sod	517 Sq. Yd.
Earth Excavation	434 Cu. Yd.
Std. Catch Basins	2 Each
12" Culvert Pipe	26 Lin. Ft.
10' Plain Concrete Pavement	565 Sq. Yd.
Straight Curb	398 Lin. Ft.
4" Concrete Walk	1038 Sq. Ft.
Final Cleanup	4 Stations.
Straw Heating Materials	3 Ton.
	565 Sq. Yd.

(All Areas run by Planimeter #26465).

REVISIONS					
NO.	ITEM	BY	DATE	NO.	DATE

BOARD OF WAYNE COUNTY ROAD COMMISSIONERS DETROIT, MICHIGAN		SCALE 1" = 20'	DAVISON
CHAIRMAN	VICE CHAIRMAN	DATE 11-2-44	
COMMISSIONER		TRANSIT BOOK T-77-2	DRAWN BY M.
		LEVEL BOOK T-77-2	CORRECT
			APPROVED
			County Highway Engineer

DATE	
BY	
PROFILE	
PLOTTED	
ALIGNED CHECKED	
BY	
NO.	

