

E. OUTER DRIVE - VAN DYKE TO SIX MILE

WAYNE COUNTY DEPARTMENT OF PUBLIC SERVICES DETROIT, MICHIGAN EDWARD H. McNAMARA COUNTY EXECUTIVE CITY OF DETROIT ROAD RESURFACING PROJECT

THE IMPROVEMENTS COVERED BY THESE PLANS SHALL BE DONE IN ACCORDANCE WITH THE MICHIGAN DEPARTMENT OF TRANSPORTATION 1984 STANDARD SPECIFICATIONS FOR CONSTRUCTION AND SUPPLEMENTAL SPECIFICATIONS.

INDEX TO SHEETS

- 1 TITLE SHEET
- 2-2A TYPICAL CROSS SECTIONS
- 3-7 PLAN
- 8-11 LANE LINE MARKINGS
- 12 QUANTITY SHEET

TRAFFIC DATA

	1990	2010
A.D.T. (Two Way)	16,000	17,000
D.H.V. (One Way)	900	900
DESIGN SPEED	40 M.P.H.	



COUNTY STANDARD PLANS

- CD1 - 89
- CD2 - 89
- CR1 - 89
- CS1 - 89
- CM2 - 89

M.D.O.T. STANDARD PLANS

- II - 29E
- VI - 125G

**EAST OUTER DRIVE
VAN DYKE (M-53)
TO SIX MILE
W.O.# 46215
1990 PROJECT**

APPROVED *Alan Richardson*
DIRECTOR OF ENGINEERING - COUNTY HIGHWAY ENGINEER

APPROVED *W.L. Conner*
DIVISION DESIGN ENGINEER - ENGINEERING DIVISION

PREPARED UNDER SUPERVISION OF
David ...
DIVISION CONSTRUCTION ENGINEER

WAYNE COUNTY
"AS CONSTRUCTED"
DJA
DATE 11/9/90

48 HOURS
BEFORE YOU DIG
CALL MISS DIG
800-482-7171
(TOLL FREE)

REG. NO. 26628
FILE F-8-1 SHEET NO. 1

TYPICAL CROSS-SECTIONS

UTILITY DIRECTORY

Michigan Consolidated Gas Co.
500 Griswold Avenue
Detroit, MI 48226

Attn: Mr. Louis Miruzzi

Michigan Bell Telephone Co.
444 Michigan Avenue
Detroit, MI 48226

Attn: Mr. Keith Regan

Detroit Public Lighting Department
9449 Grinnel
Detroit, MI 48213

Attn: Mr. Ed Tallant

City of Detroit
Department of Engineering
900 Cadillac Square
Detroit, MI 48226

Attn: Mr. Clyde Hopkins

Detroit Edison Co.
2000 Second Avenue
Room 430 S.B.
Detroit, MI 48226

Attn: Mr. R.R. Lieberman

Detroit Water and Sewage Department
Water Board Building
735 Randolph
Detroit, MI 48226

Attn: Mr. George Haberer

City of Detroit
Department of Transportation
1301 E. Warren
Detroit, MI 48207

Attn: Mr. Samuel Lawson

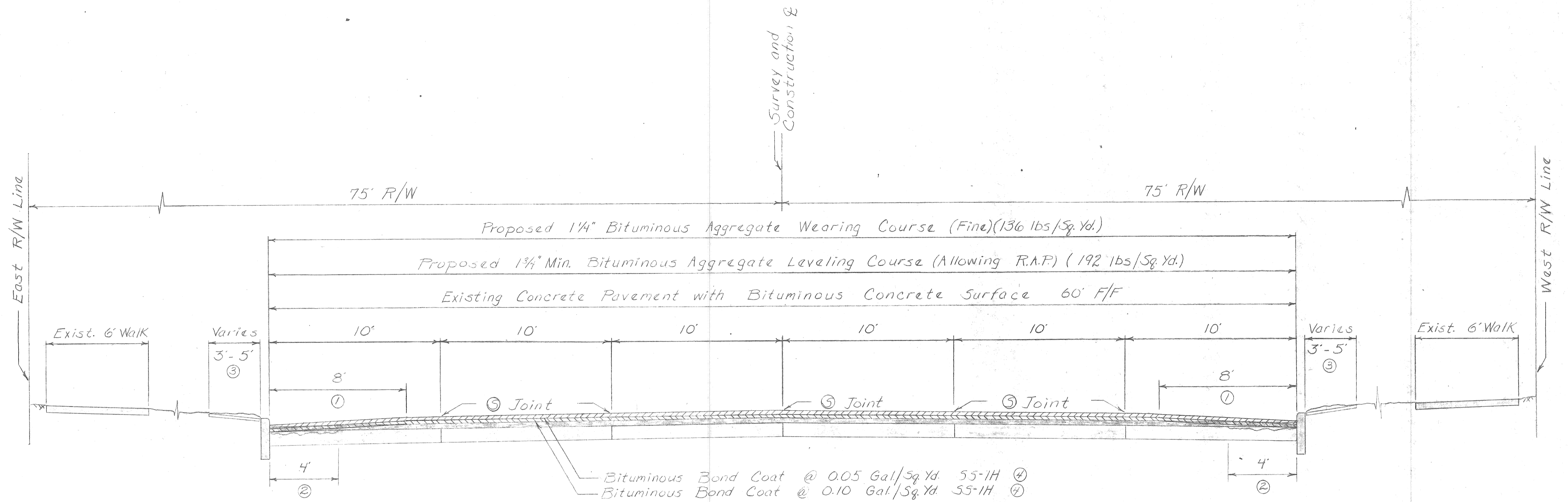

STA. 6+43 TO STA. 33+30

GENERAL NOTES

The location of all Utilities shown on these plans is taken from the best available data. The Wayne County Department of Public Services will not be responsible for any omissions or variation from the location shown. The Contractor shall contact the Utility Owners regarding their facilities including Service Connections prior to starting the work. Utility Service Connections are not shown on the plans and are not the responsibility of Wayne County Department of Public Services.

Existing Castings damaged by the Contractor shall be replaced by the Contractor at his own expense.

Street or Road Name signs and Stop signs, in the way of Construction, will be removed and reset immediately in a temporary location as directed by the Engineer. Street name signs shall be finally set by the Contractor in a location designated by the Engineer, upon completion of fine grading in the section involved. This work shall be included in Class A Sodding.

NOTES: VAN DYKE TO SEVEN MILE

- ① Remove Bituminous Surface (Milling Method) (0"-3" at gutter), or as directed by the Engineer. For details see Sed. CRI-89.
- ② Remove deteriorated concrete by compressed air or other approved method, and fill voids with bituminous material (as directed by the Engineer), paid for as Bituminous Aggregate Wedge Course, 68 Tons (Est.) have been provided. Removal of deteriorated concrete is included in "Removing Bituminous Surface (Milling Method)".
- ③ 1,683 Sq Yds. of Class A Sodding have been provided for placement as directed by the Engineer. Removal of Over-burden is included in "Class A Sodding". The quantity of over-burden is estimated to be 281 Cu. Yds. Top of sod to be flush with top of curb or as directed by the Engineer.
- ④ Bituminous Bond Coat 55-1H will not be paid for separately but shall be included in the bituminous aggregate course being applied.

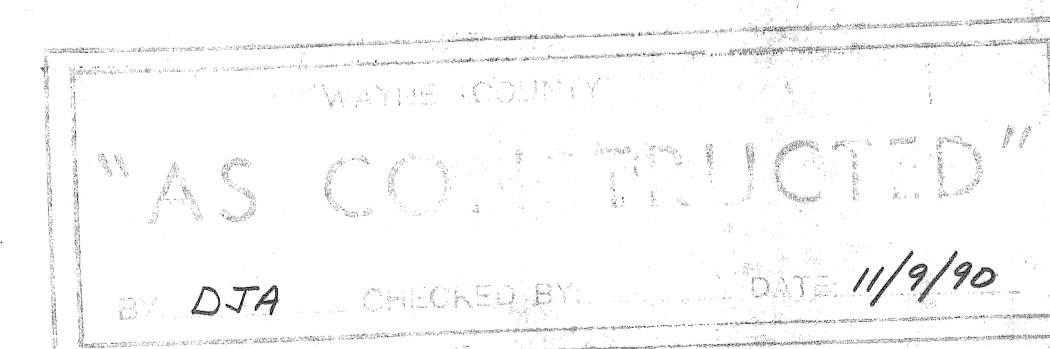

REVISIONS	DRAWN BY	CHECKED BY	DATE	CORRECT
	C. Myslinski	S.V.	4-29-89	Eddie A. Mastrosuzzi
				APPROVED
				DIVISION DESIGN ENGINEER

WAYNE COUNTY OFFICE OF PUBLIC SERVICES
ENGINEERING DIVISION

OUTER DRIVE
VAN DYKE TO SIX MILE

COUNTY PROJECT	COUNTY JOB
46215	
ISSUE NO. 1	SHEET NO. 2
DATE 4-11-90	

F-8-1

TYPICAL CROSS-SECTIONS

SCALE 1" = 5'

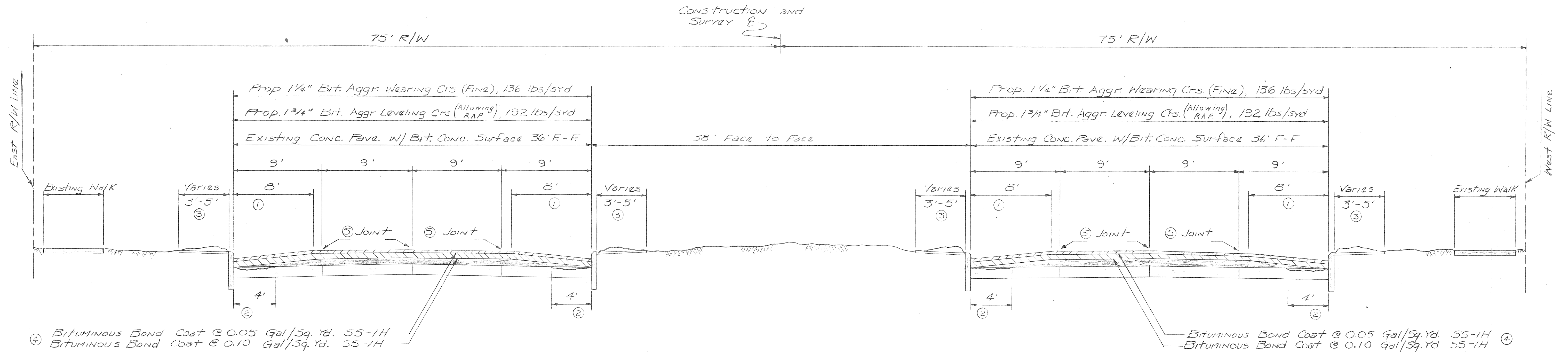

STA. 45+40 TO STA. 97+43

NOTES: SEVEN MILE TO SIX MILE

- ① Remove Bituminous Surface (Milling Method) (0"-3" at gutter), or as directed by the Engineer. For details see Std. CR1-87
- ② Remove deteriorated concrete by compressed air or other approved method, and fill voids with bituminous material (as directed by the Engineer), paid for as "Bituminous Aggregate Wedge Course"; 299 Tons (Est.) have been provided. Removal of deteriorated concrete is included in "Removing Bituminous Surface (Milling Method)".
- ③ 9,180 Sq. Yds. of Class A Sodding have been provided for placement as directed by the Engineer. Removal of Overburden is included in "Class A Sodding". The quantity of overburden is estimated to be 1,530 Cu. Yds.. Top of sod to be flush with top of curb or as directed by the Engineer.
- ④ Bituminous Bond Coat SS-1H will not be paid for separately but shall be included in the bituminous aggregate course being applied.

"AS CONSTRUCTED"

DJT 11/9/90

REVISIONS	DRAWN BY E.M. Bizek	CHECKED BY S.V.	DATE 4-29-89	CORRECT <i>Edna A. Martignetti</i> ASST. DIVISION ENGINEER
	CORRECT <i>Michael Lema</i> SQUAD LEADER			APPROVED <i>[Signature]</i> DIVISION ENGINEER

WAYNE COUNTY OFFICE OF PUBLIC SERVICES
ENGINEERING DIVISION

**OUTER DRIVE
VAN DYKE TO SIX MILE**

COUNTY PROJECT 46215	COUNTY JOB
ISSUE NO. <u>1</u>	SHEET NO. 2A
DATE <u>4-10-88</u>	

B.M., Elev. 100.00
Traffic Control Box, "X" N.E. Cor.
Conc. Base @ Sta. 0+65
60'R. 12' to E OUTER DR.

T.P. #2, Elev. 7.97
Hyd. Arrow @ Sta. 9+10 Rt.

P.O.B.
STA. 0+39

Sta. 0+39 to Sta. 6+43:
Lane Line Marking Only

BEGIN RESURFACING
STA. 6+43

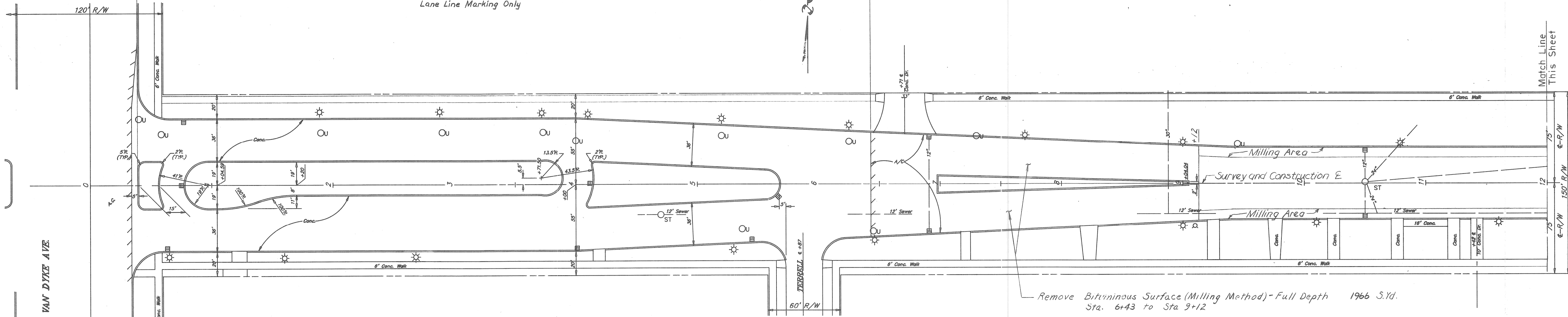

Remove Bituminous Surface (Milling Method) - Full Depth 1966 S.Yd.
Sta. 6+43 to Sta 9+12

QUANTITIES (This Sheet, For Information Only)

Removing Bituminous Surface (Milling Method)	2716	Sq. Yds.
Bituminous Aggregate Leveling Course (Allowing R.A.P.)	1311	Tons
Bituminous Aggregate Wearing Course (Fine)	923	Tons
Adjusting Structures	13	Each
Sawed Longitudinal Plane of Weakness Joint in Bit. Pav't.	8185	Lin. Ft.

PLAN
Scale: 1" = 40'

Remove Bituminous Surface
for Butt Joint, 10' Wide (Milling Method)
(Included with "Preparing Ex. Pav't.")

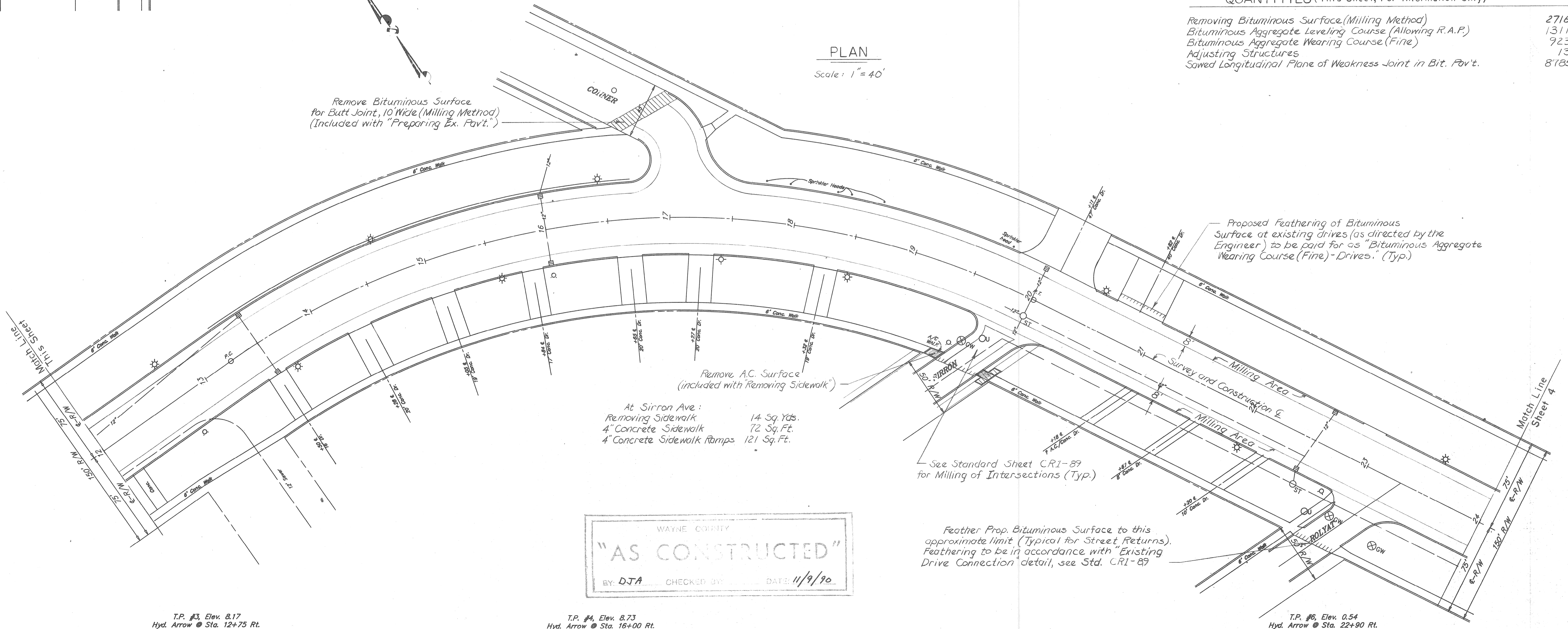

Remove A.C. Surface
(included with Removing Sidewalk)

At Sirron Ave:
Removing Sidewalk 14 Sq. Yds.
4" Concrete Sidewalk 72 Sq. Ft.
4" Concrete Sidewalk Ramps 121 Sq. Ft.

Proposed feathering of Bituminous
Surface at existing drives (as directed by the
Engineer) to be paid for as "Bituminous Aggregate
Wearing Course (Fine) - Drives." (Typ.)

See Standard Sheet CR1-89
for Milling of Intersections (Typ.)

Feather Prop. Bituminous Surface to this
approximate limit (Typical for Street Returns).
Feathering to be in accordance with "Existing
Drive Connection" detail, see Std. CR1-89

WAYNE COUNTY
"AS CONSTRUCTED"
BY: DJA CHECKED BY: DATE: 11/9/90

T.P. #3, Elev. 8.17
Hyd. Arrow @ Sta. 12+75 Rt.

T.P. #4, Elev. 8.73
Hyd. Arrow @ Sta. 16+00 Rt.

T.P. #6, Elev. 0.54
Hyd. Arrow @ Sta. 22+90 Rt.

REVISIONS

DESIGNED BY S. Von Der Mark	CHECKED BY B. Olsen	DATE 4-29-89	CORRECT Edie A. Martenson ASSISTANT DIVISION DESIGN ENGINEER
CORRECT Michael P. Jones SQUAD LEADER	APPROVED [Signature]		DIVISION DESIGN ENGINEER

WAYNE COUNTY DEPARTMENT OF PUBLIC SERVICES
ENGINEERING DIVISION

OUTER DRIVE
VAN DYKE TO SIX MILE

COUNTY PROJECT 46215	ISSUE NO. 3
DATE 1-10-90	

T.P. #7, Elev. 9.39
Hyd. Arrow @ Sta. 25+40 Rt.

T.P. #8, Elev. 0.01
Hyd. Arrow @ Sta. 30+10 Rt.

T.P. #9, Elev. 1.05
Hyd. Arrow @ Sta. 32+65 Rt.

At Yolanda Ave:
Removing Sidewalk 8 Sq. Yds.
4" Concrete Sidewalk 23 Sq. Ft.
4" Concrete Sidewalk Ramp 53 Sq. Ft.

END RESURFACING STA. 33+30
NO CONTRACT WORK

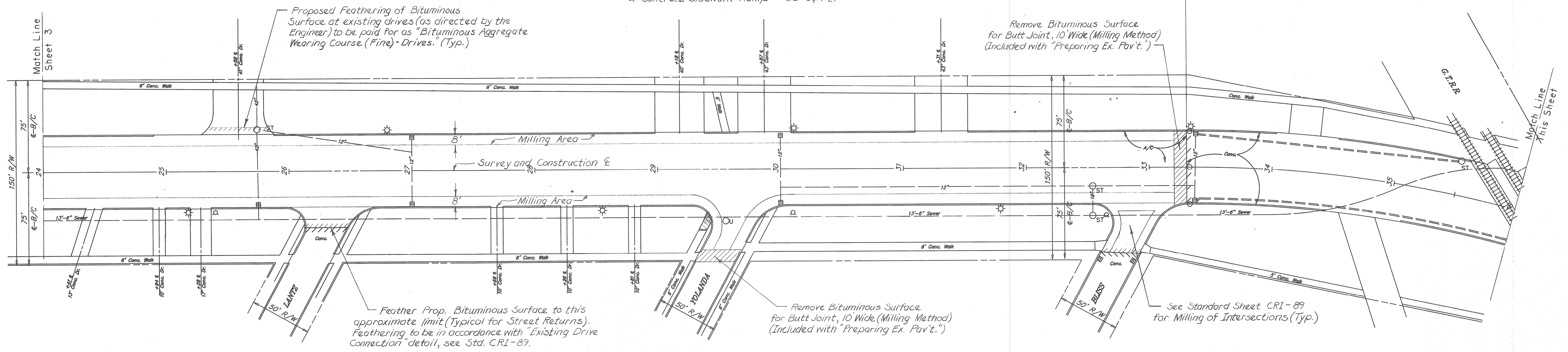

QUANTITIES (This Sheet, For Information Only)

Removing Bituminous Surface (Milling Method)	1802	Sq. Yds.
Bituminous Aggregate Leveling Course (Allowing R.A.P.)	682	Tons
Bituminous Aggregate Wearing Course (Fine) - Drives	480	Tons
Adjusting Structures	6	Each
Sawed Longitudinal Plane of Weakness Joint in Bit. Pav't.	4650	Lin. Ft.

PLAN

Scale: 1" = 40'

NO CONTRACT WORK STA. 39+23
LANE LINE MARKING ONLY

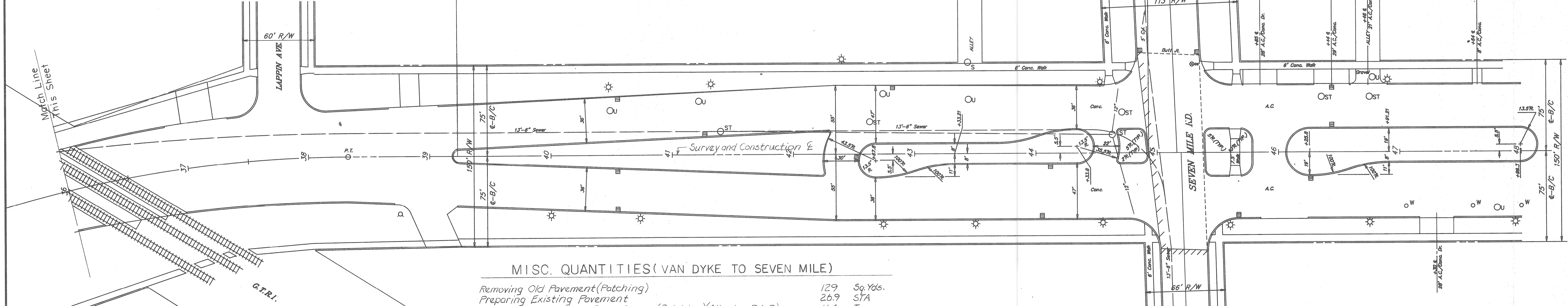

MISC. QUANTITIES (VAN DYKE TO SEVEN MILE)

Removing Old Pavement (Patching)	129	Sq. Yds.
Preparing Existing Pavement	26.9	STA
Bituminous Aggregate Base Course (Patching) (Allowing R.A.P.)	164	Tons
Bituminous Aggregate Wearing Course (Fine) - Drives	23	Tons
Cold Patching Mixture	10	Tons
Adjusting Structures, Furnishing Covers A	2	Each
Adjusting Structures, Furnishing Covers S	7	Each
Reconstructing Structures	34	Lin. Ft.
Concrete Curb Cap	93	Lin. Ft.
Concrete Curb Cap (Patching)	125	Lin. Ft.
Adjusting Water Gate Riser Boxes	2	Each

T.P. #10, Elev. 1.23
Hyd. Arrow @ Sta. 38+75 Rt.

T.P. #11, Elev. 9.74
Hyd. Arrow @ Sta. 42+50

T.P. #12, Elev. 9.97
Hyd. Arrow @ Sta. 45+60

WAYNE COUNTY
"AS CONSTRUCTED"
BY: DJT CHECKED BY: DATE: 11/9/90

WAYNE COUNTY DEPARTMENT OF PUBLIC SERVICES
ENGINEERING DIVISION

OUTER DRIVE
VAN DYKE TO SIX MILE

COUNTY PROJECT 46215
ISSUE NO. 4
DATE 4-10-90

REVISIONS

DESIGNED BY Silvan DerMeulen	CHECKED BY B. Olsen	DATE 4-27-89	CORRECT
APPROVED Michael Linn			APPROVED Edna C. Martini
SQUAD LEADER			DIVISION DESIGN ENGINEER

City of Detroit PBM 93-255
N.E. Cor. Outer Dr. and Seven Mile

TP #12
Arrow (↔) on top of hydrant
Sta. 45+60(±) Elev. 99.97

TP #13
Arrow (↔) on top of hydrant
Sta. 48+38(±) Elev. 101.36

TP #14
Arrow (↔) on top of Hydrant
Sta. 51+13(±) Elev. 100.57

TP #15
Arrow (↔) on top of Hydrant
Sta. 54+90(±) Elev. 101.49

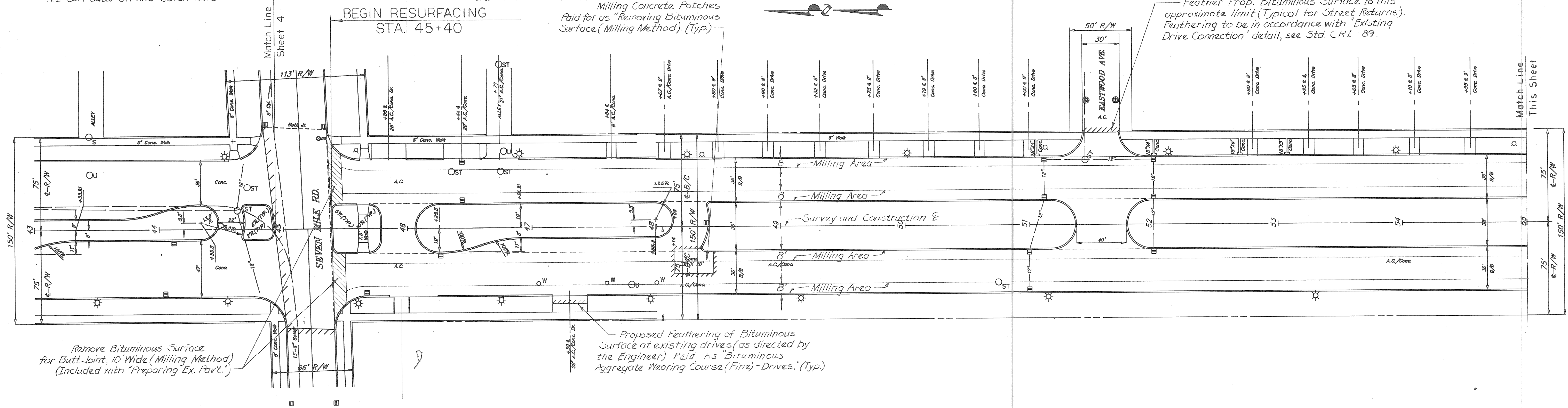

Feather Prop. Bituminous Surface to this approximate limit (Typical for Street Returns). Feathering to be in accordance with "Existing Drive Connection" detail, see Std. CRI-89.

Remove Bituminous Surface for Butt-joint, 10' Wide (Milling Method) (Included with "Preparing Ex. Pav't.")

Proposed Feathering of Bituminous Surface at existing drives (as directed by the Engineer) Paid As "Bituminous Aggregate Wearing Course (Fine)-Drives." (Typ.)

PLAN

Scale: 1"=40'

TP #16
Arrow (↔) on top of Hydrant
Sta. 57+78 Elev. 100.41

TP #17
Arrow (↔) on top of hydrant
Sta. 61+40(±) Elev. 99.93

TP #18
Arrow (↔) on top of hydrant
Sta. 64+30 Elev. 99.58

See Standard Sheet CRI-89 for Milling of Intersections (Typ.)

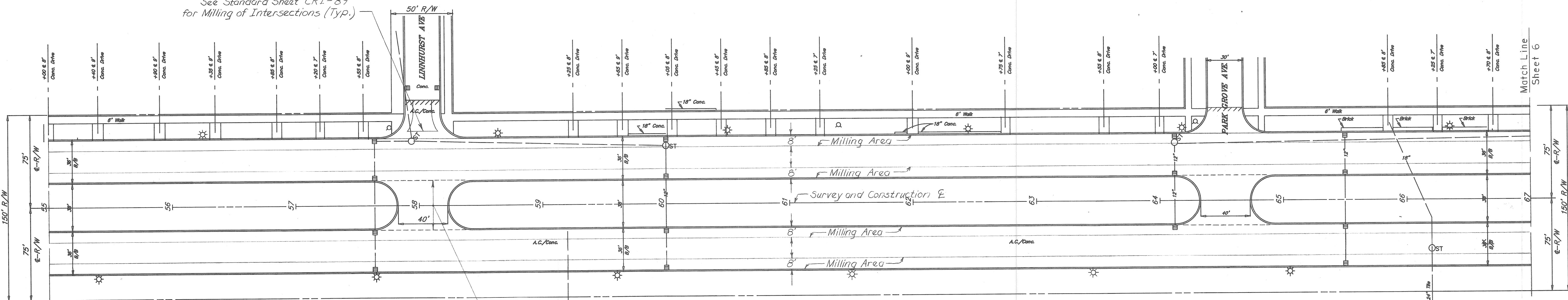

Remove Bituminous Surface (Milling Method) - Full Depth (Typ. at all Non-Signalized Median Intersections and Turn-a-rounds).

QUANTITIES (This Sheet, For Information Only)

Removing Bituminous Surface (Milling Method)	7783	Sq. Yds.
Removing Bituminous Surface (Milling Method) - Full Depth	1426	Sq. Yds.
Bituminous Aggregate Leveling Course (Allowing R.A.P.)	2101	Tons
Bituminous Aggregate Wearing Course (Fine)	1387	Tons
Sawed Longitudinal Plane of Weakness Joint in Bit. Pav't.	12316	Lin. Ft.
Adjusting Water Shutoff	3	Each
Adjusting Structures	35	Each

WAYNE COUNTY
"AS CONSTRUCTED"
BY: DJA CHECKED BY: DATE: 11/9/90

WAYNE COUNTY DEPARTMENT OF PUBLIC SERVICES
ENGINEERING DIVISION

OUTER DRIVE
VAN DYKE TO SIX MILE

COUNTY PROJECT
46215
ISSUE NO.
DATE 1-10-90

5

REVISIONS

DESIGNED BY
S. VanDerMeulen
CHECKED BY
B. Olsen
DATE
4-29-89

CORRECT
APPROVED
DIVISION DESIGN ENGINEER

TP#19
Arrow (→) on top of hydrant
Sta. 67+60⁰⁰ Elev. 99.79

City of Detroit PBM 60-252
N.E. Cor. Greiner and Outer Drive

TP#20
Spike in E. Side D.E Pole
Sta. 71+50⁰⁰W. Elev. 98.47

TP#21
X in PLD conc. base
Sta. 75+50⁰⁰ Elev. 97.44

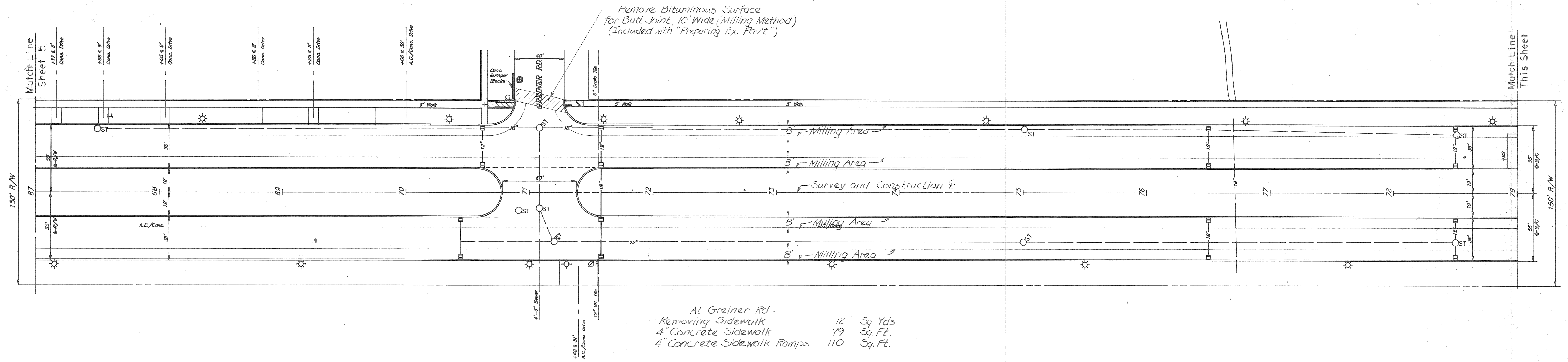

At Greiner Rd:
Removing Sidewalk 12 Sq. Yds
4" Concrete Sidewalk 179 Sq. Ft.
4" Concrete Sidewalk Ramps 110 Sq. Ft.

PLAN
Scale: 1"=40'

TP#22
X in PLD conc. base
Sta. 79+50⁰⁰ Elev. 98.46

TP#23
X in PLD conc. base
Sta. 83+75⁰⁰ Elev. 98.52

TP#24
X in PLD conc. base
Sta. 87+85 Elev. 97.74

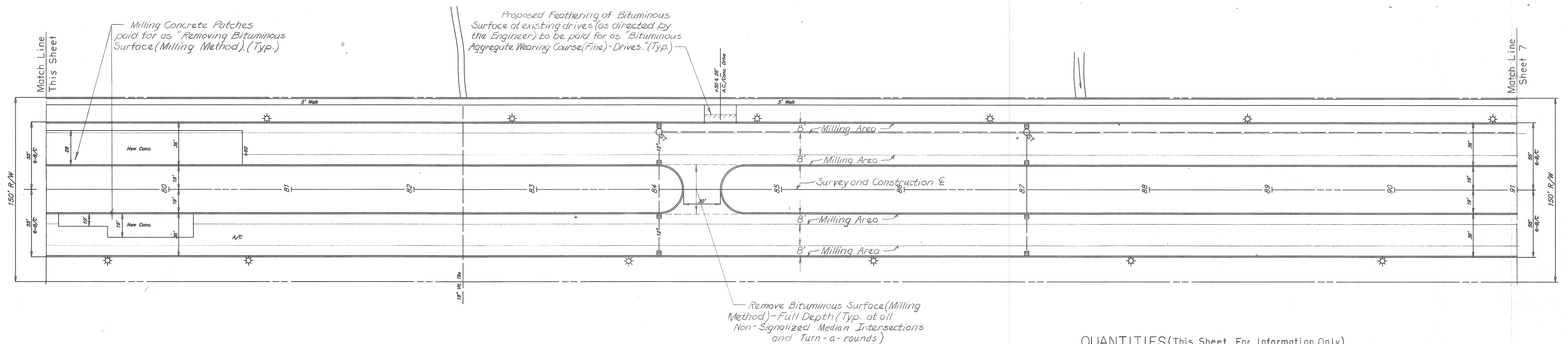

QUANTITIES (This Sheet, For Information Only)

Removing Bituminous Surface (Milling Method)	8,542	Sq. Yds.
Removing Bituminous Surface (Milling Method) - Full Depth	449	Sq. Yds.
Bituminous Aggregate Leveling Course (Allowing R.A.P.)	2,161	Tons
Bituminous Aggregate Wearing Course (Fine)	1,414	Tons
Sawed Longitudinal Plane of Weakness Joint in Bit. Pavt.	14,400	Lin. Ft.
Adjusting Structures	34	Each

WAYNE COUNTY
"AS CONSTRUCTED"
BY: DJA CHECKED BY: DATE: 11/9/90

REVISIONS

DESIGN BY S. Van Der Meulen	CHECKED BY B. Olsen	DATE 4-29-89	CORRECT Eddie A. M. [Signature] ASSISTANT DIVISION DESIGN ENGINEER
CORRECT Michael [Signature] SQUAD LEADER	APPROVED [Signature] DIVISION DESIGN ENGINEER		

WAYNE COUNTY DEPARTMENT OF PUBLIC SERVICES
ENGINEERING DIVISION

OUTER DRIVE
VAN DYKE TO SIX MILE

COUNTY PROJECT 46215	6
ISSUE NO. 1	
DATE 4-10-90	

F-8-1

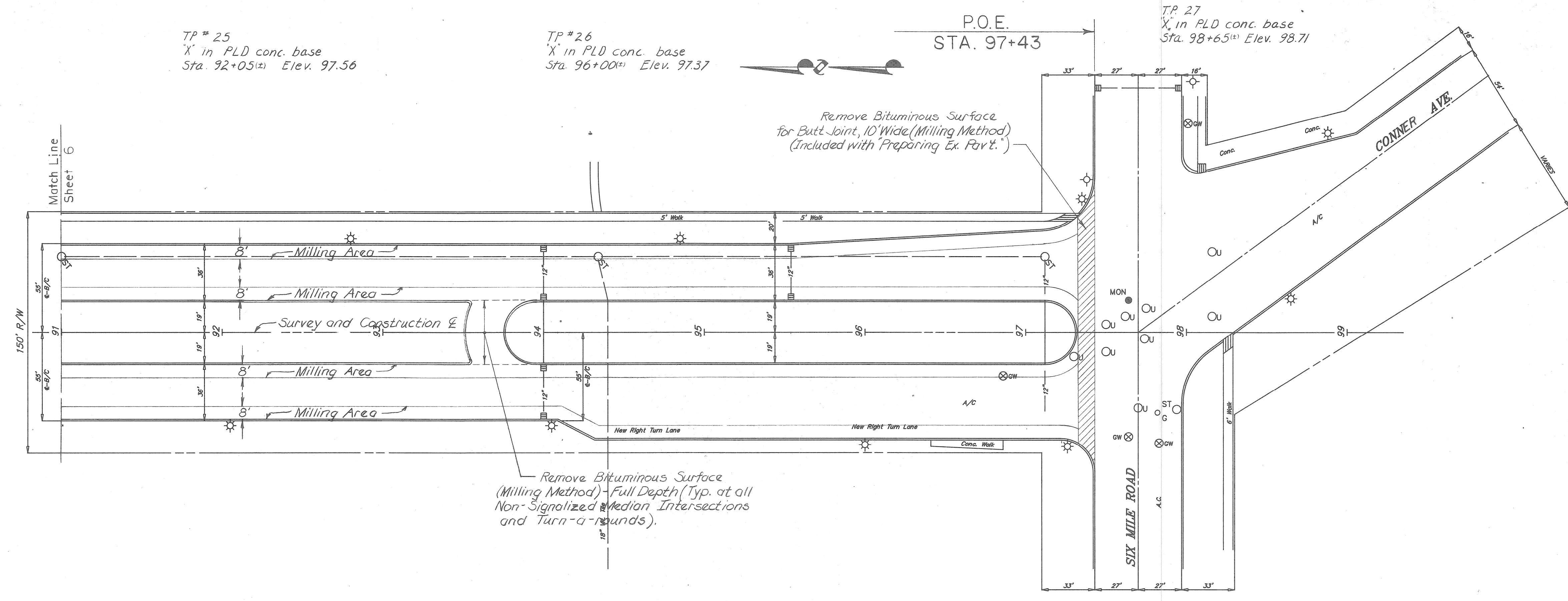

QUANTITIES (This Sheet, For Information Only)

Removing Bituminous Surface (Milling Method)	2267	Sq. Yds.
Removing Bituminous Surface (Milling Method) - Full Depth	104	Sq. Yds.
Bituminous Aggregate Levelling Course (Allowing R.A.P.)	640	Tons
Bituminous Aggregate Wearing Course (Fine)	416	Tons
Sawed Longitudinal Plane of Weakness Joint in Bit. Pavt.	4192	Lin. Ft.
Adjusting Structures	9	Each

PLAN

Scale: 1" = 40'

MISC. QUANTITIES (SEVEN MILE TO SIX MILE)

Removing Old Pavement (Patching)	242	Sq. Yds.
Preparing Existing Pavement	104.1	STA.
Bituminous Aggregate Base Course (Patching) (Allowing R.A.P.)	362	Tons
Bituminous Aggregate Wearing Course (Fine) - Drives	20	Tons
Cold Patching Mixture	20	Tons
Adjusting Structures, Furnishing Covers A	2	Each
Adjusting Structures, Furnishing Covers S	7	Each
Reconstructing Structures	24	Lin. Ft.
Concrete Curb Cap	174	Lin. Ft.
Concrete Curb Cap (Patching)	99	Lin. Ft.

WAYNE COUNTY
 "AS CONSTRUCTED"
 BY: DJA CHECKED BY: DATE: 11/9/90

REVISIONS	DESIGNED BY S. Van Der Weide	CHECKED BY B. Olsen	DATE 4-29-89	CORRECT Edwin A. M... ASSISTANT DIVISION DESIGN ENGINEER
	CORRECT Michael Olsen SQUAD LEADER			APPROVED DIVISION DESIGN ENGINEER

WAYNE COUNTY DEPARTMENT OF PUBLIC SERVICES
 ENGINEERING DIVISION

OUTER DRIVE
 VAN DYKE TO SIX MILE

COUNTY PROJECT 46215	7
ISSUE NO. 1	
DATE 4-10-90	

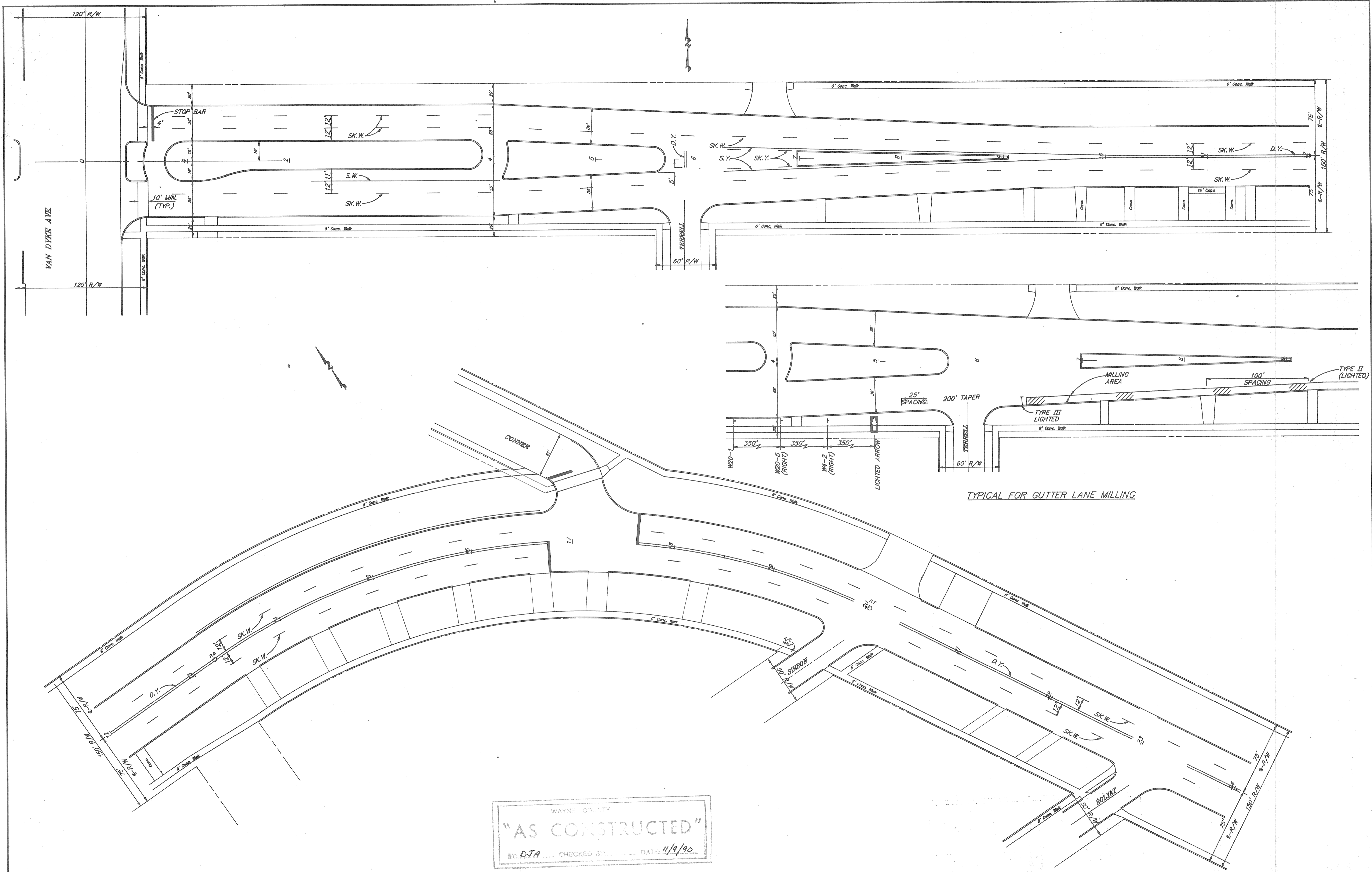

WAYNE COUNTY
 "AS CONSTRUCTED"
 BY: DJA CHECKED BY: DATE: 11/9/90

REVISIONS

DESIGNED BY D.P.H.	CHECKED BY DJA	DATE 4-10-90	CORRECT Edgar A. Montenegro ASSISTANT DIVISION DESIGN ENGINEER
CORRECT SQUAD LEADER	APPROVED DIVISION DESIGN ENGINEER		

WAYNE COUNTY DEPARTMENT OF PUBLIC SERVICES
 ENGINEERING DIVISION

LANE LINE MARKING
 OUTER DRIVE
 VAN DYKE TO SIX MILE

COUNTY PROJECT 46215	1"=40'
ISSUE NO. 1	8
DATE 4-10-90	

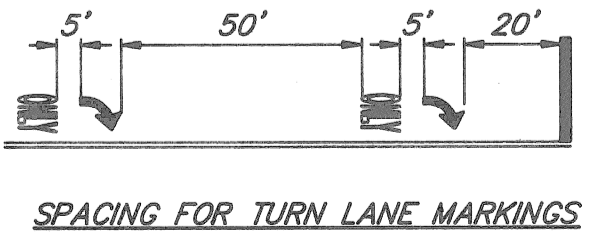
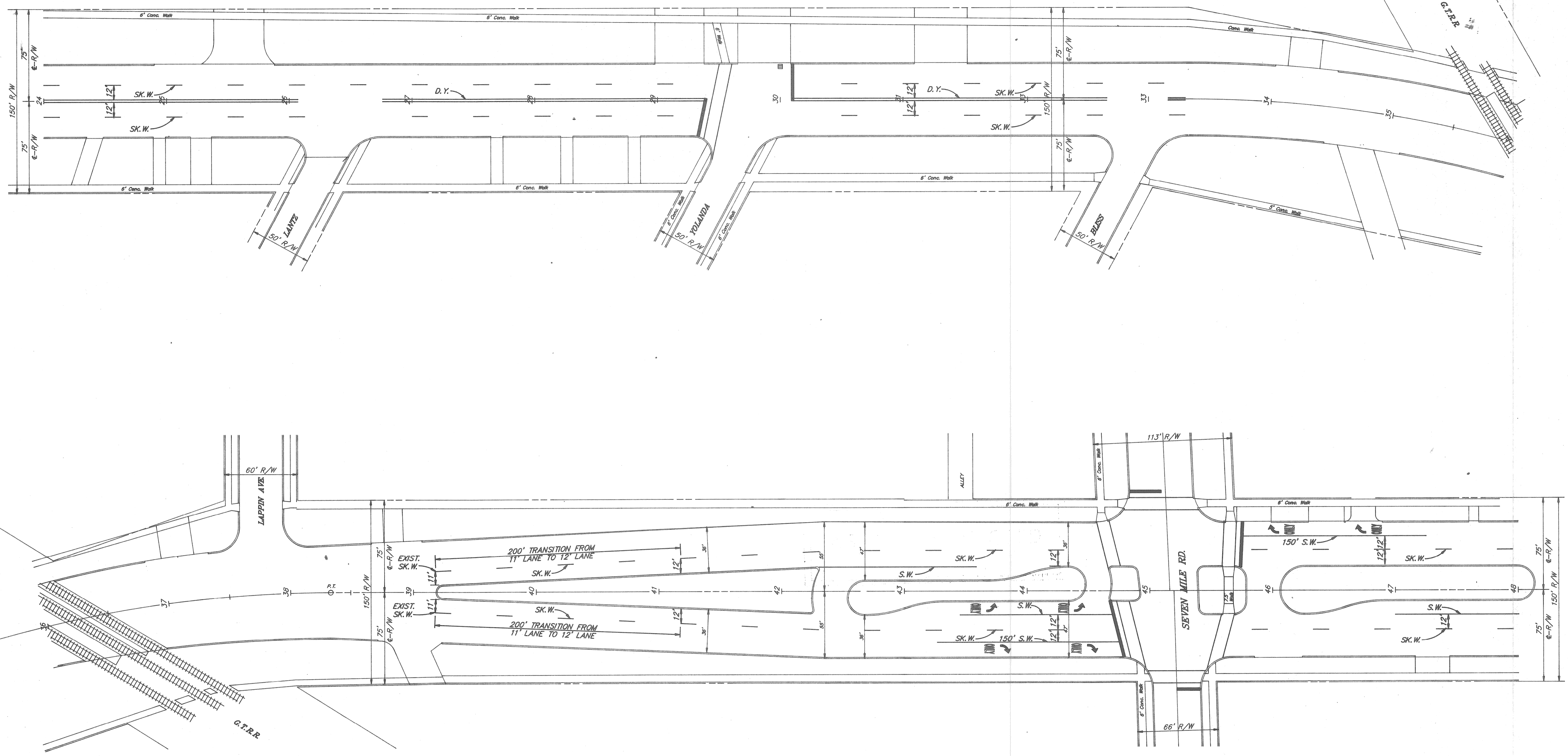
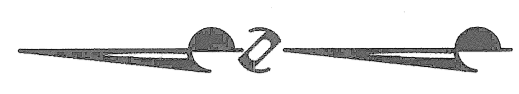

WAYNE COUNTY
 "AS CONSTRUCTED"
 BY: DJA CHECKED BY: DATE: 11/9/90

REVISIONS	DESIGNED BY D.P.H.	DRAWN BY DJA	DATE 4-10-90	CORRECT Eddie A. Martyniuk ASSISTANT DIVISION DESIGN ENGINEER
	CORRECT [Signature]			APPROVED [Signature] DIVISION DESIGN ENGINEER
				SQUAD LEADER

WAYNE COUNTY DEPARTMENT OF PUBLIC SERVICES
 ENGINEERING DIVISION

COUNTY PROJECT 46215	SCALE 1"=40'
ISSUE NO. 1	SHEET NO. 9
DATE 4-10-90	

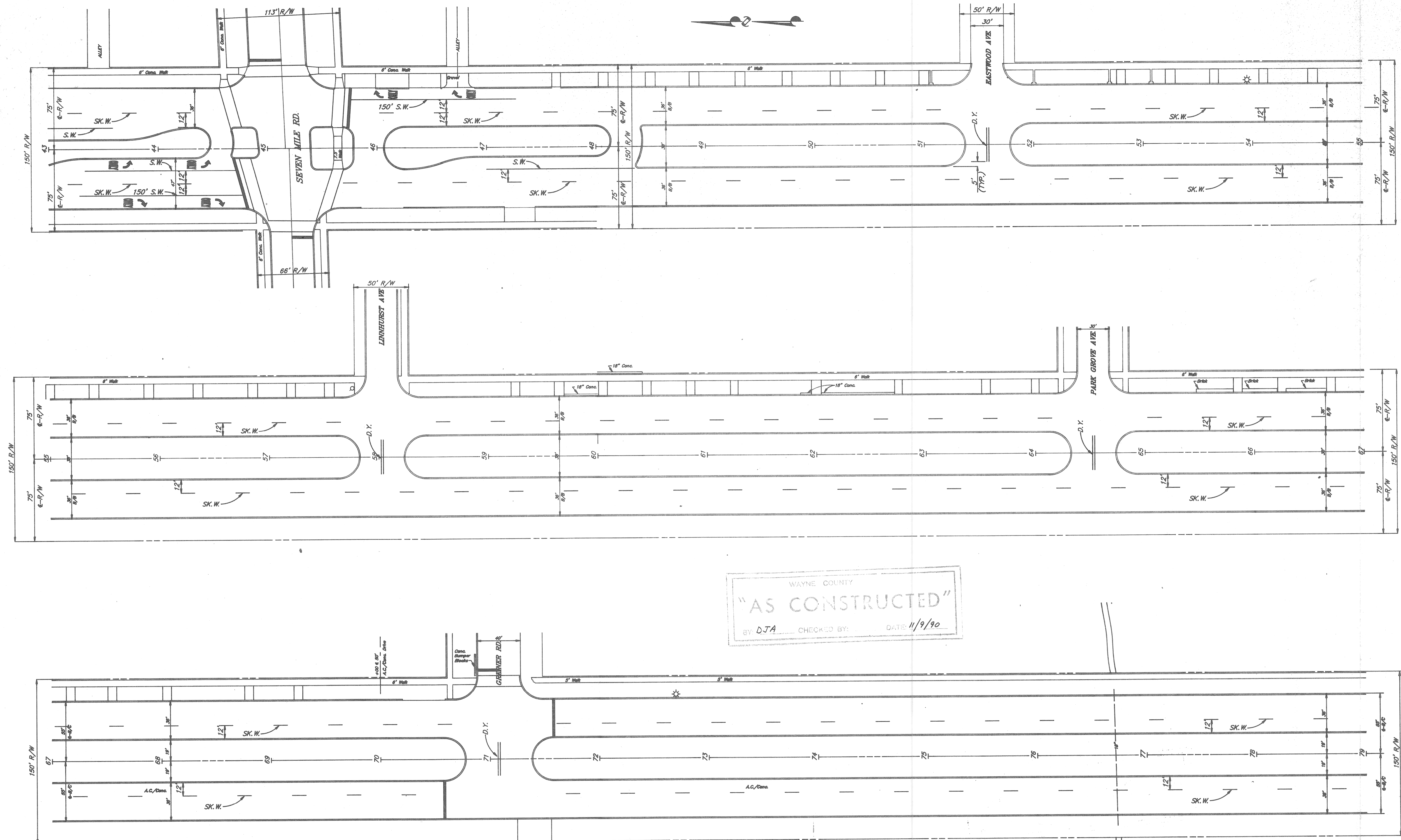

WAYNE COUNTY
 "AS CONSTRUCTED"
 BY DJA CHECKED BY: DATE 11/9/90

REVISIONS

DESIGNED BY <u>DJA</u>	DATE <u>4-10-90</u>	CORRECT <u>Bobby A. Mattinger</u> ASSISTANT DIVISION DESIGN ENGINEER
CORRECT <u>William J. Smith</u> SQUAD LEADER	APPROVED <u>[Signature]</u> DIVISION DESIGN ENGINEER	

WAYNE COUNTY DEPARTMENT OF PUBLIC SERVICES
 ENGINEERING DIVISION

LANE LINE MARKING
 OUTER DRIVE
 VAN DYKE TO SIX MILE

COUNTY PROJECT 46215	SCALE 1"=40'
ISSUE NO. <u>1</u>	SHEET NO. 10
DATE <u>4-10-90</u>	

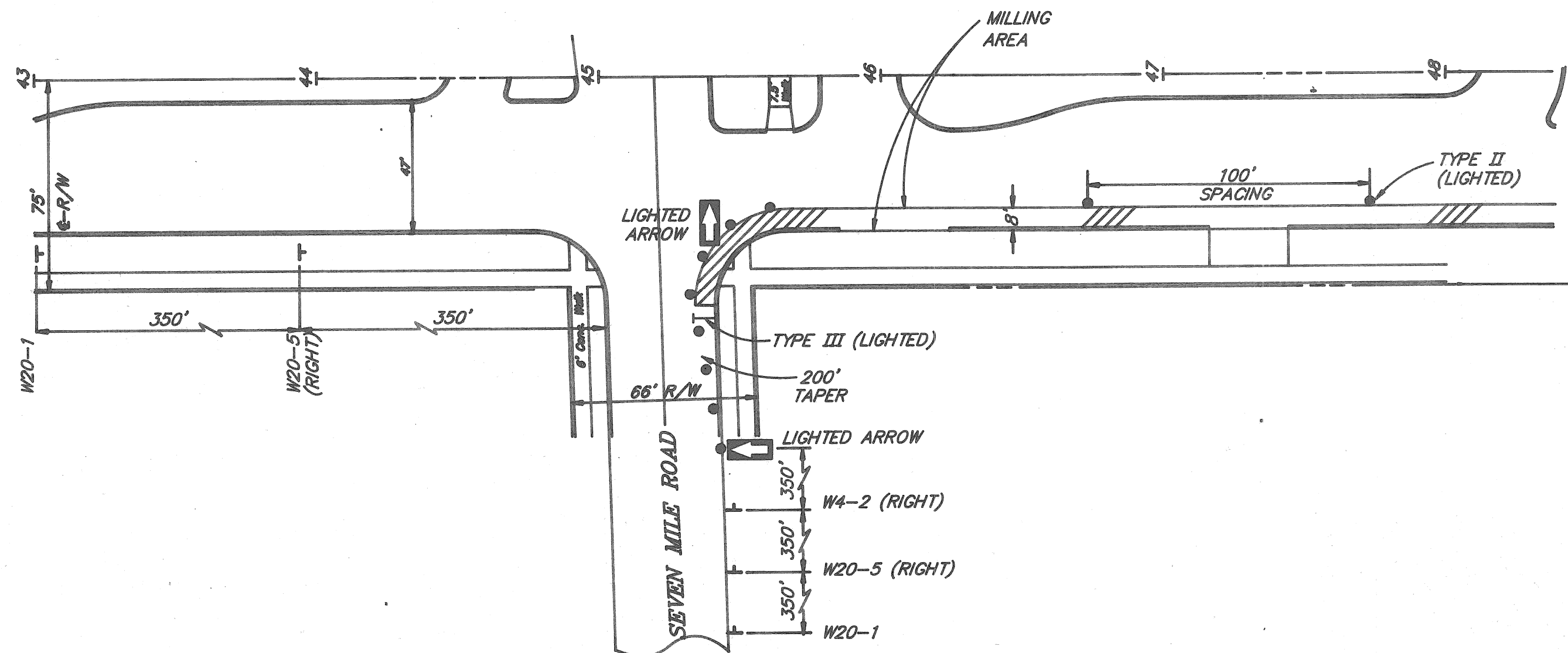
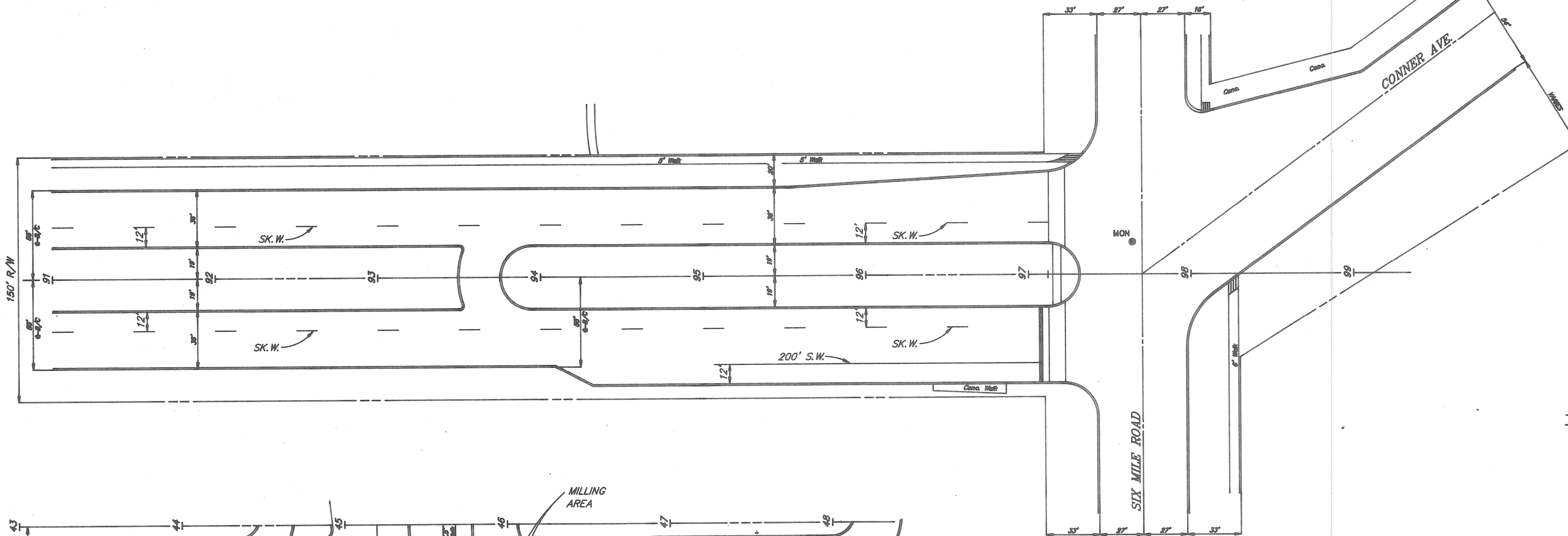
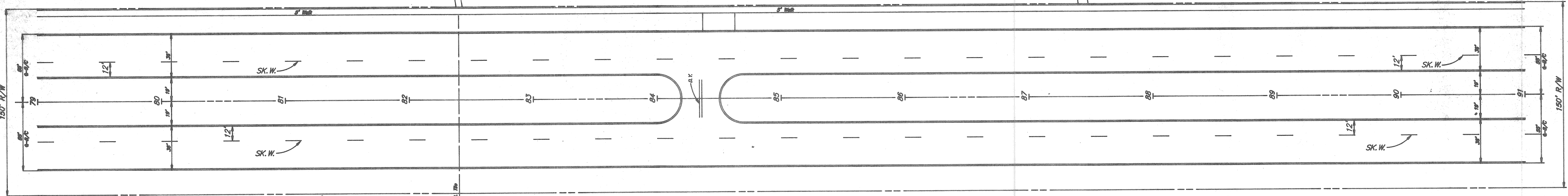

TYPICAL FOR GUTTER LANE MILLING

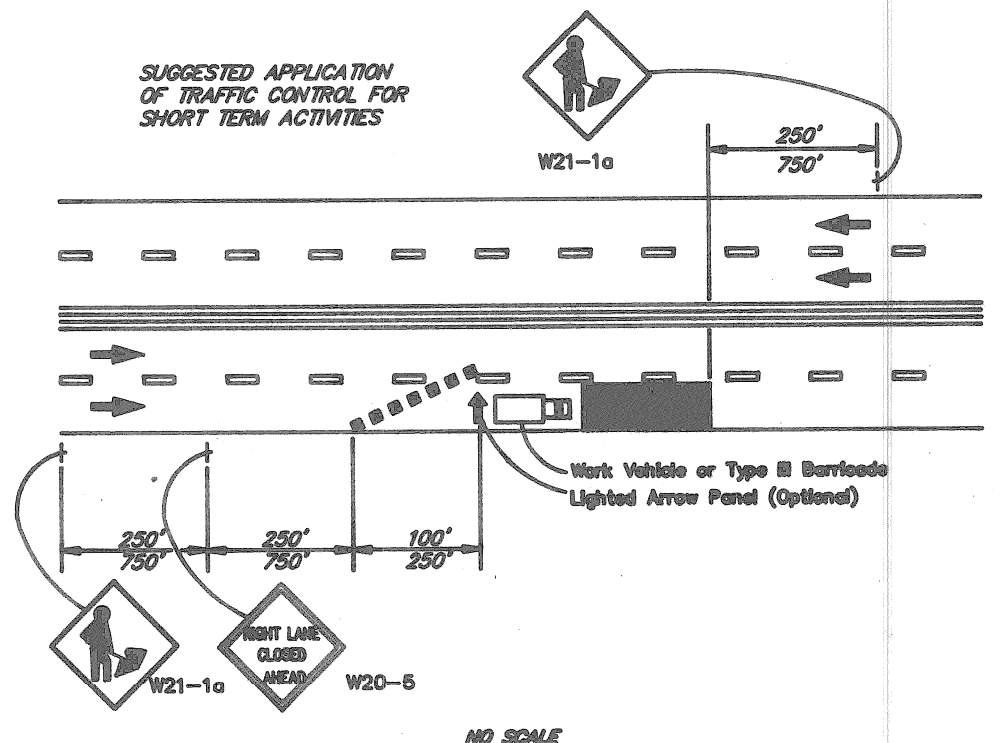

WAYNE COUNTY
 "AS CONSTRUCTED"
 BY: DJA CHECKED BY: DATE: 11/9/90

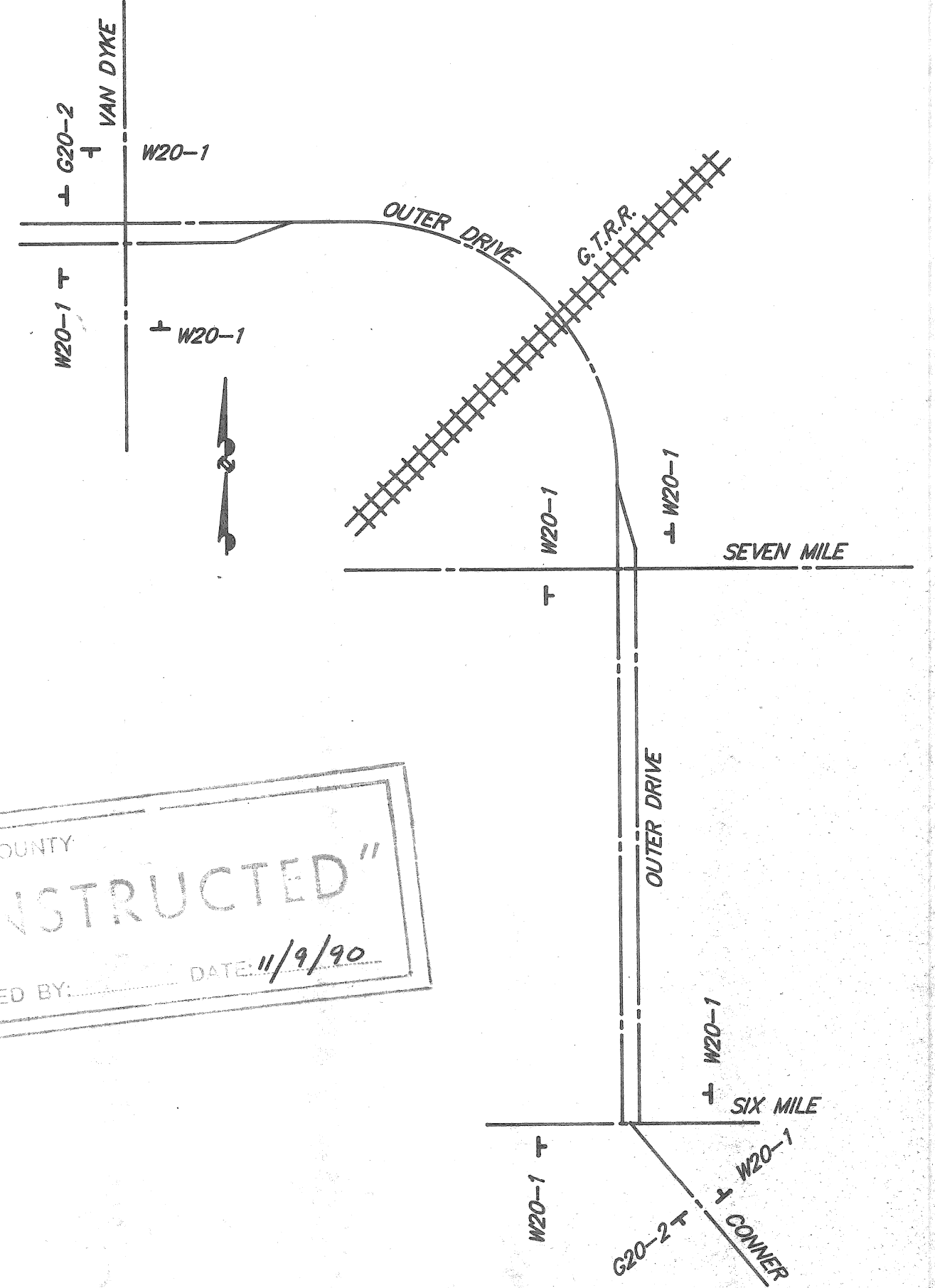

CONSTRUCTION SIGNING

SIGN TYPE "B" TEMPORARY	QUAN.	SIZE	SYD.
G20-2 END CONSTRUCTION	2	60" x 24"	20
W4-2 PAVEMENT WIDTH TRANSITION	2	48" x 48"	32
W20-1 CONSTRUCTION AHEAD	8	48" x 48"	128
W20-5 RIGHT, LEFT LANE CLOSED AHEAD	3	48" x 48"	48
W21-1a MEN WORKING	2	48" x 48"	32
LIGHTED ARROW (FURNISHED)	17		260
LIGHTED ARROW (OPERATED)	3		EACH
TYPE II BARRICADE LIGHTED (FURNISHED)	70		EACH
TYPE II BARRICADE LIGHTED (OPERATED)	60		EACH
TYPE III BARRICADE LIGHTED (FURNISHED)	3		EACH
TYPE III BARRICADE LIGHTED (OPERATED)	2		EACH
TEMP. PAVEMENT MARKINGS TYPE "R"	929		LFT.
TEMP. PAVEMENT MARKINGS TYPE "NR"	929		LFT.

LANE LINING QUANTITIES	QUAN.	UNIT
COLD PLASTIC PAVEMENT MARKING 24" STOP BAR	337	LFT.
COLD PLASTIC PAVEMENT MARKING 6" CROSSWALK	1185	LFT.
COLD PLASTIC PAVEMENT MARKING 4" WHITE	4729	LFT.
COLD PLASTIC PAVEMENT MARKING 4" YELLOW	4984	LFT.
COLD PLASTIC PAVEMENT MARKING (LEFT TURN ARROW)	2	EACH
COLD PLASTIC PAVEMENT MARKING (RIGHT TURN ARROW)	4	EACH
COLD PLASTIC PAVEMENT MARKING LEGEND (ONLY)	6	EACH

REVISIONS	DESIGNED BY	CHECKED BY	DATE	CORRECT
	D.A.H.	D.J.A.	4-10-90	Edna A. Martynowski ASSISTANT DIVISION DESIGN ENGINEER
				APPROVED DIVISION DESIGN ENGINEER

WAYNE COUNTY DEPARTMENT OF PUBLIC SERVICES
 ENGINEERING DIVISION

LANE LINE MARKING
 OUTER DRIVE
 VAN DYKE TO SIX MILE.

COUNTY PROJECT	SCALE
46215	1" = 40'
ISSUE NO. 1	SHEET NO. 11
DATE 4-10-90	