

TYPICAL CROSS-SECTIONS

SCALE 1"=4'

GENERAL NOTES

The location of all utilities shown on these plans is taken from the best available data. The Wayne County Department of Public Services will not be responsible for any omissions or variations from the location shown. The Contractor shall contact the Utility Owners regarding their facilities, including service connections, prior to starting the work. Utility service connections are not shown on the plans and are not the responsibility of Wayne County Department of Public Services. Existing castings damaged by the Contractor shall be replaced by the Contractor at his own expense. Moving hydrants and adjusting to grade all private utility structures will be done by the Owner (Michigan Bell Telephone Co., Detroit Edison Co., Michigan Consolidated Gas Co.)

Sewer taps to existing manholes, catch basins, and concrete sewers shall be included in the appropriate sewer item.

The edge of existing pavement shall be cleaned of earth or other foreign material with a wire broom before adjacent pours are placed.

Matching on seeded areas shall be applied at the rate of 2 tons per acre.

Street or road name signs and stop signs, in the way of construction, will be removed and reset immediately in a temporary location. Street name signs shall be finally set by the Contractor in a location designated by the Engineer, upon completion of fine grading in the section involved. This work shall be included in Sign type B, Formoment.

The location of all utilities shown on these plans is taken from the best available data. The Wayne County Department of Public Services will not be responsible for any omissions or variations from the location shown. The Contractor shall contact the Utility Owners regarding their facilities, including service connections, prior to starting the work. Utility service connections are not shown on the plans and are not the responsibility of Wayne County Department of Public Services. Existing castings damaged by the Contractor shall be replaced by the Contractor at his own expense. Moving hydrants and adjusting to grade all private utility structures will be done by the Owner (Michigan Bell Telephone Co., Detroit Edison Co., Michigan Consolidated Gas Co.)

Existing castings damaged by the Contractor shall be replaced by the Contractor at his own expense. Moving hydrants and adjusting to grade all private utility structures will be done by the Owner (Michigan Bell Telephone Co., Detroit Edison Co., Michigan Consolidated Gas Co.)

NOTES

STA. 0+00 TO STA. 4+80

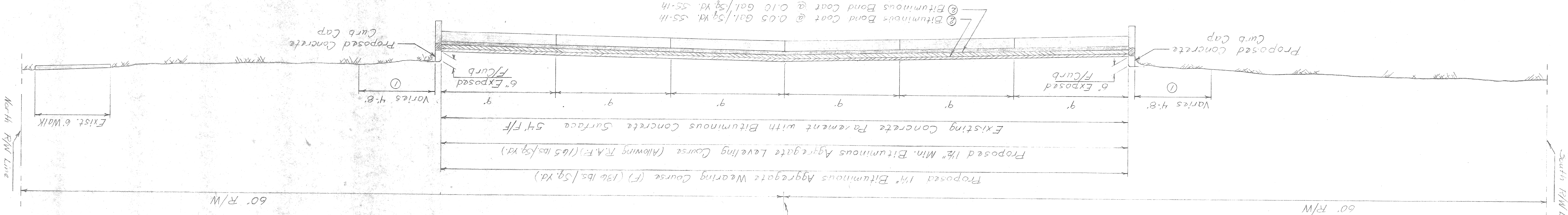

- After gapping concrete curb, remove remaining overburden (as directed by the Engineer). (Included in Topsoil Surface, 3", 13,490 sq yds of Topsoil Surface, 3", 150 lbs. of Class B Setting, Mix No. 3, and 6 Tons of Mulch have been provided for restoration within these limits.
- Bituminous Bond Coat SS-1H will not be paid for separately, but shall be included in the bituminous aggregate course being applied.

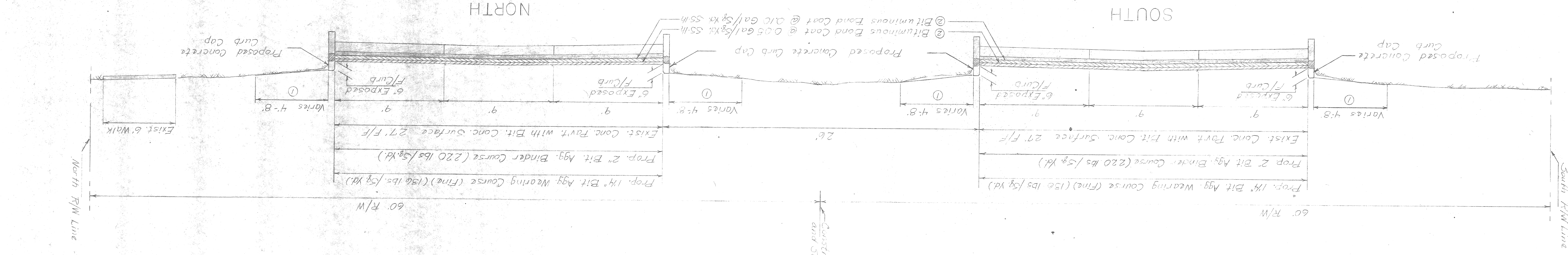

STA. 8+89 TO STA. 13+99
 STA. 19+06 TO STA. 24+45
 STA. 27+77 TO STA. 32+75
 STA. 35+58 TO STA. 41+00
 STA. 49+48 TO STA. 54+00

WAYNE COUNTY
"AS CONSTRUCTED"
 BY: DTA
 CHECKED BY: SLS DATE: 2-28-91

WAYNE COUNTY OFFICE OF PUBLIC SERVICES
 ENGINEERING DIVISION

DIX AVENUE

WOODMERE TO VERNOR HWY

COUNTY PROJECT 46213
 SHEET NO. 2
 DATE F-8-4

REVISIONS	DATE	BY	DESCRIPTION
1	4-29-89	SIV	CHECKED BY
2			CHECKED BY
3			CHECKED BY
4			CHECKED BY
5			CHECKED BY
6			CHECKED BY
7			CHECKED BY
8			CHECKED BY
9			CHECKED BY
10			CHECKED BY
11			CHECKED BY
12			CHECKED BY
13			CHECKED BY
14			CHECKED BY
15			CHECKED BY
16			CHECKED BY
17			CHECKED BY
18			CHECKED BY
19			CHECKED BY
20			CHECKED BY
21			CHECKED BY
22			CHECKED BY
23			CHECKED BY
24			CHECKED BY
25			CHECKED BY
26			CHECKED BY
27			CHECKED BY
28			CHECKED BY
29			CHECKED BY
30			CHECKED BY
31			CHECKED BY
32			CHECKED BY
33			CHECKED BY
34			CHECKED BY
35			CHECKED BY
36			CHECKED BY
37			CHECKED BY
38			CHECKED BY
39			CHECKED BY
40			CHECKED BY
41			CHECKED BY
42			CHECKED BY
43			CHECKED BY
44			CHECKED BY
45			CHECKED BY
46			CHECKED BY
47			CHECKED BY
48			CHECKED BY
49			CHECKED BY
50			CHECKED BY
51			CHECKED BY
52			CHECKED BY
53			CHECKED BY
54			CHECKED BY
55			CHECKED BY
56			CHECKED BY
57			CHECKED BY
58			CHECKED BY
59			CHECKED BY
60			CHECKED BY
61			CHECKED BY
62			CHECKED BY
63			CHECKED BY
64			CHECKED BY
65			CHECKED BY
66			CHECKED BY
67			CHECKED BY
68			CHECKED BY
69			CHECKED BY
70			CHECKED BY
71			CHECKED BY
72			CHECKED BY
73			CHECKED BY
74			CHECKED BY
75			CHECKED BY
76			CHECKED BY
77			CHECKED BY
78			CHECKED BY
79			CHECKED BY
80			CHECKED BY
81			CHECKED BY
82			CHECKED BY
83			CHECKED BY
84			CHECKED BY
85			CHECKED BY
86			CHECKED BY
87			CHECKED BY
88			CHECKED BY
89			CHECKED BY
90			CHECKED BY
91			CHECKED BY
92			CHECKED BY
93			CHECKED BY
94			CHECKED BY
95			CHECKED BY
96			CHECKED BY
97			CHECKED BY
98			CHECKED BY
99			CHECKED BY
100			CHECKED BY

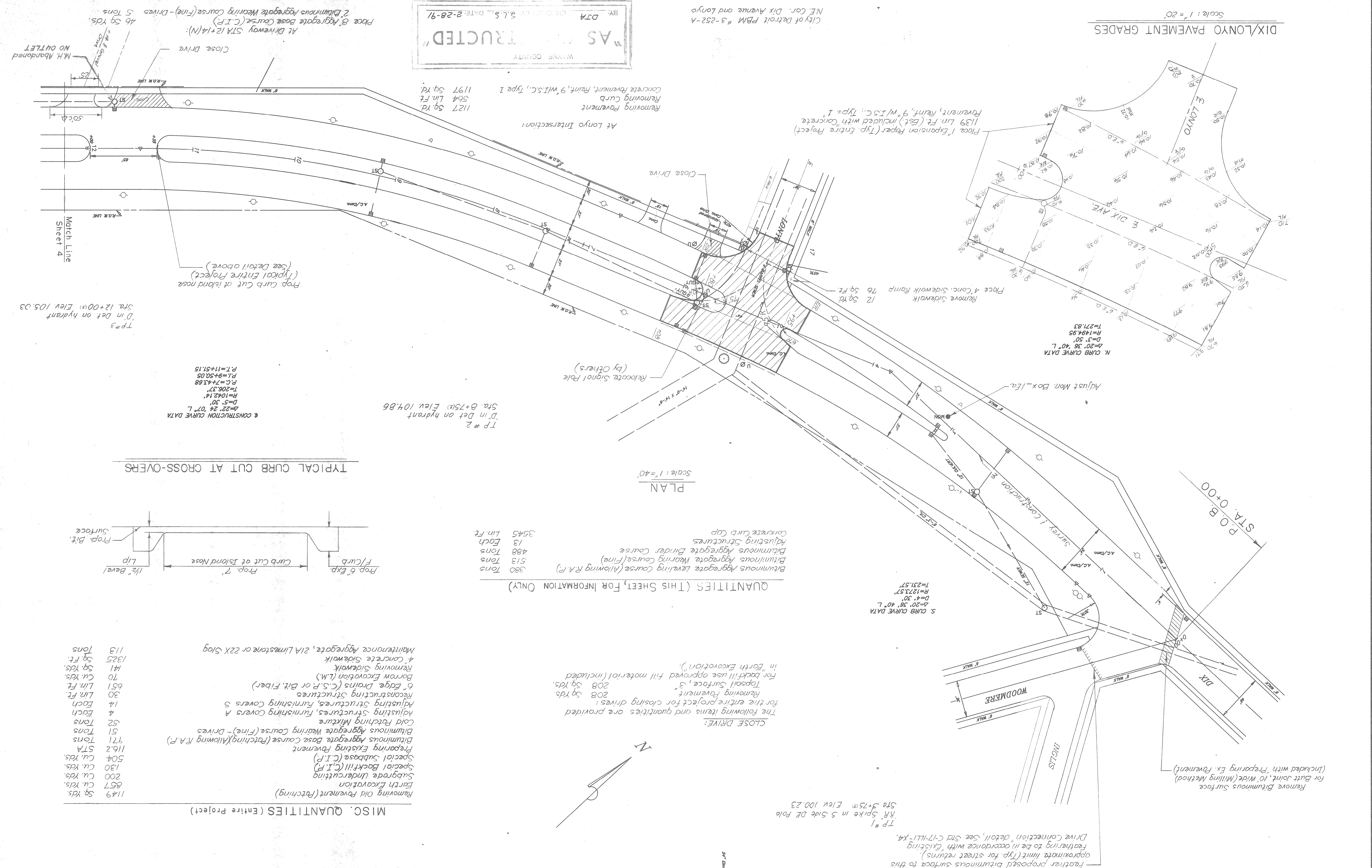

DIX/LONYO PAVEMENT GRADES
 Scale: 1" = 20'

PLAN
 Scale: 1" = 40'

TYPICAL CURB CUT AT CROSS-OVER

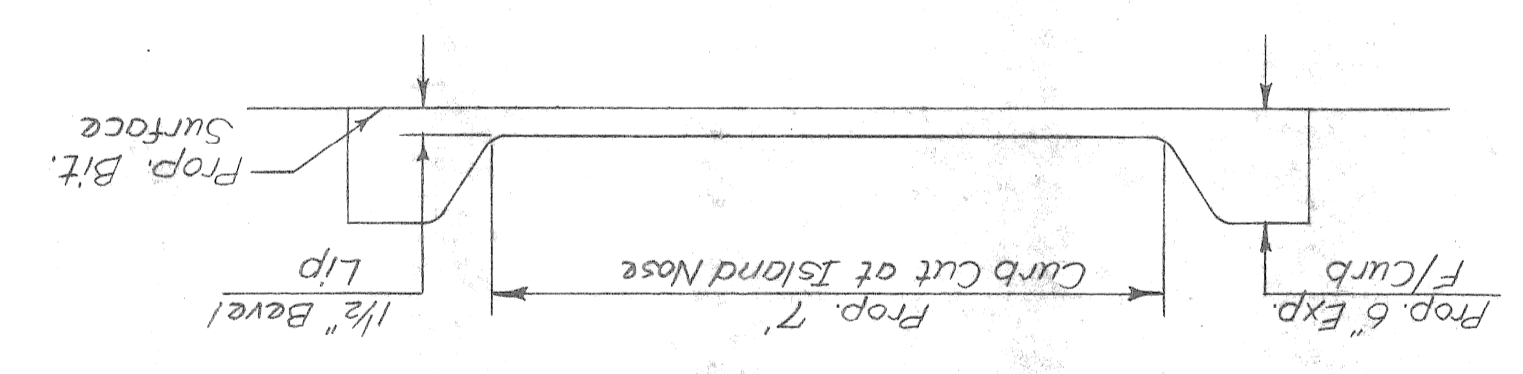

QUANTITIES (THIS SHEET, FOR INFORMATION ONLY)

380	Tons	Bituminous Aggregate Leveling Course (Allowing R.A.F.)
513	Tons	Bituminous Aggregate Wearing Course (Fine)
488	Tons	Bituminous Aggregate Binder Course
13	Each	Adjusting Structures
3545	Lin. Ft.	Concrete Curb Cap

MISC. QUANTITIES (Entire Project)

1149	Sq. Yds.	Removing Old Pavement (Patching)
857	Cu. Yds.	Earth Excavation
200	Cu. Yds.	Subgrade Undercutting
130	Cu. Yds.	Special Backfill (C.I.F.)
504	Cu. Yds.	Repairing Existing Pavement
116.2	STA	Special Subbase (C.I.F.)
971	Tons	Bituminous Aggregate Base Course (Patching) (Allowing R.A.F.)
51	Tons	Bituminous Aggregate Wearing Course (Fine) - Drives
52	Tons	Cold Patching Mixture
4	Each	Adjusting Structures, Furnishing Covers
14	Each	Adjusting Structures, Furnishing Covers
30	Lin. Ft.	Reconstructing Structures
651	Lin. Ft.	6" Edge Drains (C.S.P. or Bit. Fiber)
70	Cu. Yds.	Borrow Excavation (L.M.)
141	Sq. Yds.	Removing Sidewalk
1325	Sq. Ft.	4 Concrete Sidewalk
113	Tons	Maintenance Aggregate, 2 1/4 Limestone or 2 1/2 Slog

The following items and quantities are provided for the entire project for closing drives:
 208 Sq. Yds. Removing Pavement
 208 Sq. Yds. Topsoil Surface, 3"
 For backfill use approved fill material (included in Earth Excavation)

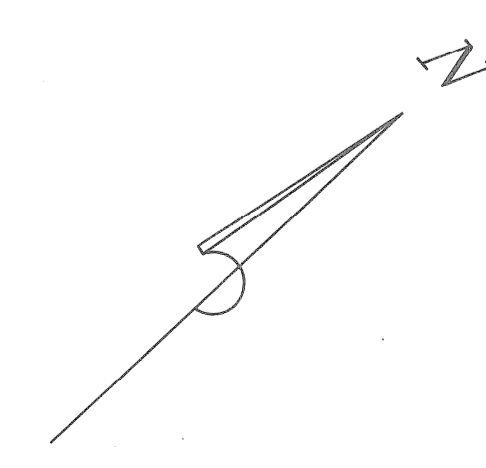

City of Detroit B.M. #3-252-A
 NE. Cor. Dix Avenue and Longo
 BY DTA
 CHECKED BY S.L.S.
 DATE: 2-28-91
 WAYNE COUNTY
 "AS CONSTRUCTED"
 Removing Pavement
 Removing Curb
 564 Lin. Ft.
 1127 Sq. Yd.
 Concrete Pavement, Reint., 9" W.I.S.C., Type 1
 1197 Sq. Yd.
 At Longo Intersection:
 Removing Pavement
 Removing Curb
 564 Lin. Ft.
 1127 Sq. Yd.
 Concrete Pavement, Reint., 9" W.I.S.C., Type 1
 1197 Sq. Yd.
 At Driveway STA 12+14(N):
 Place 2 Bituminous Aggregate Base Course (C.I.F.)
 Place 2 Bituminous Aggregate Wearing Course (Fine) - Drives
 46 Sq. Yds.
 5 Tons
 M.H. Abandoned
 NO OUTLET
 Close Drive
 2" RAK LINE
 2" RAK LINE
 2" RAK LINE
 Match Line
 Sheet 4
 Prop. Curb Cut at Island nose
 (Typical Entire Project)
 (See Detail above)
 D in Det on hydrant
 Sta. 12+00 Elev. 105.03
 TP#3
 & CONSTRUCTION CURVE DATA
 D=5.30'
 R=1042.14'
 T=208.37'
 P.C.=7+43.68
 P.L.=9+50.05
 P.T.=11+51.15

TP#1
 R.R. Spike in S Side DE Pole
 Sta. 3+75 Elev. 100.23

Further proposed bituminous surface to this
 approximately limit (Typ. for street returns)
 feathering to be in accordance with existing
 Drive Connection detail, See Std C-17-111-X4.

Remove Bituminous Surface
 for Butt Joint, 10' Wide (Milling Method)
 (Included with "Repairing Ex. Pavement")

S. CURB CURVE DATA
 D=20' 36" 40" L
 R=1273.57'
 T=231.57'

N. CURB CURVE DATA
 D=3' 50"
 R=1494.95'
 T=271.83'

Place 1" Expansion Paper (Typ. Entire Project)
 1139 Lin. Ft. (Est.) included with Concrete
 Pavement, Reint., 9" W.I.S.C., Type 1

Remove Sidewalk Ramp
 12 Sq. Yd.
 Place 4" Conc. Sidewalk Ramp
 76 Sq. Ft.

Relocate Signal Pole
 (by Others)

TP#2
 D in Det on hydrant
 Sta. 8+75 Elev. 104.86

TP#3
 D in Det on hydrant
 Sta. 12+00 Elev. 105.03

& CONSTRUCTION CURVE DATA
 D=5.30'
 R=1042.14'
 T=208.37'
 P.C.=7+43.68
 P.L.=9+50.05
 P.T.=11+51.15

Prop. Curb Cut at Island nose
 (Typical Entire Project)
 (See Detail above)

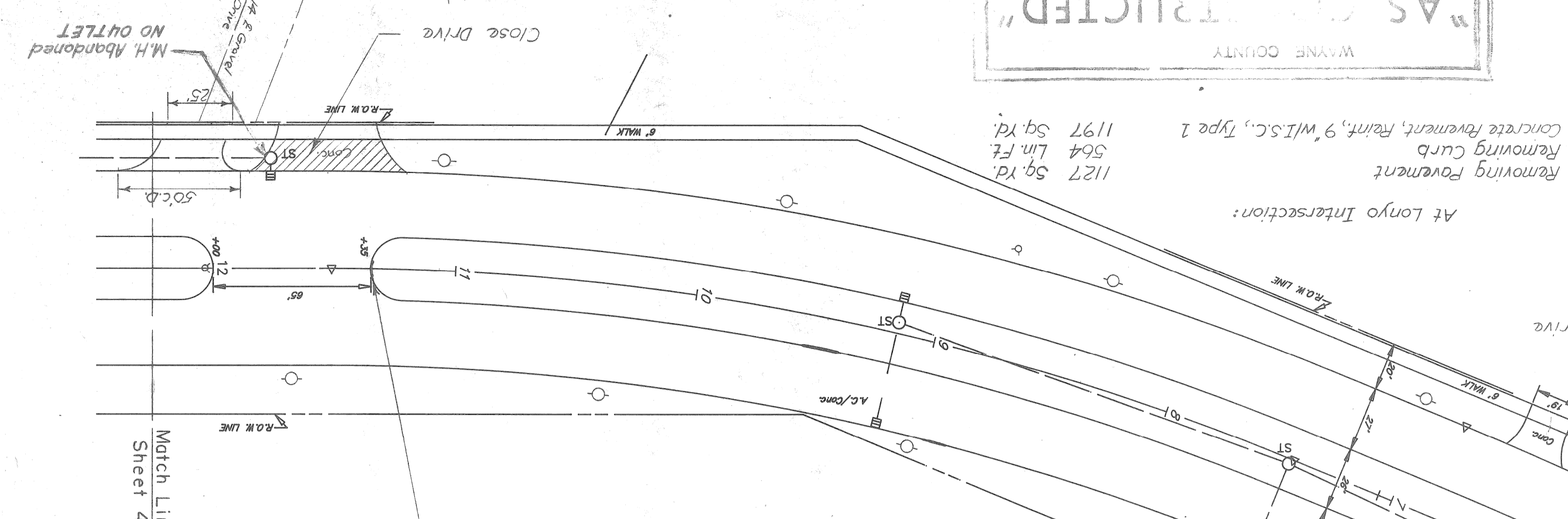

TP # 4
D in Det on hydrant
Sta 15+00[±] Elev 103.41
City of Detroit PBM # 3-251A
540 East/ Sharon E. R/W, # South/Dix N. R/W

TP # 5
D in Det on hydrant
Sta 20+62 Elev 101.35
CONSTRUCTION CURVE DATA
Δ = 4° 14' 15" R.
D = 1' 20"
R = 4297.28'
T = 158.99'
P.C. = 17420.76'
P.I. = 18489.75'
P.T. = 20+48.58'

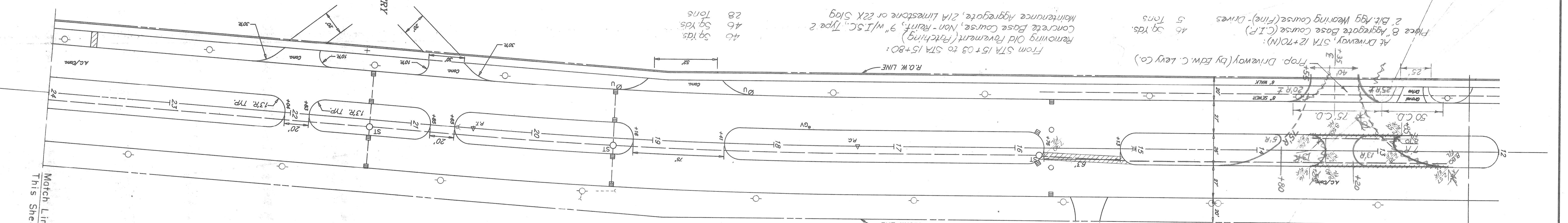

From STA 12+42 to STA 13+55:
183 Lin. Ft. Removing Curb
173 Cu. Yds. Earth Excavation
71 Cu. Yds. Special Subbase (C.I.P.)
Concrete Pavement, Reinf. 9" W.I.S.C., Type I
Edge Drains (C.S.P. or Bit. Fiber)
At Traffic Island:
Pavement poured as part of Stage I construction.
Sta 13+00 to Sta 13+55
Pavement poured and Island restored after completion of Stage III.
Sta 12+00 to Sta 13+00
Project Quantities:
Quantities for this work have been included in the

QUANTITIES (This Sheet For Information Only)
457 Tons Bituminous Aggregate Leaveling Course (Allowing R.A.P.)
1119 Tons Bituminous Aggregate Binder Course (Fine)
34 Each Adjusting Structures
3 Each Adjusting Water gate Riser Boxes
8192 L Ft Concrete Curb Cap
Removing Trees 8"-18" Dia.
1 Each

TP # 6
D in Det on hydrant
Sta 24+50m Elev 102.47
TP # 7
D in Det on hydrant
Sta 27+55m Elev 100.19
CONSTRUCTION CURVE DATA
Δ = 5° 00' 30" R.
D = 1' 20"
R = 4297.28'
T = 187.93'
P.C. = 32+72.65'
P.I. = 34+60.57'
P.T. = 36+48.28'

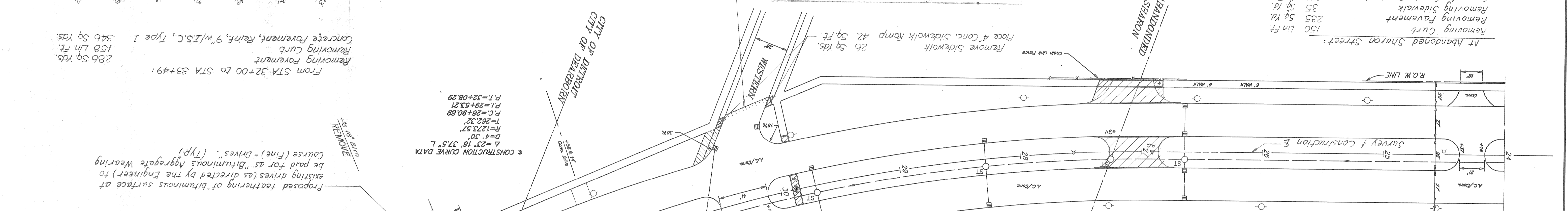

At Abandoned Sharon Street:
150 Lin. Ft. Removing Curb
235 Sq. Yd. Removing Pavement
35 Sq. Yd. Removing Sidewalk
216 L Ft. Concrete Curb, Straight
318 Sq. Ft. 4 Concrete Sidewalk.

"AS CONDUCTED"
WAYNE COUNTY
BY DTA
DATE 2-28-91

STAGE III

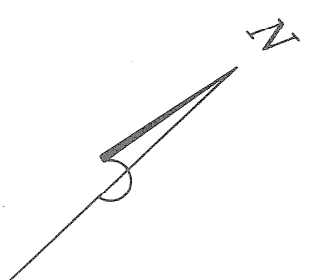
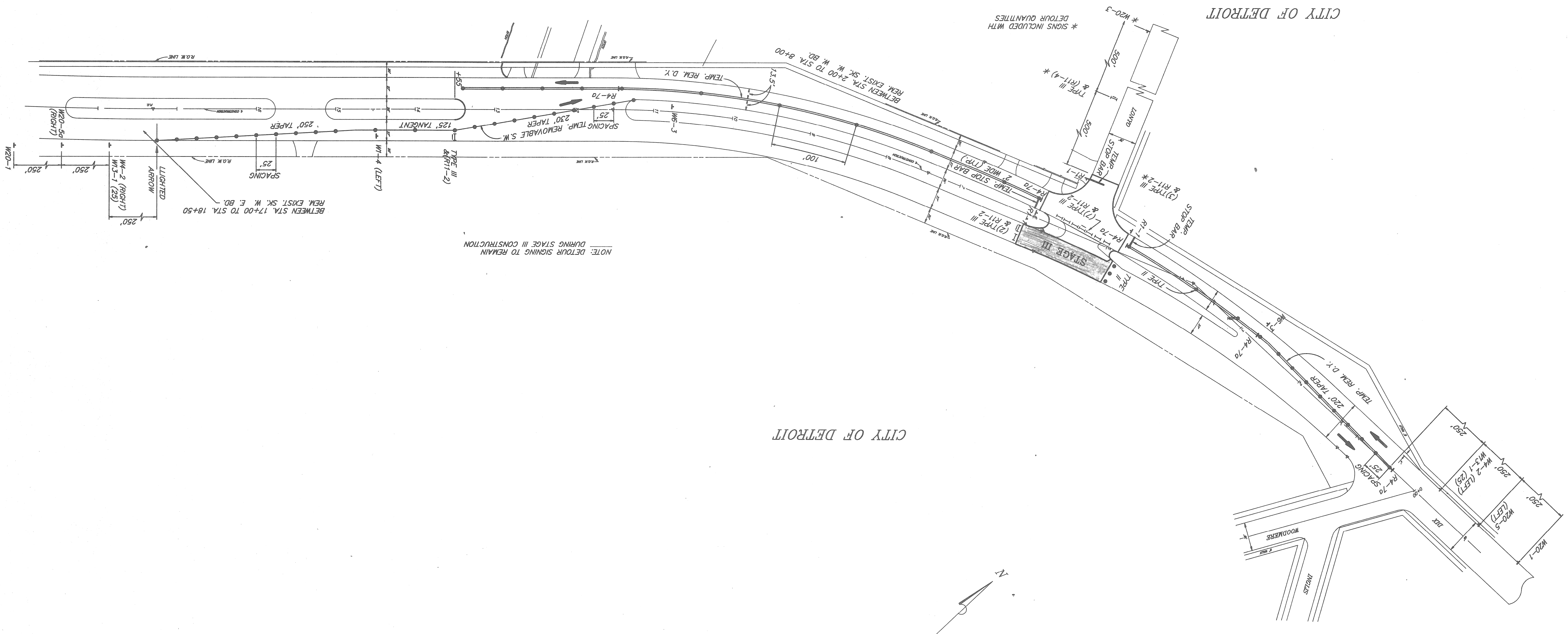

WOODMERE
INGALLS

WOODMERE
INGALLS

WOODMERE
INGALLS

WOODMERE
INGALLS

BY: DJA
DATE: 2-28-91
"AS NOTED" SCS

COLD PLASTIC QUANTITIES

1106 LFL	COLD PLASTIC PAVEMENT MARKING 4" YELLOW
2738 LFL	COLD PLASTIC PAVEMENT MARKING 4" WHITE
48 LFL	COLD PLASTIC PAVEMENT MARKING 24" WHITE (STOP BAR)
113 LFL	COLD PLASTIC PAVEMENT MARKING 6" WHITE (CROSSWALK)
38 LFL	COLD PLASTIC PAVEMENT MARKING 12" YELLOW

QUAN.

PERMANENT SIGNING

POSTS PER LOCATION	QUAN.	SIZE	LEGEND
5	2	36" x 10"	D3-1 VERNOR HWY
5	1	60" x 18"	D3-2 VERNOR HWY
1	2.5	1	
1	3	24" x 30"	R2-1 "35" SPEED LIMIT
1	15	1	
1	4	24" x 24"	R3-2 NO LEFT TURN
1	5	1	
1	9	36" x 12"	R4-7 KEEP RIGHT
1	1	1	
1	1	1	R6-1 ONE WAY
1	1	1	R8-3d NO PARKING (SYMBOL)
1	18	12" x 12"	S1-1 SCHOOL ADVANCE
1	18	36" x 36"	S2-1 SCHOOL CROSSING
1	18	36" x 36"	S3-2 STOP FOR SCHOOL BUS UNLOADING OR LOADING
1	7.5	30" x 36"	B "AT CANTERBURY" PANEL
1	3	24" x 18"	R1-1 STOP
1	6	30" x 30"	TOTAL
1	37	112	

* SIGNS TO BE FABRICATED WITH TYPE III ENCAPSULATED LENS REFLECTIVE SHEETING.

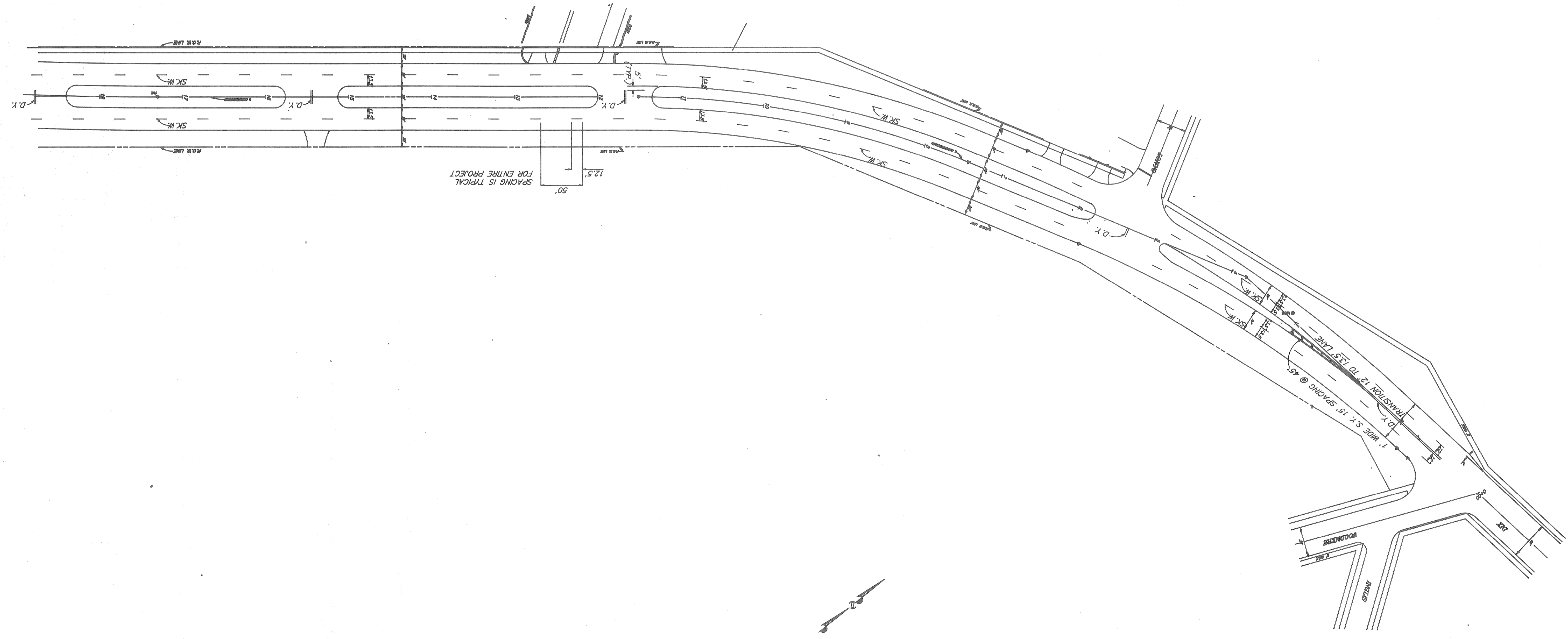

LANE LINE MARKING
 DIX AVENUE
 WOODMERE TO VERNOR HWY.

WAYNE COUNTY DEPARTMENT OF PUBLIC SERVICES
 ENGINEERING DIVISION

REVISIONS	DATE	BY	APPROVED
CORRECT	6-26-89	D.J.A.	DIVISION DESIGN ENGINEER
CORRECT			ASSISTANT DIVISION DESIGN ENGINEER
		D.F.H.	
		SQUAD LEADER	

WAYNE COUNTY
 "AS CONSTRUCTED"
 CHECKED BY: SLS DATE: 2-28-91
 BY: D.J.A.

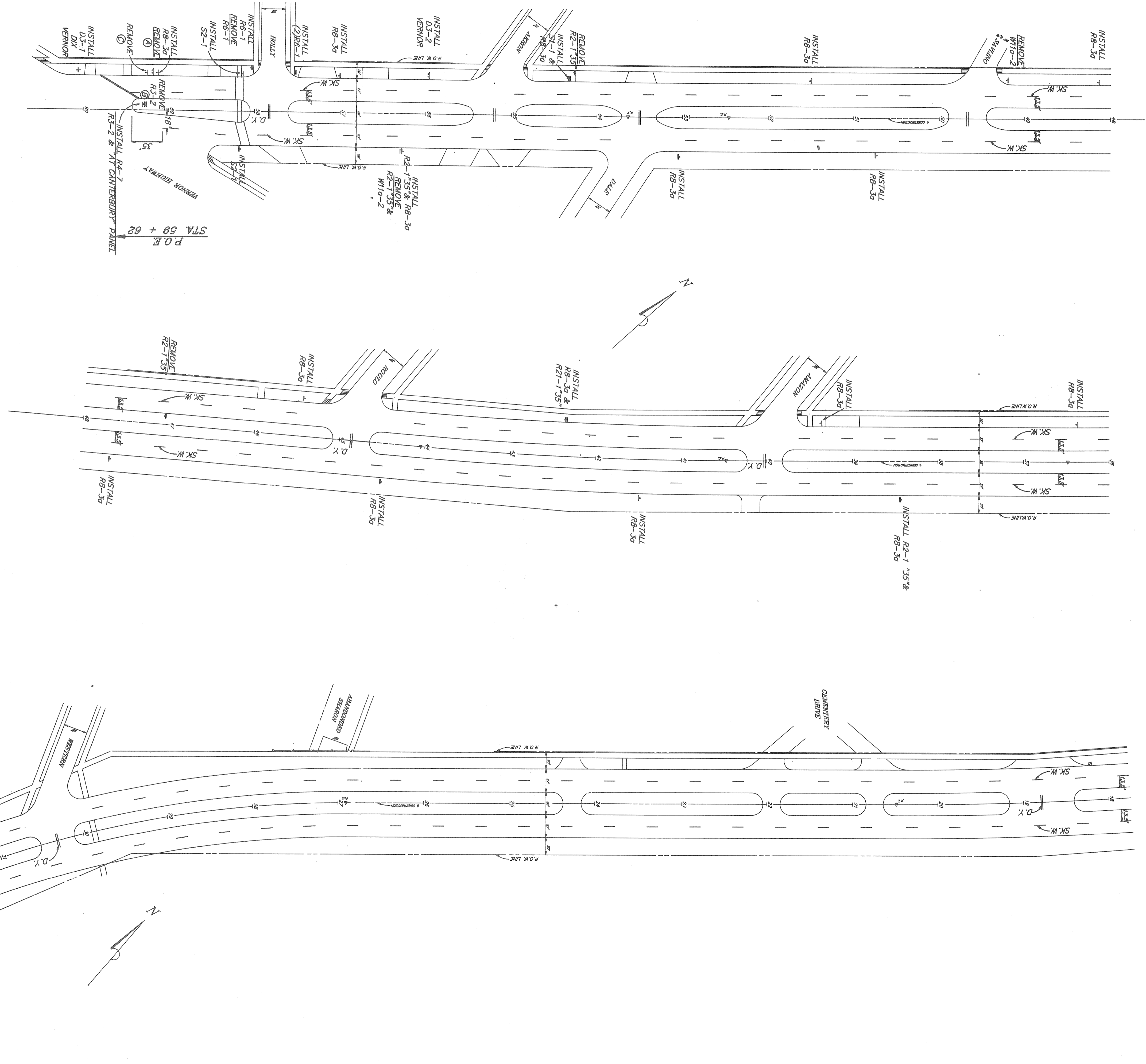

- SIGN REMOVAL LEGEND
- (A) DIX
 - (B) AT CANTERBURY
 - (C) \$500 FINE FOR THROWING TRASH ON HIGHWAY

