

SCHAEFER RD. - FORT ST. TO CAMPBELL ST.

BOARD OF
WAYNE COUNTY ROAD COMMISSIONERS
DETROIT, MICHIGAN

MICHAEL BERRY PHILIP J. NEUDECK FREDDIE G. BURTON

PLAN OF PROPOSED

RESURFACING PROJECTS

INDEX TO SHEETS

1. TITLE.

PROJECT 43034
GREENFIELD ROAD (ROUGE RIVER TO D.T. & I. R.R.)
2. TYPICAL CROSS-SECTION.
3. PLAN.

PROJECT 43038
WEST JEFFERSON (ECORSE CREEK TO NORTHLINE)
4. TYPICAL CROSS-SECTION.
5.-12. PLAN.

PROJECT 43048
OUTER DRIVE (ALLEN TO TOLEDO)
13. TYPICAL CROSS-SECTION.
14. & 15. PLAN.

PROJECT 43049
OUTER DRIVE (NINETEENTH TO HIGH)
16. TYPICAL CROSS-SECTION.
17. & 18. PLAN.

PROJECT 43051
SCHAEFER ROAD (FORT TO CAMPBELL)
19. TYPICAL CROSS-SECTION.
20. & 21. PLAN.

PROJECT 43052
SCHAEFER ROAD (CAMPBELL TO WEST JEFFERSON)
22. TYPICAL CROSS-SECTION.
23. & 24. PLAN.

PROJECT 43069
WYOMING AVENUE (MICHIGAN TO EAGLE WREN)
25. TYPICAL CROSS-SECTION.
26. PLAN.

PROJECT 43064
WARREN AVENUE (WYOMING TO E. DEARBORN LINE)
27. TYPICAL CROSS-SECTION.
28. PLAN.

STANDARD PLANS

29. ASPHALTIC CONCRETE RESURFACING DETAILS.
C-17-1A4.
C-17-1B3.
C-17-1E1.
C-17-1G1.

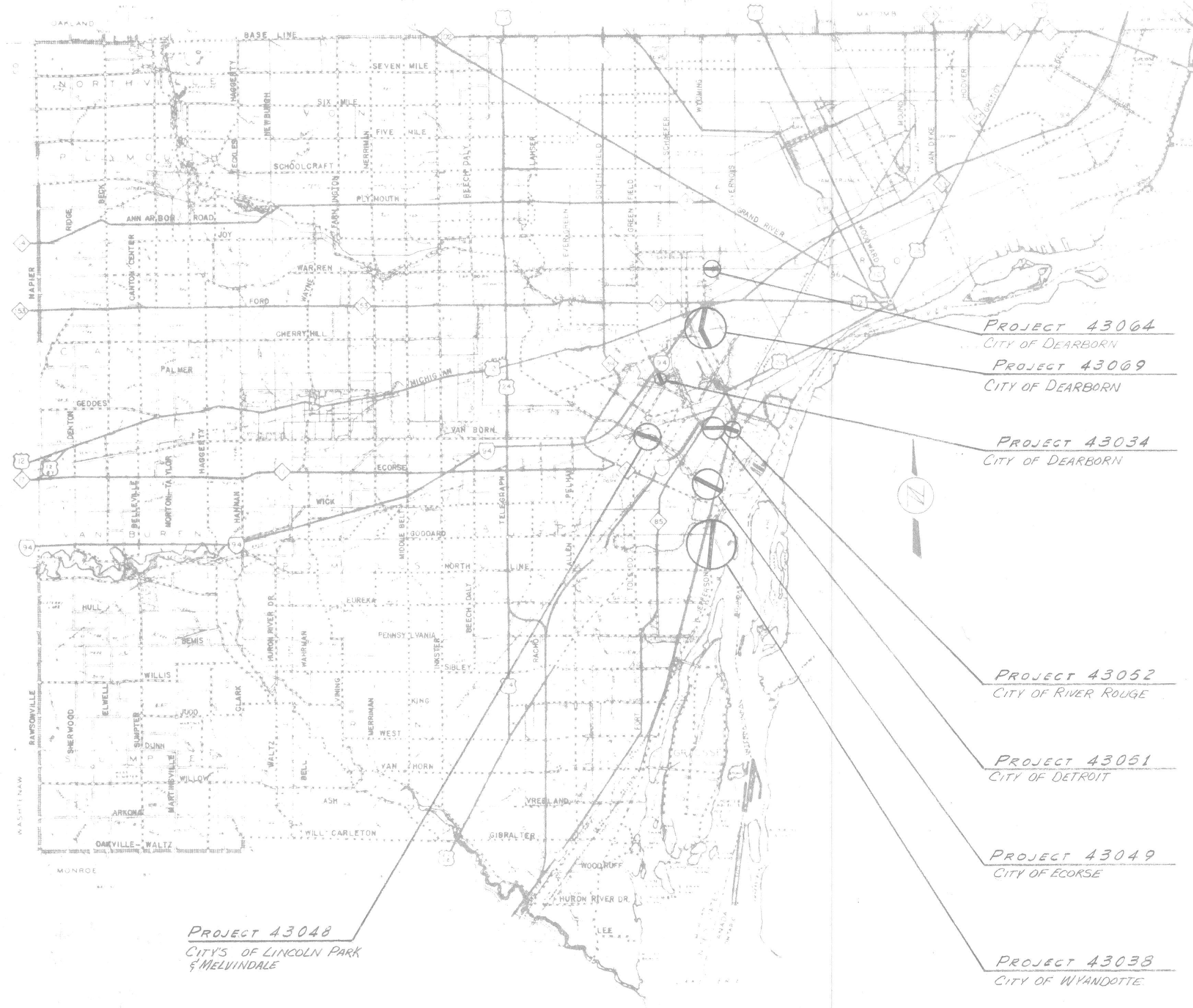

1972 A.C. PROJECTS

M. Jozaschi
W. Meyer

SCHAEFER ROAD

FORT ST TO CAMPBELL ST

TYPICAL CROSS-SECTION

SCALE 1" = 4'

| QUANTITIES | |
|---|---------------|
| ITEM | QUANTITY |
| REMOVING ASPHALT SURFACE | 872 Sq.Yd. |
| REMOVING ASPHALT SURFACE, PLANER METHOD. | 1600 Sq.Yd. |
| REMOVING SIDEWALK | Sq.Yd. |
| REMOVING OLD PAVEMENT (PATCHING) | 169 Sq.Yd. |
| REMOVING CURB (PATCHING) | 59 Lin.Ft. |
| ADJUSTING MANHOLE, FURNISHING COVER "A" | 1 EA. |
| ADJUSTING CATCH BASIN, FURNISHING COVER "X" | 1 EA. |
| ADJUSTING WATER SHUTOFF RISER BOX | EA. |
| ADJUSTING MONUMENT BOX | 3 EA. |
| RECONSTRUCTING M.H., C.B. OR W.G.W. | 5 Lin.Ft. |
| ADJUSTING COVERS | 50 EA. |
| 6" PIPE UNDERDRAIN | Lin.Ft. |
| CONCRETE PAVEMENT (PATCHING) | Sq.Yd. |
| CONCRETE CURB, STRAIGHT | 59 Lin.Ft. |
| INTEGRAL CONCRETE CURB AND WALK | 9 Lin.Ft. |
| AGGREGATE SHOULDER | Sq.Yd. |
| CALCIUM CHLORIDE, APPLIED | TONS |
| 4" CONCRETE SIDEWALK | Sq.Ft. |
| BITUMINOUS BOND COAT | 3773 GAL. |
| BITUMINOUS PRIME COAT | GAL. |
| NOTCHING CONCRETE PAVEMENT FOR JOINT | Lin.Ft. |
| PREPARING EXISTING PAVEMENT | 34 STA. |
| SAWED LONG PLANE OF WEAKNESS JOINT IN ASPHALTIC CONCRETE SURFACE | 13568 Lin.Ft. |
| CHIPPING EXISTING CONCRETE PAVEMENT | Sq.Yd. |
| (ESTIMATED QUANTITIES FOR ASPHALTIC CONCRETE MIXTURES ARE BASED ON THE USE OF NATURAL AGGREGATES) | |
| ASPH. CONC BINDER COURSE, 25A | 1281 TONS |
| ASPH. CONC BINDER COURSE, 9A | 2725 TONS |
| ASPH. CONC WEARING COURSE, 31A | 1530 TONS |
| ASPH. CONC BASE COURSE, 25A | 243 TONS |

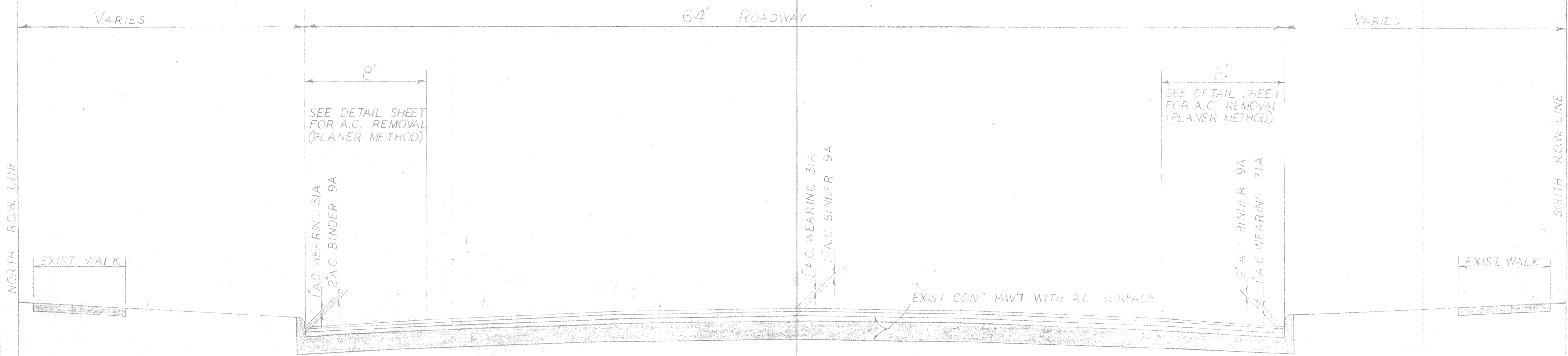

Note: BINDER COURSE, 9A OR 25A, WILL BE USED FOR WEDGING TO CORRECT MINOR DEPRESSIONS, AND ADVERSE CROWN CONDITIONS AS DIRECTED BY THE ENGINEER.

1972 AC PROJECT 43051

CORRECTED *R. J. Beck* Reg. Prof. Eng.
 APPROVED *[Signature]* Reg. Prof. Eng.
 Engineer of Highway Design



| REVISIONS | | | | | | | |
|-----------|------|----|------|-----|------|----|------|
| NO. | ITEM | BY | DATE | NO. | ITEM | BY | DATE |
| | | | | | | | |
| | | | | | | | |
| | | | | | | | |

BOARD OF WAYNE COUNTY ROAD COMMISSIONERS
 DETROIT 26, MICHIGAN

CHAIRMAN _____ VICE-CHAIRMAN _____
 COMMISSIONER _____

1972 AC PROJECT # 43051

SCALE 1" = 30'

DATE FEB 72

TRANSPORT BOOK

LEVEL BOOK

CORRECT *R. Bechler* REG. PRO. ENG.
 ASST. ENGINEER OF HIGHWAY DESIGN

APPROVED *[Signature]* REG. P.D. ENG.
 ENGINEER OF HIGHWAY DESIGN

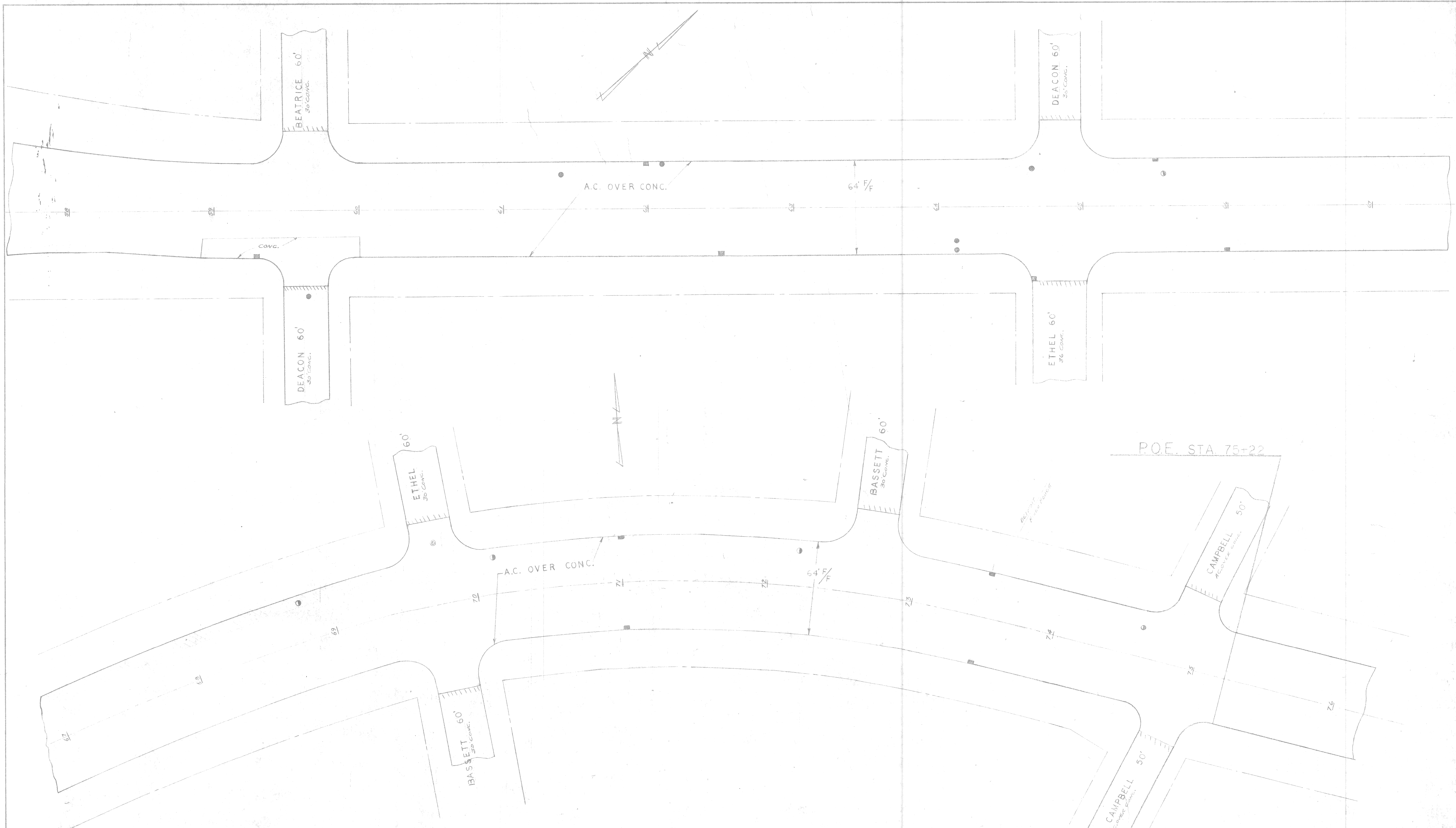

| REVISIONS | | | | | | | |
|-----------|------|----|------|-----|------|----|------|
| NO. | ITEM | BY | DATE | NO. | ITEM | BY | DATE |
| | | | | | | | |
| | | | | | | | |
| | | | | | | | |

BOARD OF
WAYNE COUNTY ROAD COMMISSIONERS
DETROIT 26, MICHIGAN

CHAIRMAN: _____ VICE-CHAIRMAN: _____
COMMISSIONER: _____

1972 AC PROJECT #43051
SCALE 1" = 30'
DATE FEB 72
TRANSIT BOOK _____
LEVEL BOOK _____

CORRECT *R. B. B...* REG. PRO. ENG.
APPROVED *[Signature]* ASST. ENGINEER OF HIGHWAY DESIGN
CONTRACTOR OF HIGHWAY DESIGN