

NO.	ITEM	BY	DATE
1	As Constructed	W. J. S.	11/2/57
2			
3			
4			
5			
6			
7			
8			
9			
10			
11			
12			
13			
14			
15			
16			
17			
18			
19			
20			
21			
22			
23			
24			
25			
26			
27			
28			
29			
30			
31			
32			
33			
34			
35			
36			
37			
38			
39			
40			
41			
42			
43			
44			
45			
46			
47			
48			
49			
50			
51			
52			
53			
54			
55			
56			
57			
58			
59			
60			
61			
62			
63			
64			
65			
66			
67			
68			
69			
70			
71			
72			
73			
74			
75			
76			
77			
78			
79			
80			

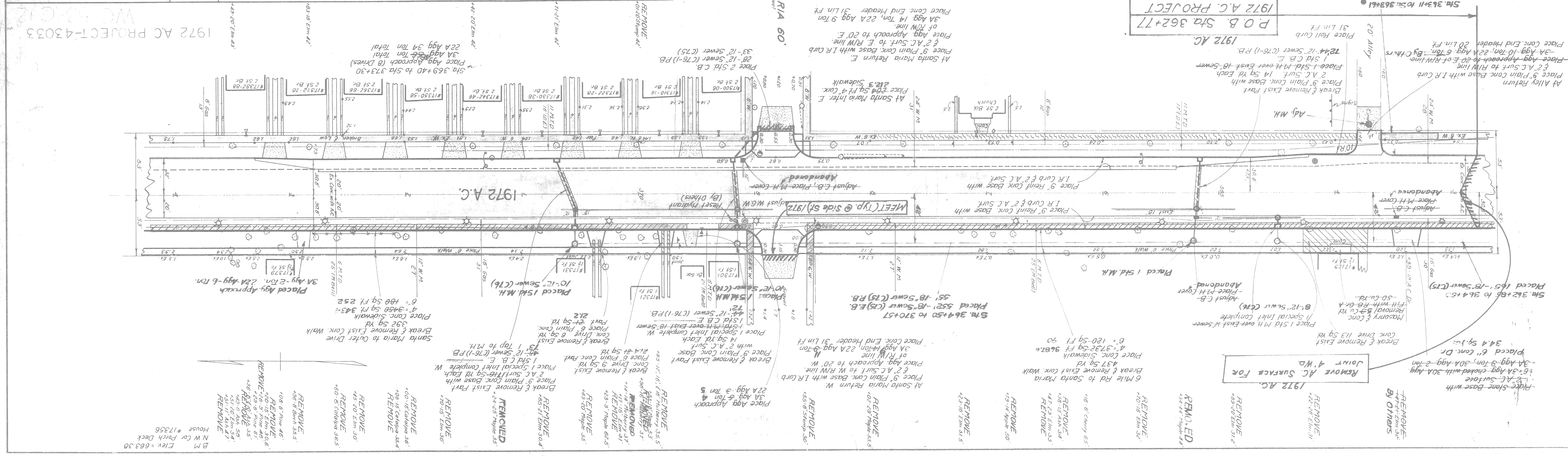

REMOVE 10-12" Sewer (C76)
 REMOVE 18" Sewer (C75) RB
 REMOVE 22" Sewer (C74) RB
 REMOVE 10-12" Sewer (C73) RB
 REMOVE 18" Sewer (C72) RB
 REMOVE 22" Sewer (C71) RB
 REMOVE 10-12" Sewer (C70) RB
 REMOVE 18" Sewer (C69) RB
 REMOVE 22" Sewer (C68) RB
 REMOVE 10-12" Sewer (C67) RB
 REMOVE 18" Sewer (C66) RB
 REMOVE 22" Sewer (C65) RB
 REMOVE 10-12" Sewer (C64) RB
 REMOVE 18" Sewer (C63) RB
 REMOVE 22" Sewer (C62) RB
 REMOVE 10-12" Sewer (C61) RB
 REMOVE 18" Sewer (C60) RB
 REMOVE 22" Sewer (C59) RB
 REMOVE 10-12" Sewer (C58) RB
 REMOVE 18" Sewer (C57) RB
 REMOVE 22" Sewer (C56) RB
 REMOVE 10-12" Sewer (C55) RB
 REMOVE 18" Sewer (C54) RB
 REMOVE 22" Sewer (C53) RB
 REMOVE 10-12" Sewer (C52) RB
 REMOVE 18" Sewer (C51) RB
 REMOVE 22" Sewer (C50) RB
 REMOVE 10-12" Sewer (C49) RB
 REMOVE 18" Sewer (C48) RB
 REMOVE 22" Sewer (C47) RB
 REMOVE 10-12" Sewer (C46) RB
 REMOVE 18" Sewer (C45) RB
 REMOVE 22" Sewer (C44) RB
 REMOVE 10-12" Sewer (C43) RB
 REMOVE 18" Sewer (C42) RB
 REMOVE 22" Sewer (C41) RB
 REMOVE 10-12" Sewer (C40) RB
 REMOVE 18" Sewer (C39) RB
 REMOVE 22" Sewer (C38) RB
 REMOVE 10-12" Sewer (C37) RB
 REMOVE 18" Sewer (C36) RB
 REMOVE 22" Sewer (C35) RB
 REMOVE 10-12" Sewer (C34) RB
 REMOVE 18" Sewer (C33) RB
 REMOVE 22" Sewer (C32) RB
 REMOVE 10-12" Sewer (C31) RB
 REMOVE 18" Sewer (C30) RB
 REMOVE 22" Sewer (C29) RB
 REMOVE 10-12" Sewer (C28) RB
 REMOVE 18" Sewer (C27) RB
 REMOVE 22" Sewer (C26) RB
 REMOVE 10-12" Sewer (C25) RB
 REMOVE 18" Sewer (C24) RB
 REMOVE 22" Sewer (C23) RB
 REMOVE 10-12" Sewer (C22) RB
 REMOVE 18" Sewer (C21) RB
 REMOVE 22" Sewer (C20) RB
 REMOVE 10-12" Sewer (C19) RB
 REMOVE 18" Sewer (C18) RB
 REMOVE 22" Sewer (C17) RB
 REMOVE 10-12" Sewer (C16) RB
 REMOVE 18" Sewer (C15) RB
 REMOVE 22" Sewer (C14) RB
 REMOVE 10-12" Sewer (C13) RB
 REMOVE 18" Sewer (C12) RB
 REMOVE 22" Sewer (C11) RB
 REMOVE 10-12" Sewer (C10) RB
 REMOVE 18" Sewer (C9) RB
 REMOVE 22" Sewer (C8) RB
 REMOVE 10-12" Sewer (C7) RB
 REMOVE 18" Sewer (C6) RB
 REMOVE 22" Sewer (C5) RB
 REMOVE 10-12" Sewer (C4) RB
 REMOVE 18" Sewer (C3) RB
 REMOVE 22" Sewer (C2) RB
 REMOVE 10-12" Sewer (C1) RB

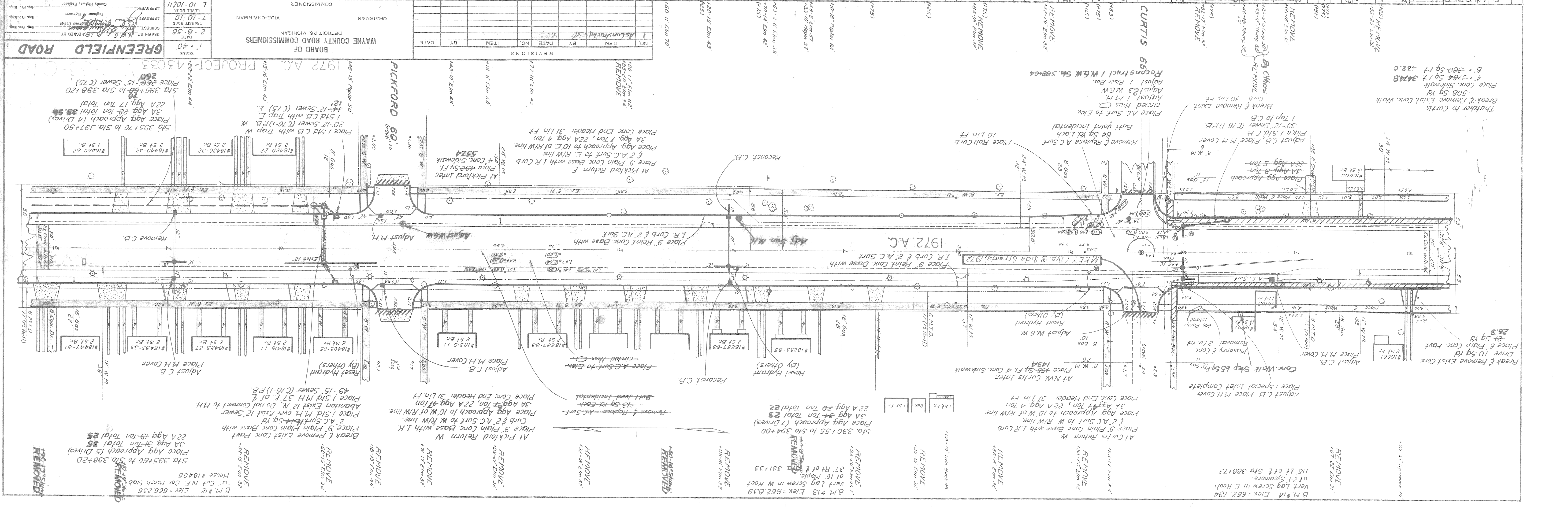
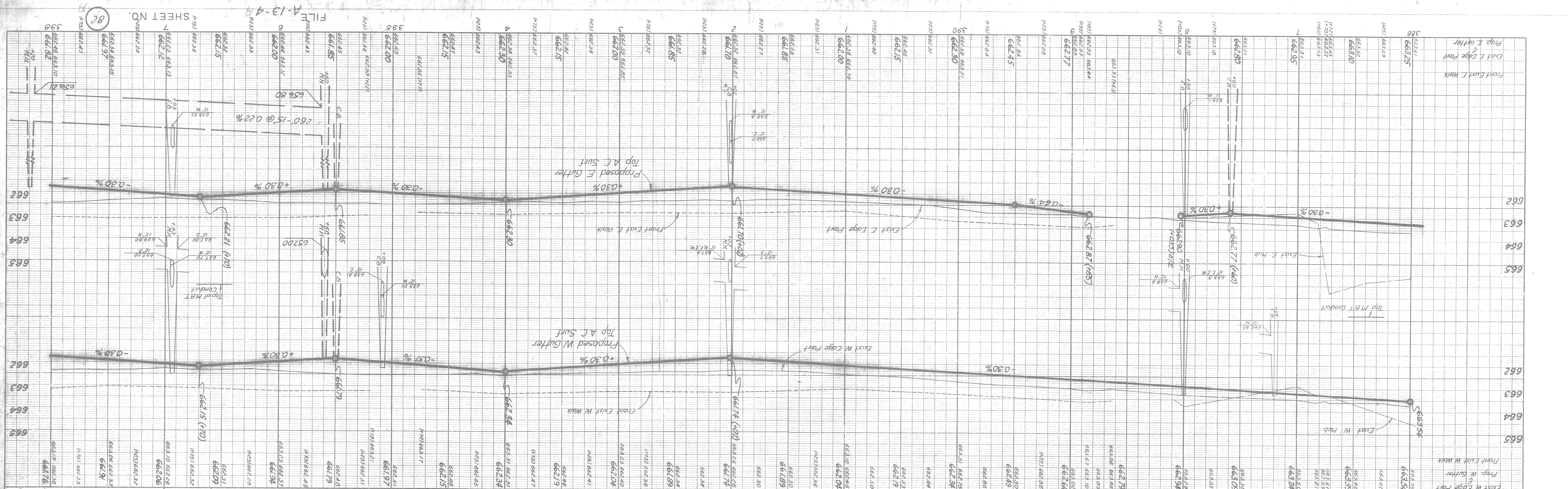

1972 A.C. PROJECT-43033
 PICKFORD 60' ROAD
 1972 A.C. PROJECT-43033
 1972 A.C. PROJECT-43033
 1972 A.C. PROJECT-43033

