

STER DR. EAST - CONNER TO CHALMERS

WAYNE COUNTY  
OFFICE OF PUBLIC SERVICES  
IN CO-OPERATION WITH  
MICHIGAN DEPARTMENT OF TRANSPORTATION  
AND  
FEDERAL HIGHWAY ADMINISTRATION  
PLAN AND PROFILE OF PROPOSED  
FEDERAL AID URBAN  
PROJECT NO MICHIGAN MR 2000 (240) and (242)  
CONTROL SECTION MUR 82400 JOB NO 22176A AND 22177A

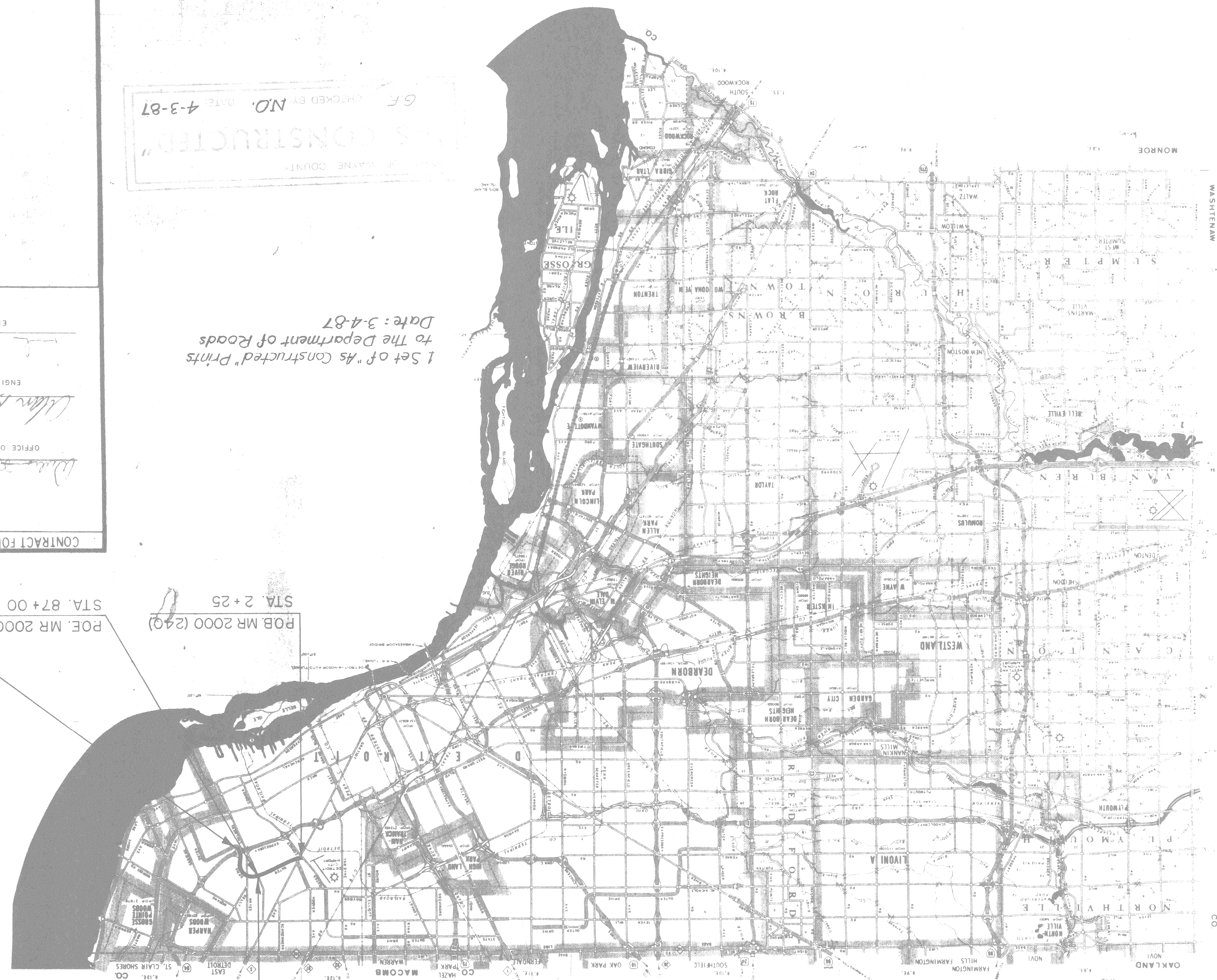

**OUTER DRIVE EAST  
CONNER TO CHALMERS**

Fed. Item No. UF 1236

TRAFFIC DATA

1984	8,000	400	40
2004	10,000	500	40

ADT (Two Way) 8,000  
D.H.V. (One Way) 400  
DESIGN SPEED 40 MPH

**OUTER DRIVE EAST  
CHALMERS TO CHANDLER PARK**

Fed. Item No. UF 1238

TRAFFIC DATA

1984	8,000	400	40
2004	10,000	500	40

ADT (Two Way) 8,000  
D.H.V. (One Way) 400  
DESIGN SPEED 40 MPH

- COUNTY STANDARD PLANS
- C-17-1A-A
  - C-17-1B-B
  - C-17-1C-C
  - C-17-1D-D
  - C-17-1E-E
  - C-17-1F-F
- MDOT STANDARD PLANS
- II-29-D
  - II-39-G (SPECIAL)
  - II-41-D (SPECIAL)
  - VI-124-C
  - VI-125-F

- INDEX OF SHEETS
- 1 TITLE SHEET
  - 2 QUANTITY SHEET
- CONNER TO CHALMERS MR 2000 (240)  
102 TYPICAL CROSS SECTIONS  
103-105 PLANS
- CHALMERS TO CHANDLER PK. MR 2000 (242)  
202 TYPICAL CROSS SECTIONS  
203-206 PLANS

CONTRACT FOR BITUMINOUS CONCRETE RESURFACING

WAYNE COUNTY APPROVAL

DATE 11-19-87

DIRECTOR OF PUBLIC SERVICES

DATE 11-13-84

DIRECTOR ENGINEERING DEPARTMENT

DATE 11-13-1984

ENGINEER OF DESIGN

PREPARED UNDER SUPERVISION OF

STATE OF MICHIGAN  
REGISTRATION NO. 07330  
ENGINEER

WAYNE COUNTY OFFICE OF PUBLIC SERVICES  
ENGINEERING DEPARTMENT  
415 CLIFFORD DETROIT, MICHIGAN, 48226  
ADDRESS

(SEAL)

B-10-2

DATE 4-3-87  
NO. 4-3-87  
CHECKED BY G.F.  
"AS CONSTRUCTED"

MR 2000 (240)	WAYNE	DETROIT	1	11
and (242)				
FED. PROJ. NO.		CITY	SHEET NO.	TOTAL SHEETS

THE IMPROVEMENTS COVERED BY THESE PLANS SHALL BE DONE IN ACCORDANCE WITH THE MICHIGAN DEPARTMENT OF TRANSPORTATION CURRENT STANDARD SPECIFICATIONS AND SUPPLEMENTAL SPECIFICATIONS

MR 2000 (240) MUR 82400 JOB NO. 22176A FED. ITEM NO. UF 1236 & MR 2000 (242) MUR 82400 JOB NO. 22177A FED. ITEM NO. UF 1238

# TYPICAL CROSS-SECTIONS

## OUTER DRIVE EAST CONNER to CHALMERS

SCALE: 1" = 4'

NOTES

F.H.W.A. REGION NO.	11
F.H.W.A. STATE	MICH.
FEDERAL PROJ. NO.	2000(240)
FEDERAL FISCAL YEAR	1985
STATE PROJECT CITY	WAYNE DETROIT
ROUTE PROJECT COUNTY	MUR 82400
SHEET TOTAL	11
SHEET NO.	102

- Remove Bituminous Concrete Surface (Milling Method) as shown on the Plans or as Directed by the Engineer.
- Remove Deteriorated Concrete by Compressed Air or Other Approved Method and Fill Voids with Bituminous Material. Paid for as Bit Surface Mix No. 12 W.M. (As Directed by the Engineer.) 250 Ton (Est.) of Mix No. 12 W.M. has been provided for the Entire Project. Removal of Deteriorated Concrete incidental to Removal of Bituminous Surface. (Milling Method)
- P.O.B. to P.O.E. Place 3" Topsoil Class "A" Seeding, Mulching & Chemical Fertilizer (As Directed by the Engineer) Removal of Overburden is incidental to Topsoil
- Remove Bituminous Concrete Surface (Milling Method) where existing curb to remain not shown on the Plans. Applies only for 25% of this Project.
- Where existing curb to remain. Place 3" Topsoil Class "A" Seeding, Mulching & Chemical Fertilizer (As Directed by the Engineer) Removal of Overburden is incidental to Topsoil.
- Restoration of this area is incidental to this Project. Topsoil Surface 3" Class "A" Seeding Mix No. 1, Mulching \* 8' or as Directed by the Engineer & Chemical Fertilizer Nutrient.
- Mill 3" @ Gutter

- Restoration of this area is incidental to this Project. Topsoil Surface 3" Class "A" Seeding Mix No. 1, Mulching \* 8' or as Directed by the Engineer & Chemical Fertilizer Nutrient.
- Mill 3" @ Gutter

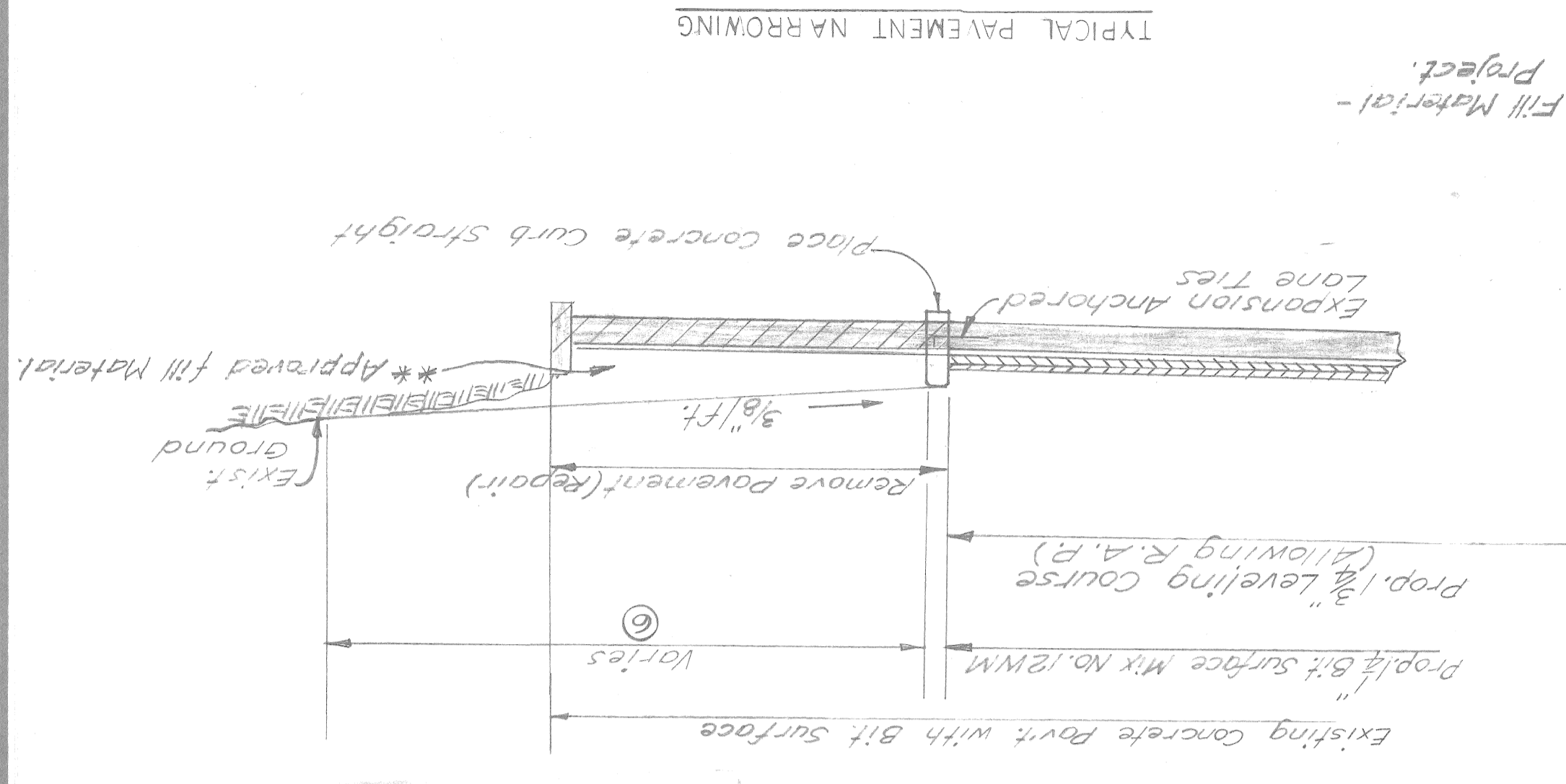
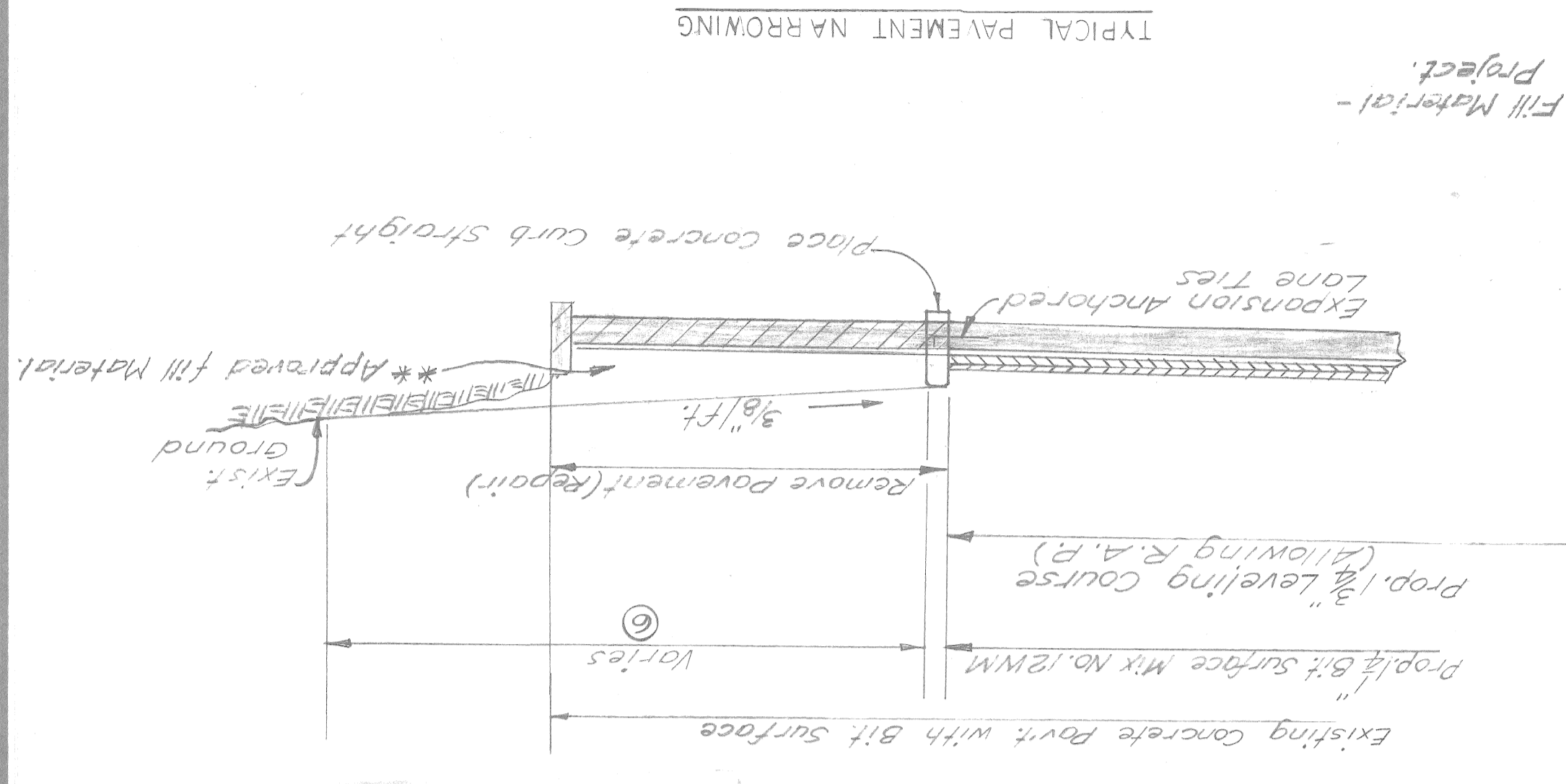
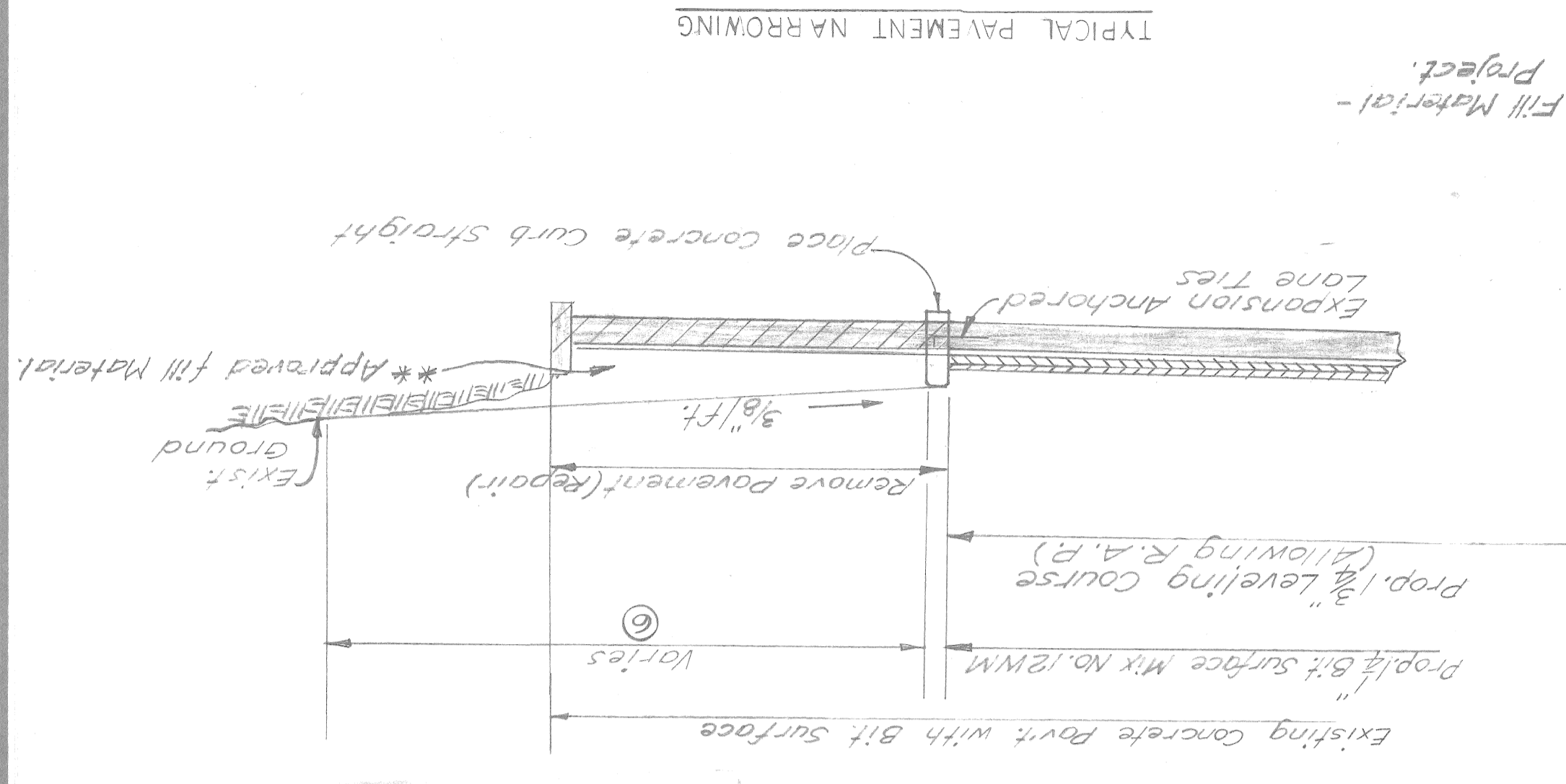

### Sta. 2+25 to Sta. 87+00

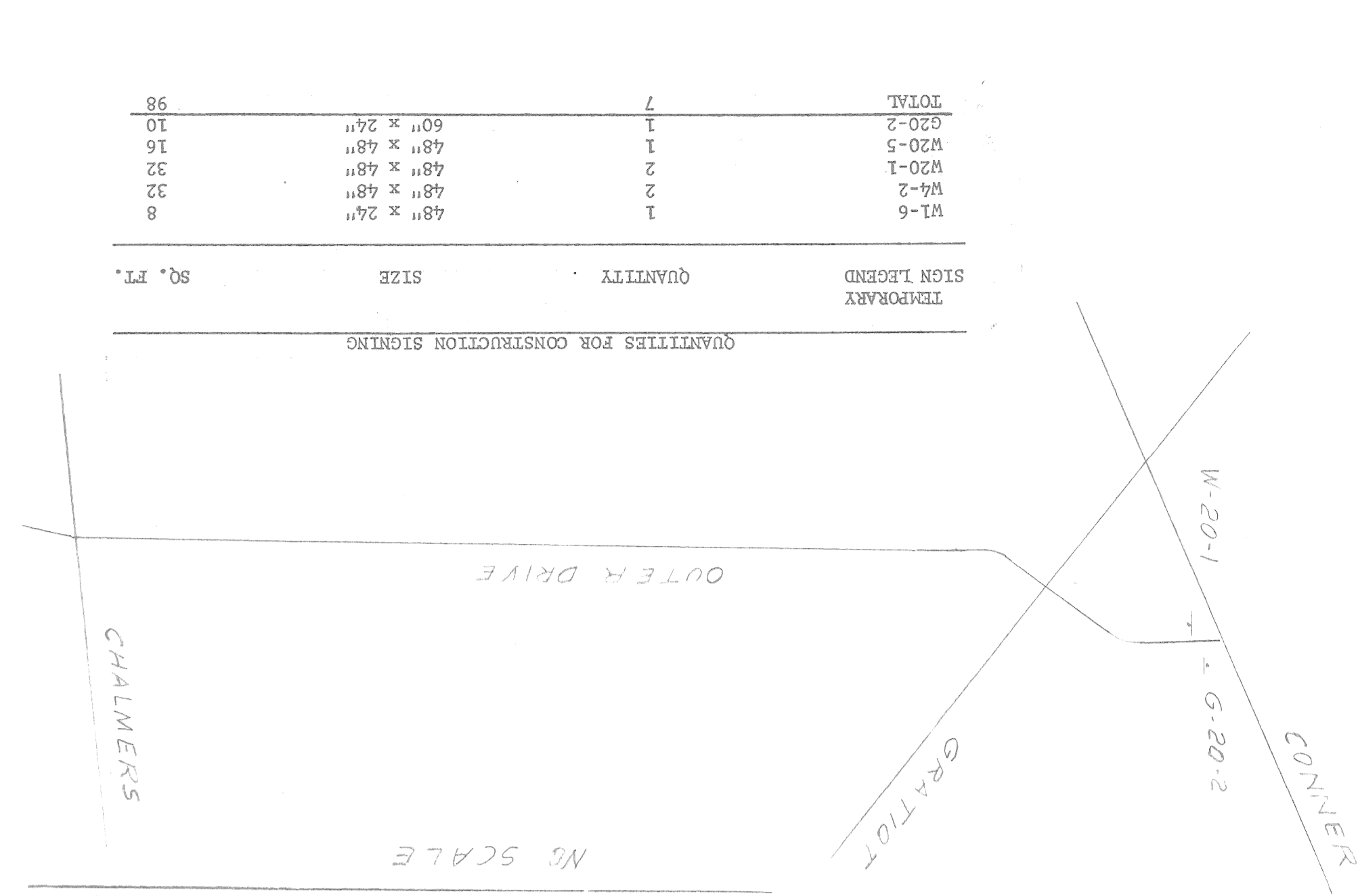
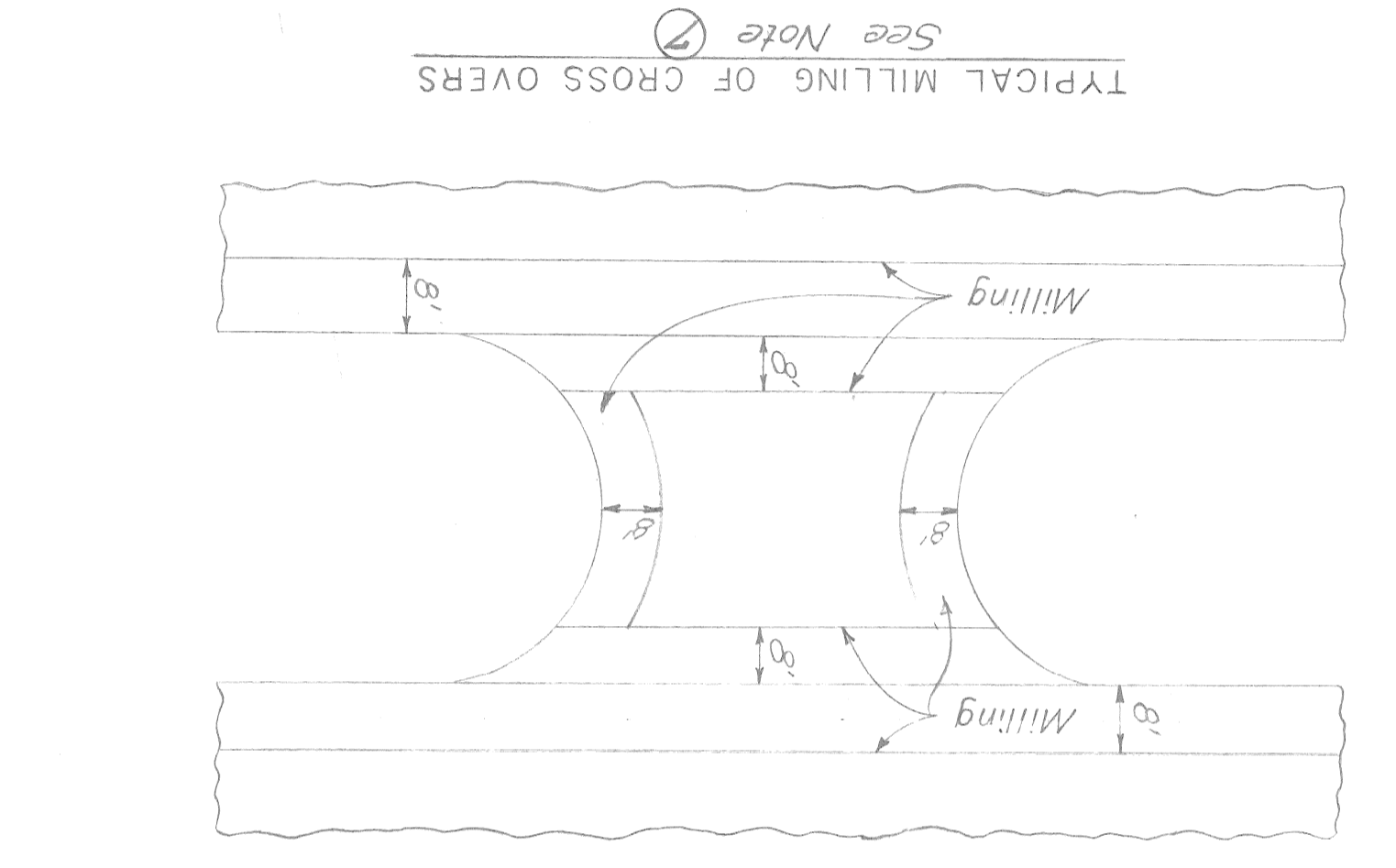
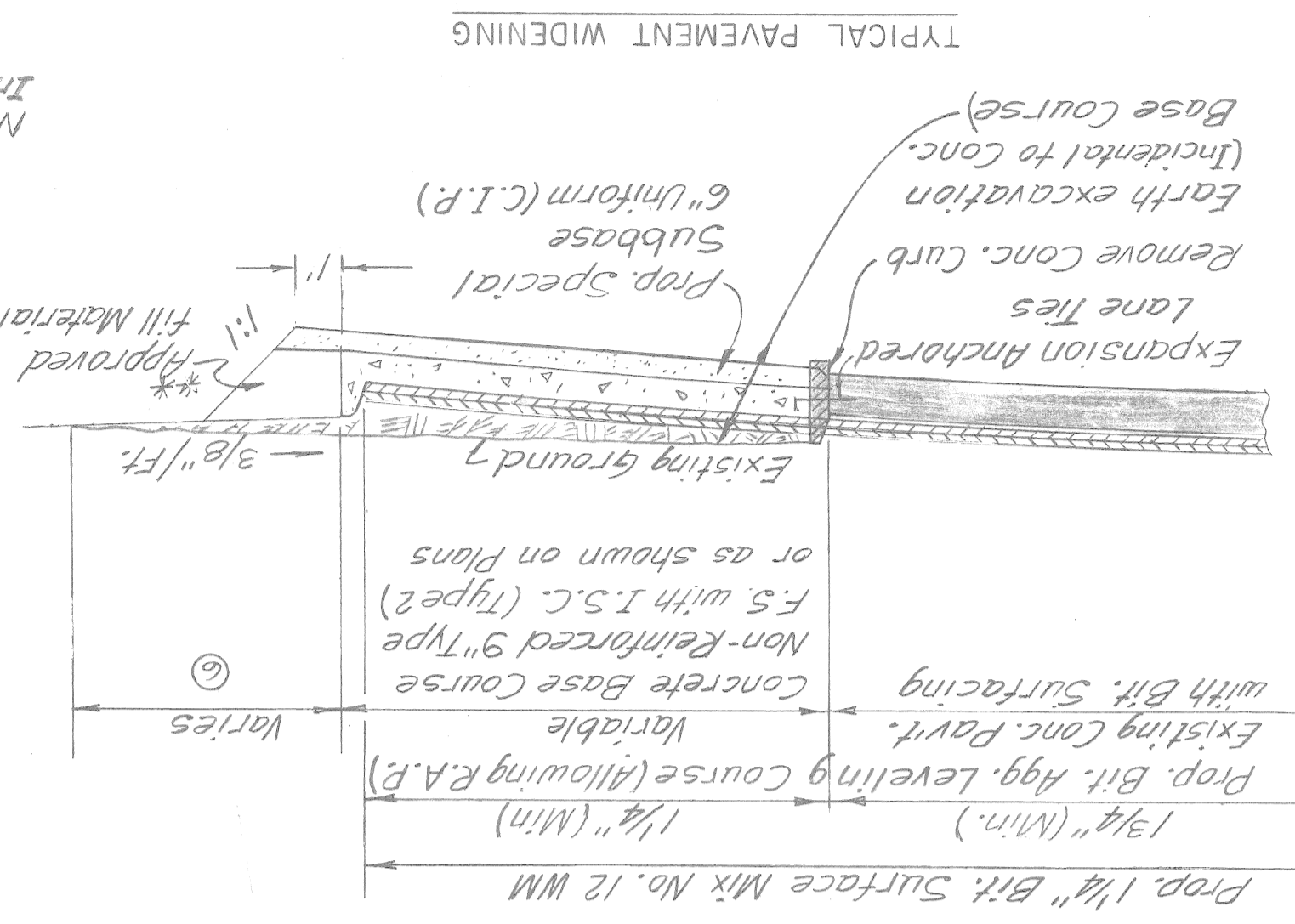
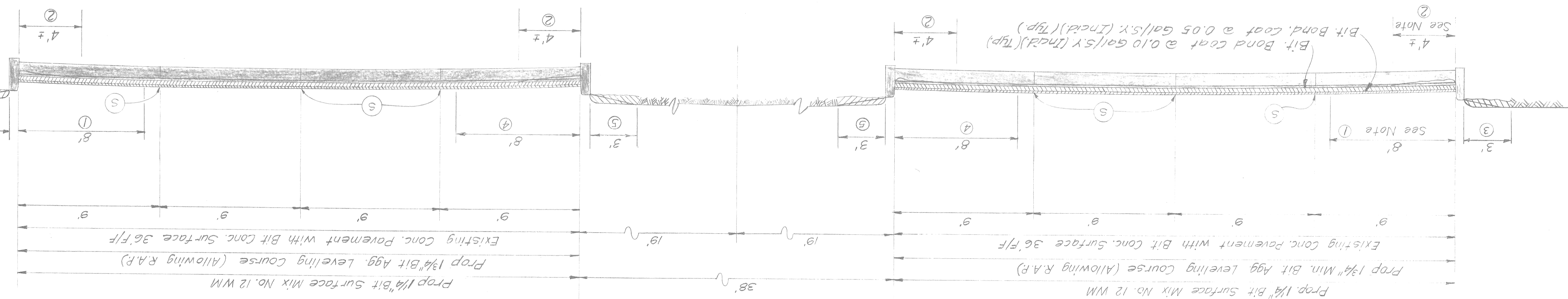

TEMPORARY SIGN LEGEND	QUANTITY	SIZE	SQ. FT.
W1-6	1	48" x 24"	8
W4-2	2	48" x 48"	32
W20-1	2	48" x 48"	32
W20-5	1	48" x 48"	16
G20-2	1	60" x 24"	10
TOTAL	7		98

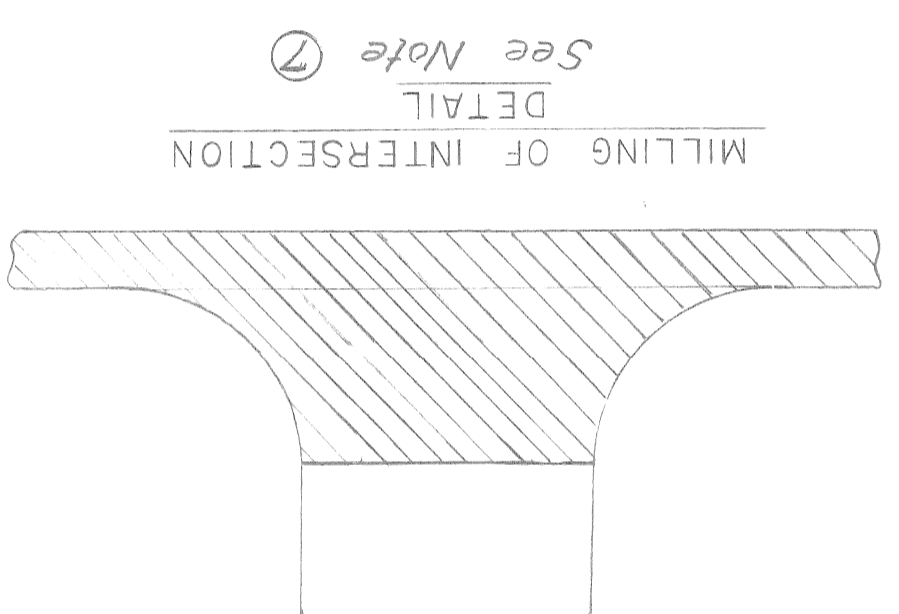
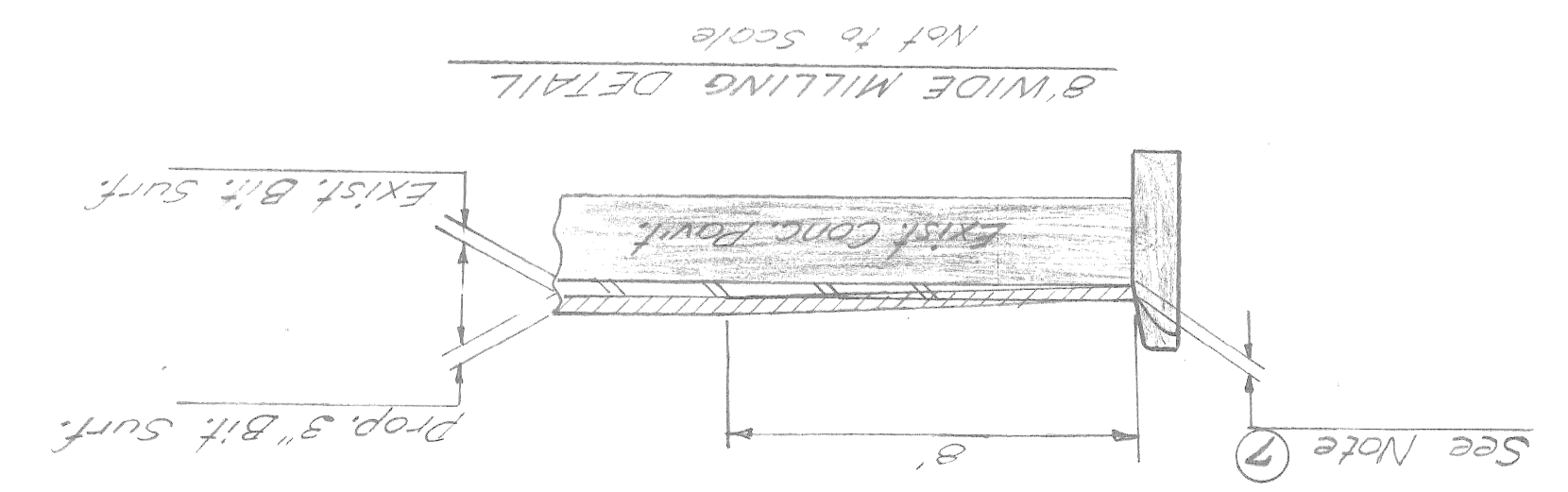



DATE 5-16-84  
 SCALE 1" = 40'  
 CONT. SEC. MUR 82400  
 JOB NO. 22176  
 DESIGN UNIT  
 R. O. W. CONST. 103

OUTER DRIVE EAST-CONNER TO CHALMERS

AS CONSTRUCTED  
 CHECKED BY N.O. 3-4-87  
 G.F.

BOOK: T-16-22

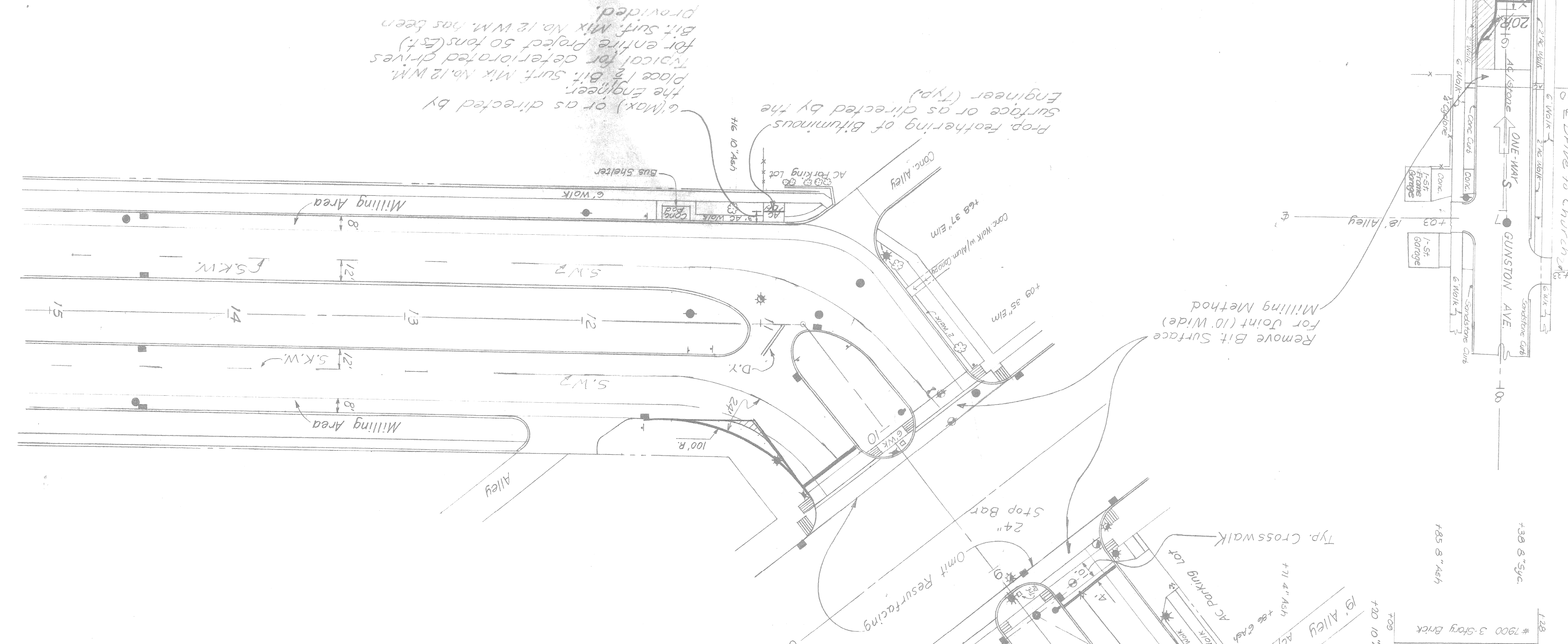
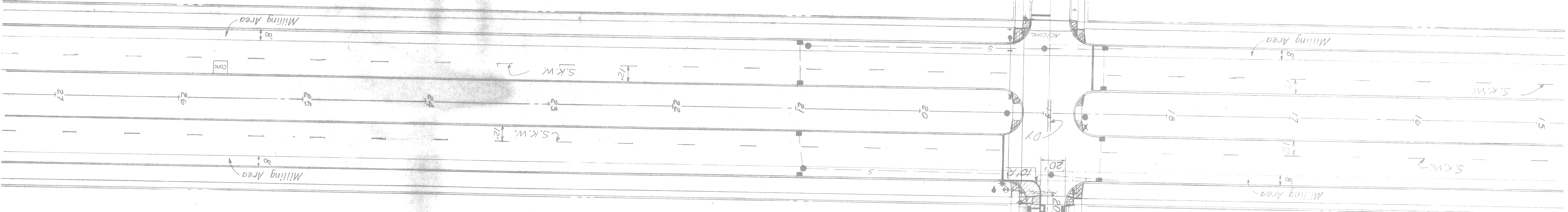

\* Top To Existing Structure Incidental

UNIT	EA. N.	EA. S.	WB. N.	WB. N.	WB. N.	WB. N.	WB. N.	WB. N.	WB. N.	WB. N.	WB. N.	WB. N.	WB. N.	WB. N.	WB. N.	WB. N.	WB. N.	WB. N.	WB. N.
Remove Curb	L.F.	64																	
Remove Sidewalk	S.Y.	14																	
Remove Pavement	S.Y.	74																	
Remove Pavement (Repair)	S.Y.	46	5	85															
Adjust C.B., Furnish Cover A"	EA.	1																	
Place Concrete Curb, Straight	L.F.	78																	
Concrete Base Course (Patching)	L.F.	96	25	55															
9" Non-Reinf. W.I.S.C. Type F.5	S.Y.	14	35	5	42	29													
Expansion Anchored Lane Ties	EA.	25	31	30	30	30													
4" Concrete Sidewalk Ramps	S.F.	108																	
12" Sewer C76 II Trench "A" *	L.F.	467	15.8																
Catch Basin "A" (Over Exist. Sewer)	EA.	1																	
Remove C.B.	EA.	1																	
Remove 12" Sewer	L.F.	1																	
Catch Basin "A"	EA.																		
Conc. Curb Cap (Patching)	L.F.	42	32																

Prop. feathering of bituminous surface or as directed by the Engineer (TYP)  
 (Max.) or as directed by the Engineer.  
 place 1 1/2" Bit. Surf. Mix No. 12 W.M. for deferred drives  
 for entire project 50 tons (5 ft) Bit. Surf. Mix No. 12 W.M. has been provided.

Remove Bit Surface For Joint (10' Wide) Milling Method

NOTE: All Stop Bars, Crosswalks & Double Yellow Markings at Two Way Crossovers to be Performed Thermoplastic

NOTE: All Crosswalks To Be 10' Wide

FINAL ROW	REVISION	DATE	NO.	BY

406 1" Stamp  
 +77 0" Elevation  
 +79 8" Elevation  
 +99 5" Elevation  
 +98 9" Elevation  
 +40 6" Elevation  
 +47 12" Elevation  
 +56 14" Elevation  
 +75 22" Elevation

Remove Bit Surface For Joint (10' Wide) Milling Method



DICKERSON AVE INTERSECTION		BARRETT, ROSEBERRY, ANNSBURY & PARKDRIVE	
94	S.Y.	17	S.Y.
2	Ea.	2	Ea.
100	L.F.	100	L.F.
54	Ea.	54	Ea.
180	S.F.	180	S.F.
370	S.F.	370	S.F.
28	L.F.	28	L.F.
Remove Pavement (Repair)		Remove Sidewalk	
Adjust C.B. Furnish Cover "A"		Place Conc. Curb, Straight	
Conc. Base Course, (Patching)		9" Non-Reinf. w/ISC, Type F.S.	
(Include Detail "A")		Expansion Anchored Lane Ties	
4" Conc. Sidewalk Ramps		4" Conc. Sidewalk	
Conc. Curb Cap (Patching)		1463 S.F.	
		304 L.F.	

DATE	5-16-84	SCALE	1" = 40'	CONTRACT NO.	MUR 82400	JOB NO.	22176
DESIGN UNIT	OUTER DRIVE EAST - CONNER TO CHALMERS						
SHEET NO.	104						

DESIGNED BY: GF  
 CHECKED BY: N.O.  
 DATE: 3-4-87

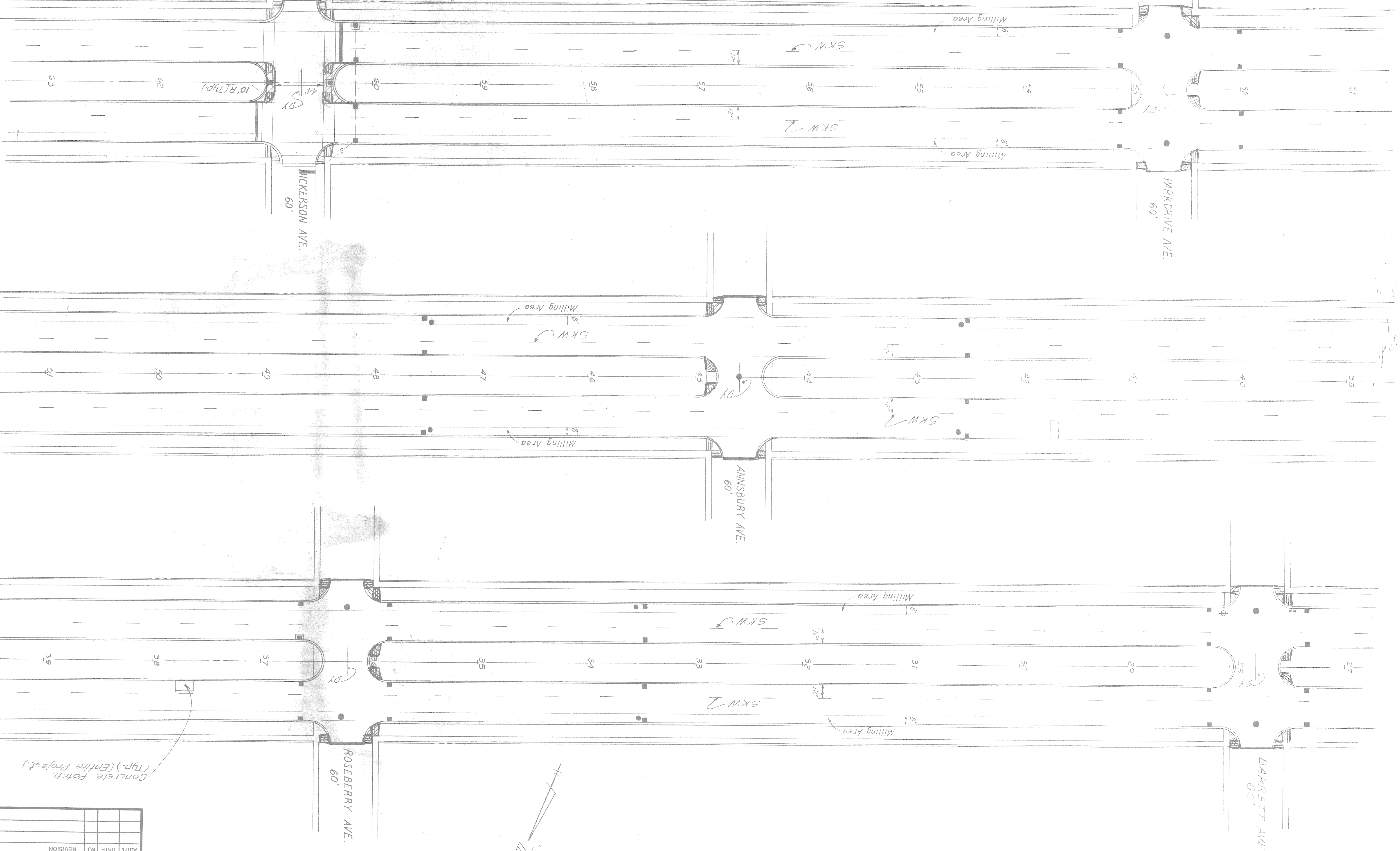

Concrete Patch (Typ.) (Entire Project.)

FINAL ROW				
REVISION				
NO.				
DATE				
AUTH.				



DATE 5-16-84  
 SCALE 1" = 40'  
 CONT. SEC. MUR 82400  
 JOB NO. 22176  
 DESIGN UNIT  
 R.O.W. CONST. SHEET NO. 105

# OUTER DRIVE EAST-CONNER TO CHALMERS

G.F. NO. 3-487

QUANTITIES (THIS SHEET ONLY)

Removing Sidewalk	71	S.Y.
4" Concrete Sidewalk	90	S.F.
Concrete Curb Cap (Patching)	136	L.F.
4" Concrete Sidewalk Ramp	600	S.F.

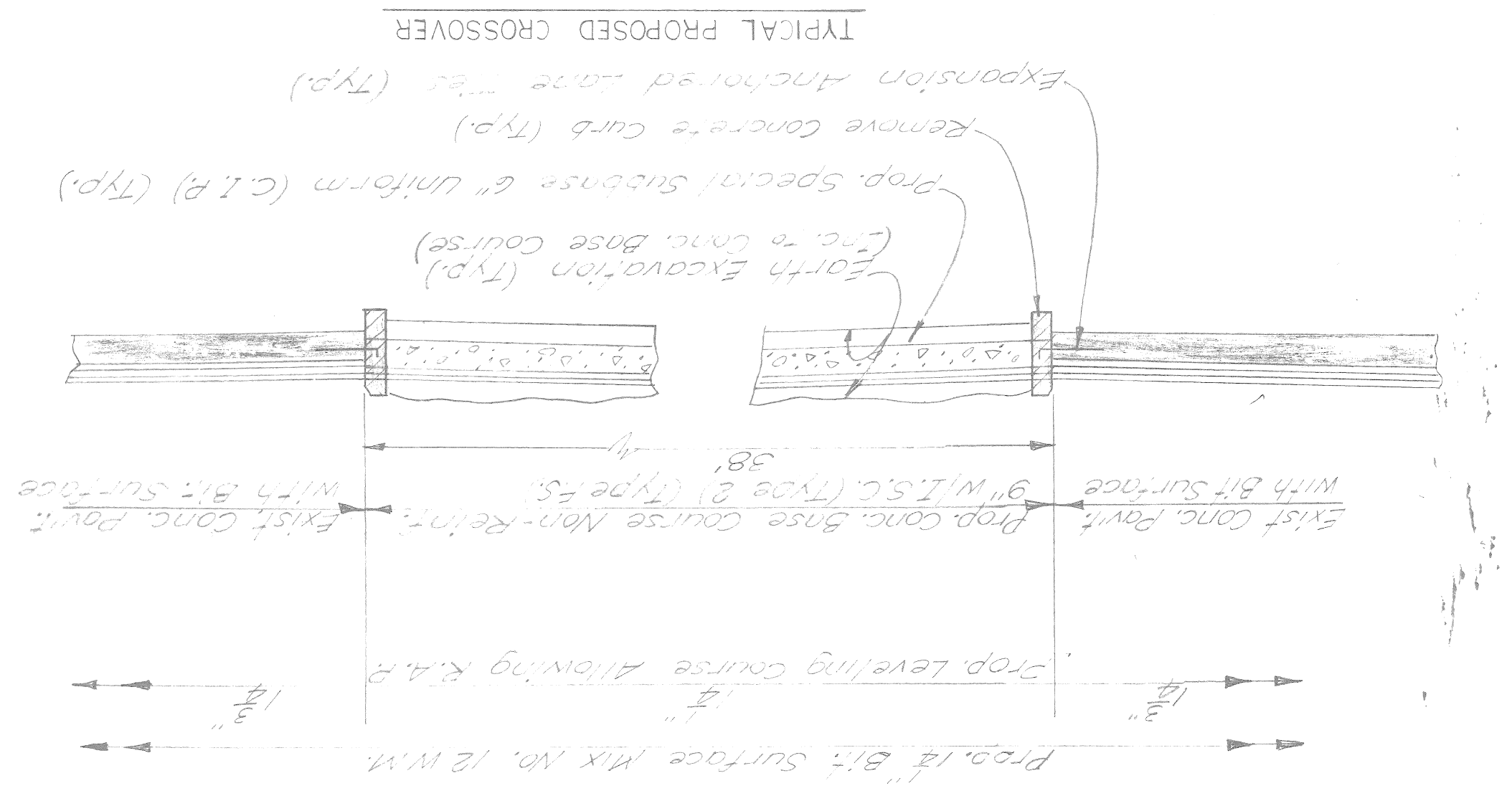
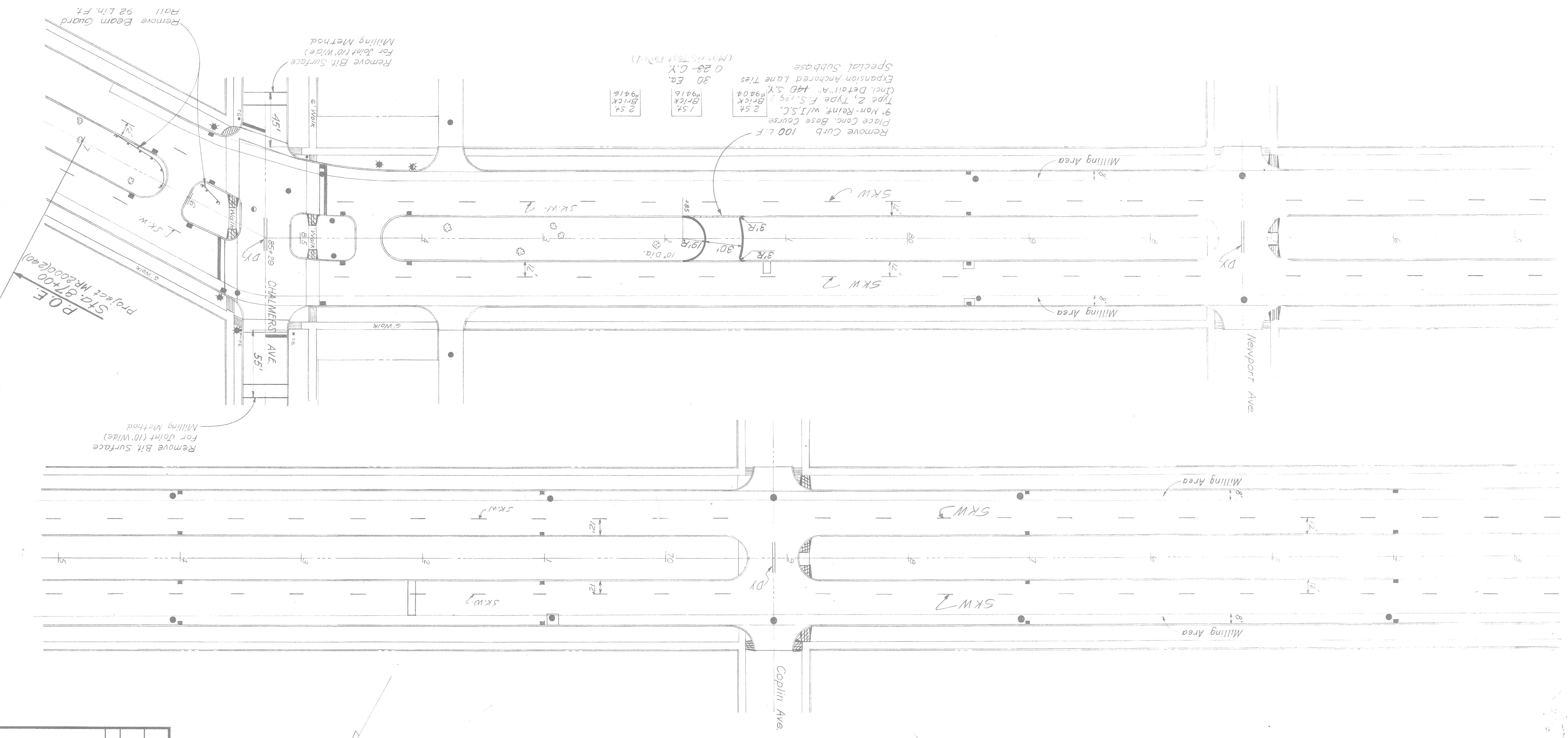

FINAL ROW				
REVISION				
DATE NO.				
AUTH.				

# TYPICAL CROSS-SECTIONS OUTER DRIVE EAST CHALMERS to CHANDLER PARK SCALE: 1" = 4'

5	MICH.	2000(242)	1985	202	11
FED. NO.	STATE	FEDERAL PROJECT	YEAR	SHEET NO.	TOTAL SHEETS
ROUTE	COUNTY	CITY	PROJECT	JOB NO.	
WAYNE	MUR 82400	DETROIT			

## NOTES

- Remove Bituminous concrete surface (Milling Method) as shown on the Plans or as directed by the Engineer.
- Remove deteriorated concrete by compressed air or other approved Method and fill voids with Bituminous Mix Material. Paid for as Bit Surface Mix No. 12 W/M. (As directed by the Engineer) 240 Ton (Est.) of Mix No. 12 W/M. has been provided for the Entire Project. Removal of deteriorated concrete incidental to Removal of bituminous surface. (Milling Method)
- P.O.B. to P.O.E. place 3" Topsoil Class "A" Seeding, Mulching & Chemical Fertilizer (As Directed by the Engineer) Removal of overburden is incidental to Topsoil
- Remove Bituminous concrete surface (Milling Method) where existing curb Applies only for 25% of this Project.
- Where existing curb to remain. Place 3" Topsoil Class "A" Seeding, Mulching & Chemical Fertilizer (As Directed by the Engineer) Removal of overburden is incidental to Topsoil.
- Restoration of this area is incidental to this project. Topsoil surface 3" class "A" Seeding, Mulching & Chemical Fertilizer.
- Mill 3" @ gutter

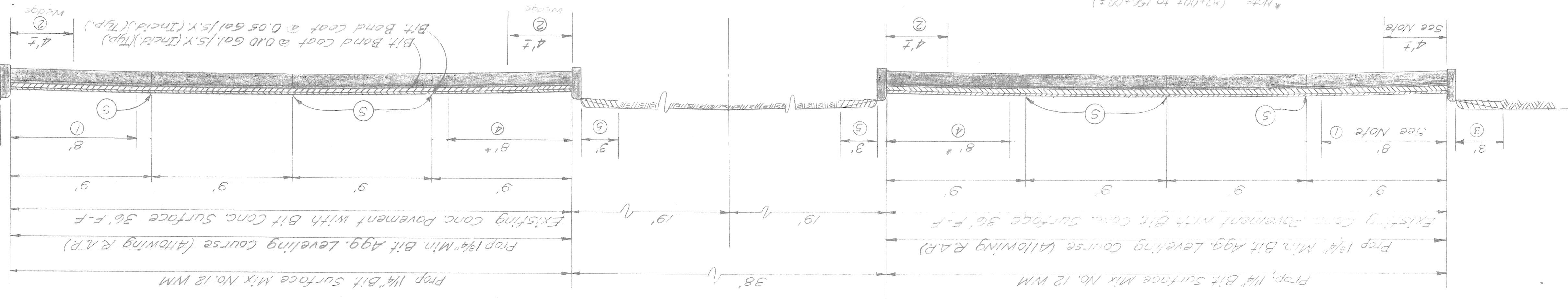

Sta. 87+00 to Sta. 157+28

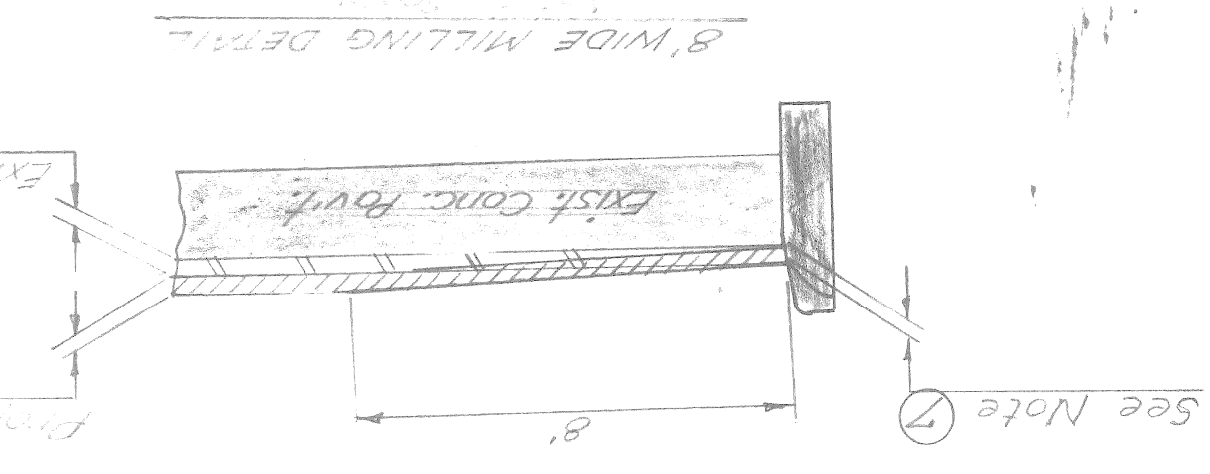

\*NOTE: (+/- 0.02 to 152+00±) Milling in this area eliminated along median cut due to poor/deteriorated curb. New curb placed (10±).

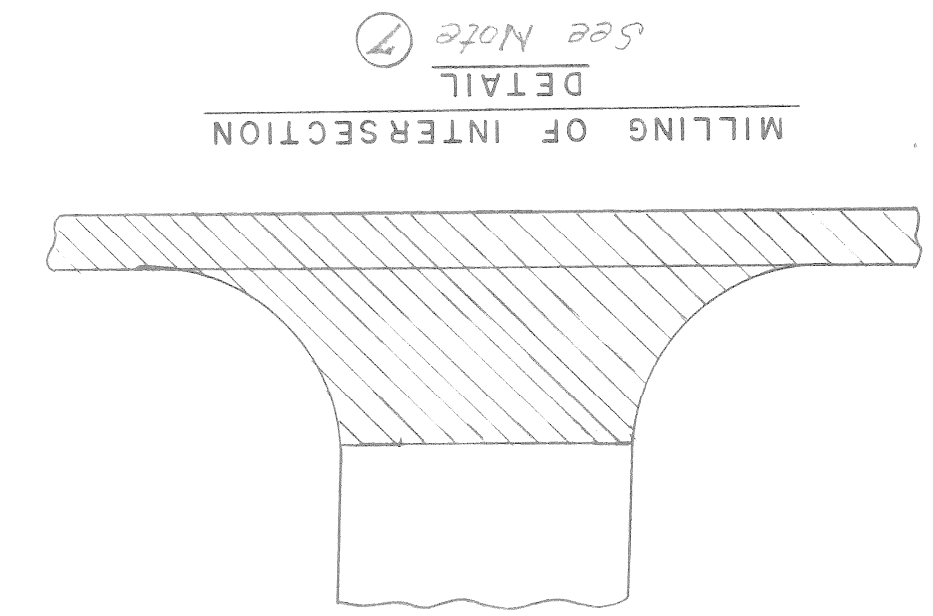

## CONSTRUCTION SIGNING NO SCALE

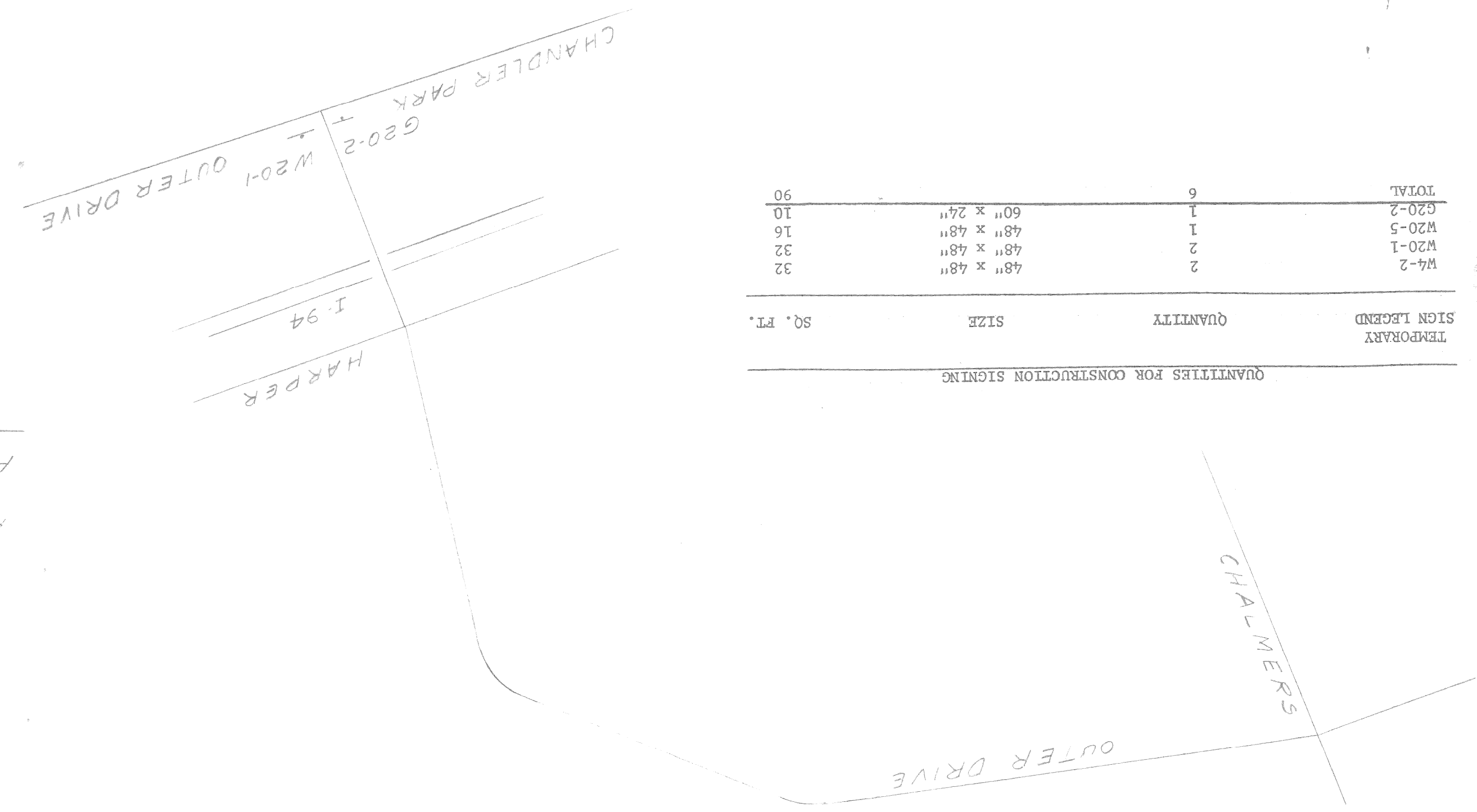

TEMPORARY SIGN LEGEND	QUANTITY	SIZE	SQ. FT.
W4-2	2	48" x 48"	32
W20-1	2	48" x 48"	32
W20-5	1	48" x 48"	16
G20-2	1	60" x 24"	10
TOTAL	6		90

QUANTITIES FOR CONSTRUCTION SIGNING

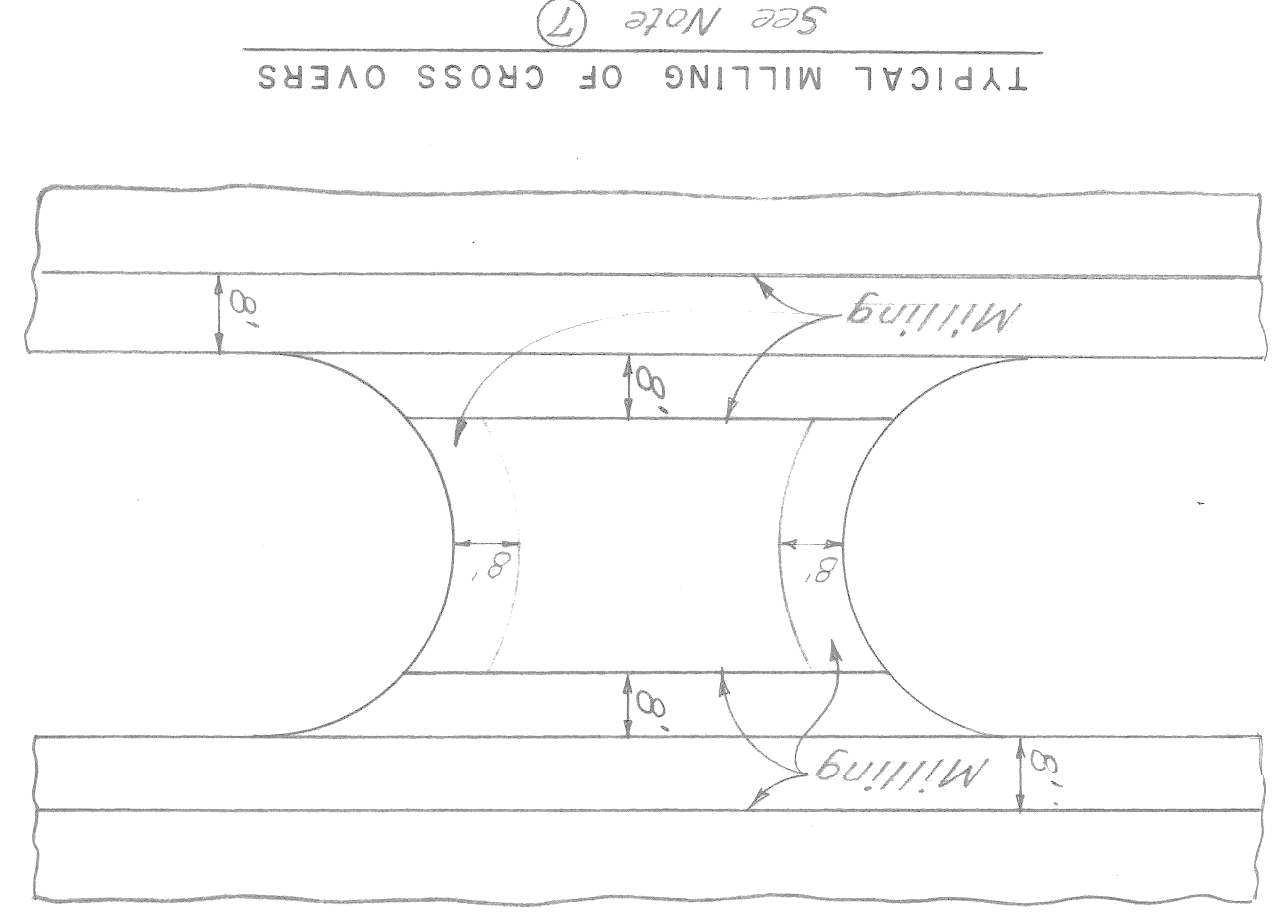

TYPICAL MILLING OF CROSS OVERS  
See Note 7

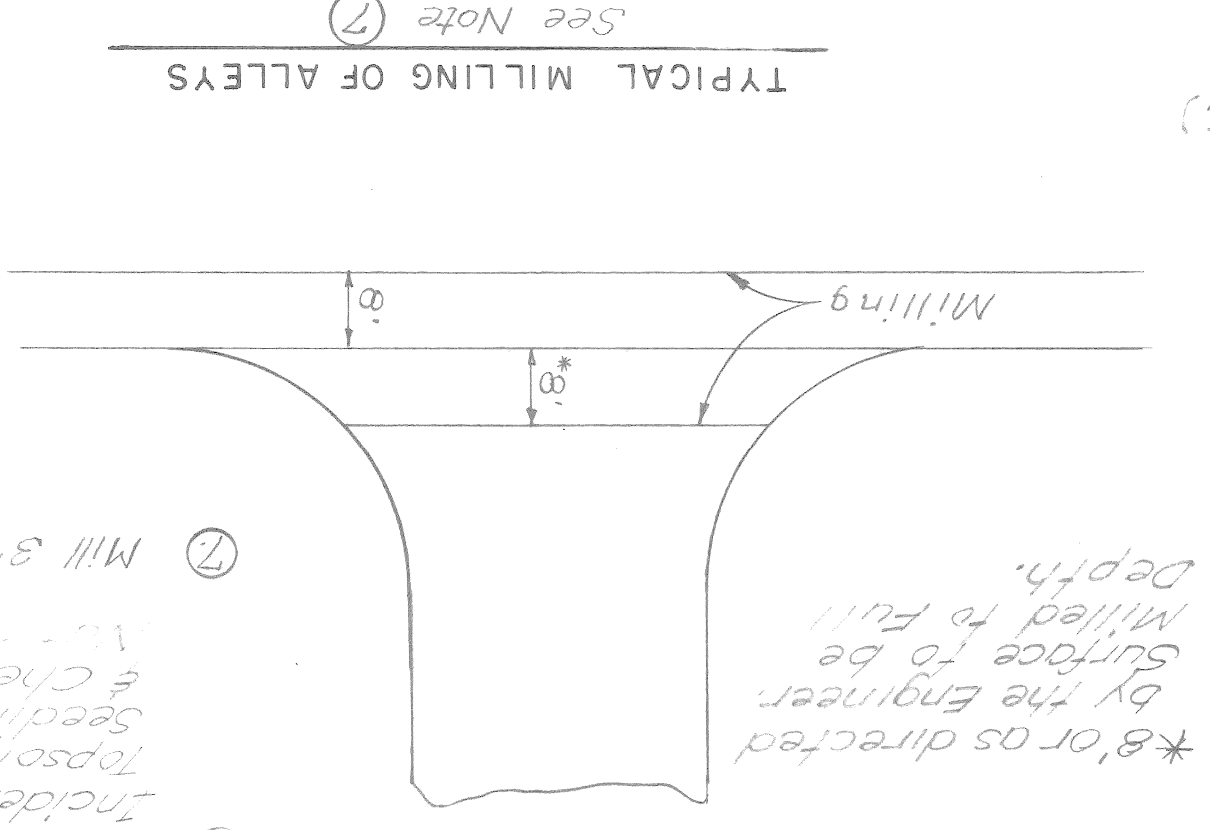

TYPICAL MILLING OF ALLEYS  
See Note 7

Estimated Quantity of Overburden 930 CY (Inc'd to Topsoil)

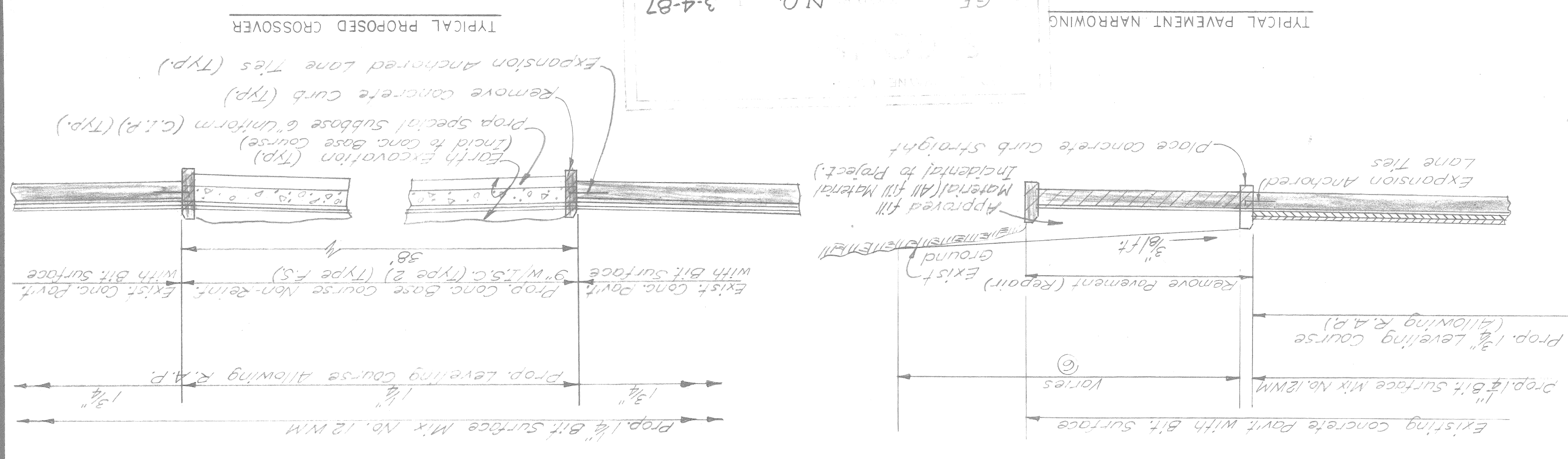

TYPICAL PAVEMENT NARROWING

TYPICAL PROPOSED CROSSOVER

N.O. 3-4-87

202	SECTION	JOB NO.	FEDERAL PROJECT
11	202	1985	5
11	202	1985	5
11	202	1985	5

FINAL ROW				
REVISION				
NO.				
DATE				
AUTH.				



6"(Max) or as directed by the Engineer, or as directed by the Engineer.  
 Prop. feathering of bituminous surface or as directed by the Engineer.  
 1-st Brk #9549  
 1/2-st Brk #9561  
 1/2-st Brk #9571  
 1/2-st Brk #9581  
 1/2-st Brk #9591

P.O.B.  
 Sta. 87+00  
 Proj. MR 2000 (242)

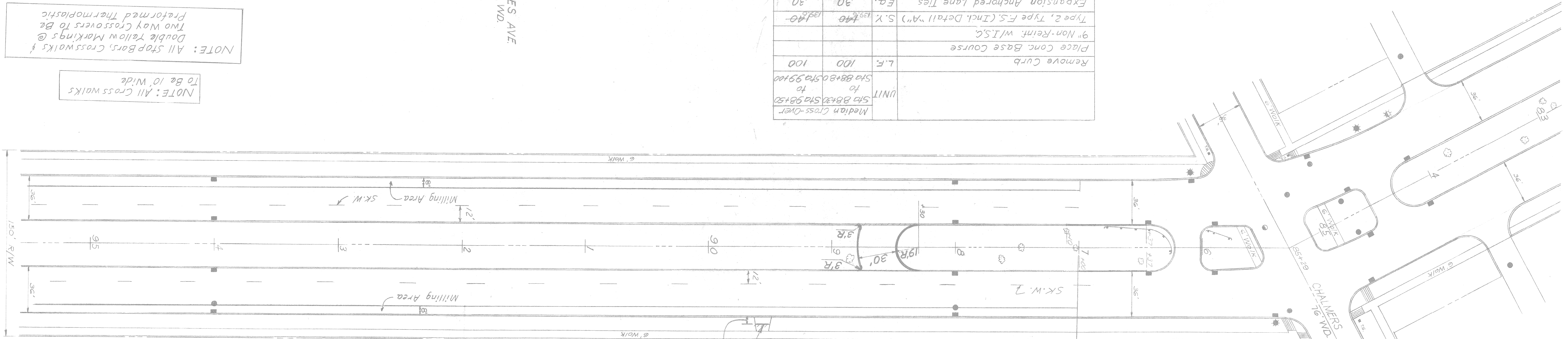

Median Cross-Over	UNIT	100	100	100
Remove Curb	L.F.	100	100	100
Place Conc. Base Course				
9" Non-Reinft. w/ISC	S.Y.	140	139	140
Type 2, Type F.S. (Incl. Detail "A")				
Expansion Anchored Lane Ties	Ea.	30	30	30
Special Subbase (C.I.P.)	C.Y.	0.23	0.23	0.23

HAYES INTERSECTION  
 QUEEN AVE.

Remove Pavement	246	S.Y.
Remove Sidewalk	77	S.Y.
Adjust C.B. Furnish Cover "A"	2	Ea.
Concrete Curb Cap	78	L.F.
Concrete Curb Cap (Patching)	24	L.F.
Catch Basin "A" (Over Exist Sewer)	Ea.	
12" Sewer C76-IV T. "A"	L.F.	
Concrete Curb, Straight	179	L.F.
Concrete Base Course (Patching)		
Non-Reinft. w/ISC, Type 2, Type F.S. (Including Detail "A")	13	S.Y.
Expansion Anchored Lane Ties	77	Ea.
4" Concrete Sidewalk	455	S.F.
4" Concrete Sidewalk Ramps	539	S.F.
	159	S.F.

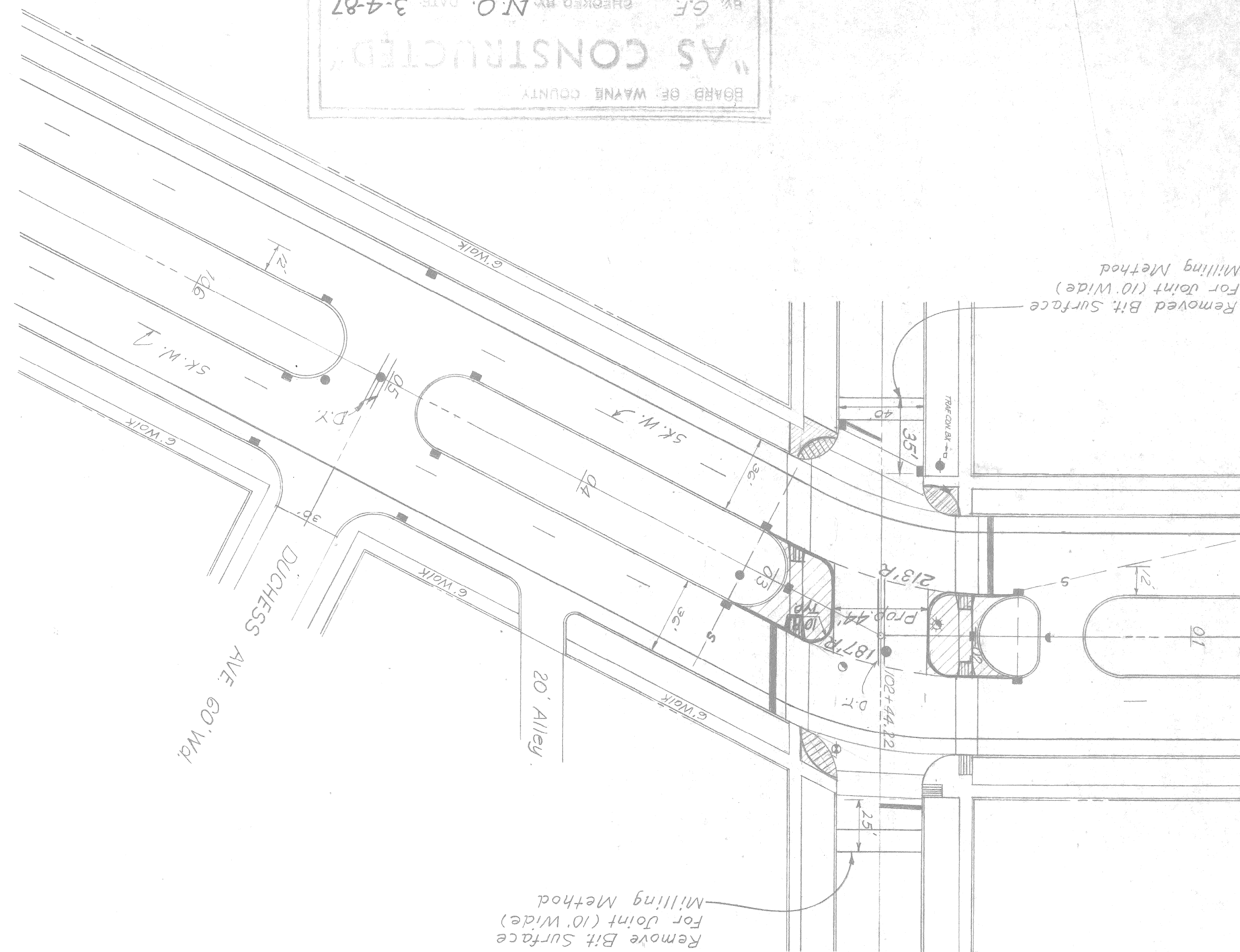

BOARD OF WAYNE COUNTY  
 "AS CONSTRUCTED"  
 BY G.F. CHECKED BY N.O. DATE 3-4-87

Books: T-16-13

DATE	5-14-84	SCALE	1" = 40'	CONT. SEC.	MUR 82400	JOB NO.	22177
DESIGN UNIT		SHEET NO.	203	R.O.W.	CONST.		

OUTER DRIVE EAST - CHALMERS TO CHANDLER PK.

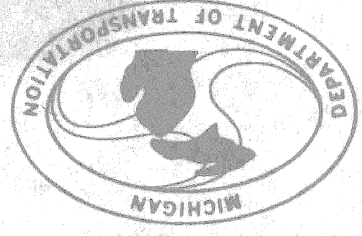

DATE 5-14-84 SCALE 1" = 40' MUR 82400 CONT. SEC. 22177 JOB NO. 204 SHEET NO. 204

OUTER DRIVE EAST-CHALMERS TO CHANDLER PK.

Books-T-16-13

BOARD OF WAYNE COUNTY  
 CHECKED BY N.O. DATE 3-4-87  
 BY G.F.

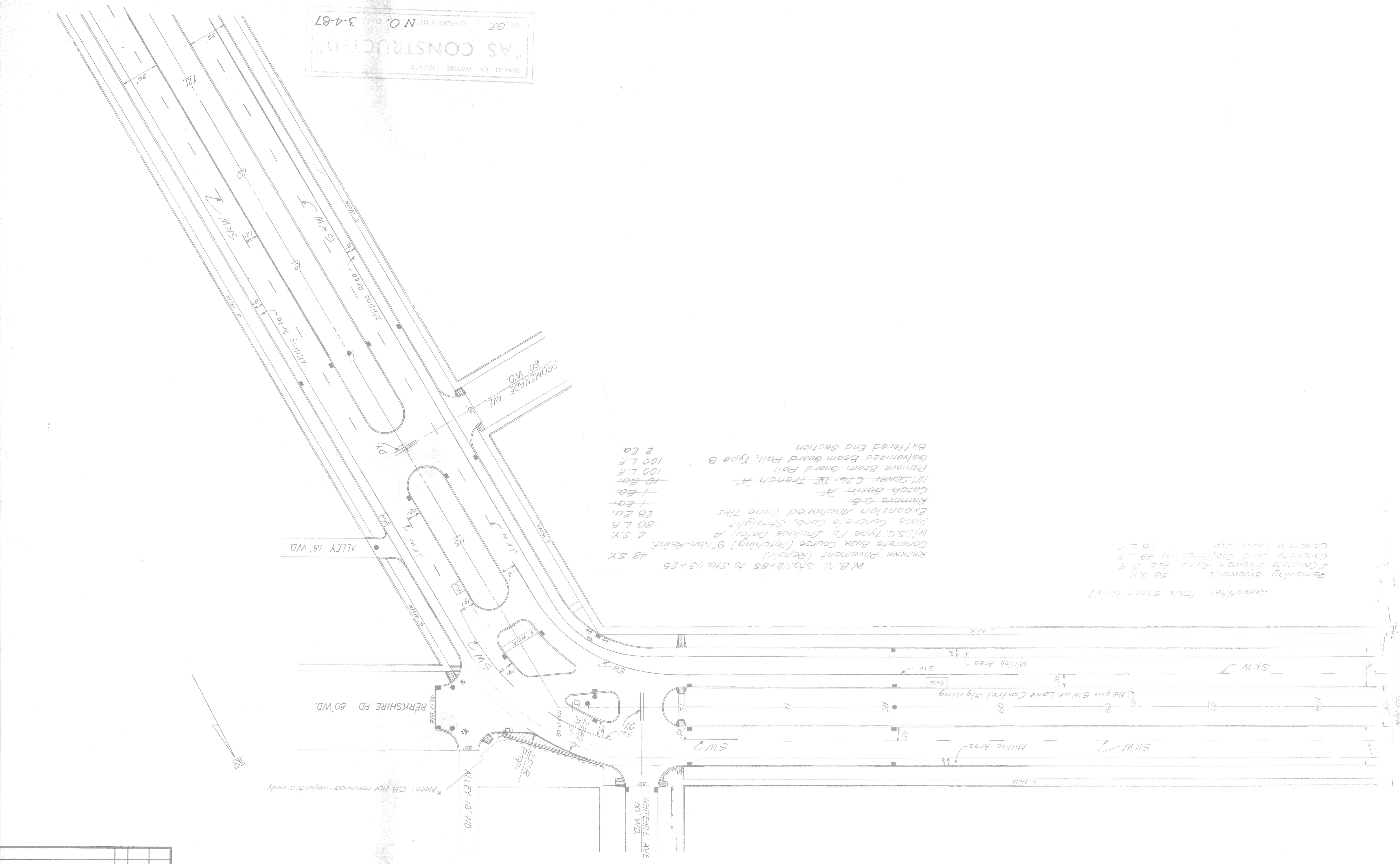

M.B.N. Sta. 12+85 to Sta. 13+25  
 48 S.Y.  
 Remove Pavement (Repair)  
 Concrete Base Course (Patching) 9" Non-Reinf. 4 S.Y.  
 W/S.S.C. Type Fs Include Detail A  
 Place Concrete Curb, Straight  
 Expansion Anchored Lane Ties  
 Remove C.B.  
 Catch Basin "A"  
 12" Sewer - C-76-IX French "A"  
 10 Ea.  
 100 L.F.  
 Remove Beam Guard Rail, Type B  
 Galvanized Beam Guard Rail, Type B  
 100 L.F.  
 Buffered End Section  
 2 Ea.

Quantities (This Sheet Only)  
 Removing Sidewalk 58 S.Y.  
 Concrete Sema & Run 45 S.Y.  
 Concrete Curb Cap (Patching) 49 L.F.  
 Concrete Curb Cap 25 L.F.

Note: CB not removed - adjusted only

FINAL ROW				
REVISION	NO.	DATE		
AUTH.				



AS CONSTRUCTED  
CHECKED BY N.O. 3-4-67

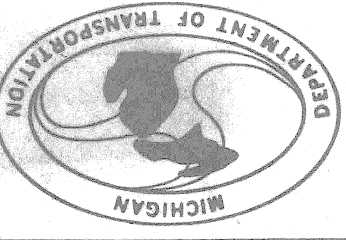

DATE 5-14-84 SCALE 1" = 40' JOB NO. 22177 CONT. SEC. MUR 82400 SHEET NO. 205  
 DESIGN UNIT R.O.W. CONST. 205

OUTER DRIVE EAST-CHALMERS TO CHANDLER PK.

Books: T-16-13

Quantities (This sheet only)  
 Removing Sidewalk 129 S.Y.  
 4" Concrete Sidewalk Ramp 841 S.F.  
 Concrete Curb cap (Patching) 91 L.F.  
 Concrete Curb cap 50 L.F.

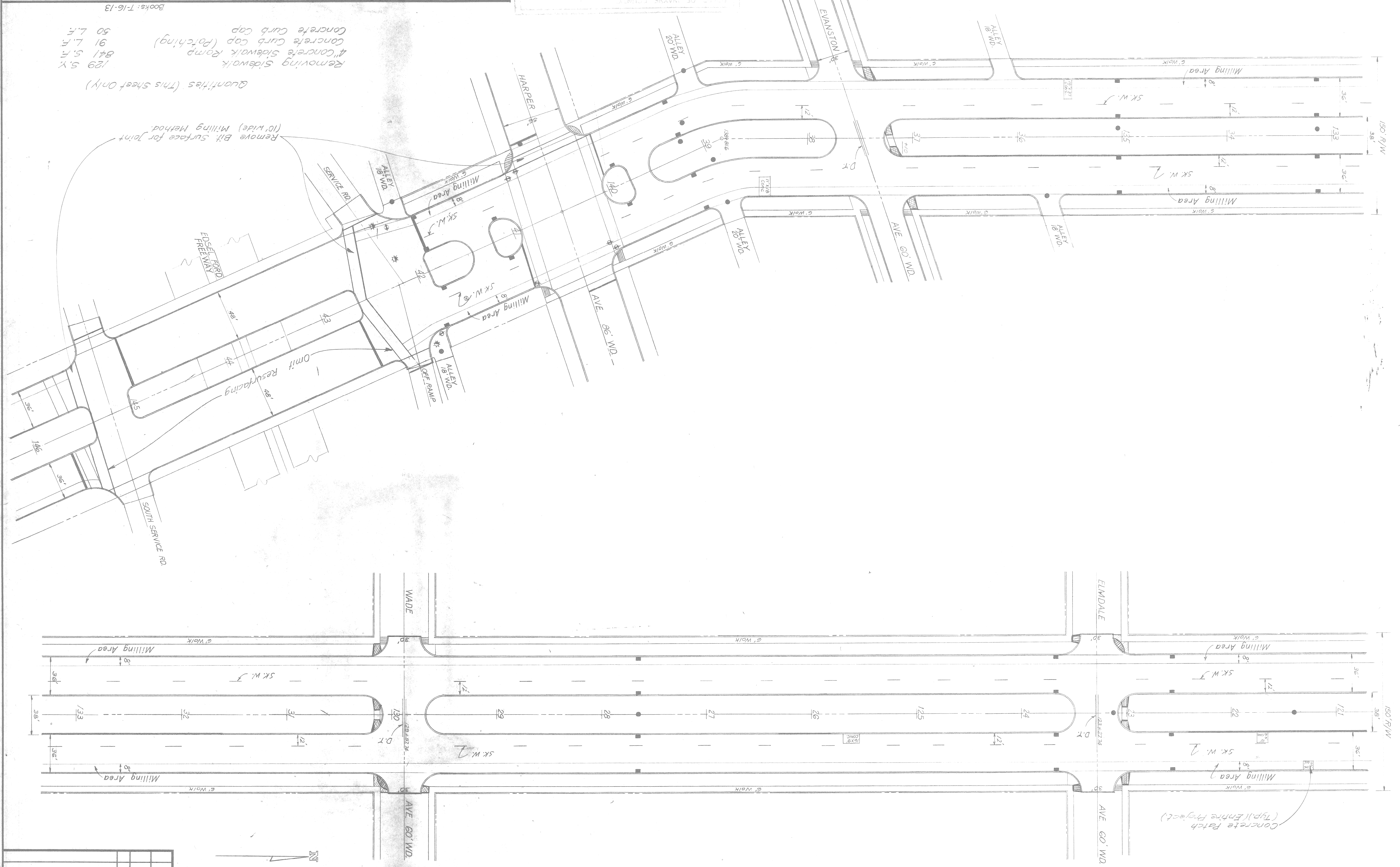

FINAL R.O.W.	NO.	DATE	REVISION	AUTH.



DATE	SCALE	CONT. SEC.	JOB NO.	DESIGN UNIT	R. O. W.	SHEET NO.
						206

OUTER DRIVE EAST-CHALMERS TO CHANDLER PK.

City of Detroit Drwg. # 59, C4, G5 & G6  
Books: T-16-13

BOARD OF WAYNE COUNTY  
 "AS CONSTRUCTED"  
 BY: G.F. CHECKED BY: N.O. DATE: 3-4-87

QUANTITIES (THIS SHEET ONLY)

Removing sidewalk	180 S.Y.
4" concrete sidewalk	S.F.
4" concrete sidewalk Ramp	1224 S.F.
Concrete curb cap Patching	128 L.F.
Concrete curb cap	100 L.F.

City of Detroit Water Main Contractor may be performing work in this area during the time of resurfacing operation. This Contractor shall coordinate his work with that of Water Main Contractor.

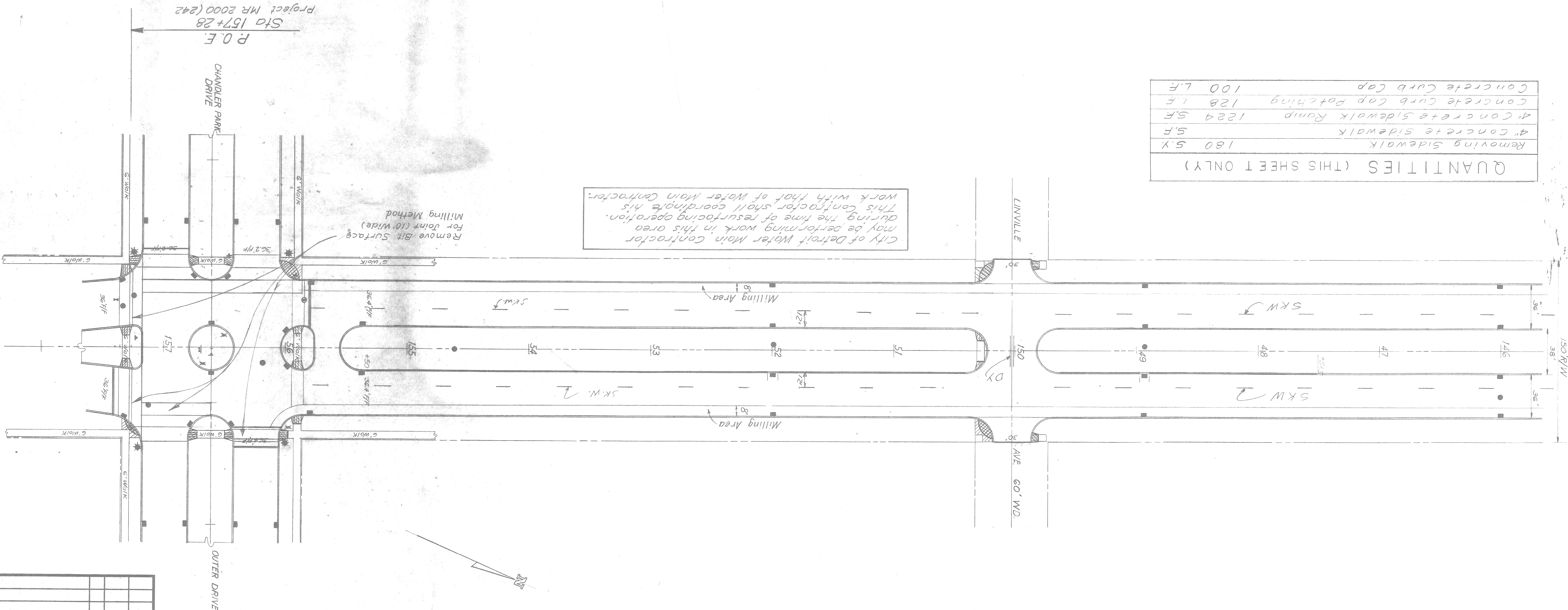

FINAL P.L.O.W.				
AUTH.	DATE	NO.	REVISION	