

BITUMINOUS APPLICATION CHART			
ITEM	Rate of Application	Estimated Thickness	Asphalt Penetration
Bit. Mixture No. 1100L, 20AA	130#/S.Y.	1 1/2 inch	85-100
Bit. Mixture No. 1100T, 20AA	120#/S.Y.	1 inch	85-100
Bituminous Shoulders	340#/S.Y.	3 inches	200-250

Bit. Bond Coat 0-0.10 Gal./Sq.Yd. to Rigid Bases and 0-0.05 Gal./Sq.Yd. Tack Coat between layers.

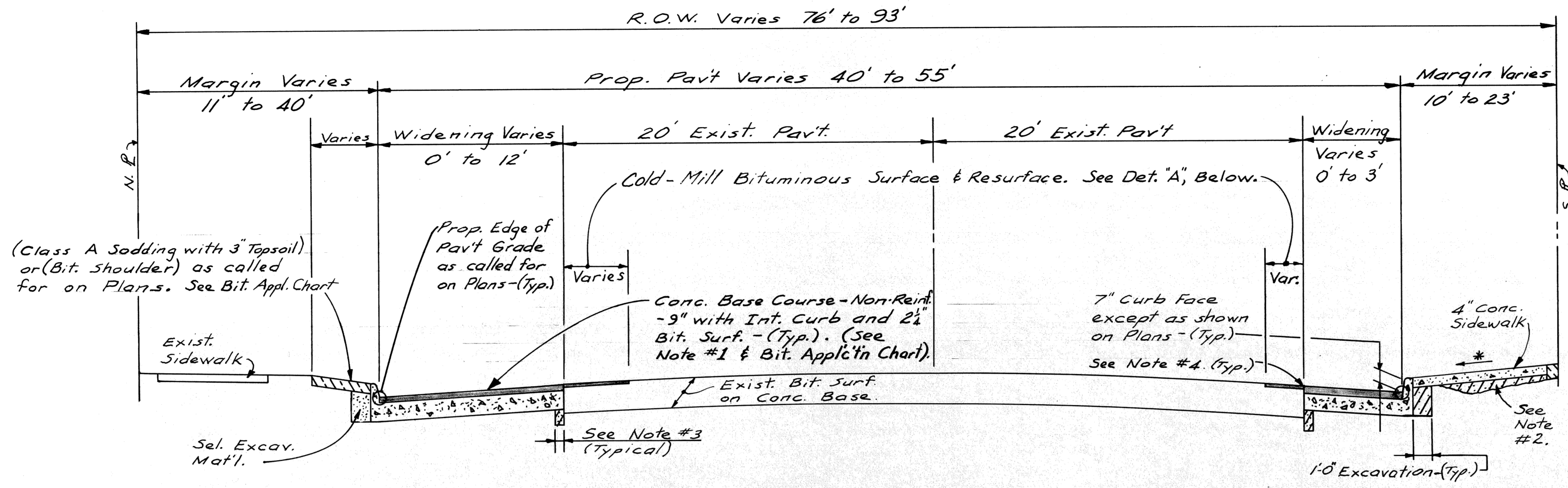

TYPICAL CROSS-SECTION
SEVEN MILE RD., ST. LOUIS TO E. OF FILER

NO SCALE

* Full Sidewalk shall slope at 3/8 inch per foot unless the Engineer determines otherwise to meet existing conditions. The Engineer will choose within these limits: 1/4 inch per ft. min. to 3/4 inch per ft. max.

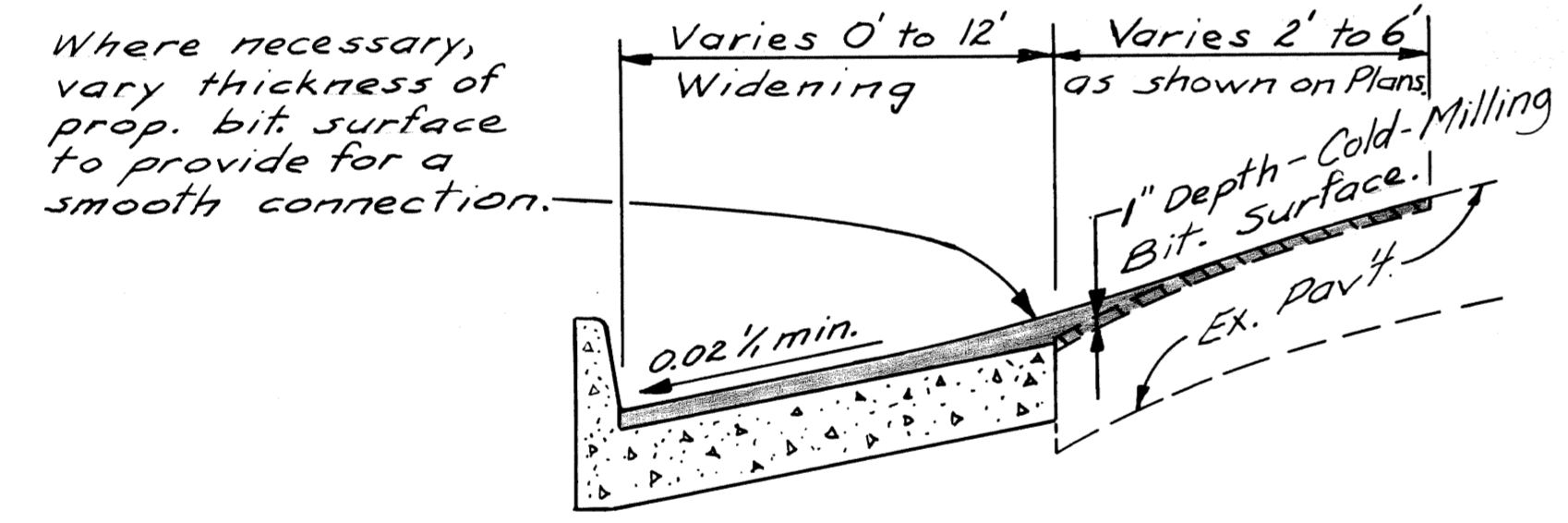

DETAIL "A"
NO SCALE

CURB DIMENSIONS	
FACE F	DEPTH D
5"	16 1/2"
6"	17 1/2"
7"	18 1/2"

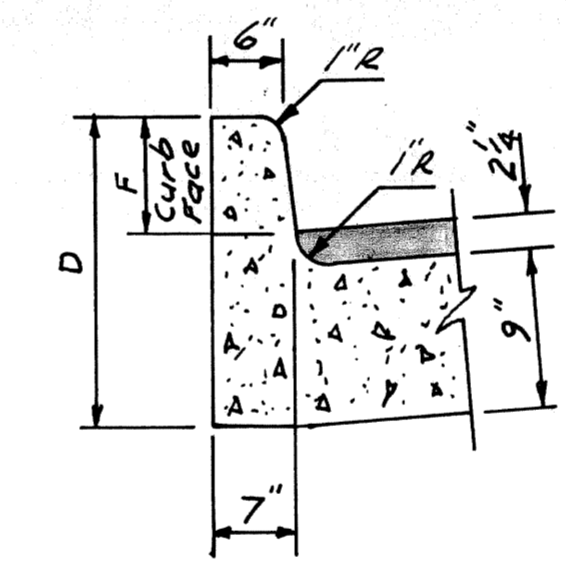

INTEGRAL CURB
NO SCALE

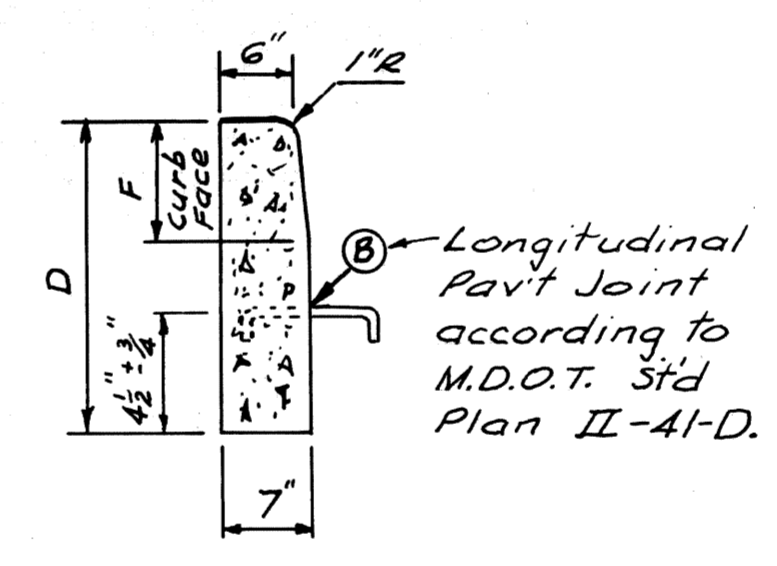

CONCRETE CURB
DETAIL "X"
NO SCALE

GENERAL NOTES

1. The prop. curb shall be "Integral Curb" with "Conc. Curb - Detail X" as an option. For Details, See this sheet.
2. Backfill, if required, under prop. sidewalks and/or pavement shall be Granular Material - Class II (Incidental to prop. sidewalk and/or pavement construction).
3. Fill exist. curb void with Granular Mat'l Cl. II (Incidental to pavement construction).
4. Saw plane of weakness joints over the existing joint. This work will be paid for as "Sawed Longitudinal Plane of Weakness Joint". Saw as required by the Engineer.

REVISIONS LOCATED BY COORDINATES ON SHEET COOR'D DESCRIPTION DRN CKD AP'D DATE		DESIGNED BY DRAWN BY <i>RBP</i> TRACED BY CHECKED BY <i>WB</i>	APPROVED ENGINEER OF STREETS HIGHWAY ENGINEER	CITY OF DETROIT CITY ENGINEERING DIVISION - D. P. W. BUREAUS OF STREETS AND HIGHWAYS	MT. ELLIOTT AT SEVEN MILE ROAD TYPICAL CROSS-SECTION	SHEET 6 OF 40 SHEETS CONTRACT NO. 15892A ASSIGNMENT NO. DATE Jan, 1983
---	--	---	---	--	---	---

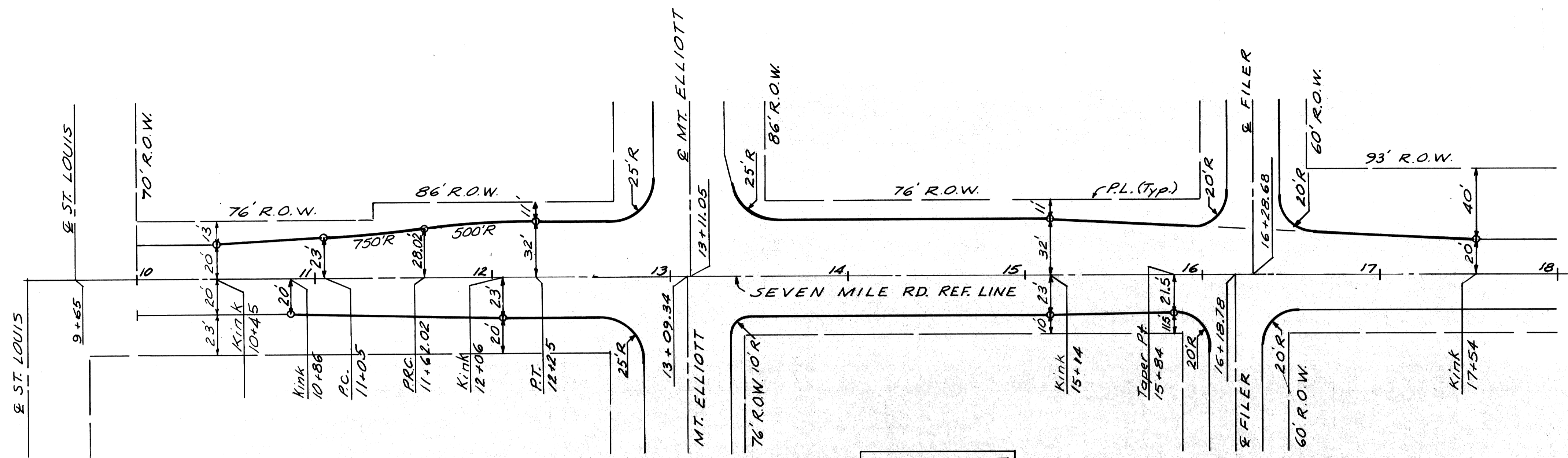

ALIGNMENT

Scale: 1" = 40'

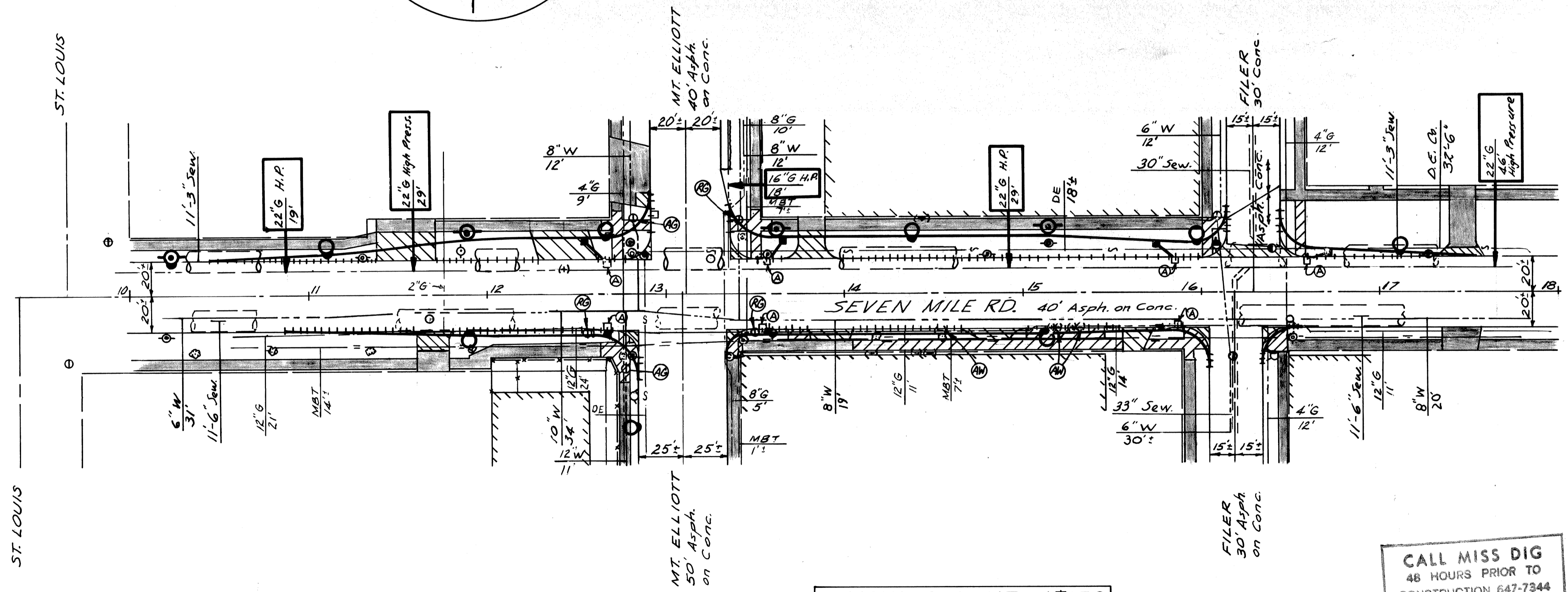

REMOVALS & UTILITIES

- REMOVAL LEGEND**
- Removing Pavement
 - Removing Sidewalk
 - Existing Sidewalk or Driveway to Remain
 - Existing Building
 - Abandoning Drainage Structures
 - Removing Curb
 - Adjusting Gatewell Manhole Covers
 - Reconstruct Gatewell Manhole
 - Adjusting Water Shutoffs

- NOTES**
1. For Utility Legend, See Sh.# 12.
 2. Locations of existing utility lines are based on the best available records and are not guaranteed for accuracy.

CALL MISS DIG
48 HOURS PRIOR TO
CONSTRUCTION 647-7344

REFERENCE DRAWINGS DESIGNED BY DRAWN BY <i>RBP</i> TRACED BY CHECKED BY <i>WB</i>		APPROVED ENGINEER OF STREETS HIGHWAY ENGINEER	CITY OF DETROIT CITY ENGINEERING DIVISION - D. P. W. BUREAUS OF STREETS AND HIGHWAYS	MT. ELLIOTT AT SEVEN MILE ROAD ALIGNMENT, REMOVALS, AND UTILITIES	SHEET 7 OF 40 SHEETS CONTRACT NO. 15892A ASSIGNMENT NO. DATE Jan, 1983
COORD	DESCRIPTION	DRN	CK'D	APVD	DATE
REVISIONS LOCATED BY COORDINATES ON SHEET					

C.B.M. Elev. 145.74 Arrow on Hydrant
S.E. Corner Seven Mile & St. Louis.

C.B.M. Elev. 144.75 Arrow on Hydrant
on Hydrant SW. Corner
Seven Mile & Mt. Elliott.

C.B.M. Elev. 144.46 Arrow on Hydrant
N.E. Corner Seven Mile & Mt. Elliott.

C.B.M. Elev. 144.57 Arrow on Hydrant
S.E. Corner Seven Mile & Filer.

SURFACING LEGEND

- Conc. Base Course - Nonreint. - 9" with Integral Curb & 2" Bituminous Surface
- Conc. Pavt - Nonreinforced - 8" (Driveway)
- 4" Concrete Sidewalk
- 6" Concrete Sidewalk
- Bituminous Shoulder (3" Thickness)
- Removing Bituminous Surface & Resurface
- Glass "A" Sodding with 3" Topsoil
- Existing Sidewalk or Driveway to Remain
- ①, ③, ② Sidewalk Ramps, Types 1 & 3 & 2
- Drainage Flow Arrows
- ⊕ Adjusting Drainage Structure Covers

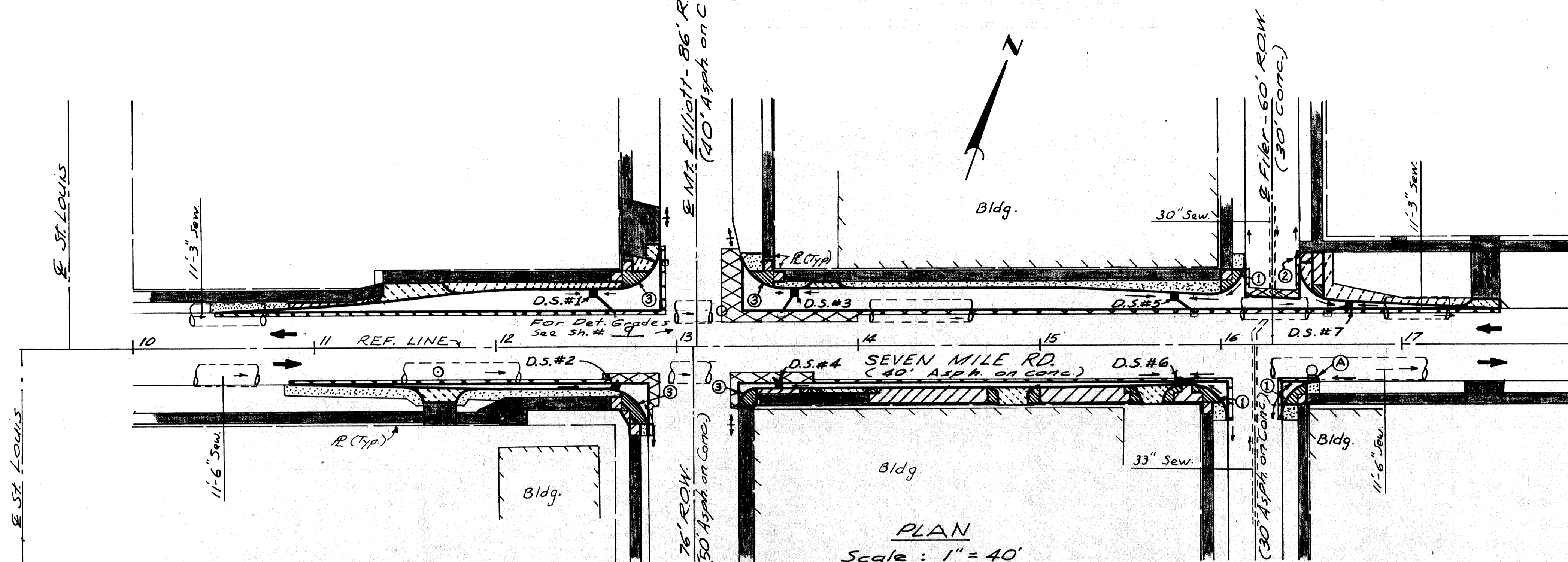

D.S. - See Note #4.

NOTES:

1. For Alignment, See Sh.# 7.
2. For Utility Legend & Symbols, See Sh.# 12.
3. For Driveway Details, See Sh.# 12.
4. Proposed Drainage Structures (D.S.) #1 through #7 shall be Catch Basins Type "B" with Trap and 12 inch Sewer C-76-III, Trench Detail 9. Each shall drain to the outlet sewer of a near-by existing catch basin, as shown. If necessary, to clear existing obstacles, the Engineer may substitute a Catch Basin "L" with Halt Trap for a C.B. "B" T. The Halt Trap shall be paid for as 12" sewer.
5. Limits of "Removing Bituminous Surface and Resurface" may, if necessary, be altered by the Engineer.

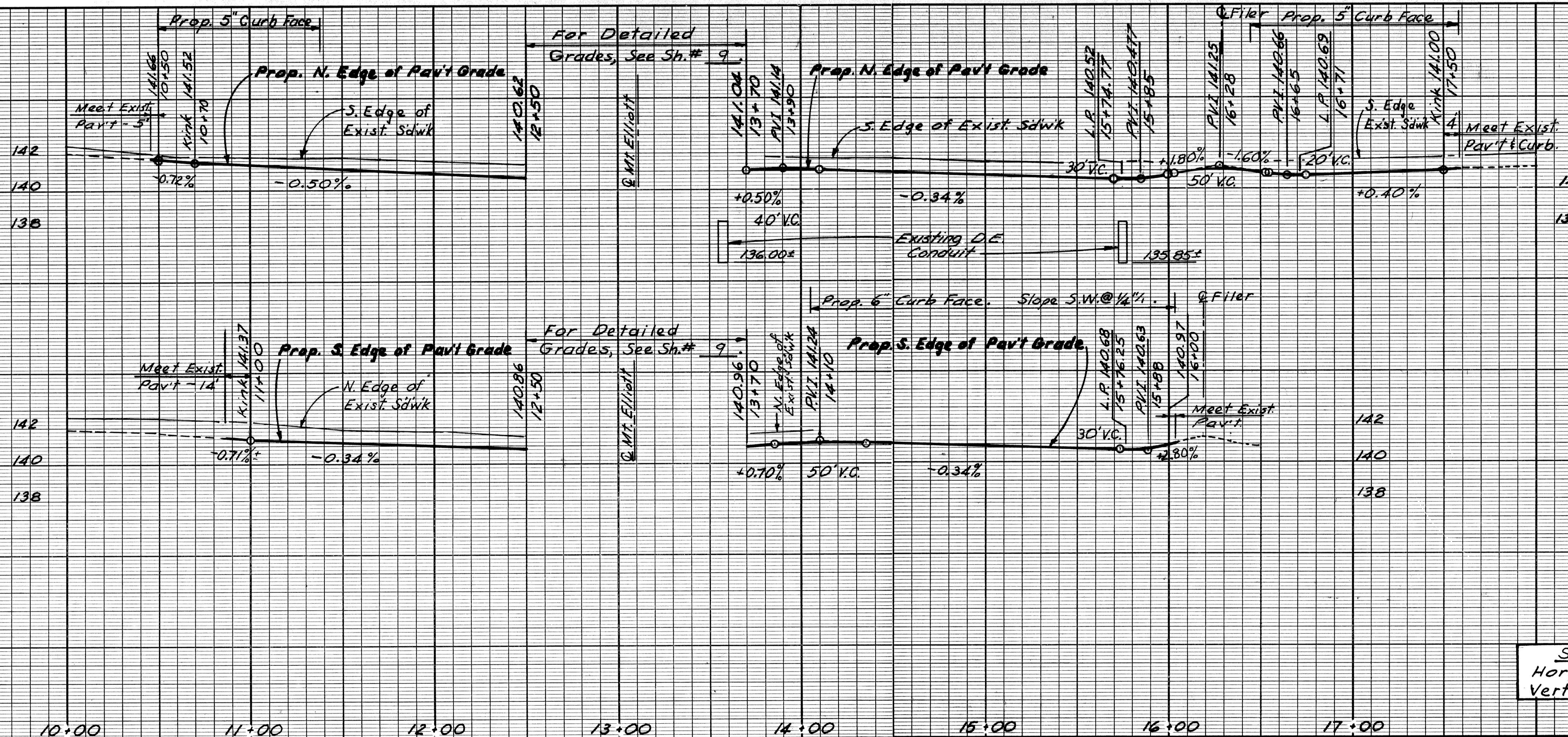

<table border="1" style="width: 100%; border-collapse: collapse;"> <tr> <td style="width: 15%;">BY</td> <td style="width: 15%;">RP</td> <td style="width: 15%;">CHECKED BY</td> <td style="width: 15%;">WB</td> <td style="width: 15%;">APPROVED:</td> <td rowspan="2" style="text-align: center; vertical-align: middle;"> CITY OF DETROIT CITY ENGINEERING BUREAU OF STREETS AND HIGHWAYS </td> <td rowspan="2" style="text-align: center; vertical-align: middle;"> MT. ELLIOTT AT SEVEN MILE ROAD </td> <td style="width: 10%; text-align: center;">INDEX NO.</td> <td style="width: 10%; text-align: center;">SHEET 8 OF 40 SHEETS</td> </tr> <tr> <td>PLAN</td> <td>RP</td> <td>WB</td> <td>WB</td> <td>ENGINEER OF STREETS</td> <td style="text-align: center;">CONTRACT NO.</td> <td style="text-align: center;">15892A</td> </tr> </table>		BY	RP	CHECKED BY	WB	APPROVED:	CITY OF DETROIT CITY ENGINEERING BUREAU OF STREETS AND HIGHWAYS	MT. ELLIOTT AT SEVEN MILE ROAD	INDEX NO.	SHEET 8 OF 40 SHEETS	PLAN	RP	WB	WB	ENGINEER OF STREETS	CONTRACT NO.	15892A	<table border="1" style="width: 100%; border-collapse: collapse;"> <tr> <td style="width: 15%;">CHECKED</td> <td style="width: 15%;">REVIEW</td> <td style="width: 15%;">ASSIGNMENT NO.</td> <td style="width: 10%; text-align: center;">DATE</td> </tr> <tr> <td>FINAL</td> <td></td> <td></td> <td style="text-align: center;">Jan, 1983</td> </tr> </table>		CHECKED	REVIEW	ASSIGNMENT NO.	DATE	FINAL			Jan, 1983
		BY	RP	CHECKED BY	WB	APPROVED:			CITY OF DETROIT CITY ENGINEERING BUREAU OF STREETS AND HIGHWAYS	MT. ELLIOTT AT SEVEN MILE ROAD	INDEX NO.	SHEET 8 OF 40 SHEETS															
PLAN	RP	WB	WB	ENGINEER OF STREETS	CONTRACT NO.	15892A																					
CHECKED	REVIEW	ASSIGNMENT NO.	DATE																								
FINAL			Jan, 1983																								
<table border="1" style="width: 100%; border-collapse: collapse;"> <tr> <td style="width: 15%;">DESCRIPTION</td> <td style="width: 15%;">DATE</td> <td style="width: 15%;">BY</td> <td style="width: 15%;">CHECKED</td> <td style="width: 15%;">APPROVED</td> <td style="width: 15%;">DATE</td> </tr> <tr> <td>REVISIONS</td> <td></td> <td></td> <td></td> <td></td> <td></td> </tr> </table>		DESCRIPTION	DATE	BY	CHECKED	APPROVED	DATE	REVISIONS						PLAN AND PROFILES													
DESCRIPTION	DATE	BY	CHECKED	APPROVED	DATE																						
REVISIONS																											

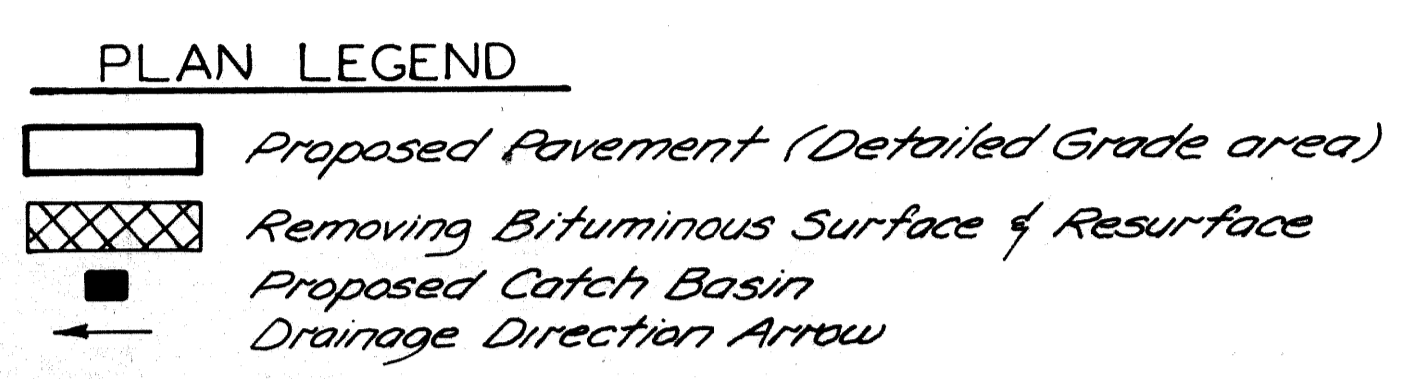
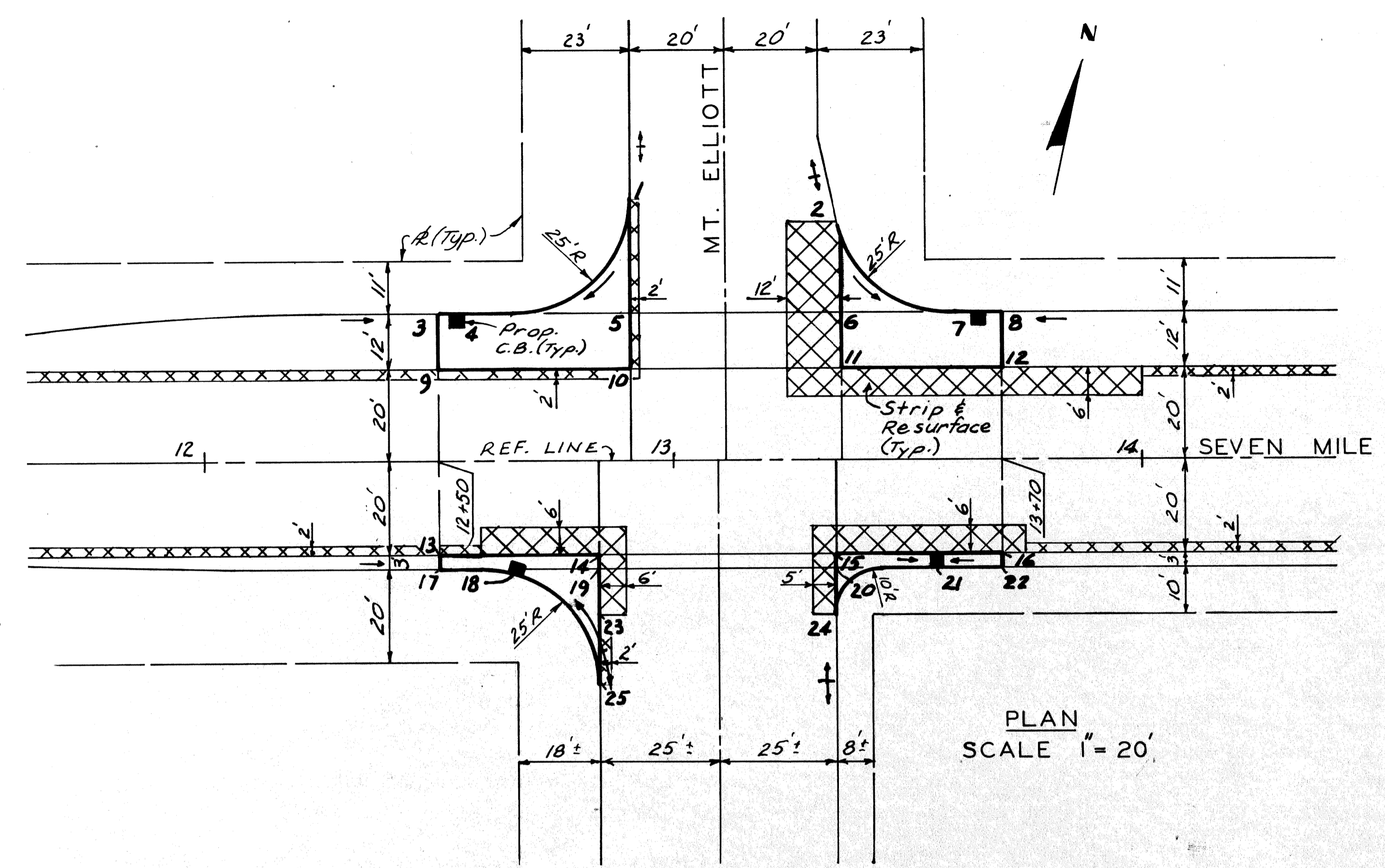

PLAN SCALE 1" = 20'

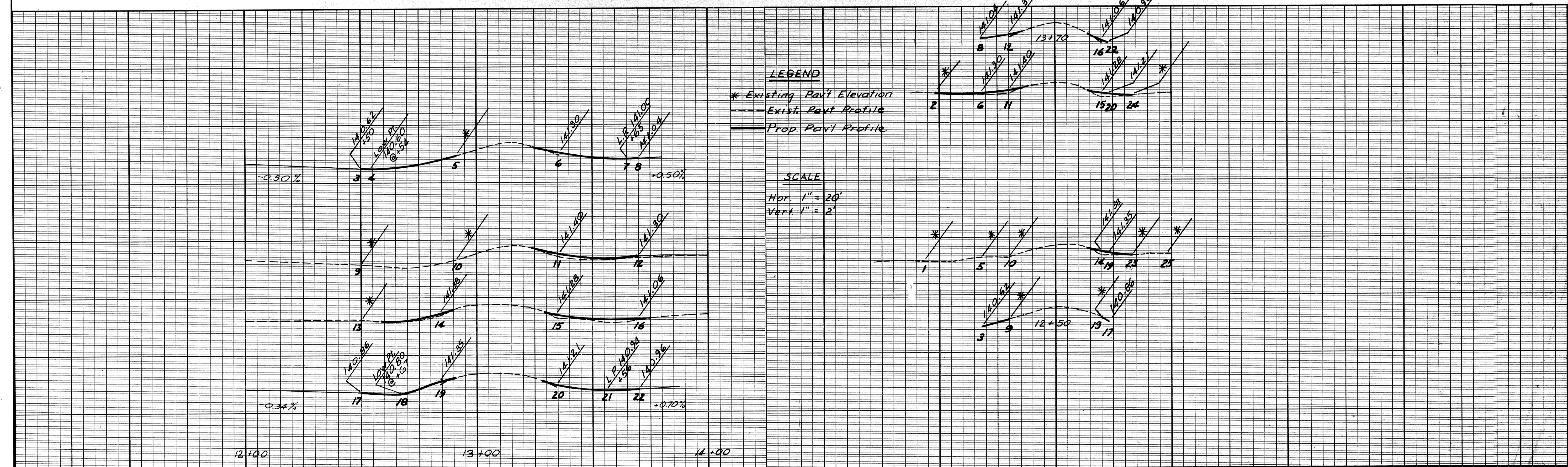

LEGEND

- * Existing Pav't Elevation
- - - - - Exist. Pav't Profile
- Prop. Pav't Profile

SCALE
Hor. 1" = 20'
Vert. 1" = 2'

<p>CITY OF DETROIT CITY ENGINEERING BUREAU OF STREETS AND HIGHWAYS</p>		<p>MT. ELLIOTT AT SEVEN MILE ROAD</p> <p>SEVEN MILE - MT. ELLIOTT DETAILED GRADE</p>	<p>INDEX NO. SHEET 9 OF 40 SHEETS</p> <p>CONTRACT NO. 15892A</p> <p>ASSIGNMENT NO.</p> <p>DATE Jan., 1983</p>																	
<p>DESCRIPTION</p> <p>REVISIONS</p>	<table border="1" style="width: 100%; border-collapse: collapse;"> <tr> <td>BY</td> <td>CHECKED BY</td> <td>APPROVED:</td> </tr> <tr> <td>PLAN RP 3/10/81</td> <td>WB</td> <td></td> </tr> <tr> <td>GRADE RP 1/10/81</td> <td>WB</td> <td></td> </tr> <tr> <td>ESTIMATE</td> <td>CHECK</td> <td>REVIEW</td> </tr> <tr> <td>FINAL</td> <td></td> <td></td> </tr> </table>	BY	CHECKED BY	APPROVED:	PLAN RP 3/10/81	WB		GRADE RP 1/10/81	WB		ESTIMATE	CHECK	REVIEW	FINAL			<table border="1" style="width: 100%; border-collapse: collapse;"> <tr> <td>ENGINEER OF STREETS</td> </tr> <tr> <td>HIGHWAY ENGINEER</td> </tr> </table>	ENGINEER OF STREETS	HIGHWAY ENGINEER	
BY	CHECKED BY	APPROVED:																		
PLAN RP 3/10/81	WB																			
GRADE RP 1/10/81	WB																			
ESTIMATE	CHECK	REVIEW																		
FINAL																				
ENGINEER OF STREETS																				
HIGHWAY ENGINEER																				