

STATE OF MICHIGAN
DEPARTMENT OF STATE HIGHWAYS AND TRANSPORTATION

ROUTE	JOB NUMBER	FEDERAL NUMBER	SHEET NO.	TOTAL SHEETS
US-24	06459A		1	

THE IMPROVEMENTS COVERED BY THESE PLANS SHALL BE DONE IN ACCORDANCE WITH THE MICHIGAN DEPARTMENT OF STATE HIGHWAYS 1973 STANDARD SPECIFICATIONS AND SUPPLEMENTAL SPECIFICATIONS.

PLANS OF PROPOSED
MICHIGAN PROJECT
CONTROL SECTION UM 82053
JOB NUMBER 06459A
TELEGRAPH ROAD (US-24)
WAYNE COUNTY
CITY OF DETROIT

ROAD PLANS	SHEET NO'S.
TITLE	
TYPICAL CROSS SECTION	
NOTE SHEET	
PLANS & PROFILES	
SPECIAL DETAILS	
MASS DIAGRAMS	
QUANTITY SHEETS	

BRIDGE PLANS
SIGNING PLANS

LEGEND

A.D.T.....	
D.H.V.....	
COMM. %	
DESIGN SPEED.....	

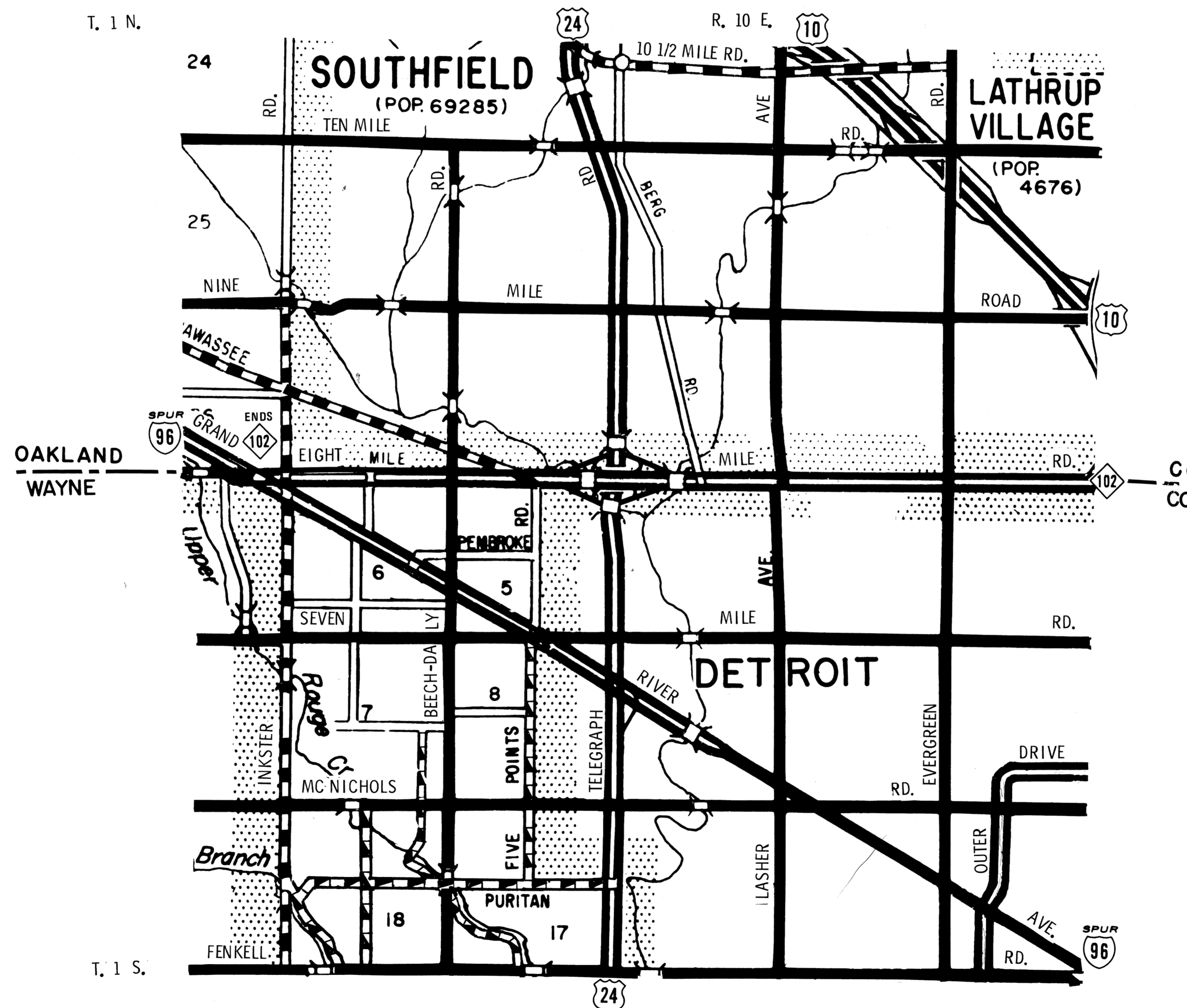

TITLE SHEET LEGEND

	EXISTING CONDITION
PAVED	
BITUMINOUS	
GRAVEL	
UNIMPROVED OR CITY STREET	
SECTION LINE	
TOWNSHIP LINE	
COUNTY LINE	
CITY OR VILLAGE LIMITS	
RAILROADS	

ITEM NO.	
CONTRACT FOR APPROVALS	
CHECKED	ENGINEER - DESIGN SECTION II
RECOMMENDED FOR APPROVAL	ENGINEER OF DESIGN
RECOMMENDED FOR APPROVAL	ENGINEER OF TRAFFIC & SAFETY
RECOMMENDED FOR APPROVAL	ENGINEER OF CONSTRUCTION
DEPARTMENT OF STATE HIGHWAYS AND TRANSPORTATION JOHN P. WOODFORD - DIRECTOR	
APPROVED BY:	DEPUTY DIRECTOR - HIGHWAYS
PLANS PREPARED BY MICHIGAN DEPARTMENT OF STATE HIGHWAYS AND TRANSPORTATION	
U.S. DEPARTMENT OF TRANSPORTATION FEDERAL HIGHWAY ADMINISTRATION	
SQUAD	CLOCK
APPROVED	
UM 82053	JOB NUMBER 06459A
	FEDERAL PROJECT
	SHEET NO. 1

UM 82053-06459A

TYPICAL CROSS-SECTIONS

F.H.W.A. REG. NO.	STATE	FEDERAL PROJECT	R.O.W. NO.	SHEET NO.	TOTAL SHEETS
4	MICH.				
ROUTE	COUNTY	CONTROL SECTION	JOB NO.		
U.S.-24	WAYNE	82053	06459		

FINAL R.O.W.

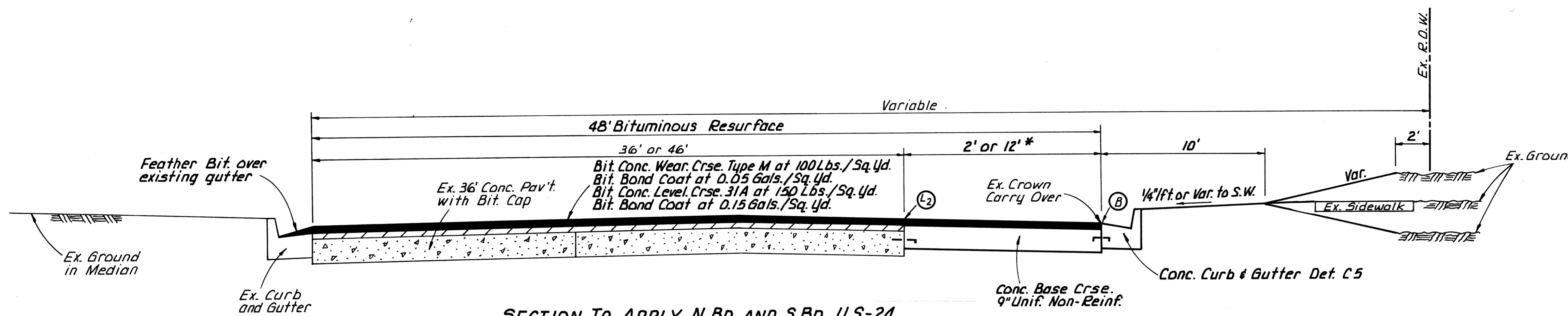

SECTION TO APPLY N.B.D. AND S.B.D. U.S.-24

48' BITUMINOUS RESURFACING:
Sta. 101+00 to Sta. 148+65 N.B.D.
Sta. 101+70 to Sta. 148+65 S.B.D.

*** CONCRETE WIDENING**

Sta. 101+00 to Sta. 102+71 N.B. } 2' Wide
Sta. 118+35 to Sta. 118+75 S.B. }
Sta. 102+71 to Sta. 114+65 N.B. } 12' Wide
Sta. 118+73 to Sta. 131+75 N.B. }
Sta. 132+62 to Sta. 148+63 N.B. }
Sta. 118+70 to Sta. 148+65 S.B. }

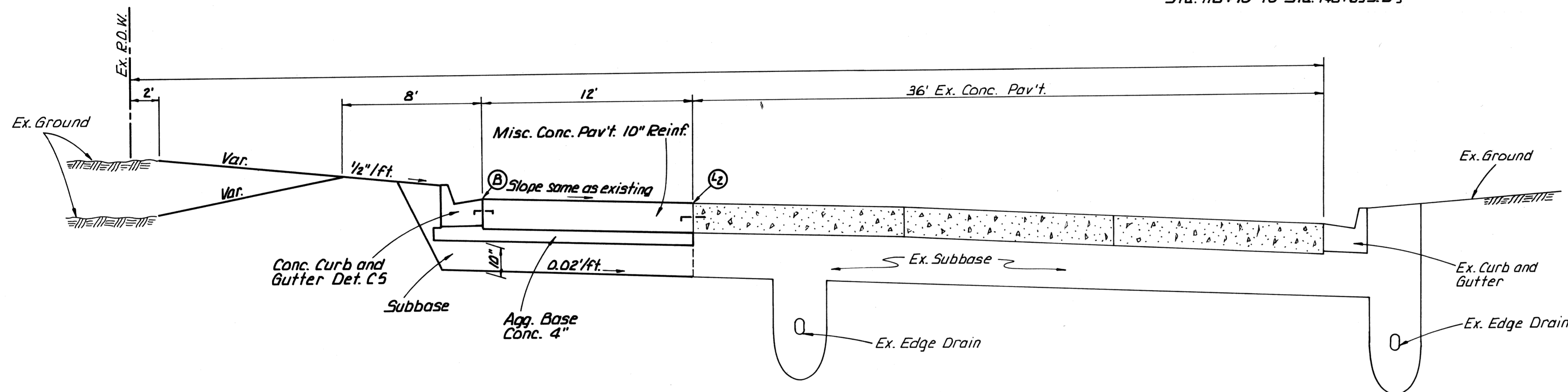

SECTION TO APPLY S.B.D. U.S.-24

Sta. 148+65 to Sta. 150+12 S.B.D.

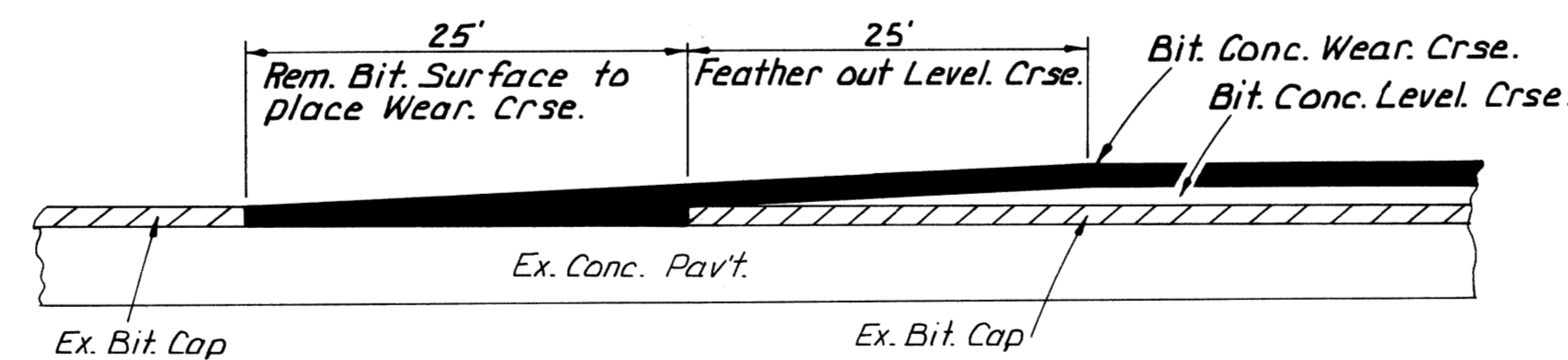

SURFACING TRANSITION SKETCH

NOTES

Surfacing at intersections back to the spring line will be of the same material and rate of application as U.S.-24, but will be paid for as Bituminous Approach. Also the left turn slots in the median will be paid for as Bituminous Approach. Approaches to cross streets and drives will be surfaced as Bituminous Approach at 160 Lbs./Sq. Yd.

ASPHALT PENETRATION

Bituminous Concrete Wearing Course } 85-120
Bituminous Concrete Leveling Course }

All unsodded slopes and ditches shall be mulched at the rate of two tons per acre.
Class A Slopes will be required on this project.
The edges of existing pavement shall be thoroughly cleaned before concrete widening is placed.
Topsoil shall be stockpiled for use as Topsoil Surface. Any such material not required for Topsoil Surface shall be used as far as possible in fill slopes outside of a 1 on 1 slope below the intersection of the front slope and the bottom of subbase, and in median fill areas. No allowance will be made for double handling.

JOINT LEGEND FOR PAVEMENT JOINTS

B - Longitudinal Bulkhead Construction Joint, according to Standard Plan II-39A, Detail 2.
L₂ - Longitudinal Bulkhead Construction Joint, according to Standard Plan II-39A, Detail 4A.
Detail 4 of Standard Plan E-4-A-127C shall be modified so that joint spacing for widening will be determined by dividing existing joint spacing into equal lengths of approximately 20'.

F.H.W.A. REG. NO.	STATE	FEDERAL PROJECT NO.	R.O.W. SHEET NO.	TOTAL SHEETS
4	MICH.			
ROUTE	COUNTY	CONTROL SECTION	JOB NO.	
U.S.-24	WAYNE	82053	06459	

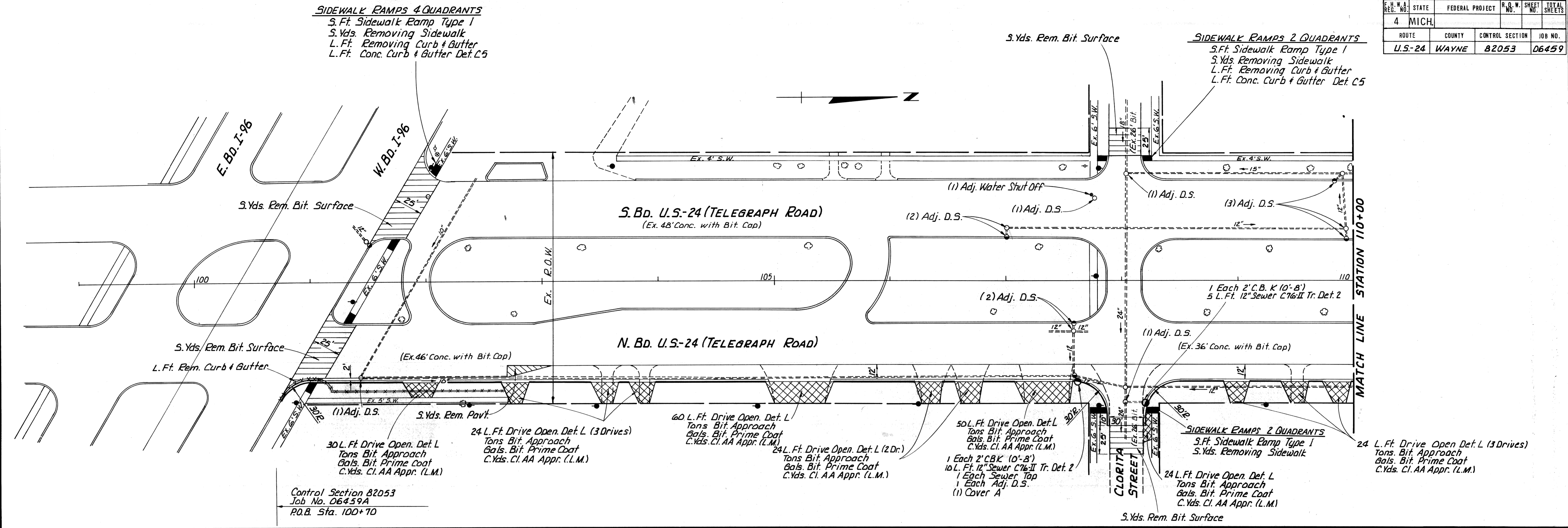

Control Section 82053
 Job No. 06459A
 P.O.B. Sta. 100+70

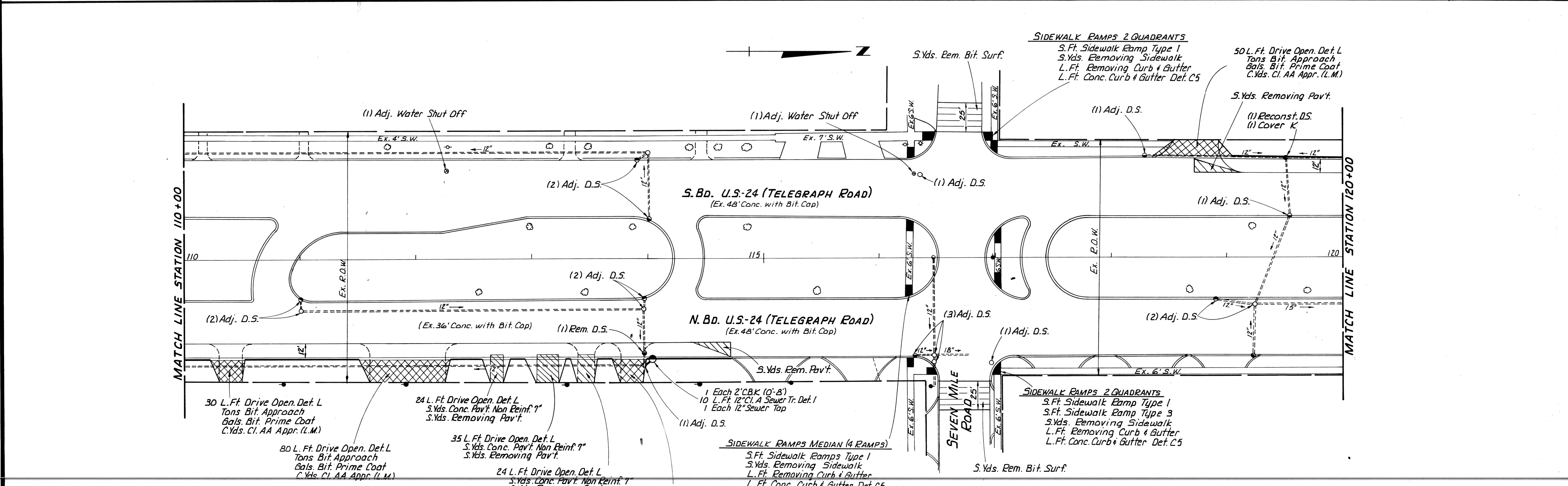

F.H.W.A. REG. NO.	STATE	FEDERAL PROJECT	R.O.W. NO.	SHEET NO.	TOTAL SHEETS
5	MICH.				
ROUTE	COUNTY	CONTROL SECTION	JOB NO.		
U.S.-24	WAYNE	82053	06459		

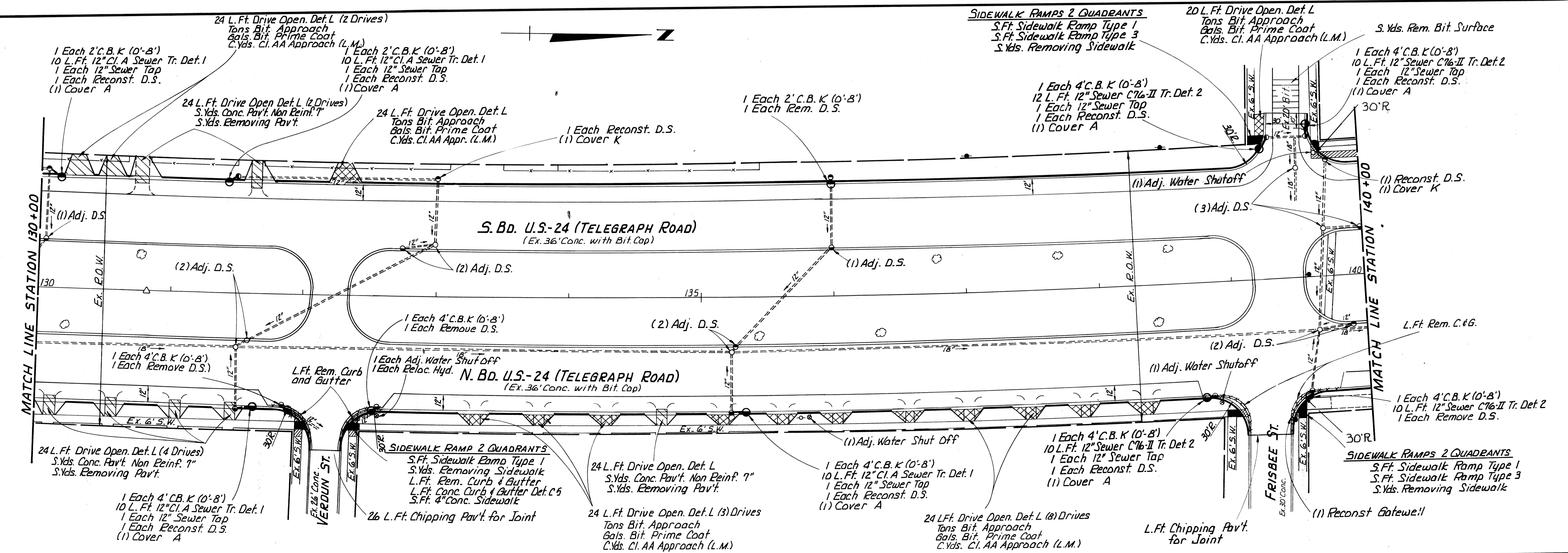
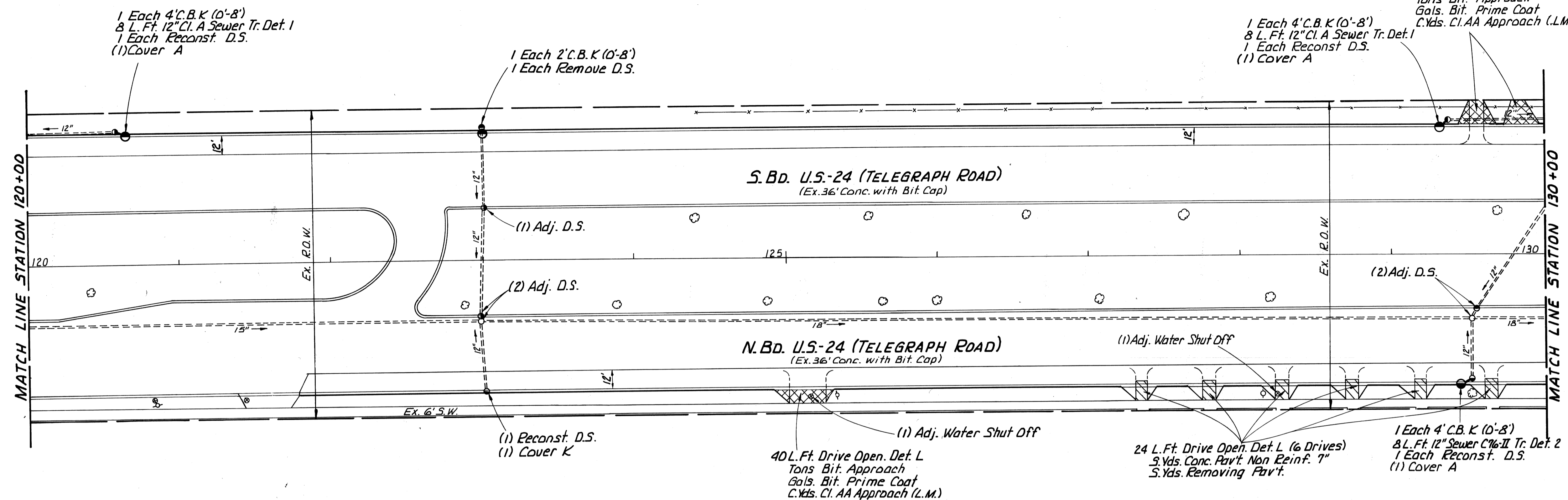

Control Section 82053
 Job No. 06459A
 POE. Sta. 148+65

F.H.W.A. REG. NO.	STATE	FEDERAL PROJECT	R.O.W. NO.	SHEET NO.	TOTAL SHEETS
5	MICH.				
ROUTE	COUNTY	CONTROL SECTION	JOB NO.		
U.S.-24	WAYNE	82053	06459		

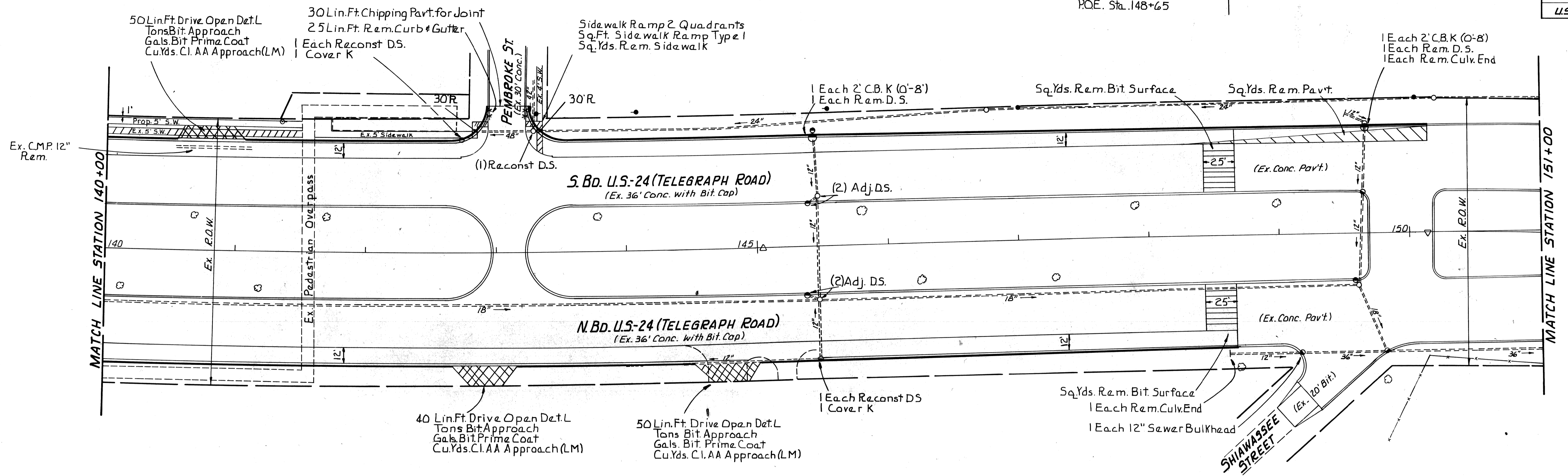

F.R.W.A. REG. NO.	STATE	FEDERAL PROJECT	R.O.W. NO.	SHEET NO.	TOTAL SHEETS
5	MICH.				
ROUTE	COUNTY	CONTROL SECTION	JOB NO.		
US 24	Wayne	82053	06459		

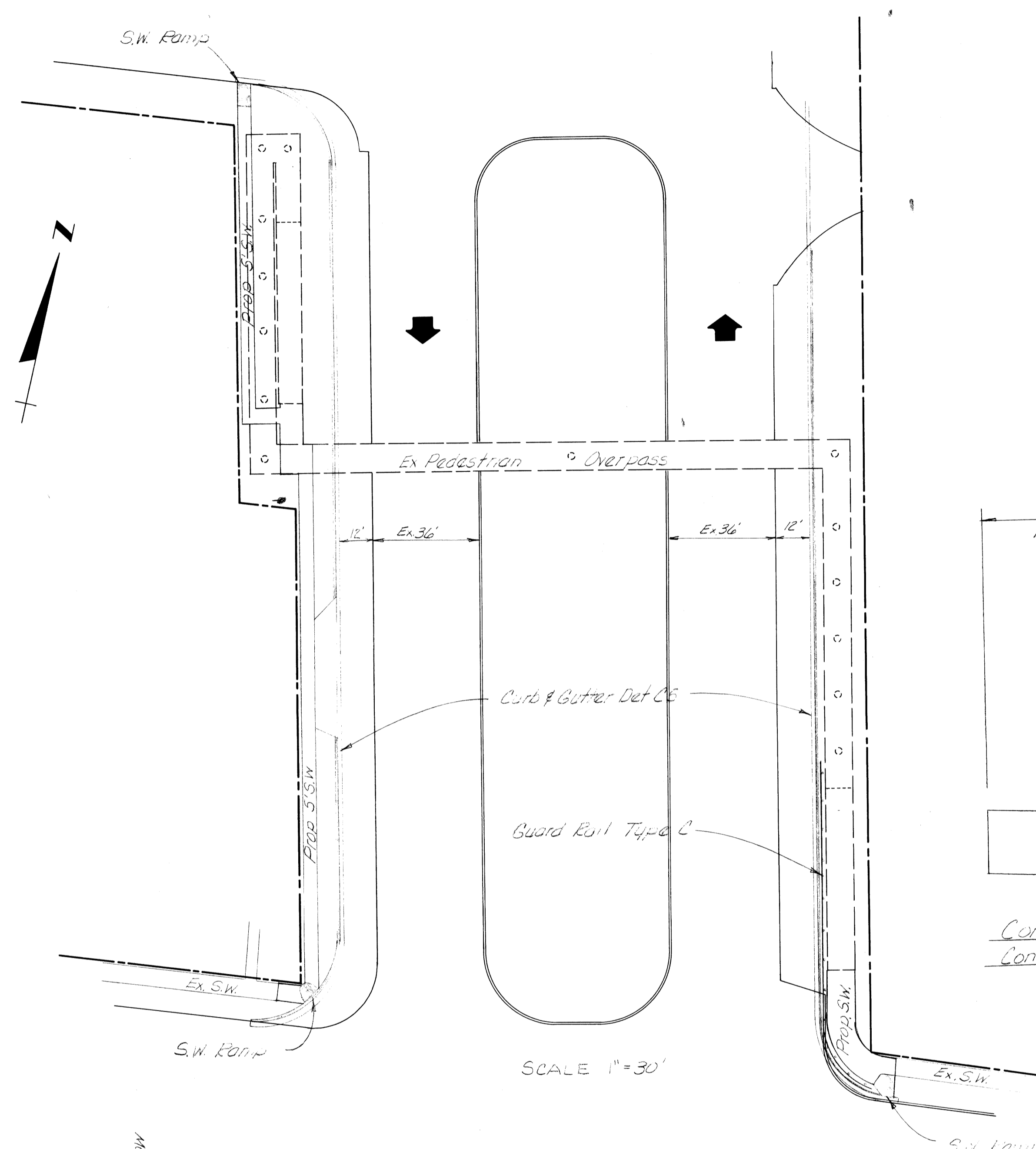

SCALE 1"=30'

Const barrier on additional 3" in width where barrier is adjacent to ramp wall

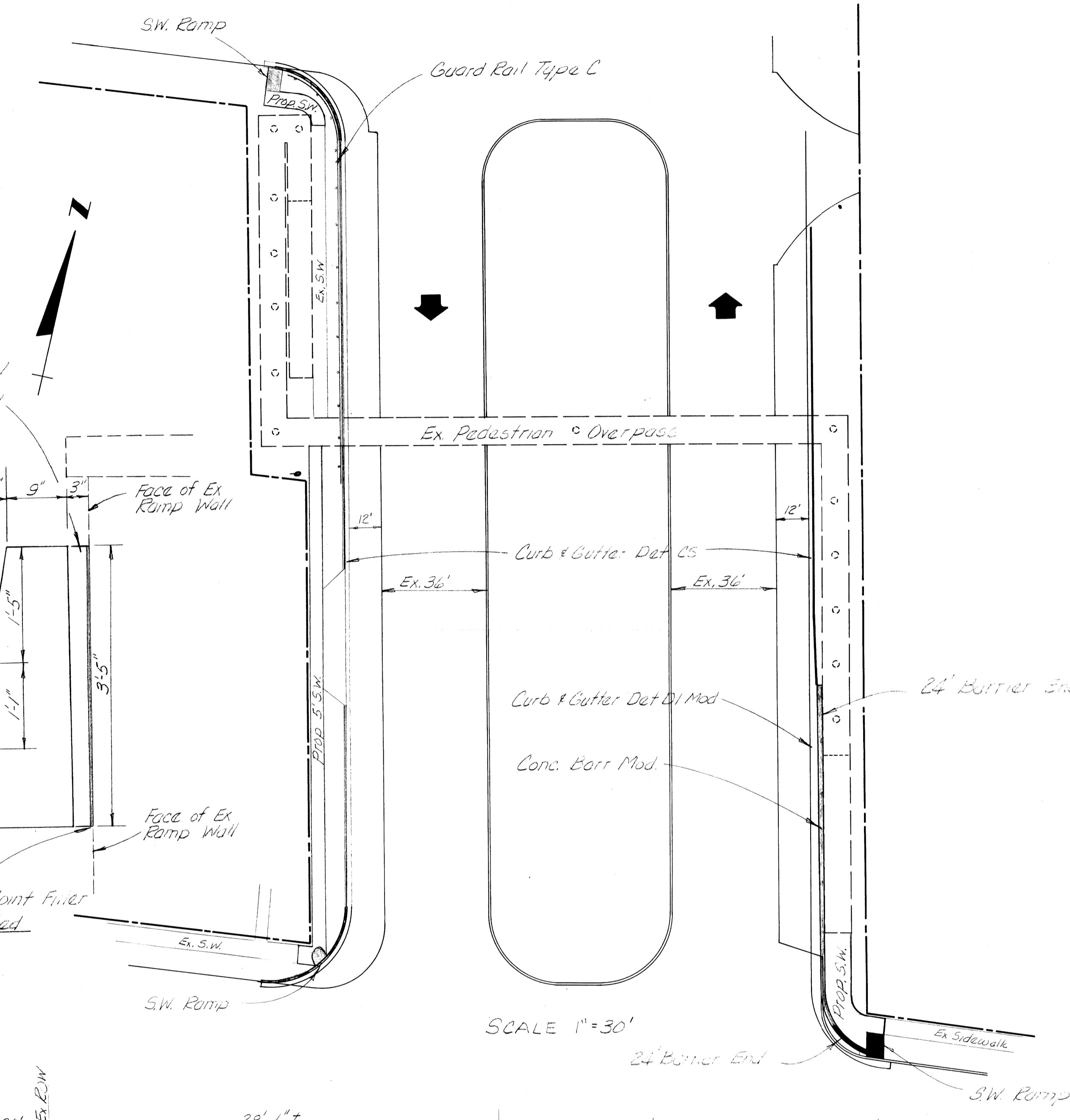
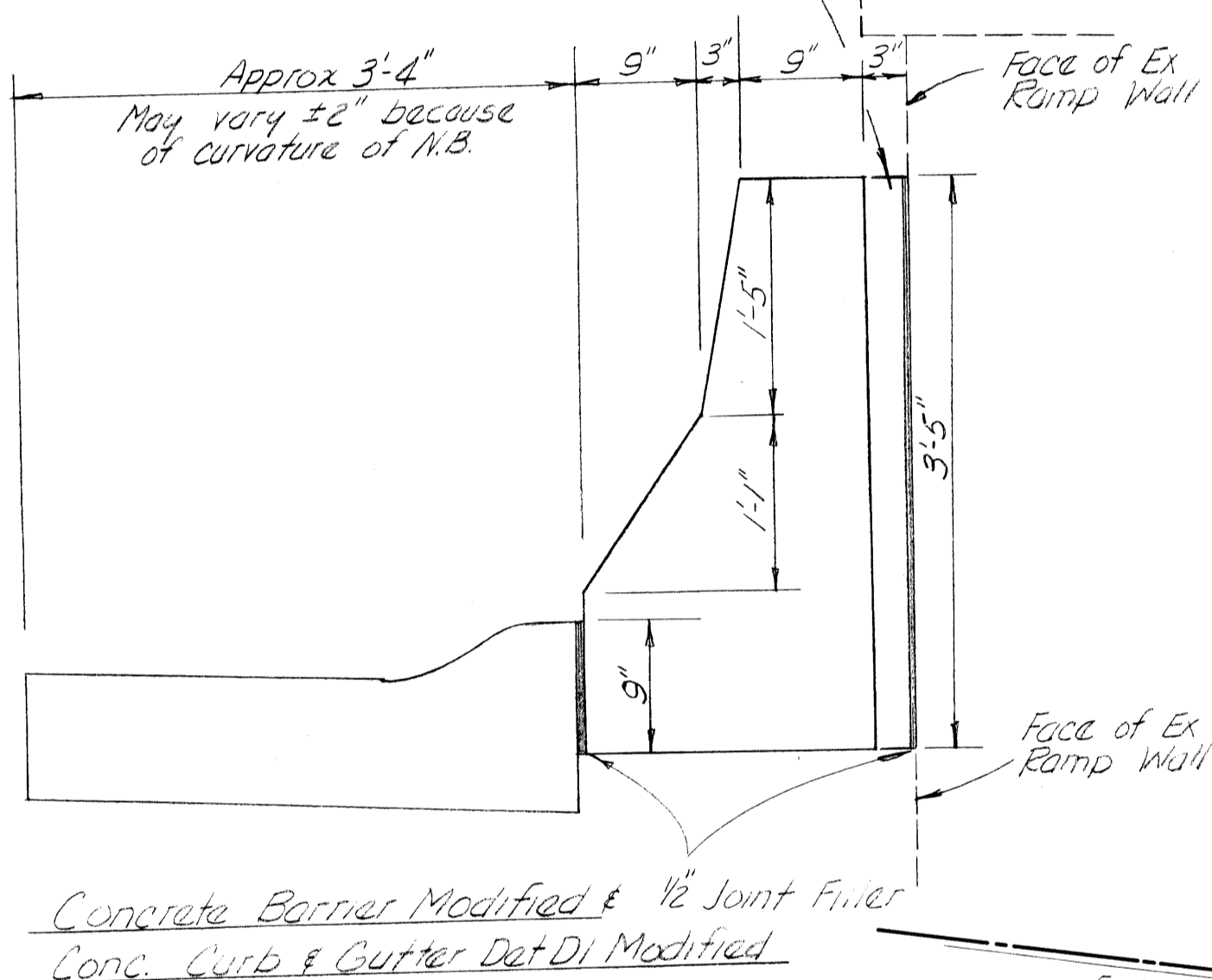

SCALE 1"=30'

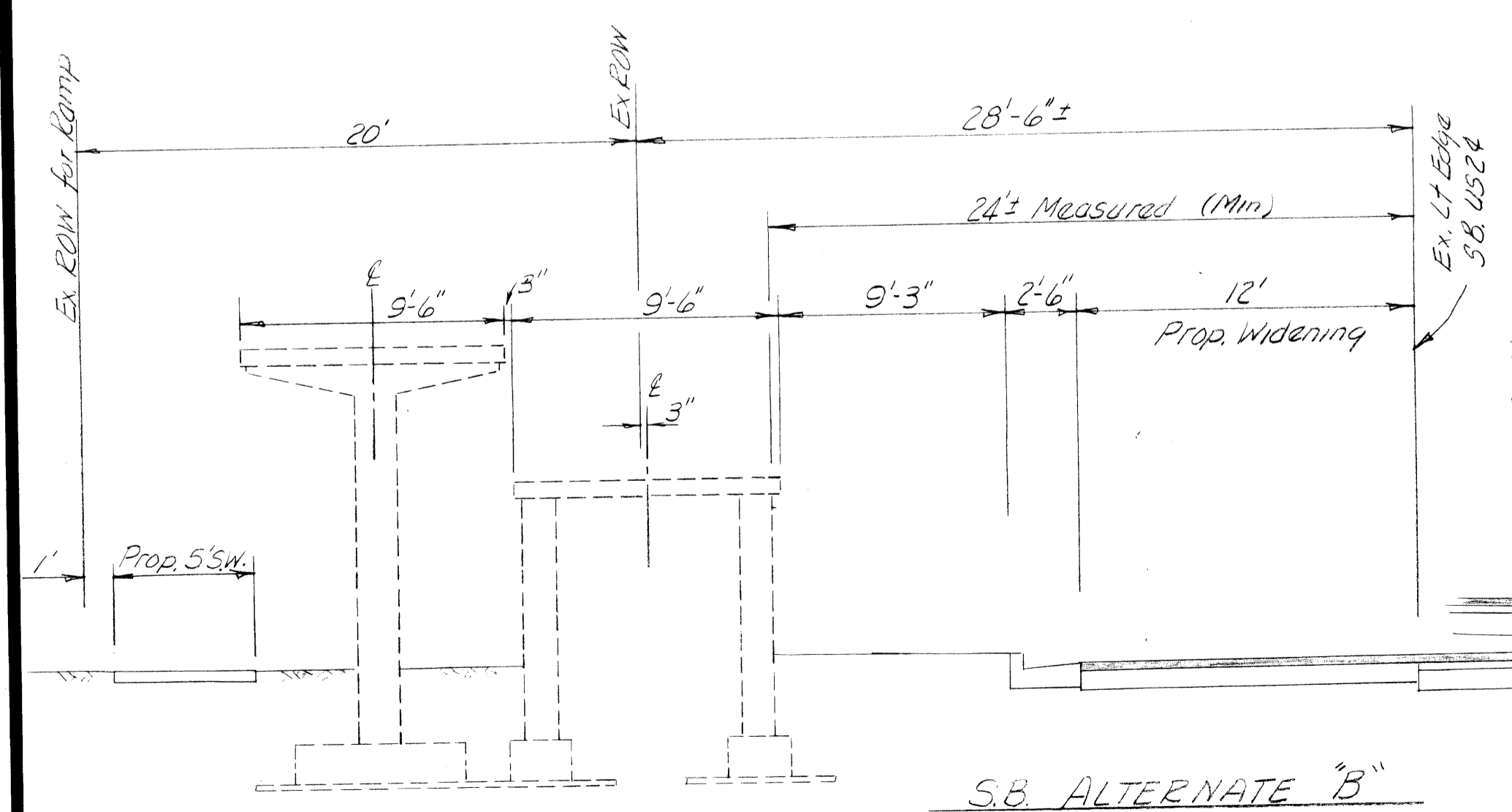

SB ALTERNATE 'B'

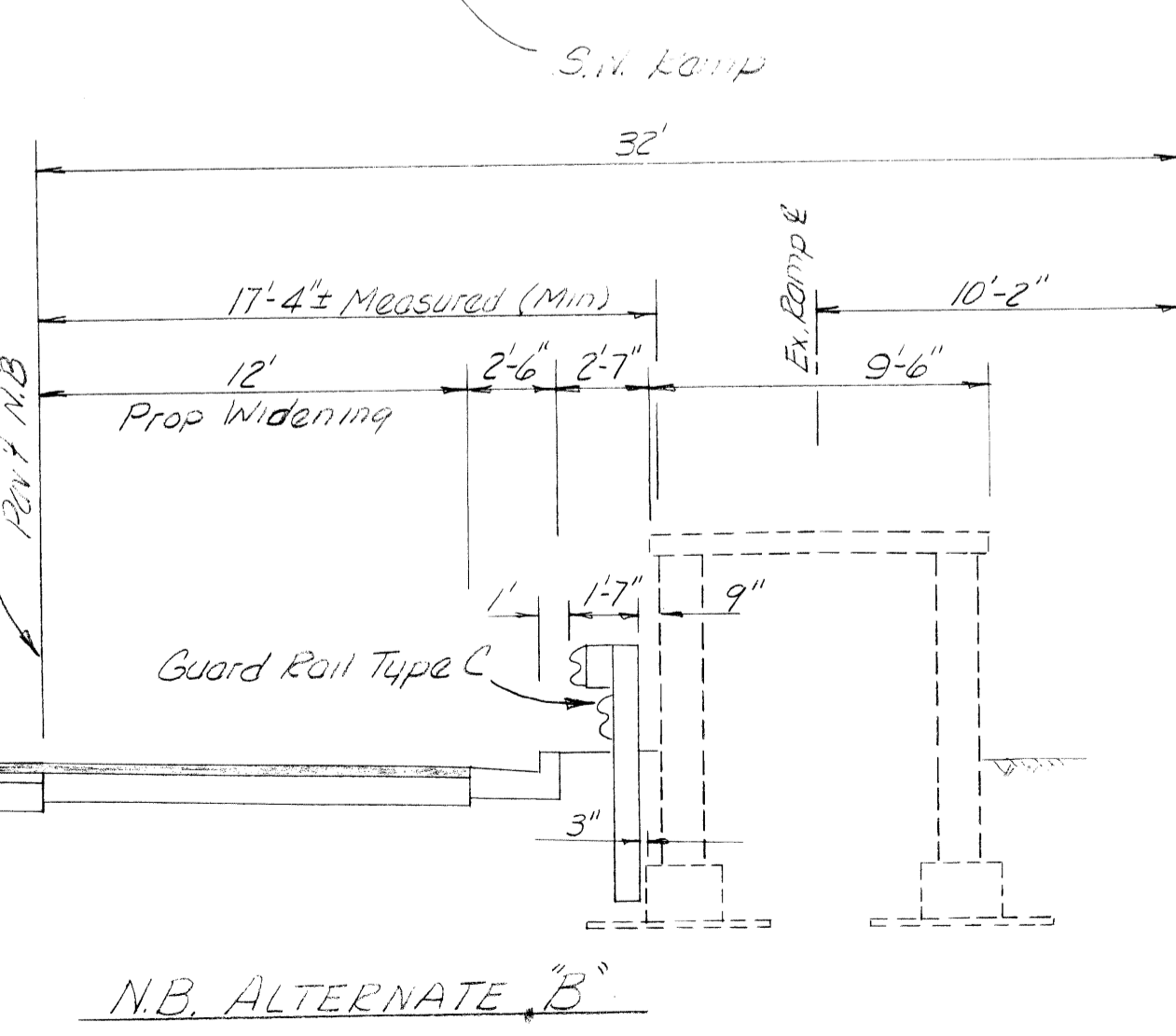

NB ALTERNATE 'B'

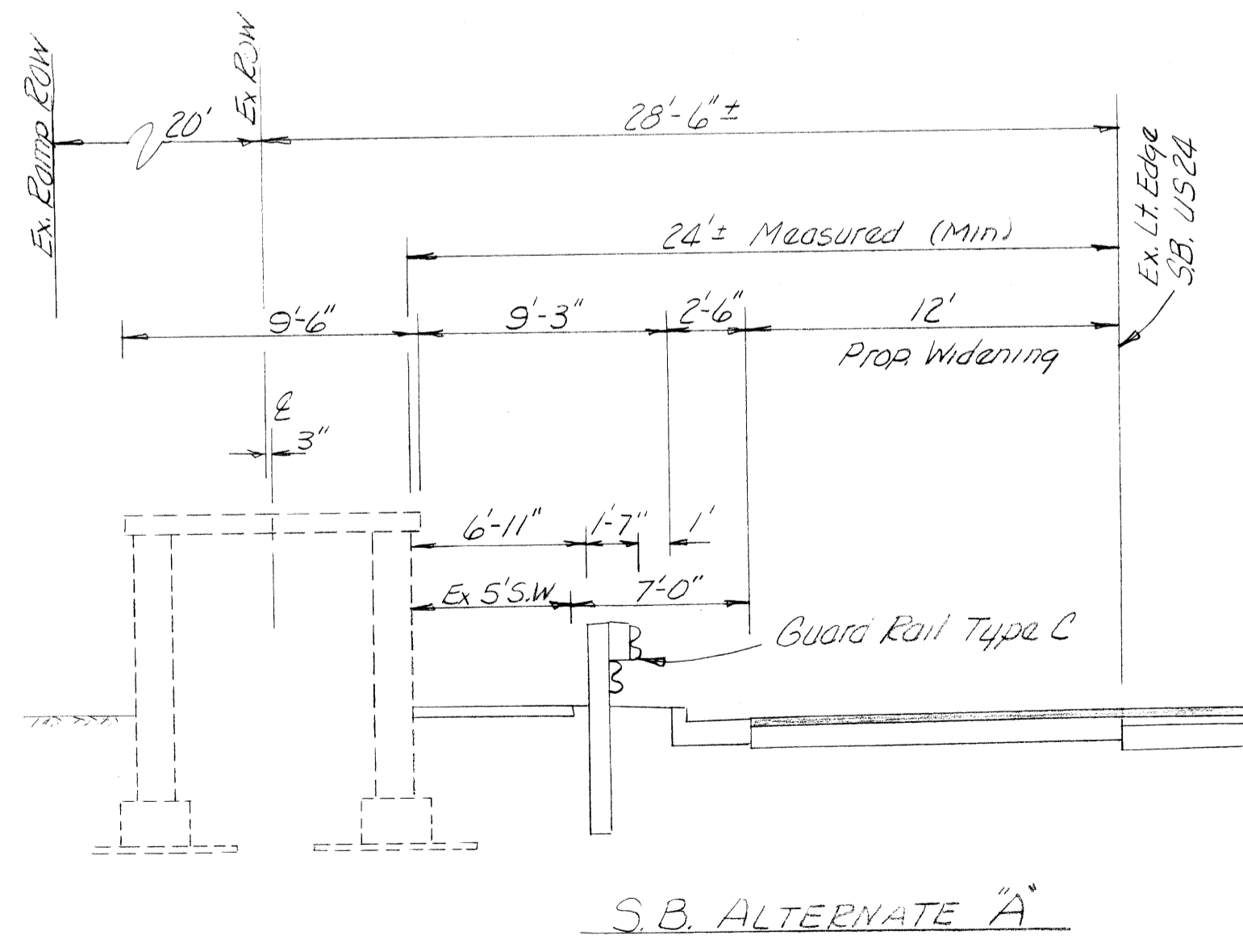

SB ALTERNATE 'A'

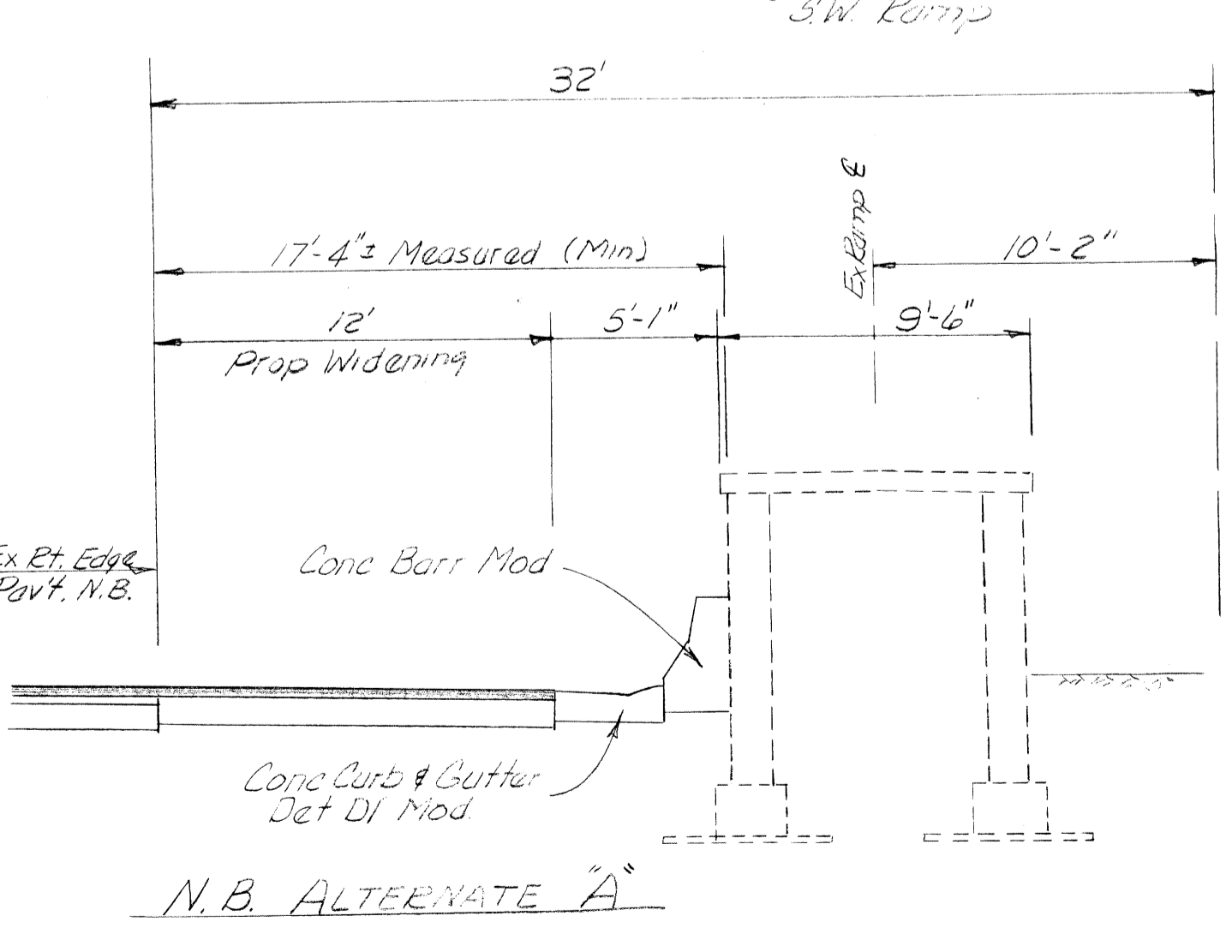

NB ALTERNATE 'A'

PEDESTRIAN OVERPASS ALTERNATES