

DEPARTMENT OF PUBLIC WORKS

STREET PAVING PLAN

WHITEHEAD

12.35' W. OF E.P.L. OF GILBERT
15' E. OF W.P.L. OF LIVERNOIS

49-18
325 J-24
2125
24 FT

Section - Robert R. Reom
R.B. Burdley
M. J. Sullivan
Martin Q. Frieber

26' 3/8" ✓	115 ✓	301 ✓	64 ✓	1054	79
729 ✓	31 ✓	35 ✓	35 ✓	10-13-48	
8-6-8 ✓	83 ✓	868 ✓	92 ✓	41/8/49	
8 UNIF.			38		
4 ✓	321 ✓	690 ✓	475 ✓	2/6/50	
RE CONE	25 ✓		475 ✓	3/2/50	
	1 ✓		18470 ✓	4/2/50	
	3 ✓		8970 ✓	4/2/50	
	100 ✓		71470 ✓	35735	
	88 ✓				
	3 ✓				
	100 ✓				
	88 ✓				
	84 ✓				

1/2" = 50'
1" = 50'
6-13-50
C.C. 6-13-50

1/2" = 50'
1" = 50'
6-13-50

6" CONC. DR. STP.

1/2" = 50'
1" = 50'
6-13-50

1/2" = 50'
1" = 50'
6-13-50

PET. NO. 2125 STANLEY KOZLOWSKI 7/6/48
GILBERT TO LIVERNOIS-FORCEDRAVE 7-4-49

BENCH MARKS
P.B.M. 13-252 N.E. COR. OF PELOUZE & CICCOTTE
B.M. ARROW ON HYD. SE COR. GILBERT & WHITEHEAD
B.M. ARROW ON HYD. OPR. SOUTH LINE WHITEHEAD EAST
SIDE OF LIVERNOIS
P.B.M. 13-2524 N.E. COR. OF PELOUZE & LIVERNOIS

NOTES:

- AT (A) ABANDON 2 EXISTING 12" L. BASINS, PLUG OUTLETS WITH CLASS "C" CONCRETE & REMOVE OR FILL BASINS WITH CLASS "C" CONCRETE.
- AT (B) CONSTRUCT 3 STD. 18" DIA. FLAT TYPE BASINS COMPLETE & CONNECT TO EXISTING OUTLETS AS SHOWN.
- AT (C) CONSTRUCT 24 FT RETURNS WITHOUT CURBS.
- AT (D) CONSTRUCT 1011 SQ. FT. OF 4" STD. SIDEWALK.
- ADJUST TOPS OF EXISTING WATER MANHOLES.
- ADJUST TOP OF EXISTING SEWER MANHOLE.
- ADJUST TOP OF EXISTING LAMPPOLE.
- RECONSTRUCT CONE OF EXISTING SEWER MANHOLE, IF NECESSARY.
- REMOVE 32' LIN. FT. OF EXISTING CURB.
- BACKFILL SEWER PIPE TRENCHES UNDER PROPOSED PAVEMENT WITH APPROVED SAND GRAVEL MATERIAL, ELSEWHERE FILL & TAMP WITH APPROVED EARTH LAYERS AS REQUIRED.
- DIRT ALLEYS, AT ENDS OF PAVEMENT SHALL BE GRADED BACK & STONED 6" DEEP UNIFORMLY FOR A DISTANCE OF 10 FT TO MEET EXISTING GRADES 2 1/2" CU YDS. IS INCLUDED UNDER EXCAVATION TOTALS FOR COST.
- CONTRACTOR SHALL FURNISH ALL NECESSARY MATERIALS INCLUDING CASTINGS & SHALL HAUL ALL SALVAGEABLE MATERIALS TO D.P.W. YARD AT STATE FAIR & JOHN R. STS.
- AT (E) CONSTRUCT 24 FT. RETURN WITH TYPE II CURBS, NO TEND.
- AT (F) CONSTRUCT 8" UNIFORM CONCRETE.

NOTE: COMMON COUNCIL DECLARATORY RESOLUTION DATED 7-6-49-ABSORBING AND BECOMING A PART OF AND PARCEL LYING NORTH OF AND ADJUTING WHITEHEAD AVENUE DEDICATED AS AN ALLEY.

41166

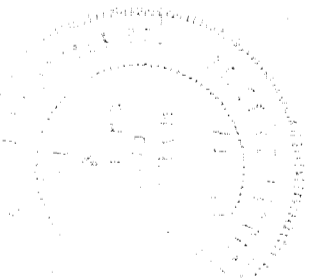
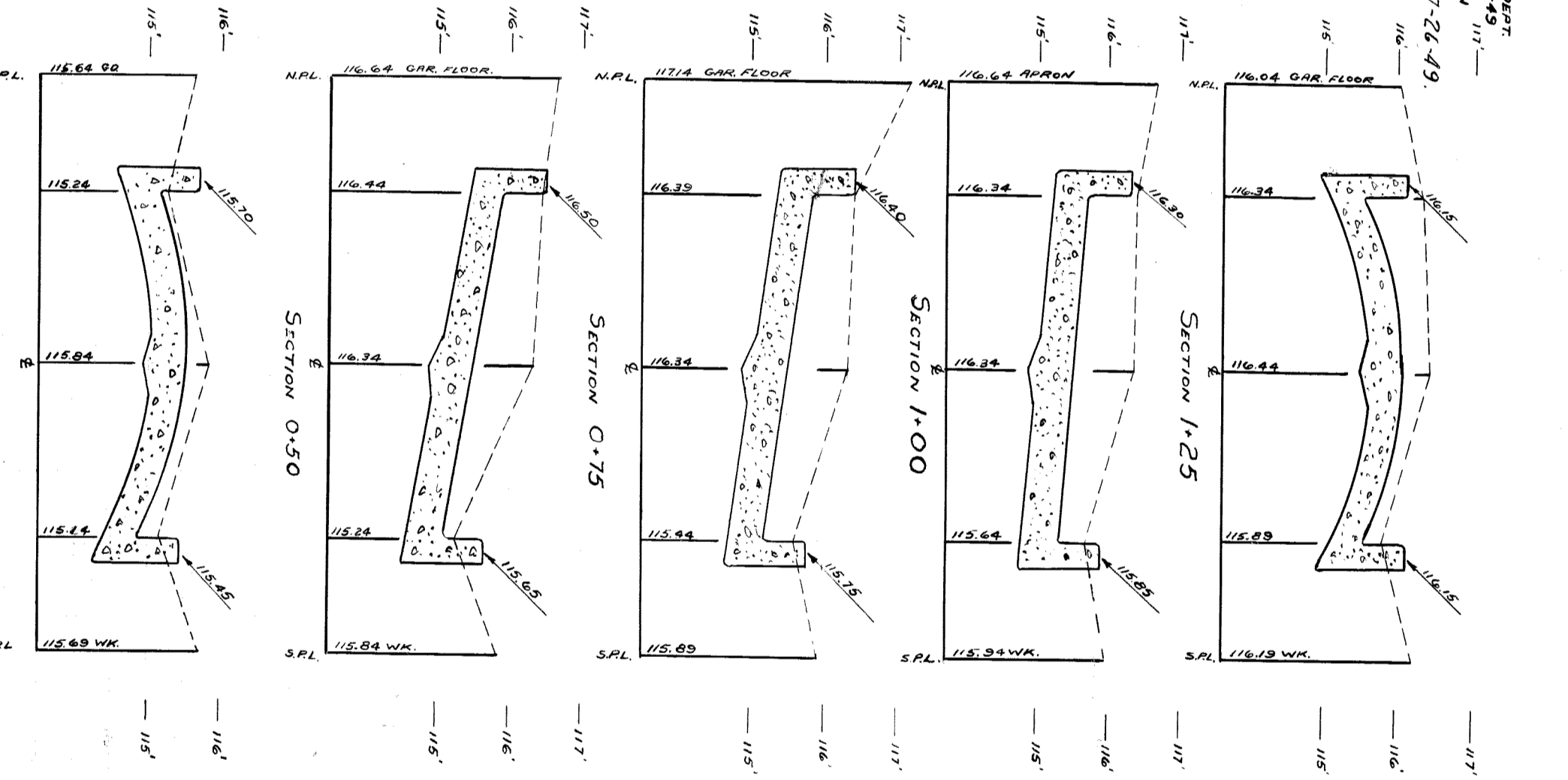
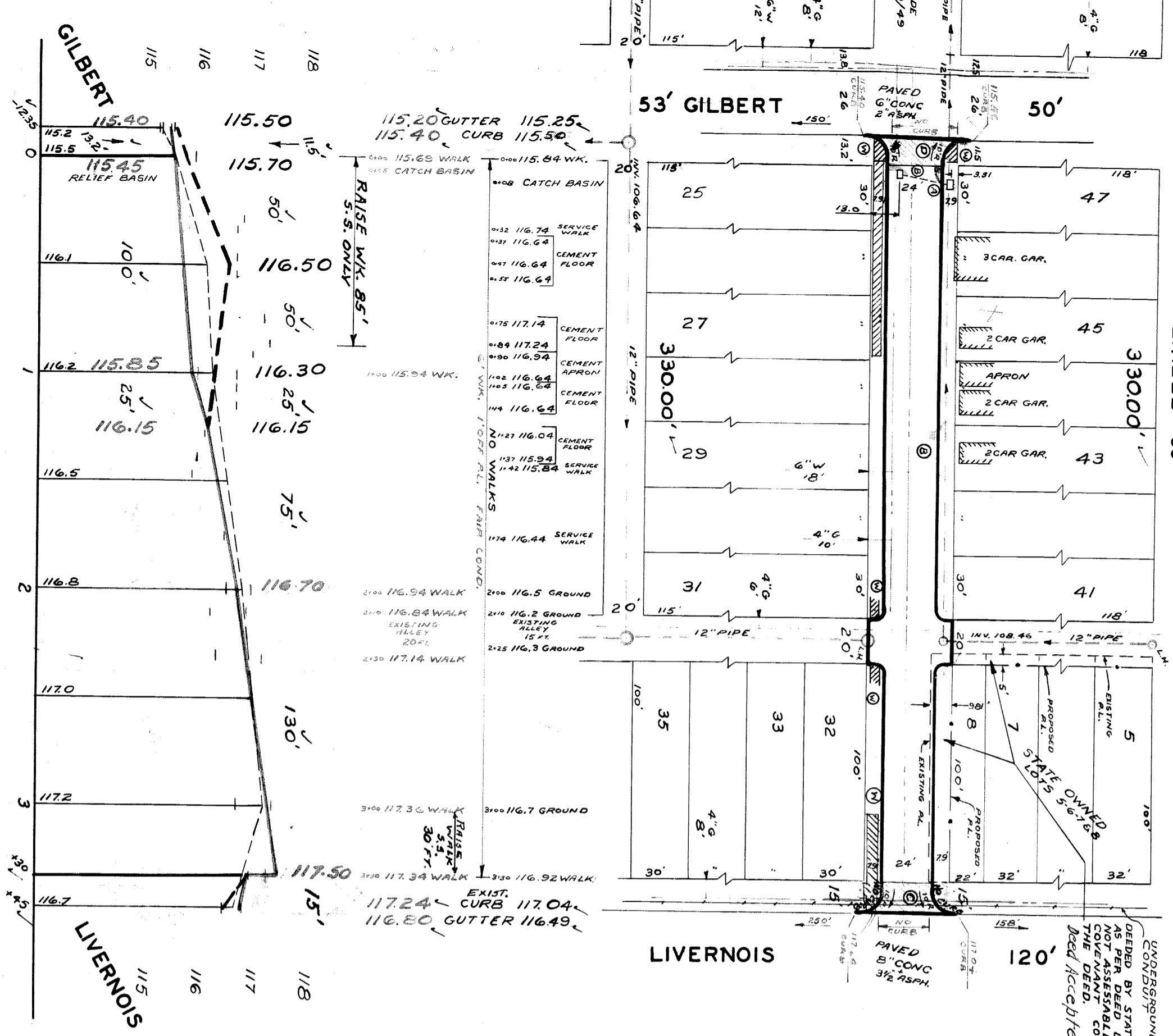

Note: Delayed until Fall Engineering Session
to be completed 12-2-48