

SEWER	REVISIONS	OLD MAP
C-327	C-586	C-739A
C-326A	C-585	C-739
C-325	C-524	C-738
C-324A	C-390	C-587
SUPPLEMENTARY DETAILS		
C-738		
C-739		
C-738		
C-739		
C-1609		

PLAN SCALE: 1" = 100'  
 STREET WIDTHS: 1 1/2" = 50'  
 PAYING COMPLETED: C.C. 5-29-51  
 WIDEN EXISTING 20' RETURN WITH TYPE II CURB TO 24' PAVE WING STRIP WITH 3/8" ASPH. ON 8" CONC. -10' RADII.

QUANTITIES	EST. QUANTITY	REMARKS
838	✓	109
91	✓	35
109	✓	11
35	✓	42
11	✓	342
42	✓	2
342	✓	1
2	✓	1
1	✓	6
6	✓	100
100	✓	80

1 1/2" = 2'	1688	32
8-25-50	9-8-50	0.8
1448761	22438	F.F.
4130	2065	
1490061	74503	

DESIGNED BY: KANSMAN  
 DRAWN BY: KANSMAN  
 CHECKED BY: SARBAN-RR ROOM  
 APPROVED BY: J. J. [Signature]  
 DEPUTY: [Signature]

DEPARTMENT OF PUBLIC WORKS DETROIT  
 CITY ENGINEERS' OFFICE - DIVISION OF PAVING DESIGN  
 STREET PAVING PLAN  
 WHITEHEAD  
 FROM 43658' W. OF W.P.L. OF CIGOTTE  
 TO 1315' E. OF W.P.L. OF GILBERT  
 SHEET 1 OF 1  
 ASSIGN NO. 325194/18  
 PETITION NO. 1764

CONTRACT NO. P.W.-1598 W

Pet. No. 1764 T. Smetana 5-16-50  
 Bench Marks  
 P.L. B.M. #13-283 N.E. cor. Palouge & Cicotte  
 Arrow of Hyd. 5th. cor. Cicotte & Whitehead  
 P.L. B.M. #13-2528 N.W. cor. Palouge & Livernors  
 115.040 -  
 118.02 -  
 118.48 -  
 116.138 -  
 Elev.

FOR SYMBOLS (C), ETC. SEE STD. DETAIL DRAWING # C-327

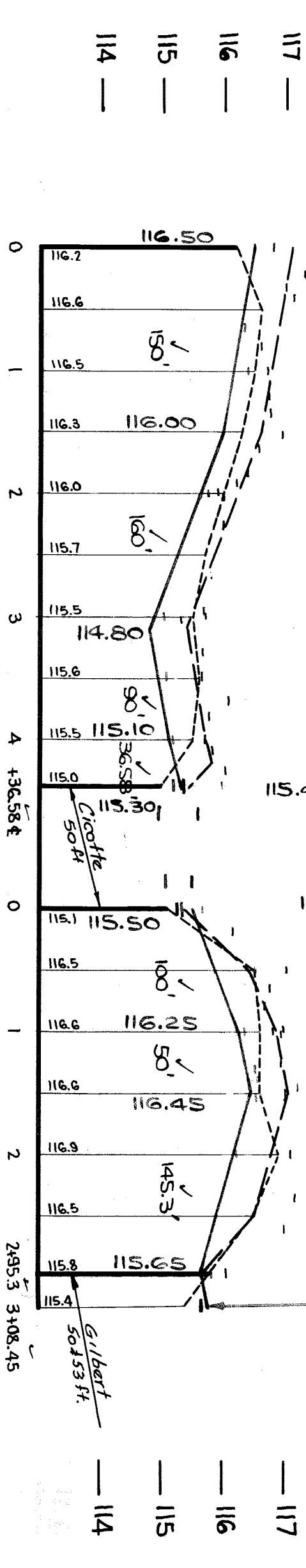

From Sta. 0+00 to Sta. 4+20 West of Cicotte  
 From Sta. 0+50 to Sta. 2+50 Cicotte to Gilbert

117 -  
 116 -  
 115 -  
 114 -

117 -  
 116 -  
 115 -  
 114 -