

CONTRACT NO. PRIVATE

DEPARTMENT OF PUBLIC WORKS DETROIT

CITY ENGINEER'S OFFICE -- DIVISION OF PAVING DESIGN

STREET PAVING PLAN

VAUGHAN (PARKING BAY)

NAME OF STREET: **VAUGHAN**

FROM: **ALLEY S. OF PLYMOUTH**

TO: **S.P.L. PLYMOUTH**

PROJECT NO.: 3258M-1

ASSAY NO.: 3258M-1

INDEX TO: **77 110**

RECORD NO.:

DATE OF SHEET: 10-16-52

DESIGNED BY: **W. OWENS**

DRAWN BY: **J. Erickson**

CHECKED BY: **J. Wallace**

APPROVED BY: **M. Vaughan**

ELEVATION: 142.159, 143.39

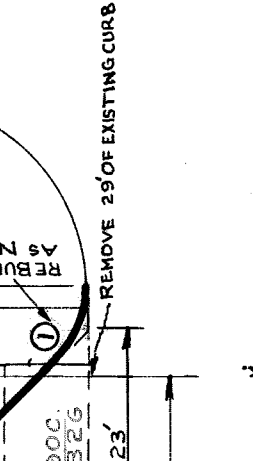
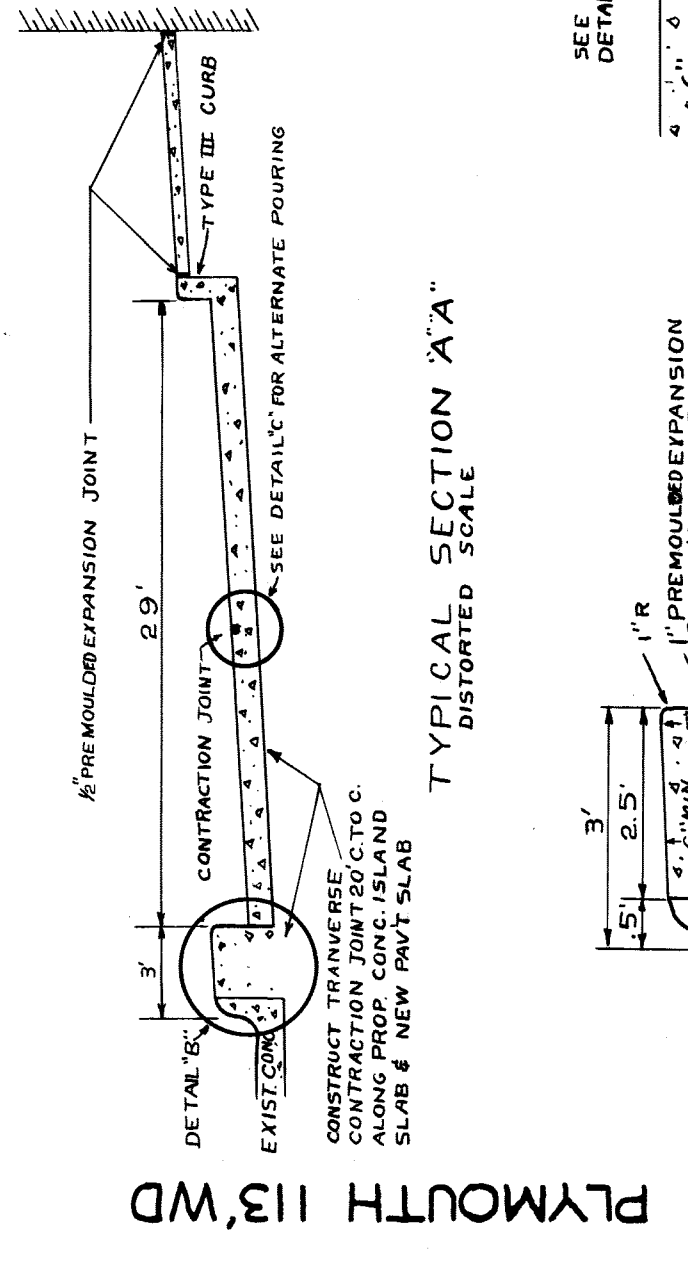
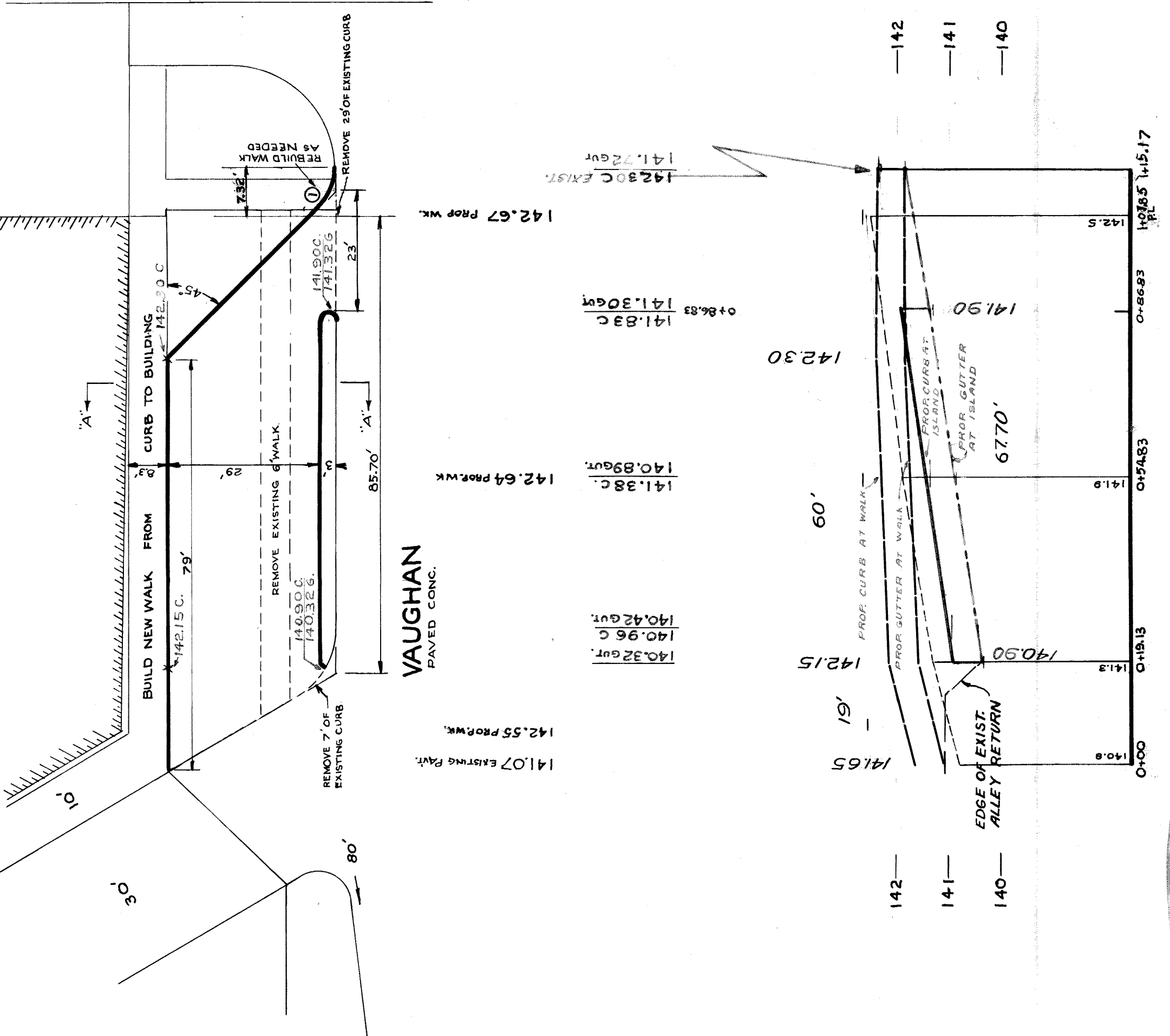

①
CURVE DATA
 $A = 45^\circ$
 $R = 10'$
 $T = 414'$

PRIVATE MR. JAY M. KOGAN

BENCH MARKS
 P.L.B.M.# 111-254 N.E. COR. PLYMOUTH & EVERGREEN
 ARR. ON HYD. E. SIDE VAUGHAN NO.# 11382

ELEVATION
 142.159 ✓
 143.39 ✓

REFERENCE - Traffic Eng. Draw'g. No. 06-36

410810