

DEPARTMENT OF PUBLIC WORKS
CITY ENGINEERS OFFICE - DIVISION OF PAVING DESIGN
STREET PAVING PLAN

SUSSEX

N.P.L. VASSAR
N.P.L. PEMBROKE

ONE COURSE CONCRETE, INDUSTRIAL GRADE
8" UNIFORM AT STREET INTERSECTIONS
W.F. Richardson Et Al

DESIGNED BY James W. Allen
CHECKED BY Senior Traffic Room
APPROVED BY
ENGINEER
ASSIST. ENGINEER

W. F. Richardson
MARTIN R. TAYLOR

NOTE:
BEFORE STARTING CONSTRUCTION CONTRACTOR MUST CHECK WITH UTILITIES FOR LOCATIONS OF EXISTING UTILITIES AND MARK THEM WITH CHAINS OR PINS.
PLAN SCALE DISTORTED
STREET WIDTHS 1"=50'
By D.P.W. 2 Basins - St. Martin's & Vassar
DRAINAGE COVER SET 8-9-43 10/1/48
PAVING COMPLETED 6/6/10/26/48

QUANTITIES	ESTIMATED	FINAL
RECONSTRUCTION CU YDS.	1383	536
NEW CURB LIN FT	4066	1383
PAVING 8 1/2" CONC. YDS.	1104	4066
STREETS 1" ADJUST	6	138
MANHOLE ADJUST	1	4
MANHOLE CONSTRUCT	8	1
MANHOLE CONSTRUCT	4	8
REPAIRS LIN FT	145	144
8" UNIF. PAV. SIDS	743	743

NO. OF LOTS	AREA	PERCENTAGE	DATE	REMARKS
1	2361.22	100%		
2	312.00	13.2%		
3	2673.22	114.7%		
TOTAL	5346.44	227.9%		

NO. OF LOTS	AREA	PERCENTAGE	DATE	REMARKS
1	1806.61	100%		
2	156.00	8.6%		
3	1336.61	74.4%		
TOTAL	3300.22	183.0%		

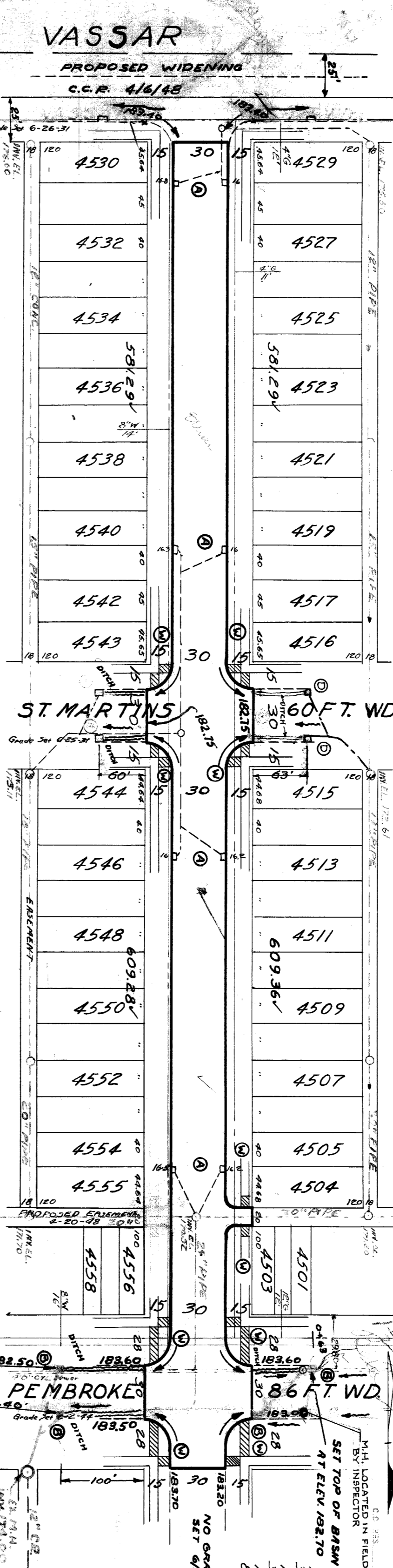

LOT NO.	W. BOUNDARY	E. BOUNDARY
4530	183.54 W	183.44 W
4532	183.64 DR	183.64 DR
4534	183.74 W	183.84 W
4536	183.64 DR	183.74 W
4538	183.36 W	183.46 W
4540	183.26 DR	183.26 DR
4542	183.16 DR	183.06 DR
4543	183.26 W	183.06 W
4544	183.16 W	183.06 W
4546	183.36 W	183.26 W
4548	183.46 DR	183.46 W
4550	183.56 DR	183.46 DR
4552	183.76 W	183.56 W
4554	183.91 DR	183.71 DR
4555	184.11 W	183.81 W
4556	184.11 DR	184.11 DR
4558	184.11 W	184.21 W
4558	184.12 W	184.23 W

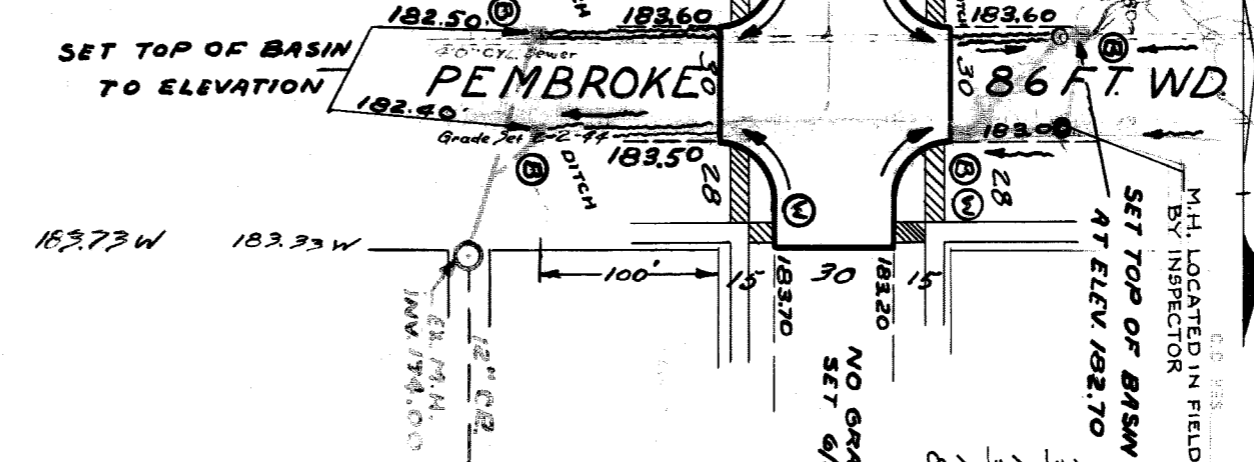
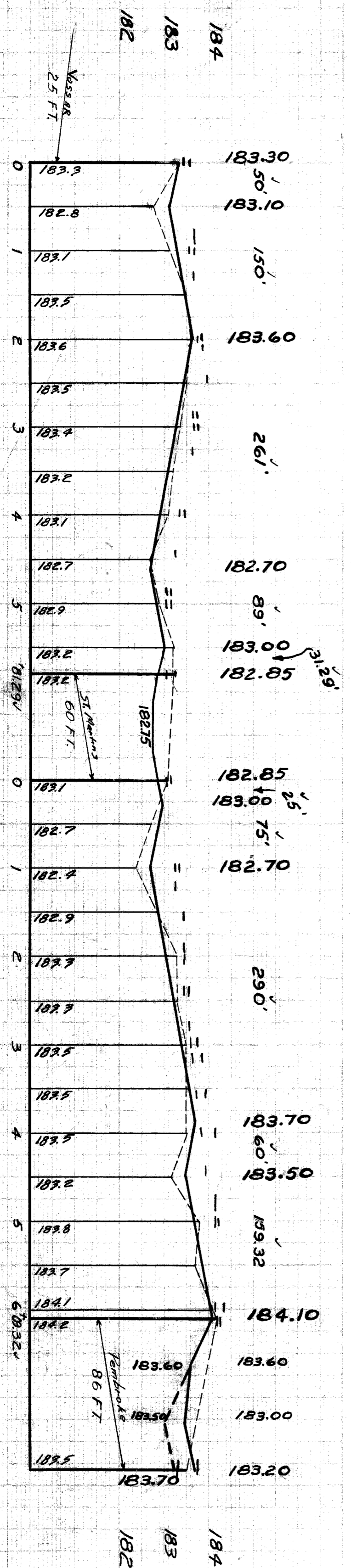

NOTES:

- ADJUST TOPS OF EXISTING 18"12"Y BASINS WITH FLAT GRATINGS & FRANKS.
- CONSTRUCT 4 STD. 18"12"Y DOME TYPE BASINS & CONNECT TO EXISTING OUTLETS AS SHOWN.
- ADJUST TOPS OF 4 EXISTING GATE BASINS IF NECESSARY AT UNIT COST FOR GATE BASIN ADJUSTMENT.
- CONSTRUCT 11045G. FT. OF STANDARD 4" SIDEWALK. CONTRACTOR SHALL CONSTRUCT UNIFORM DITCH WHERE SHOWN ON PLAN 30 CU YDS. IS INCLUDED UNDER EXCAVATION TOTALS FOR COST.
- ADJUST TOPS OF 6 WATER OR SEWER MANHOLES. DIET ROADWAYS AT PAVEMENT SHALL BE GRADED BACK & STONED 6" DEEP UNIFORMLY FOR A DISTANCE OF 10 FT. TO MEET EXISTING GRADES. 126 CU YDS. IS INCLUDED UNDER EXCAVATION TOTALS FOR COST. CONTRACTOR SHALL FURNISH ALL NECESSARY MATERIALS INCLUDING CASTINGS & SHALL HAUL ALL SALVAGEABLE MATERIALS TO D.P.W. YARD AT STATE FAIR & JOHN R. STS.
- ALL CURBS WITHIN STREET INTERSECTION TO BE SEPARATE TYPE II OR INTEGRAL TYPE III.

NOTE: 9-23-48
AT D.P.W. TO CONSTRUCT 2 NEW 18"12"Y BASINS & CONNECTING SEWERS AT LOCATION SHOWN.
CHARGE TO Acct # 911-2190-1324
Called Central Acct. 11/23/48 to send over copy of Bill for sewer.

410717