

SUSSEX AVE 60 FT

PURTAN TO McNICHOLS

B-1089
L. D. HAYS
ESTIMATE NO. 1104 NAT BANK BLDG
BETWEEN STS 4 & 6
CA 5823

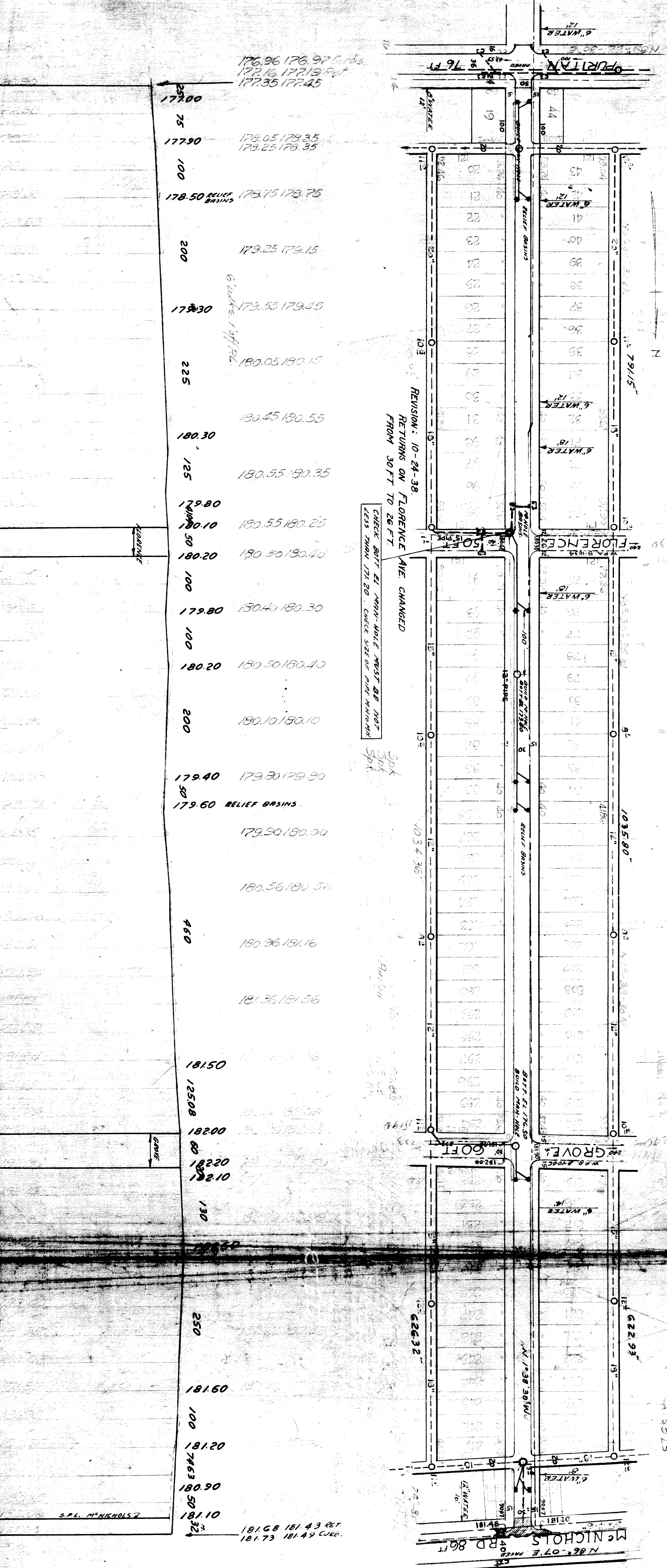

177.00	176.96 176.97	177.16 177.19	177.35 177.45
75			
177.90	178.05 178.35	179.25 179.35	
100			
178.50	178.75 179.75	RELIEF BASINS	
200	179.25 179.15		
179.30	179.55 179.45	6' WATER	
225	180.05 180.15		
180.30	180.45 180.55		
125	180.55 180.35		
179.80			
180.10	180.55 180.25		
180.20	180.50 180.40		
100			
179.80	180.40 180.30		
100			
180.20	180.50 180.40		
200	180.10 180.10		
179.40	179.80 179.30		
50	179.60	RELIEF BASINS	
	179.90 180.00		
460	180.56 180.56		
	180.36 181.16		
181.50			
125.08			
00281			
02201			
01281			
130			
250			
181.60			
100			
181.20			
7863			
180.90			
50			
181.10			
181.32			
	181.68 181.43	RET.	
	181.73 181.49	CURB.	

REVISION: 10-24-38.
RETURNS ON FLORENCE AVE CHANGED FROM 30 FT TO 26 FT.

CHECK BOLT ET MARK. HOLE MUST BE NOT LESS THAN 1/16". CHECK SIZE OF PIPE MAINMAN.

3pk
3pk
3pk

103 4 36"

103 4 36"

103 4 36"

103 4 36"

103 4 36"

103 4 36"

103 4 36"

103 4 36"

103 4 36"

103 4 36"

Field Investigated
Mar 1939
No. 1939
for - list

JOB-NO - D-2038

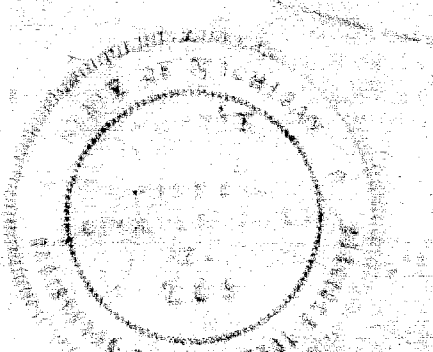

DESIGNED BY	W. L. HAYS	APPROVED	
DRAWN BY			
TRACED BY			
CHECKED BY	W. L. HAYS		

NOTE
NO GAS MAINS IN SUSSEX

LOTS	9	575	32	4	787	66
CITY		582	-	15	221	-
TOTAL	10	117	32	5	058	66

WATERMAN OK 11-4-38

1040	8725	30
	1541	
	2297	
	33	

DATE	11/1/38
BY	W. L. HAYS
FOR	16 1/16