

CONTRACT NO. P.W. 444

DEPARTMENT OF PUBLIC WORKS DETROIT
CITY ENGINEER'S OFFICE DIVISION OF PAVING DESIGN
STREET PAVING PLAN
STRASBURG
135 N OF S.R.L. OF PARK GROVE
N.P.L. OF LINNHURST

DESIGNED BY SAM A. SMITH
A. LAMIA
CHECKED BY J. L. BARTON
S. J. McWANE
APPROVED BY MARTIN R. FISHER
ASST. CHIEF ENGINEER

DATE 9-11-47
9-12-47
A.J.L.
P.M.
A.J.L.
P.M.
600 71
99 00
609 71

1"=100'
1"=2'
A.J.L.
S.S.
120 42
188 00
1399 42

NOTE: PAVING SHALL BE CONSTRUCTION CONTRACTOR'S RESPONSIBILITY.
STREETS TO BE PAVED WITH PORTLAND CEMENT CONCRETE.
CURBS TO BE PAVED WITH PORTLAND CEMENT CONCRETE.
SLOPES TO BE SHOWN ON THIS PLAN.
STREETS TO BE PAVED WITH PORTLAND CEMENT CONCRETE.
CURBS TO BE PAVED WITH PORTLAND CEMENT CONCRETE.
SLOPES TO BE SHOWN ON THIS PLAN.

UNIFORM AT STREET INTERSECTION
8" 6" 8"
BD. OF EDUCATION

LETTER FROM MILANE DATED TO CC. - 7-8-47
REQUESTING STREET BE PAVED & COST BILLED TO
BOARD OF EDUCATION

FORCED PAVING C.C.R. 4-29-47

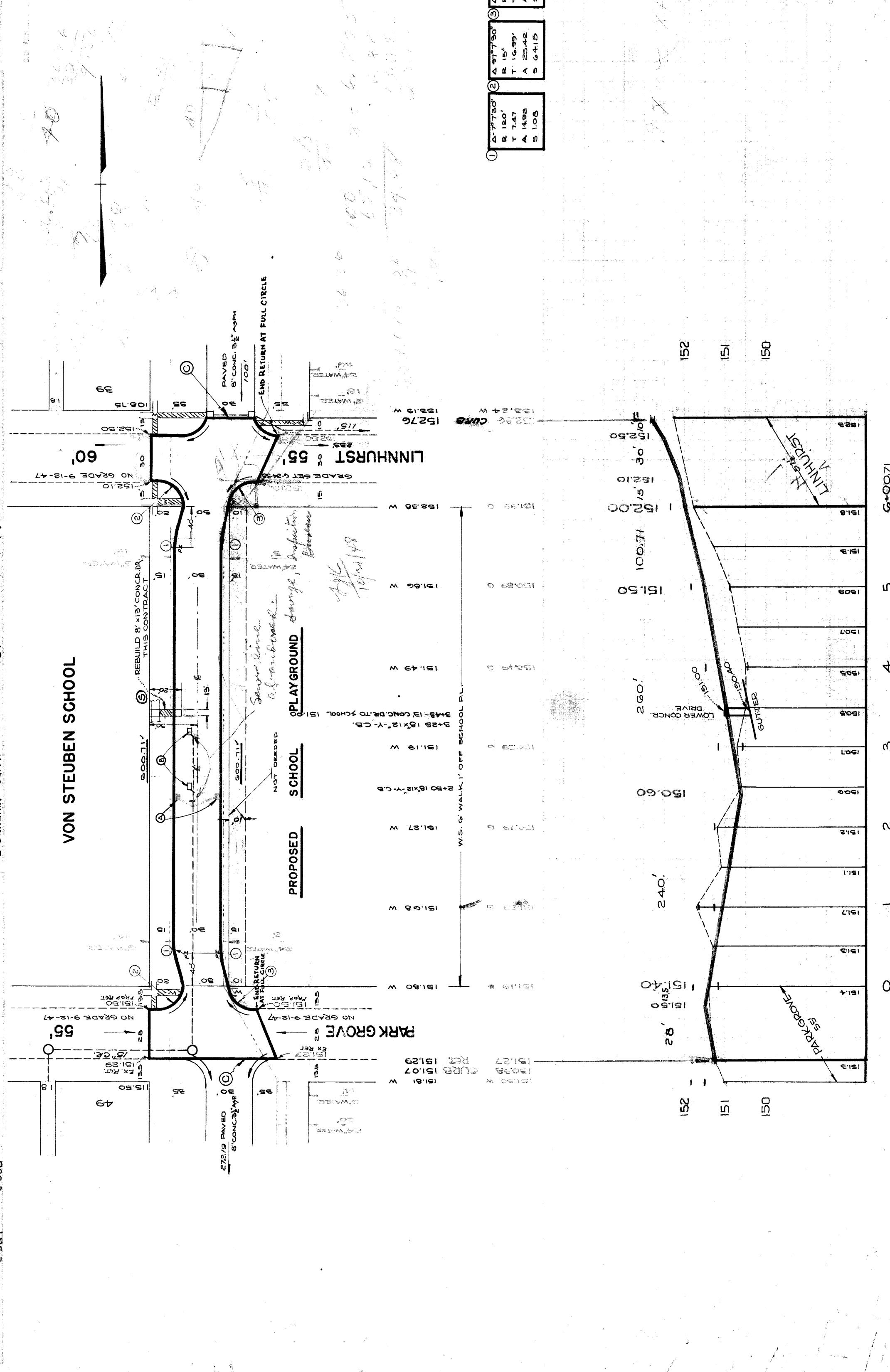

BENCH MARKS

PL.M. 67-251	ELEV.
TP. #18039	146.625
ARROW W. SIDE HAMBURG - OPP.	150.74
B.M. ARROW S.E. COR. HAMBURG & PARK GROVE	150.66
B.M. ARROW - HYD. SW. COR. PARK GROVE & STRASBURG	154.18
B.M. ARROW - HYD. W.S. OF STRASBURG & N. OF PARK GROVE	154.55
B.M. ARROW - HYD. N.W. CORNER LINNHURST & STRASBURG	155.71
PL.M. # 60-255 A - N.W. COR. GREINER & ANNOTT	146.82

-NOTES-

- AT (1) CONSTRUCT 2 STD. 18x12 Y-BASINS COMPLETE & CONNECT AS SHOWN
- AT (2) REMOVE 2 EXISTING BASINS & PLUS OUTLET FOR FILL BASINS WITH CLASS "C" CONCRETE
- CONTRACTOR SHALL FURNISH & INSTALL STD. FLAT-TYPE CATCH BASIN FRAMES & GRATES.
- CONTRACTOR SHALL HAUL ALL CASTING TO DR.W. YARD AT STATE FAIR & JOHN R.
- BACKFILL SEWER PIPE TRENCH WITH APPROVED SAND GRAVEL MATERIAL
- ALL CURBS WITHIN STREET INTERSECTIONS TO BE SEPARATE TYPE II OR INTEGRAL TYPE III.
- DIRT ROADWAYS, AT ENDS OF PAVEMENT, SHALL BE GRADED BACK & STORED & DEEP UNIFORMLY FOR A DISTANCE OF 10 FT. TO MEET EXISTING GRADES. 82 CU YDS IS INCLUDED IN EXCAVATION TOTALS.
- ADJUST TOPS OF 3 SEWER OR WATER MANHOLES.
- CONSTRUCT 627 SQ. FT. OF STD. 4" WALK.
- REBUILD 104 ± sq. ft. - 6" DRIVEWAY CONCR. SLAB
- CONTRACTOR SHALL REMOVE CONCRETE HEADER & BROKEN ASPHALT BACK OF JUNCTION AS REQUIRED, FILL WITH COLD PATCH TO MEET NEW GRADE. 20 CU YDS. ARE ADDED IN EXCAVATION TOTALS FOR COST.

1	Δ 77.50	Δ 77.50	Δ 82.50
R	15.0	R	15.0
T	7.47	T	16.99
A	14.98	A	25.42
S	1.06	S	6.415
			S 55.65

410609

