

DEPARTMENT OF PUBLIC WORKS DETROIT
 CITY ENGINEER'S OFFICE - DIVISION OF PAVING DESIGN
 STREET PAVING PLAN

PROJECT NO. 50-11
 SHEET NO. 72 115
 RECORD NO. 325AG-24
 DIVISION 312

STOUT
 28' S. OF N.R.L. OF PEMBROKE
 15' N. OF S.R.L. OF TROJAN

APPROVED BY: *Jacob J. Fisher*
 DRAWN BY: *McLean*
 CHECKED BY: *McLean*
 APPROVED BY: *R.R. Patton*
 DEPUTY CITY ENGINEER

OLD MAP 4-22-46
 REVISIONS NOTED ADDED 3-13-50
 DRAINAGE 3-24-50 F.F.
 5-28-50 DRWG. REVISED TO SHOW
 GAS LINE EXISTING C.S./K.M.

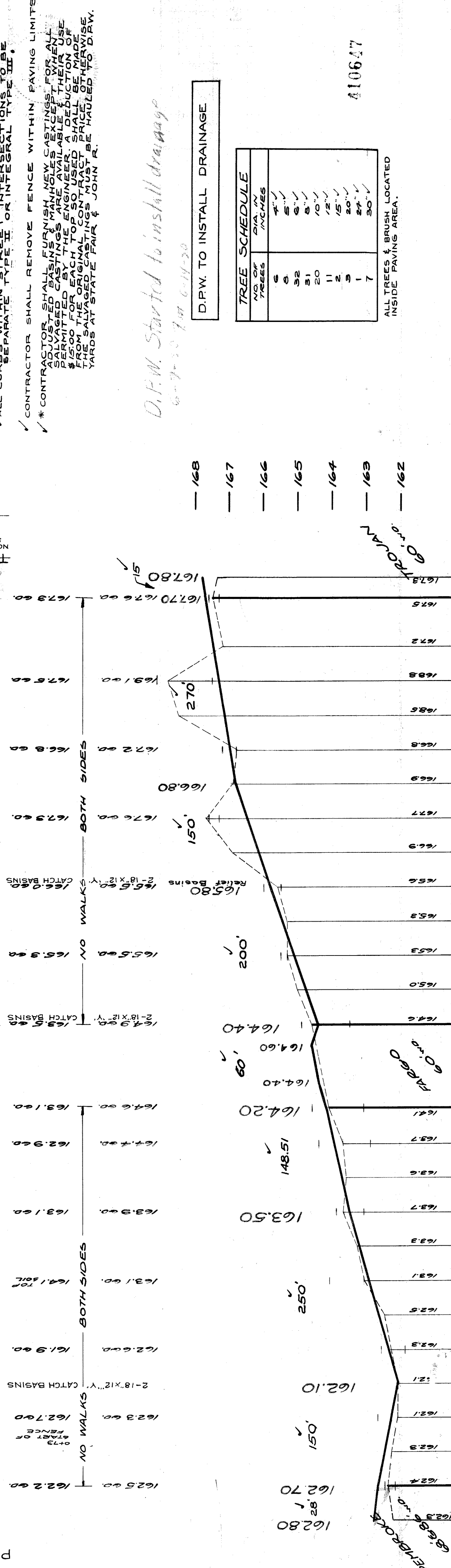
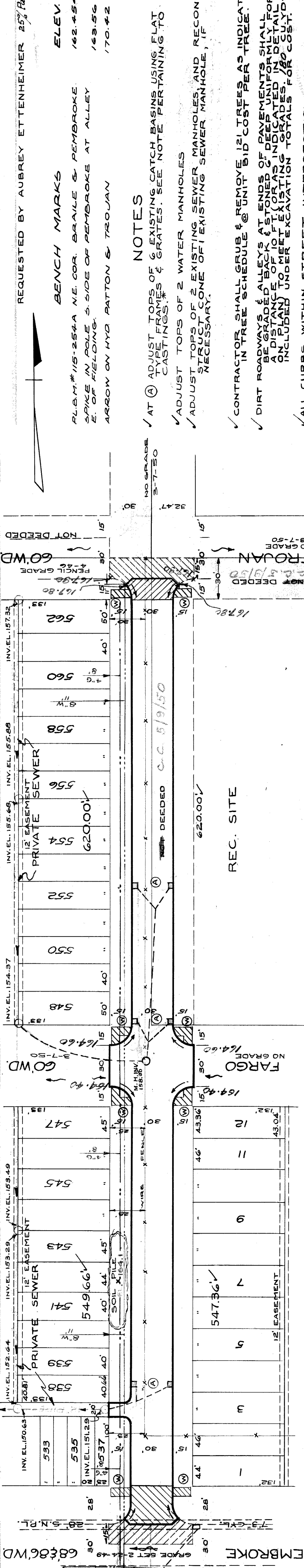

NOTES

- AT (A) ADJUST TOPS OF EXISTING CATCH BASINS USING FLAT TYPE FRAMES & GRATES. SEE NOTE PERTAINING TO CASTINGS.
- ADJUST TOPS OF 2 WATER MANHOLES
- ADJUST TOPS OF 2 EXISTING SEWER MANHOLES, AND RECONSTRUCT CONE OF EXISTING SEWER MANHOLE, IF NECESSARY.
- CONTRACTOR SHALL GRUB & REMOVE 121 TREES AS INDICATED IN TREE SCHEDULE @ UNIT BID COST PER TREE.
- DIRT ROADWAYS & ALLEYS AT ENDS OF PAVEMENTS SHALL BE GRADED BACK TO STONES OF PAVEMENTS INDICATED ON PLAN TO MEET EXISTING GRADES. 100 CUBIC YARDS INCLUDED UNDER EXCAVATION TOTALS FOR COST.
- ALL CURBS WITHIN STREET INTERSECTIONS TO BE SEPARATE TYPE II OR INTERSECTION TYPE III.
- CONTRACTOR SHALL REMOVE FENCE WITHIN PAVING LIMITS.
- * CONTRACTOR SHALL FURNISH NEW CASTINGS FOR ALL ADJUSTED BASINS & MANHOLES EXCEPT FOR ALL SALVAGED CASTINGS ARE AVAILABLE & THEIR USE PERMITTED BY THE ENGINEER. A DEDUCTION OF \$500 FOR EACH TOP SO USED. SHALL BE MADE OF THE SALVAGE ORIGINAL CONTRACT PRICE. OTHERWISE THE SALVAGE ORIGINAL CONTRACT PRICE MUST BE HAULED TO OTHER WARE YARDS AT STATE FAIR & JOHN R.

D.P.W. TO INSTALL DRAINAGE

TREE SCHEDULE	NO. OF TREES	DIA. IN INCHES
	6	4"
	9	5"
	32	6"
	31	8"
	20	10"
	11	12"
	3	15"
	1	20"
	1	24"
	1	30"

ALL TREES & BRUSH LOCATED INSIDE PAVING AREA.

*D.P.W. Started to install drainage
 6-7-50 7th 6-11-50*